

LATITUDE 39° 37' 30"

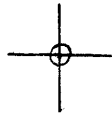

80° 12' 30"

LONGITUDE

7'5 OGIS topo location

7.5' loc 0.42 S 15' loc _____
' 0.57 W (calc.) _____

Company _____

Farm _____

Quad GRANT TOWN 7 1/2'

County MONONGALIA

District CLAY

WELL LOCATION MAP

File No. 061-0451

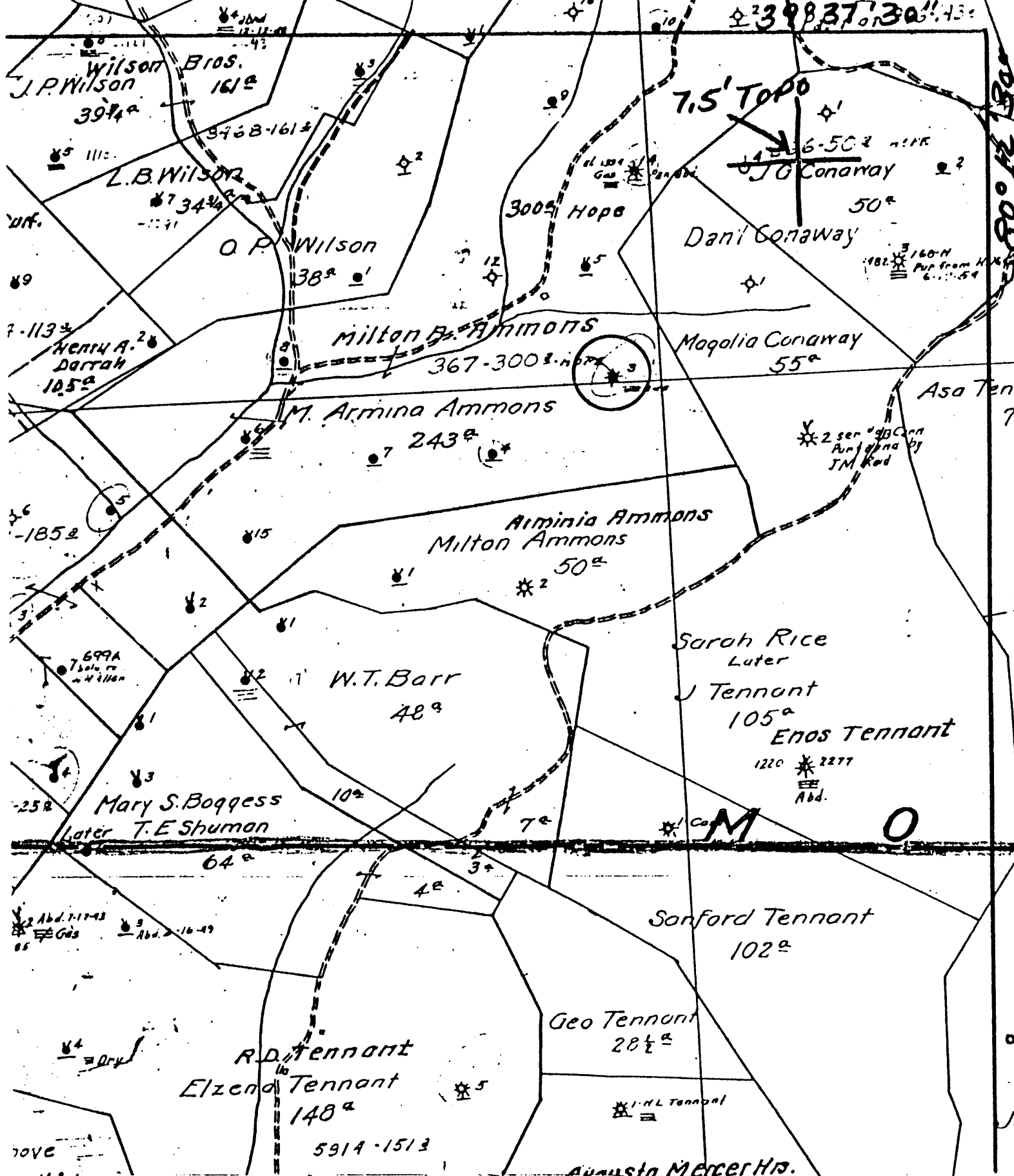

(+) DENOTES LOCATION OF WELL ON UNITED STATES TOPOGRAPHIC MAPS

FORM IV-6 (8-78)

162E N12E22 STATE OF WEST VIRGINIA DEPARTMENT OF MINES OIL AND GAS DIVISION



DATE Nov 30, 1978
 OPERATOR'S WELL NO. 3
 API WELL NO. 47-061-0451
 STATE COUNTY PERMIT

WELL TYPE: OIL GAS LIQUID INJECTION WASTE DISPOSAL
 (IF "GAS", PRODUCTION STORAGE DEEP SHALLOW
 LOCATION: ELEVATION 1158 WATER SHED Bennfield Fork
 DISTRICT Clay COUNTY Monongalia
 QUADRANGLE GRANT TOWN 7.5'

SURFACE OWNER _____ ACREAGE 300
 OIL & GAS ROYALTY OWNER _____ LEASE ACREAGE 300
 LEASE NO. 367-50

PROPOSED WORK: DRILL CONVERT DRILL DEEPER REDRILL FRACTURE OR STIMULATE PLUS OFF OLD FORMATION PERFORATE NEW FORMATION OTHER PHYSICAL CHANGE IN WELL (SPECIFY) _____

PLUS AND ABANDON CLEAN OUT AND REPLUG
 TARGET FORMATION _____ ESTIMATED DEPTH _____
 WELL OPERATOR Pennzoil Company DESIGNATED AGENT James A. Crews
 ADDRESS P. O. Box 1588 Parkersburg, WV 26101 ADDRESS P. O. Box 1588 Parkersburg, WV 26101

No. *110* County *Monongalia* State *W. Va.*
 District *11* Contractor *W. U. G.*
 Commenced *July 11* 1893 Drilling Completed *Sept 10* 1893
 N. S. E. W.

ROCK FORMATION	TOP	BOTTOM	STEEL LINE MEASUREMENT	REMARKS
<i>W. Coal</i>	<i>575</i>			<i>Fl. 1155.55</i>
<i>S. S. Gyp</i>	<i>1815</i>			<i>Gr. 1157.66</i>
<i>1st Gyp</i>	<i>1982</i>			
<i>2d Gyp</i>	<i>1991</i>			
<i>Total depth</i>		<i>2012</i>		

Lease No. *649* District *11* County *Monongalia* State *W. Va.*
 Contractor *S. R. P. Blasing*
 Drilling Commenced *July 22* 1925 Drilling Completed *Sept. 8* 1925
 N. S. E. W.

ROCK FORMATION	TOP	BOTTOM	STEEL LINE MEASUREMENT	REMARKS
<i>Pittsburgh Coal</i>	<i>575</i>	<i>2045</i>	<i>2012</i>	
<i>Big Spring Sand</i>	<i>1885</i>	<i>2045</i>		
<i>Started to D. D.</i>	<i>2050</i>	<i>2065</i>		
<i>Snow sand</i>	<i>2360</i>	<i>2380</i>		
<i>Shaly sand</i>	<i>2455</i>	<i>2488</i>		
<i>50 ft. Sand</i>	<i>2458</i>		<i>2468</i>	<i>12/10 W-1-0x</i>
<i>Gals</i>	<i>2609</i>	<i>2670</i>		
<i>30 ft. Sand</i>	<i>2792</i>	<i>2797</i>		
<i>London Sand</i>			<i>2809</i>	
<i>4 1/4" Liner</i>	<i>2825</i>	<i>2850</i>	<i>2825</i>	
<i>Fourth Sand</i>	<i>2981</i>	<i>2987</i>	<i>2981</i>	
<i>Fifth Sand</i>	<i>2982</i>	<i>2987</i>	<i>2982</i>	<i>26/10 W-2"</i>
<i>Gals</i>	<i>3023</i>	<i>3030</i>	<i>3023</i>	
<i>Bayard Sand</i>		<i>3077</i>	<i>3077</i>	
<i>Total Depth</i>				

Minute Pressure Test

Out	1	2	3	4	5	6	7	8	9	10	30	60	the	Rock
<i>1425</i>	<i>2"</i>	<i>30</i>	<i>50</i>	<i>80</i>	<i>95</i>	<i>100</i>	<i>115</i>	<i>125</i>	<i>140</i>	<i>160</i>	<i>246</i>	<i>270</i>	<i>24</i>	<i>320</i>

CASING RECORD AS TALLIED. NOT STEEL LINE MEASUREMENT

Size	Put in Well		Pulled Out		Left in Well		Shot Date Amount Sand Result
	Feet	In.	Feet	In.	Feet	In.	
<i>8 1/4</i>	<i>804</i>						<i>Packer Size 2" x 4" x 16"</i>
<i>6 3/8</i>	<i>1607</i>						
<i>5 7/16</i>	<i>275</i>	<i>4</i>					<i>Depth Set 2832</i>
<i>4 1/2 x 4</i>	<i>883</i>						
<i>2"</i>	<i>3096</i>						

No. *110* County *Monongalia* State *W. Va.*
 District *11* Contractor *W. U. G.*
 Commenced *July 11* 1893 Drilling Completed *Sept 10* 1893
 N. S. E. W.

ROCK FORMATION	TOP	BOTTOM	STEEL LINE MEASUREMENT	REMARKS
<i>W. Coal</i>	<i>575</i>			<i>Fl. 1155.55</i>
<i>S. S. Gyp</i>	<i>1815</i>			<i>Gr. 1157.66</i>
<i>1st Gyp</i>	<i>1982</i>			
<i>2d Gyp</i>	<i>1991</i>			
<i>Total depth</i>		<i>2012</i>		

CASING RECORD AS TALLIED. NOT STEEL LINE MEASUREMENT

Size	Put in Well		Pulled Out		Left in Well		Shot Date Amount Sand Result
	Feet	In.	Feet	In.	Feet	In.	
<i>10 1/4</i>	<i>416</i>						<i>Packer Size</i>
<i>8 3/4</i>	<i>804</i>						
<i>5 7/8</i>	<i>1607</i>		<i>416</i>				<i>Depth Set</i>
<i>3 1/4</i>	<i>275</i>						

Production First 24 Hours _____ Bbls. Gas Test *20/10 W-2 2185*
 Approved by *J. N. Weaver* Superintendent