

LATITUDE 38° 42' 30"

LONGITUDE 80° 15' 00"

5,600'

700'

TOPO. LOC. WADESTOWN QUAD. 7 1/2' SERIES

1065  
0.1140

NORTH

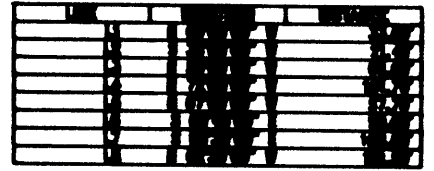
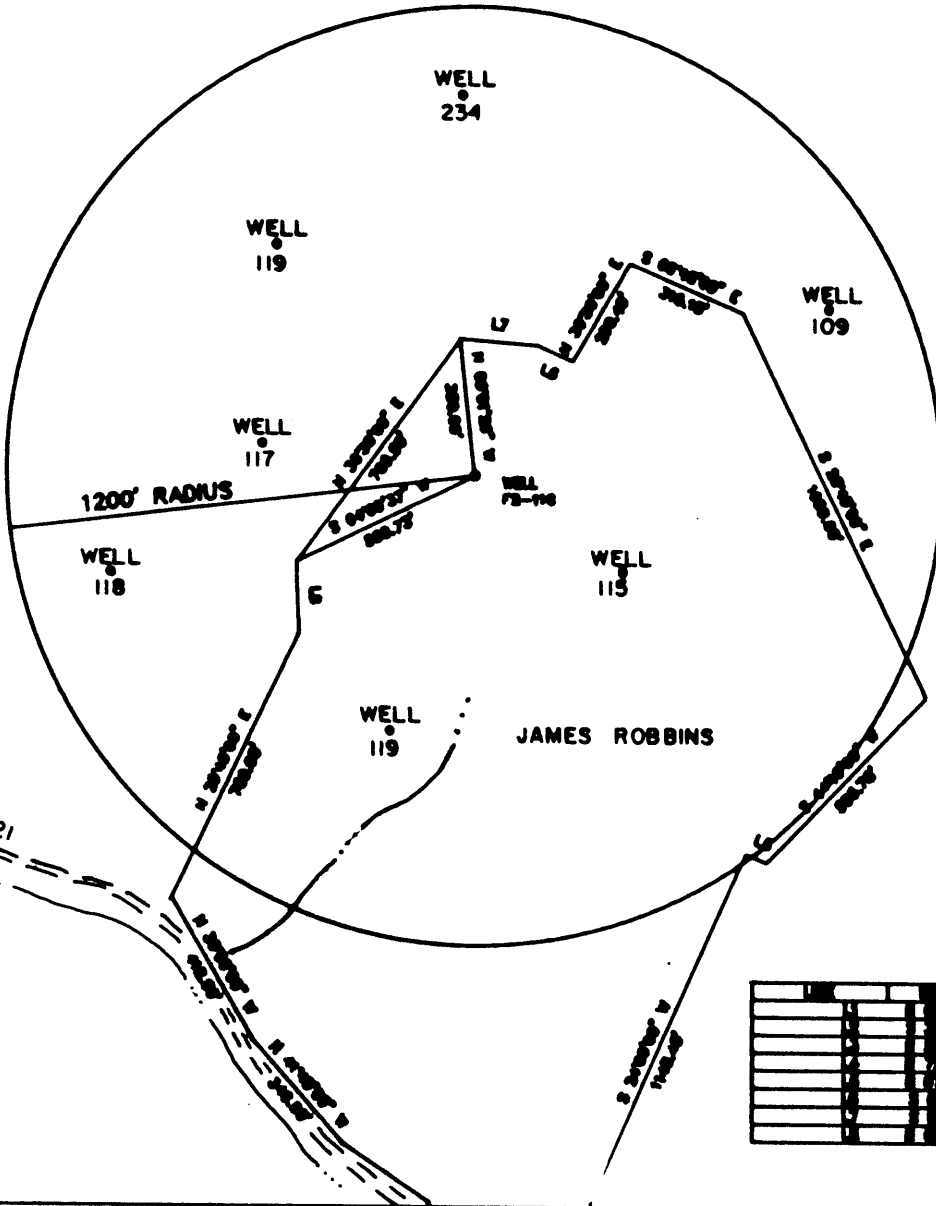

FILE NO. F2-1-191  
 DRAWING NO. F2-2-221  
 SCALE 1" = 500'  
 MINIMUM DEGREE OF ACCURACY 1/2500'  
 PROVEN SOURCE OF ELEVATION USGS B.M.

I THE UNDERSIGNED, HEREBY CERTIFY THAT THIS PLAT IS CORRECT TO THE BEST OF MY KNOWLEDGE AND BELIEF AND SHOWS ALL THE INFORMATION REQUIRED BY LAW AND THE REGULATIONS ISSUED AND PRESCRIBED BY THE DEPARTMENT OF MINES.  
 (SIGNED) John F. Ewell, Jr.  
 R.P.E. 11133 L.L.S.

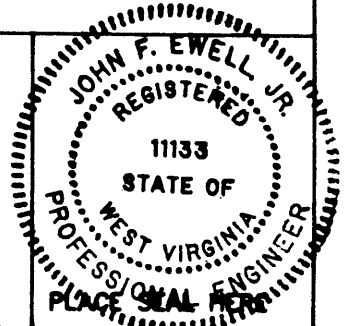

(+) DENOTES LOCATION OF WELL ON UNITED STATES TOPOGRAPHIC MAPS

DATE JUNE 8, 19 91  
 OPERATOR'S WELL NO. F2-116  
 API WELL NO. \_\_\_\_\_  
47 - 061 - 1028-P  
 STATE COUNTY PERMIT

FORM IV-6  
(6-78)

STATE OF WEST VIRGINIA  
 DEPARTMENT OF MINES  
 OIL AND GAS DIVISION

WELL TYPE: OIL  GAS \_\_\_\_\_ LIQUID INJECTION \_\_\_\_\_ WASTE DISPOSAL \_\_\_\_\_  
 (IF "GAS", PRODUCTION \_\_\_\_\_ STORAGE \_\_\_\_\_ DEEP \_\_\_\_\_ SHALLOW   
 LOCATION: ELEVATION 1300 WATERSHED MIRACLE RUN  
 DISTRICT BATTELLE COUNTY MONONGALIA  
 QUADRANGLE WADESTOWN  
 SURFACE OWNER JAMES ROBBINS ACREAGE 67  
 OIL & GAS ROYALTY OWNER FORMERLY HOPE NAT. GAS CO. LEASE ACREAGE \_\_\_\_\_  
 LEASE NO. \_\_\_\_\_  
 PROPOSED WORK: DRILL \_\_\_\_\_ CONVERT \_\_\_\_\_ DRILL DEEPER \_\_\_\_\_ REDRILL  FRACTURE OR  
 STIMULATE \_\_\_\_\_ PLUG OFF OLD FORMATION \_\_\_\_\_ PERFORATE NEW  
 FORMATION \_\_\_\_\_ OTHER PHYSICAL CHANGE IN WELL (SPECIFY) \_\_\_\_\_  
 PLUG AND ABANDON  CLEAN OUT AND REPLUG \_\_\_\_\_  
 TARGET FORMATION BIG INJUN ESTIMATED DEPTH 2398  
 WELL OPERATOR EASTERN ASSOC. COAL DESIGNATED AGENT TERRY O. HENDERSHOT  
 ADDRESS ROUTE 1 BOX 144 ADDRESS ROUTE 1 BOX 144  
FAIRVIEW WV. 26570 FAIRVIEW WV. 26570

JUN 17 1991

STATE OF WEST VIRGINIA  
DEPARTMENT OF ENERGY  
DIVISION OF OIL AND GAS

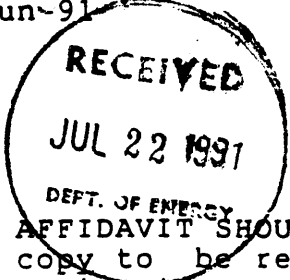

AFFIDAVIT OF PLUGGING AND FILLING WELL

AFFIDAVIT SHOULD BE IN TRIPLICATE, one copy mailed to the Division, one copy to be retained by the Well Operator and the third copy (and extra copies if required) should be mailed to each coal operator at their respective addresses.

F2-116

Farm name: ROBBINS, JAMES Operator Well No.: H.C.WILSON 4652

LOCATION: Elevation: 1300.00 Quadrangle: WADESTOWN  
District: BATTELLE County: MONONGALIA  
Latitude: 5600 Feet South of 39 Deg. 42 Min. 30 Sec.  
Longitude 700 Feet West of 80 Deg. 15 Min. 0 Sec.

Well Type: OIL X GAS \_\_\_\_\_

Company: Eastern Assoc. Coal Corp. Coal Operator Eastern Assoc. Coal Corp.  
Route 1 - Box 144 or Owner Route 1 - Box 144  
Fairview, WV 26570 Fairview, WV 26570

Agent: Terry O. Hendershot Coal Operator \_\_\_\_\_  
Inspector: Donald Ellis or Owner \_\_\_\_\_  
Permit Issued: 06/12/91

AFFIDAVIT

STATE OF WEST VIRGINIA,  
County of Monongalia ss:

Fred Chisler and Jim Gump being first duly sworn according to law depose and say that they are experienced in the work of plugging and filling oil and gas wells and were employed by Chisler Brother's, well operator, and participated in the work of plugging and filling the above well, that said work was commenced on the 20th day of June, 1991, and that the well was plugged and filled in the following manner:

TYPE	FROM	TO	PIPE REMOVED	LEFT
Cleaned out to depth of	1325'			
Run Loggs Gamma Ray, Neutron and 3 Arm Caliper				
Run 4 1/2" pipe to 1317'	jelled hole 11 Sk.	jell		
Run 330 Sk. Portland,	150 Sk. Chem.	Comp. cement		
Pulled 4 1/2" pipe to 1080'				
Run 750 Sk. Portland &	150 Sk. Chem	Comp. got circulation		
Pumped latch down plug	to 1060'			
Bailed water out inside	4 1/2" pipe and	checked plug - OK		
Pittsburgh Coal. 949 to	955			

Description of monument: 4 1/2" x 2" swedge, 2" pipe with metal plate, date plugged and A.P.I. No.

and that the work of plugging and filling said well was completed on the 15th day of July, 1991.

And further deponents saith not.

Fred Chisler  
Jim Gump

Sworn and subscribe before me this 17th day of July, 1991  
My commission expires June 17 1991

William J. Tuttle  
Notary Public

JUL 29 1991