

TOP HOLE (UTM NAD 83)
N) 4395389.6
E) 568191.8
BOTTOM HOLE (UTM NAD 83)
N) 4393501.9
E) 569586.7

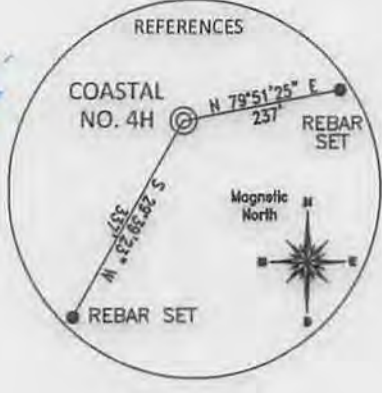

- WELL REFERENCE
(API#, DISTANCE TO LATERAL)
- 061-30208 N 58°11'09" W 1,212'
 - 061-01845 N 09°57'30" W 1,364'
 - 061-70248
 - PLUGGED (FOUND IN FIELD)
 - 061-01347
 - 061-71040
 - 061-70251
 - 061-30014
 - 061-71042
 - 061-30130
 - 061-71043
 - 061-01394
 - 061-01568
 - 061-30200
 - 061-70249
 - 061-71024
 - 061-71025

A	WILLROY SIMPSON C/O RONNIE SIMPSON	4-7-37	5.32 ACRES	061-003338-001
B	RONALD M. SIMPSON	4-7-38	5.42 ACRES	061-003110-001
C	EDWARD SIMPSON C/O RONNIE SIMPSON	4-7-40	15.28 ACRES	061-003063-001

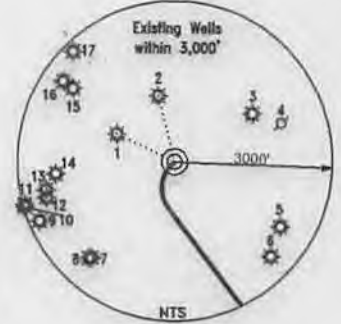
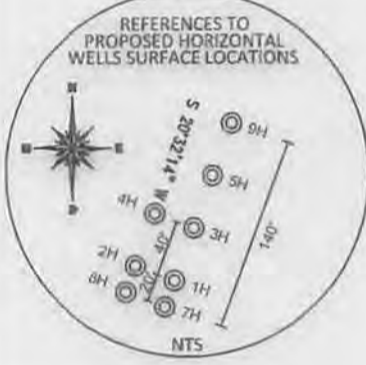

REFERENCE NOTES
Boundaries as shown taken from deeds, tax maps and field locations. A full boundary survey is not expressed nor implied. All bearings are based on true north. Dimensions taken from public records MONONGALIA County, West Virginia JUNE 2013
State Plane Coordinates & NAD 83 Lat/Long by differential submeter mapping grade GPS. Drafted by EAM.

WILLIAM J. & LINDA S. SOLOMAN
74.54 TOTAL ACRES
LEASE NUMBER 061-001143-001
TAX MAP AND PARCEL 4-7-21

ORLY W. MOORE & SANDRA MERRIFIELD
16.45 TOTAL ACRES
LEASE NUMBER 061-002586-001
TAX MAP AND PARCEL 4-7-42

LESLEY SPRAHNEY
63.8 TOTAL ACRES
LEASE NUMBER 061-001174-001
TAX MAP AND PARCEL 4-7-41

ARLE W. MOORE, JR. & IONA WOLFORD
20.09 TOTAL ACRES
LEASE NUMBER 061-003545-001
TAX MAP AND PARCEL 4-7-43

JONI MURPHY
16.8 TOTAL ACRES
LEASE NUMBER 061-001435-001
TAX MAP AND PARCEL 4-10-60

NOTE: NO WATER WELLS WERE FOUND WITHIN 250' OF THE CENTER OF WELL PAD. NO DWELLINGS WERE FOUND WITHIN 425' OF THE CENTER OF WELL PAD.



FILE #: NNE12
DRAWING #: 2349
SCALE: PLAT: 1" = 1200'
TICK MARK: 1" = 2000'
MINIMUM DEGREE OF ACCURACY: 1/200
PROVEN SOURCE OF ELEVATION: SUBMETER MAPPING GRADE GPS

I, THE UNDERSIGNED, HEREBY CERTIFY THAT THIS PLAT IS CORRECT TO THE BEST OF MY KNOWLEDGE AND BELIEF AND SHOWS ALL THE INFORMATION REQUIRED BY LAW AND THE REGULATIONS ISSUED AND PRESCRIBED BY THE DEPARTMENT OF ENVIRONMENTAL PROTECTION.
Signed: [Signature]
L.L.S. #2124: Ernest J. Benchek III

(+) DENOTES LOCATION OF WELL ON UNITED STATES TOPOGRAPHIC MAPS
WVDEP
OFFICE OF OIL & GAS
601 57TH STREET
CHARLESTON, WV 25304
Well Type: Oil Waste Diposal Production Deep
 Gas Liquid Injection Storage Shallow
WATERSHED: DUNKARD CREEK
COUNTY/DISTRICT: MONONGALIA / CLAY
SURFACE OWNER: COASTAL FOREST RESOURCES COMPANY
OIL & GAS ROYALTY OWNER: WACO OIL AND GAS, ET AL
LEASE NUMBERS: _____

DATE: JULY 31, 2014
OPERATOR'S WELL #: COASTAL NO. 4H
API WELL #: 47 61 0168546A
STATE COUNTY PERMIT
ELEVATION: 1,420'
QUADRANGLE: BLACKSVILLE, WV
ACREAGE: 63.8 +/-
ACREAGE: 329.89 +/-

DRILL CONVERT DRILL DEEPER REDRILL FRACTURE OR STIMULATE
PLUG OFF FORMATION PERFORATE NEW FORMATION PLUG & ABANDON
CLEAN OUT & REPLUG OTHER CHANGE (SPECIFY): _____
TARGET FORMATION: MARCELLUS
ESTIMATED DEPTH: TVD: 8,129' TMD: 16,071'
WELL OPERATOR: NORTHEAST NATURAL ENERGY LLC
DESIGNATED AGENT: JOHN ADAMS
ADDRESS: 707 VIRGINIA STREET EAST, SUITE 1200
ADDRESS: 707 VIRGINIA STREET EAST, SUITE 1200
CITY: CHARLESTON STATE: WV ZIP CODE: 25301
CITY: CHARLESTON STATE: WV ZIP CODE: 25301

10/31/2014

