

①	N 23°18'32" W 1,061'
②	N 23°45'53" W 1,159'
③	N 33°46'08" E 1,052'

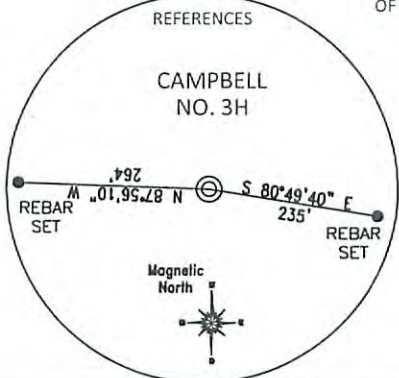

RECEIVED  
Office of Oil and Gas  
DEC 6 2015

WV Department of Environmental Protection  
Office of Oil and Gas

RECEIVED  
Office of Oil and Gas  
DEC 16 2015

WV Department of Environmental Protection

WV Department of Environmental Protection

FILE #: NNE12

DRAWING #: 2323

SCALE: PLAT: 1" = 1200'  
TICK: 1" = 2000'

MINIMUM DEGREE OF ACCURACY: 1/200

PROVEN SOURCE OF ELEVATION: SUBMETER MAPPING GRADE GPS

I, THE UNDERSIGNED, HEREBY CERTIFY THAT THIS PLAT IS CORRECT TO THE BEST OF MY KNOWLEDGE AND BELIEF AND SHOWS ALL THE INFORMATION REQUIRED BY LAW AND THE REGULATIONS ISSUED AND PRESCRIBED BY THE DEPARTMENT OF ENVIRONMENTAL PROTECTION.

Signed: [Signature]

L.L.S. #2124: Ernest J. Benchek III

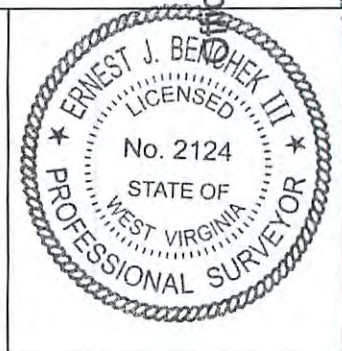

(+) DENOTES LOCATION OF WELL ON UNITED STATES TOPOGRAPHIC MAPS WYDEP

OFFICE OF OIL & GAS  
601 57TH STREET  
CHARLESTON, WV 25304

Well Type:  Oil  Waste Diposal  Production  Deep  
 Gas  Liquid Injection  Storage  Shallow

WATERSHED: DUNKARD CREEK ELEVATION: 1,293.6'

COUNTY/DISTRICT: MONONGALIA / CLAY QUADRANGLE: BLACKSVILLE

SURFACE OWNER: ELLEN F. CAMPBELL ACREAGE: 7.05 +/-

OIL & GAS ROYALTY OWNER: ELLEN FOLEY CAMPBELL, ET AL ACREAGE: 558.85 +/-

LEASE NUMBERS: \_\_\_\_\_

DRILL  CONVERT  DRILL DEEPER  REDRILL  FRACTURE OR STIMULATE   
PLUG OFF FORMATION  PERFORATE NEW FORMATION  PLUG & ABANDON   
CLEAN OUT & REPLUG  OTHER CHANGE  (SPECIFY): \_\_\_\_\_

TARGET FORMATION: MARCELLUS ESTIMATED DEPTH: TVD: 8,118' TMD: 16,408.08'

WELL OPERATOR: NORTHEAST NATURAL ENERGY LLC DESIGNATED AGENT: JOHN ADAMS

ADDRESS: 707 VIRGINIA STREET EAST, SUITE 1200 ADDRESS: 707 VIRGINIA STREET EAST, SUITE 1200

CITY: CHARLESTON STATE: WV ZIP CODE: 25301 CITY: CHARLESTON STATE: WV ZIP CODE: 25301

WELL: CAMPBELL NO. 3H  
QUAD: BLACKSVILLE

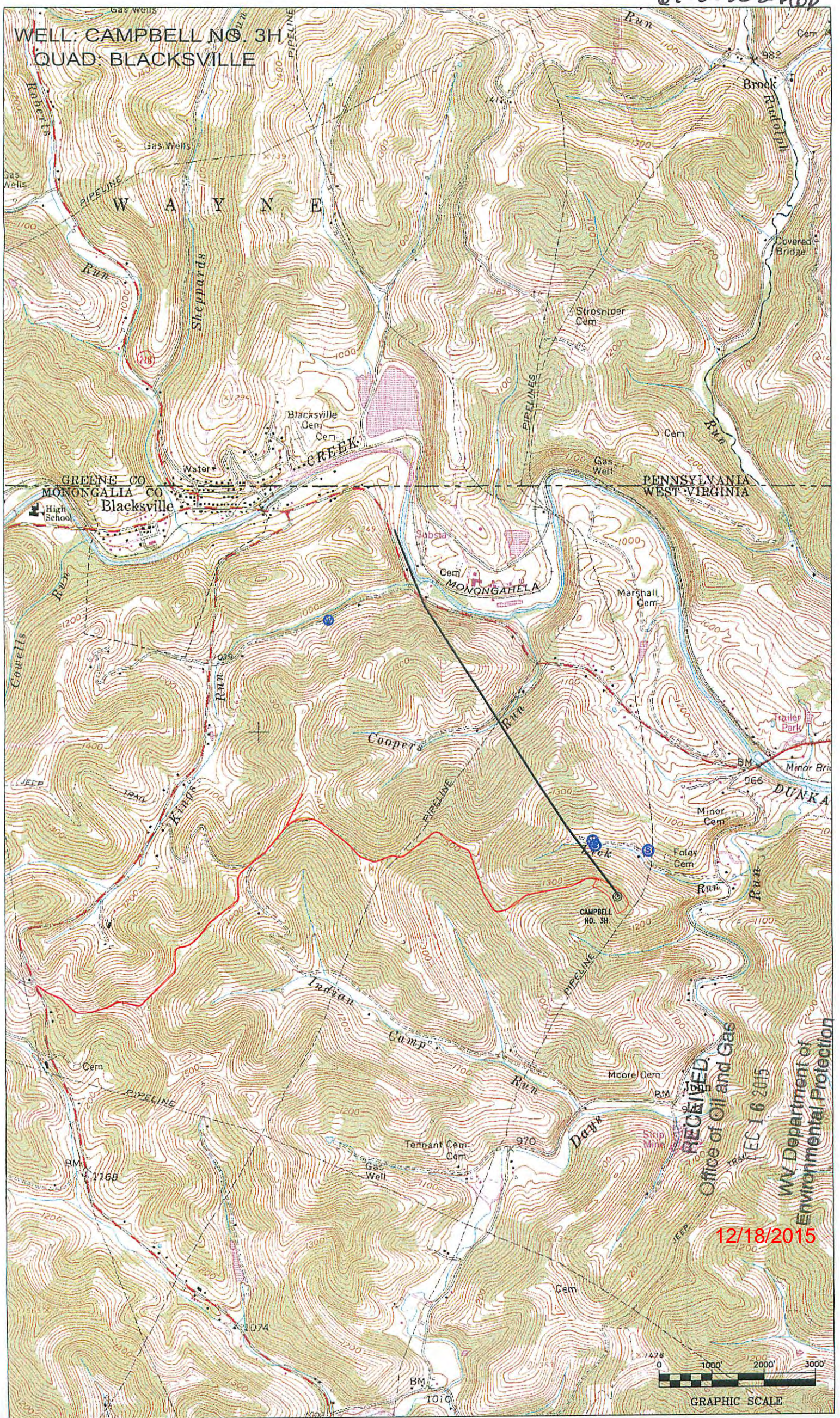

RECEIVED  
Office of Oil and Gas  
DEC 16 2015  
WV Department of  
Environmental Protection

12/18/2015



GRAPHIC SCALE