

SURFACE HOLE DEC. LONG. 80.213895
 SURVEYED LONG. 80° 12' 50.0"

Latitude: 39° 42' 30" (NAD27)

Longitude: 80° 12' 30" (NAD27)

AS-DRILLED



TOP HOLE (UTM NAD 83)
 N) 4394325.7
 E) 567416.2
 BOTTOM HOLE (UTM NAD 83)
 N) 4392636.5
 E) 568522.7

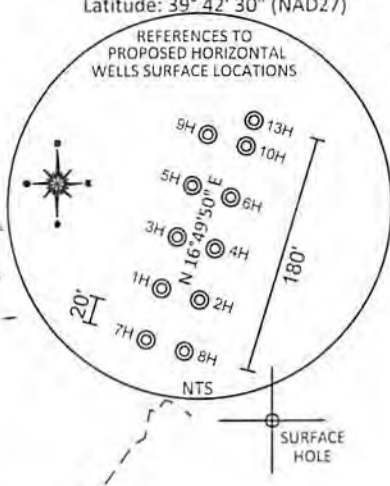

SURFACE HOLE DEC. LAT. 39.698039
 SURVEYED LAT. 39° 41' 45.7"

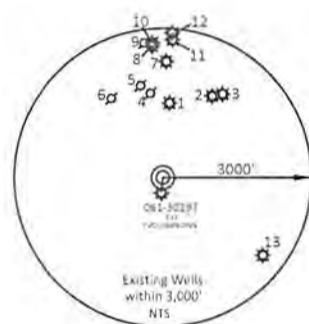

- Existing Wells within 3,000' NTS
- WELL REFERENCE (API#, DISTANCE TO WELL)
- 0.61-30132
 - 0.61-70251
 - 0.61-30014
 - 0.61-71046
 - 0.61-30120
 - PLUGGED FOUND IN FIELD
 - 0.61-71042
 - 0.61-30130
 - PLUGGED FOUND IN FIELD
 - 0.61-71043
 - 0.61-01594
 - 0.61-01568
 - 0.61-71096

REFERENCE NOTES
 Boundaries as shown taken from deeds, tax maps and field locations. A full boundary survey is not expressed nor implied. All bearings are based on true north. Ownership taken from public records MONONGALIA County, West Virginia MAY 2016
 State Plane Coordinates & NAD 83 Lat/Long by differential submeter mapping grade GPS
 Drafted by: E.A.M.

NOTE:
 NO WATER WELLS WERE FOUND WITHIN 250' OF THE CENTER OF WELL PAD.
 NO DWELLINGS WERE FOUND WITHIN 625' OF THE CENTER OF WELL PAD.

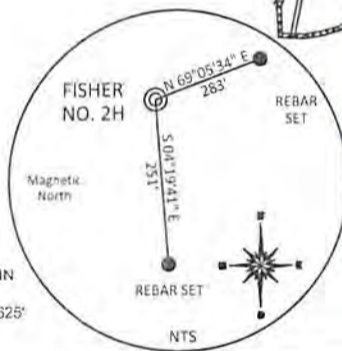

FILE #: NNE14
 DRAWING #: 2384
 SCALE: PLAT: 1" = 1400'
TICK: 1" = 2000'
 MINIMUM DEGREE OF ACCURACY: 1/200
 PROVEN SOURCE OF ELEVATION: SUBMETER MAPPING GRADE GPS

I, THE UNDERSIGNED, HEREBY CERTIFY THAT THIS PLAT IS CORRECT TO THE BEST OF MY KNOWLEDGE AND BELIEF AND SHOWS ALL THE INFORMATION REQUIRED BY LAW AND THE REGULATIONS ISSUED AND PRESCRIBED BY THE DEPARTMENT OF ENVIRONMENTAL PROTECTION.

Signed: [Signature]
 L.L.S. #2124 : Ernest J. Benchek III

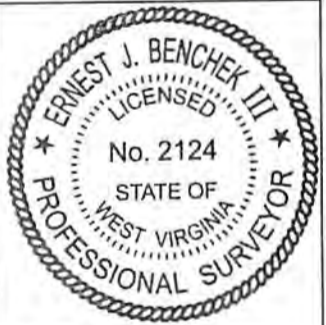

(+) DENOTES LOCATION OF WELL ON UNITED STATES TOPOGRAPHIC MAPS WVDEP
 OFFICE OF OIL & GAS
 601 57TH STREET
 CHARLESTON, WV 25304

Well Type: Oil Waste Disposal Production Deep
 Gas Liquid Injection Storage Shallow

WATERSHED: DUNKARD CREEK
 COUNTY/DISTRICT: MONONGALIA / CLAY
 SURFACE OWNER: AARON K. FISHER
 OIL & GAS ROYALTY OWNER: HENRY P. AMES, III, ET AL
 LEASE NUMBERS: _____

DATE: APRIL 13, 2018
 OPERATOR'S WELL #: FISHER NO. 2H
 API WELL #: 47 61
 STATE COUNTY PERMIT

AS-BUILT ELEVATION: 1,453'
 QUADRANGLE: BLACKSVILLE
 ACREAGE: 52.203 +/-
 ACREAGE: 562.9188 **07/20/2018**

DRILL CONVERT DRILL DEEPER REDRILL FRACTURE OR STIMULATE
 PLUG OFF FORMATION PERFORATE NEW FORMATION PLUG & ABANDON
 CLEAN OUT & REPLUG OTHER CHANGE (SPECIFY): _____

TARGET FORMATION: MARCELLUS
 ESTIMATED DEPTH: TVD: 8,293.36' TMD: 14,591'
 WELL OPERATOR: NORTHEAST NATURAL ENERGY LLC
 ADDRESS: 707 VIRGINIA STREET EAST, SUITE 1200
 CITY: CHARLESTON STATE: WV ZIP CODE: 25301
 DESIGNATED AGENT: JOHN ADAMS
 ADDRESS: 707 VIRGINIA STREET EAST, SUITE 1200
 CITY: CHARLESTON STATE: WV ZIP CODE: 25301