

NOTES ON SURVEY

- COORDINATES SYSTEM IS UTM, NAD 83 DATUM, ZONE 17, U.S. FOOT AND WELL COORDINATES ESTABLISHED USING SURVEY GRADE GPS.
- SURFACE AND ROYALTY OWNER INFORMATION AND THEIR BOUNDARIES SHOWN HEREON WERE OBTAINED FROM INFORMATION PROVIDED BY CNX GAS COMPANY LLC AND TAX RECORDS.
- THIS PLAT DOES NOT REPRESENT A BOUNDARY SURVEY OF THE PARCELS SHOWN HEREON.
- NO DWELLINGS AND BUILDINGS WITHIN 625 FEET OF PROPOSED OF CENTER OF PAD.
- NO WATER WELLS OR DEVELOPED SPRINGS WITHIN 250 FEET OF PROPOSED WELL.
- NO PERENNIAL STREAMS, LAKES, PONDS, RESERVOIRS OR WETLANDS WITHIN 100 FEET OF THE LIMITS OF DISTURBANCE.
- NO NATURALLY PRODUCING TROUT STREAM WITHIN 300 FEET OF LIMITS OF DISTURBANCE.

- LEGEND**
- ⊕ Active Well
 - ⊕ Plugged Well Location
 - ⊕ Abandoned Well
 - ⊕ Future Use
 - ① Surface Tract Identification
 - Proposed Gas Well
 - ⊗ Located Corner, as noted
 - Permitted Lateral
 - As-Drilled Lateral
 - Surface Tract Lines
 - Reference Line
 - Match Line
 - Lease Boundary
 - Creek or Drain
 - State Line
 - ⑤ WV County Route
 - ⑤ WV State Route

See Page 3 For Surface Owners and Lessors

(⊕) Denotes Location of Well on United States Topographic Maps



I, the undersigned, hereby certify that this plat is correct to the best of my knowledge and belief and shows all the information required by law and the regulations issued and prescribed by the Department of Environmental Protection.

Thomas C. Smith
L. L. S. 687

FILE NO: _____
 DRAWING NO: _____
 SCALE: 1" = 2000'
 MINIMUM DEGREE OF ACCURACY: 1:2500
 PROVEN SOURCE OF ELEVATION: NGS CORS Station



DATE: JUNE 08 20 23
 OPERATORS WELL NO: _____
 API WELL NO: 47 - 061 - 01903
 STATE COUNTY PERMIT

WELL TYPE: OIL GAS LIQUID INJECTION WASTE DISPOSAL
 (IF GAS) PRODUCTION: STORAGE DEEP SHALLOW

LOCATION ELEVATION: 1264.30' WATERSHED: Dunkard Creek QUADRANGLE: Wadestown
 DISTRICT: Batelle COUNTY: Monongalia

SURFACE OWNER: CNX Gas Company LLC ACREAGE: 96.91 ±
 ROYALTY OWNER: Three Rivers Royalty II, LLC, et al LEASE NO: 205228000 ACREAGE: 96.91 ±

PROPOSED WORK: DRILL CONVERT DRILL DEEPER FRACTURE OR STIMULATE PLUG OFF OLD FORMATION
 PERFORATE NEW FORMATION OTHER PHYSICAL CHANGE IN WELL (SPECIFY)
 PLUG AND ABANDON CLEAN OUT AND REPLUG TARGET FORMATION: Marcellus ESTIMATED DEPTH: TVD: 7,913'

WELL OPERATOR: CNX Gas Company LLC DESIGNATED AGENT: Anthony Kendziora
 ADDRESS: 1000 Horizon Vue Drive ADDRESS: 1000 Horizon Vue Drive
 Canonsburg, PA 15317 Canonsburg, PA 15317

AS-DRILLED

LATITUDE 39° 40' 00" BH: 4135'

LONGITUDE 80° 17' 30" BH: 2905'

WDTN19EHSM
CNX Gas Company LLC



NOTES ON SURVEY

1. COORDINATES SYSTEM IS UTM, NAD 83 DATUM, ZONE 17, U.S. FOOT AND WELL COORDINATES ESTABLISHED USING SURVEY GRADE GPS.
2. SURFACE AND ROYALTY OWNER INFORMATION AND THEIR BOUNDARIES SHOWN HEREON WERE OBTAINED FROM INFORMATION PROVIDED BY CNX GAS COMPANY LLC AND TAX RECORDS.
3. THIS PLAT DOES NOT REPRESENT A BOUNDARY SURVEY OF THE PARCELS SHOWN HEREON.
4. NO DWELLINGS AND BUILDINGS WITHIN 625 FEET OF PROPOSED OF CENTER OF PAD.
5. NO WATER WELLS OR DEVELOPED SPRINGS WITHIN 250 FEET OF PROPOSED WELL.
6. NO PERENNIAL STREAMS, LAKES, PONDS, RESERVOIRS OR WETLANDS WITHIN 100 FEET OF THE LIMITS OF DISTURBANCE.
7. NO NATURALLY PRODUCING TROUT STREAM WITHIN 300 FEET OF LIMITS OF DISTURBANCE.

LEGEND

- Active Well
- Plugged Well Location
- Abandoned Well
- Future Use
- Surface Tract Identification
- Proposed Gas Well
- Located Corner, as noted
- Permitted Lateral
- As-drilled Lateral
- Surface Tract Lines
- Reference Line
- Match Line
- Lease Boundary
- Creek or Drain
- State Line
- WV County Route
- WV State Route

See Page 3 For Surface Owners and Lessors

() Denotes Location of Well on United States Topographic Maps

I, the undersigned, hereby certify that this plat is correct to the best of my knowledge and belief and shows all the information required by law and the regulations issued and prescribed by the Department of Environmental Protection.

Thomas C. Smit

L. L. S. 687



SEAL



FILE NO: _____
 DRAWING NO: _____
 SCALE: 1" = 2000'
 MINIMUM DEGREE OF ACCURACY: 1:2500
 PROVEN SOURCE OF ELEVATION: NGS CORS Station



DATE: JUNE 08 20 23
 OPERATORS WELL NO: _____
 API WELL NO: 47 - 061 - 01903
 STATE COUNTY PERMIT

WELL TYPE: OIL GAS LIQUID INJECTION WASTE DISPOSAL
 (IF GAS) PRODUCTION: STORAGE DEEP SHALLOW
 LOCATION ELEVATION: 1264.30' WATERSHED: Dunkard Creek QUADRANGLE: Wadestown
 DISTRICT: Batelle COUNTY: Monongalia
 SURFACE OWNER: CNX Gas Company LLC ACREAGE: 96.91 ±
 ROYALTY OWNER: Three Rivers Royalty II, LLC, et al LEASE NO: 205228000 ACREAGE: 96.91 ±
 PROPOSED WORK: DRILL CONVERT DRILL DEEPER FRACTURE OR STIMULATE PLUG OFF OLD FORMATION
 PERFORATE NEW FORMATION OTHER PHYSICAL CHANGE IN WELL (SPECIFY)
 PLUG AND ABANDON CLEAN OUT AND REPLUG TARGET FORMATION: Marcellus ESTIMATED DEPTH: TVD: 7,913'

09/15/2023

WELL OPERATOR: CNX Gas Company LLC DESIGNATED AGENT: Anthony Kendziora
 ADDRESS: 1000 Horizon Vue Drive ADDRESS: 1000 Horizon Vue Drive
 Canonsburg, PA 15317 Canonsburg, PA 15317

AS-DRILLED

TRACT ID	SURFACE OWNER	LESSOR	PIN
1	CNX Gas Company LLC	Hugh Kirkland Jack T. Livengood and Mary Jo Livengood Barbara Haning Diane H. Gonclaves, individually and co-executor of the Edward Lee North Estate Patrick Lee North Melissa Kubishke Catherine C. Kirkland Louise H. Berg, as Trustee of the The Louise H. Berg Revocable Trust Sherry Lemons Christine A. Kirkland, as Trustee of the Christine A. Kirkland Trust Pamela Jayne Brewer, as Trustee of the Pamela Jayne Brewer Revocable Trust Stephen D. Kirkland and Julie D. Kirkland, Trustees of the Kirkland Family Revocable Trust dated 9/2/1998 Catherine Haning Coleman, f/k/a Catherine G. Haning Zachary C. Haning Mary Hennen A. E. Hennen, III Morgan Haning Sarah C. Sheridan Kathleen Farmer Anne W. Haning David Michael Hennen John K. Hennen Robert Douglas Hennen Elizabeth L. March Three Rivers Royalty, II, LLC Deborah Rae Manning, a/k/a Deborah R. Manning, a/k/a Deborah R. Manning and Robert Manning, w/h Kathryn Rew Becker and Michael Compton, w/h BOKF, N.A. as Sole Trustee of the Alma Kirkland Revocable Trust Gail T. Bellucci Northeast Natural Energy LLC	1-8-9
2	CNX Gas Company LLC	Three Rivers Royalty, II, LLC Jack T. Livengood and Mary Jo Livengood Elizabeth L. March Deborah Rae Manning, a/k/a Deborah R. Manning, a/k/a Deborah R. Manning and Robert Manning Kathryn Rew Becker and Michael Compton	1-8-9
4	David Troy Beckner, et al	Mary Jane Beckner, Life Estate, widow and Troy David Beckner and Janet Lee Smith, Remaindermen, JTROS Antero Resources Corporation	1-8-10

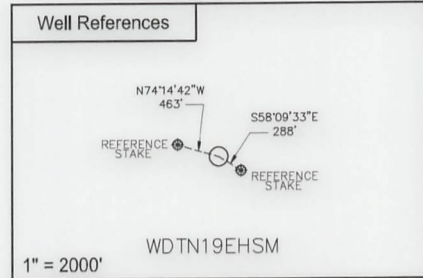
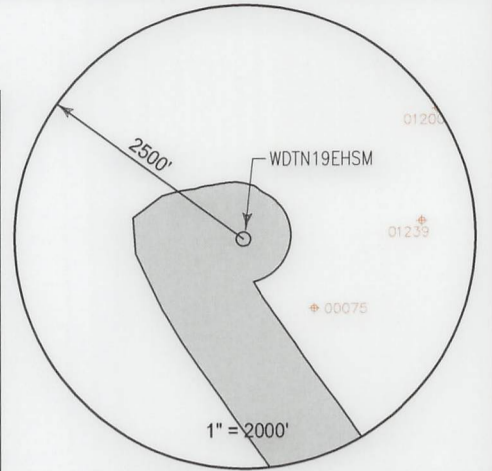

SURFACE HOLE LOCATION (SHL)	
UTM 17 NAD 83	
N: 4393944.871	
E: 556994.094	
NAD 83, WV NORTH	
N: 435781.455	
E: 1733461.600	
LAT/LON DATUM NAD 83	
LAT: 39°41'36.408"	
LON: 80°20'06.981"	
LANDING POINT	
UTM 17 NAD 83	
N: 4393670.714	
E: 556921.827	
NAD 83, WV NORTH	
N: 434885.809	
E: 1733209.433	
LAT/LON DATUM NAD 83	
LAT: 39°41'27.534"	
LON: 80°20'10.100"	

WDTN19 WELL PAD		BOTTOM HOLE LOCATION (BHL)	
○ WDN19EHSM		UTM 17 NAD 83	
○ WDN19DHSM	○ WDN19BHSM	N: 4390106.414	
○ WDN19CHSM	○ WDN19FHSM	E: 559503.274	
○ WDN19AHSM	○ WDN19RHSM	NAD 83, WV NORTH	
		N: 423048.550	
		E: 1741484.691	
		LAT/LON DATUM NAD 83	
		LAT: 39°39'31.293"	
		LON: 80°18'22.881"	



I, the undersigned, hereby certify that this plat is correct to the best of my knowledge and belief and shows all the information required by law and the regulations issued and prescribed by the Department of Environmental Protection.

L. L. S.
L. L. S. 687

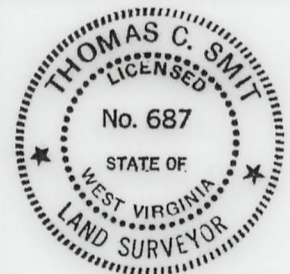

SEAL

FILE NO: _____
DRAWING NO: _____
SCALE: 1" = 1000'
MINIMUM DEGREE OF ACCURACY: 1:2500
PROVEN SOURCE OF ELEVATION: NGS CORS Station



DATE: JUNE 08 20 23
OPERATORS WELL NO: _____
API WELL NO: 47 - 061 - 01903
STATE COUNTY PERMIT

WELL TYPE: OIL GAS LIQUID INJECTION WASTE DISPOSAL
(IF GAS) PRODUCTION: STORAGE DEEP SHALLOW

LOCATION ELEVATION: 1264.30' WATERSHED: Dunkard Creek QUADRANGLE: Wadestown
DISTRICT: Batelle COUNTY: Monongalia

SURFACE OWNER: CNX Gas Company LLC ACREAGE: 99.15/2023
ROYALTY OWNER: Three Rivers Royalty II, LLC, et al LEASE NO: 205228000 ACREAGE: 96.91 ±

PROPOSED WORK: DRILL CONVERT DRILL DEEPER FRACTURE OR STIMULATE PLUG OFF OLD FORMATION
 PERFORATE NEW FORMATION OTHER PHYSICAL CHANGE IN WELL (SPECIFY)
 PLUG AND ABANDON CLEAN OUT AND REPLUG TARGET FORMATION: Marcellus ESTIMATED DEPTH: TVD: 7,913'

WELL OPERATOR: CNX Gas Company LLC DESIGNATED AGENT: Anthony Kendziora
ADDRESS: 1000 Horizon Vue Drive ADDRESS: 1000 Horizon Vue Drive
Canonsburg, PA 15317 Canonsburg, PA 15317

AS-DRILLED