

NOTES ON SURVEY

- COORDINATES SYSTEM IS UTM, NAD 83 DATUM, ZONE 17, U.S. FOOT AND WELL COORDINATES ESTABLISHED USING SURVEY GRADE GPS.
- SURFACE AND ROYALTY OWNER INFORMATION AND THEIR BOUNDARIES SHOWN HEREON WERE OBTAINED FROM INFORMATION PROVIDED BY CNX GAS COMPANY LLC AND TAX RECORDS.
- THIS PLAT DOES NOT REPRESENT A BOUNDARY SURVEY OF THE PARCELS SHOWN HEREON.
- NO DWELLINGS AND BUILDINGS WITHIN 625 FEET OF PROPOSED CENTER OF PAD.
- NO WATER WELLS OR DEVELOPED SPRINGS WITHIN 250 FEET OF PROPOSED WELL.
- NO PERENNIAL STREAMS, LAKES, PONDS, RESERVOIRS OR WETLANDS WITHIN 100 FEET OF THE LIMITS OF DISTURBANCE.
- NO NATURALLY PRODUCING TROUT STREAM WITHIN 300 FEET OF LIMITS OF DISTURBANCE.

- LEGEND**
- Active Well
 - Plugged Well Location
 - Abandoned Well
 - Future Use
 - Surface Tract Identification
 - Proposed Gas Well
 - Located Corner, as noted
 - Surface Tract Lines
 - Reference Line
 - Match Line
 - Lease Boundary
 - Creek or Drain
 - State Line
 - WV County Route
 - WV State Route

See Page 3 For Surface Owners and Lessors

(⊕) Denotes Location of Well on United States Topographic Maps



I, the undersigned, hereby certify that this plat is correct to the best of my knowledge and belief and shows all the information required by law and the regulations issued and prescribed by the Department of Environmental Protection.

L. L. S. 687

L. L. S. 687



FILE NO:
DRAWING NO:
SCALE: 1" = 2000'
MINIMUM DEGREE OF ACCURACY: 1:2500
PROVEN SOURCE OF ELEVATION: NGS CORS Station

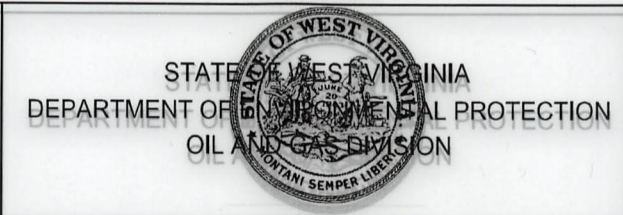

DATE: OCTOBER 24 20 24
OPERATORS WELL NO:
API WELL NO
47 - 061 - 01916
STATE COUNTY PERMIT

WELL TYPE: OIL GAS LIQUID INJECTION WASTE DISPOSAL
(IF GAS) PRODUCTION: STORAGE DEEP SHALLOW

LOCATION ELEVATION: 1199' WATERSHED: Dunkard Creek QUADRANGLE: Wadestown
DISTRICT: Batelle COUNTY: Monongalia

SURFACE OWNER: Consol Mining Company LLC ACREAGE: 46.75 ±
ROYALTY OWNER: Bounty Minerals, LLC LEASE NO: 189033000 ACREAGE: 39.02 ±

PROPOSED WORK: DRILL CONVERT DRILL DEEPER FRACTURE OR STIMULATE PLUG OFF OLD FORMATION
 PERFORATE NEW FORMATION OTHER PHYSICAL CHANGE IN WELL (SPECIFY)
 PLUG AND ABANDON CLEAN OUT AND REPLUG TARGET FORMATION: Marcellus ESTIMATED DEPTH: TVD: 7,848'

WELL OPERATOR: CNX Gas Company LLC DESIGNATED AGENT: Anthony Kendziora
ADDRESS: 1000 Horizon Vue Drive ADDRESS: 111 Avondale Road
Canonsburg, PA 15317 Fairmont, WV 26554

AS-DRILLED

WDTN18UHSM
CNX Gas Company LLC

WDTN18UHSM
AS-DRILLED
BOTTOM HOLE



NOTES ON SURVEY

1. COORDINATES SYSTEM IS UTM, NAD 83 DATUM, ZONE 17, U.S. FOOT AND WELL COORDINATES ESTABLISHED USING SURVEY GRADE GPS.
2. SURFACE AND ROYALTY OWNER INFORMATION AND THEIR BOUNDARIES SHOWN HEREON WERE OBTAINED FROM INFORMATION PROVIDED BY CNX GAS COMPANY LLC AND TAX RECORDS.
3. THIS PLAT DOES NOT REPRESENT A BOUNDARY SURVEY OF THE PARCELS SHOWN HEREON.
4. NO DWELLINGS AND BUILDINGS WITHIN 625 FEET OF PROPOSED OF CENTER OF PAD.
5. NO WATER WELLS OR DEVELOPED SPRINGS WITHIN 250 FEET OF PROPOSED WELL.
6. NO PERENNIAL STREAMS, LAKES, PONDS, RESERVOIRS OR WETLANDS WITHIN 100 FEET OF THE LIMITS OF DISTURBANCE.
7. NO NATURALLY PRODUCING TROUT STREAM WITHIN 300 FEET OF LIMITS OF DISTURBANCE.

LEGEND

- Active Well
- Plugged Well Location
- Abandoned Well
- Future Use
- Surface Tract Identification
- Proposed Gas Well
- Located Corner, as noted
- Surface Tract Lines
- Reference Line
- Match Line
- Lease Boundary
- Creek or Drain
- State Line
- WV County Route
- WV State Route

See Page 3 For Surface Owners and Lessors

(⊕) Denotes Location of Well on United States Topographic Maps

AZ 324°57'11"
16,962±



I, the undersigned, hereby certify that this plat is correct to the best of my knowledge and belief and shows all the information required by law and the regulations issued and prescribed by the Department of Environmental Protection.

L. L. Rowe
L. L. S. 687



FILE NO: _____
DRAWING NO: _____
SCALE: 1" = 2000'
MINIMUM DEGREE OF ACCURACY: 1:2500
PROVEN SOURCE OF ELEVATION: NGS CORS Station



DATE: OCTOBER 24 20 24
OPERATORS WELL NO: _____
API WELL NO
47 - 061 - 01916
STATE COUNTY PERMIT

WELL TYPE: OIL GAS LIQUID INJECTION WASTE DISPOSAL
(IF GAS) PRODUCTION: STORAGE DEEP SHALLOW
LOCATION ELEVATION: 1199' WATERSHED: Dunkard Creek QUADRANGLE: Wadestown
DISTRICT: Batelle COUNTY: Monongalia
SURFACE OWNER: Consol Mining Company LLC ACREAGE: 46.75±
ROYALTY OWNER: Bounty Minerals, LLC LEASE NO: 189033000 ACREAGE: 59.02±
PROPOSED WORK: DRILL CONVERT DRILL DEEPER FRACTURE OR STIMULATE PLUG OFF OLD FORMATION
 PERFORATE NEW FORMATION OTHER PHYSICAL CHANGE IN WELL (SPECIFY)
 PLUG AND ABANDON CLEAN OUT AND REPLUG TARGET FORMATION: Marcellus ESTIMATED DEPTH: TVD: 7,848'

WELL OPERATOR: CNX Gas Company LLC DESIGNATED AGENT: Anthony Kendziora
ADDRESS: 1000 Horizon Vue Drive ADDRESS: 111 Avondale Road
Canonsburg, PA 15317 Fairmont, WV 26554

AS-DRILLED

LATITUDE 39° 42' 30" TH: 7015'

WDTN18UHSM
CNX Gas Company LLC

PENNSYLVANIA
GREENE COUNTY
WEST VIRGINIA
MONONGALIA COUNTY

Matchline Sheet 1
Matchline Sheet 2

500' WELL BORE BUFFER
SHOWING EXISTING WELLS

AZ 324°57'11"
16,962'±

WDTN18UHSM
AS-DRILLED
LANDING POINT

NOTES ON SURVEY

- COORDINATES SYSTEM IS UTM, NAD 83 DATUM, ZONE 17, U.S. FOOT AND WELL COORDINATES ESTABLISHED USING SURVEY GRADE GPS.
- SURFACE AND ROYALTY OWNER INFORMATION AND THEIR BOUNDARIES SHOWN HEREON WERE OBTAINED FROM INFORMATION PROVIDED BY CNX GAS COMPANY LLC AND TAX RECORDS.
- THIS PLAT DOES NOT REPRESENT A BOUNDARY SURVEY OF THE PARCELS SHOWN HEREON.
- NO DWELLINGS AND BUILDINGS WITHIN 625 FEET OF PROPOSED OF CENTER OF PAD.
- NO WATER WELLS OR DEVELOPED SPRINGS WITHIN 250 FEET OF PROPOSED WELL.
- NO PERENNIAL STREAMS, LAKES, PONDS, RESERVOIRS OR WETLANDS WITHIN 100 FEET OF THE LIMITS OF DISTURBANCE.
- NO NATURALLY PRODUCING TROUT STREAM WITHIN 300 FEET OF LIMITS OF DISTURBANCE.

LEGEND

- Active Well
- Plugged Well Location
- Abandoned Well
- Future Use
- Surface Tract Identification
- Proposed Gas Well
- Located Corner, as noted
- Surface Tract Lines
- Reference Line
- Match Line
- Lease Boundary
- Creek or Drain
- State Line
- WV County Route
- WV State Route

See Page 3 For Surface Owners and Lessors

(⊕) Denotes Location of Well on United States Topographic Maps



I, the undersigned, hereby certify that this plat is correct to the best of my knowledge and belief and shows all the information required by law and the regulations issued and prescribed by the Department of Environmental Protection.

L. L. S. 687
L. L. S. 687

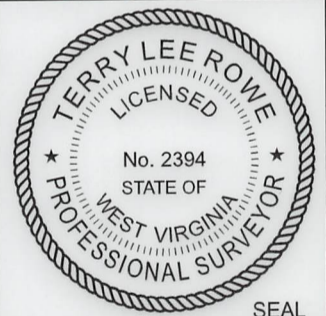

FILE NO: _____
 DRAWING NO: _____
 SCALE: 1" = 2000'
 MINIMUM DEGREE OF ACCURACY: 1:2500
 PROVEN SOURCE OF ELEVATION: NGS CORS Station



DATE: OCTOBER 24 20 24
 OPERATORS WELL NO: _____
 API WELL NO
 47 - 061 - 01916
 STATE COUNTY PERMIT

WELL TYPE: OIL GAS LIQUID INJECTION WASTE DISPOSAL
 (IF GAS) PRODUCTION: STORAGE DEEP SHALLOW
 LOCATION ELEVATION: 1199' WATERSHED: Dunkard Creek QUADRANGLE: Wadestown
 DISTRICT: Batelle COUNTY: Monongalia
 SURFACE OWNER: Consol Mining Company LLC ACREAGE: 46.75 ±
 ROYALTY OWNER: Bounty Minerals, LLC LEASE NO: 189033000 ACREAGE: 59.02 ±
 PROPOSED WORK: DRILL CONVERT DRILL DEEPER FRACTURE OR STIMULATE PLUG OFF OLD FORMATION
 PERFORATE NEW FORMATION OTHER PHYSICAL CHANGE IN WELL (SPECIFY)
 PLUG AND ABANDON CLEAN OUT AND REPLUG TARGET FORMATION: Marcellus ESTIMATED DEPTH: TVD: 7,848'
 WELL OPERATOR: CNX Gas Company LLC DESIGNATED AGENT: Anthony Kendziora
 ADDRESS: 1000 Horizon Vue Drive ADDRESS: 111 Avondale Road
 Canonsburg, PA 15317 Fairmont, WV 26554

AS-DRILLED

TRACT ID	SURFACE OWNER	LESSOR	PIN	
1	Consol Mining Company LLC	Bounty Minerals, LLC	1-9-37	
		Bounty Minerals III Acquisitions, LLC	1-12-7	
		LOLA Drilling I, LLC		
		Rice Drilling B, LLC		
10	Consol Mining Company LLC	Eastern Associated Coal Corporation	1-9-37	
			1-9-38	
11	Consol Mining Company LLC	Eastern Associated Coal Corporation	1-12-8	
12	Consol Mining Company LLC, et al	Ralph Six	1-9-39	
			1-9-39.1	
			1-9-39.2	
			1-9-39.3	
			1-9-39.4	
			1-9-39.5	
			1-9-39.6	
			Antero Resources Corporation	
			Doris Margaret White	
			George Stephen Knight	
13A	Rose L. Thomas	Rose Thomas, aka Rose L. Thomas	1-9-42	
		Sarah C. Sheridan		
		Gail T. Bellucci		
		Hugh Kirkland		
		BOKF, NA, as Sole Trustee of the Alma Kirkland Revocable Trust		
		Sherry Lemons		
		Melissa Kubishke		
		Pamela Jayne Brewer, as Trustee of the Pamela Jayne Brewer Revocable Trust		
		Stephen D. Kirkland and Julie D. Kirkland, Trustees of the Kirkland Family Revocable Trust dated September 2, 1998		
		Louise H. Berg, Trustee of the Louise H. Berg Revocable Trust		
		Christine A. Kirkland, as Trustee of the Christine A. Kirkland Trust		
		Catherine Kirkland		
		Dorothy A. Hammer		
David B. Haines and Jeanette C. Haines, h/w				
Barbara Thomas				
Constance A. Corey f/k/a Constance Ann Haines and Robert Corey, w/h				
Lisa Craig				
Kathleen Costner f/k/a Kathy Figueroa				

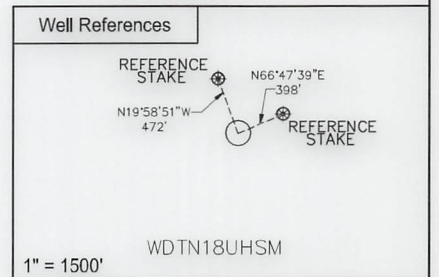
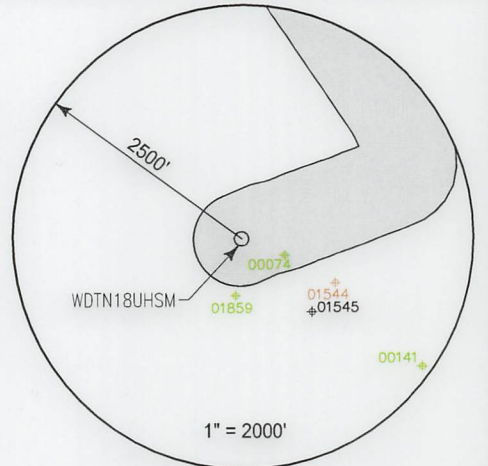

SURFACE HOLE LOCATION (SHL)	
UTM 17 NAD 83	N: 4393679.387
	E: 555024.496
NAD 83, WV NORTH	
	N: 435018.292
	E: 1726984.067
LAT/LON DATUM NAD 83	
	LAT: 39°41'28.263"
	LON: 80°21'29.754"
LANDING POINT	
UTM 17 NAD 83	N: 4394162.980
	E: 555480.032
NAD 83, WV NORTH	
	N: 436580.167
	E: 1728505.363
LAT/LON DATUM NAD 83	
	LAT: 39°41'43.842"
	LON: 80°21'10.482"

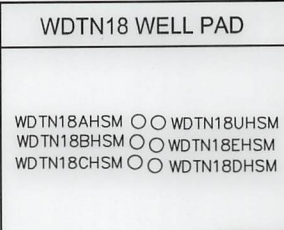

I, the undersigned, hereby certify that this plat is correct to the best of my knowledge and belief and shows all the information required by law and the regulations issued and prescribed by the Department of Environmental Protection.

L. L. S. 687
L. L. S. 687

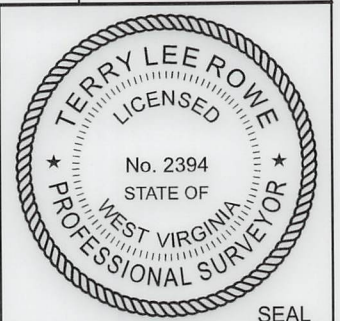

FILE NO:
DRAWING NO:
SCALE: 1" = 1000'
MINIMUM DEGREE OF ACCURACY:
1:2500
PROVEN SOURCE OF ELEVATION:
NGS CORS Station



DATE: OCTOBER 24 20 24
OPERATORS WELL NO:
API WELL NO
47 - 061 - 01916
STATE COUNTY PERMIT

WELL TYPE: OIL GAS LIQUID INJECTION WASTE DISPOSAL
(IF GAS) PRODUCTION: STORAGE DEEP SHALLOW

LOCATION ELEVATION: 1199' WATERSHED: Dunkard Creek QUADRANGLE: Wadestown
DISTRICT: Batelle COUNTY: Monongalia

SURFACE OWNER: Consol Mining Company LLC ACREAGE: 40.75 ±
ROYALTY OWNER: Bounty Minerals, LLC LEASE NO: 189033000 ACREAGE: 59.02 ±

PROPOSED WORK: DRILL CONVERT DRILL DEEPER FRACTURE OR STIMULATE PLUG OFF OLD FORMATION
 PERFORATE NEW FORMATION OTHER PHYSICAL CHANGE IN WELL (SPECIFY)
 PLUG AND ABANDON CLEAN OUT AND REPLUG TARGET FORMATION: Marcellus ESTIMATED DEPTH: TVD: 7,848'

WELL OPERATOR: CNX Gas Company LLC DESIGNATED AGENT: Anthony Kendziora
ADDRESS: 1000 Horizon Vue Drive ADDRESS: 111 Avondale Road
Canonsburg, PA 15317 Fairmont, WV 26554

		Mark A. Macale	
		Mike E. Macale	
		June Fulton f/k/a Jane Fulton	
		Faye B. Sigman f/k/a Faye Arnold Buckley	
		Michelle Woods f/k/a Michelle Brienne Haines	
		Terri Attinger f/k/a Terri Devlin and Richard C. Attinger, w/h	
		Jerilyn R. Baucum	
		Julie Ann Griffis and Gary Griffis, w/h	
		William Lee Haines, Jr.	
		Phillip Ronald Laws	
		Glynis Marion, f/k/a Glynis Lane	
		Larry J. Miller, Jr.	
		Pepe Patrick Jack Miller f/k/a Pat Miller and Kelly Anne Miller, h/w	
		Kris Laws Miller and Robin McClary, her wife	
		Raymond Wayne Frye	
		Rosalie J. Capshaw	
		Jean Banks	
		Kathleen Farmer	
		A. E. Hennen, III	
		John K. Hennen	
		David Michael Hennen	
		Mary Hennen	
		Robert Douglas Hennen	
		Morgan Haning	
		Anne W. Haning	
		Zachary C. Haning	
		Catherine Haning Coleman	
		Carlos Saucedo	
		Ezra Charles McDaniel	
		Patrick James Saucedo	
		Barbara Haning	
		Patrick Lee North, individually and as co-executor of the Edward Lee North Estate	
		Diane H. Goncalves, individually and as co-executor of the Edward Lee North Estate	
		Shawn R. Haines	
		Jerry R. Haines, II	
		Tonya Huntoon	
TRACT ID	SURFACE OWNER	LESSOR	PIN
13B	Rose L. Thomas	George Shriver, himself and as Guardian of J. M. Shriver Lucy White and Edward White, her husband	1-9-40
		Dennis Haines, F.E. Liming and Ethel Liming, his wife	
		Dennis Haines, F.E. Liming and Ethel Liming, his wife	
		Dennis Haines, F.E. Liming and Ethel Liming, his wife	
		The Philadelphia Company of West Virginia	
		Pittsburgh and West Virginia Gas Company	
		Equitable Gas Company	
		Equitrans, Inc	
		Equitrans, L.P.	
		Tri-County Oil & Gas, Inc,	
		Leatherwood, Inc.	
13C	Rose L. Thomas	Rose Thomas, aka Rose L. Thomas	1-9-40.2
		Sarah C. Sheridan	
		Gail T. Bellucci	
		BOKF, NA, as Sole Trustee of the Alma Kirkland Revocable Trust	
		Sherry Lemons	
		Melissa Kubishke	
		Pamela Jayne Brewer, as Trustee of the Pamela Jayne Brewer Revocable Trust	
		Stephen D. Kirkland and Julie D. Kirkland, Trustees of the Kirkland Family Revocable Trust dated September 2, 1998	
		Louise H. Berg, as Trustee of the Louise H. Berg Revocable Trust	
		Christine A. Kirkland, as Trustee of the Christine A. Kirkland Trust	
		Catherine C. Kirkland	
		Morgan Haning	
		Anne W. Haning	
		Zachary C. Haning	
		Catherine Haning Coleman	
		Kathleen Farmer	
		A. E. Hennen, III	
		John K. Hennen	

03/07/2025

		David Michael Hennen	
		Mary Hennen	
		Robert Douglas Hennen	
		Barbara Haning	
		Hugh Kirkland,	
		Patrick Lee North, individually and as co-executor of the Edward Lee North Estate	
		Diane H. Goncalves, individually and as co-executor of the Edward Lee North Estate	
TRACT ID	SURFACE OWNER	LESSOR	PIN
14	Curtis L. Thomas, et ux	George Shriver, himself and as Guardian of J. M. Shriver, Lucy White and Edward White, her husband	1-9-40.3
		Dennis Haines, F.E. Liming and Ethel Liming, his wife	
		Dennis Haines, F.E. Liming and Ethel Liming, his wife	
		Dennis Haines, F.E. Liming and Ethel Liming, his wife	
		The Philadelphia Company of West Virginia	
		Pittsburgh and West Virginia Gas Company	
		Equitable Gas Company	
		Equitrans, Inc	
		Equitrans, L.P.	
		Tri-County Oil & Gas, Inc,	
		Leatherwood, Inc.	
TRACT ID	SURFACE OWNER	LESSOR	PIN
15	Curtis L. Thomas, et ux	Curtis L Thomas and Diana B Thomas	1-9-40.1
		Gail T Bellucci	
		Alma E. Kirkland Revocable Living Trust Agreement, Bank of Oklahoma N.A., Sole Successor Trustee	
		Sherry Lemons	
		Melissa Kubishke f/k/a Melissa Graham	
		Pamela Jane Brewer	
		Stephen D Kirkland and Julie D Kirkland, Trustees of the Kirkland Family Revocable Trust dated September 2, 1998	
		Louise Kirkland Berg	
		Christine A Kirkland, as Trustee of the Christine A Kirkland Trust	
		Catherine C Kirkland	
		Ann W Haning	
		Morgan Haning	
		Zachery Haning	
		Catherine Haning Coleman	
		Kathleen Farmer	
		A E Hennen III	
		John K Hennen	
		David Michael Hennen	
		Mary Hennen	
		Robert Douglas Hennen	
		Sarah Casey Sheridan	
		Hugh Kirkland	
		Patrick Lee North, individually and as co-executor of the Edward Lee North Estate	
		Diane H. Goncalves, individually and as co-executor of the Edward Lee North Estate	
		Barbara Haning	
TRACT ID	SURFACE OWNER	LESSOR	PIN
16	Richard J. Cassone, et ux, et al	Samuel William Stewart and Barbara C. Stewart, individually and as husband and wife	1-9-18 1-9-18.1 1-9-18.2 1-9-18.3
		John Samuel Stewart	
		Merrion Oil and Gas Corporation	
		Hu's Land & Minerals, LLC	
		EQT Production Company	
		Richard J. Cassone and Linda Ann Cassone, h/w	
		Harold Creel and Martha Ann Creel, h/w	
		James Creel	
TRACT ID	SURFACE OWNER	LESSOR	PIN
24	Consol Mining Company LLC	Bounty Minerals LLC	1-9-19

03/07/2025

TRACT ID	SURFACE OWNER	LESSOR	PIN
25A	Glenn L. White Trust, et al	David C. White a/k/a David Charles White and Regina S. White a/k/a Regina Sue White h/w	1-9-9 1-9-9.1 1-9-9.2 1-9-9.4 1-9-9.5 1-9-9.6
		Marian Rebecca Stone Garrett	
		Patricia Kathleen White Hoekstra	
		Carol Sue Davis	
		Richard H. Benson, II	
		Edwin Ray White, II	
		Anita Susan Talbott	
		Robert L. Tate, Jr.	
		Robert S. Elliott	
		Donald Edward Stone	
		Doris Jean White	
		David Ray Stone	
		Bettyann Reed	
		Mary Ann Borkowski and Marc Borkowski	
		Jan W. Ellison and Thomas A. Ellison	
		Jane W. McIntyre and Glenn C. McIntyre	
		Lucy Mae Stickle	
Nancy Emerick			
Marsha W. Byers and Stephen R. Byers			
Edith B. White			
Alvy Scott White			
Karen Imogene Meyer			
Candace L. McPheron			
Howard L. Leckey			
Dennis F. Hatton, Jr.			
Melinda Reid Hatton			
Three Rivers Royalty II, LLC			
Amanda Hatton			
Frederick C. Tate			
TRACT ID	SURFACE OWNER	LESSOR	PIN
25B	CNX RCPC LLC	David C. White a/k/a David Charles White and Regina S. White a/k/a Regina Sue White	1-9-9.6
		Marian Rebecca Stone Garrett	
		Patricia Kathleen White Hoekstra	
		Carol Sue Davis	
		Richard H. Benson, II	
		Edwin Ray White, II	
		Anita Susan Talbott	
		Robert L. Tate, Jr.	
		Robert S. Elliott	
		Donald Edward Stone	
		Doris Jean White	
		David Ray Stone	
		Bettyann Reed	
		Mary Ann Borkowski and Marc Borkowski	
		Jan W. Ellison and Thomas A. Ellison	
		Jane W. McIntyre and Glenn C. McIntyre	
		Lucy Mae Stickle	
Nancy Emerick			
Marsha W. Byers and Stephen R. Byers			
Edith B. White (Daniel Reed White Heirs)			
Alvy Scott White			
Karen Imogene Meyer			
Candace L. McPheron			
Howard L. Leckey			
Dennis F. Hatton, Jr.			
Melinda Reid Hatton			
Three Rivers Royalty II, LLC			
Amanda Hatton			
Frederick C. Tate			

03/07/2025

TRACT ID	SURFACE OWNER	LESSOR	PIN
26A	Kevin Hartley, et ux	Kevin Hartley and Linda Hartley, h/w	1-9-8
		Martha Carol Grimes	
		Mary Frances Grimes-Yeater	
		Margaret Harriett Grimes-Bryan and John W. Bryan, w/h	
		Karen S. Stewart and Randall L. Stewart, w/h	
		Thomas Bradford Grimes	
		Diana Williamson	
		Mary Ann McGlumphy	
		Myra Lynn Fitzsimmons	
		Susan Kay Fitzsimmons	
		Cynthia Kinder	
		Lawrence Raymond Stiles and Winfred A. Stiles, h/w	
		Joseph David Cross	
		Rebecca Stiles	
		Thomas Edward Stiles and Deborah K. Stiles, h/w	
		Billy Gordon Fitzsimmons	
		Shari Jo Murnane	
		Michael Edwin Smith and Juliann M. Smith, h/w	
		Robert Dean Smith and Cynthia Rae Smith, h/w	
		Donald Ray Jordan	
		Megan Jordan	
		Mary Beth Steele	
		Jan Marie Steele	
		Gary Arthur Kesteven and Nancy R. Kesteven, h/w	
		Wendy C. Hershey f/k/a Wendy C. Kesteven	
		Sandra Hadsell	
		Douglas Baker	
		Gloria Dunlap	
		David Stiles	
TRACT ID	SURFACE OWNER	LESSOR	PIN
26B	Kevin Hartley, et ux	Kevin Hartley and Linda Hartley, h/w	1-9-7
TRACT ID	SURFACE OWNER	LESSOR	PIN
27	Davin Austin Copeland	Davin Austin Copeland	1-2-25
TRACT ID	SURFACE OWNER	LESSOR	PIN
38	Kevin Hartley, et ux	Kevin Hartley and Linda Hartley, h/w	1-2-9
TRACT ID	SURFACE OWNER	LESSOR	PIN
39	Paul David Beck, et al	Bounty Minerals, LLC	1-2-8
TRACT ID	SURFACE OWNER	LESSOR	PIN
40	Paul David Beck, et al	Bounty Minerals, LLC	1-2-8
TRACT ID	SURFACE OWNER	LESSOR	PIN
42	Paul David Beck, et al	Bounty Minerals, LLC	1-2-8
		James W. Dorsey	
		Janice Whitaker	
		Janet Stukins	
		Gary A. Booth	
		David L. Booth	
		Daniel B. Booth	
		William C. Booth	
		Judy A. Taylor	
		Robert Campbell	
		Kenneth Jeff Campbell	
TRACT ID	SURFACE OWNER	LESSOR	PIN
43	Paul David Beck, et al	Bounty Minerals, LLC	1-2-8
		James W. Dorsey	
		Janice Whitaker	
		Janet Stukins	
		Gary A. Booth	
		David L. Booth	
		Daniel B. Booth	
		William C. Booth	
		Judy A. Taylor	
		Robert Campbell	
		Kenneth Jeff Campbell	

03/07/2025

TRACT ID	SURFACE OWNER	LESSOR	PIN
44	Consol Mining Company LLC	Flossie Kimble, widow of S. E. Kimble, Denzle Kimble and Olive Irene Wright Kimble, h/w	1-2-12
		Consolidation Coal Company	
		James W. Dorsey	
		Janice Whitaker	
		Janet Stukins	
		Gary A. Booth	
		David L. Booth	
		Daniel B. Booth	
		William C. Booth	
		Judy A. Taylor	
		Robert Campbell	
		Kenneth Jeff Campbell	
TRACT ID	SURFACE OWNER	LESSOR	PIN
45	Consol Mining Company LLC	Flossie Kimble, widow of S. E. Kimble; Denzle Kimble and Olive Irene Wright Kimble, h/w	1-2-5
		Consolidation Coal Company	
		Aliakbar Afshari	
		Amir H. Mohammadi	
		EQT Production Company	
TRACT ID	SURFACE OWNER	LESSOR	PIN
48	Consol Mining Company LLC	James L. Taylor and DeEtta K. Taylor, his wife,	1-2-4
		Consolidation Coal Company	
		Elkhorn Minerals, LLC	

03/07/2025