

FILE #: NNE20  
 DRAWING #: 3047  
 SCALE: PLAT: 1" = 2000'  
 TCK: 1" = 2000'  
 MINIMUM DEGREE OF ACCURACY: 1/200  
 PROVEN SOURCE OF ELEVATION: SUBMETER MAPPING GRADE GPS

I, THE UNDERSIGNED, HEREBY CERTIFY THAT THIS PLAT IS CORRECT TO THE BEST OF MY KNOWLEDGE AND BELIEF AND SHOWS ALL THE INFORMATION REQUIRED BY LAW AND THE REGULATIONS ISSUED AND PRESCRIBED BY THE DEPARTMENT OF ENVIRONMENTAL PROTECTION.

Signed: [Signature]  
 L.L.S. #2124 : Ernest J. Benchek III

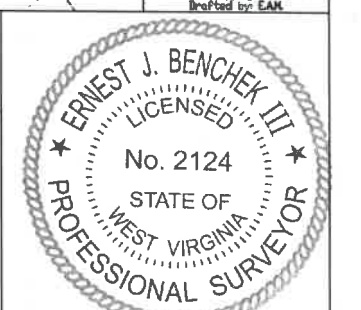

(+) DENOTES LOCATION OF WELL ON UNITED STATES TOPOGRAPHIC MAPS WYDEP

OFFICE OF OIL & GAS  
 601 57TH STREET  
 CHARLESTON, WV 25304

Well Type:  Oil  Waste Disposal  Production  Deep  
 Gas  Liquid Injection  Storage  Shallow

WATERSHED: UPPER MONONGAHELA RIVER  
 COUNTY/DISTRICT: MONONGALIA / CLAY  
 SURFACE OWNER: ALAN SULLIVAN  
 OIL & GAS ROYALTY OWNER: ALAN SULLIVAN  
 LEASE NUMBERS: \_\_\_\_\_

DATE: OCTOBER 18, 2022  
 OPERATOR'S WELL #: SULLIVAN 1H  
 API WELL #: 47 61 01917  
 STATE COUNTY PERMIT  
 CURRENT ELEVATION: 1,520'  
 PROPOSED ELEVATION: 1,476.4'  
 QUADRANGLE: GRANT TOWN  
 ACREAGE: 870.94 +/-  
 ACREAGE: 25.870 +/-

DRILL  CONVERT  DRILL DEEPER  REDRILL  FRACTURE OR STIMULATE   
 PLUG OFF FORMATION  PERFORATE NEW FORMATION  PLUG & ABANDON   
 CLEAN OUT & REPLUG  OTHER CHANGE  (SPECIFY): \_\_\_\_\_

TARGET FORMATION: MARCELLUS  
 ESTIMATED DEPTH: TVD: 8,247' TMD: 22,000'  
 WELL OPERATOR: NORTHEAST NATURAL ENERGY LLC  
 DESIGNATED AGENT: JOHN ADAMS  
 ADDRESS: 707 VIRGINIA STREET EAST, SUITE 1200  
 ADDRESS: 707 VIRGINIA STREET EAST, SUITE 1200  
 CITY: CHARLESTON STATE: WV ZIP CODE: 25301  
 CITY: CHARLESTON STATE: WV ZIP CODE: 25301

01/06/2023

4-19-14	PENNY S QUICKLE
4-19-23	BOYD & MARY STARKEY ESTATE
4-26-35	RANDY LEE & TRINA TENNANT
4-26-34	SHIRLEY J NEELY, DEANNA M FRAZIER, DONNA J WALDEN & DARRIN NEELY
4-26-18	ROSE MARIE FLUHARTY
4-26-30	THOMAS R & LISA A LUZADER
4-26-38	ADAM CLAY DARRAH
4-26-30.2	WAYNE WHIPKEY
4-26-17	ROSE MARIE FLUHARTY
4-26-29	WAYNE WHIPKEY
4-19-14.2	PENNY S QUICKLE
4-19-26	CHARLES W MOORE; JASON T & KIRSTON KARSON (LIFE)
4-19-24	EDITH L DARRAH
4-19-25	SHIRLEY L MOORE ESTATE
4-19-49	ROCKY & CATHY J BARR
4-26-12	KENNETH W & RUTH E ALBERT
4-26-35.1	ALAN SULLIVAN
4-26-26	NNE MIDSTREAM LLC
4-26-20	KENNETH W & RUTH E ALBERT
4-19-6	JIMMY R & PAMELA K TENNANT; RAY & ROXANA CAHILL
4-19-7	STEPHEN R WILSON, ET AL
4-19-1.1	KEMBLE D TATE

LEASE INDEX			
A	WV-061-000160-001-ACT	I	WV-061-003931-001
B	WV-061-005448-002	J	WV-061-003931-011
C	WV-061-000160-001-ACT	K	WV-061-003931-002
D	WV-061-000165-001 - LA	L	WV-061-000160-001-ACT
E	WV-061-000160-001-ACT	M	WV-061-003931-011
F	WV-061-005998-001	N	WV-061-000160-001-ACT
G	WV-061-004797-039	O	WV-061-004792-004
H	WV-061-000160-001-ACT	P	WV-061-005788-001
		Q	WV-061-005876-002

01/06/2023

FILE #: NEE20  
DRAWING #: 3047  
SCALE: N/A

DATE: OCTOBER 18, 2022  
OPERATOR'S WELL #: SULLIVAN 1H  
API WELL #: 47 61 01917  
STATE COUNTY PERMIT

WELL NAME: SULLIVAN 1H  
GRANT TOWN, WV

RECEIVED  
Office of Oil and Gas  
NOV 15 2022  
WV Department of  
Environmental Protection

TOTAL DISTANCE BORED  
FROM LP TO BH = 12,934'

MONONGALIA COUNTY CO  
MARION COUNTY CO

01/06/2023

GRAPHIC SCALE

