

NOTES ON SURVEY

- COORDINATES SYSTEM IS UTM, NAD 83 DATUM, ZONE 17, U.S. FOOT AND WELL COORDINATES ESTABLISHED USING SURVEY GRADE GPS.
- SURFACE AND ROYALTY OWNER INFORMATION AND THEIR BOUNDARIES SHOWN HEREON WERE OBTAINED FROM INFORMATION PROVIDED BY CNX GAS COMPANY LLC AND TAX RECORDS.
- THIS PLAT DOES NOT REPRESENT A BOUNDARY SURVEY OF THE PARCELS SHOWN HEREON.
- NO DWELLINGS AND BUILDINGS WITHIN 625 FEET OF PROPOSED OF CENTER OF PAD.
- NO WATER WELLS OR DEVELOPED SPRINGS WITHIN 250 FEET OF PROPOSED WELL.
- NO PERENNIAL STREAMS, LAKES, PONDS, RESERVOIRS OR WETLANDS WITHIN 100 FEET OF THE LIMITS OF DISTURBANCE.
- NO NATURALLY PRODUCING TROUT STREAM WITHIN 300 FEET OF LIMITS OF DISTURBANCE.

LEGEND

- Active Well
- Plugged Well Location
- Abandoned Well
- Future Use
- Surface Tract Identification
- Proposed Gas Well
- Located Corner, as noted
- Surface Tract Lines
- Reference Line
- Match Line
- Lease Boundary
- Creek or Drain
- State Line
- WV County Route
- WV State Route



I, the undersigned, hereby certify that this plat is correct to the best of my knowledge and belief and shows all the information required by law and the regulations issued and prescribed by the Department of Environmental Protection.

L. L. S. 687
L. L. S. 687



FILE NO:
DRAWING NO:
SCALE: 1" = 2000'
MINIMUM DEGREE OF ACCURACY: 1:2500
PROVEN SOURCE OF ELEVATION: NGS CORS Station



DATE: OCTOBER 24 20 24
OPERATORS WELL NO:
API WELL NO
47 - 061 - 01944
STATE COUNTY PERMIT

WELL TYPE: OIL GAS LIQUID INJECTION WASTE DISPOSAL
(IF GAS) PRODUCTION: STORAGE DEEP SHALLOW
LOCATION ELEVATION: 1199' WATERSHED: Dunkard Creek QUADRANGLE: Wadestown
DISTRICT: Battelle COUNTY: Monongalia
SURFACE OWNER: Consol Mining Company LLC ACREAGE: 46.75 ±
ROYALTY OWNER: Bounty Minerals, LLC LEASE NO: 189033000 ACREAGE: 59.02 ±
PROPOSED WORK: DRILL CONVERT DRILL DEEPER FRACTURE OR STIMULATE PLUG OFF OLD FORMATION
 PERFORATE NEW FORMATION OTHER PHYSICAL CHANGE IN WELL (SPECIFY)
 PLUG AND ABANDON CLEAN OUT AND REPLUG TARGET FORMATION: Marcellus ESTIMATED DEPTH: TVD: 7,848'

WELL OPERATOR: CNX Gas Company LLC DESIGNATED AGENT: Anthony Kendziora
ADDRESS: 1000 Horizon Vue Drive ADDRESS: 111 Avondale Road
Canonsburg, PA 15317 Fairmont, WV 26554

AS-DRILLED

WDTN18AHSM
CNX Gas Company LLC

WDTN18AHSM
AS-DRILLED
BOTTOM HOLE



NOTES ON SURVEY

1. COORDINATES SYSTEM IS UTM, NAD 83 DATUM, ZONE 17, U.S. FOOT AND WELL COORDINATES ESTABLISHED USING SURVEY GRADE GPS.
2. SURFACE AND ROYALTY OWNER INFORMATION AND THEIR BOUNDARIES SHOWN HEREON WERE OBTAINED FROM INFORMATION PROVIDED BY CNX GAS COMPANY LLC AND TAX RECORDS.
3. THIS PLAT DOES NOT REPRESENT A BOUNDARY SURVEY OF THE PARCELS SHOWN HEREON.
4. NO DWELLINGS AND BUILDINGS WITHIN 625 FEET OF PROPOSED OF CENTER OF PAD.
5. NO WATER WELLS OR DEVELOPED SPRINGS WITHIN 250 FEET OF PROPOSED WELL.
6. NO PERENNIAL STREAMS, LAKES, PONDS, RESERVOIRS OR WETLANDS WITHIN 100 FEET OF THE LIMITS OF DISTURBANCE.
7. NO NATURALLY PRODUCING TROUT STREAM WITHIN 300 FEET OF LIMITS OF DISTURBANCE.

LEGEND

- Active Well
- Plugged Well Location
- Abandoned Well
- Future Use
- Surface Tract Identification
- Proposed Gas Well
- Located Corner, as noted
- Surface Tract Lines
- - - Reference Line
- Match Line
- Lease Boundary
- Creek or Drain
- State Line
- WV County Route
- WV State Route

See Page 3 For Surface Owners and Lessors

(- ⊕) Denotes Location of Well on United States Topographic Maps

AZ 324°59'06"
20,807±

PENNSYLVANIA
GREENE COUNTY

WEST VIRGINIA
MONONGALIA COUNTY

Matchline Sheet 1
Matchline Sheet 2



I, the undersigned, hereby certify that this plat is correct to the best of my knowledge and belief and shows all the information required by law and the regulations issued and prescribed by the Department of Environmental Protection.

L. L. S. 687
L. L. S. 687



FILE NO:
DRAWING NO:
SCALE: 1" = 2000'
MINIMUM DEGREE OF ACCURACY: 1:2500
PROVEN SOURCE OF ELEVATION: NGS CORS Station



DATE: OCTOBER 24 20 24
OPERATORS WELL NO:
API WELL NO
47 - 061 - 01944
STATE COUNTY PERMIT

WELL TYPE: OIL GAS LIQUID INJECTION WASTE DISPOSAL
(IF GAS) PRODUCTION: STORAGE DEEP SHALLOW
LOCATION ELEVATION: 1199' WATERSHED: Dunkard Creek QUADRANGLE: Wadestown
DISTRICT: Battelle COUNTY: Monongalia
SURFACE OWNER: Consol Mining Company LLC ACREAGE: 46.75 ±
ROYALTY OWNER: Bounty Minerals, LLC LEASE NO: 189033000 ACREAGE: 59.02 ±
PROPOSED WORK: DRILL CONVERT DRILL DEEPER FRACTURE OR STIMULATE PLUG OFF OLD FORMATION
 PERFORATE NEW FORMATION OTHER PHYSICAL CHANGE IN WELL (SPECIFY)
 PLUG AND ABANDON CLEAN OUT AND REPLUG TARGET FORMATION: Marcellus ESTIMATED DEPTH: TVD: 7,848'

WELL OPERATOR: CNX Gas Company LLC DESIGNATED AGENT: Anthony Kendziora
ADDRESS: 1000 Horizon Vue Drive ADDRESS: 111 Avondale Road
Canonsburg, PA 15317 Fairmont, WV 26554

AS-DRILLED

TRACT ID	SURFACE OWNER	LESSOR	PIN
1	Consol Mining Company LLC	Bounty Minerals, LLC	1-9-37
			1-12-7
		Bounty Minerals III Acquisitions, LLC	
		LOLA Drilling I, LLC	
		Rice Drilling B, LLC	
3	Consol Mining Company LLC	Norman Core	1-12-4
		Deep Rock Mineral Group, Inc.	
		Northeast Natural Energy LLC	
		EQT Production Company	
		Kimeric and Company, LLC	
		Antero Resources Corporation	
		Shuman, Inc.	
		Pamela J. Gaston	
4	Consol Mining Company LLC	Fred C. Park, et al	1-9-35
		Consolidation Coal Company	
		CONSOL Mining Company LLC	
		CNX Resource Holdings LLC	
		Joseph S. Delaney	
		Michael S. Delaney	
		Earlene Owens and Robert Owens, w/h	
		Nancy Paulovicks and Jay E. Paulovicks, w/h	
		Martha A. Pryor, a/k/a Martha Ann Pryor by Robert Owens as Agent	
		W. James Shannon	
		Leon E. Delaney	
		Jeff T. Delaney	
		Mary Ellen Bell	
		Lee E. Delaney	
		Martha Ann Price	
		George William Cummins, Jr.	
David Allen Jolliffe and Donna Sue A. Jolliffe, h/w			
Lisa Ellen May and Gary A. May, w/h			

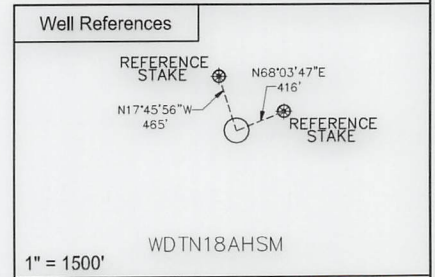
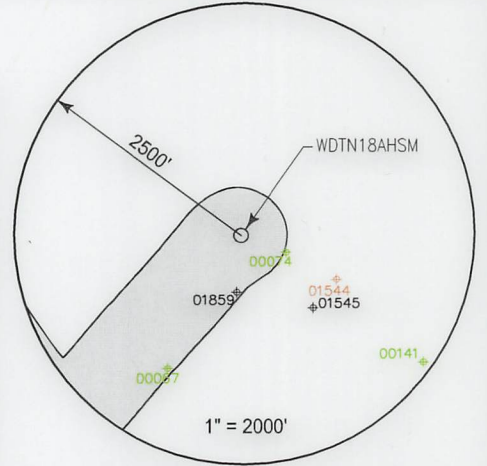

SURFACE HOLE LOCATION (SHL)	
UTM 17 NAD 83	
N: 4393679.771	
E: 555018.489	
NAD 83, WV NORTH	
N: 435019.883	
E: 1726964.377	
LAT/LON DATUM NAD 83	
LAT: 39°41'28.276"	
LO: 80°21'30.006"	
LANDING POINT	
UTM 17 NAD 83	
N: 4393206.434	
E: 554292.169	
NAD 83, WV NORTH	
N: 433506.507	
E: 1724555.098	
LAT/LON DATUM NAD 83	
LAT: 39°41'13.091"	
LO: 80°22'00.639"	
BOTTOM HOLE LOCATION (BHL)	
UTM 17 NAD 83	
N: 4398337.100	
E: 550568.586	
NAD 83, WV NORTH	
N: 450546.383	
E: 1712617.917	
LAT/LON DATUM NAD 83	
LAT: 39°44'00.328"	
LO: 80°24'35.542"	

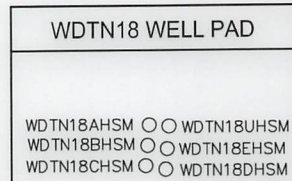

I, the undersigned, hereby certify that this plat is correct to the best of my knowledge and belief and shows all the information required by law and the regulations issued and prescribed by the Department of Environmental Protection.

L. L. S. 687
L. L. S. 687

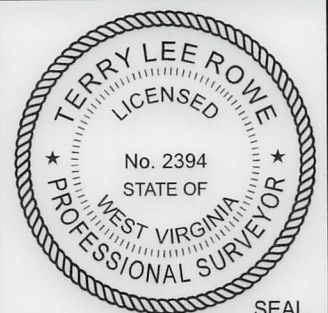

FILE NO: _____
DRAWING NO: _____
SCALE: 1" = 1000'
MINIMUM DEGREE OF ACCURACY: 1:2500
PROVEN SOURCE OF ELEVATION: NGS CORS Station

STATE OF WEST VIRGINIA
DEPARTMENT OF ENVIRONMENTAL PROTECTION
OIL AND GAS DIVISION



DATE: OCTOBER 24 20 24
OPERATORS WELL NO: _____
API WELL NO: 47 - 061 - 01944
STATE COUNTY PERMIT

WELL TYPE: OIL GAS LIQUID INJECTION WASTE DISPOSAL
(IF GAS) PRODUCTION: STORAGE DEEP SHALLOW

LOCATION ELEVATION: 1199' WATERSHED: Dunkard Creek QUADRANGLE: Wadestown
DISTRICT: Battelle COUNTY: Monongalia

SURFACE OWNER: Consol Mining Company LLC ACREAGE: 59.02 ±
ROYALTY OWNER: Bounty Minerals, LLC LEASE NO: 189033000

PROPOSED WORK: DRILL CONVERT DRILL DEEPER FRACTURE OR STIMULATE PLUG OFF OLD FORMATION
 PERFORATE NEW FORMATION OTHER PHYSICAL CHANGE IN WELL (SPECIFY) _____
 PLUG AND ABANDON CLEAN OUT AND REPLUG TARGET FORMATION: Marcellus ESTIMATED DEPTH: TVD: 7,848'

WELL OPERATOR: CNX Gas Company LLC DESIGNATED AGENT: Anthony Kendziora
ADDRESS: 1000 Horizon Vue Drive ADDRESS: 111 Avondale Road
Canonsburg, PA 15317 Fairmont, WV 26554

03/07/2025

TRACT ID	SURFACE OWNER	LESSOR	PIN
5	Consol Mining Company LLC	Fred C. Park, et al	1-9-34 1-9-34.1
		Consolidation Coal Company	
		CONSOL Mining Company LLC	
		CNX Resource Holdings LLC	
6	Consol Mining Company LLC	Mike Ross, Inc.	1-9-29
		Waco Oil & Gas Co., Inc.	
7	Consol Mining Company LLC	Ronnie Lee Jones and Elizabeth Ann Jones, h/w	1-9-30
		Consolidation Coal Company	
		CONSOL Mining Company LLC	
		CNX Resource Holdings LLC	
8A	Consol Mining Company LLC	Martha Sue Kerr	1-9-36
		Larry A. Kerr	
		Antero Resources Corporation	
		Bruce Scott Carpenter	
		Patti Carpenter	
		Bruce P. Carpenter	
		Jeannine Osmanski and Robert E. Osmanski, w/h	
8B	Consol Mining Company LLC	Martha Sue Kerr	1-12-5
		Larry A. Kerr	
		Antero Resources Corporation	
		Bruce Scott Carpenter	
		Patti Carpenter	
		Bruce P. Carpenter	
		Jeannine Osmanski and Robert E. Osmanski, w/h	
8C	Consol Mining Company LLC	Martha Sue Kerr	1-9-36
		Larry A. Kerr	
		Antero Resources Corporation	
		Bruce Scott Carpenter	
		Patti Carpenter	
		Bruce P. Carpenter	
		Jeannine Osmanski and Robert E. Osmanski, w/h	
		Rodney A Clovis	
		Christopher Lance Clovis	
		Timothy Steele Clovis a/k/a Timothy S. Clovis	
		Clinton Alan Clovis a/k/a Clint Clovis	
		Robin L. Clovis Wade a/k/a Robin Lynn Clovis	
		James Douglas Campbell	
		Robert York Uren	
		Pennie Mae Gurley	
		Tiffany May Coker and Micahel D. Coker, w/h	
		Joseph Allen Campbell and Kathryn Ernst Campbell, h/w	
		Dorothy Ione Harcum	
		David Hilirion Campbell and Sheryl L. Campbell, h/w	
		Regina Kay Orfanos and Anthony Orfanos, w/h	
		Michelle Law	
		Tina Law	
		Robin Lynn Campbell	
		Susan Cale Teter and Gary Teter, w/h	
		John Edward Cale	
		Karen L. Haught and Jimmie A. Haught, w/h	

03/07/2025

	Edwin R. White a/k/a Eddie White and Patricia White,
	Cherrie Anderson Yost a/k/a Cherrie Anderson Yost
	Douglas Yost
	David Yost
	Nancy Bohannon
	Mary Jo Morris
	Janet Eglund
	David Allen Jolliffe and Donna Sue A. Jolliffe, h/w
	Lisa Ellen May and Gary A. May, w/h
	William James Shannon
	Nancy Paulovicks
	Robert Owens and Earlene Owens, h/w
	Mary Ellen Bell
	Martha Ann Prince
	Charles R. Delaney
	Shawn Delaney
	Larry Delaney
	George William Cummins, Jr.
	Lee E. Delaney and Shannon Delaney, h/w
	Susan D. Delaney
	Joseph S. Delaney
	Michael S. Delaney and Susan Delaney, h/w
	Nola Chisler and Charles D. Chisler, w/h
	Jay Park and Carolyn S. Park, h/w
	Donna J. Glaspell a/k/a Donna J. Snyder
	Debra Lynn Lundgren
	Cheryl Darlene Fordyce
	Robert Henderson Fordyce a/k/a Robert H. Fordyce and Patricia A. Fordyce, h/w
	Martha Sue Cvechko and John M. Cvechko, w/h
	Brenda Lou Painter f/k/a Brenda Lou Henderson
	Cheryl Lynn Stout
	James Michael Cale and Laura W. Cale, h/w
	John Smith
	Robert L. Smith a/k/a Bob Smith and Carol Smith, h/w
	William M. Smith a/k/a Bill Smith and Ruth C. Smith, h/w
	Greg Rowland and Brady Rowland, h/w
	Carol Neal
	William F. Henderson a/k/a Willaim F. Hendsen a/k/a Bill Henderson
	Steve Edward Henderson
	Matthew David Stiles
	Mark Douglas Stiles, a/k/a Mark Douglas Stiles
	Marcia Stiles Batson
	James Aspinall and Marion Aspinall, h/w
	Robert S. Elliott
	Robert Scott Davis and Jennifer Davis, h/w
	Olen Ray Harker
	Jo Ann Henderson
	John Gaertner
	Taylor Nicole Best
	Kevin Russell Beasley
	Magnus Audbjorn Sonofthor
	Shannon Renee Sutton
	Jessica Bergevine
	Drema L. Howard
	Arnold Lebron Uren
	Victor A. White
	CNX Resource Holding LLC

03/07/2025

TRACT ID	SURFACE OWNER	LESSOR	PIN
10	Consol Mining Company LLC	Eastern Associated Coal Corporation	1-9-37 1-9-38
20	Consol Mining Company LLC	Donald C. Clovis and Donna P. Clovis, h/w	1-9-28 1-9-28.2
21	Consol Mining Company LLC	Donald C. Clovis and Donna P. Clovis, h/w	1-9-27 1-9-28.2
22A	CNX RCPC LLC	Joseph Muto	1-9-21
		Milan W. Cikovich, Jr. and Susan K. Cikovich	
		Steven E. Hennen	
		Gregory S. Clark	
		Carl J. Woods	
		Mark A. Clark	
		Beverly A. Tonge	
		Wanda Lee Shaffer	
		Denzil L. Hennen and Bonnie L. Hennen, h/w	
		Eugene D. Hennen	
		Nancy K. Haddix	
		Carolyn S. Moore and James E. Moore, w/h	
		Charlie Fudge	
		Mary Sargent Hennen	
		Belinda T. Shriver and Chalres C. Shriver, w/h	
		Donna K. Wickham	
		Denise Mitchell	
		Marjorie Woods White	
		James R. Hennen, Jr.	
		Judy Kay Marshall and Graham Marshall, h/w	
		Mary Virginia Davis	
		EQT Production Company	
		Donna R. Hennen	
		WOG Leaseing, LLC	
		Betty Short	
		Don Fordyce	
		Mildred Louise Walton	
		Linda S. Sansone and Charles F. Sansone, w/h	
		Karen S. Gray	
		Helene M. Muetzel	
		Cecil Hennen	
		Roger L. Pratt	
		Milan W. Cikovich, Jr., individually and as Trustee of the Amended and Restated Milan W. Cikovich Testamentary Trust F/B/O Francine R. Cikovich, and Christine Michelle Park, individually and as Trsutee of the Amended and Restated Milan W. Cikovich Testamentary Trust F/B/O Francine R. Cikovich	
		Melissa Ann Hennen Limbaugh	
		Three Rivers Royalty II, LLC	
		Connie Jean Thompson Hennen	
		Richard P. Hennen	
		Bonnie Lee Hennen Winnen	
		David L. Liming and Nancy A. Liming, h/w	
		Herbert Lee Haines and Linda R. Haines, h/w	
		Helen Pecora	
		Dorothy Chohrach	
		Patricia A. Cooney	
		Nancy Irwin Singer	
		James C. Irwin	
		Jeannette Irwin Prout	
		St. John's Evangelical Protestant Church	
		Nelson James Hennen, Jr.	
		Francis J. Waldron Hennen	
		Delores Ann Hennen Bryant	
		Clark H. Hennen	
		Ronald Fordyce	
		James Cox	
		Ralph E. Hixenbaugh	
		Frank Hennen	
		Frank Hennen	
		Carol A. Irwin	
		Bernard A. Yocke	

03/07/2025

TRACT ID	SURFACE OWNER	LESSOR	PIN
22B	CNX RCPC LLC	Joseph Muto	1-9-21
		Milan W. Cikovich, Jr. and Susan K. Cikovich	
		Steven E. Hennen	
		Gregory S. Clark	
		Carl J. Woods	
		Mark A. Clark	
		Beverly A. Tonge	
		Wanda Lee Shaffer	
		Denzil L. Hennen and Bonnie L. Hennen, h/w	
		Eugene D. Hennen	
		Nancy K. Haddix	
		Carolyn S. Moore and James E. Moore, w/h	
		Charlie Fudge	
		Mary Sargent Hennen	
		Belinda T. Shriver and Chalres C. Shriver, w/h	
		Donna K. Wickham	
		Denise Mitchell	
		Marjorie Woods White	
		James R. Hennen, Jr.	
		Judy Kay Marshall and Graham Marshall, h/w	
		Mary Virginia Davis	
		EQT Production Company	
		Donna R. Hennen	
		WOG Leaseing, LLC	
		Betty Short	
		Don Fordyce	
		Mildred Louise Walton	
		Linda S. Sansone and Charles F. Sansone, w/h	
		Karen S. Gray	
		Helene M. Muetzel	
		Cecil Hennen	
		Roger L. Pratt	
		Milan W. Cikovich, Jr., individually and as Trustee of the Amended and Restated Milan W. Cikovich Testamentary Trust F/B/O Francine R. Cikovich, and Christine Michelle Park, individually and as Trsutee of the Amended and Restated Milan W. Cikovich Testamentary Trust F/B/O Francine R. Cikovich	
		Melissa Ann Hennen Limbaugh	
		Three Rivers Royalty II, LLC	
		Connie Jean Thompson Hennen	
		Richard P. Hennen	
		Bonnie Lee Hennen Winnen	
		David L. Liming and Nancy A. Liming, h/w	
		Herbert Lee Haines and Linda R. Haines, h/w	
		Helen Pecora	
		Dorothy Chohrach	
		Patricia A. Cooney	
		Nancy Irwin Singer	
		James C. Irwin	
		Jeannette Irwin Prout	
		St. John's Evangelical Protestant Church	
		Nelson James Hennen, Jr.	
		Francis J. Waldron Hennen	
		Delores Ann Hennen Bryant	
		Clark H. Hennen	
		Ronald Fordyce	
		James Cox	
		Ralph E. Hixenbaugh	
		Frank Hennen	
		Frank Hennen	
		Carol A. Irwin	
		Bernard A. Yocke	
TRACT ID	SURFACE OWNER	LESSOR	PIN
23	Consol Mining Company LLC	Russell Scotchell and Robin G. Scotchell, h/w	1-9-22
		Consolidation Coal Company	
		CONSOL Mining Company LLC	
		CNX Resource Holdings LLC	

03/07/2025

API WELL NO

47 - 061 - 01944
STATE COUNTY PERMIT

TRACT ID	SURFACE OWNER	LESSOR	PIN
33A	Robert L. Slider, et al	Larry Charles Taylor, individually and as trustee for the Generation-Skipping Trust FBO Larry Charles Taylor	1-9-1 1-9-1.1 1-9-1.3 1-9-1.4
		Samata Taylor-Sturm, a/k/a Dixie Taylor-Sturm and Michael Douglas Sturm, wife and husband	
		Linda Suzann Miller, individually and as trustee for the Generation-Skipping Trust FBO Linda Suzann Miller	
		Chrysanthe E. Taylor a/k/a Chris Taylor	
TRACT ID	SURFACE OWNER	LESSOR	PIN
33B	Joey A. Slider, et ux	Larry Charles Taylor, individually and as trustee for the Generation-Skipping Trust FBO Larry Charles Taylor	1-9-1.2
		Samata Taylor-Sturm, a/k/a Dixie Taylor-Sturm and Michael Douglas Sturm, wife and husband	
		Linda Suzann Miller, individually and as trustee for the Generation-Skipping Trust FBO Linda Suzann Miller	
		Chrysanthe E. Taylor a/k/a Chris Taylor	
TRACT ID	SURFACE OWNER	LESSOR	PIN
34	Consol Mining Company LLC	Jenny Lynn Clark and Philip E. Clark, w/h Clyde F. Hostutler and June Hostutler, h/w George W. Hostutler	1-9-2
TRACT ID	SURFACE OWNER	LESSOR	PIN
35	David Henderson, et ux	David Henderson and Gail Henderson, h/w	1-10-5
		Antero Resources Corporation	
		Kenneth Jeffrey Campbell	
		Robert William Campbell	
		Janice Kay Dorsey Whitaker	
		Janet Lynn Dorsey Stukins	
		James W. Dorsey	
		Daniel Bruce Booth, aka Daniel B. Booth	
		William Charles Booth, aka William C. Booth	
		David Lee Booth aka David L. Booth	
		Gary Arthur Kesteven	
		Wendy C. Hershey fka Wendy C. Kesteven	
		Gary Allan Booth	
		Judith Ann Booth Taylor aka Judy A. Taylor	
TRACT ID	SURFACE OWNER	LESSOR	PIN
51B	Monongalia County Coal Resources LLC	Wild Thing Barnstormers, LLC	1-2-1
		Accord Land Services, LLC	
		Stanhagen Legal LLC	
		MP&G Legacy Holding, LLC	
		Regina Schrimper	
		Latricia Estridge	
		Jon Walton	
		Ellis Shannon McCreadie	
		Sarah E. Roark, f/k/a Sarah E. McCreadie	
		Anna Marie Boortz	
		Virginia Smalley	
		Clareen Frances Gomez	
		Timothy Michael Kleinhenz and Verallen M. Kleinhenz,	
		Gregory Joseph Kleinhenz	
		Dora Irene Antel Six	
		Alice Clara Conwell, a/k/a Alice Clarie Conwell	
		Judith Six	
		Marjorie Oakley	
		David M. McCallum	
		Michael Stephen Kleinhenz	
		Mark Anthony Kleinhenz	
		Andrea Lee Chapman	
		Anthony Francis Kleinhenz	
		Carol Marie Murray	
		Barbara Ann Dillon	
		Linda Samuels	
		Jimmie Kyle Core	
		Donna DiPietrantonio, f/k/a Donna Romey	
		Wilma Arlene Coffey	
		Monongalia County Coal Company	

03/07/2025

TRACT ID	SURFACE OWNER	LESSOR	PIN
52B	Cucumber Tree Farm Inc.	Cucumber Tree Farm, Inc.	1-1-9
		Mountain V Oil and Gas, Inc.	
		Hayden Harper Energy Pennsylvania, LLC	
		Bluestone Energy Partners	
		Antero Resources Bluestone LLC	
		Antero Resources Appalachian Corporation	
		Energy Corporation of America	
		EQT Production Company	
TRACT ID	SURFACE OWNER	LESSOR	PIN
53	Cucumber Tree Farm Inc.	Cucumber Tree Farm, Inc.	1-1-9
		Mountain V Oil and Gas, Inc.	
		Hayden Harper Energy Pennsylvania, LLC	
		Bluestone Energy Partners	
		Antero Resources Bluestone LLC	
		Antero Resources Appalachian Corporation	
		Energy Corporation of America	
		EQT Production Company	
TRACT ID	SURFACE OWNER	LESSOR	PIN
54A	Frank G. Cox, Jr., et ux	Frank G. Cox, Jr.	1-1-6
		Amy Vandenberghe	
		Antero Resources Corporation	

03/07/2025