

- NOTES ON SURVEY**
1. COORDINATES SYSTEM IS UTM, NAD 83 DATUM, ZONE 17, U.S. FOOT AND WELL COORDINATES ESTABLISHED USING SURVEY GRADE GPS.
 2. SURFACE AND ROYALTY OWNER INFORMATION AND THEIR BOUNDARIES SHOWN HEREON WERE OBTAINED FROM INFORMATION PROVIDED BY CNX GAS COMPANY LLC AND TAX RECORDS.
 3. THIS PLAT DOES NOT REPRESENT A BOUNDARY SURVEY OF THE PARCELS SHOWN HEREON.
 4. NO DWELLINGS AND BUILDINGS WITHIN 625 FEET OF PROPOSED OF CENTER OF PAD.
 5. NO WATER WELLS OR DEVELOPED SPRINGS WITHIN 250 FEET OF PROPOSED WELL.
 6. NO PERENNIAL STREAMS, LAKES, PONDS, RESERVOIRS OR WETLANDS WITHIN 100 FEET OF THE LIMITS OF DISTURBANCE.
 7. NO NATURALLY PRODUCING TROUT STREAM WITHIN 300 FEET OF LIMITS OF DISTURBANCE.

- LEGEND**
- ⊕ Active Well
 - ⊕ Plugged Well Location
 - ⊕ Abandoned Well
 - ⊕ Future Use
 - ① Surface Tract Identification
 - Proposed Gas Well
 - ⊕ Located Corner, as noted
 - Surface Tract Lines
 - Reference Line
 - Match Line
 - Lease Boundary
 - Creek or Drain
 - State Line
 - ⑤ WV County Route
 - ⑤ WV State Route

See Page 3 For Surface Owners and Lessors

(⊕) Denotes Location of Well on United States Topographic Maps



I, the undersigned, hereby certify that this plat is correct to the best of my knowledge and belief and shows all the information required by law and the regulations issued and prescribed by the Department of Environmental Protection.

L. L. Rowe
L. L. S. 687



FILE NO: _____
DRAWING NO: _____
SCALE: 1" = 2000'
MINIMUM DEGREE OF ACCURACY: 1:2500
PROVEN SOURCE OF ELEVATION: NGS CORS Station



DATE: OCTOBER 24 20 24
OPERATORS WELL NO: _____
API WELL NO: 47 - 061 - 01948
STATE COUNTY PERMIT

WELL TYPE: OIL GAS LIQUID INJECTION WASTE DISPOSAL
(IF GAS) PRODUCTION: STORAGE DEEP SHALLOW
LOCATION ELEVATION: 1199' WATERSHED: Dunkard Creek QUADRANGLE: Wadestown
DISTRICT: Battelle COUNTY: Monongalia
SURFACE OWNER: Consol Mining Company LLC ACREAGE: 46.75 ±
ROYALTY OWNER: Bounty Minerals, LLC LEASE NO: 189033000 ACREAGE: 59.02 ±
PROPOSED WORK: DRILL CONVERT DRILL DEEPER FRACTURE OR STIMULATE PLUG OFF OLD FORMATION
 PERFORATE NEW FORMATION OTHER PHYSICAL CHANGE IN WELL (SPECIFY)
 PLUG AND ABANDON CLEAN OUT AND REPLUG TARGET FORMATION: Marcellus ESTIMATED DEPTH: TVD: 7,848'

WELL OPERATOR: CNX Gas Company LLC DESIGNATED AGENT: Anthony Kendziora
ADDRESS: 1000 Horizon Vue Drive ADDRESS: 111 Avondale Road
Canonsburg, PA 15317 Fairmont, WV 26554

AS-DRILLED

LATITUDE 39° 45' 00" BH: 4,445'

LONGITUDE 80° 22' 30" BH: 6,665'

WDTN18EHSM
CNX Gas Company LLC

WDTN18EHSM
AS-DRILLED
BOTTOM HOLE



500' WELL BORE BUFFER
SHOWING EXISTING WELLS

NOTES ON SURVEY

1. COORDINATES SYSTEM IS UTM, NAD 83 DATUM, ZONE 17, U.S. FOOT AND WELL COORDINATES ESTABLISHED USING SURVEY GRADE GPS.
2. SURFACE AND ROYALTY OWNER INFORMATION AND THEIR BOUNDARIES SHOWN HEREON WERE OBTAINED FROM INFORMATION PROVIDED BY CNX GAS COMPANY LLC AND TAX RECORDS.
3. THIS PLAT DOES NOT REPRESENT A BOUNDARY SURVEY OF THE PARCELS SHOWN HEREON.
4. NO DWELLINGS AND BUILDINGS WITHIN 625 FEET OF PROPOSED CENTER OF PAD.
5. NO WATER WELLS OR DEVELOPED SPRINGS WITHIN 250 FEET OF PROPOSED WELL.
6. NO PERENNIAL STREAMS, LAKES, PONDS, RESERVOIRS OR WETLANDS WITHIN 100 FEET OF THE LIMITS OF DISTURBANCE.
7. NO NATURALLY PRODUCING TROUT STREAM WITHIN 300 FEET OF LIMITS OF DISTURBANCE.

LEGEND

- Active Well
- Plugged Well Location
- Abandoned Well
- Future Use
- Surface Tract Identification
- Proposed Gas Well
- Located Corner, as noted
- Surface Tract Lines
- Reference Line
- Match Line
- Lease Boundary
- Creek or Drain
- State Line
- WV County Route
- WV State Route

See Page 3 For Surface Owners and Lessors

() Denotes Location of Well on United States Topographic Maps

AZ 325°01'28"
17,098'±



I, the undersigned, hereby certify that this plat is correct to the best of my knowledge and belief and shows all the information required by law and the regulations issued and prescribed by the Department of Environmental Protection.

T. L. S. 687
L. L. S. 687



FILE NO: _____
 DRAWING NO: _____
 SCALE: 1" = 2000'
 MINIMUM DEGREE OF ACCURACY: 1:2500
 PROVEN SOURCE OF ELEVATION: NGS CORS Station



DATE: OCTOBER 24 20 24
 OPERATORS WELL NO: _____
 API WELL NO: 47 - 061 - 01948
 STATE COUNTY PERMIT

WELL TYPE: OIL GAS LIQUID INJECTION WASTE DISPOSAL
 (IF GAS) PRODUCTION: STORAGE DEEP SHALLOW
 LOCATION ELEVATION: 1199' WATERSHED: Dunkard Creek QUADRANGLE: Wadestown
 DISTRICT: Battelle COUNTY: Monongalia
 SURFACE OWNER: Consol Mining Company LLC ACREAGE: 46.75 ±
 ROYALTY OWNER: Bounty Minerals, LLC LEASE NO: 189033000 ACREAGE: 59.02 ±
 PROPOSED WORK: DRILL CONVERT DRILL DEEPER FRACTURE OR STIMULATE PLUG OFF OLD FORMATION
 PERFORATE NEW FORMATION OTHER PHYSICAL CHANGE IN WELL (SPECIFY)
 PLUG AND ABANDON CLEAN OUT AND REPLUG TARGET FORMATION: Marcellus ESTIMATED DEPTH: TVD: 7,848'

WELL OPERATOR: CNX Gas Company LLC DESIGNATED AGENT: Anthony Kendziora
 ADDRESS: 1000 Horizon Vue Drive ADDRESS: 111 Avondale Road
 Canonsburg, PA 15317 Fairmont, WV 26554

AS-DRILLED

TRACT ID	SURFACE OWNER	LESSOR	PIN
9	Consol Mining Company LLC	Paul Reeder	1-9-33
		Consolidation Coal Company	
		CONSOL Mining Company LLC	
		CNX Resource Holdings LLC	
10	Consol Mining Company LLC	Eastern Associated Coal Corporation	1-9-37 1-9-38
12	Consol Mining Company LLC, et al	Ralph Six	1-9-39 1-9-39.1 1-9-39.2 1-9-39.3 1-9-39.4 1-9-39.5 1-9-39.6
		Antero Resources Corporation	
		Doris Margaret White	
		George Stephen Knight	
14	Curtis L Thomas, et ux	Curtis L. Thomas and Diana B. Thomas	1-9-40.3

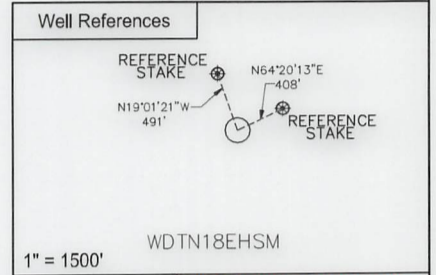
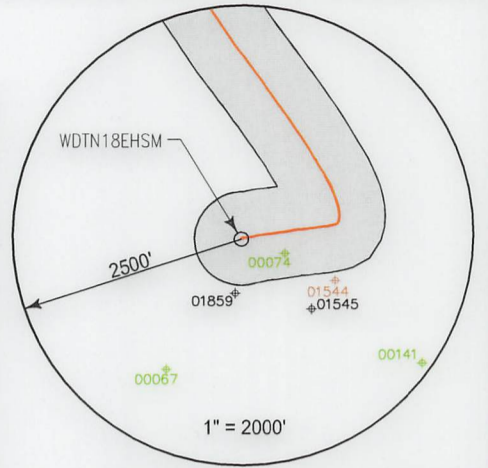

SURFACE HOLE LOCATION (SHL)

UTM 17 NAD 83
N: 4393673.371
E: 555024.121
NAD 83, WV NORTH
N: 434998.572
E: 1726982.506
LAT/LON DATUM NAD 83
LAT: 39°41'28.068"
LON: 80°21'29.771"
LANDING POINT
UTM 17 NAD 83
N: 4393943.129
E: 555261.785
NAD 83, WV NORTH
N: 435870.719
E: 1727777.161
LAT/LON DATUM NAD 83
LAT: 39°41'36.762"
LON: 80°21'19.712"

BOTTOM HOLE LOCATION (BHL)

UTM 17 NAD 83
N: 4398161.170
E: 552204.974
NAD 83, WV NORTH
N: 449879.340
E: 1717977.899
LAT/LON DATUM NAD 83
LAT: 39°43'54.267"
LON: 80°23'26.849"

WDTN18 WELL PAD

WDTN18AHSM ○○ WDTN18UHSM
WDTN18BHSM ○○ WDTN18EHSM
WDTN18CHSM ○○ WDTN18DHSM



I, the undersigned, hereby certify that this plat is correct to the best of my knowledge and belief and shows all the information required by law and the regulations issued and prescribed by the Department of Environmental Protection.

L. L. S. 687
L. L. S. 687



FILE NO: _____
DRAWING NO: _____
SCALE: 1" = 1000'
MINIMUM DEGREE OF ACCURACY: 1:2500
PROVEN SOURCE OF ELEVATION: NGS CORS Station

STATE OF WEST VIRGINIA
DEPARTMENT OF ENVIRONMENTAL PROTECTION
OIL AND GAS DIVISION



DATE: OCTOBER 24 20 24
OPERATORS WELL NO: _____
API WELL NO: 47 - 061 - 01948
STATE COUNTY PERMIT

WELL TYPE: OIL GAS LIQUID INJECTION WASTE DISPOSAL
(IF GAS) PRODUCTION: STORAGE DEEP SHALLOW
LOCATION ELEVATION: 1199' WATERSHED: Dunkard Creek QUADRANGLE: Wadestown
DISTRICT: Battelle COUNTY: Monongalia
SURFACE OWNER: Consol Mining Company LLC ACREAGE: 16.75 ±
ROYALTY OWNER: Bounty Minerals, LLC LEASE NO: 189033000 ACREAGE: 59.02 ±
PROPOSED WORK: DRILL CONVERT DRILL DEEPER FRACTURE OR STIMULATE PLUG OFF OLD FORMATION
 PERFORATE NEW FORMATION OTHER PHYSICAL CHANGE IN WELL (SPECIFY) _____
 PLUG AND ABANDON CLEAN OUT AND REPLUG TARGET FORMATION: Marcellus ESTIMATED DEPTH: TVD: 7,848'

WELL OPERATOR: CNX Gas Company LLC DESIGNATED AGENT: Anthony Kendziora
ADDRESS: 1000 Horizon Vue Drive ADDRESS: 111 Avondale Road
Canonsburg, PA 15317 Fairmont, WV 26554

03/07/2025

TRACT ID	SURFACE OWNER	LESSOR	PIN
15	Curtis L Thomas, et ux	Gail T. Bellucci	1-9-40.1
		Alma E. Kirkland Revocable Living Trust Agreement, Bank of Oklahoma N.A., Sole Successor Trustee	
		Sherry Lemons	
		Melissa Kubischke	
		Pamela Jayne Brewer, as Trustee of the Pamela Jayne Brewer Revocable Trust	
		Stephen D. Kirkland and Julie D. Kirkland, Trustees of the Kirkland Family Revocable Trust dated September 2, 1998	
		Louise Kirkland Berg	
		Christine A. Kirkland, as Trustee of the Christine A. Kirkland Trust	
		Catherine C. Kirkland	
		Ann W. Haning	
		Morgan Haning	
		Zachery Haning	
		Catherine Haning Coleman	
		Kathleen Farmer	
		A. E. Hennen III	
		John K. Hennen	
		David Michael Hennen	
		Mary Hennen	
		Robert Douglas Hennen	
		Sarah C. Sheridan	
		Curtis L. Thomas and Diana B. Thomas	
		Hugh Kirkland	
		Patrick Lee North, individually and as co-executor of the Edward Lee North Estate	
		Diane H. Goncalves, individually and as co-executor of the Edward Lee North Estate	
		Barbara Haning	
TRACT ID	SURFACE OWNER	LESSOR	PIN
17	Wolfpen Knob Development	Gail T. Bellucci	1-9-40.4
		Alma E. Kirkland Revocable Living Trust Agreement, Bank of Oklahoma N.A., Sole Successor Trustee	
		Sherry Lemons	
		Melissa Kubischke	
		Pamela Jayne Brewer, as Trustee of the Pamela Jayne Brewer Revocable Trust	
		Stephen D. Kirkland and Julie D. Kirkland, Trustees of the Kirkland Family Revocable Trust dated September 2, 1998	
		Louise Kirkland Berg	
		Christine A. Kirkland, as Trustee of the Christine A. Kirkland Trust	
		Catherine C. Kirkland	
		Ann W. Haning	
		Morgan Haning	
		Zachery Haning	
		Catherine Haning Coleman	
		Kathleen Farmer	
		A. E. Hennen III	
		John K. Hennen	
		David Michael Hennen	
		Mary Hennen	
		Robert Douglas Hennen	
		Sarah C. Sheridan	
		Hugh Kirkland	
		Patrick Lee North, individually and as co-executor of the Edward Lee North Estate	
		Diane H. Goncalves, individually and as co-executor of the Edward Lee North Estate	
		Barbara Haning	
		CNX Resource Holdings LLC	

03/07/2025

TRACT ID	SURFACE OWNER	LESSOR	PIN
18A	CNX RCPC LLC	Donna R. Hennen WOG Leasing, LLC	1-9-20
		Milan W. Cikovich, Jr. and Susan K. Cikovich, husband and wife EQT Production Company	
		Don Fordyce Betty Short Milan W. Cikovich, Jr. and Christine Michelle Park, individually and trustee of of the Amended and Restated Milan W. Cikovich Testamentary Trust F/B/O Francine R. Cikovich	
		Melissa Ann Hennen Limbaugh Linda S. Sansone Mildred Louise Walton Judy Kay Marshall, f/k/a Judy Kay Howard Mary Virginia Davis Karen S. Gray Helene M. Muetzel James R. Hennen, Jr. Cecil Hennen Roger L. Pratt Nelson James Hennen, Jr.	
		Clark H. Hennen Delores Ann Hennen Bryant Francis J. Waldron Hennen Ronald Fordyce James Cox Joseph Muto	
		Robert Morgan and Vickie Morgan Terra Firma Company CNX Land LLC	
TRACT ID	SURFACE OWNER	LESSOR	PIN
18B	CNX RCPC LLC	Kimeric and Company LLC Antero Resources Corporation	1-9-20
TRACT ID	SURFACE OWNER	LESSOR	PIN
24	Consol Mining Company LLC	Bounty Minerals, LLC	1-9-19
TRACT ID	SURFACE OWNER	LESSOR	PIN
25B	CNX RCPC LLC	Marsha W. Byers and Stephen R. Byers David C. White a/k/a David Charles White and Regina S. White a/k/a Regina Sue White Candace L. McPheron and Douglas A. McPheron Howard L. Leckey Lucy Mae Stickley Betty Ann Reed David Ray Stone Donald E. Stone Marian Rebecca Stone Garrett Patricia Kathaleen White Hoekstra Alvy Scott White Karen Imogene Meyer Robert S. Elliott Carol Sue Davis Edwin Ray White, II Melinda Reid Hatton Dennis F. Hatton Jr. Amanda Hatton Jane E. McIntyre and Glenn C. McIntyre Jan W. Ellison and Thomas A. Ellison Mary Ann Borkowski and Marc Borkowski Edith B. White Robert L. Tate, Jr. Nancy Emerick Doris Jean White Anita Susan Talbott Richard H. Benson, II Three Rivers Royalty II, LLC	1-9-9.6
		Frederick C. Tate	

03/07/2025

TRACT ID	SURFACE OWNER	LESSOR	PIN
26B	Kevin Hartley, et ux	Kevin Hartley and Linda Hartley	1-9-7
TRACT ID	SURFACE OWNER	LESSOR	PIN
26C	Kevin Hartley, et ux	Kevin Hartley and Linda Hartley	1-9-7
		Betty Carol Canan	
		Neil M. Canan	
TRACT ID	SURFACE OWNER	LESSOR	PIN
28	Paul David Beck, et al	Bounty Minerals, LLC	1-9-6 1-9-6.1 1-9-6.2
TRACT ID	SURFACE OWNER	LESSOR	PIN
37	Mike J. Prendergast, et ux	Mike J. Prendergast and Thelma M. Predergast	1-2-7
TRACT ID	SURFACE OWNER	LESSOR	PIN
41	Paul David Beck, et al	Bounty Minerals, LLC	1-2-8
TRACT ID	SURFACE OWNER	LESSOR	PIN
45	Consol Mining Company LLC	Aliakbar Afshari	1-2-5
		Amir H. Mohammadi	
		EQT Production Company	
		EQT Production Company	
		Flossie Kimble; Denzle Kimble and Olive Irene Wright Kimble	
		Consolidation Coal Company	
TRACT ID	SURFACE OWNER	LESSOR	PIN
46	Consol Mining Company LLC	Elkhorn Minerals, LLC	1-2-5
		Shuman Inc.	
		Noumenon Corporation	
		O-Max Coal Company	
		Flossie Kimble; Denzle Kimble and Olive Irene Wright Kimble	
		Consolidation Coal Company	
TRACT ID	SURFACE OWNER	LESSOR	PIN
48	Consol Mining Company LLC	Elkhorn Minerals, LLC	1-2-4
		James L. Taylor and DeEtta K. Taylor	
		Consolidation Coal Company	

03/07/2025