

WDTN18KHSM CNX Gas Company LLC		LATITUDE 39° 42' 30" TH: 7,030'	
		LONGITUDE 80° 20' 00" TH: 6,465'	
<b>NOTES ON SURVEY</b> 1. COORDINATES SYSTEM IS UTM, NAD 83 DATUM, ZONE 17, U.S. FOOT AND WELL COORDINATES ESTABLISHED USING SURVEY GRADE GPS. 2. SURFACE AND ROYALTY OWNER INFORMATION AND THEIR BOUNDARIES SHOWN HEREON WERE OBTAINED FROM INFORMATION PROVIDED BY CNX GAS COMPANY LLC AND TAX RECORDS. 3. THIS PLAT DOES NOT REPRESENT A BOUNDARY SURVEY OF THE PARCELS SHOWN HEREON. 4. NO DWELLINGS AND BUILDINGS WITHIN 625 FEET OF PROPOSED OF CENTER OF PAD. 5. NO WATER WELLS OR DEVELOPED SPRINGS WITHIN 250 FEET OF PROPOSED WELL. 6. NO PERENNIAL STREAMS, LAKES, PONDS, RESERVOIRS OR WETLANDS WITHIN 100 FEET OF THE LIMITS OF DISTURBANCE. 7. NO NATURALLY PRODUCING TROUT STREAM WITHIN 300 FEET OF LIMITS OF DISTURBANCE.			
<b>LEGEND</b> Active Well Proposed Well Location Future Use Surface Tract Identification Proposed Gas Well Located Corner, as noted --- Surface Tract Lines --- Reference Line --- Match Line --- Lease Boundary --- Creek or Drain --- State Line WV County Route WV State Route		<b>See Detail A Sheet 3</b> <b>See Page 4 For Surface Owners and Lessors</b> (  ) Denotes Location of Well on United States Topographic Maps	
		<p>I, the undersigned, hereby certify that this plat is correct to the best of my knowledge and belief and shows all the information required by law and the regulations issued and prescribed by the Department of Environmental Protection.</p> <p></p> <p>L. L. S. 2394</p>	
FILE NO: DRAWING NO: SCALE: 1" = 2000' MINIMUM DEGREE OF ACCURACY: 1:2500 PROVEN SOURCE OF ELEVATION: NGS CORS Station		DATE: OCTOBER 16 20 25 OPERATORS WELL NO: API WELL NO 47 - 061 - 02003 STATE COUNTY PERMIT	
WELL TYPE: <input type="checkbox"/> OIL <input checked="" type="checkbox"/> GAS <input type="checkbox"/> LIQUID INJECTION <input type="checkbox"/> WASTE DISPOSAL (IF GAS) PRODUCTION: <input type="checkbox"/> STORAGE <input type="checkbox"/> DEEP <input checked="" type="checkbox"/> SHALLOW LOCATION ELEVATION: 1199' WATERSHED: Dunkard Creek QUADRANGLE: Wadestown DISTRICT: Battelle COUNTY: Monongalia SURFACE OWNER: Consol Mining Company LLC ACREAGE: 46.75 ± ROYALTY OWNER: Bounty Minerals, LLC LEASE NO: 189033000 ACREAGE: 59.02 ± PROPOSED WORK: <input checked="" type="checkbox"/> DRILL <input type="checkbox"/> CONVERT <input type="checkbox"/> DRILL DEEPER <input checked="" type="checkbox"/> FRACTURE OR STIMULATE <input type="checkbox"/> PLUG OFF OLD FORMATION <input type="checkbox"/> PERFORATE NEW FORMATION <input type="checkbox"/> OTHER PHYSICAL CHANGE IN WELL (SPECIFY) <input type="checkbox"/> PLUG AND ABANDON <input type="checkbox"/> CLEAN OUT AND REPLUG TARGET FORMATION: Marcellus ESTIMATED DEPTH: TVD: 7,847' WELL OPERATOR: CNX Gas Company LLC DESIGNATED AGENT: Anthony Kendziora ADDRESS: 1000 Horizon Vue Drive ADDRESS: 111 Avondale Road Canonsburg, PA 15317 Fairmont, WV 26554			

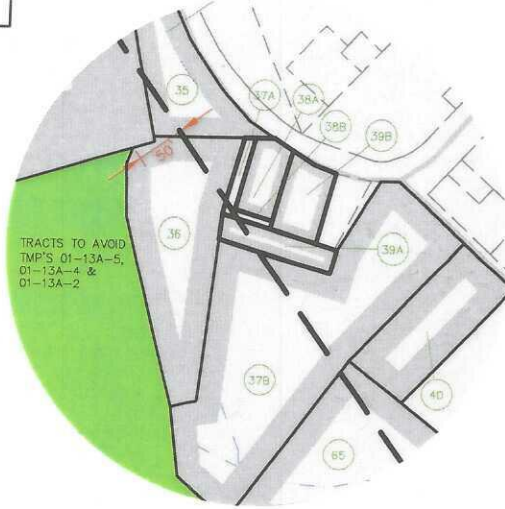

WDTN18KHSM CNX Gas Company LLC		LATITUDE 39° 40' 00" BH: 7,175'	
		AZ 145°00'00" 17,542±	
See Detail A Sheet 3		500' WELL BORE BUFFER SHOWING EXISTING WELLS	
<b>NOTES ON SURVEY</b> 1. COORDINATES SYSTEM IS UTM, NAD 83 DATUM, ZONE 17, U.S. FOOT AND WELL COORDINATES ESTABLISHED USING SURVEY GRADE GPS. 2. SURFACE AND ROYALTY OWNER INFORMATION AND THEIR BOUNDARIES SHOWN HEREON WERE OBTAINED FROM INFORMATION PROVIDED BY CNX GAS COMPANY LLC AND TAX RECORDS. 3. THIS PLAT DOES NOT REPRESENT A BOUNDARY SURVEY OF THE PARCELS SHOWN HEREON. 4. NO DWELLINGS AND BUILDINGS WITHIN 625 FEET OF PROPOSED CENTER OF PAD. 5. NO WATER WELLS OR DEVELOPED SPRINGS WITHIN 250 FEET OF PROPOSED WELL. 6. NO PERENNIAL STREAMS, LAKES, PONDS, RESERVOIRS OR WETLANDS WITHIN 100 FEET OF THE LIMITS OF DISTURBANCE. 7. NO NATURALLY PRODUCING TROUT STREAM WITHIN 300 FEET OF LIMITS OF DISTURBANCE.		Matchline Sheet 1 Matchline Sheet 2	
<b>LEGEND</b> Active Well Proposed Gas Well Future Use Surface Tract Identification Proposed Gas Well Located Corner, as noted Surface Tract Lines Reference Line Match Line Lease Boundary Creek or Drain State Line WV County Route WV State Route		See Page 4 For Surface Owners and Lessors	
		( ) Denotes Location of Well on United States Topographic Maps	
I, the undersigned, hereby certify that this plat is correct to the best of my knowledge and belief and shows all the information required by law and the regulations issued and prescribed by the Department of Environmental Protection.			
FILE NO: DRAWING NO: SCALE: 1" = 2000' MINIMUM DEGREE OF ACCURACY: 1:2500 PROVEN SOURCE OF ELEVATION: NGS CORS Station		STATE OF WEST VIRGINIA DEPARTMENT OF ENVIRONMENTAL PROTECTION OIL AND GAS DIVISION	
WELL TYPE: <input type="checkbox"/> OIL <input checked="" type="checkbox"/> GAS <input type="checkbox"/> LIQUID INJECTION <input type="checkbox"/> WASTE DISPOSAL (IF GAS) PRODUCTION: <input type="checkbox"/> STORAGE <input type="checkbox"/> DEEP <input checked="" type="checkbox"/> SHALLOW LOCATION ELEVATION: 1199' WATERSHED: Dunkard Creek QUADRANGLE: Wadestown DISTRICT: Battelle COUNTY: Monongalia SURFACE OWNER: Consol Mining Company LLC ACREAGE: 46.75 ± ROYALTY OWNER: Bounty Minerals, LLC LEASE NO: 189033000 ACREAGE: 59.02 ± PROPOSED WORK: <input checked="" type="checkbox"/> DRILL <input type="checkbox"/> CONVERT <input type="checkbox"/> DRILL DEEPER <input checked="" type="checkbox"/> FRACTURE OR STIMULATE <input type="checkbox"/> PLUG OFF OLD FORMATION <input type="checkbox"/> PERFORATE NEW FORMATION <input type="checkbox"/> OTHER PHYSICAL CHANGE IN WELL (SPECIFY) <input type="checkbox"/> PLUG AND ABANDON <input type="checkbox"/> CLEAN OUT AND REPLUG TARGET FORMATION: Marcellus ESTIMATED DEPTH: TVD: 7,847'		DATE: OCTOBER 16 20 25 OPERATORS WELL NO: API WELL NO 47 - 061 - 02003 STATE COUNTY PERMIT	
WELL OPERATOR: CNX Gas Company LLC ADDRESS: 1000 Horizon Vue Drive Canonsburg, PA 15317		DESIGNATED AGENT: Anthony Kendziora ADDRESS: 111 Avondale Road Fairmont, WV 26554	





DETAIL A  
1" = 200'

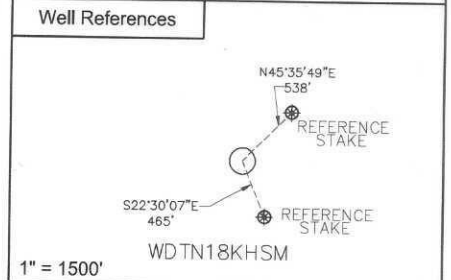
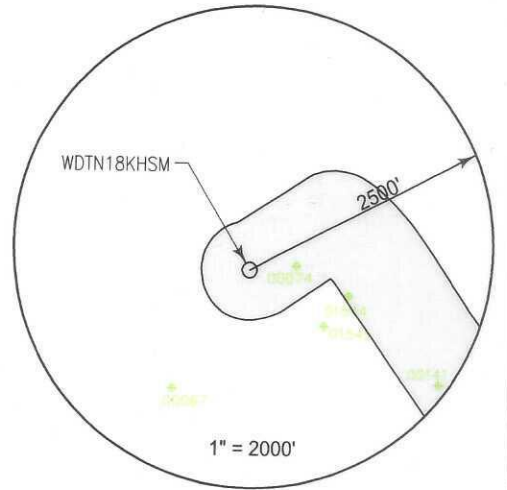

SURFACE HOLE LOCATION (SHL)

UTM 17 NAD 83  
N: 4393612.54  
E: 555020.24  
NAD 83, WV NORTH  
N: 434799.170  
E: 1726966.429  
LAT/LON DATUM NAD 83  
LAT: 39°41'26.095"  
LON: 80°21'29.953"

LANDING POINT

UTM 17 NAD 83  
N: 4393630.63  
E: 555445.00  
NAD 83, WV NORTH  
N: 434835.237  
E: 1728361.228  
LAT/LON DATUM NAD 83  
LAT: 39°41'26.583"  
LON: 80°21'12.114"

WDTN18 WELL PAD

BOTTOM HOLE LOCATION (BHL)

WDTN18HHSM ○ ○ WDTN18JHSM  
WDTN18GHSM ○ ○ WDTN18KHSM  
WDTN18FHSM ○ ○ WDTN18VHSM

UTM 17 NAD 83  
N: 4389303.84  
E: 558583.44  
NAD 83, WV NORTH  
N: 420465.406  
E: 1738422.424  
LAT/LON DATUM NAD 83  
LAT: 39°39'05.490"  
LON: 80°19'01.736"



I, the undersigned, hereby certify that this plat is correct to the best of my knowledge and belief and shows all the information required by law and the regulations issued and prescribed by the Department of Environmental Protection.

L. L. S. 2394

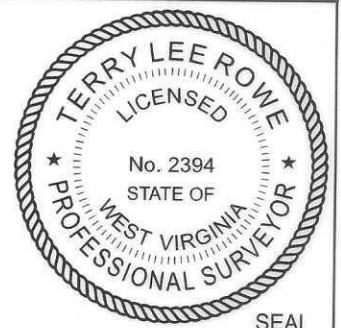

STATE OF WEST VIRGINIA  
DEPARTMENT OF ENVIRONMENTAL PROTECTION  
OIL AND GAS DIVISION

FILE NO:  
DRAWING NO:  
SCALE: 1" = 1000'  
MINIMUM DEGREE OF ACCURACY:  
1:2500  
PROVEN SOURCE OF ELEVATION:  
NGS CORS Station

DATE: OCTOBER 16 20 25  
OPERATORS WELL NO:  
API WELL NO  
47 - 061 - 02003  
STATE COUNTY PERMIT

WELL TYPE: ☐ OIL ☒ GAS ☐ LIQUID INJECTION ☐ WASTE DISPOSAL  
(IF GAS) PRODUCTION: ☐ STORAGE ☐ DEEP ☒ SHALLOW  
LOCATION ELEVATION: 1199' WATERSHED: Dunkard Creek QUADRANGLE: Wadestown  
DISTRICT: Battelle COUNTY: Monongalia  
SURFACE OWNER: Consol Mining Company LLC ACREAGE: 46.75 ±  
ROYALTY OWNER: Bounty Minerals, LLC LEASE NO: 189033000 ACREAGE: 59.02 ±  
PROPOSED WORK: ☒ DRILL ☐ CONVERT ☐ DRILL DEEPER ☒ FRACTURE OR STIMULATE ☐ PLUG OFF OLD FORMATION  
☐ PERFORATE NEW FORMATION ☐ OTHER PHYSICAL CHANGE IN WELL (SPECIFY)  
☐ PLUG AND ABANDON ☐ CLEAN OUT AND REPLUG TARGET FORMATION: Marcellus ESTIMATED DEPTH: TVD: 7,847'

WELL OPERATOR: CNX Gas Company LLC DESIGNATED AGENT: Anthony Kendziora  
ADDRESS: 1000 Horizon Vue Drive ADDRESS: 111 Avondale Road  
Canonsburg, PA 15317 Fairmont, WV 26554

TRACT ID	SURFACE OWNER	LESSOR	PIN
1	Consol Mining Company LLC	Eastern Associated Coal Corporation	1-9-38 1-9-37
2	Consol Mining Company LLC, et al	Ralph Six	1-9-39 1-9-39.1 1-9-39.2 1-9-39.3 1-9-39.4 1-9-39.5 1-9-39.6
		Antero Resources Corporation	
		Doris Margaret White	
		George Stephen Knight	
6A	CONSOL Mining Company LLC	Virgie Shriver, et al	1-12-8
		Eastern Associated Coal Corp.	
		CNX Gas Company LLC	
		Consolidation Coal Company	
6B	CONSOL Mining Company LLC	Virgie Shriver, et al	1-12-8
		Eastern Associated Coal Corp.	
		CNX Gas Company LLC	
		Consolidation Coal Company	
19A	Ralph Six	Bounty Minerals, LLC	1-12-9
		Bounty Minerals III Acquisitions, LLC	
		LOLA Drilling 1, LLC	
		Rice Drilling B, LLC	
		Rice Drilling B, LLC	
		SWS Holding LLC	
19B	Ralph Six	Bounty Minerals, LLC	1-12-9
		Bounty Minerals III Acquisitions, LLC	
		LOLA Drilling 1, LLC	
		Rice Drilling B, LLC	
		Rice Drilling B, LLC	
19F	Ralph Six, et al	Bounty Minerals, LLC	1-12-9 1-12-9.1 1-13-2
		Bounty Minerals III Acquisitions, LLC	
		LOLA Drilling 1, LLC	
		Rice Drilling B, LLC	
		Rice Drilling B, LLC	
30	Clarence E. Park, et ux	Clarence Earl Park and Linda Sue Park, husband and wife	1-13-3
31	John and Joann King Irrevocable Trust	Debra Lynn Lundgren	1-13-7
		EQT Production Company	
32	West Warren Baptist Church, et al	West Warren Baptist Church by its Trustees, Greg Shriver, Norman Core, and Tom Sanders	1-13A-6 1-13A-7 1-13A-7.1
35	Deken Wilson	Deken Wilson	1-13A-17
36	Timothy E. Russell, et ux	Donald L. White and Linda L. White, Husband and Wife	1-13A-21
37A	John and Joann King Irrevocable Trust	John King and Joann King, Husband and Wife	1-13A-21.1
37B	John and Joann King Irrevocable Trust	John King and Joann King, Husband and Wife	1-13A-21.1
38A	CNX Gas Company LLC	EDWIN RIFFLE, Trustee; LAWRENCE L. COOL, III, Trustee; and JOHN DUGAN, SR., Trustee; as Trustees of the MONONGALIA LODGE NO. 10, I.O.O.F., Controller of the CRUSADER LODGE NO. 422, I.O.O.F., and as Authorized Representatives for the GOLDEN GLOW REBEKAH LODGE NO. 299	1-13A-18
38B	CNX Gas Company LLC	EDWIN RIFFLE, Trustee; LAWRENCE L. COOL, III, Trustee; and JOHN DUGAN, SR., Trustee; as Trustees of the MONONGALIA LODGE NO. 10, I.O.O.F., Controller of the CRUSADER LODGE NO. 422, I.O.O.F., and as Authorized Representatives for the GOLDEN GLOW REBEKAH LODGE NO. 299	1-13A-18
39A	CNX Gas Company LLC	Roy L. Hall and Victoria J. Hall, husband and wife	1-13A-21.2
39B	CNX Gas Company LLC	Roy L. Hall and Victoria J. Hall, husband and wife	1-13A-19
40	John L. Miller, et ux	John L. Miller a/k/a Johnie L. Miller and Karen E. Miller a/k/a Karen Miller, husband and wife	1-13A-22
59	Daniel Altfather, et ux	Daniel Altfather and Sandra Barr Altfather, husband and wife	1-13-18.3
60	Brent Delaney, et al	Chad Delaney, a/k/a, Chad Allen Delaney Brent Delaney, a/k/a, Brent E. Delaney	1-13-18
		Dathan Lee Cottrill a/k/a Dathan Cottrill	
		Dacia M. Cottrell Fletcher a/k/a Dacia M. Cottrill Fletcher	
		Samara Jo Wesley a/k/a Samara Wesley f/k/a Samara Jo Cottrell Gump a/k/a	
		Angela Lemley f/k/a Angela Ione Echard	
		Northeast Natural Energy LLC	

11/07/2025



TRACT ID	SURFACE OWNER	LESSOR	PIN
65	John L. Miller, et ux	John L. Miller a/k/a Johnie L. Miller and Karen E. Miller a/k/a Karen Miller, husband and wife	1-13A-23
TRACT ID	SURFACE OWNER	LESSOR	PIN
66	Jessica L. Waddell, et al	Bounty Minerals LLC	1-13-11
TRACT ID	SURFACE OWNER	LESSOR	PIN
88	Gary W. Berkshire, et ux	West Warren Baptist Church by its Trustees, Greg Shriver, Norman Core, and Tom Sanders WVTD LLC	1-13-12
TRACT ID	SURFACE OWNER	LESSOR	PIN
89	Justin P. Walls, et ux	Debra L. Frazier and Bradley S. Frazier, her husband Terrance W. Mason and Joy L. Mason, his wife John Richard Hockenberry and Kathy Jo Hockenberry, his wife Brenda Michael Diane M. Morris Kathy Morgan n/k/a Kathy Sheehan Thomas L. Austin and Simona Austin, his wife Eugene Herrmann a/k/a Eugene Herrmann Jr. Maryjean Herrmann Kathy Chesney a/k/a Kathy B. Chesney Lori Mendiola Rodana D. Gorman Raymond Stiles Tammarra L. Mordecki and James Mordecki, her husband Paul Herrmann a/k/a Paul J. Herrmann Sr., and Mary Alice Herrmann, his wife Walter Kevin Huffman Linda D. Herrmann Franklin David Hockenberry a/k/a David Hockenberry and Debra S. Hockenberry, his wife Shari L. Rush Sharon Fox Bishop f/k/a Sharon Lynn Perkins Nancy Jo Perkins Sandra Lee Woods DWG Oil and Gas Acquisitions, LLC Jyll E. Park Linda L. Redmond Jimmie Wayne Redmond Barbara Joann Bowers Michael Joseph Bowers II a/k/a Michael Joseph Bowers Thomas Sollars and Martha Sollars, his wife Kelli Dawn Meeks Robert Yeater Seth Rush Stephen Franklin Bowers Timothy P. Hockenberry Lewis Lyn Mason Debra N. Straight Jami L. Wagner Jason Eric Straight Jimmy Douglas Straight, II Virginia Marie Griffin Michael Hockenberry Alan Howard Joyce Ann Hebb a/k/a Joyce Hebb James Jay Vassalo Melanie Marie Embry f/k/a Melanie Myers Key f/k/a Melanie Marie Myers f/k/a Melanie Myers Judith Ann Munkittrick Paulette Park Zachary L. Mason Gregory C. Mason Suzanne D. Cilliers Laura A. Mason Mark W. Mason Donna Tennant Lavere J. Mason Revocable Trust Northeast Natural Energy LLC Joyce Ann Hebb and Harold H. Hebb, her husband Deborah M. Murray and Ronald W. Murray, her husband Patricia A. Salvatore and Joseph E. Salvatore, her husband Connie C. Sutton Donna C. Miller Quentin Dale Knight Mark Howard Brad Howard and Mary Howard, his wife Brian Howard John D. Stiles a/k/a John Donley Stiles and Frances B. Stiles, his wife Josephine S. Rush and Zane Rush, her husband Clark Donley Stiles Gina Lou Smith Beth Ann Stiles Rouse Diane Marie Myers Pamela Poling and Richard A. Poling, her husband Margaret Anne Stiles Frank Donley Vassalo and Dorothy M. Vassalo, his wife Anita Kay Furfari and Nicholas Furfari, her husband Northeast Natural Energy LLC	1-13-14

11/07/2025



TRACT ID	SURFACE OWNER	LESSOR	PIN
90	Daniel Altfather, et ux	Sandra Barr, a/k/a Sandra Barr-Altfather and Daniel Altfather	1-13-13
TRACT ID	SURFACE OWNER	LESSOR	PIN
91	Donzel Walls, et al	Donzell Walls and Diana J. Walls, husband and wife	1-13-13 1-13-17
		CNG Producing Company	
		Dominion Exploration & Production, Inc.	
		Antero Resources Appalachian Corporation	
		Dominion Exploration & Production, Inc.	
		Consol Gas Company	
		Kathryn Rew Becker and Michael Compton, wife and husband	
TRACT ID	SURFACE OWNER	LESSOR	PIN
92	CNX RCPC LLC	Terrance W. Mason	1-13-15 1-13-15.1 1-13-15.2 1-13-15.3
		Debra L. Frazier	
TRACT ID	SURFACE OWNER	LESSOR	PIN
99A	Betty S. Baird	William E. King and M. Cynthia Barnhart, Trustees of the John and Joann King Irrevocable Trust dated December 19, 2019	1-18-3
		Masonic Charity Foundation of Oklahoma f/k/a Most Worshipful Grand Lodge of Ancient Free and Accepted Masons of the State of Oklahoma	
		Northeast Natural Energy LLC	
		EQT Production Company	
TRACT ID	SURFACE OWNER	LESSOR	PIN
99B	Beverly Brower, et al	William E. King and M. Cynthia Barnhart, Trustees of the John and Joann King Irrevocable Trust dated December 19, 2019	1-13-16 1-13-16.1 through 1-13-16.9 1-13-16.11 through 1-13-16.15 1-13-16.17
		Masonic Charity Foundation of Oklahoma f/k/a Most Worshipful Grand Lodge of Ancient Free and Accepted Masons of the State of Oklahoma	
		Northeast Natural Energy LLC	
		Northeast Natural Energy LLC	
		EQT Production Company	
TRACT ID	SURFACE OWNER	LESSOR	PIN
102	Michael W. Godby	EQT Production Company; Rice Drilling B, LLC	1-18-21
		Betty G. Mason, a widow	
		Margaret S. Ater and David A. Ater, wife and husband	
		Richard M. Snow	
		Robert A. Snow	
TRACT ID	SURFACE OWNER	LESSOR	PIN
104	Vernon L. Toothman, et ux	Vernon L. Toothman and Deborah J. Toothman, his wife	1-18-22
		LOLA Drilling I, LLC	
		Rice Drilling B LLC	
TRACT ID	SURFACE OWNER	LESSOR	PIN
105	Betty S. Baird	Northeast Natural Energy LLC	1-18-23.3
		EQT Production Company	
TRACT ID	SURFACE OWNER	LESSOR	PIN
126	Thomas E. Walker, et ux	William F. Reeder	1-18-40
		James B. Reeder	
		Margaret R. Ferguson, by her Attorney-in-Fact, Stephen Berkley Ferguson	
		Susan Reeder Ruffatto	
		Thomas Bradley Reeder, Trustee of the Reeder Living Trust of 2008	
		Carolyn R. Greiner, Trustee of the Carolyn R. Greiner Trust of 1999	
		Louise Reeder Seeton, Trustee of the Louise Reeder Seeton Trust, created August 17, 1993	
		Northeast Natural Energy LLC	
TRACT ID	SURFACE OWNER	LESSOR	PIN
128A	Raymond Benner, et ux	Shuman, Inc.	1-18-42
		NNE Properties II LLC	
		Ridgetop Appalachia LLC	
		Frank J. Failla, Jr.	
		Sam Failla	
		Bernice T. Cook	
		The Geraldine Holmes Living Trust	
		Elizabeth Gaylene Owen	
		Janice Harris	
		Amanda Hollis	
		Kathy Ferguson Tidd	
		Peter R. Roseberry	
		Marlene L. Shirey a/k/a Marlene Shirey	
		Richard L. Sharp	
		Larene Welch	
		Stephen L. Welch and Ellen B. Welch	
		Sonya R. Shrum	
		Miles Lee Holcomb, a/k/a Miles Lee Halcomb	
		Unknown Heirs and Assigns of Gary D. Tennant	
		Roberta Ann Diggs Herman	
		Northeast Natural Energy LLC	
		Equinor USA Onshore Properties Inc.	
		Northeast Natural Energy LLC	
		NNESP LLC	
		Northeast Natural Energy LLC	

11/07/2025

TRACT ID	SURFACE OWNER	LESSOR	PIN
129	Betty J. Martino	Roger D. Cole	1-18-43
		Gwendolyn J. Ketchum	
		Kenneth R. Tennant	
		Kurt W. Tennant	
		Tamara S. Roberts	
		Carl Kinder	
		Shirley Tennant Jautz	
		Janice Stutzman	
		Patricia Lee Van Gorder	
		Connie Horneker	
		Susan Dickey	
		Heirs and Assigns of Arlie J. Tennant, Jr.	
		Holly Lynn McCoy a/k/a Holly Lynn McCoy Nelson and Brett Nelson, wife and husband	
		James W. Tennant Irrevocable Supplemental Needs Trust, by Susan Dickey, Trustee	
		Northeast Natural Energy LLC	
		AMP IV, LP	
		CNX Gas Company LLC	
		Northeast Natural Energy LLC	
		Northeast Natural Energy LLC	

11/07/2025