

Map showing the location of Well No. 1 of
 Orrin C. Hoffman of Maynashburg, Va. and
 adjacent to the Alpha's Sink Farm of the
 same, located in Clay District, Mississippi County.

May 20 1888

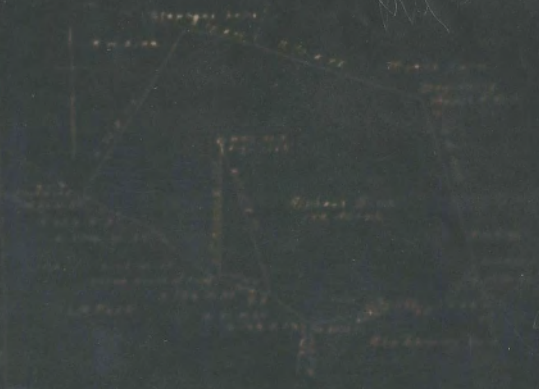

DECLARATION

I, the undersigned, hereby certify that this map was prepared by me, or under my supervision, and that the same is a true and correct copy of the original map on file in the office of the County Clerk of Mississippi County, Missouri.

W. J. [Signature]

Witness my hand and seal of office this 20th day of May, 1888, at the City of Springfield, Missouri.

W. J. [Signature]

1888

Clay District, Monongalia County, W. Va.

By Orran C. Hoffman, 716 N. West St., Waynesburg, Pa.

On 149 acres, surface owned by Reeves W. Sine, Blacksville, W. Va.,
and mineral rights by Henry A. Phillips, Pittsburgh, Pa.

Drilling begun fall of 1919.

Elevation, 1262'.

12" conductor; 10" casing, 927'; 8½", 1717'; 6", 2156'.

Coal was encountered at 815-820 and 912-919'.

No liner used.

Abandonment reported to Dept. of Mines Jan. 21, 1933.

Well was not shot.

Producing hole.

MON-56-A

	Top.	Bottom.	Thickness.
Bluff Sand	489	- 529	40
Mapletown (Sewickley) Coal	815	- 820	5
Pittsburgh Coal	912	- 919	7
Little Dunkard Sand	1250	- 1265	15
Big Dunkard Sand	1478	- 1530	52
Salt Sand	1716	- 1955	239
Big Lime	2148	- 2200	52
Big Injun Sand	2200	- 2345	145

WEST VIRGINIA DEPARTMENT OF MINES

OIL AND GAS DIVISION

PRELIMINARY DATA SHEET NO. 1

File No. _____ Well No. 3
Orran C. Hoffman owner of 716 N. West St. Waynesburg, Pa.as the Alpheus Sine Farm
containing 149 acres. Location Blacksville P.O.Clay District, in Manangaka county, West VirginiaThe surface of the above tract is owned in fee by Reeves W. Sine
of Blacksville, W. Va. address, and the mineral rights are owned byHenry A Phillips - Pittsburgh, Pa.The oil and gas privileges are held under lease by the above named company, and this well is drilled under grant
No. _____ issued by the West Virginia Department of Mines, Oil and Gas DivisionDrilling begun - Fall of 1919Elevation of surface at top of well 1262 ft.

The number of feet of the different steel casings used in the well.

_____ 12 feet. _____ feet. _____ feet._____ 927 feet. 10° dip, top _____ feet. 1717 feet. 8'4" steel top_____ 2156 feet. 6° dip, top _____ feet. _____ feet. _____ feet.

_____ feet. _____ dip, top _____ feet. _____ feet. _____ feet.

_____ feet. _____ dip, top _____ feet. _____ feet. _____ feet.

_____ feet. _____ dip, top _____ feet. _____ feet. _____ feet.

_____ feet. _____ dip, top _____ feet. _____ feet. _____ feet.

_____ feet. _____ dip, top _____ feet. _____ feet. _____ feet.

Coal was encountered at _____ 815 feet. thickness _____ 60 inches, and at _____ 912feet. thickness _____ 24 inches, and at _____ feet. thickness _____ inches.

Jan 21 - 1933By Orran C. Hoffman

Orren C. Hoffman Company
 716 H. West St. Address
 Waynesburg - Pa. City

COMPLETION DATA SHEET
 No. 2
 FORMATION RECORD

Name	Color	Character	Oil, Gas or Water	Top	Bottom	Thickness	Test Depth	Remarks
Bluff Sand				489	529	40	529	
Mapletown Coal				815	820	5	820	
Pittsburgh Coal				912	919	7	919	
Little Dunkard				1250	1265	15	1265	
Big Dunkard				1478	1530	52	1530	
Salt Sand				1716	1955	239	1955	
Big Lime				2148	2200	52	2200	
Big Injun				2300	2395	95	2395	

Well was first drilled on _____ and was first completed on _____

First water at _____ and first oil at _____

Well was completed on _____

Well No. 100-21-1932 _____ Orren C. Hoffman

NOTE: All entries on this form should be made in ink and should be made as soon as possible after the completion of the well. This form should be filed in the well log book.

PROPOSED MANNER OF PLUGGING AND FILLING WELL
(SUBJECT TO RULES AND REGULATIONS)

WEST VIRGINIA DEPARTMENT OF MINES
OIL AND GAS DIVISION

WORK ORDER

Well to be plugged and filled as follows:

Depth of well 2345 ft.

Big Tatum Sand 2345 ft to 2200 ft. Mud filled thru this sand and a wood then a cement plug placed at top.

High lime 2200 ft to 2148 ft. Mud filled up to a point 20' above High lime; cement plug at this point.

Salt Sand 1955 ft to 1716 ft. Bridge at 1985 ft (30' below Salt Sand) and fill with mud up to 1696 ft (20' above Salt Sand); cement plug at this point. Mud filled to 957 ft.

Pgh. coal 919 ft to 912 ft. Cement from 940 ft to 892 ft (from 30' below to 20' above Pgh. coal). Mud filled up to 857 ft.

Sewakly Coal 820 ft to 815 ft. Cement from 857 ft to 795 ft (from 30' below to 20' above Sewakly Coal) Mud filled from 795 ft to top of hole.

To the Department of Mines,
Coal Office at Charleston,
West Virginia.

Concrete markers created as per rule 18 of 1931 regulations.

Comments:

This "work order" is submitted for your approval and acceptance and when accepted of you the approval of acceptance, the endorsement will proceed with the plugging and filling of well and to the above described manner as the date stated in the notice of intention to plug and abandon the well and on opposite side of this sheet.

Very truly yours,

Oran C. Hoffman

No signature has been filed by the well owner or well operator, or any suitable person having or assuming to be authorized by the Department of Mines to the manner herein described for the plugging and filling of the well above mentioned. Therefore, the same is hereby approved this _____ day of _____, 1931.

DEPARTMENT OF MINES
Oil and Gas Division

By: J. D. Goolie

NOTE: This "work order" must be filed by duplicate, one copy for the file of the Department of Mines and the other to be returned to applicant and returned to the well owner for the file of the Department of Mines and the

NOTICE OF INTENTION TO PLUG AND ABANDON WELL
 PROVIDED BY SECTION 4, ARTICLE 4, CHAPTER 20 OF THE CODE
 WEST VIRGINIA DEPARTMENT OF MINES
 COL. AND GEAR DIVISION

To the Representatives or Heirs,
 Charleston, W. Va.

<u>Henry A. Phillips</u>	<u>O. C. Hoffman</u>
<u>Mellon Nat'l Bank - Pgh., Pa.</u>	<u>716 N. West St. - Hagerstown, Pa.</u>
_____	<u>Jan 21 - 1933</u>
_____	WELL TO BE ABANDONED
_____	<u>Clay</u> State
<u>Brown Sine</u>	<u>Marrangake</u> Co.
_____	W. Va. <u>3</u>
<u>Blacksmith - W. Va.</u>	<u>Alphew Sine</u> Co.

Ordinance—

The undersigned well operator is about to abandon the above described well and will commence the

work of plugging and abandoning said well on the 20th day of January, 1933.
 (This date shall not be less than five days after the day on which this notice is mailed, or in the event should be received by the Department of Mines.)

This notice is given you in order that your respective representatives may be present at the plugging and filling of said well. You are further notified that whether you are represented or not represented, the undersigned will proceed on that date, or shortly thereafter, to plug and fill said well in the manner required by Section 4, Article 4, Chapter 20 of the Code and given in detail on the reverse side of this notice, in "Well Code."

This notice is being mailed by registered mail to each of you at the above addresses on the above date.

Very truly yours,

Oscar C. Hoffman

THE DEPARTMENT OF MINES, WEST VIRGINIA DEPARTMENT OF MINES, COL. AND GEAR DIVISION

1.3/20