

LATITUDE 39° 42' 30"

121° 30'

LONGITUDE

75'

7'5 OGIS topo location

7.5' loc	<u>11625</u>	15' loc	<u>4505</u>
	<u>126W</u>	(calc.)	<u>348W</u>

Company _____

Farm _____

Quad Blacksville NW

County Monongahela

District Clay

WELL LOCATION MAP

File No. 061-99A

Plot showing the location of Well No. 1, of
 C. C. Hoffman of Pittsburgh, Pa. to be abandoned
 on the Luther Tennant Farm containing 264 Acres
 Located in Clay District, Mingo Co. West Virginia.

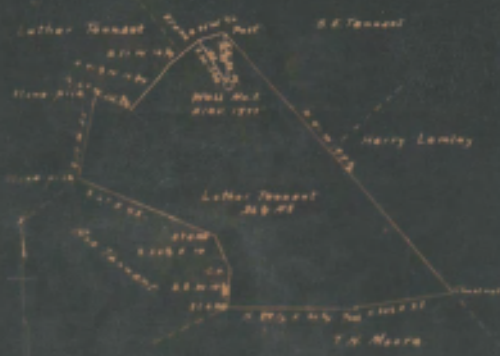

WITNESSES

I, the undersigned hereby certify that this map is correct and shows all the information to the best of my knowledge and belief required by the Oil and Gas Section of the Mining Laws of West Virginia.

A. L. Haasler
 2-2-1911

Witnessed before me a Notary Public in and for Mingo Co. West Virginia this the 11th day of July, 1911.

By Commission Expires
 Dec 12 1911

A. B. Chalkley
 Notary Public

WEST VIRGINIA DEPARTMENT OF MINES

OIL AND GAS DIVISION

PRELIMINARY DATA SHEET NO. 1

File No. _____ Well No. 1
O.C. Hoffman ~~Owner~~ of 1062 E. 101st St -
Cleveland - Ohio as the Luther Tennant ~~Part~~
 containing 26 1/4 acres. Location R.D., Fairview
Clay District, in Marion County, West Virginia

The surface of the above tract is owned in fee by Luther Tennant
 of R.D., Fairview, W. Va. address, and the mineral rights are owned by
Henry W. Phillips of Mellon Nat'l. Bank - Pgh., Pa.

The oil and gas privileges are held under lease by the above named company, and this well is drilled under permit
 No. _____ issued by the West Virginia Department of Mines, Oil and Gas Division

Elevation of surface at top of well, 1377' 0" Depth
Barometer.

The number of feet of the different sized casings used in the well.

feet	also	Wood conductor.
<u>2355</u> feet <u>6 5/8"</u>	also, cap	also cap
<u>2550</u> feet <u>5 3/16"</u>	also, cap	also cap
feet	also, cap	also cap
gauge of	also, set at	
gauge of	also, set at	
in casing perforated at	feet to	feet
in casing perforated at	feet to	feet

Coal was encountered at 943 feet, thickness 6 inches, and at 1042
 feet; thickness 7 inches; and at _____ feet; thickness _____ inches.

Logs were used as follows: (Give details) _____

Dec. 29 - 1954

Date _____
 Approved O.C. Hoffman _____, Owner
 By _____

11/2/30

O.C. Hoffman
 1862 E 101st St - Cleveland
 1 - Luther Ohio
 Thurst Farm

COMPLETION DATA SHEET
 NO. 2
 FORMATION RECORD

Zone	Color	Character	Oil or Gas or Water	Top	Bottom	Thickness	Sand Depth	Remarks
Semi-blebby Coal				943	949	6		
Rich Coal				1042	1044	7		
Soft Sand				1901	2044	143		
Big Lime			Water	2280	2281	53		
Big Injyn			Oil/Gas	2281	2546	195		22.0 - 68 2.11 - 6 1/2
50' Sand				2931	3017	86		
30' Sand				3025	3060	25		
4th Sand				3245	3325	30		
Bayard				3403	3571	164		

Well was set down at _____ Date well was set at _____

First water at _____ Date first water at _____

Well was produced by _____

Dec 29 - 1934

O.C. Hoffman

NOTE: All bottom descriptions must be noted on tabulated sheets and all top-ends and oil and gas sample must be recorded under

Clay District, Monongalia County, W. Va.

By O. C. Hoffman, 1862 E. 101st St., Cleveland, Ohio.

On 26 $\frac{1}{2}$ acres, surface owned by Luther Tennant, R. D. Fairview,
W. Va., and mineral rights by Henry W. Phillips, Mellon
National Bank, Pittsburgh, Pa.

Elevation, 1377' L.

6-5/8" casing, 2355'; 5-3/16", 2550'.

Coal was encountered at 943-949 and 1042-1049'.

Abandonment reported to Dept. of Mines Dec. 29, 1934.

Well was not shot.

MON-99-A

	Top.	Bottom.	Thickness.
Sewickley Coal	943	- 949	6
Pittsburgh Coal	1042	- 1049	7
Salt Sand	1901	- 2044	143
Big Lime	2298	- 2351	53
Big Injun Sand (water, oil, and gas)	2351	- 2546	195
50-Ft. Sand	2931	- 3017	86
30-Ft. Sand	3035	- 3060	25
4th Sand	3295	- 3325	30
Bayard Sand (gas)	3511	- 3525	14