

Latitude 39° 40'

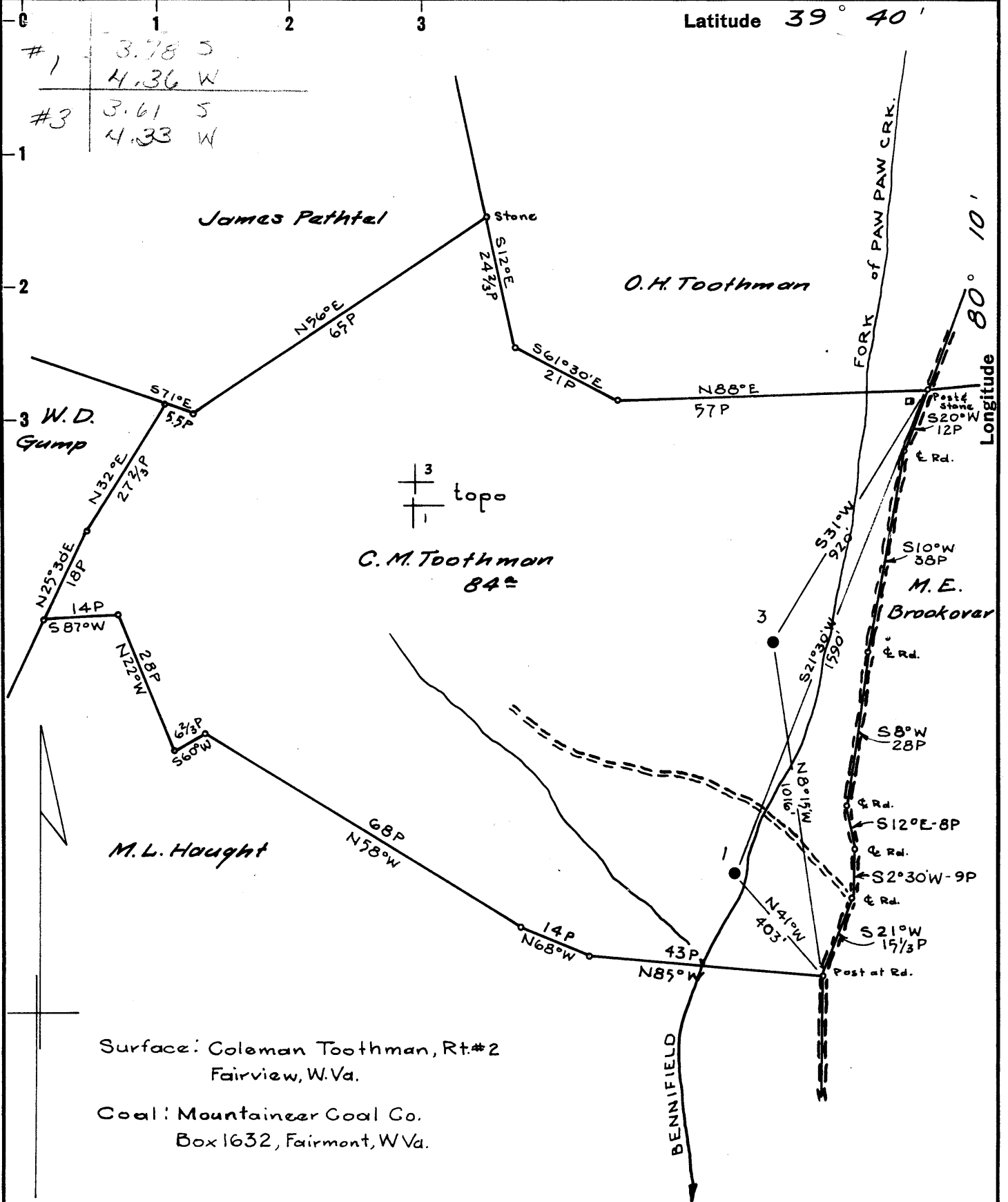

#1	3.78 S
	4.36 W
#3	3.61 S
	4.33 W

Surface: Coleman Toothman, Rt.#2  
Fairview, W.Va.

Coal: Mountaineer Coal Co.  
Box 1632, Fairmont, W.Va.

New Location

Drill Deeper

Abandonment

Map N61E N11E21

Company SOUTH PENN OIL CO.

Address PARKERSBURG, W.Va.

Farm C.M. TOOTHMAN

Tract \_\_\_\_\_ Acres 84<sup>±</sup> Lease No. 79558

Well (Farm) No. 1 & 3 Serial No. \_\_\_\_\_

Elevation (Spirit Level) (1) 1043.41 ch. (3) 1073.54 ch.

Quadrangle BLACKSVILLE

County MONONGALIA District CLAY

Engineer [Signature]

Engineer's Registration No. 2534

File No. 1318 Drawing No. \_\_\_\_\_

Date MAR. 31, 1960 Scale 1" = 400'

STATE OF WEST VIRGINIA  
DEPARTMENT OF MINES  
OIL AND GAS DIVISION  
CHARLESTON

WELL LOCATION MAP  
FILE NO. MON-644-A #1  
MON-645-A #3

+ Denotes location of well on United States Topographic Maps, scale 1 to 62,500, latitude and longitude lines being represented by border lines as shown.

- Denotes one inch spaces on border line of original tracing.

— 130



671

STATE OF WEST VIRGINIA  
DEPARTMENT OF MINES  
OIL AND GAS DIVISION

Quadrangle Blacksville

Permit No. 644A

WELL RECORD

Oil or Gas Well \_\_\_\_\_ (KIND)

Company SOUTH PENN OIL COMPANY  
Address Box 1280, Parkersburg, West Virginia  
Farm C. M. Toothman Acres 24  
Location (waters) Bennifield Fork  
Well No. 1 Elev. 1043.41 ch.  
District Clay County Masonalia  
The surface of tract is owned in fee by Coleman Toothman  
Rt. # 2 Address Fairview, W. Va.  
Mineral rights are owned by c/o Empire National Bank  
Address Clarksburg, W. Va.

Casing and Tubing	Used in Drilling	Left in Well	Packers
Size			Kind of Packer
16			
13	64'	64'	
10	570'	570'	Size of
8 3/4	1075'	1075'	
6 5/8	1600'	1600'	Depth set
5 3/16	1830'	1830'	
3			Perf. top
2			Perf. bottom
Liners Used			Perf. top
			Perf. bottom

Drilling commenced 10-9-02  
Drilling completed 10-21-02  
Date Shot 1918 From 1976' To \_\_\_\_\_  
With 10 Qts-20 Qts-20 Qts  
Open Flow /10ths Water in \_\_\_\_\_ Inch  
/10ths Merc. in \_\_\_\_\_ Inch  
Volume \_\_\_\_\_ Cu. Ft.  
Rock Pressure \_\_\_\_\_ lbs. \_\_\_\_\_ hrs.  
Oil \_\_\_\_\_ bbls., 1st 24 hrs.  
WELL ACIDIZED \_\_\_\_\_  
WELL FRACTURED \_\_\_\_\_

CASING CEMENTED \_\_\_\_\_ SIZE \_\_\_\_\_ No. Ft. \_\_\_\_\_ Dat \_\_\_\_\_

COAL WAS ENCOUNTERED AT 561 FEET 7 INCHES  
\_\_\_\_\_ FEET \_\_\_\_\_ INCHES FEET \_\_\_\_\_ INCHES  
\_\_\_\_\_ FEET \_\_\_\_\_ INCHES FEET \_\_\_\_\_ INCHES

RESULT AFTER TREATMENT \_\_\_\_\_

ROCK PRESSURE AFTER TREATMENT \_\_\_\_\_

Fresh Water \_\_\_\_\_ Feet Salt Water \_\_\_\_\_ Feet

Formation	Color	Hard or Soft	Top	Bottom	Oil, Gas or Water	Depth	Remarks
<b>Pittsburgh Coal</b>			<b>561'</b>				
<b>Big Injun Sand</b>			<b>1860'</b>	<b>2006'</b>			
<b>TOTAL DEPTH</b>				<b>1992'</b>	<b>Pay</b>	<b>1976-1983</b>	

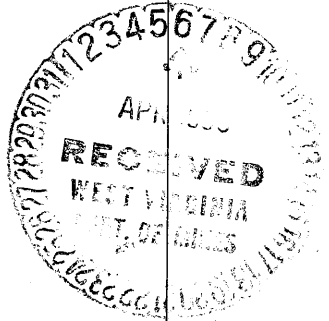

APR 6 1962

Formation	Color	Hard or Soft	Top	Bottom	Oil, Gas or Water	Depth Found	Remarks

Date March 30, 1960

APPROVED SOUTH PENN OIL COMPANY, Owner

By George W. Kilman  
 George W. Kilman (Title) Land Agent