



STATE OF WEST VIRGINIA
DEPARTMENT OF MINES

Oil and Gas Division

OIL AND GAS WELL PERMIT APPLICATION

RECEIVED

APR 11 1977

OIL & GAS DIVISION
DEPT. OF MINES

PK

TO THE DEPARTMENT OF MINES,
Charleston, W. Va.

DATE April 11, 1977

Surface Owner Mower Lumber Company

Company Texas International Petroleum

Address Durbin, West Virginia

Address Charleston, West Virginia

Mineral Owner Mower Lumber Company

Farm Mower Lumber Co. Acres 92.25

Address Durbin, West Virginia

Location (waters) Gauley River

Coal Owner Mower Lumber Company

Well No. 1 Elevation 1610.27

Address Durbin, West Virginia

District Jefferson County Nicholas

Coal Operator None

Quadrangle 7.5' Summersville Dam

Address _____

THIS PERMIT MUST BE POSTED AT THE WELL SITE

All provisions being in accordance with Chapter 22, of the W. Va. Code, the location is hereby approved for drilling. This permit shall expire if operations have not commenced by 8-11-77.

[Signature]

Deputy Director - Oil & Gas Division
GENTLEMEN:

INSPECTOR TO BE NOTIFIED Paul Thomas

ADDRESS Summersville, W.Va.

PHONE 872-3070

The undersigned well operator is entitled to drill upon the above named farm or tract of land for oil and gas, having fee title thereto, (or as the case may be) under grant or lease dated June 15, 1970 by Mower Lumber Company made to C. C. Dodd and recorded on the 19th day of August 1970, in Nicholas County, Book 89 Page 439,452

NEW WELL DRILL DEEPER REDRILL FRACTURE OR STIMULATE
 OIL AND GAS WELL ORIGINALLY DRILLED BEFORE JUNE 5, 1969.

The enclosed plat was prepared by a registered engineer or licensed land surveyor and all coal owners and/or operators have been notified as of the above date.

The above named coal owners and/or operator are hereby notified that any objection they wish to make, or are required to make by Section 3 of the Code, must be received by, or filed with the Department of Mines within ten (10) days. *

Copies of this notice and the enclosed plat were mailed by registered mail, or delivered to the above named coal operators or coal owners at their above shown respective address _____ day _____ before, or on the same day with the mailing or delivery of this copy to the Department of Mines at Charleston, West Virginia.

PLEASE SUBMIT COPIES OF ALL GEOPHYSICAL LOGS DIRECTLY TO:

WEST VIRGINIA GEOLOGICAL AND ECONOMIC SURVEY
P. O. BOX 879
MORGANTOWN, WEST VIRGINIA 26505
AC-304 - 292-6331

Address of Well Operator

Very truly yours, Texas International Petroleum
(Sign Name) J. M. Blanton (S)
Well Operator

Suite 1020 - One Valley Square
Street

Charleston
City or Town

West Virginia 25301
State

09/29/2023

*SECTION 3 If no objections are filed or found by the Department of mines, within said period of ten days from the receipt of notice and plat by the department of mines, to said proposed location, the department shall forthwith issue to the well operator a permit reciting the filing of such plat, that no objections have been made by the coal operators or found thereto by the department and that the same is approved and the well operator authorized to proceed.

BLANKET BOND

NIC-418

PERMIT NUMBER

"I have read and understand the reclamation requirements as set forth in Chapter 22, Article 4, Section 12-b and will carry out the specified requirements."

47-067

Signed by J. M. Blanton (S)

**THIS IS AN ESTIMATE ONLY
ACTUAL INFORMATION WILL BE SUBMITTED ON OG-10 UPON COMPLETION**

PROPOSED WORK ORDER TO X DRILL _____ DEEPEN _____ FRACTURE-STIMULATE _____
 DRILLING CONTRACTOR: (If Known) _____ RESPONSIBLE AGENT: _____
 NAME F.W.A. Drilling Company NAME James M. Blanton
 ADDRESS Elkview, West Virginia ADDRESS Charleston, West Virginia
 TELEPHONE (304) 965-3379 TELEPHONE (304) 343-4609
 ESTIMATED DEPTH OF COMPLETED WELL: 2116 ROTARY X CABLE TOOLS _____
 PROPOSED GEOLOGICAL FORMATION: Weir Sand
 TYPE OF WELL: OIL _____ GAS X COMB. _____ STORAGE _____ DISPOSAL _____
 RECYCLING _____ WATER FLOOD _____ OTHER _____

TENTATIVE CASING PROGRAM:

CASING AND TUBING SIZE	USED FOR DRILLING	LEFT IN WELL	CEMENT FILL UP OR SACKS - CUBIC FT.
20 - 16			
13 - 10	20'	20'	
9 - 5/8			
8 - 5/8	300'	300'	Cement to surface.
7			
5 1/2			
4 1/2		2116'	Cement w/100 sacks.
3			Perf. Top
2			Perf. Bottom
Liners			Perf. Top
			Perf. Bottom

APPROXIMATE FRESH WATER DEPTHS 50 FEET _____ SALT WATER _____ FEET _____
 APPROXIMATE COAL DEPTHS None _____
 IS COAL BEING MINED IN THE AREA? No BY WHOM? _____

TO DRILL:

SUBMIT FIVE (5) COPIES OF OG - 1, \$100.00 PERMIT FEE, PERFORMANCE BOND AND PERMANENT COPY OF PLAT.

TO DRILL DEEPER OR REDRILL:

SUBMIT FIVE (5) COPIES OF OG - 1, SHOWING ORIGINAL PERMIT NUMBER AND PERFORMANCE BOND. ON WELLS DRILLED PRIOR TO 1929, A PERMANENT COPY OF THE PLAT AND THE ORIGINAL WELL RECORD MUST ALSO BE SUBMITTED.

TO FRACTURE - STIMULATE:

OIL AND/OR GAS WELL ORIGINALLY DRILLED BEFORE JUNE 5, 1929, FIVE (5) COPIES OG - 1, PERFORMANCE BOND, PERMANENT PLAT AND ORIGINAL WELL RECORD.

OIL AND/OR GAS WELL ORIGINALLY DRILLED ON AND/OR AFTER JUNE 5, 1929, FIVE COPIES OG - 1, SHOWING ORIGINAL PERMIT NUMBER, AND PERFORMANCE BOND.

Required forms must be filed within ninety (90) days of completion for bond release. Inspector to be notified twenty-four (24) hours in advance.

The following waiver must be completed by the coal operator if the permit is to be issued within ten days of receipt thereof.

WAIVER: I the undersigned, Agent for _____ Coal Company, Owner or Operator of the coal under this lease have examined and place on our mine maps this proposed well location.

We the _____ Coal Company have no objections to said well being drilled at this location, providing operator has complied with all rules and regulations in Articles 4, 5, and 7, Chapter 22 of the West Virginia Code.

For Coal Company

Official Title

09/29/2023

STATE OF WEST VIRGINIA
DEPARTMENT OF MINES
OIL AND GAS WELLS DIVISION
INSPECTOR'S PLUGGING REPORT

Permit No. _____ Well No. _____

COMPANY _____ ADDRESS _____

FARM _____ DISTRICT _____ COUNTY _____

Filling Material Used _____

Liner	Location		Amount	Packer	Location		
PLUGS USED AND DEPTH PLACED			BRIDGES		CASING AND TUBING		
CEMENT-THICKNESS	WOOD-SIZE	LEAD	CONSTRUCTION-LOCATION		RECOVERED	SIZE	LOST

Drillers' Names _____

Remarks: _____

_____ I hereby certify I visited the above well on this date.

DATE

DISTRICT WELL INSPECTOR
09/29/2023

STATE OF WEST VIRGINIA
DEPARTMENT OF MINES
OIL AND GAS WELLS DIVISION

RECEIVED

APR 25 1977

OIL & GAS DIVISION
DEPT. OF MINES

INSPECTOR'S WELL REPORT

Permit No. DIC-418

Oil or Gas Well _____
(KIND)

Company Seas International
Address Chas. W. A.
Farm Moore Lumber Co.
Well No. _____
District Jefferson County Richmond
Drilling commenced 4-18-77
Drilling completed _____ Total depth _____
Date shot _____ Depth of shot _____
Initial open flow _____ /10ths Water in _____ Inch
Open flow after tubing _____ /10ths Merc. in _____ Inch

CASING AND TUBING	USED IN DRILLING	LEFT IN WELL	PACKERS
Size			
16			Kind of Packer _____
13			
10			Size of _____
8 3/8	189'		Depth set _____
9 5/8			
5 3/16			
3			Perf. top _____
2			Perf. bottom _____
Liners Used			Perf. top _____
			Perf. bottom _____

Volume _____ Cu. Ft.
Rock pressure _____ lbs. _____ hrs.
Oil _____ bbls., 1st 24 hrs.
Fresh water 20° feet _____ feet
Salt water _____ feet _____ feet

CASING CEMENTED 8 3/8 SIZE 189 No. FT. _____ Date _____
NAME OF SERVICE COMPANY Cement & Lumber
COAL WAS ENCOUNTERED AT 34 FEET 36 INCHES

_____ FEET _____ INCHES FEET _____ INCHES
_____ FEET _____ INCHES FEET _____ INCHES

Drillers' Names Lester Parson Redroad
G. W. D. Potony

Remarks: Cementing 8" 39. Called out 10:30 P.M. 4-19-77
on job 11:00 P.M. 4-19-77
plug started 3:30 A.M. 4-20-77
plug down 5:00 A.M. 4-20-77

4-20-77
DATE

Paul W. [Signature]
DISTRICT WELL INSPECTOR

09/29/2023

STATE OF WEST VIRGINIA
 DEPARTMENT OF MINES
 OIL AND GAS WELLS DIVISION
INSPECTOR'S PLUGGING REPORT

Permit No. _____ Well No. _____

COMPANY _____ ADDRESS _____

FARM _____ DISTRICT _____ COUNTY _____

Filling Material Used _____

Liner	Location	Amount	Packer	Location		
PLUGS USED AND DEPTH PLACED			BRIDGES	CASING AND TUBING		
CEMENT-THICKNESS	WOOD-SIZE	LEAD	CONSTRUCTION-LOCATION	RECOVERED	SIZE	LOST

Drillers' Names _____

Remarks: _____

_____ I hereby certify I visited the above well on this date.
DATE

 DISTRICT WELL INSPECTOR
09/29/2023

STATE OF WEST VIRGINIA
DEPARTMENT OF MINES
OIL AND GAS WELLS DIVISION

RECEIVED
APR 25 1977

OIL & GAS DIVISION
DEPT. OF MINES

INSPECTOR'S WELL REPORT

Permit No. 710-418

Oil or Gas Well _____
(KIND)

		CASING AND TUBING	USED IN DRILLING	LEFT IN WELL	PACKERS
Company	<u>Super International</u>				
Address	<u>Char. W. P.</u>	Size			
Farm	<u>Moore Lumber Co.</u>	16			Kind of Packer _____
Well No.		13			
District	<u>Jefferson County Nicholas</u>	10			Size of _____
Drilling commenced	<u>4-18-77</u>	8 1/4			
Drilling completed		6 5/8			Depth set _____
Date shot		5 3/16			
Initial open flow		3			Perf. top _____
Open flow after tubing		2			Perf. bottom _____
Volume		Liners Used			Perf. top _____
Rock pressure					Perf. bottom _____
Oil		CASING CEMENTED _____ SIZE _____ No. FT. _____ Date _____			
Fresh water		NAME OF SERVICE COMPANY _____			
Salt water		COAL WAS ENCOUNTERED AT <u>34</u> FEET <u>36</u> INCHES			
		_____ FEET _____ INCHES	_____ FEET _____ INCHES	_____ FEET _____ INCHES	_____ FEET _____ INCHES

Drillers' Names _____

Joseph Jarvis Redmond
J. W. A. Patton

Remarks:

ushing at 104 ft.
get OK

4-18-77
DATE

Paul Thomas
DISTRICT WELL INSPECTOR

09/29/2023

STATE OF WEST VIRGINIA
 DEPARTMENT OF MINES
 OIL AND GAS WELLS DIVISION
INSPECTOR'S PLUGGING REPORT

Permit No. _____ Well No. _____

COMPANY _____ ADDRESS _____

FARM _____ DISTRICT _____ COUNTY _____

Filling Material Used _____

Liner	Location	Amount	Packer	Location	
PLUGS USED AND DEPTH PLACED			BRIDGES	CASING AND TUBING	
CEMENT-THICKNESS	WOOD-SIZE	LEAD	CONSTRUCTION-LOCATION	RECOVERED	SIZE LOST

Drillers' Names _____

Remarks: _____

_____ I hereby certify I visited the above well on this date.
DATE

DISTRICT WELL INSPECTOR
09/29/2023

STATE OF WEST VIRGINIA
DEPARTMENT OF MINES
OIL AND GAS WELLS DIVISION

RECEIVED

APR 19 1977

OIL & GAS DIVISION
DEPT. OF MINES

INSPECTOR'S WELL REPORT

Permit No. MC-418

Oil or Gas Well _____
(KIND)

Company <u>Texas International</u>	CASING AND TUBING	USED IN DRILLING	LEFT IN WELL	PACKERS
Address <u>Chas, W. VA.</u>	Size			
Farm <u>Mason Lumber Co.</u>	16			Kind of Packer _____
Well No. _____	13			
District <u>Jefferson</u> County <u>Putnam</u>	10			Size of _____
Drilling commenced _____	8 1/4			
Drilling completed _____ Total depth _____	6 5/8			Depth set _____
Date shot _____ Depth of shot _____	5 3/16			
Initial open flow _____ /10ths Water in _____ Inch	3			Perf. top _____
Open flow after tubing _____ /10ths Merc. in _____ Inch	2			Perf. bottom _____
Volume _____ Cu. Ft.	Liners Used			Perf. top _____
Rock pressure _____ lbs. _____ hrs.				Perf. bottom _____
Oil _____ bbls., 1st 24 hrs.	CASING CEMENTED _____ SIZE _____ No. FT. _____ Date _____			
Fresh water _____ feet _____ feet	NAME OF SERVICE COMPANY _____			
Salt water _____ feet _____ feet	COAL WAS ENCOUNTERED AT _____ FEET _____ INCHES			
	_____ FEET _____ INCHES _____ FEET _____ INCHES			
	_____ FEET _____ INCHES _____ FEET _____ INCHES			

Drillers' Names _____

Remarks: F. W. A. - Potomac
Moving in - Will start Delg. Monday
Get OK

4-15-77
DATE

Paul Roman
DISTRICT WELL INSPECTOR

09/29/2023

**HALLIBURTON SERVICES
JOB SUMMARY**

012 R-1

HALLIBURTON DIVISION

HALLIBURTON LOCATION

BILLED ON TICKET NO.

*Pittsburgh, Pa.
Elkview, W.Va.*

028572

Benxon *Nov 418*

SEC. _____ TWP. _____ RNG. _____ COUNTY *Fayette* STATE *W.Va.*

WELL NAME _____ TYPE _____

THICKNESS _____ FROM _____ TO _____

PROD. OIL _____ BPD. WATER _____ BPD. GAS _____ MCFD _____

DATE _____ MUD TYPE _____ MUD WT. _____

TYPE _____ SET AT _____

TEMP. _____ PRESSURE _____

DATA _____

WELL DATA

	NEW USED	SIZE	FROM	TO	WEIGHT	MAXIMUM PSI ALLOWABLE
CASING	<i>4-10</i>	<i>4 1/2"</i>	<i>EB</i>	<i>1406</i>	<i>10.5</i>	<i>1300</i>
LINER						
TUBING						
OPEN HOLE					TOTAL DEPTH:	
PERFORATIONS						SHOTS/FT.
PERFORATIONS						SHOTS/FT.
PERFORATIONS						SHOTS/FT.

JOB DATA

CALLER OUT	ON LOCATION	JOB STARTED	JOB COMPLETED
DATE <i>4-25-77</i>	DATE <i>4-25-77</i>	DATE <i>4-25-77</i>	DATE <i>4-25-77</i>
TIME <i>16:00</i>	TIME <i>21:00</i>	TIME <i>21:30</i>	TIME <i>22:15</i>

TOOLS AND ACCESSORIES

TYPE AND SIZE	QTY.	MAKE
COLLAR		
HOE		
HOE		
LIZERS <i>4 1/2</i>	<i>3EN</i>	<i>Eaton</i>
PLUG		
<i>Leak Sealer</i>	<i>1EN</i>	<i>Tool. Ruffel</i>
<i>PC 4 1/2</i>	<i>1EN</i>	<i>Halliburton</i>

PERSONNEL AND SERVICE UNITS

NAME	UNIT NO. & TYPE	LOCATION
<i>McSweeney</i>	<i>2235 & Pick up</i>	<i>Elkview W.Va.</i>
<i>Dr. Harper</i>	<i>0743</i>	
<i>Nichols</i>	<i>61-C</i>	
	<i>271 Bulk Tr.</i>	
<i>Dr. Williams</i>	<i>Flat Bed</i>	

MATERIALS

FLUID _____ DENSITY _____ LB/GAL. API _____

FLUID _____ DENSITY _____ LB/GAL. API _____

TYPE _____ SIZE _____ LB. _____

TYPE _____ SIZE _____ LB. _____

TYPE _____ GAL. _____ % _____

TYPE _____ GAL. _____ % _____

TYPE _____ GAL. _____ % _____

TANT TYPE _____ GAL. _____ IN _____

NT TYPE _____ GAL. _____ IN _____

SS ADD. TYPE _____ GAL.-LB. _____ IN _____

AGENT TYPE _____ GAL.-LB. _____ IN _____

ED. AGENT TYPE _____ GAL.-LB. _____ IN _____

R TYPE _____ GAL.-LB. _____ IN _____

IG AGENT TYPE _____ GAL.-LB. _____

C BALLS TYPE _____ QTY. _____

DEPARTMENT *Crew*

DESCRIPTION OF JOB *Cement 4 1/2" Prod*

Classing

JOB DONE THRU: TUBING CASING ANNULUS TBG./ANN.

CUSTOMER REPRESENTATIVE *X* *Hale*

HALLIBURTON OPERATOR _____ COPIES REQUESTED _____

CEMENT DATA

NUMBER OF SACKS	TYPE	API CLASS	BRAND	BULK SACKED	ADDITIVES	YIELD CU.FT./SK.	MIXED LBS./GAL.
<i>4</i>	<i>4 1/2"</i>				<i>@ 10% 50% 1 1/2" J. ...</i>		

PRESSURES IN PSI

SUMMARY

VOLUMES

TING _____ DISPLACEMENT _____

OWN _____ MAXIMUM _____

FRACTURE GRADIENT _____

INSTANT _____ 5-MIN. _____ 15-MIN. _____

HYDRAULIC HORSEPOWER

AVAILABLE _____ USED _____

AVERAGE RATES IN BPM

DISPL. _____ OVERALL _____

CEMENT LEFT IN PIPE

REASON _____

PREFLUSH: BBL-GAL. _____

LOAD & BKDN: BBL-GAL. _____

TREATMENT: BBL-GAL. _____

CEMENT SLURRY: BBL-GAL. _____

TOTAL VOLUME: BBL-GAL. _____

DISPL: BBL-GAL. *21.9*

OIL & GAS DIVISION
DEPT. OF MINES

JUN 2 1977

REMARKS

CUSTOMER: *Terms International Corp*
 LEASE: *Heavy Lumber Co*
 WELL NO.: *41*
 JOB TYPE: *Cement 4 1/2" Prod*
 DATE: *4-25-77*

09/29/2023

CUSTOMER

HALLIBURTON SERVICES
JOB LOG

WELL NO. 1 LEASE Winey Lumber TICKET NO. 028572
 CUSTOMER Texas International Corp PAGE NO. _____
 JOB TYPE Cement 4 1/2" Prod Casing DATE 4-15-77

FORM 2013 R-2

CHART NO.	TIME	RATE (BPM)	VOLUME (BBL)	PUMPS		PRESSURE (PSI)		DESCRIPTION OF OPERATION AND MATERIALS
				T	C	TUBING	CASING	
	21:00							Safety Meeting
	21:00		10				300	Pump 10 BBL H ₂ O
	21:30							
			12				300	Pump Mud Flush
			10				300	Pump 10 BBL H ₂ O Pad
			31.4				350	Mix Cement
							0	Wash out Pump & Line
								Release Latch down Plug
			21.9				300	Displace Plug to Baffle with 21.9 BBL H ₂ O
							1500	latch Plug In
								Release & Check Plug
								Plug Held
	22:15							Finished with Job

RECEIVED
 JUN 29 1977
 OIL & GAS DIVISION
 DEPT. OF MINES



STATE OF WEST VIRGINIA
DEPARTMENT OF MINES

Oil and Gas Division

WELL RECORD

RECEIVED

JUN 29 1977

OIL & GAS DIVISION
DEPT. OF MINES

Quadrangle 7.5' Summersville Dam

Permit No. NIC-418

Rotary Oil _____
Cable _____ Gas
Recycling _____ Comb. _____
Water Flood _____ Storage _____
Disposal _____ (Kind) _____

Company Texas International Petroleum
Address Charleston, W.V.
Farm Mower Lumber Co. Acres 92.25
Location (waters) Gauley River
Well No. #1 Elev. 1610.27
District Jefferson County Nicholas
The surface of tract is owned in fee by _____
Mower Lumber Company
Address Durbin, W.V.
Mineral rights are owned by Mower Lumber
Company Address Durbin, W.V.
Drilling Commenced April 18, 1977
Drilling Completed June 1, 1977
Initial open flow -0- cu. ft. _____ bbls.
Final production 1750 cu. ft. per day _____ bbls.
Well open 5 hrs. before test 220 RP.

Casing and Tubing	Used in Drilling	Left in Well	Cement fill up Cu. ft. (Sks.)
Size 20-16			
Cond. 13-10"			
9 5/8			
8 5/8	200'	200'	cemented w/100 sacks, circulated.
7			
5 1/2			
4 1/2	1405'	1405'	cemented w/145 sacks
3			
2			
Liners Used			

Well treatment details:

Attach copy of cementing record.

Perforated 1129' - 32', 7 shots; 1152' - 57', 11 shots; 1167' - 69', 5 shots. Broke down formation with 2,000 PSI. Ran 500 gallons 15% HCL. Fraced w/868 barrels gelled water, 15,000 # 80/100 sand and 45,000 # 20/40 sand. Average injection rate 35.2 barrels per minute. Average injection pressure 2086 PSI. Instant shut-in pressure 1200 PSI.

Coal was encountered at 34' - 37' Feet _____ Inches _____
Fresh water _____ Feet _____ Salt Water _____ Feet _____
Producing Sand Ravencliff Depth 1115' - 1197'

Formation	Color	Hard or Soft	Top Feet	Bottom Feet	Oil, Gas or Water	* Remarks
Sandstone			0	34		
Coal			34	37		
Sandstone			37	54		
Rock			54	95		
Sandstone			95	104		
Rock			104	198		
Sandstone			198	235		
Rock			235	450		
Shale			450	625		
Shale			625	780		
Sand & Shale			780	915		
Shale			915	1102		
Maxton Sand			1102	1195		
Shale			1195	1370		
Maxton Sand			1370	1393		
Shale			1393	1610		
Little Lime			1610	1630		
Blue Monday			1630	1660		
Pencil Cave			1660	1700		
Big Lime			1700	2020		
Shale			2020	2134		

09/29/2023

T.D.

(over)

* Indicates Electric Log tops in the remarks section.

STATE OF WEST VIRGINIA
DEPARTMENT OF MINES
OIL AND GAS WELLS DIVISION

RECEIVED

APR 19 1977

OIL & GAS DIVISION
DEPT. OF MINES

INSPECTOR'S WELL REPORT

Permit No. MC-418

Oil or Gas Well _____
(KIND)

Company <u>Texas International</u>	CASING AND TUBING	USED IN DRILLING	LEFT IN WELL	PACKERS
Address <u>Chas, W. VA.</u>	Size			Kind of Packer _____
Farm <u>Moore Lumber Co.</u>	16			
Well No. _____	13			Size of _____
District <u>Jefferson</u> County <u>Nicholas</u>	10			
Drilling commenced _____	8 1/4			Depth set _____
Drilling completed _____ Total depth _____	6 5/8			
Date shot _____ Depth of shot _____	5 3/16			Perf. top _____
Initial open flow _____ /10ths Water in _____ Inch	3			Perf. bottom _____
Open flow after tubing _____ /10ths Merc. in _____ Inch	2			Perf. top _____
Volume _____ Cu. Ft.	Liners Used			Perf. bottom _____
Rock pressure _____ lbs. _____ hrs.	CASING CEMENTED _____ SIZE _____ No. FT. _____ Date _____			
Oil _____ bbls., 1st 24 hrs.	NAME OF SERVICE COMPANY _____			
Fresh water _____ feet _____ feet	COAL WAS ENCOUNTERED AT _____ FEET _____ INCHES			
Salt water _____ feet _____ feet	_____ FEET _____ INCHES _____ FEET _____ INCHES			
	_____ FEET _____ INCHES _____ FEET _____ INCHES			

Drillers' Names _____

J. W. A. Rotony

Remarks: Moving in - Will start Drilling Monday
Per OK

4-15-77
DATE

Paul Roman
DISTRICT WELL INSPECTOR

7-10-77
DATE

W. A. [Signature]
DISTRICT WELL INSPECTOR

09/29/2023

STATE OF WEST VIRGINIA
DEPARTMENT OF MINES
OIL AND GAS WELLS DIVISION
INSPECTOR'S PLUGGING REPORT

Permit No. _____ Well No. _____

COMPANY _____ ADDRESS _____

FARM _____ DISTRICT _____ COUNTY _____

Filling Material Used _____

Liner		Location	Amount	Packer	Location		
PLUGS USED AND DEPTH PLACED			BRIDGES		CASING AND TUBING		
CEMENT-THICKNESS	WOOD-SIZE	LEAD	CONSTRUCTION-LOCATION		RECOVERED	SIZE	LOST

Drillers' Names _____

Remarks:

_____ I hereby certify I visited the above well on this date.

DATE

09/29/2023

DISTRICT WELL INSPECTOR

STATE OF WEST VIRGINIA
DEPARTMENT OF MINES
OIL AND GAS WELLS DIVISION

RECEIVED

AUG 14 1978

INSPECTOR'S WELL REPORT OIL & GAS DIVISION
DEPT. OF MINES

Permit No. NIG 418

Oil or Gas Well GAS
(KIND)

Company <u>TEXAS INTERNATIONAL</u> Address <u>CHARLESTON WVA</u> Farm <u>MOWER LUMBER CO</u> Well No. <u># 1</u> District <u>JEFFERSON</u> County <u>NIG</u> Drilling commenced _____ Drilling completed _____ Total depth _____ Date shot _____ Depth of shot _____ Initial open flow _____ /10ths Water in _____ Inch Open flow after tubing _____ /10ths Merc. in _____ Inch Volume _____ Cu. Ft. Rock pressure _____ lbs. _____ hrs. Oil _____ bbls., 1st 24 hrs. Fresh water _____ feet _____ feet Salt water _____ feet _____ feet	CASING AND TUBING	USED IN DRILLING	LEFT IN WELL	PACKERS
	Size			
	16			Kind of Packer
	13			
	10			Size of
	8 1/4			
	6 3/8			Depth set
	5 3/16			
	3			Perf. top
	2			Perf. bottom
Liners Used			Perf. top	
			Perf. bottom	

CASING CEMENTED _____ SIZE _____ No. FT. _____ Date _____

NAME OF SERVICE COMPANY _____

COAL WAS ENCOUNTERED AT _____ FEET _____ INCHES

_____ FEET _____ INCHES _____ FEET _____ INCHES

_____ FEET _____ INCHES _____ FEET _____ INCHES

Drillers' Names _____

Remarks: PAUL THOMAS CALLED ME TO MAKE A FINAL ON (NIG 418) GRADING AND MUSHING AND SEEDING IS DONE BUT WELL IS NOT HOLED UP

8-11-78
DATE

Larry H. Hefner 09/29/2023
DISTRICT WELL INSPECTOR

STATE OF WEST VIRGINIA
DEPARTMENT OF MINES
OIL AND GAS WELLS DIVISION
INSPECTOR'S PLUGGING REPORT

Permit No. _____ Well No. _____

COMPANY _____ ADDRESS _____

FARM _____ DISTRICT _____ COUNTY _____

Filling Material Used _____

Liner	Location		Amount	Packer	Location			
	PLUGS USED AND DEPTH PLACED				BRIDGES	CASING AND TUBING		
	CEMENT-THICKNESS	WOOD-SIZE			CONSTRUCTION-LOCATION	RECOVERED	SIZE	LOST

Drillers' Names _____

Remarks: _____

DATE I hereby certify I visited the above well on this date.

DISTRICT WELL INSPECTOR
09/29/2023



RECEIVED
DEPARTMENT OF ENERGY
OIL AND GAS

JAN 7 1986

State of West Virginia
Department of Mines
Oil and Gas Division
Charleston 25305

FINAL INSPECTION REPORT
INSPECTORS COMPLIANCE REPORT
July 27, 1984

COMPANY Texas Int. Petroleum Corp.

PERMIT NO 067-0418 (4-11-77)

6525 N. Meridian

FARM & WELL NO Mower Lumber Co. #1

Oklahoma City, Oklahoma 73116

DIST. & COUNTY Jefferson/Nicholas

RULE	DESCRIPTION	IN COMPLIANCE	
		YES	NO
23.06	Notification Prior to Starting Work	_____	_____
25.04	Prepared before Drilling to Prevent Waste	_____	_____
25.03	High-Pressure Drilling	_____	_____
16.01	Required Permits at Wellsite	_____	_____
15.03	Adequate Fresh Water Casing	_____	_____
15.02	Adequate Coal Casing	_____	_____
15.01	Adequate Production Casing	_____	_____
15.04	Adequate Cement Strenght	_____	_____
15.05	Cement Type	_____	_____
23.02	Maintained Access Roads	_____	_____
25.01	Necessary Equipment to Prevent Waste	_____	_____
23.04	Reclaimed Drilling Pits	_____	_____
23.05	No Surface or Underground Pollution	_____	_____
23.07	Requirements for Production & Gathering Pipelines	_____	_____
16.01	Well Records on Site	_____	_____
16.02	Well Records Filed	_____	_____
7.05	Identification Markings	_____	_____

I HAVE INSPECTED THE ABOVE CAPTIONED WELL AND RECOMMEND THAT IT BE RELEASED:

SIGNED Craig Blackworth
DATE 1/2/86

Your well record was received and reclamation requirements approved. In accordance with Chapter 22, Article 4, Section 2, the above well will remain under bond coverage for the life of the well.

RECEIVED
DEPARTMENT OF ENERGY
OIL AND GAS

T. H. ...
Administrator-Oil & Gas Division

January 17, 1986

DATE

JAN 7 1986

RECEIVED
ENERGY
OIL AND GAS

JAN 7 1986

State of Texas
Department of Energy
Oil and Gas Division
Austin, Texas

[Handwritten signature]

RECEIVED
ENERGY
OIL AND GAS

JAN 7 1986

09/29/2023

RECEIVED

JAN 30 1979

OIL & GAS DIVISION
DEPT. OF MINES

1.0 API well number: (If not available, leave blank. 14 digits.)	47-067-0418				
2.0 Type of determination being sought: (Use the codes found on the front of this form.)	103 Section of NGPA	Category Code			
3.0 Depth of the deepest completion location: (Only needed if sections 103 or 107 in 2.0 above.)	1169 feet				
4.0 Name, address and code number of applicant: (35 letters per line maximum. If code number not available, leave blank.)	Texas International Pet. Corp. Name Suite 300, National Foundation Center Street Oklahoma City, Oklahoma City State Zip Code		018753 Seller Code		
5.0 Location of this well: [Complete (a) or (b).] (a) For onshore wells (35 letters maximum for field name.)	Jefferson Field Name Nicholas County County W. Va. State				
(b) For OCS wells:	Area Name Block Number Date of Lease: Mo. Day Yr. OCS Lease Number				
(c) Name and identification number of this well: (35 letters and digits maximum.)	Mower Lumber Company #1				
(d) If code 4 or 5 in 2.0 above, name of the reservoir: (35 letters maximum.)					
6.0 (a) Name and code number of the purchaser: (35 letters and digits maximum. If code number not available, leave blank.)	Equitable Gas Company Name		005939 Buyer Code		
(b) Date of the contract:	0, 5, 0, 9, 7, 8, Mo. Day Yr.				
(c) Estimated annual production:	73.0 MMcf.				
7.0 Contract price: (As of filing date. Complete to 3 decimal places.) @ 14.73 PSI	*	(a) Base Price (\$/MMBTU) 1.520	(b) Tax 0.199	(c) All Other Prices [Indicate (+) or (-).] 0.010	(d) Total of (a), (b) and (c) 1.729
8.0 Maximum lawful rate: (As of filing date. Complete to 3 decimal places.) @ 14.73 PSI		1.980	0.259	0.000	2.239
9.0 Person responsible for this application:	James M. Blanton Name Division Manager Title <i>James M Blanton</i> Signature January 10, 1979 Date Application is Completed 304 345-3430 Phone Number				
Agency Use Only Date Received by Juris. Agency Date Received by FERC	JAN 30 1979				

09/29/2023

*Subject to area rate clause under NGPA.

U.S. DEPARTMENT OF ENERGY
Federal Energy Regulatory Commission
Washington, D.C. 20426

**APPLICATION FOR DETERMINATION OF THE MAXIMUM LAWFUL
PRICE UNDER THE NATURAL GAS POLICY ACT (NGPA)**
(Sections 102, 103, 107 and 108)

PLEASE READ BEFORE COMPLETING THIS FORM:

General Instructions:

Complete this form if you are applying for price classification under sections 102, 103, 107 or 108 of the NGPA. A separate application is required for each well. If any reservoir qualifies for a category which differs from the category applicable to the producing well, separate applications must be made for the producing well and the reservoir. Complete each appropriate item on the reverse side of this page. The code numbers used in items 4.0 and 6.0 can be obtained from the Buyer/Seller Code Book. If there is more than one purchaser or contract, identify the additional information in the space below. Enter any additional remarks in the space below.

Submit the completed application to the appropriate Jurisdictional Agency as listed in title 18 of the CFR, part 270.103. If there are any questions, call (202) 275-4539.

Specific Instructions for Item 2.0, Type of Determination:

<u>Section of NGPA</u>	<u>Category Code</u>	<u>Description</u>
102	1	New OCS Lease
102	2	New onshore well (2.5 mile test)
102	3	New onshore well (1,000 feet deeper test)
102	4	New onshore reservoir
102	5	New reservoir on old OCS Lease
103	-	New onshore production well
107	-	High cost natural gas
108	-	Stripper well

Other Purchasers/Contracts:

<u>Contract Date</u> (Mo. Day Yr.)	<u>Purchaser</u>	<u>Buyer Code</u>
_____	_____	_____
_____	_____	_____
_____	_____	_____

Remarks:

09/29/2023

WELL DETERMINATION REPORT

PARTICIPANTS:

DATE: April 3, 1979

BUYER-SELLER CODE

WELL OPERATOR: Texas International Pet. Corp.

018753

FIRST PURCHASER: Equitable Gas Company

005939

OTHER:

W. Va. Department of Mines, Oil & Gas Division

WELL DETERMINATION FILE NUMBER

790130.103.067.0418

Use Above File Number on all Communications Relating to Determination of this Well

Nicholas

Mets 103 *referred to*
for hit to lead

CHECK EACH ITEM AS COMPLETE OR NOTE WHAT IS MISSING

ITEM NO.

1 FERC-121 Items not completed - Line No. _____

2 IV-1 - Agent James M. Blanton

3 IV-2 - Well Permit

4 IV-6 - Well Plat

5 IV-35- Well Record Drilling 2134' Deepening _____

6 IV-36- Gas-Oil Test: Gas Only Was Oil Produced? _____ Ratio _____

7 IV-39- Annual Production _____ years

8 IV-40- 90 day Production _____ Days off Line: _____

9 IV-48- Application for Certification. Complete?

10 - 17 IV Form #51 - 52 - 53 - 54 - 55 - 56 - 57 - 58. Complete Affidavit Signed

18 - 28 Other: Survey _____ Logs _____ Geological Charts _____ Structure Map _____

1:4000 Map _____ Well Tabulations _____ Gas Analyses _____

(5) Date Completed: June 6, 1977 Deepened _____

(5) Production Depth: 1104'

(5) Production Formation: Ravencliff

(5) Initial Potential: 1750 MCFD

(5) Static R.P. Initially: 220

(6) Other Gas Test: _____

(7) Avg. Daily Gas from Annual Production: _____

(8) Avg. Daily Gas from 90-day ending w/1-120 days _____

(8) Line Pressure: _____ PSIG from Daily Report

(5) Oil Production: _____ From Completion Report _____

(10-17) Does lease inventory indicate enhanced recovery being done? No 09/29/2023

(10-17) Is affidavit signed? Notarized?

Does official well record with the Department confirm the submitted information?

Additional Information Does computer program confirm?

Was Determination Objected to? No By Whom? _____

Date January 10, 1979

Operator's Well No. Mower Lumber Co. #1

API Well No. 47 - 067 - 0418
State County Permit

STATE APPLICATION FOR WELL CLASSIFICATION

Previous File No. _____
(If Applicable)

WELL OPERATOR Texas International Pet. Corp. DESIGNATED AGENT James M. Blanton
ADDRESS Suite 300, Nat'l Foundation Center ADDRESS Suite 740, One Valley Square
Oklahoma City, Oklahoma 73112 Charleston, West Virginia 25301

Gas Purchase Contract No. 6825 and Date May 9, 1978
(Month, day and year)

Meter Chart Code None

Name of First Purchaser Equitable Gas Company
420 Boulevard of the Allies
(Street or P. O. Box)
Pittsburgh, Pennsylvania 15219
(City) (State) (Zip Code)

FERC Seller Code 018753 FERC Buyer Code 005939

TYPE OF DETERMINATION BEING SOUGHT:

- (1) Initial determination (See FERC Form 121.) 103 Section of NGPA Category Code _____
- (2) Determination that increased production is the result of enhanced recovery technology.
- (3) Determination of a seasonally affected well.

James M. Blanton Division Manager
Name (Print) Title
James M Blanton
Signature
Suite 740, One Valley Square
Street or P. O. Box
Charleston, West Virginia 25301
City State (Zip Code)
(304) 345-3430
Area Phone Number
Code

(Certificate of Proof of Service to Purchaser)

Sent to Equitable Gas Company by registered mail.

(All of the above to be completed by the Operator/Applicant)

(To be completed by Jurisdictional Agency. Executed copy to be returned to Operator/Applicant and purchaser, if known).

The Department of Mines has received a request for certification of the above described well as meeting the requirements of Section 103 under the Natural Gas Policy Act of 1978, (NGPA); or for determination that increased production is the result of enhanced recovery technology under Section 108 of (NGPA); or for determination of a seasonally affected well under Section 108 of (NGPA).

All interested parties are hereby notified that on the 3 day of April, 1979, at the office of the Oil and Gas Division in Charleston, West Virginia, or as soon thereafter as it may be heard, there will be a public hearing, if requested, or if objection is filed.

This Application is assigned File No. 7901301030670418

Initial review of information submitted indicates the well is, is not entitled to certification as claimed under the Natural Gas Policy Act (NGPA). A review of this evidence and any additional evidence will be made at the time appointed for a public hearing or as soon thereafter as the matter may be heard.

Unless objections are timely filed or a request for a hearing is made within fifteen (15) days, a hearing will not be held except on ex parte motion of the department and the matter will go to determination.

WEST VIRGINIA DEPARTMENT OF MINES

JAN 30 1979

Date received by _____
Jurisdictional Agency

Director
By Robert L. Bell
Title _____

09/29/2023

Checklist of minimum Forms and Information needed to apply for each well classification. Each is identified by an "Item No.". The "Items" required are listed beneath each well classification.

FOR NEW ONSHORE WELL - Sec. 102 NGPA - More than 2.5 miles from a marker well.
Items - 1,2,3,4,5,6,9,10,22,23 - (18 & 19 Qualified)

FOR NEW ONSHORE WELL - Sec. 102 NGPA - More than 1,000 feet deeper than a marker well.
Items - 1,2,3,4,5,6,9,11,22,23 - (18 & 19 Qualified)

FOR NEW ONSHORE RESERVOIR WELL - Sec. 102 NGPA
Items - 1,2,3,4,5,6,9,12,20,21,24 - (18 & 19 Qualified)

FOR NEW ONSHORE PRODUCTION WELL - Sec. 103 NGPA
Items - 1,2,3,4,5,6,9,13

FOR HIGH COST GAS - Sec. 107 NGPA
Items - 1,2,3,4,5,6,9,14,19 - (18 Qualified)

FOR STRIPPER WELLS - Sec. 108 NGPA
Items - 1,2,3,4,5,6,7,8,9,15 (28 If Available)

FOR STRIPPER WELLS - Sec. 108 NGPA - Enhanced Recovery
Items - 9,16

FOR STRIPPER WELLS - Sec. 108 NGPA - Seasonally Affected
Items - 9,17,28

ITEM NOS.	FORM NO.	DESCRIPTION
1.	FERC 121	
2.	IV-1	Operator Agent Certification
3.	IV-2	Well Permit Application
4.	IV-6	Well Plat
5.	IV-35	Well Operator's Drilling Report
6.	IV-36	Gas/Oil Ratio Test Report
7.	IV-39	Report of Annual Production
8.	IV-40	Ninety (90) Day Production Report
9.	IV-48WC	State Application for Well Classification
10.	IV-51WC	Wells drilled more than 2.5 miles from a marker well
11.	IV-52WC	Wells drilled more than 1,000 ft. deeper than a marker well
12.	IV-53WC	New Onshore Reservoir Well
13.	IV-54WC	New Onshore Production Well
14.	IV-55WC	High Cost Natural Gas Well
15.	IV-56WC	Stripper Well Classification
16.	IV-57WC	Stripper - Increased Production by Enhanced Recovery
17.	IV-58WC	Stripper - Seasonally Affected
18.	N/A	Directional Survey
19.	N/A	Electric Logs
20.	N/A	Subsurface cross-section charts (Geological charts)
21.	N/A	Formation Structure Map
22.	N/A	1:4000 Well Location Map
23.	N/A	Well Tabulation Sheet
24.	N/A	Gas Analysis
25.	N/A	Other
26.	N/A	Notice - Increase of Production
27.	N/A	Lease Inventory
28.	N/A	Tax records or verified copies of billing statements for appropriate periods

09/29/2023

STATE OF WEST VIRGINIA
DEPARTMENT OF MINES, OIL AND GAS DIVISION

Date January 10, 1979

Operator's Well No. Mower Lumber #1

API Well No. 47 - 067 - 0418
State County Permit

WELL CLASSIFICATION FORM
NEW ONSHORE PRODUCTION WELL
NGPA Section 103

DESIGNATED AGENT James M. Blanton
ADDRESS Suite 740, One Valley Square
Charleston, West Virginia 25301

WELL OPERATOR Texas International Pet. Corp. Elevation 1610.27
ADDRESS Suite 300, Nat'l Foundation Center Watershed Gauley River
Oklahoma City, Oklahoma 73112 Dist Jefferson County Nicholas Quad 7.5'Summersville

GAS PURCHASER Equitable Gas Company Gas Purchase Contract No. 6825
ADDRESS 420 Boulevard of the Allies Meter Chart Code None
Pittsburgh, Pa. 15219 Date of Contract May 9, 1978

* * * * *

Date surface drilling was begun: April 18, 1977

Indicate the bottom hole pressure of the well and explain how this was calculated:
207.5 PSIA @ 1144 ft. Calculated from surface shut in gauge pressure of 201.73 by determining the average pressure gradient and then multiplying the gradient by the height of the gas column.

AFFIDAVIT

I, James M. Blanton, having been first sworn according to law state that surface drilling of the well for which this determination is sought was begun on or after February 19, 1977; the well satisfies applicable state or federal well spacing requirements and the well is not within a proration unit, in existence at the time surface drilling began, which was applicable to the reservoir from which gas is or will be produced and which applied to any other well producing gas in commercial quantities or on which surface drilling began on or after February 19, 1977, and which was capable of producing gas in commercial quantities. I state, further, that I have concluded, to the best of my information, knowledge and belief, that the well for which this determination is sought is a new onshore production well and that I am not aware of any information not described in the application which is inconsistent with this conclusion.

James M. Blanton

STATE OF WEST VIRGINIA,

COUNTY OF Kanawha, TO WIT

I, Diane R. Allen, a Notary Public in and for the state and county aforesaid, do certify that James M. Blanton, whose name is signed to the writing above, bearing date the 10th day of January, 1979, has acknowledged the same before me, in my county aforesaid.

Given under my hand and official seal this 10th day of January, 1979.

My term of office expires on the 12th day of January, 1982.

[NOTARIAL SEAL]

Diane R. Allen
Notary Public

09/29/2023

RECEIVED
 JAN 31 1980
 OIL & GAS DIVISION
 DEPT. OF MINES

1.0 API well number: (If not available, leave blank. 14 digits.)	47-067-418			
2.0 Type of determination being sought: (Use the codes found on the front of this form.)	102 Section of NGPA		4 Category Code	
3.0 Depth of the deepest completion location: (Only needed if sections 103 or 107 in 2.0 above.)	_____ feet			
4.0 Name, address and code number of applicant: (35 letters per line maximum. If code number not available, leave blank.)	Texas Int. Pet. Corp.			018753
	Name			Seller Code
	Suite 300, 3535 N. W. 58th			
	Street	Oklahoma City	OK	73112
	City	State	Zip Code	
5.0 Location of this well: (Complete (a) or (b).) (a) For onshore wells (35 letters maximum for field name.)	Jefferson			
	Field Name	Nicholas		W. Va. State
(b) For OCS wells:	Area Name		Block Number	
	Date of Lease:		OCS Lease Number	
	Mo.	Day	Yr.	
(c) Name and identification number of this well: (35 letters and digits maximum.)	Mower Lumber Company #1			
(d) If code 4 or 5 in 2.0 above, name of the reservoir: (35 letters maximum.)	Ravencliff			
6.0 (a) Name and code number of the purchaser: (35 letters and digits maximum. If code number not available, leave blank.)	Equitable Gas Co.			005939
	Name			Buyer Code
(b) Date of the contract:	0 5 0 9 7 8 Mo Day Yr.			
(c) Estimated annual production.	65 MMcf.			
	(a) Base Price (\$/MMBTU)	(b) Tax	(c) All Other Prices (Indicate (+) or (-).)	(d) Total of (a), (b) and (c)
7.0 Contract price: (As of filing date. Complete to 3 decimal places.)	1.762	0.224	0.000	1.986
8.0 Maximum lawful rate: (As of filing date. Complete to 3 decimal places.)	2.314	0.295	0.000	2.609
9.0 Person responsible for this application:	J. L. Gaskill			Vice-President
	Name			Title
	Signature			
	Date Application is Completed		Phone Number	
Agency Use Only		405/947-8682		
Date Received by Juris. Agency		11/30/79		
Date Received by FERC		JAN 31 1980		

09/29/2023

PARTICIPANTS:

DATE: JUN 25 1980

BUYER-SELLER CODE

WELL OPERATOR: Texas Int. Pet Corp

018753

FIRST PURCHASER: Equitable Gas Co.

005939

OTHER:

Qualified as Section 102-4 New machine
reservoir. Felt & Lodd

W. Va. Department of Mines, Oil & Gas Division
WELL DETERMINATION FILE NUMBER
800131-102-067-0418
Use Above File Number on all Communications
Relating to Determination of this Well

CHECK EACH ITEM AS COMPLETE OR NOTE WHAT IS MISSING

ITEM NO.

- 1 FERC-121 Items not completed - Line No. _____
 - 2 IV-1 - Agent James M. Blanton
 - 3 IV-2 - Well Permit _____
 - 4 IV-6 - Well Plat
 - 5 IV-35- Well Record Drilling Deepening _____
 - 6 IV-36- Gas-Oil Test: Gas Only _____ Was Oil Produced? _____ Ratio _____
 - 7 IV-39- Annual Production NO years
 - 8 IV-40- 90 day Production NO Days off Line: _____
 - 9 IV-48- Application for Certification. Complete?
 - 10 - 17 IV Form #51 - 52 - 53 - 54 - 55 - 56 - 57 - 58. Complete Affidavit Signed
 - 18 - 28 Other: Survey _____ Logs Geological Charts Structure Map
1:4000 Map _____ Well Tabulations _____ Gas Analyses _____
 - (5) DATE COMMENCED 4-18-77
Date Completed: 6-1-77 Deepened _____
 - (5) Production Depth: 1115 - 1197
 - (5) Production Formation: Ravencliff
 - (5) Final OPEN FLOW: 1750 Mcfd
 - (5) Static R.P. Initially: 220#
 - (6) Other Gas Test: _____
 - (7) Avg. Daily Gas from Annual Production: NO PRODUCTION
 - (8) Avg. Daily Gas from 90-day ending w/1-120 days NO PRODUCTION
 - (8) Line Pressure: NO PSIG from Daily Report: _____
 - (5) Oil Production: NO From Completion Report: _____
 - (10-17) Does lease inventory indicate enhanced recovery being done: NO 09/29/2023
 - (10-17) Is affidavit signed? Notarized?
- Does official well record with the Department confirm the submitted information? yes
- Additional Information _____ Does computer program confirm? _____
- Was Determination Objected to? _____ By Whom? _____

DATE 11/2/79, 19__

STATE OF WEST VIRGINIA
DEPARTMENT OF MINES, OIL AND GAS DIVISION

Operator's Well No. Mower Lumber Co. #1
API Well No: 47 - 067 - 0418
State County Permit

WELL CLASSIFICATION FORM

NEW ONSHORE RESERVOIR WELL

NGPA Section 102(c)(1)(C) Category 4

DESIGNATED AGENT James M. Blanton

ADDRESS 740 One Valley Square
Charleston, W. Va.

WELL OPERATOR TIPCO

ADDRESS 3535 N. W. 58th, Suite 300
Oklahoma City, Oklahoma 73112

GAS PURCHASER Equitable Gas Co.

ADDRESS 420 Boulevard of the Allies
Pittsburgh, Pa. 15217

LOCATION: Elevation 1610.27

Watershed Gourley River

Dist Jefferson County Nicholas Quad 7.5 Summers-

Gas Purchase Contract No. 6825 ville Dam

Meter Chart Code 31472

Date of Contract 5/9/78

* * * * *

List all records reasonably available to you which contain information relevant to a determination of eligibility (including production records, B&O Tax Records and royalty payment records) and indicate the location of such records:

B/O tax records, ad valorem tax records, royalty payment records, and production records - Oklahoma City, Oklahoma

Drilling and completion records - Charleston, W. Va.

Describe the search made of any records listed above:

Well by well, the records were reviewed to determine completion and production history. Other information was reviewed when necessary, to substantiate that this well is in a new onshore reservoir.

09/29/2023

Are there any records not reasonably available to you which may contain information relevant to the determination of eligibility? Yes ___ No X. If yes, identify such records and indicate their location, if known:

Are you aware of any other information which would tend to be inconsistent with the information specified above? Yes ___ No X. If yes, indicate the type and source of the information.

- 1) Was natural gas produced from the reservoir in commercial quantities prior to April 20, 1977? Yes ___ No X.
- 2) Was the reservoir penetrated by an old well from which oil or gas was produced in commercial quantities from any other reservoir? Yes X No ___
- 3) If the answer to 2) is "yes", could natural gas have been produced in commercial quantities prior to April 20, 1977 from any old well so indicated? Yes ___ No X.
- 4) If the gas is to be produced through an old well, were suitable production and gathering facilities available on April 20, 1977? Yes ___ No X.
- 5) If the answer to 3) or 4) is "yes", attach a separate sheet explaining why you believe the well, for which a determination is sought, can be qualified as a new onshore reservoir well and include any information which would support your conclusion.

BOTTOM HOLE PRESSURE DATA

Indicate the bottom hole pressure of the well and explain how this was calculated.

207.5 psia @ 1144'. Calculated from a surface shut in gauge pressure of 201.73 psia by determining the average pressure gradient and then multiplying the gradient by the height of the gas column.

AFFIDAVIT

I, J. L. Gaskill, having been first sworn according to law, state that I have caused to be made a diligent search of those records hereinbefore indicated in the manner herein described, that the information contained in this document is true and accurate and that on the basis of the records and examinations hereinbefore described, and to the best of my information, knowledge and belief, the well for which this determination is sought is a well producing from a new onshore reservoir.

J. L. Gaskill

STATE OF ~~WEST VIRGINIA~~ Oklahoma
COUNTY OF Oklahoma, TO WIT:

I, Wanda G. Logan, a Notary Public in and for the state and county aforesaid, do certify that J. L. Gaskill, whose name is signed to the writing above, bearing date the 31st day of December, 19 79, has acknowledged the same before me, in my county aforesaid.

Given under my hand and official seal this 31st day of December, 19 79.
My term of office expires on the 12th day of March, 19 83.

[NOTARIAL SEAL]

Wanda G. Logan
Notary Public

09/29/2023



State of West Virginia

Office of Oil and Gas

Charleston 25305

DESIGNATED AGENT		PURCHASER		FILING DATE		NGPA SEC.	CO. CODE	PERMIT NO.
Waco International Petroleum Corp.		Equitable Gas Co.		YR	MO	DA		
James M. Johnston		Operator's Well Name or Number		7	9	0	1	0
PURCHASER IDENTIFICATION NUMBER		MAWES Lumber Co. #1		3	0	1	0	3
CONTRACT NO. 6825		FERC CONTROL NO. 79-5179		0	1	0	1	2
METER CHART				0	1	0	1	2
				4-3-79				
				DATE OF ISSUE				
				5-24-79				
				EFFECTIVE DATE				

BY THE AUTHORITY INVESTED IN ME BY THE STATE OF WEST VIRGINIA, I HEREBY CERTIFY THIS WELL TO HAVE MET THE REQUIREMENTS OF CHAPTER 22, ARTICLE 4, SECTION 1 a (11) OF THE WEST VIRGINIA CODE OF 1931, AS AMENDED AND THE NATURAL GAS POLICY ACT OF 1978, TO BE CERTIFIED AS A SECTION 103 New Orleans Production Well THIS CERTIFICATE IS ISSUED AS AN ORIGINAL AND IS SUBJECT TO SURRENDER UPON LAWFUL DEMAND BY THIS AGENCY.

ROBERT C. DODD
ADMINISTRATOR
OFFICE OF OIL AND GAS

[Signature]

HALLIBURTON SERVICES JOB SUMMARY

HALLIBURTON
DIVISION
LOCATION

1711111111
EIKOEN WVA

BILLED ON
TICKET NO. 028567

WELL DATA

FIELD Duncan SEC. _____ TWP. _____ RING. _____ COUNTY W. Va. STATE WVA

FORMATION NAME _____ TYPE _____

FORMATION THICKNESS _____ FROM _____ TO _____

INITIAL PROD: OIL _____ BPD. WATER _____ BPD. GAS _____ MCFD _____

PRESENT PROD: OIL _____ BPD. WATER _____ BPD. GAS _____ MCFD _____

COMPLETION DATE _____ MUD TYPE _____ MUD WT. _____

PACKER TYPE _____ SET AT _____

BOTTOM HOLE TEMP. _____ PRESSURE _____

MISC. DATA _____

	NEW USED	SIZE	FROM	TO	WEIGHT	MAXIMUM PSI ALLOWABLE
CASING	NEW	8 7/8	KB	201	79	300
LINER						
TUBING						
OPEN HOLE						TOTAL DEPTH: _____
PERFORATIONS						SHOTS/FT. _____
PERFORATIONS						SHOTS/FT. _____
PERFORATIONS						SHOTS/FT. _____

JOB DATA

CALLER OUT	ON LOCATION	JOB STARTED	JOB COMPLETED
DATE <u>4-19-77</u>	DATE <u>4-20-77</u>	DATE <u>4-20-77</u>	DATE <u>4-20-77</u>
TIME <u>21:00</u>	TIME <u>01:00</u>	TIME <u>03:00</u>	TIME <u>08:30</u>

PERSONNEL AND SERVICE UNITS

NAME	UNIT NO. & TYPE	LOCATION
<u>M. Sweeney</u>	<u>22352</u>	<u>Pickup</u>
<u>DL Harper</u>	<u>0743</u>	<u>CMEC</u>
<u>B Williams</u>	<u>0711</u>	<u>Bulk Tank</u>
<u>BMEC</u>		

TOOLS AND ACCESSORIES

TYPE AND SIZE	QTY.	MAKE
FLOAT COLLAR		
GUIDE SHOE		
CENTRALIZERS		
BOTTOM PLUG		
TOP PLUG <u>2A-10 8 7/8</u>	<u>1EA</u>	<u>Halliburton</u>
HEAD <u>PC 8 7/8</u>	<u>1EA</u>	<u>Halliburton</u>
PACKER		
OTHER <u>Basket</u>	<u>1EA</u>	<u>Levin</u>

MATERIALS

TREAT. FLUID _____ DENSITY _____ LB./GAL. API

DISPL. FLUID _____ DENSITY _____ LB./GAL. API

PROP. TYPE _____ SIZE _____ LB.

ACID TYPE _____ GAL. _____ %

SURFACTANT TYPE _____ GAL. _____ IN

NE AGENT TYPE _____ GAL. _____ IN

FLUID LOSS ADD. TYPE _____ GAL.-LB. _____ IN

GELLING AGENT TYPE _____ GAL.-LB. _____ IN

FRIC. RED. AGENT TYPE _____ GAL.-LB. _____ IN

BREAKER TYPE _____ GAL.-LB. _____ IN

BLOCKING AGENT TYPE _____ GAL.-LB. _____

PERFPAC BALLS TYPE _____ QTY. _____

OTHER _____

OTHER _____

DEPARTMENT _____

DESCRIPTION OF JOB _____

JOB DONE THRU: TUBING CASING ANNUALS TSG./ANN.

CUSTOMER REPRESENTATIVE X M. Sweeney

HALLIBURTON OPERATOR M. Sweeney COPIES REQUESTED _____

CEMENT DATA

STAGE	NUMBER OF SACKS	TYPE	API CLASS	BRAND	BULK SACKED	ADDITIVES	YIELD CU.FT./SK.	MIXED LBS./GAL.
	<u>80</u>	<u>Class A @</u>	<u>370 @</u>	<u>CL2</u>	<u>+ 1/4" Halcobal</u>			

PRESSURES IN PSI

SUMMARY

VOLUMES

CIRCULATING _____ DISPLACEMENT _____

BREAKDOWN _____ MAXIMUM _____

AVERAGE _____ FRACTURE GRADIENT _____

SHUT-IN: INSTANT _____ 5-MIN. _____ 15-MIN. _____

HYDRAULIC HORSEPOWER _____

ORDERED _____ AVAILABLE _____ USED _____

AVERAGE RATES IN BPM _____

TREATING _____ DISPL. _____ OVERALL _____

CEMENT LEFT IN PIPE _____

FEET 20' REASON Requested

PREFLUSH: SBL-GAL. _____ TYPE _____

LOAD & BKDN: SBL-GAL. _____ PAD: SBL-GAL. 15

TREATMENT: SBL-GAL. _____ DISPL: SBL-GAL. 12

CEMENT SLURRY: SBL-GAL. _____

TOTAL VOLUME: SBL-GAL. _____

REMARKS _____

CUSTOMER

09/29/2023

JOB LOG

CUSTOMER Texas International Ref Corp.

PAGE NO. 1

JOB TYPE 8 5/8" Surface

DATE 4-20-77

FORM 2013 R-1

CHART NO.	TIME	RATE (BPM)	VOLUME (BBL) (GAL)	PUMPS		PRESSURE (PSI)		DESCRIPTION OF OPERATION AND MATERIALS
				T	C	TUBING	CASING	
	02:30							Safety Meeting
	03:00		10				200	Break Circulation with H ₂ O
							200	Mix Cement
								Release Top H ₂ O Plug
			12				200	Displace Plug with 12 BBL H ₂ O leaving 20' of cement in casing
								Close well in
	03:30							Finished with Job

RECEIVED
JUN 21 1977

OIL & GAS
DEPT. OF ENERGY

4/11/77 R

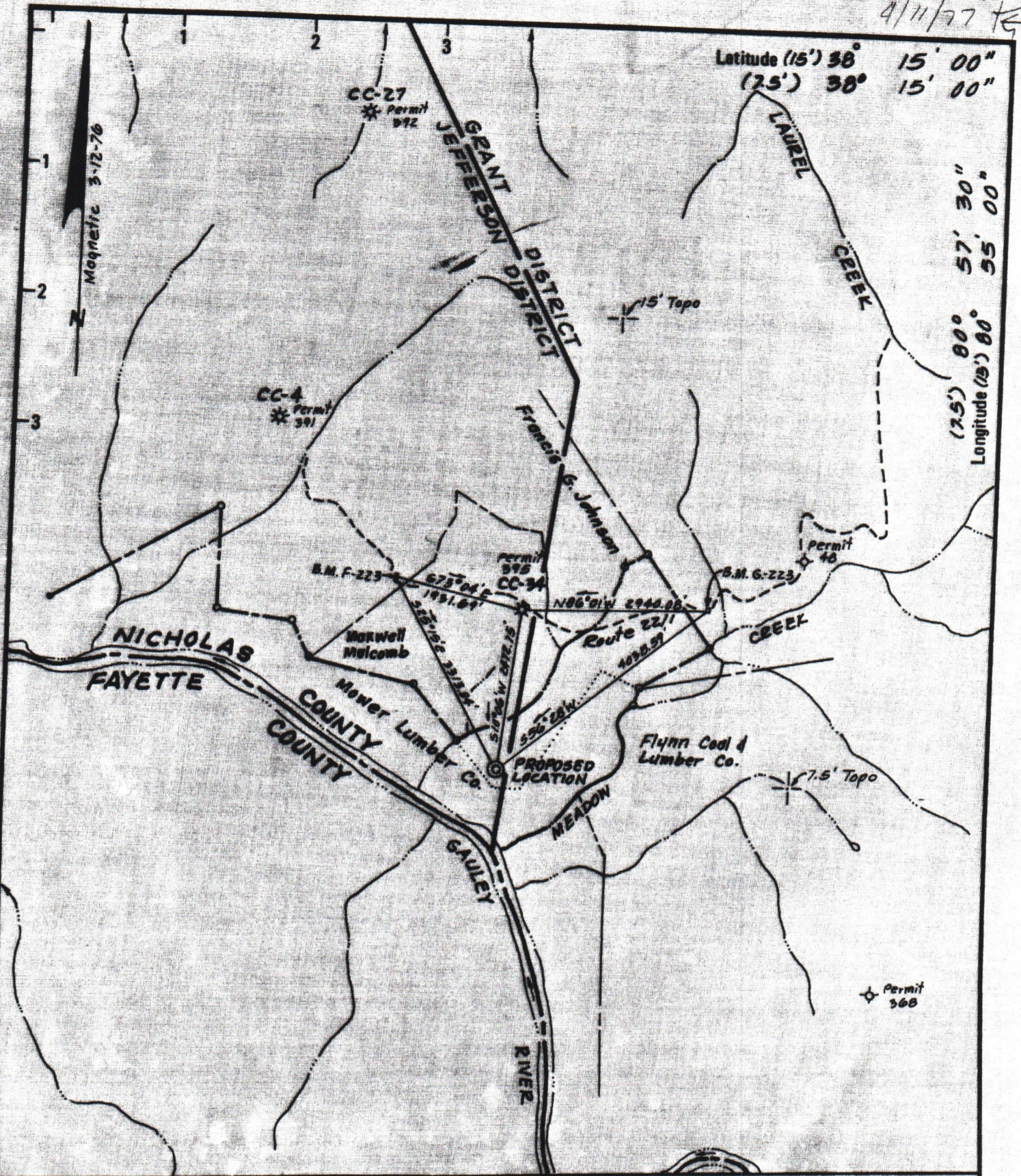

New Location
 Drill Deeper
 Abandonment

Minimum Error of Closure 1/2000
 Source of Elevation B.M. G-223, located on north edge of Route 22/1.
 Elev. given as 1548.33
 "I, the undersigned, hereby certify that this map is correct to the best of my knowledge and belief and shows all the information required by paragraph 6 of the rules and regulations of the oil and gas section of the mining laws of West Virginia."
J. G. Sturgill

Company **TIPCO TEXAS INTERNATIONAL PETROLEUM CORPORATION**
 Address Suite 1020 Valley Square - Charleston, W. Va.
 Farm **MOWER LUMBER CO.**
 Tract 92.25 pt. of 1159 ac Acres 1159 ac Lease No. 5105
 Well (Farm) No. 1 Serial No. _____
 Elevation (Spirit Level) 1610.27
 Quadrangle 25' Summersville Dam/15' Winona
 County Nicholas District Jefferson
 Engineer W. Vo. Surveying & Mapping, Inc. - L.G. Sturgill, U.S.
 Engineer's Registration No. 412
 File No. W75-2 Drawing No. D-55
 Date 3-23-77 Scale 1" = 2000'

STATE OF WEST VIRGINIA
 DEPARTMENT OF MINES
 OIL AND GAS DIVISION
 CHARLESTON
WELL LOCATION MAP
 FILE NO. NIC-418
 09/29/2023
 + Denotes location of well on United States Topographic Maps, scale 1 to 62,500 latitude and longitude lines being represented by border lines as shown.
 - Denotes one inch spaces on border line of original tracing.
47-067

N19266
2116 Wein