

NEW GAULEY COAL CORPORATION LEASE

18,821.835 OF 29,809 ACRES±

WELL NO. TNG 19

SURVEYED LONG. 80° 40' 24.1"

LATITUDE 38° 15'00"

1,900'

LONGITUDE 80° 40'00"

SURVEYED LAT. 38° 14' 38.1"

GRID NORTH
WV SOUTH ZONE

PLUM CREEK TIMBERLANDS, LP
18,821.835 ACRES±
(SURFACE)

T. BURGESS
2.02 ACRES±
(SURFACE)

T. BURGESS
2.03 ACRES±
(SURFACE)

C. STRADER
8.35 ACRES±
(SURFACE)

ANDY BOOTHE
100 ACRES±
(SURFACE)

WELL NO. TNG 19

NOTES

LEASE BOUNDARY DOES NOT APPEAR WITHIN THE SCOPE OF THIS PLAN.

OWNERSHIP INFORMATION TAKEN FROM PUBLIC RECORDS OF NICHOLAS COUNTY, WV IN JANUARY, 2008.

WELL LAT. & LONG. ESTABLISHED BY DIFFERENTIAL SUBFOOT MAPPING GRADE GPS.

REFERENCES

SCALE: 1" = 100'

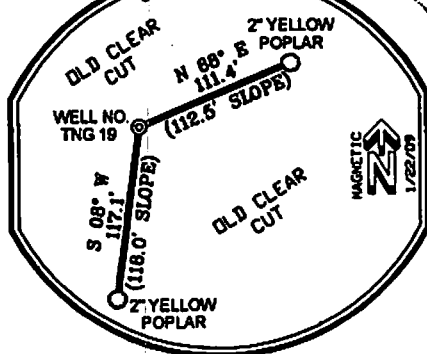

WELL NO. TNG 19
STATE PLANE COORDINATES
(N) 452,907
(E) 2,093,809

WELL NO. TNG 19
SURVEYED LAT. & LONG. DECIMAL DEGREES
(LAT.) 38.243383°
(LONG.) 80.673359°

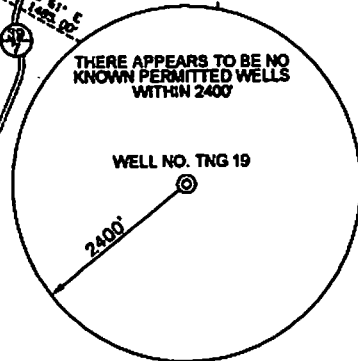

G. A. COVEY

P.O. BOX 185
SUTTON, WEST VIRGINIA 25071
PHONE: (304) 354-4180
FAX: (304) 354-5180
WWW.COVEYENGINEERING.COM

P.O. BOX 5584
1206 ROBERT C. GYRD DRIVE
BECKLEY, WEST VIRGINIA 25801
PHONE: (304) 254-3333
FAX: (304) 825-3464

(*) DENOTES LOCATION ON UNITED STATES TOPOGRAPHIC MAPS.

I THE UNDERSIGNED, HEREBY CERTIFY THAT THIS PLAN IS CORRECT TO THE BEST OF MY KNOWLEDGE AND BELIEF AND SHOWS ALL THE INFORMATION REQUIRED BY LAW AND THE REGULATIONS ISSUED AND PRESCRIBED BY THE DEPARTMENT OF ENVIRONMENTAL PROTECTION.

P.S. 2140

Justin R. Meadows

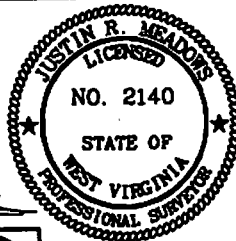

DATE FEBRUARY 2 20 09

OPERATORS WELL NO. TNG 19

API WELL NO. 47-067-00924
STATE COUNTY PERMIT

MINIMUM DEGREE OF ACCURACY CANCELLED

FILE NO. 29012 (50-21)

SCALE 1" = 1000'

PROVEN SOURCE OF ELEVATION DGPS (SUBFOOT MAPPING GRADE)

STATE OF WEST VIRGINIA
DIVISION OF ENVIRONMENTAL PROTECTION
OFFICE OF OIL AND GAS



WELL TYPE: OIL GAS LIQUID INJECTION WASTE DISPOSAL IF "GAS" PRODUCTION STORAGE DEEP SHALLOW

LOCATION: ELEVATION 2,454' WATERSHED LITTLE LAUREL CREEK OF GAULEY RIVER

DISTRICT KENTUCKY COUNTY NICHOLAS QUADRANGLE NETTIE 7.5'

SURFACE OWNER PLUM CREEK TIMBERLANDS, LP. ACREAGE 18,821.835±

ROYALTY OWNER NEW GAULEY COAL CORPORATION LEASE ACREAGE 18,821.835 OF 29,809±

PROPOSED WORK: DRILL CONVERT DRILL DEEPER REDRILL FRACTURE OR STIMULATE PLUG OFF OLD

FORMATION PERFORATE NEW FORMATION PLUG AND ABANDON CLEAN OUT AND REPLUG OTHER

PHYSICAL CHANGE IN WELL (SPECIFY) TARGET FORMATION DEVONIAN SANDS AND SHALES

ESTIMATED DEPTH 7,280'

WELL OPERATOR TRIANA ENERGY, LLC. DESIGNATED AGENT RAY PRUDNICK, JR.

ADDRESS 900 VIRGINIA STREET EAST, SUITE 400 CHARLESTON, WV 25301

COURT NAME PERMIT