

LATITUDE 40°12'30"

LONGITUDE 80°37'30"

TOP HOLE (NAD 83)
 N: 611540.7
 E: 1644940.2
 LAT: 40°10'23.6"
 LONG: -80°39'28.3"
 DEC. LAT: 40.173224
 DEC. LONG: -80.657877

TOP HOLE (NAD 27)
 N: 611503.8
 E: 1676375.3
 LAT: 40°10'23.3"
 LONG: -80°39'29.0"
 DEC. LAT: 40.173152
 DEC. LONG: -80.658078

BOTTOM HOLE (NAD 83)
 N: 615850.8
 E: 1643895.1
 LAT: 40°11'06.1"
 LONG: -80°39'42.5"
 DEC. LAT: 40.185017
 DEC. LONG: -80.661816

BOTTOM HOLE (NAD 27)
 N: 615813.9
 E: 1675330.3344
 LAT: 40°11'05.8"
 LONG: -80°39'43.3"
 DEC. LAT: 40.184946
 DEC. LONG: -80.662016

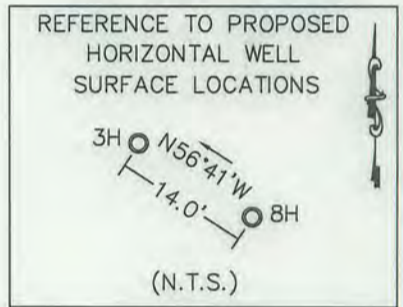

- NOTES:
1. TIES TO WELLS AND CORNERS ARE BASED ON GRID NORTH FOR THE WEST VIRGINIA STATE PLANE COORDINATE SYSTEM, NORTH ZONE NAD 27.
 2. WELL LOCATION REFERENCES ARE BASED ON MAGNETIC MERIDIAN.
 3. BOUNDARIES SHOWN HEREON DERIVED FROM DEEDS, TAX MAPS AND FIELD LOCATION AND ARE NOT INTENDED TO INFER A FULL BOUNDARY SURVEY.
 4. SURFACE OWNERSHIP INFORMATION TAKEN FROM THE ASSESSOR AND COUNTY CLERK RECORDS OF OHIO & BROOKE COUNTIES IN JUNE 2011.
 5. WELL COORDINATES ESTABLISHED BY SUBFOOT GPS UNIT.

FILE NO. 11-0167-762
 DRAWING NO. 3H
 SCALE 1" = 2000'
 MINIMUM DEGREE OF ACCURACY 1 IN 2500
 PROVEN SOURCE OF ELEVATION GPS
SUBFOOT UNIT

I THE UNDERSIGNED, HEREBY CERTIFY THAT THIS PLAT IS CORRECT TO THE BEST OF MY KNOWLEDGE AND BELIEF AND SHOWS ALL THE INFORMATION REQUIRED BY LAW AND THE REGULATIONS ISSUED AND PRESCRIBED BY THE DEPARTMENT OF ENVIRONMENTAL PROTECTION.
 (SIGNED) Victor M. Dawson
 R.P.E. _____ P.S. 956



STATE OF WEST VIRGINIA
 DEPARTMENT OF ENVIRONMENTAL PROTECTION
 OIL AND GAS DIVISION

DATE JUNE 29, 2011
 OPERATOR'S WELL NO. S.E.W. TRUST OHI 3H
 API WELL NO. 47-069-00097H

WELL TYPE: OIL GAS X LIQUID INJECTION WASTE DISPOSAL
 (IF "GAS,") PRODUCTION STORAGE DEEP SHALLOW X

LOCATION: ELEVATION 1137.5' WATERSHED SHORT CREEK
 DISTRICT RICHLAND COUNTY OHIO
 QUADRANGLE TILTONSVILLE

SURFACE OWNER S.E.W. TRUST ACREAGE 220.947 +/-
 OIL & GAS ROYALTY OWNER S.E.W. TRUST, ET AL LEASE ACREAGE 1035.9 +/-
 LEASE NO. _____

PROPOSED WORK: DRILL X CONVERT DRILL DEEPER REDRILL FRACTURE OR STIMULATE X PLUG OFF OLD FORMATION PERFORATE NEW FORMATION OTHER PHYSICAL CHANGE IN WELL (SPECIFY) _____

PLUG AND ABANDON CLEAN OUT AND REPLUG
 TARGET FORMATION MARCELLUS ESTIMATED DEPTH _____ TVD: 5,790' TMD: 10,020'
 WELL OPERATOR CHESAPEAKE APPALACHIA, LLC DESIGNATED AGENT ERIC GILLESPIE
 ADDRESS PO BOX 18496, OKLAHOMA CITY, OK 73154-0496 ADDRESS PO BOX 6070, CHARLESTON, WV 25301

03/21/2014

CANCELLED

COUNTY NAME PERMIT



west virginia department of environmental protection

Office of Oil and Gas
601 57th Street SE
Charleston, WV 25304
(304) 926-0450
(304) 926-0452 fax

Earl Ray Tomblin, Governor
Randy C. Huffman, Cabinet Secretary
www.dep.wv.gov

March 24, 2014

FINAL INSPECTION REPORT

Horizontal Well Permit Cancelled

CHESAPEAKE APPALACHIA, L.L.C.,

The FINAL INSPECTION REPORT for the CANCELLED permit, API Well Number: 47-6900097, issued to CHESAPEAKE APPALACHIA, L.L.C., and listed below has been received in this office. The permit has been cancelled as of 3/14/2014.

James Martin
Chief

Operator: CHESAPEAKE APPALACHIA, L.L.C.
Operator's Well No: S.E.W. TRUST OHI 3H
Farm Name: WOLOSHAN, SHANE - TRUSTEE
API Well Number: 47-6900097
Date Issued: 10/20/2011

Date Cancelled: 03/14/2014

Promoting a healthy environment.

INSPECTORS PERMIT SUMMARY FORM

GPS YES [] NO []

DATE STARTED/LOCATION: _____ OPERATOR: CHESAPEAKE APPALACHIA, L.L.C.
 DRILLING COMMENCED: _____ FARM: WOLOSHAN, SHANE - TRUSTEE
 TO DATE: _____ DEPTHS: _____ Well No: S.E.W. TRUST OHI 3H
 WATER DEPTHS: _____ COAL DEPTHS _____

QUESTIONS FOR THIS REPORT ARE IN ACCORDANCE OF WV CODE 22-6-30 AND REGULATIONS 35CSR 4-12.1 AND 35CSR 4-16 AND THE GENERAL WATER POLLUTION CONTROL PERMIT.

POINTS ARE TO BE GIVEN UP TO MAXIMUM AS SHOWN BASED ON PERFORMANCE.

1. DID OPERATOR GIVE PROPER NOTICE TO INSPECTOR BEFORE THE FOLLOWING:
 - A. CONSTRUCTION YES [] NO [] (2_PTS) (4_PTS) ____
 - B. DRILLING YES [] NO [] (2_PTS)
2. WAS THE TIMBER CUT, STACKED, AND BRUSH USED FOR SEDIMENT BARRIERS BEFORE DIRT WORK STARTED?
 YES [] NO [] (2_PTS) (4_PTS) ____
3. ARE ALL LOCATION AND/OR ROAD BANKS BEING SLOPED?
 YES [] NO [] (4_PTS) (4_PTS) ____
4. CONSTRUCTIONS:
 WERE THE FOLLOWING SEDIMENT CONTROL STRUCTURES PROPERLY INSTALLED/MAINTAINED?
 - A. ROAD DITCHES (1)_ (2)_ (3)_ (4)_ (PTS)
 - B. CROSS DRAINS (1)_ (2)_ (3)_ (4)_ (5)_ (PTS)
 - C. CULVERTS (1)_ (2)_ (3)_ (4)_ (5)_ (PTS)
 - D. CREEK CROSSINGS (1)_ (2)_ (3)_ (PTS)
 - E. DIVERSION DITCHES (1)_ (2)_ (3)_ (PTS)
 - F. BARRIERS (1)_ (2)_ (3)_ (PTS)
 - G. TEMPORARY SEEDING YES [] NO [] (10_PTS)

POINTS AVAILABLE FOR QUESTION 4: (33_PTS) ____

5. HAS TOP SOIL (IF ANY) BEEN STOCKED PILED? YES [] NO [] (2_PTS) (2_PTS) ____
6. IS THE PIT PROPERLY INSTALLED AND MAINTAINED?
 YES [] NO [] (9_PTS) (9_PTS) ____

7. RECLAMATION:
 - A. ROADWAY (1)_ (2)_ (3)_ (PTS)
 - B. LOCATION (1)_ (2)_ (3)_ (PTS)
 - C. PITS (1)_ (2)_ (3)_ (PTS)
 - D. PIPELINES (1)_ (2)_ (3)_ (PTS)
 - E. TANK DIKES (1)_ (2)_ (3)_ (PTS)
 - F. API INSTALLED YES [] NO (3_PTS)
 - G. ADEQUATE SEEDING MATERIALS (1)_ (2)_ (3)_ (PTS)
 - H. WAS SEED BED ADEQUATE (1)_ (2)_ (3)_ (PTS)

POINTS AVAILABLE FOR QUESTION 7: (24_PTS) ____

8. WAS RECLAMATION COMPLETED WITHIN:
 6 MTHS OF TD 6_PTS ONLY; 4 MTHS OF TD 12_PTS ONLY; 2 MTHS OF TD 19_PTS ONLY;

POINTS AVAILABLE FOR QUESTION 8: (19_PTS) ____

TOTAL MAXIMUM POSSIBLE SCORE OF 99.

TOTAL RECLAMATION SCORE: _____

3/14/2014
DATE RELEASED

Shane J. King
INSPECTOR'S SIGNATURE

Cancelled

RECORD INSPECTIONS TO THIS WELL ON PAGE 2