

State of West Virginia
Department of Environmental Protection - Office of Oil and Gas
Well Operator's Report of Well Work

API 47-069-00206 County OHIO District LIBERTY
Quad BETHANY Pad Name SHAWN COUCH-OHI-PAD1 Field/Pool Name PANHANDLE FIELD
Farm name SHAWN W. COUCH TRUST Well Number SHAWN COUCH OHI 10H
Operator (as registered with the OOG) SWN PRODUCTION COMPANY, LLC
Address PO BOX 12359 City SPRING State TX Zip 77391-2359

As Drilled location NAD 83/UTM Attach an as-drilled plat, profile view, and deviation survey
Top hole Northing 4,444,244.888 Easting 535,039.574
Landing Point of Curve Northing 4,456,828.926 Easting 535,465.094
Bottom Hole Northing 4,441,315.419 Easting 536,641.853

Elevation (ft) 1246.9' GL Type of Well New Existing Type of Report Interim Final
Permit Type Deviated Horizontal Horizontal 6A Vertical Depth Type Deep Shallow
Type of Operation Convert Deepen Drill Plug Back Redrilling Rework Stimulate
Well Type Brine Disposal CBM Gas Oil Secondary Recovery Solution Mining Storage Other _____
Type of Completion Single Multiple Fluids Produced Brine Gas NGL Oil Other _____
Drilled with Cable Rotary

Drilling Media Surface hole Air Mud Fresh Water Intermediate hole Air Mud Fresh Water Brine
Production hole Air Mud Fresh Water Brine
Mud Type(s) and Additive(s)
SOBM

RECEIVED
Office of Oil and Gas
JUL 3 2017
WV Department of Environmental Protection

Date permit issued 01/21/2016 Date drilling commenced 09/24/2016 Date drilling ceased 11/23/2016
Date completion activities began 02/20/2017 Date completion activities ceased 04/12/2014
Verbal plugging (Y/N) N Date permission granted N/A Granted by N/A

Please note: Operator is required to submit a plugging application within 5 days of verbal permission to plug

Freshwater depth(s) ft 300' Open mine(s) (Y/N) depths N
Salt water depth(s) ft 673' Void(s) encountered (Y/N) depths N
Coal depth(s) ft 466' Cavern(s) encountered (Y/N) depths N
Is coal being mined in area (Y/N) N

APPROVED
Reviewed by: _____
NAME: Eric Nevel
DATE: 9/12/17

API 47- 069 - 00206 Farm name SHAWN W. COUCH TRUST Well number SHAWN COUCH OHI 10H

| CASING STRINGS | Hole Size | Casing Size | Depth | New or Used | Grade wt/ft | Basket Depth(s) | Did cement circulate (Y/N) * Provide details below* |
|---------------------------|------------------|-------------|-------|-------------|-------------|-----------------|--|
| Conductor | 28 | 20 | | NEW | J-55/94# | | Y |
| Surface | 17.5 | 13.375 | | NEW | J-55/54.5# | | Y; 22 BBLS RETURNED |
| Coal | SEE INTERMEDIATE | | | | | | |
| Intermediate 1 | 12.25 | 9.625 | | NEW | J-55/40# | | Y; 32 BBLS RETURNED |
| Intermediate 2 | | | | | | | |
| Intermediate 3 | | | | | | | |
| Production | 8.75/8.50 | 5.5 | | NEW | HCP-110/20# | | Y |
| Tubing | | 2.375 | | NEW | L-80/4.7# | | N |
| Packer type and depth set | | | | | | | |

Comment Details _____

| CEMENT DATA | Class/Type of Cement | Number of Sacks | Slurry wt (ppg) | Yield (ft ³ /sks) | Volume (ft ³) | Cement Top (MD) | WOC (hrs) |
|----------------|----------------------|-----------------|-----------------|------------------------------|---------------------------|-----------------|-----------|
| Conductor | CLASS A | 435 | 15.70 | 1.20 | 100 | SURFACE | 24 |
| Surface | CLASS A | 410 | 15.60 | 1.20 | 492 | SURFACE | 8 |
| Coal | SEE INTERMEDIATE | | | | | | |
| Intermediate 1 | CLASS A | 720 | 15.60 | 1.20 | 864 | SURFACE | 8 |
| Intermediate 2 | | | | | | | |
| Intermediate 3 | | | | | | | |
| Production | CLASS A | 925/2130 | 15.60 | 1.23/1.19 | 1137.75/2534.70 | SURFACE | 24 |
| Tubing | | | | | | | |

Drillers TD (ft) 16,718' Loggers TD (ft) 16,718'
 Deepest formation penetrated MARCELLUS Plug back to (ft) N/A
 Plug back procedure _____

RECEIVED
Office of Oil and Gas

JUL 3 2017

Kick off depth (ft) 5,519'

WV Department of Environmental Protection

Check all wireline logs run caliper density deviated/directional induction
 neutron resistivity gamma ray temperature sonic

Well cored Yes No Conventional Sidewall Were cuttings collected Yes No

DESCRIBE THE CENTRALIZER PLACEMENT USED FOR EACH CASING STRING _____

SURFACE: 7 CENTRALIZERS - EVERY THIRD JOINT OF CASING
 INTERMEDIATE: 24 CENTRALIZERS - EVERY THIRD JOINT OF CASING
 PRODUCTION: 181 CENTRALIZERS - EVERY THIRD JOINT FROM SURFACE TO TOP OF CURVE, THEN EVERY JOINT UNTIL TD

WAS WELL COMPLETED AS SHOT HOLE Yes No DETAILS _____

WAS WELL COMPLETED OPEN HOLE? Yes No DETAILS _____

WERE TRACERS USED Yes No TYPE OF TRACER(S) USED _____

SHAWN COUCH OHI 10H
PERF SUMMARY

| STAGE NUM | Perf Date | Perf Top MD | Perf Bottom MD | # SHOTS PER STG |
|-----------|-----------|-------------|----------------|-----------------|
| 1 | 2/21/2017 | 16,503 | 16,600 | 42 |
| 2 | 2/21/2017 | 16,363 | 16,470 | 42 |
| 3 | 2/21/2017 | 16,223 | 16,330 | 42 |
| 4 | 2/21/2017 | 16,083 | 16,190 | 42 |
| 5 | 2/22/2017 | 15,943 | 16,050 | 42 |
| 6 | 2/22/2017 | 15,803 | 15,910 | 42 |
| 7 | 2/22/2017 | 15,663 | 15,770 | 42 |
| 8 | 2/22/2017 | 15,523 | 15,630 | 42 |
| 9 | 2/22/2017 | 15,383 | 15,490 | 42 |
| 10 | 2/23/2017 | 15,243 | 15,350 | 42 |
| 11 | 2/23/2017 | 15,103 | 15,210 | 42 |
| 12 | 2/23/2017 | 14,963 | 15,070 | 42 |
| 13 | 2/23/2017 | 14,823 | 14,930 | 42 |
| 14 | 2/23/2017 | 14,683 | 14,790 | 42 |
| 15 | 2/24/2017 | 14,543 | 14,650 | 42 |
| 16 | 2/24/2017 | 14,403 | 14,510 | 42 |
| 17 | 2/24/2017 | 14,263 | 14,370 | 42 |
| 18 | 2/24/2017 | 14,123 | 14,230 | 42 |
| 19 | 2/24/2017 | 13,983 | 14,090 | 42 |
| 20 | 2/25/2017 | 13,843 | 13,950 | 42 |
| 21 | 2/25/2017 | 13,703 | 13,810 | 42 |
| 22 | 2/25/2017 | 13,563 | 13,670 | 42 |
| 23 | 2/25/2017 | 13,426 | 13,530 | 42 |
| 24 | 2/25/2017 | 13,283 | 13,390 | 42 |
| 25 | 2/25/2017 | 13,143 | 13,250 | 42 |
| 26 | 2/26/2017 | 13,003 | 13,110 | 42 |
| 27 | 2/26/2017 | 12,863 | 12,970 | 42 |
| 28 | 2/26/2017 | 12,723 | 12,830 | 42 |
| 29 | 2/26/2017 | 12,583 | 12,690 | 42 |
| 30 | 2/27/2017 | 12,443 | 12,550 | 42 |
| 31 | 2/27/2017 | 12,303 | 12,410 | 42 |
| 32 | 2/27/2017 | 12,163 | 12,270 | 42 |
| 33 | 2/27/2017 | 12,023 | 12,130 | 42 |
| 34 | 2/27/2017 | 11,883 | 11,990 | 42 |
| 35 | 2/28/2017 | 11,743 | 11,850 | 42 |
| 36 | 2/28/2017 | 11,603 | 11,710 | 42 |
| 37 | 2/28/2017 | 11,463 | 11,570 | 42 |
| 38 | 2/28/2017 | 11,323 | 11,430 | 42 |
| 39 | 2/28/2017 | 11,183 | 11,290 | 42 |
| 40 | 2/28/2017 | 11,043 | 11,150 | 42 |
| 41 | 2/28/2017 | 10,903 | 11,010 | 42 |
| 42 | 3/1/2017 | 10,763 | 10,870 | 42 |
| 43 | 3/1/2017 | 10,623 | 10,730 | 42 |
| 44 | 3/1/2017 | 10,483 | 10,590 | 42 |
| 45 | 3/1/2017 | 10,343 | 10,450 | 42 |
| 46 | 3/2/2017 | 10,203 | 10,310 | 42 |

RECEIVED
Office of Oil and Gas

JUL 3 2017

WV Department of
Environmental Protection

SHAWN COUCH OHI 10H
PERF SUMMARY

| | | | | |
|----|----------|--------|--------|----|
| 47 | 3/2/2017 | 10,063 | 10,170 | 42 |
| 48 | 3/2/2017 | 9,923 | 10,030 | 42 |
| 49 | 3/3/2017 | 9,783 | 9,890 | 42 |
| 50 | 3/3/2017 | 9,643 | 9,750 | 42 |
| 51 | 3/3/2017 | 9,503 | 9,610 | 42 |
| 52 | 3/3/2017 | 9,363 | 9,470 | 42 |
| 53 | 3/3/2017 | 9,223 | 9,330 | 42 |
| 54 | 3/4/2017 | 9,083 | 9,190 | 42 |
| 55 | 3/4/2017 | 8,943 | 9,050 | 42 |
| 56 | 3/4/2017 | 8,803 | 8,910 | 42 |
| 57 | 3/4/2017 | 8,663 | 8,770 | 42 |
| 58 | 3/4/2017 | 8,523 | 8,630 | 42 |
| 59 | 3/4/2017 | 8,383 | 8,490 | 42 |
| 60 | 3/5/2017 | 8,243 | 8,350 | 42 |
| 61 | 3/5/2017 | 8,103 | 8,210 | 42 |
| 62 | 3/5/2017 | 7,963 | 8,070 | 42 |
| 63 | 3/5/2017 | 7,823 | 7,930 | 42 |
| 64 | 3/5/2017 | 7,683 | 7,790 | 42 |
| 65 | 3/6/2017 | 7,543 | 7,650 | 42 |
| 66 | 3/6/2017 | 7,403 | 7,510 | 42 |
| 67 | 3/6/2017 | 7,263 | 7,370 | 42 |
| 68 | 3/6/2017 | 7,123 | 7,230 | 42 |
| 69 | 3/6/2017 | 6,983 | 7,090 | 42 |
| 70 | 3/6/2017 | 6,843 | 6,950 | 42 |
| 71 | 3/7/2017 | 6,703 | 6,810 | 42 |
| 72 | 3/7/2017 | 6,563 | 6,670 | 42 |

RECEIVED
Office of Oil and Gas

JUL 3 2017

WV Department of
Environmental Protection

SHAWN COUCH OHI 10H
FRAC STAGE SUMMARY

| STAGE NUM | Stim Date | Ave Pump Rate (BPM) | Ave Treatment Pressure (PSI) | Max Breakdown Pressure (PSI) | ISIP (PSI) | Amount of Proppant (lbs) | Amount of water bbls | Amount of nitrogen/other |
|-----------|-----------|---------------------|------------------------------|------------------------------|------------|--------------------------|----------------------|--------------------------|
| 1 | 2/21/2017 | 95 | 7,921 | 8,204 | 4,424 | 500,780 | 9,267 | |
| 2 | 2/21/2017 | 94 | 8,112 | 8,865 | 4,686 | 500,240 | 9,436 | |
| 3 | 2/21/2017 | 96 | 8,071 | 8,540 | 4,826 | 502,880 | 8,580 | |
| 4 | 2/21/2017 | 100 | 8,181 | 8,713 | 5,251 | 500,600 | 7,748 | |
| 5 | 2/22/2017 | 100 | 8,193 | 8,669 | 4,875 | 502,300 | 8,004 | |
| 6 | 2/22/2017 | 97 | 8,089 | 8,423 | 4,912 | 500,040 | 7,874 | |
| 7 | 2/22/2017 | 100 | 8,198 | 8,682 | 5,215 | 500,180 | 7,803 | |
| 8 | 2/22/2017 | 100 | 7,989 | 8,590 | 4,907 | 505,080 | 7,896 | |
| 9 | 2/22/2017 | 98 | 8,250 | 9,080 | 5,021 | 501,580 | 7,613 | |
| 10 | 2/23/2017 | 101 | 8,087 | 8,472 | 4,983 | 500,000 | 8,627 | |
| 11 | 2/23/2017 | 99 | 8,135 | 8,461 | 5,089 | 500,100 | 7,751 | |
| 12 | 2/23/2017 | 100 | 8,308 | 8,696 | 4,862 | 503,160 | 7,598 | |
| 13 | 2/23/2017 | 101 | 8,256 | 8,700 | 5,111 | 500,680 | 7,507 | |
| 14 | 2/23/2017 | 100 | 7,939 | 8,585 | 4,706 | 500,880 | 7,361 | |
| 15 | 2/24/2017 | 100 | 8,033 | 8,385 | 4,828 | 501,040 | 7,759 | |
| 16 | 2/24/2017 | 98 | 7,982 | 8,478 | 4,685 | 501,300 | 7,563 | |
| 17 | 2/24/2017 | 100 | 8,022 | 8,262 | 4,408 | 502,980 | 7,392 | |
| 18 | 2/24/2017 | 99 | 8,133 | 8,876 | 4,692 | 502,120 | 9,153 | |
| 19 | 2/24/2017 | 102 | 7,841 | 8,412 | 4,723 | 500,580 | 7,098 | |
| 20 | 2/25/2017 | 100 | 7,828 | 8,526 | 4,823 | 499,280 | 7,597 | |
| 21 | 2/25/2017 | 100 | 8,123 | 8,389 | 4,989 | 488,820 | 7,686 | |
| 22 | 2/25/2017 | 98 | 7,999 | 8,480 | 4,999 | 499,260 | 7,654 | |
| 23 | 2/25/2017 | 99 | 7,901 | 8,529 | 4,890 | 502,820 | 7,326 | |
| 24 | 2/25/2017 | 99 | 7,922 | 8,386 | 4,597 | 500,880 | 7,229 | |
| 25 | 2/25/2017 | 100 | 7,926 | 8,335 | 4,602 | 500,000 | 7,704 | |
| 26 | 2/26/2017 | 99 | 8,031 | 8,603 | 4,736 | 500,090 | 7,664 | |
| 27 | 2/26/2017 | 98 | 7,952 | 8,418 | 4,795 | 500,060 | 7,535 | |
| 28 | 2/26/2017 | 97 | 8,170 | 8,611 | 4,673 | 500,040 | 7,188 | |
| 29 | 2/26/2017 | 100 | 7,975 | 8,323 | 4,788 | 500,000 | 7,097 | |
| 30 | 2/27/2017 | 99 | 7,996 | 8,327 | 4,473 | 500,120 | 7,765 | |
| 31 | 2/27/2017 | 100 | 7,800 | 8,703 | 4,699 | 500,940 | 7,449 | |
| 32 | 2/27/2017 | 100 | 7,675 | 8,020 | 4,563 | 500,020 | 7,488 | |
| 33 | 2/27/2017 | 100 | 7,807 | 8,325 | 4,610 | 500,000 | 7,028 | |
| 34 | 2/27/2017 | 101 | 7,519 | 8,184 | 4,603 | 500,000 | 7,166 | |
| 35 | 2/28/2017 | 98 | 7,803 | 8,366 | 4,671 | 500,000 | 7,050 | |
| 36 | 2/28/2017 | 100 | 7,541 | 7,856 | 4,658 | 500,040 | 7,275 | |
| 37 | 2/28/2017 | 99 | 7,552 | 8,305 | 4,332 | 500,060 | 7,311 | |
| 38 | 2/28/2017 | 101 | 7,453 | 8,163 | 4,747 | 500,080 | 7,226 | |
| 39 | 2/28/2017 | 7,633 | 7,633 | 8,246 | 4,586 | 499,320 | 7,023 | |
| 40 | 2/28/2017 | 7,285 | 7,285 | 7,622 | 4,463 | 500,080 | 6,987 | |
| 41 | 2/28/2017 | 100 | 6,861 | 8,085 | 4,565 | 496,540 | 8,606 | |
| 42 | 3/1/2017 | 101 | 7,341 | 8,143 | 4,602 | 500,340 | 7,196 | RECEIVED |
| 43 | 3/1/2017 | 101 | 7,302 | 8,294 | 4,580 | 500,000 | 7,071 | Office of Oil and Gas |
| 44 | 3/1/2017 | 100 | 7,131 | 8,567 | 4,555 | 500,860 | 6,925 | JUL 3 2017 |
| 45 | 3/1/2017 | 100 | 7,242 | 7,826 | 4,587 | 501,200 | 7,005 | |
| 46 | 3/2/2017 | 98 | 7,217 | 8,210 | 4,452 | 501,740 | 7,382 | WV Depart |
| 47 | 3/2/2017 | 100 | 7,339 | 7,981 | 4,574 | 500,080 | 7,040 | Environmental |
| 48 | 3/2/2017 | 100 | 7,319 | 7,758 | 4,579 | 500,060 | 6,935 | |
| 49 | 3/3/2017 | 100 | 7,399 | 7,964 | 4,414 | 497,340 | 6,983 | |
| 50 | 3/3/2017 | 101 | 7,499 | 8,522 | 4,619 | 502,340 | 7,445 | |
| 51 | 3/3/2017 | 100 | 7,471 | 8,378 | 4,620 | 500,880 | 8,406 | |
| 52 | 3/3/2017 | 98 | 7,097 | 7,581 | 4,761 | 499,840 | 7,013 | |
| 53 | 3/3/2017 | 100 | 7,635 | 8,288 | 4,602 | 503,040 | 7,434 | |
| 54 | 3/4/2017 | 101 | 7,319 | 8,318 | 4,683 | 500,100 | 6,859 | |
| 55 | 3/4/2017 | 100 | 6,975 | 7,439 | 4,752 | 501,960 | 7,213 | |
| 56 | 3/4/2017 | 100 | 7,498 | 8,310 | 4,284 | 498,600 | 7,190 | |
| 57 | 3/4/2017 | 101 | 7,081 | 7,641 | 4,412 | 500,077 | 6,975 | |
| 58 | 3/4/2017 | 100 | 7,056 | 7,690 | 4,439 | 500,094 | 6,866 | RECEIVED |
| 59 | 3/4/2017 | 101 | 7,361 | 8,040 | 4,445 | 500,047 | 6,727 | Office of Oil and Gas |
| 60 | 3/5/2017 | 100 | 7,189 | 8,420 | 4,428 | 500,020 | 7,069 | JUL 3 2017 |

WV Department of
Environmental Protection

SHAWN COUCH OHI 10H
FRAC STAGE SUMMARY

| | | | | | | | |
|----|----------|-----|-------|-------|-------|---------|-------|
| 61 | 3/5/2017 | 100 | 7,499 | 7,945 | 4,410 | 500,782 | 6,907 |
| 62 | 3/5/2017 | 100 | 7,605 | 7,993 | 4,580 | 500,110 | 6,864 |
| 63 | 3/5/2017 | 101 | 7,120 | 7,250 | 4,608 | 500,378 | 6,912 |
| 64 | 3/5/2017 | 100 | 7,494 | 8,255 | 4,431 | 500,217 | 7,416 |
| 65 | 3/6/2017 | 100 | 7,192 | 7,766 | 4,352 | 499,880 | 6,837 |
| 66 | 3/6/2017 | 101 | 7,392 | 7,880 | 4,422 | 499,824 | 6,991 |
| 67 | 3/6/2017 | 100 | 7,674 | 7,922 | 4,538 | 500,553 | 6,911 |
| 68 | 3/6/2017 | 100 | 7,501 | 8,225 | 4,502 | 500,047 | 6,536 |
| 69 | 3/6/2017 | 101 | 7,605 | 8,008 | 4,467 | 500,107 | 6,670 |
| 70 | 3/6/2017 | 100 | 7,265 | 7,930 | 4,434 | 500,040 | 6,529 |
| 71 | 3/7/2017 | 101 | 7,514 | 8,247 | 4,419 | 501,060 | 6,903 |
| 72 | 3/7/2017 | 101 | 7,276 | 8,288 | 4,613 | 500,140 | 6,766 |

RECEIVED
Office of Oil and Gas
JUL 3 2017
WV Department of
Environmental Protection

Well Name:

SHAWN COUCH OHI 10H

47069002060000

| LITHOLOGY/FORMATION | TOP DEPTH, MD (FT) | TOP DEPTH, TVD (FT) | BOTTOM DEPTH, MD (FT) | BOTTOM DEPTH, TVD (FT) | QUANTITY AND TYPE OF FLUID |
|---------------------|--------------------|---------------------|-----------------------|------------------------|----------------------------|
| Base of Fresh Water | N/A | N/A | 300.00 | 300.00 | |
| Top of Salt Water | 673.00 | 673.00 | N/A | N/A | |
| Pittsburgh Coal | 466.00 | 466.00 | 473.00 | 472.98 | |
| Big Injun (ss) | 1710.00 | 1707.80 | 1820.00 | 1817.38 | |
| Berea (siltstone) | 2170.00 | 2165.06 | 2224.00 | 2218.43 | |
| Rhinestreet (shale) | 5748.00 | 5635.72 | 6045.94 | 5894.26 | |
| Cashaqua (shale) | 6045.94 | 5894.26 | 300' | 5952.83 | |
| Middlesex (shale) | 6116.76 | 5952.83 | 6204.78 | 6021.39 | |
| Burket (shale) | 6204.78 | 6021.39 | 6233.83 | 6042.57 | |
| Tully (ls) | 6233.83 | 6042.57 | 6302.99 | 6089.36 | |
| Mahantango (shale) | 6302.99 | 6089.36 | 6575.58 | 6216.18 | |
| Marcellus (shale) | 6575.58 | 6216.18 | N/A | N/A | GAS |

RECEIVED
Office of Oil and Gas
JUL 3 2017
NY Department of
Environmental Conservation

Hydraulic Fracturing Fluid Product Component Information Disclosure

| | |
|--------------------------------|---------------------|
| Job Start Date: | 2/21/2017 |
| Job End Date: | 3/7/2017 |
| State: | West Virginia |
| County: | Ohio |
| API Number: | 47-069-00206-00-00 |
| Operator Name: | Southwestern Energy |
| Well Name and Number: | SHAWN COUCH OHI 10H |
| Latitude: | 40.14728000 |
| Longitude: | -80.58862000 |
| Datum: | NAD27 |
| Federal Well: | NO |
| Indian Well: | NO |
| True Vertical Depth: | 6,382 |
| Total Base Water Volume (gal): | 22,122,689 |
| Total Base Non Water Volume: | 0 |

RECEIVED
Office of Oil and Gas

JUL 3 2017

WV Department of
Environmental Protection



Hydraulic Fracturing Fluid Composition:

| Trade Name | Supplier | Purpose | Ingredients | Chemical Abstract Service Number (CAS #) | Maximum Ingredient Concentration in Additive (% by mass)** | Maximum Ingredient Concentration in HF Fluid (% by mass)** | Comments |
|-------------|--------------|--------------|-------------|--|--|--|-----------------|
| Fresh Water | Operator | Base Fluid | | | | | |
| | | | Water | 7732-18-5 | 100.00000 | 82.51745 | Density = 8.340 |
| Ingredients | Listed Above | Listed Above | | | | | |
| | | | Water | 7732-18-5 | 100.00000 | 1.32058 | |

| | | | | | | | |
|---|----------------|---------------------|--|--------------|--|--|---|
| HYDROCHLORIC ACID | Halliburton | Solvent | | | | | |
| | | | | Listed Below | | | |
| EC6486A | Nalco Champion | Scale Inhibitor | | | | | |
| | | | | Listed Below | | | |
| Bactron K-219 | Nalco Champion | Biocide | | | | | |
| | | | | Listed Below | | | RECEIVED Office of Oil and Gas JUL 3 2017 |
| SAND-COMMON WHITE - 100 MESH, 3307 LB BAG | Halliburton | Proppant | | | | | WV Department of Environmental Protection |
| | | | | Listed Below | | | |
| SAND-PREMIUM WHITE-40/70, BULK | Halliburton | Proppant | | | | | |
| | | | | Listed Below | | | |
| HAI-150E | Halliburton | Corrosion Inhibitor | | | | | |
| | | | | Listed Below | | | |
| FDP-S1176-15 | Halliburton | Friction Reducer | | | | | |
| | | | | Listed Below | | | |

Items above are Trade Names with the exception of Base Water . Items below are the individual ingredients.

| | | | | | | | |
|--|--|--|---|------------|-----------|----------|--|
| | | | Crystalline silica, quartz | 14808-60-7 | 100.00000 | 16.11269 | |
| | | | Hydrochloric acid | 7647-01-0 | 30.00000 | 0.76947 | |
| | | | Hydrotreated light petroleum distillate | 64742-47-8 | 30.00000 | 0.01907 | |

| | | | | | | | |
|--|--|--|--|-------------|-----------|---------|--|
| | | | Polyacrylate | Proprietary | 30.00000 | 0.01907 | |
| | | | Methanol | 67-56-1 | 60.00000 | 0.01122 | |
| | | | Quarternary Ammonium Compounds, Benzyl-C12-16-Alkyldimethyl, Chlorides | 68424-85-1 | 30.00000 | 0.00561 | |
| | | | Sodium chloride | 7647-14-5 | 5.00000 | 0.00318 | |
| | | | Sorbitan, mono-9-octadecenoate, (Z) | 1338-43-8 | 5.00000 | 0.00318 | |
| | | | Castor oil, ethoxylated | 61791-12-6 | 5.00000 | 0.00318 | |
| | | | 9-Octadecenamide, n,n-bis-2(hydroxy-ethyl)-(Z) | 93-83-4 | 5.00000 | 0.00318 | |
| | | | Ammonium chloride | 12125-02-9 | 5.00000 | 0.00318 | |
| | | | Ethylene Glycol | 107-21-1 | 30.00000 | 0.00150 | |
| | | | Amine Triphosphate | Proprietary | 30.00000 | 0.00150 | |
| | | | Non-hazardous food substance | Proprietary | 100.00000 | 0.00013 | Denise Tuck, Halliburton, 3000 N. Sam Houston Pkwy E., Houston, TX 77032, 281-871-6226 |

* Total Water Volume sources may include various types of water including fresh water, produced water, and recycled water

** Information is based on the maximum potential for concentration and thus the total may be over 100%

*** If you are calculating a percentage of total ingredients do not add the water volume below the green line to the water volume above the green line

Note: For Field Development Products (products that begin with FDP), MSDS level only information has been provided.

Ingredient information for chemicals subject to 29 CFR 1910.1200(i) and Appendix D are obtained from suppliers Material Safety Data Sheets (MSDS)

RECEIVED
Office of Oil and Gas

JUL 3 2017

WV Department of
Environmental Protection

THRASHER

THE THRASHER GROUP, INC.
600 WHITE OAKS BLVD.
BRIDGEPORT, WV 26330
PHONE 304-624-4108

NOTES ON SURVEY

- COORDINATES SYSTEM IS UTM, NAD 83 DATUM, ZONE 17, U.S. FOOT AND WELL COORDINATES ESTABLISHED USING SURVEY GRADE GPS.
- SURFACE AND ROYALTY OWNER INFORMATION AND THEIR BOUNDARIES SHOWN HEREON WERE PLOTTED FROM DEEDS AND/OR TAX PARCEL MAPS PROVIDED BY CLIENT AND FIELD LOCATIONS.
- THIS PLAT DOES NOT REPRESENT A BOUNDARY SURVEY OF THE PARCELS SHOWN HEREON.
- NO DWELLINGS AND BUILDINGS WITHIN 625 FEET OF PROPOSED CENTER OF PAD.
- NO WATER WELLS OR DEVELOPED SPRINGS WITHIN 250 FEET OF PROPOSED WELL.
- NO PERENNIAL STREAMS, LAKES, PONDS, RESERVOIRS OR WETLANDS WITHIN 100 FEET OF THE LIMITS OF DISTURBANCE.
- NO NATURALLY PRODUCING TROUT STREAM WITHIN 300 FEET OF LIMITS OF DISTURBANCE.

| LINE | DESCRIPTION | DISTANCE | DESCRIPTION | MONUMENT |
|------|---------------|----------|------------------|--------------------|
| L1 | N 10°39'32" E | 24.53' | SHL TO 069-00072 | EXISTING WELL HEAD |
| L2 | N 55°46'47" E | 28.02' | SHL TO 069-00105 | EXISTING WELL HEAD |
| L3 | N 87°42'37" W | 1705.67' | SHL TO LANDMARK | IRF FOUND |
| L4 | S 75°19'02" W | 1588.97' | SHL TO LANDMARK | IRF FOUND |
| L5 | S 83°08'14" E | 985.57' | SHL TO LP | LANDING POINT |

| TRACT | SURFACE OWNER | TAX PARCEL | ACRES |
|-------|------------------------------|------------------|---------|
| 1 | SHAWN W. COUCH TRUST | 3-L4011000000000 | 121.56 |
| 2 | PAUL & RHONDA TYRNA | 3-L4011400000000 | 1.24 |
| 3 | PENELOPE T. MILLER | 3-L4011700000000 | 139.51 |
| 4 | JAMES W. & HELEN L. LOEW | 3-L4011800020000 | 15.00 |
| 5 | KEVIN L. & RHONDA L. KIMMINS | 3-L4011800030000 | 29.00 |
| 6 | HERBERT P. & CAROL A. MINCH | 3-L4012000000000 | 190.721 |
| 7 | RONALD D. & MARY LEE FEKETE | 3-L7000500000000 | 40.18 |
| 8 | JOSEPH F. BIPPUS SR (ET AL) | 3-L8000100050000 | 96.315 |
| 9 | CHARLES E. DAGUE | 3-L8001400000000 | 2.399 |
| 10 | TUNNEL RIDGE, LLC | 3-L8001500000000 | 19.829 |
| 11 | THOMAS J. SCHMITT | 3-L8001600000000 | 15.350 |
| 12 | THOMAS J. SCHMITT | 3-L8001600100000 | 2.700 |

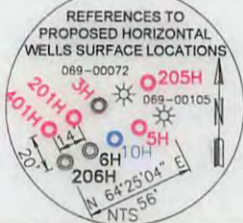

| LOCATION | UTM (NAD83, ZONE 17, METERS) | NORTHING | EASTING |
|--------------------------------------|-------------------------------|-------------------------|----------------------|
| SURFACE HOLE LOCATION (SHL): | | | |
| | UTM (NAD83, ZONE 17, METERS): | NORTHING: 4,444,244.888 | EASTING: 535,039.574 |
| | | NORTHING: 4,444,244.894 | EASTING: 535,039.583 |
| LANDING POINT LOCATION (LPL): | | | |
| | UTM (NAD83, ZONE 17, METERS): | NORTHING: 4,456,828.925 | EASTING: 535,465.094 |
| | | NORTHING: 4,444,196.053 | EASTING: 535,393.338 |
| BOTTOM HOLE LOCATION (BHL): | | | |
| | UTM (NAD83, ZONE 17, METERS): | NORTHING: 4,441,315.419 | EASTING: 536,541.853 |
| | | NORTHING: 4,441,802.905 | EASTING: 536,312.751 |

I, THE UNDERSIGNED, HEREBY CERTIFY THAT THIS PLAT IS CORRECT TO THE BEST OF MY KNOWLEDGE AND BELIEF AND SHOWS ALL THE INFORMATION REQUIRED BY LAW AND REGULATIONS ISSUED AND PRESCRIBED BY THE DEPARTMENT OF ENVIRONMENTAL PROTECTION.

P.S. 2270



(+) DENOTES LOCATION OF WELL ON UNITED STATES TOPOGRAPHIC MAPS
WVDEP
OFFICE OF OIL & GAS
601 57TH STREET
CHARLESTON, WV 25034

MINIMUM DEGREE OF ACCURACY: 1/200
PROVEN SURVEY SOURCE OF ELEVATION: GRADE GPS (NAVD 88, US FT)

COMPANY: **SWN** Production Company, LLC

SHAWN COUCH
OPERATOR'S WELL #: OHI 10H
API WELL #: 47 069 00206
STATE COUNTY PERMIT

WELL TYPE: OIL WASTE DISPOSAL PRODUCTION DEEP GAS LIQUID INJECTION STORAGE SHALLOW

WATERSHED: MCGRAW RUN
DISTRICT: LIBERTY COUNTY: OHIO
SURFACE OWNER: SHAWN W. COUCH TRUST
OIL & GAS ROYALTY OWNER: GEORGE W. COUCH

DRILL DRILL DEEPER REDRILL FRACTURE OR STIMULATE PLUG OFF OLD FORMATION PERFORATE NEW FORMATION

CONVERT PLUG & ABANDON CLEAN OUT & REPLUG OTHER CHANGE (SPECIFY) AS-DRILLED

TARGET FORMATION: MARCELLUS ESTIMATED DEPTH: 5,365 TVD 16,971 TMD

WELL OPERATOR: SWN PRODUCTION COMPANY, LLC
ADDRESS: P.O. BOX 1300
CITY: JANE LEW STATE: WV ZIP CODE: 26378

DESIGNATED AGENT: DEE SOUTHALL
ADDRESS: P.O. BOX 1300
CITY: JANE LEW STATE: WV ZIP CODE: 26378

| LEGEND: | REVISIONS: | DATE: |
|---------------------------------------|------------|----------------------|
| ○ PROPOSED SURFACE HOLE / BOTTOM HOLE | | 04-28-2017 |
| ⊙ EXISTING / PRODUCING WELLHEAD | | |
| ⊗ ABANDONED WELL | | |
| ⊕ PLUGGED & ABANDONED WELL | | |
| △ CUT CONDUCTOR | | |
| ⊙ EXISTING SPRING | | |
| ⊙ EXISTING WATER WELL | | |
| --- LEASE BOUNDARY | | |
| --- PROPOSED DHP | | |
| --- AS-DRILLED DHP | | |
| | | DRAWN BY: K. POTH |
| | | SCALE: 1" = 2000' |
| | | DRAWING NO: 050-5635 |
| | | WELL LOCATION PLAT |

THRASHER

THE THRASHER GROUP, INC.
600 WHITE OAKS BLVD.
BRIDGEPORT, WV 26330
PHONE 304-654-4108

NOTES ON SURVEY

1. COORDINATE SYSTEM IS UTM, NAD 83 DATUM, ZONE 17, U.S. FOOT AND WELL COORDINATES ESTABLISHED USING SURVEY GRADE GPS.
2. SURFACE AND ROYALTY OWNER INFORMATION AND THEIR BOUNDARIES SHOWN HEREON WERE PLOTTED FROM DEEDS AND/OR TAX PARCEL MAPS PROVIDED BY CLIENT AND FIELD LOCATIONS.
3. THIS PLAN DOES NOT REPRESENT A BOUNDARY SURVEY OF THE PARCELS SHOWN HEREON.
4. NO DWELLINGS AND BUILDINGS WITHIN 825 FEET OF PROPOSED OF CENTER OF PAD.
5. NO WATER WELLS OR DEVELOPED SPRINGS WITHIN 250 FEET OF PROPOSED WELL.
6. NO PERMANENT STREAMS, LAKES, PONDS, RESERVOIRS OR WETLANDS WITHIN 100 FEET OF THE LIMITS OF DISTURBANCE.
7. NO NATURALLY PRODUCING TIGHT STRATA WITHIN 300 FEET OF LIMITS OF DISTURBANCE.

| LINE | DESCRIPTION | DISTANCE | MONUMENT |
|------|------------------|----------|--------------------|
| L1 | SHL TO 089-00073 | 24.52' | EXISTING WELL HEAD |
| L2 | SHL TO 089-00102 | 28.03' | EXISTING WELL HEAD |
| L3 | SHL TO 089-00102 | 17.02' | RR FOUND |
| L4 | SHL TO 089-00102 | 25.12' | RR FOUND |
| L5 | SHL TO LP | 882.52' | LANDING POINT |

| TRACT | SURFACE OWNER | TAX PARCEL | ACRES |
|-------|------------------------------|-----------------|---------|
| 12 | THOMAS J. SCHMITT | 3-1800160010000 | 2.700 |
| 11 | THOMAS J. SCHMITT | 3-1800160000000 | 12.250 |
| 10 | TUNNEL RIDGE, LLC | 3-1800150000000 | 19.829 |
| 9 | CHARLES E. DACUS | 3-1800140000000 | 2.399 |
| 8 | JOSEPH F. BIRBUS SR (ET AL) | 3-1800100000000 | 88.319 |
| 7 | RONALD D. & MARY LEE FEKETE | 3-1000200000000 | 40.18 |
| 6 | HERBERT R. & CAROL A. MINCH | 3-1401300000000 | 190.731 |
| 5 | KEVIN J. & RHONDA L. KIMMINS | 3-1401800030000 | 29.00 |
| 4 | JAMES W. & HELEN J. LEW | 3-1401780002000 | 12.00 |
| 3 | PENICLOPE T. MILLER | 3-1401700000000 | 129.21 |
| 2 | PAUL & RYAN TYRAN | 3-1401740000000 | 1.24 |
| 1 | SHAWN W. COUCH TRUST | 3-1401700000000 | 121.28 |

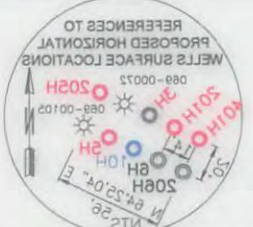

| LOCATION | EASTING | NORTHING |
|-------------------------------|-------------|---------------|
| BOTTOM HOLE LOCATION (BHL) | 535,292.378 | 4,444,198.023 |
| LANDING POINT LOCATION (L.P.) | 535,039.583 | 4,444,244.884 |
| SURFACE HOLE LOCATION (SHL) | 535,039.583 | 4,444,244.888 |

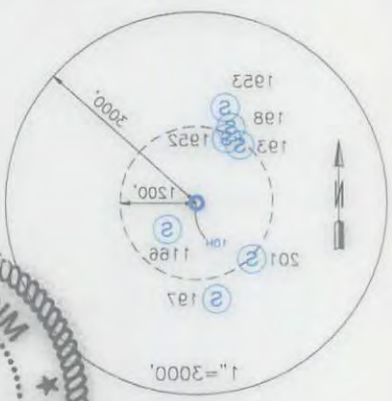

I, THE UNDERSIGNED, HEREBY CERTIFY THAT THIS PLAN IS CORRECT TO THE BEST OF MY KNOWLEDGE AND BELIEF AND SHOWS ALL THE INFORMATION REQUIRED BY LAW AND REGULATIONS ISSUED AND PRESCRIBED BY THE DEPARTMENT OF ENVIRONMENTAL PROTECTION.

P.2. 2270



COMPANY: **swm** Production Company, LLC

SHAWN COUCH
OHIO 10H
OPERATOR'S WELL #:
API WELL #:
STATE COUNTY PERMIT

WELL OPERATOR: SWM PRODUCTION COMPANY, LLC
ADDRESS: P.O. BOX 1300
CITY: JANE LEW STATE: WV ZIP CODE: 26378

DESIGNATED AGENT: DEE SOUTHLALL
ADDRESS: P.O. BOX 1300
CITY: JANE LEW STATE: WV ZIP CODE: 26378

WELL TYPE: OIL WASTE DISPOSAL PRODUCTION DEEP GAS LIQUID INJECTION STORAGE SHALLOW

WATERSHED: MCGRAW RUN

DISTRICT: LIBERTY COUNTY: OHIO

SURFACE OWNER: SHAWN W. COUCH TRUST
OIL & GAS ROYALTY OWNER: GEORGE W. COUCH

CONVERT PLUG & ABANDON CLEAN OUT & REPLUG OTHER CHANGE (SPECIFY AS-DRILLED) PERFORATE NEW FORMATION

DRILL DEEPER REDRILL FRACTURE OR STIMULATE PLUG OFF OLD FORMATION

TARGET FORMATION: MARCELLUS

ESTIMATED DEPTH: 6,385 TMD 18,971 TMD

| REVISIONS: | DATE: |
|------------|-------|
| 04-28-2017 | |

DRAWN BY: K. POTH
SCALE: 1" = 2000'
DRAWING NO: 020-2632
WELL LOCATION PLAN

LEGEND:

- PROPOSED SURFACE HOLE \ BOTTOM HOLE
- EXISTING \ PRODUCING WELLS
- ABANDONED WELL
- PLUGGED & ABANDONED WELL
- CUT CONDUCTOR
- AS-DRILLED DHP
- PROPOSED DHP
- LEASE BOUNDARY
- EXISTING WATER WELL
- EXISTING SPRING

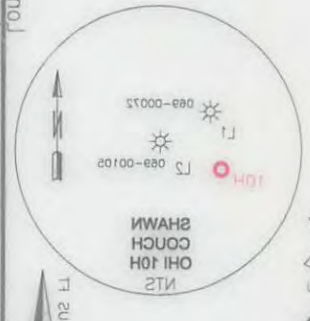
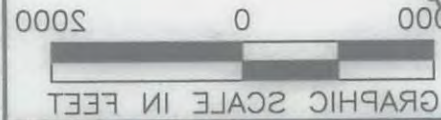



THE THRASHER GROUP, INC.
600 WHITE OAKS BLVD.
BRIDGEPORT, WV 26330
PHONE 304-624-4108

ADJOINING OWNER INSET

| TRACT | SURFACE OWNER | TAX PARCEL | ACRES |
|-------|---|------------------|--------|
| A | SHAWN W. COUCH TRUST | 3-L4011000010000 | 1.16 |
| B | STEVEN M. MCGLUMPHEY | 3-L4011000030000 | 189.84 |
| C | ROBERT E. DUVALL & E. C. DUVALL | 3-L4011100000000 | 0.34 |
| D | MARK P. KAUFMAN & ANNELIESE KAUFMAN | 3-L5000200000000 | 102.08 |
| E | TODD E. PORTER | 3-L4012500000000 | 0.53 |
| F | WILLIAM S. PATTERSON, JR. | 3-L4011500000000 | 3.00 |
| G | MARK E. NORMAN | 3-L4011000020000 | 2.44 |
| H | WILBERT A. UPTON & GWEN ANN UPTON | 3-L4011600020000 | 1.11 |
| I | WILLIAM A. BENSON & LORI L. BOHENKO | 3-L4001600050000 | 2.11 |
| J | STEVEN J. MINTER & SANDRA W. MINTER | 3-L5001700000000 | 1.20 |
| K | DAVID A. GILBERT SR. & PAULA A. GILBERT | 3-L4011900020000 | 3.00 |
| L | ROBERT SORSBY | 3-L5003300000000 | 3.05 |
| M | ROBERT SORSBY | 3-L5003300010000 | 3.05 |
| N | DONALD T. PIKO | 3-L5001600000000 | 10.91 |
| O | DAVID ALAN BELLANCO & DEBRA KAY BELLANCO | 3-L5002000110000 | 2.87 |
| P | JOSEPH F. BIPPUS SR., ET AL | 3-L5002000010000 | 205.22 |
| Q | TUNNEL RIDGE LLC | 3-L4012000030000 | 6.12 |
| R | SARAH A. PORTER, ET AL | 3-L8000300000000 | 108.00 |
| S | HOWELL LAND GROUP | 3-L8001300000000 | 75.37 |
| T | ALBERT T. DAGUE & BEATRICE V. DAGUE | 3-L8000210000000 | 6.59 |
| U | TUNNEL RIDGE LLC | 3-L8001500010000 | 3.77 |
| V | JAY T. MAUCK & MELISSA J. MAUCK | 3-L8002200000000 | 5.86 |
| W | DANIEL MCKEE | 3-L8002300000000 | 4.11 |
| X | DANIEL MCKEE | 3-L8002400080000 | 9.26 |
| Y | COREY M. SOBOTA | 3-L8002400000000 | 4.00 |
| Z | JOSEPH F. BIPPUS SR., ET AL | 3-L8000100000000 | 0.42 |
| AA | MILO H. CRISWELL | 3-L7000600030000 | 27.08 |
| BB | JOSEPH F. BIPPUS SR. & ICY M. BIPPUS (LIFE ESTATE); JOSEPH S. BIPPUS JR., MARY FEKETE & BETTY ANN SMITH (REMAINDERMEN) | 3-L8000100040000 | 1.00 |
| CC | JOSEPH F. BIPPUS SR. & ICY M. BIPPUS (LIFE ESTATE); JOSEPH S. BIPPUS JR., MARY FEKETE & BETTY ANN SMITH (REMAINDERMEN) | 3-L8000100030000 | 1.45 |
| DD | RONALD D. FEKETE & M. L. FEKETE | 3-L8000100010000 | 4.09 |
| EE | RUSSEL E. MYERS & BETTY JANE MYERS | 3-L7000960000000 | 10.69 |
| FF | WENDY J. DAVIS | 3-L7000600020000 | 2.49 |
| GG | RICHARD J. SCHNELLE & CALVIN W. SCHNELLE | 3-L7000500010000 | 4.81 |
| HH | RICHARD J. SCHNELLE & CALVIN W. SCHNELLE | 3-L7000800000000 | 2.00 |
| II | WAYNE L. WILHELM & M. B. WILHELM | 3-L7000400000000 | 184.76 |
| JJ | B. A. FARMER (LIFE ESTATE); CINDY L. LINTON | 3-L7005000000000 | 1.00 |
| KK | CARL HARTLIEB & ELSIE HARTLIEB | 3-L4012000010000 | 1.29 |
| LL | HERBERT P. MINCH JR. & C. A. MINCH | 3-L4012000020000 | 1.45 |
| MM | EDWARD L. STUPAK & B. W. STUPAK | 3-L4011800010000 | 23.60 |
| NN | KEVIN L. KIMMINS & RHONDA L. KIMMINS | 3-L4011800000000 | 33.39 |
| OO | LEE C. PAULL III & JUNE W. PAULL | 3-L4010900000000 | 204.00 |
| PP | JOHN C. MYERS & A.F. MYERS | 3-L4010700000000 | 3.68 |
| OO | HOLLAND PARK LIMITED LIABILITY | 3-L4010500000000 | 141.82 |
| RR | WINDSOR POWER HOUSE COAL COMPANY | 3-L4010500070000 | 3.81 |
| SS | B. G. RIDLER & J. M. TALLMON | 3-L4011300000000 | 1.03 |
| TT | DONALD E. GILBERT JR. | 3-L4011200000000 | 0.71 |
| UU | B. G. RIDLER & J. M. TALLMON | 3-L4010600000000 | 1.06 |
| VV | DIXIE M. LAUDERMILT & L. LAUDERMILT | 3-L4010000010000 | 0.19 |
| WW | JOSEPH F. BIPPUS, SR. & C. L. BIPPUS | 3-L8000100020000 | 2.99 |
| XX | HOWELL LAND GROUP, LLC | 3-L8000180000000 | 1.67 |
| YY | KIMBERLY A. WELLMAN | 3-L8000180010000 | 1.50 |
| ZZ | TUNNEL RIDGE, LLC | 3-L8000190000000 | 5.98 |
| AAA | JEFFREY J. EISENHAEUER & JOLENE M. EISENHAEUER | 3-L8000200000000 | 3.66 |
| BBB | HOWARD J. HAGLOCK & STEPHANIE C. HAGLOCK | 3-L8000170000000 | 0.816 |

| | |
|------------|----------------------|
| COMPANY: | |
| REVISIONS: | 04-28-2017 |
| | DRAWN BY: K. POTH |
| | SCALE: |
| | DRAWING NO: 050-5635 |
| | WELL LOCATION PLAT |

| TRACT | SUBPAC OWNER | TAX PARCEL | ACRES |
|-------|---|-----------------|--------|
| AAA | HOWARD J. HAGLOCK & STEPHANIE C. HAGLOCK | 3-1800017000000 | 0.816 |
| AA | JEFFREY J. EISENHÄUER & JOLENE M. EISENHÄUER | 3-1800020000000 | 2.66 |
| YY | TUNNEL RIDGE, LLC | 3-1800018001000 | 1.50 |
| XX | KIMBERLY A. WELLMAN | 3-1800018001000 | 1.50 |
| WV | HOWELL LAND GROUP, LLC | 3-1800018000000 | 1.87 |
| WW | JOSEPH F. BIRPUS, SR. & C. L. BIRPUS | 3-1800010005000 | 2.99 |
| VV | DIXIE M. LAUDERMILT & J. LAUDERMILT | 3-1401000001000 | 0.19 |
| UU | B. G. RIDLER & J. M. TATLUM | 3-1401080000000 | 1.08 |
| TT | DOMALD E. GILBERT, JR. | 3-1401120000000 | 0.71 |
| SS | B. G. RIDLER & J. M. TATLUM | 3-1401120000000 | 1.03 |
| RR | WINDSOR POWER HOUSE COAL COMPANY | 3-1401050007000 | 3.81 |
| QQ | HOLLAND PARK LIMITED LIABILITY | 3-1401020000000 | 141.83 |
| PP | JOHN C. MEYER & A.F. MEYER | 3-1401070000000 | 3.88 |
| OO | LEE C. PAUL III & JUNE W. PAUL | 3-1401090000000 | 204.00 |
| NI | KEVIN L. KIMMINS & RHONDA L. KIMMINS | 3-1401180000000 | 23.29 |
| MM | EDWARD L. STUPAK & B. W. STUPAK | 3-1401180001000 | 23.80 |
| LL | HERBERT P. MINCH, JR. & C. A. MINCH | 3-1401200002000 | 1.45 |
| KK | CARL HARTLEB & ELSIE HARTLEB | 3-1401200001000 | 1.59 |
| JJ | B. A. FARMER (LIFE ESTATE); CINDY L. LINTON | 3-1401200000000 | 1.00 |
| II | WAYNE J. WILHELM & M. B. WILHELM | 3-1400040000000 | 184.28 |
| HH | RICHARD J. SCHNELLE & CALVIN W. SCHNELLE | 3-1400080000000 | 2.00 |
| GG | RICHARD J. SCHNELLE & CALVIN W. SCHNELLE | 3-1400080001000 | 4.81 |
| FF | WENDY J. DAVIS | 3-1400080002000 | 2.49 |
| EE | RUSSEL E. MYERS & BETTY JANE MYERS | 3-1400080000000 | 10.89 |
| DD | RONALD D. FEKETE & M. J. FEKETE | 3-1800010001000 | 4.09 |
| CC | JOSEPH F. BIRPUS, SR. & ICY M. BIRPUS (LIFE ESTATE); JOSEPH S. BIRPUS, JR. & BETTY ANN SMITH (REMARKS) | 3-1800010002000 | 1.42 |
| BB | JOSEPH F. BIRPUS, SR. & ICY M. BIRPUS (LIFE ESTATE); JOSEPH S. BIRPUS, JR. & BETTY ANN SMITH (REMARKS) | 3-1800010003000 | 1.00 |
| AA | MILO H. CRISWELL | 3-1400060002000 | 23.08 |
| Z | JOSEPH F. BIRPUS, SR., ET AL. | 3-1800010000000 | 0.42 |
| Y | COREY M. SOBOTA | 3-1800340000000 | 4.00 |
| X | DANIEL MCKEE | 3-1800340008000 | 9.58 |
| W | DANIEL MCKEE | 3-1800340000000 | 4.11 |
| V | JAY T. MAUCK & MELISSA J. MAUCK | 3-1800320000000 | 5.86 |
| U | TUNNEL RIDGE, LLC | 3-1800120001000 | 2.77 |
| T | ALBERT T. DAGUE & BEATRICE V. DAGUE | 3-1800021000000 | 8.59 |
| S | HOWELL LAND GROUP | 3-1800130000000 | 25.27 |
| R | SARAH A. PORTER, ET AL. | 3-1800030000000 | 108.00 |
| Q | TUNNEL RIDGE, LLC | 3-1401200002000 | 6.12 |
| P | JOSEPH F. BIRPUS, SR., ET AL. | 3-1800200001000 | 202.22 |
| O | DAVID ALAN BELLANCO & DEBRA KAY BELLANCO | 3-1800200011000 | 2.87 |
| N | DONALD T. PIKO | 3-1800180000000 | 10.91 |
| M | ROBERT SORSBY | 3-1800330001000 | 2.02 |
| L | ROBERT SORSBY | 3-1800330000000 | 2.02 |
| K | DAVID A. GILBERT, SR. & PAULA A. GILBERT | 3-1401180003000 | 2.00 |
| J | STEVEN J. MINTER & SANDRA W. MINTER | 3-1800170000000 | 1.20 |
| I | WILLIAM A. BENSON & LORI L. BOHENKO | 3-1400180008000 | 2.11 |
| H | WILBERT A. UPTON & GWEN ANN UPTON | 3-1401180002000 | 1.11 |
| G | MARK E. NORMAN | 3-1401180003000 | 2.44 |
| F | WILLIAM S. PATTERSON, JR. | 3-1401120000000 | 2.00 |
| E | TODD E. PORTER | 3-1401250000000 | 0.23 |
| D | MARK P. KAUFMAN & ANNELEISE KAUFMAN | 3-1800020000000 | 102.08 |
| C | ROBERT E. DUVAL & E. C. DUVAL | 3-1401110000000 | 0.24 |
| B | STEVEN M. MCGILMURPHY | 3-1401100003000 | 189.84 |
| A | SHAWN W. COUCH TRUST | 3-1401100001000 | 1.18 |

COMPANY: SWN Production Company, LLC

SWN Production Company, LLC

REVISIONS: 04-28-2017

DRAWN BY: K. POTH

SCALE:

DRAWING NO: 020-2635

WELL LOCATION PLAT