



west virginia department of environmental protection

Office of Oil and Gas  
601 57<sup>th</sup> Street, S.E.  
Charleston, WV 25304  
(304) 926-0450  
fax: (304) 926-0452

Jim Justice , Governor  
Austin Caperton , Cabinet Secretary  
www.dep.wv.gov

Monday, May 08, 2017  
WELL WORK PERMIT  
Horizontal 6A / New Drill

SWN PRODUCTION COMPANY, LLC (A)  
POST OFFICE BOX 12359

SPRING, TX 773914954

Re: Permit approval for MELVIN KAHLE OHI 6H  
47-069-00224-00-00

This well work permit is evidence of permission granted to perform the specified well work at the location described on the attached pages and located on the attached plat, subject to the provisions of Chapter 22 of the West Virginia Code of 1931, as amended, and all rules and regulations promulgated thereunder, and to any additional specific conditions and provisions outlined in the pages attached hereto. Notification shall be given by the operator to the Oil and Gas Inspector at least 24 hours prior to the construction of roads, locations, and/or pits for any permitted work. In addition, the well operator shall notify the same inspector 24 hours before any actual well work is commenced and prior to running and cementing casing. Spills or emergency discharges must be promptly reported by the operator to 1-800-642-3074 and to the Oil and Gas Inspector.

Please be advised that form WR-35, Well Operators Report of Well Work is to be submitted to this office within 90 days of completion of permitted well work, as should form WR-34 Discharge Monitoring Report within 30 days of discharge of pits, if applicable. Failure to abide by all statutory and regulatory provisions governing all duties and operations hereunder may result in suspension or revocation of this permit and, in addition, may result in civil and/or criminal penalties being imposed upon the operators.

Per 35 CSR 4-5.2.g this permit will expire in two (2) years from the issue date unless permitted well work is commenced. If there are any questions, please feel free to contact me at (304) 926- 0450.

James A. Martin  
Chief

Operator's Well Number: MELVIN KAHLE OHI 6H  
Farm Name: KAHLE, MELVIN W. & CAROL M.  
U.S. WELL NUMBER: 47-069-00224-00-00  
Horizontal 6A / New Drill  
Date Issued: 5/8/2017

Promoting a healthy environment.

05/12/2017

# PERMIT CONDITIONS

West Virginia Code § 22-6A-8(d) allows the Office of Oil and Gas to place specific conditions upon this permit. Permit conditions have the same effect as law. Failure to adhere to the specified permit conditions may result in enforcement action.

## CONDITIONS

---

1. This proposed activity may require permit coverage from the United States Army Corps of Engineers (USACE). Through this permit, you are hereby being advised to consult with USACE regarding this proposed activity.
2. If the operator encounters an unanticipated void, or an anticipated void at an unanticipated depth, the operator shall notify the inspector within 24 hours. Modifications to the casing program may be necessary to comply with W. Va. Code § 22-6A-5a (12), which requires drilling to a minimum depth of thirty feet below the bottom of the void, and installing a minimum of twenty (20) feet of casing. Under no circumstance should the operator drill more than one hundred (100) feet below the bottom of the void or install less than twenty (20) feet of casing below the bottom of the void.
3. When compacting fills, each lift before compaction shall not be more than 12 inches in height, and the moisture content of the fill material shall be within limits as determined by the Standard Proctor Density test of the actual soils used in specific engineered fill, ASTM D698, Standard Test Method for Laboratory Compaction Characteristics of Soil Using Standard Effort, to achieve 95 % compaction of the optimum density. Each lift shall be tested for compaction, with a minimum of two tests per lift per acre of fill. All test results shall be maintained on site and available for review.
4. Operator shall install signage per § 22-6A-8g (6) (B) at all source water locations included in their approved water management plan within 24 hours of water management plan activation.
5. Oil and gas water supply wells will be registered with the Office of Oil and Gas and all such wells will be constructed and plugged in accordance with the standards of the Bureau for Public Health set forth in its Legislative rule entitled *Water Well Regulations*, 64 C.S.R. 19. Operator is to contact the Bureau of Public Health regarding permit requirements. In lieu of plugging, the operator may transfer the well to the surface owner upon agreement of the parties. All drinking water wells within fifteen hundred feet of the water supply well shall be flow tested by the operator upon request of the drinking well owner prior to operating the water supply well.
6. Pursuant to the requirements pertaining to the sampling of domestic water supply wells/springs the operator shall, no later than thirty (30) days after receipt of analytical data provide a written copy to the Chief and any of the users who may have requested such analyses.
7. 24 hours prior to the initiation of the completion process the operator shall notify the Chief or his designee.
8. During the completion process the operator shall monitor annular pressures and report any anomaly noticed to the chief or his designee immediately.
9. If any explosion or other accident causing loss of life or serious personal injury occurs in or about a well or well work on a well, the well operator or its contractor shall give notice, stating the particulars of the explosion or accident, to the oil and gas inspector and the Chief, within 24 hours of said accident.
10. During the casing and cementing process, in the event cement does not return to the surface, the oil and gas inspector shall be notified within 24 hours.

## PERMIT CONDITIONS

11. The operator shall provide to the Office of Oil and Gas the dates of each of the following within 30 days of their occurrence: completion of construction of the well pad, commencement of drilling, cessation of drilling, completion of any other permitted well work, and completion of the well. Such notice shall be provided by sending an email to [DEPOOGNotify@wv.gov](mailto:DEPOOGNotify@wv.gov).

4706900224

WW-6B  
(04/15)

API NO. 47-069  
OPERATOR WELL NO. Melvin Kahle OHI 6H  
Well Pad Name: Melvin Kahle OHI

STATE OF WEST VIRGINIA  
DEPARTMENT OF ENVIRONMENTAL PROTECTION, OFFICE OF OIL AND GAS  
WELL WORK PERMIT APPLICATION

- 1) Well Operator: SWN Production Co., LLC 494512924 69- Ohio 6- Triad 674- Wheeling  
Operator ID County District Quadrangle
- 2) Operator's Well Number: Melvin Kahle OHI 6H Well Pad Name: Melvin Kahle OHI
- 3) Farm Name/Surface Owner: Melvin W. & Carol M. Kahle Public Road Access: Chapel Hill Road
- 4) Elevation, current ground: 1276' Elevation, proposed post-construction: 1276'
- 5) Well Type (a) Gas  Oil  Underground Storage   
Other   
(b) If Gas Shallow  Deep   
Horizontal
- 6) Existing Pad: Yes or No Yes *3-6-17*
- 7) Proposed Target Formation(s), Depth(s), Anticipated Thickness and Expected Pressure(s):  
Target Formation- Marcellus, Target Top TVD- 6312', Target Base TVD- 6350', Anticipated Thickness- 38', Associated Pressure- 4106
- 8) Proposed Total Vertical Depth: 6348'
- 9) Formation at Total Vertical Depth: Marcellus
- 10) Proposed Total Measured Depth: 11857'
- 11) Proposed Horizontal Leg Length: 5113.43'
- 12) Approximate Fresh Water Strata Depths: 336'
- 13) Method to Determine Fresh Water Depths: WR-35 completion report and from nearby water wells
- 14) Approximate Saltwater Depths: 766'
- 15) Approximate Coal Seam Depths: 604'
- 16) Approximate Depth to Possible Void (coal mine, karst, other): May encounter void at 600' (Abandoned Mine)
- 17) Does Proposed well location contain coal seams directly overlying or adjacent to an active mine? Yes  No
- (a) If Yes, provide Mine Info: Name: \_\_\_\_\_  
Depth: \_\_\_\_\_  
Seam: \_\_\_\_\_  
Owner: \_\_\_\_\_

RECEIVED  
Office of Oil and Gas

MAR 09 2017

Page 1 of 3  
WV Department of  
Environmental Protection

05/12/2017

WW-6B  
(04/15)

API NO. 47-069  
OPERATOR WELL NO. Melvin Kahle OH# 6H  
Well Pad Name: Melvin Kahle OH#

18) CASING AND TUBING PROGRAM

TYPE	Size (in)	New or Used	Grade	Weight per ft. (lb/ft)	FOOTAGE: For Drilling (ft)	INTERVALS: Left in Well (ft)	CEMENT: Fill-up (Cu. Ft.)/CTS
Conductor	20"	New	H-40	94#	100'	100'	CTS
Fresh Water	13 3/8"	New	H-40	48#	436'	436'	423 sx/CTS
Coal	9 5/8"	New	J-55	36#	1999'	1999'	771 sx/CTS
Intermediate	7"	New	HCP-110	20#	If Needed	If Needed	If Needed/As Needed
Production	5 1/2"	New	HCP-110	20#	11857'	11857'	11857' / 11857' / 11857'
Tubing	2 3/8"	New	P-110	4.7#	Approx. 6317'	Approx. 6317'	
Liners							

*E. 2820 3-6-17*

TYPE	Size (in)	Wellbore Diameter (in)	Wall Thickness (in)	Burst Pressure (psi)	Anticipated Max. Internal Pressure (psi)	Cement Type	Cement Yield (cu. ft./k)
Conductor	20"	30"	0.25	2120	81	Class A	1.19/50% Excess
Fresh Water	13 3/8"	17.5"	0.380	2740	633	Class A	1.19/50% Excess
Coal	9 5/8"	12 1/4"	0.395	3950	1768	Class A	1.19/50% Excess
Intermediate	7"	8 3/4"	0.317	4360	3250	Class A	1.20/50% Excess
Production	5 1/2"	8 3/4"	0.361	12360	9500	Class A	1.20/50% Excess
Tubing	2 3/8"	4.778"	0.190	Approx 8193'	Approx 8193'		
Liners							

PACKERS

Kind:	10K Arrowset AS-1X			
Sizes:	5 1/2"			
Depths Set:				

19) Describe proposed well work, including the drilling and plugging back of any pilot hole:

Drill and stimulate any potential zones between and including the Benson to Marcellus. \*\*If we should encounter a void place basket above and below void area- balance cement to bottom of void and grout from basket to surface. Run casing not less than 20' below void nor more than 50' below void. (\*If freshwater is encountered deeper than anticipated it must be protected, set casing 50' below and cts.)

20) Describe fracturing/stimulating methods in detail, including anticipated max pressure and max rate:

Well will be perforated within the target formation and stimulated with a slurry of water, sand, and chemical additives at a high rate. This will be performed in stages with the plug and perf method along the wellbore until the entire lateral has been stimulated within the target formation. All stage plugs are then drilled out and the well is flowed back to surface. The well is produced through surface facilities consisting of high pressure production unites, vertical separation units, water and oil storage tanks. Max press and anticipated max rate- 9000 lbs @ 80 barrels a minute.

21) Total Area to be disturbed, including roads, stockpile area, pits, etc., (acres): 8.14

22) Area to be disturbed for well pad only, less access road (acres): 7.17

23) Describe centralizer placement for each casing string:

All casing strings will be ran with a centralizer at a minimum of 1 per every 3 joints of casing.

24) Describe all cement additives associated with each cement type:

See Attachment \*\*\*

25) Proposed borehole conditioning procedures:

All boreholes will be conditioned with circulation and rotation for a minimum of one bottoms up and continuing until operator is satisfied with borehole conditions.

RECEIVED  
Office of Oil and Gas  
MAR 09 2017  
WV Department of  
Environmental Protection

\*Note: Attach additional sheets as needed.

## Schlumberger Cement Additives

	Product Name	Product Use	Chemical Name	CAS Number
Kick Off Plug	S001	accelerator	calcium chloride	10043-52-4
	S001	accelerator	calcium chloride	10043-52-4
Production-Lead	D080	dispersant	sodium polynaphthalene sulfonate	9008-63-3
	D801	retarder	aromatic polymer derivative	proprietary
	D047	antifoam	polypropylene glycol	25322-69-4
	D167	fluid loss	aliphatic amide polymer	proprietary
	D154	extender	non-crystalline silica	7631-86-9
	D400	gas migration	boric acid	10043-35-3
	D046	antifoam	polypropylene glycol	25322-69-4
			fullers earth (attapulgate)	8031-18-3
			chrystalline silica	14808-60-7
			metal oxide	proprietary
Production-Tail	D201	retarder	metal oxide	proprietary
	D202	dispersant	sulphonated synthetic polymer	proprietary
			formaldehyde (impurity)	proprietary
	D046	antifoam	polypropylene glycol	25322-69-4
			fullers earth (attapulgate)	8031-18-3
	D167	fluid loss	aliphatic amide polymer	proprietary
	D065	dispersant	sodium polynaphthalene sulfonate	9008-63-3
			sodium sulfate	7757-82-6
		chrystalline silica	14808-60-7	
		metal oxide	proprietary	
		chrystalline silica	14808-60-7	

RECEIVED  
Office of Oil and Gas  
MAR 09 2017  
WV Department of  
Environmental Protection

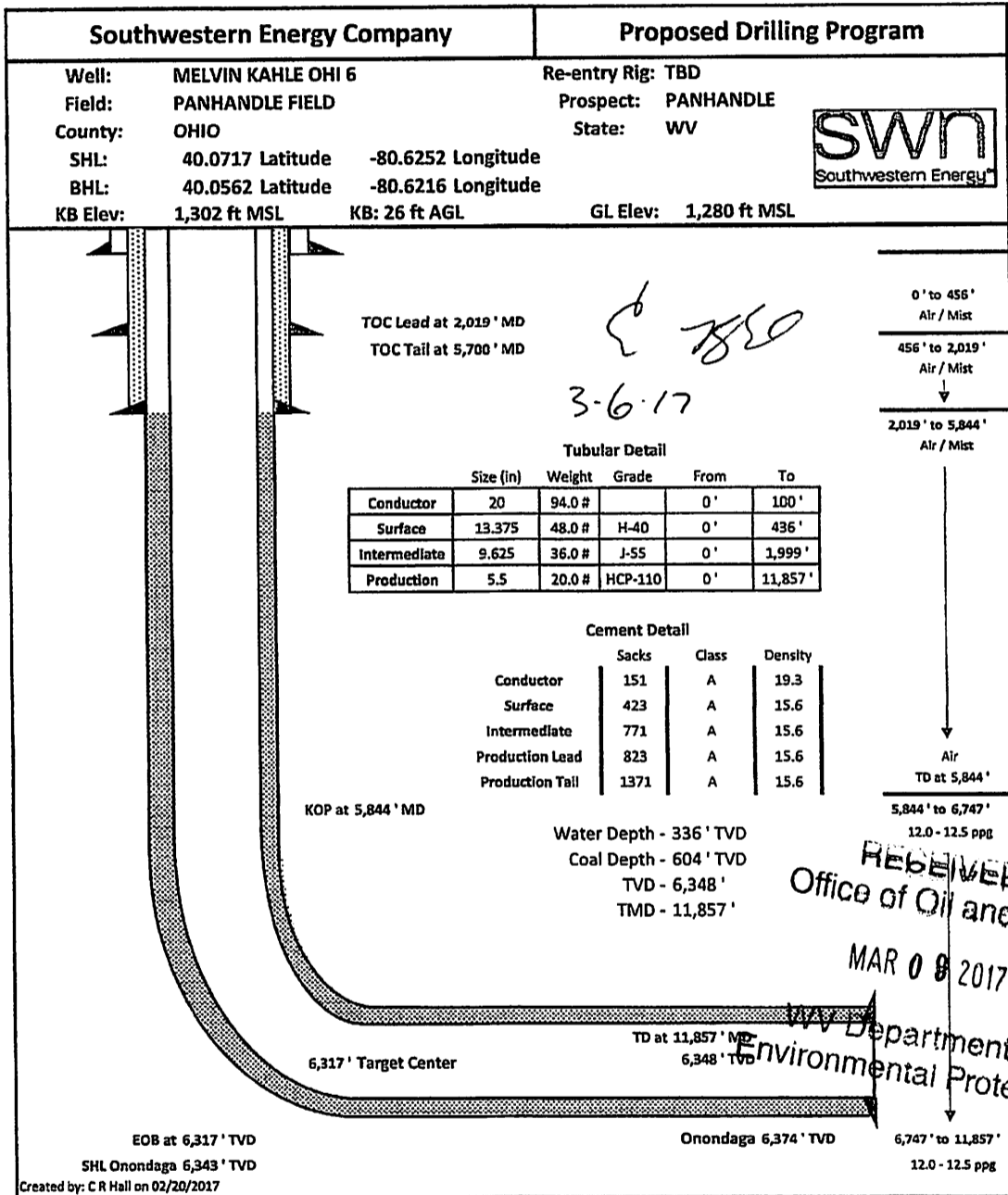



4706900224



SWN Production Company, LLC  
P O Box 12359  
Spring, Texas 77391-2359  
www.swn.com

March 2, 2017

Ms. Laura Adkins  
Office of Oil & Gas  
601 57<sup>th</sup> Street  
Charleston, WV 25304

**RE:** Proposed New Well: Melvin Kahle OHI 6H

Dear Ms. Adkins

SWN has reviewed the area of the above mentioned well and discovered no shallow wells within 500' of the lateral. This well is situated on the Kahles's property, in Triadelphia District, Ohio County, West Virginia.

If you have any questions or desire additional information, please me at 304-884-1614

Thank you.

Sincerely,

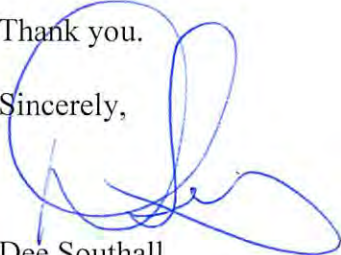

Dee Southall  
Regulatory Supervisor  
Southwestern Energy Production Company, LLC  
PO Box 1300  
Jane Lew, WV 26378

RECEIVED  
Office of Oil and Gas  
MAR 09 2017  
WV Department of  
Environmental Protection  
R  
A

WW-9  
(4/16)

4706900224

API Number 47 - 69 -  
Operator's Well No. Melvin Kale OHI 6H

STATE OF WEST VIRGINIA  
DEPARTMENT OF ENVIRONMENTAL PROTECTION  
OFFICE OF OIL AND GAS

FLUIDS/ CUTTINGS DISPOSAL & RECLAMATION PLAN

Operator Name SWN Production Company, LLC OP Code 494512924

Watershed (HUC 10) Upper Ohio South Quadrangle Wheeling

Do you anticipate using more than 5,000 bbls of water to complete the proposed well work? Yes  No

Will a pit be used? Yes  No

If so, please describe anticipated pit waste: closed loop system in place at this time- cuttings will be taken to a permitted landfill

Will a synthetic liner be used in the pit? Yes  No  If so, what ml.?

Proposed Disposal Method For Treated Pit Wastes:

- Land Application
- Underground Injection ( UIC Permit Number \_\_\_\_\_ )
- Reuse (at API Number \_\_\_\_\_ at next anticipated well, API # will be included with the WR-34/DDMR &/or permit addendum \_\_\_\_\_ )
- Off Site Disposal (Supply form WW-9 for disposal location)
- Other (Explain flow back fluids will be put in steel tanks and reused or taken to a permitted disposal facility)

Will closed loop system be used? If so, describe: yes

Drilling medium anticipated for this well (vertical and horizontal)? Air, freshwater, oil based, etc. air at drill to KOP, fluid drill with SOBM from KOP to TD

-If oil based, what type? Synthetic, petroleum, etc. synthetic oil base

Additives to be used in drilling medium? see attached sheets

Drill cuttings disposal method? Leave in pit, landfill, removed offsite, etc. landfill

-If left in pit and plan to solidify what medium will be used? (cement, lime, sawdust)

-Landfill or offsite name/permit number? meadow SWF-1032, SS grading SWF-4902, Northwestern SWF-1025, Short Creek 1034/WV0109517/CID28726, Carbon Limestone 28726-CID28726

Arden Landfill 10072, American 02-12954, Country wide 38390/CID38390, Pine Grove 13688

Permittee shall provide written notice to the Office of Oil and Gas of any load of drill cuttings or associated waste rejected at any West Virginia solid waste facility. The notice shall be provided within 24 hours of rejection and the permittee shall also disclose where it was properly disposed.

I certify that I understand and agree to the terms and conditions of the GENERAL WATER POLLUTION PERMIT issued on August 1, 2005, by the Office of Oil and Gas of the West Virginia Department of Environmental Protection. I understand that the provisions of the permit are enforceable by law. Violations of any term or condition of the general permit and/or other applicable law or regulation can lead to enforcement action.

I certify under penalty of law that I have personally examined and am familiar with the information submitted on this application form and all attachments thereto and that, based on my inquiry of those individuals immediately responsible for obtaining the information, I believe that the information is true, accurate, and complete. I am aware that there are significant penalties for submitting false information, including the possibility of fine or imprisonment.

Company Official Signature [Signature]  
Company Official (Typed Name) Dee Southall  
Company Official Title Regulatory Supervisor

RECEIVED  
Office of Oil and Gas  
MAR 09 2017

Subscribed and sworn before me this 23rd day of January  
Brittany R Woody  
My commission expires 11/27/22

2017  
Notary Public  
OFFICIAL SEAL  
Notary Public, State of West Virginia  
BRITTANY R WOODY  
6302 Old Elkins Road  
Buckhannon, WV 26201  
My commission expires November 27, 2022  
05/12/2017

SWN Production Company, LLC

Proposed Revegetation Treatment: Acres Disturbed 8.14 Prevegetation pH \_\_\_\_\_

Lime as determined by pH test min. 2 Tons/acre or to correct to pH 7.17

Fertilizer type 10-20-20

Fertilizer amount 600 lbs/acre

Mulch Hay/Straw 2.5 Tons/acre

Seed Mixtures

**Temporary**

**Permanent**

Seed Type lbs/acre

Seed Type lbs/acre

**\*\*See Attachment**

**Attach:**

Maps(s) of road, location, pit and proposed area for land application (unless engineered plans including this info have been provided). If water from the pit will be land applied, include dimensions (L x W x D) of the pit, and dimensions (L x W), and area in acreage, of the land application area.

Photocopied section of involved 7.5' topographic sheet.

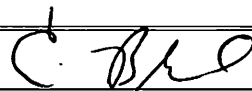
Plan Approved by:  1.26.17

Comments: \_\_\_\_\_  
\_\_\_\_\_  
\_\_\_\_\_  
\_\_\_\_\_  
\_\_\_\_\_

Title: oil and gas inspector

Date: 1.26.17

Field Reviewed?  Yes  No

RECEIVED  
Office of Oil and Gas  
MAR 09 2017

WV Department of  
Environmental Protection  
05/12/2017



# WVD Seeding Specification



To Order Seed contact Lyndsi Eddy Flippo office 570-996-4271 cell 501-269-5451 lyndsi\_eddy@swn.com (please allow 7 to 10 days for delivery)

## NON-ORGANIC PROPERTIES

Seed Mixture: ROW Mix	SWN Supplied
Orchardgrass	40%
Timothy	15%
Annual Ryegrass	15%
Brown Top Millet	5%
Red Top	5%
Medium Red Clover	5%
White Clover	5%
Birdsfoot Trefoil	5%
Rough Bluegrass	5%

All legumes are  
innoculated at 5x normal  
rate

Apply @ 100lbs per acre  
April 16th- Oct. 14th

Apply @ 200lbs per acre  
Oct. 15th- April 15th PLUS  
50lbs per acre of Winter Wheat

## SOIL AMENDMENTS

10-20-20 Fertilizer	*Apply @ 500lbs per Acre
Pelletized Lime	Apply @ 2 Tons per Acre

\*unless otherwise dictated by soil test results

## Seeding Calculation Information:

1452' of 30' ROW/LOD is One Acre  
871' of 50' ROW/LOD is One Acre  
622' of 70' ROW/LOD is One Acre

## Synopsis:

Every 622 linear feet in a 70' ROW/LOD, you should be using (2) 50lb bags of seed, (4) 50lb bags of fertilizer and (80) 50lb bags of Lime (2x seed in winter months + 50lb Winter Wheat/ac).

## Special Considerations:

Landowner Special Considerations including CREP program participants require additional guidance that is not given here. Discuss these requirements with SWN supervision at the beginning of the project to allow time for special seed delivery.

## ORGANIC PROPERTIES

Seed Mixture: SWN Production Organic Mix	SWN Supplied
Organic Timothy	50%
Organic Red or White Clover	50%
OR	
Organic Perennial Ryegrass	50%
Organic Red or White Clover	50%

Apply @ 100lbs per acre  
April 16th- Oct. 14th

Apply @ 200lbs per acre  
Oct. 15th- April 15th

Organic Fertilizer @ 200lbs per Acre

Pelletized Lime @ 2 Tons per Acre

## WETLANDS (delineated as jurisdictional wetlands)

Seed Mixture: Wetland Mix	SWN Supplied
VA Wild Ryegrass	20%
Annual Ryegrass	20%
Fowl Bluegrass	20%
Cosmos 'Sensation'	10%
Redtop	5%
Golden Tickseed	5%
Maryland Senna	5%
Showy Tickseed	5%
Fox Sedge	2.5%
Soft Rush	2.5%
Woolgrass	2.5%
Swamp Verbena	2.5%

Apply @ 25lbs per acre  
April 16th- Oct. 14th

Apply @ 50lbs per acre  
Oct. 15th- April 15th

NO FERTILIZER OR LIME INSIDE WETLAND LIMITS

4706900224

4706900224

## Drilling Mediums

Synthetic Oil

Brine

Barite

Calcium Chloride

Lime

Organophilic Bentonite

Primary and Secondary Emulsifiers

Gilsonite

Calcium Carbonate

Friction Reducers

RECEIVED  
Office of Oil and Gas

APR 26 2017

WV Department of  
Environmental Protection

05/12/2017

# MARCELLUS WELL DRILLING PROCEDURES AND WELL SITE SAFETY PLAN



SWN Production Company, LLC  
179 Innovation Drive  
Jane Lew, West Virginia 26378

**API NO. 47-XXX-XXXXX**  
**WELL NAME: Melvin Kahle OHI 6H**  
**Wheeling QUAD**  
**Triadelphia DISTRICT**  
**Ohio COUNTY, WEST VIRGINIA**

Submitted by:

Dee Southall

Date: 1/23/2017

Title: Regulatory Supervisor

SWN Production Co., LLC

Approved by:

Oil & Gas Inspector

Date: 1.26.17

Approved by:

Date: \_\_\_\_\_

Title: \_\_\_\_\_

SWN PRODUCTION COMPANY, LLC

RECEIVED  
Office of Oil and Gas  
MAR 09 2017  
WV Department of  
Environmental Protection

05/12/2017

**ELK LAKE SERVICES, LLC**

280 Indian Springs Road,  
Suite 123 Indiana, PA 15701  
Phone: (724) 463-7303

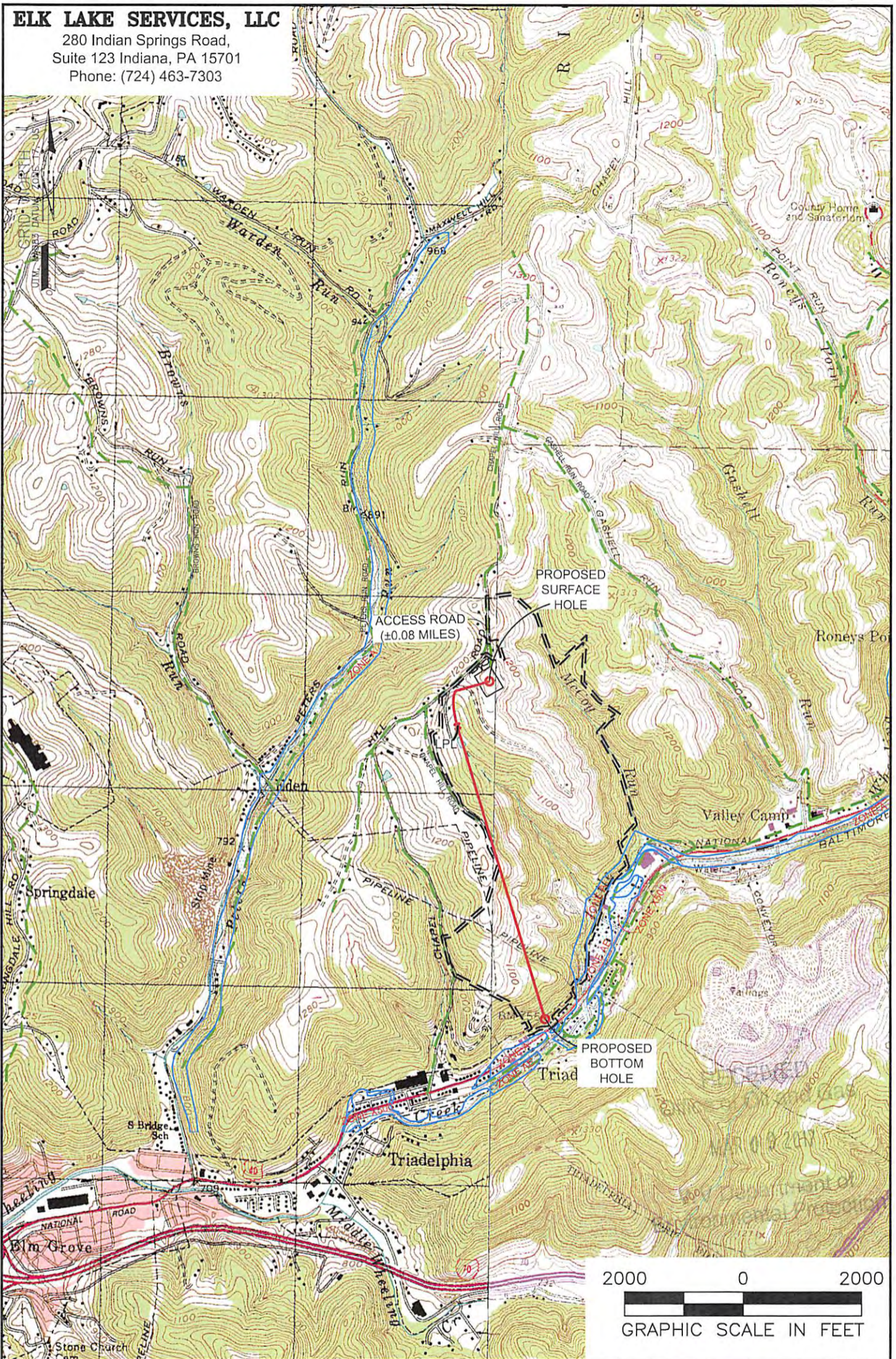

**NOTES ON SURVEY**

1. SURFACE AND ROYALTY OWNER INFORMATION AND THEIR BOUNDARIES SHOWN HEREON WERE PLOTTED FROM DEEDS AND/OR TAX PARCEL MAPS PROVIDED BY CLIENT AND/OR FIELD LOCATIONS.
2. THIS PLAT DOES NOT REPRESENT A BOUNDARY SURVEY OF THE PARCELS SHOWN HEREON.
3. ALL INSETS ARE GRID NORTH UNLESS OTHERWISE DEPICTED.

**LEGEND:**

- PROPOSED SURFACE HOLE / BOTTOM HOLE
- ⊙ EXISTING / PRODUCING WELLHEAD
- \* LPL: LANDING POINT LOCATION
- ⊡ FLOOD PLAIN
- ACCESS ROAD
- - - PUBLIC ROAD
- ACCESS ROAD TO PREV. SITE
- = = = = LEASE BOUNDARY
- PROPOSED PATH

05/12/2017

WELL OPERATOR: SWN PRODUCTION COMPANY, LLC	WELL (FARM) NAME: MELVIN KAHLE OHI	WELL # 6H	SERIAL # XXXX
ADDRESS: P.O. BOX 1300 JANE LEW, WV 26378	COUNTY OHIO COUNTY - 69	DISTRICT: TRIADELPHIA	
SURFACE OWNER: MELVIN W. KAHLE AND CAROL M. KAHLE	USGS 7 1/2 QUADRANGLE MAP NAME WHEELING, WV & VALLEY GROVE, WV		

# ELK LAKE SERVICES, LLC

280 Indian Springs Road,  
Suite 123 Indiana, PA 15701  
Phone: (724) 463-7303

Latitude: 40°05'00"

Latitude: 40°05'00" SURFACE HOLE 46'

BOTTOM HOLE 10700'

### SURFACE HOLE LOCATION (SHL):

UTM (NAD83, ZONE 17, METERS):  
NORTHING: 4,435,782.73  
EASTING: 531,962.45

### LANDING POINT (LPL):

UTM (NAD83, ZONE 17, METERS):  
NORTHING: 4,435,551.57  
EASTING: 531,801.24

### BOTTOM HOLE LOCATION (BHL):

UTM (NAD83, ZONE 17, METERS):  
NORTHING: 4,434,068.08  
EASTING: 532,277.35

GRID NORTH  
UTM, NAD83 DATUM, ZONE 17, US FT

TRACT	SURFACE OWNER / ROYALTY OWNER	TAX PARCEL	ACRES
1	MELVIN W. KAHLE AND CAROL M. KAHLE	6-T7-170	84.99
2	MARY ANGELA DICKEY	TAX PARCEL	99.95
3	CONNIE DAVIS	8-T7-172.16	10.036
4	ROBERT T. SELAK AND TAMMY L. SELAK	6-T7-172.13	1.078
5	ROBERT T. SELAK AND TAMMY L. SELAK	6-T7-172.18	1.078
6	BRIAN W. VOSSEN AND TAMMIRA K. VOSSEN	6-T7-172.1	33.8
7	RANDALL E. BARTLETT	6-T7-172.15	1
8	CLARK EDWARD MCKEE	6-T7-174	61
9	LOUIS G. BRINKMEIER JR. AND JELINDA A. BRINKMEIER	6-T7-175	45.238
10	LINDA L. CLARK	7-TW3-1	10.4

TRACT	SURFACE OWNER	TAX PARCEL	ACRES
A	MELVIN W. & CAROL M. KAHLE JR.	6-T7-170.2	1.14
B	MELVIN W. KAHLE JR.	6-T2-36	28.47
C	FRANCIS A. & D.M. RIGGS	6-TBE-3	4.35
D	CHAS M. SLEDD COMPANY	7-TW7-1	2.96
E	CHAS M. SLEDD COMPANY	7-TW7-2	5.84
F	NAGLE FAMILY IRREVOCABLE TRUST	6-TW7-3	0.97
G	OHIO COUNTY PUBLIC SERV DIST	7-TW7-4.1	0.18
H	OHIO COUNTY PUBLIC SERV DIST	7-TW7-5	0.46
I	OHIO COUNTY PUBLIC SERV DIST	7-TW7-6	0.56
J	OHIO COUNTY PUBLIC SERV DIST	7-TW7-7	0.56
K	KEVIN S. & BRENDA A. KOSEM	7-TW7-8	1.19
L	EDWARD P. & JEAN C. LAUFFER (LE)	7-TW7-9	0.6
M	KEVIN S. & BRENDA A. KOSEM	7-TW7-10	0.61
N	KEVIN S. & BRENDA A. KOSEM	7-TW7-11	2.4
O	KEVIN S. & BRENDA A. KOSEM	7-TW7-12	0.98
P	EDWARD B. HARTLUB	7-TW8-2.1	0.54
Q	DAVID A. & KIMBERLY D. DOUGLASS	7-TW8-6	0.3
R	LARRY R. & REBECCA L. KALO	7-TW8-7	0.18
S	MATTHEW H. GOSSET	7-TW8-14	0.21
T	MATTHEW H. & LEIGH ANN GOSSETT	7-TW8-13	0.19
U	MATTHEW H. GOSSET	7-TW8-14.1	0.33
V	MICHELLE L. PARSONS	7-TW8-17	0.33
W	MICHELLE L. PARSONS	7-TW8-18-2	0.15
X	CLARENCE M. & BJ DENAUL	7-TW8-19	0.54
Y	CARPET UNLIMITED INC	7-TW8-2	0.67
Z	CARPET UNLIMITED INC	7-TW8-2.1	0.3
AA	CAROL L. McDONALD	7-TW8-21	0.27
BB	WILLIAM M. & S.R. ROSEMEIER	7-TW8-22	0.24
CC	ELMER & MARTHA ANDREWS	7-TW8-23	0.29
DD	JOHN WILLIAM NASH	7-TW8-24	0.97
EE	MIDTOWN MOBILE HOMES, INC	7-TW8-25	0.35
FF	WOODROW J. KNOLLINGER, JR.	7-TW8-26	0.23
GG	RAMOND FRANK HELBING, JR	7-TW8-27	0.09
HH	RAMOND FRANK HELBING, JR	7-TW8-28	0.09
II	R.S. HELBING	7-TW8-29	0.11
JJ	THOMAS J. NASSIF, JR.	7-TW8-30	0.16
KK	BOBBY D. PLANTS	7-TW8-30.1	0.25
LL	LINDA L. CLARK	7-TW4-50	0.47
MM	MIDTOWN MOBILE HOMES, INC	7-TW4-49	0.09
NN	WM C. & ALICE N. ECKLER	7-TW4-48	0.1
OO	DAWN M. MEANS	7-TW4-47	0.45
PP	LINDA L. CLARK	7-T7-187	0.13
QQ	ROBERT C. & S.C. TRENTON	7-T7-186	3.91
RR	WILLIAM J. BRINKMEIER	6-T7-175.2	1.9
SS	LOUIS BRINKMEIER, JR.	6-T7-175.1	10.44
TT	WILDA-LE BRINKMEIER	6-T7-165.1	3.02
UU	ABUNDANT LIFE BAPTIST CHURCH	6-T7-172.14	22.13
VV	RANDALL E. & D.M. BARTLETT	6-T7-172.4	7.25
WW	JERRY L. & CYNTHIA KOPIAR	6-T7-172.6	4.87
XX	DAVID A. DICKEY	6-T7-172.3	3.6
YY	WILLIAM R. & TERRY L. BENNETT	6-T7-172.11	2.87
ZZ	DAVID L. & MARY LOU FURBEE	6-T7-172.5	2.54
AB	THOMAS SCOTT TOMINACK	6-T7-172.7	4.18
AC	THOMAS S. & M.D. TOMINACK	6-T7-172.8	3.68
AD	MARK A. & ALAIRE S. KNOX	6-T7-172.10	3.82
AE	THOMAS & CATHY MILLER	6-T7-172.17	2.03
AF	JOSEPH T. SUBASIC	6-T7-161	0.4
AG	470 LAND CO. LLC	6-T7-158	30.04
AH	KAREN J. BUTLER	6-T7-160	2.94

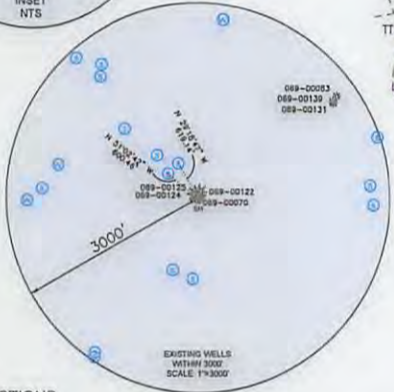
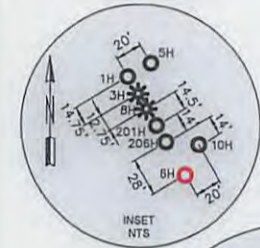
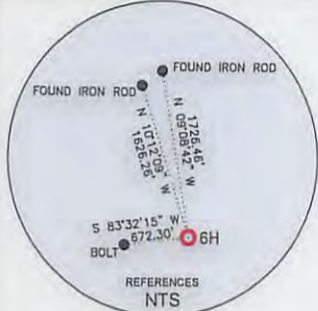

### WELL RESTRICTIONS

- NO OCCUPIED DWELLINGS > 2500 SQ FT. WITHIN 625 FEET OF CENTER OF PAD.
- NO AGRICULTURE BUILDINGS > 2500 SQ FT. WITHIN 625 FEET OF CENTER OF PAD.
- WATER WELLS OR DEVELOPED SPRINGS ARE WITHIN 531 FEET OF PROPOSED WELL.
- PERENNIAL STREAMS, LAKES, PONDS, OR RESERVOIRS ARE WITHIN THE LIMITS OF DISTURBANCE.
- NO NATURALLY PRODUCING TROUT STREAM WITHIN 300 FEET OF LIMITS OF DISTURBANCE.
- NO GROUND INTAKE OR PUBLIC WATER SUPPLY WITHIN 1000 FEET OF WELL PAD, LIMITS OF DISTURBANCE, E & S CONTROLS OR PUBLIC WATER SUPPLY.

### NOTES ON SURVEY

- SURFACE AND ROYALTY OWNER INFORMATION AND THEIR BOUNDARIES SHOWN HEREON WERE PLOTTED FROM DEEDS AND/OR TAX PARCEL MAPS PROVIDED BY CLIENT AND/OR FIELD LOCATIONS.
- THIS PLAT DOES NOT REPRESENT A BOUNDARY SURVEY OF THE PARCELS SHOWN HEREON.
- ALL INSETS ARE GRID NORTH UNLESS OTHERWISE DEPICTED.

I, THE UNDERSIGNED, HEREBY CERTIFY THAT THIS PLAT IS CORRECT TO THE BEST OF MY KNOWLEDGE AND BELIEF AND SHOWS ALL THE INFORMATION REQUIRED BY LAW AND REGULATIONS ISSUED AND PRESCRIBED BY THE DEPARTMENT OF ENVIRONMENTAL PROTECTION.

P.S. 2164

*[Signature]*

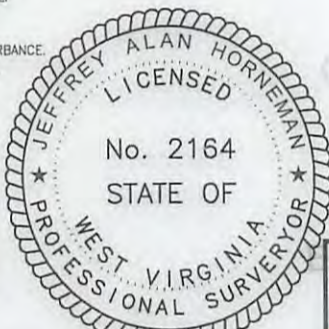

2000 0 2000

GRAPHIC SCALE IN FEET

COMPANY:

**SWN**

**SWN** *Production Company*

Production Company, LLC Production Company™

<p>(+) DENOTES LOCATION OF WELL ON UNITED STATES TOPOGRAPHIC MAPS</p> <p>WVDEP OFFICE OF OIL &amp; GAS 601 57TH STREET CHARLESTON, WV 25034</p>	<p>MINIMUM DEGREE OF ACCURACY: 1/200</p> <p>PROVEN SURVEY SOURCE OF ELEVATION: GRADE GPS (NAVD 88, US FT)</p>	<p>COMPANY: MELVIN KAHLE OHI</p> <p>OPERATOR'S WELL #: 6H</p> <p>API WELL #: 47 69 00224</p> <p>STATE COUNTY PERMIT</p>
	<p>WELL TYPE: OIL <input type="checkbox"/> WASTE DISPOSAL <input type="checkbox"/> PRODUCTION <input checked="" type="checkbox"/> DEEP <input type="checkbox"/> GAS <input checked="" type="checkbox"/> LIQUID INJECTION <input type="checkbox"/> STORAGE <input type="checkbox"/> SHALLOW <input checked="" type="checkbox"/></p> <p>WATERSHED: UPPER OHIO SOUTH ELEVATION: 1276.3'</p> <p>DISTRICT: TRIADELPHIA COUNTY: OHIO COUNTY QUADRANGLE: WHEELING &amp; VALLEY GROVE</p> <p>SURFACE OWNER: MELVIN W. KAHLE AND CAROL M. KAHLE ACREAGE: ±84.99</p> <p>OIL &amp; GAS ROYALTY OWNER: MELVIN W. KAHLE AND CAROL M. KAHLE ACREAGE: ±84.99</p> <p>DRILL <input checked="" type="checkbox"/> DRILL DEEPER <input type="checkbox"/> REDRILL <input type="checkbox"/> FRACTURE OR STIMULATE <input checked="" type="checkbox"/> PLUG OFF OLD FORMATION <input type="checkbox"/> PERFORATE NEW FORMATION <input checked="" type="checkbox"/></p> <p>CONVERT <input type="checkbox"/> PLUG &amp; ABANDON <input type="checkbox"/> CLEAN OUT &amp; REPLUG <input type="checkbox"/> OTHER CHANGE <input type="checkbox"/> (SPECIFY)</p> <p>TARGET FORMATION: MARCELLUS ESTIMATED DEPTH: 6,348' TVD 11,857' TMD</p>	<p>DESIGNATED AGENT: DEE SOUTHALL</p> <p>ADDRESS: P.O. BOX 1300</p> <p>CITY: JANE LEW STATE: WV ZIP CODE: 26378</p>

05/12/2017

### LEGEND:

- PROPOSED SURFACE HOLE / BOTTOM HOLE
- EXISTING / PRODUCING WELLHEAD
- LPL: LANDING POINT LOCATION
- EXISTING WATER WELL
- EXISTING SPRING
- SURVEYED BOUNDARY
- DRILLING UNIT
- LEASE BOUNDARY
- PROPOSED PATH

### REVISIONS:

DATE: 03-06-2017
FILE NO: 16-51
DRAWN BY: H. JOHN
SCALE: 1" = 2000'
DRAWING NO: 1
WELL LOCATION PLAT 1



WW-6A1  
(5/13)

Operator's Well No. Melvin Kahle OHI 6H

**INFORMATION SUPPLIED UNDER WEST VIRGINIA CODE  
Chapter 22, Article 6A, Section 5(a)(5)  
IN LIEU OF FILING LEASE(S) AND OTHER CONTINUING CONTRACT(S)**

Under the oath required to make the verification on page 1 of this Notice and Application, I depose and say that I am the person who signed the Notice and Application for the Applicant, and that –

- (1) the tract of land is the same tract described in this Application, partly or wholly depicted in the accompanying plat, and described in the Construction and Reclamation Plan;
- (2) the parties and recordation data (if recorded) for lease(s) or other continuing contract(s) by which the Applicant claims the right to extract, produce or market the oil or gas are as follows:

Lease Name or Number	Grantor, Lessor, etc.	Grantee, Lessee, etc.	Royalty	Book/Page
See Exhibit				

**Acknowledgement of Possible Permitting/Approval  
In Addition to the Office of Oil and Gas**

The permit applicant for the proposed well work addressed in this application hereby acknowledges the possibility of the need for permits and/or approvals from local, state, or federal entities in addition to the DEP, Office of Oil and Gas, including but not limited to the following:

- WV Division of Water and Waste Management
- WV Division of Natural Resources WV Division of Highways
- U.S. Army Corps of Engineers
- U.S. Fish and Wildlife Service
- County Floodplain Coordinator

The applicant further acknowledges that any Office of Oil and Gas permit in no way overrides, replaces, or nullifies the need for other permits/approvals that may be necessary and further affirms that all needed permits/approvals should be acquired from the appropriate authority before the affected activity is initiated.

Well Operator: SWN Production Company, LLC.  
 By:   
 Its: Senior Landman

RECEIVED  
Office of Oil and Gas  
MAR 09 2017  
WV Department of  
Environmental Protection

4706000224

#	TMP	SURFACE OWNER	DEEDED A	LEASE #	LESSOR	LESSEE	ROYALTY	BK/PG
1	6-T7-170	Melvin W. Kahle and Carol M. Kahle	84.99	730210-000	Melvin W. Kahle, Jr. and Carol M. Kahle	Great Lakes Energy Partners, LLC Chesapeake Appalachia, LLC SWN Production Company, LLC	14.00%	771/494 808/462 883/204
2	06-T7-171	Mary Angela Dickey	99.95	725130-000	Mary Angela Dickey	Chesapeake Appalachia, LLC SWN Production Company, LLC	12.50%	792/213 885/512
3	6-T7-172.16	Connie Davls	10.036	728429-000	Connie Davis	Chesapeake Appalachia, LLC SWN Production Company, LLC	12.50%	807/286 883/291
4	6-T7-172.13	Robert T. Selak and Tammy L. Selak	1.078	729404-000	Robert T. Selak and Tammy L. Selak	Chesapeake Appalachia, LLC SWN Production Company, LLC	18.00%	811/117 883/168
5	6-T7-172.18	Robert T. Selak and Tammy L. Selak	0.126	729327-000	Robert T. Selak and Tammy L. Selak	Chesapeake Appalachia, LLC SWN Production Company, LLC	18.00%	811/81 883/156
6	6-T7-172.1	Brian W. Vossen and Tambria K. Vossen	33.8	728110-000	Brian W. Vossen and Tambria K. Vossen	Chesapeake Appalachia, LLC SWN Production Company, LLC	18.00%	806/445 883/267
7	6-T7-172.15	Randall E. Bartlett	1	735064-000	Randall E. Bartlett	Chesapeake Appalachia, LLC SWN Production Company, LLC	14.00%	864/393 884/385
8	6-T7-174	Clark Edward McKee	61	730054-000	Clark Edward McKee	Great Lakes Energy Partners, LLC Chesapeake Appalachia, LLC SWN Production Company, LLC	12.50%	779/136 808/514 883/192
9	6-T7-175	Louis G. Brinkmeyer Jr. and Jelinda A. Brinkmeyer	45.238	735651-000	Louis G. Brinkmeier Jr. and Jelinda A. Brinkmeier	Chesapeake Appalachia, LLC SWN Production Company, LLC	18.00%	818/431 884/313
10	7-TW3-1	Linda L. Clark	10.4	735686-000	Linda L. Clark	Chesapeake Appalachia, LLC SWN Production Company, LLC	18.00%	820/263 884/325

RECEIVED  
Office of Oil and Gas

MAR 09 2017

WV Department of  
Environmental Protection

# SWN

Southwestern Energy®

PO Box 1300  
Jane Lew, WV 26378  
PHONE: (832) 796-1610

January 23, 2017

Ms. Laura Adkins  
WV DEP Office of Oil & Gas  
601 57<sup>th</sup> St., SE  
Charleston, WV 25304

**RE:** SWN's proposed Melvin Kahle OHI 6H in Ohio County, West Virginia, Drilling under Peters Run Road & Chapel Hill Road.

Dear Ms. Adkins:

SWN Production Company, LLC ("SWN") is applying for a drilling permit for the above referenced well. The State of West Virginia has raised some concern as to SWN's right to drill under Peters Run Road & Chapel Hill Road. Please be advised that SWN has leased all mineral owners under said route as it relates to the above-referenced well and unit.

Thank you.

Sincerely,



Robert Walter  
Senior Landman  
SWN Production Company, LLC  
PO Box 1300  
Jane Lew, WV 26378

RECEIVED  
Office of Oil and Gas  
MAR 09 2017  
The Right People doing the Right Things,  
wisely Investing the cash flow from  
our underlying Assets, will create Value+  
WV Department of Environmental Protection

05/12/2017

STATE OF WEST VIRGINIA  
DEPARTMENT OF ENVIRONMENTAL PROTECTION, OFFICE OF OIL AND GAS  
NOTICE CERTIFICATION

Date of Notice Certification: 3/7/17

API No. 47- 069 -  
Operator's Well No. Melvin Kahle OHI 6H  
Well Pad Name: Melvin Kahle OHI

**Notice has been given:**

Pursuant to the provisions in West Virginia Code § 22-6A, the Operator has provided the required parties with the Notice Forms listed below for the tract of land as follows:

State: WV	UTM NAD 83	Easting: 531962.45
County: 69- Ohio		Northing: 4435782.73
District: Triadelphia	Public Road Access:	Chapel Hill Road
Quadrangle: Wheeling	Generally used farm name:	Melvin Kahle
Watershed: Upper Ohio South		

Pursuant to West Virginia Code § 22-6A-7(b), every permit application filed under this section shall be on a form as may be prescribed by the secretary, shall be verified and shall contain the following information: (14) A certification from the operator that (i) it has provided the owners of the surface described in subdivisions (1), (2) and (4), subsection (b), section ten of this article, the information required by subsections (b) and (c), section sixteen of this article; (ii) that the requirement was deemed satisfied as a result of giving the surface owner notice of entry to survey pursuant to subsection (a), section ten of this article six-a; or (iii) the notice requirements of subsection (b), section sixteen of this article were waived in writing by the surface owner; and Pursuant to West Virginia Code § 22-6A-11(b), the applicant shall tender proof of and certify to the secretary that the notice requirements of section ten of this article have been completed by the applicant.

<p>Pursuant to West Virginia Code § 22-6A, the Operator has attached proof to this Notice Certification that the Operator has properly served the required parties with the following:</p> <p>*PLEASE CHECK ALL THAT APPLY</p> <p><input type="checkbox"/> 1. NOTICE OF SEISMIC ACTIVITY or <input type="checkbox"/> NOTICE NOT REQUIRED BECAUSE NO SEISMIC ACTIVITY WAS CONDUCTED</p> <p><input type="checkbox"/> 2. NOTICE OF ENTRY FOR PLAT SURVEY or <input type="checkbox"/> NO PLAT SURVEY WAS CONDUCTED</p> <p><input checked="" type="checkbox"/> 3. NOTICE OF INTENT TO DRILL or <input type="checkbox"/> NOTICE NOT REQUIRED BECAUSE NOTICE OF ENTRY FOR PLAT SURVEY WAS CONDUCTED or</p> <p style="padding-left: 100px;"><input type="checkbox"/> WRITTEN WAIVER BY SURFACE OWNER (PLEASE ATTACH)</p> <p><input checked="" type="checkbox"/> 4. NOTICE OF PLANNED OPERATION</p> <p><input type="checkbox"/> 5. PUBLIC NOTICE</p> <p><input type="checkbox"/> 6. NOTICE OF APPLICATION</p>	<p><b>OOG OFFICE USE ONLY</b></p> <p><input checked="" type="checkbox"/> RECEIVED/ NOT REQUIRED</p> <p><input checked="" type="checkbox"/> RECEIVED</p> <p><input checked="" type="checkbox"/> RECEIVED/ NOT REQUIRED</p> <p><input checked="" type="checkbox"/> RECEIVED</p> <p><input checked="" type="checkbox"/> RECEIVED</p> <p><input checked="" type="checkbox"/> RECEIVED</p>
--	---

**Required Attachments:**

The Operator shall attach to this Notice Certification Form all Notice Forms and Certifications of Notice that have been provided to the required parties and/or any associated written waivers. For the Public Notice, the operator shall attach a copy of the Class II Legal Advertisement with publication date verification or the associated Affidavit of Publication. The attached Notice Forms and Certifications of Notice shall serve as proof that the required parties have been noticed as required under West Virginia Code § 22-6A. Pursuant to West Virginia Code § 22-6A-11(b), the Certification of Notice to the person may be made by affidavit of personal service, the return receipt card or other postal receipt for certified mailing.

MAR 09 2017

**Certification of Notice is hereby given:**

THEREFORE, I \_\_\_\_\_, have read and understand the notice requirements within West Virginia Code § 22-6A. I certify that as required under West Virginia Code § 22-6A, I have served the attached copies of the Notice Forms, identified above, to the required parties through personal service, by registered mail or by any method of delivery that requires a receipt or signature confirmation. I certify under penalty of law that I have personally examined and am familiar with the information submitted in this Notice Certification and all attachments, and that based on my inquiry of those individuals immediately responsible for obtaining the information, I believe that the information is true, accurate and complete. I am aware that there are significant penalties for submitting false information, including the possibility of fine and imprisonment.

Well Operator: SWN Production Co., LLC  
By: \_\_\_\_\_  
Its: \_\_\_\_\_  
Telephone: 832-796-1614

Address: P.O. Box 1300  
Jane Lew, WV 26378  
Facsimile: \_\_\_\_\_  
Email: Dee\_Southall@swn.com

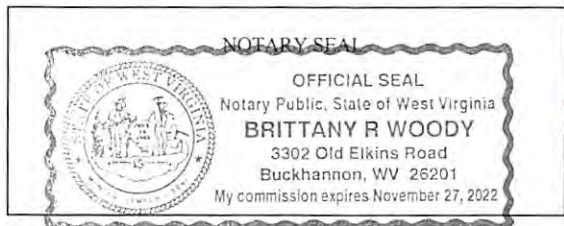

Subscribed and sworn before me this 23<sup>rd</sup> day of January 2017  
Brittany R Woody Notary Public  
My Commission Expires 11/27/22

**Oil and Gas Privacy Notice:**

The Office of Oil and Gas processes your personal information, such as name, address and telephone number, as part of our regulatory duties. Your personal information may be disclosed to other State agencies or third parties in the normal course of business or as needed to comply with statutory or regulatory requirements, including Freedom of Information Act requests. Our office will appropriately secure your personal information. If you have any questions about our use or your personal information, please contact DEP's Chief Privacy Officer at [depprivacyofficer@wv.gov](mailto:depprivacyofficer@wv.gov).

RECEIVED  
Office of Oil and Gas

MAR 09 2017

WV Department of  
Environmental Protection

05/12/2017

**STATE OF WEST VIRGINIA  
DEPARTMENT OF ENVIRONMENTAL PROTECTION, OFFICE OF OIL AND GAS  
NOTICE OF APPLICATION**

**Notice Time Requirement:** notice shall be provided no later than the **filing date of permit application.**

**Date of Notice:** 3/7/17 **Date Permit Application Filed:** 3/7/17

Notice of:

- PERMIT FOR ANY WELL WORK
- CERTIFICATE OF APPROVAL FOR THE CONSTRUCTION OF AN IMPOUNDMENT OR PIT

**Delivery method pursuant to West Virginia Code § 22-6A-10(b)**

- PERSONAL SERVICE
- REGISTERED MAIL
- METHOD OF DELIVERY THAT REQUIRES A RECEIPT OR SIGNATURE CONFIRMATION

Pursuant to W. Va. Code § 22-6A-10(b) no later than the filing date of the application, the applicant for a permit for any well work or for a certificate of approval for the construction of an impoundment or pit as required by this article shall deliver, by personal service or by registered mail or by any method of delivery that requires a receipt or signature confirmation, copies of the application, the erosion and sediment control plan required by section seven of this article, and the well plat to each of the following persons: (1) The owners of record of the surface of the tract on which the well is or is proposed to be located; (2) The owners of record of the surface tract or tracts overlying the oil and gas leasehold being developed by the proposed well work, if the surface tract is to be used for roads or other land disturbance as described in the erosion and sediment control plan submitted pursuant to subsection (c), section seven of this article; (3) The coal owner, operator or lessee, in the event the tract of land on which the well proposed to be drilled is located [sic] is known to be underlain by one or more coal seams; (4) The owners of record of the surface tract or tracts overlying the oil and gas leasehold being developed by the proposed well work, if the surface tract is to be used for the placement, construction, enlargement, alteration, repair, removal or abandonment of any impoundment or pit as described in section nine of this article; (5) Any surface owner or water purveyor who is known to the applicant to have a water well, spring or water supply source located within one thousand five hundred feet of the center of the well pad which is used to provide water for consumption by humans or domestic animals; and (6) The operator of any natural gas storage field within which the proposed well work activity is to take place. (c)(1) If more than three tenants in common or other co-owners of interests described in subsection (b) of this section hold interests in the lands, the applicant may serve the documents required upon the person described in the records of the sheriff required to be maintained pursuant to section eight, article one, chapter eleven-a of this code. (2) Notwithstanding any provision of this article to the contrary, notice to a lien holder is not notice to a landowner, unless the lien holder is the landowner. W. Va. Code R. § 35-8-5.7.a requires, in part, that the operator shall also provide the Well Site Safety Plan ("WSSP") to the surface owner and any water purveyor or surface owner subject to notice and water testing as provided in section 15 of this rule.

Application Notice  WSSP Notice  E&S Plan Notice  Well Plat Notice is hereby provided to:

SURFACE OWNER(s)  
Name: Mevlin W. Kahle & Carol M. Kahle  
Address: 28 Maple Ave  
Wheeling, WV 26003

Name: \_\_\_\_\_  
Address: \_\_\_\_\_

SURFACE OWNER(s) (Road and/or Other Disturbance)

Name: \_\_\_\_\_  
Address: \_\_\_\_\_

Name: \_\_\_\_\_  
Address: \_\_\_\_\_

SURFACE OWNER(s) (Impoundments or Pits)

Name: \_\_\_\_\_  
Address: \_\_\_\_\_

COAL OWNER OR LESSEE  
Name: Alliance Resources GP, LLC  
Address: 2596 Battle Run Road  
Triadelphia, WV 26059

COAL OPERATOR  
Name: \_\_\_\_\_  
Address: \_\_\_\_\_

SURFACE OWNER OF WATER WELL AND/OR WATER PURVEYOR(s)

Name: See Attachment #1  
Address: \_\_\_\_\_

OPERATOR OF ANY NATURAL GAS STORAGE FIELD

Name: \_\_\_\_\_  
Address: \_\_\_\_\_

\*Please attach additional forms if necessary

**RECEIVED**  
**Office of Oil and Gas**  
**MAR 09 2017**  
**WV Department of Environmental Protection**  
**05/12/2017**

**STATE OF WEST VIRGINIA  
DEPARTMENT OF ENVIRONMENTAL PROTECTION, OFFICE OF OIL AND GAS  
NOTICE OF APPLICATION**

**Notice Time Requirement:** notice shall be provided no later than the **filing date of permit application.**

Date of Notice: 3/7/17 Date Permit Application Filed: 3/7/17

Notice of:

- PERMIT FOR ANY WELL WORK
- CERTIFICATE OF APPROVAL FOR THE CONSTRUCTION OF AN IMPOUNDMENT OR PIT

**Delivery method pursuant to West Virginia Code § 22-6A-10(b)**

- PERSONAL SERVICE
- REGISTERED MAIL
- METHOD OF DELIVERY THAT REQUIRES A RECEIPT OR SIGNATURE CONFIRMATION

Pursuant to W. Va. Code § 22-6A-10(b) no later than the filing date of the application, the applicant for a permit for any well work or for a certificate of approval for the construction of an impoundment or pit as required by this article shall deliver, by personal service or by registered mail or by any method of delivery that requires a receipt or signature confirmation, copies of the application, the erosion and sediment control plan required by section seven of this article, and the well plat to each of the following persons: (1) The owners of record of the surface of the tract on which the well is or is proposed to be located; (2) The owners of record of the surface tract or tracts overlying the oil and gas leasehold being developed by the proposed well work, if the surface tract is to be used for roads or other land disturbance as described in the erosion and sediment control plan submitted pursuant to subsection (c), section seven of this article; (3) The coal owner, operator or lessee, in the event the tract of land on which the well proposed to be drilled is located [sic] is known to be underlain by one or more coal seams; (4) The owners of record of the surface tract or tracts overlying the oil and gas leasehold being developed by the proposed well work, if the surface tract is to be used for the placement, construction, enlargement, alteration, repair, removal or abandonment of any impoundment or pit as described in section nine of this article; (5) Any surface owner or water purveyor who is known to the applicant to have a water well, spring or water supply source located within one thousand five hundred feet of the center of the well pad which is used to provide water for consumption by humans or domestic animals; and (6) The operator of any natural gas storage field within which the proposed well work activity is to take place. (c)(1) If more than three tenants in common or other co-owners of interests described in subsection (b) of this section hold interests in the lands, the applicant may serve the documents required upon the person described in the records of the sheriff required to be maintained pursuant to section eight, article one, chapter eleven-a of this code. (2) Notwithstanding any provision of this article to the contrary, notice to a lien holder is not notice to a landowner, unless the lien holder is the landowner. W. Va. Code R. § 35-8-5.7.a requires, in part, that the operator shall also provide the Well Site Safety Plan ("WSSP") to the surface owner and any water purveyor or surface owner subject to notice and water testing as provided in section 15 of this rule.

Application Notice  WSSP Notice  E&S Plan Notice  Well Plat Notice is hereby provided to:

SURFACE OWNER(s)

Name: \_\_\_\_\_  
Address: \_\_\_\_\_

Name: \_\_\_\_\_  
Address: \_\_\_\_\_

SURFACE OWNER(s) (Road and/or Other Disturbance)

Name: \_\_\_\_\_  
Address: \_\_\_\_\_

Name: \_\_\_\_\_  
Address: \_\_\_\_\_

SURFACE OWNER(s) (Impoundments or Pits)

Name: \_\_\_\_\_  
Address: \_\_\_\_\_

COAL OWNER OR LESSEE

Name: Melvin W. Kahle, Jr. & Carol M. Kahle ✓  
Address: 28 Maple Ave.  
Wheeling, WV 26003

COAL OPERATOR

Name: \_\_\_\_\_  
Address: \_\_\_\_\_

SURFACE OWNER OF WATER WELL AND/OR WATER PURVEYOR(s)

Name: See Attachment #1  
Address: \_\_\_\_\_

OPERATOR OF ANY NATURAL GAS STORAGE FIELD

Name: \_\_\_\_\_  
Address: \_\_\_\_\_

\*Please attach additional forms if necessary

RECEIVED  
Office of Oil and Gas  
MAR 09 2017  
WV Department of  
Environmental Protection  
05/12/2017

**Notice is hereby given:**

Pursuant to West Virginia Code § 22-6A-10(b), notice is hereby given that the undersigned well operator has applied for a permit for well work or for a certificate of approval for the construction of an impoundment or pit.

**This Notice Shall Include:**

Pursuant to W. Va. Code § 22-6A-10(b), this notice shall include: (1) copies of the application; (2) the erosion and sediment control plan required by section seven of this article; and (3) the well plat.

Pursuant to W. Va. Code § 22-6A-10(f), this notice shall include: (1) a statement of the time limits for filing written comments; (2) who may file written comments; (3) the name and address of the secretary for the purpose of filing the comments and obtaining additional information; and (4) a statement that the persons may request, at the time of submitting written comments, notice of the permit decision and a list of persons qualified to test water.

Pursuant to W. Va. Code R. § 35-8-5.7.a, the operator shall provide the Well Site Safety Plan to the surface owner and any water purveyor or surface owner subject to notice and water testing as provided in section 15 of this rule.

Pursuant to W. Va. Code R. § 35-8-15.2.c, this notice shall: (1) contain a statement of the surface owner's and water purveyor's right to request sampling and analysis; (2) advise the surface owner and water purveyor of the rebuttable presumption for contamination or deprivation of a fresh water source or supply; advise the surface owner and water purveyor that refusal to allow the operator to conduct a pre-drilling water well test constitutes a method to rebut the presumption of liability; (3) advise the surface owner and water purveyor of his or her independent right to sample and analyze any water supply at his or her own expense; advise the surface owner and water purveyor whether or not the operator will utilize an independent laboratory to analyze any sample; and (4) advise the surface owner and or water purveyor that he or she can obtain from the Chief a list of water testing laboratories in the subject area capable of and qualified to test water supplies in accordance with standard acceptable methods.

Additional information related to horizontal drilling may be obtained from the Secretary, at the WV Department of Environmental Protection headquarters, located at 601 57<sup>th</sup> Street, SE, Charleston, WV 25304 (304-926-0450) or by visiting [www.dep.wv.gov/oil-and-gas/pages/default.aspx](http://www.dep.wv.gov/oil-and-gas/pages/default.aspx).

**Well Location Restrictions**

Pursuant to W. Va. Code § 22-6A-12, Wells may not be drilled within two hundred fifty feet measured horizontally from any existing water well or developed spring used for human or domestic animal consumption. The center of well pads may not be located within six hundred twenty-five feet of an occupied dwelling structure, or a building two thousand five hundred square feet or larger used to house or shelter dairy cattle or poultry husbandry. This limitation is applicable to those wells, developed springs, dwellings or agricultural buildings that existed on the date a notice to the surface owner of planned entry for surveying or staking as provided in section ten of this article or a notice of intent to drill a horizontal well as provided in subsection (b), section sixteen of this article was provided, whichever occurs first, and to any dwelling under construction prior to that date. This limitation may be waived by written consent of the surface owner transmitted to the department and recorded in the real property records maintained by the clerk of the county commission for the county in which such property is located. Furthermore, the well operator may be granted a variance by the secretary from these distance restrictions upon submission of a plan which identifies the sufficient measures, facilities or practices to be employed during well site construction, drilling and operations. The variance, if granted, shall include terms and conditions the department requires to ensure the safety and protection of affected persons and property. The terms and conditions may include insurance, bonding and indemnification, as well as technical requirements. (b) No well pad may be prepared or well drilled within one hundred feet measured horizontally from any perennial stream, natural or artificial lake, pond or reservoir, or a wetland, or within three hundred feet of a naturally reproducing trout stream. No well pad may be located within one thousand feet of a surface or ground water intake of a public water supply. The distance from the public water supply as identified by the department shall be measured as follows: (1) For a surface water intake on a lake or reservoir, the distance shall be measured from the boundary of the lake or reservoir. (2) For a surface water intake on a flowing stream, the distance shall be measured from a semicircular radius extending upstream of the surface water intake. (3) For a groundwater source, the distance shall be measured from the wellhead or spring. The department may, in its discretion, waive these distance restrictions upon submission of a plan identifying sufficient measures, facilities or practices to be employed during well site construction, drilling and operations to protect the waters of the state. A waiver, if granted, shall impose any permit conditions as the secretary considers necessary. (c) Notwithstanding the foregoing provisions of this section, nothing contained in this section prevents an operator from conducting the activities permitted or authorized by a Clean Water Act Section 404 permit or other approval from the United States Army Corps of Engineers within any waters of the state or within the restricted areas referenced in this section. (d) The well location restrictions set forth in this section shall not apply to any well on a multiple well pad if at least one of the wells was permitted prior to the effective date of this article. (e) The secretary shall, by December 31, 2012, report to the Legislature on the noise, light, dust and volatile organic compounds generated by the drilling of horizontal wells as they relate to the well location restrictions regarding occupied dwelling structures pursuant to this section. Upon a finding, if any, by the secretary that the well location restrictions regarding occupied dwelling structures are inadequate or otherwise require alteration to address the items



examined in the study required by this subsection, the secretary shall have the authority to propose for promulgation legislative rules establishing guidelines and procedures regarding reasonable levels of noise, light, dust and volatile organic compounds relating to drilling horizontal wells, including reasonable means of mitigating such factors, if necessary.

**Water Well Testing:**

Pursuant to West Virginia Code § 22-6A-10(d), notification shall be made, with respect to surface landowners identified in subsection (b) or water purveyors identified in subdivision (5), subsection (b) of this section, of the opportunity for testing their water well. The operator shall provide an analysis to such surface landowner or water purveyor at their request.

**Water Testing Laboratories:**

Pursuant to West Virginia Code § 22-6A-10(i), persons entitled to notice pursuant to subsection (b) of this section may contact the department to ascertain the names and locations of water testing laboratories in the subject area capable and qualified to test water supplies in accordance with standard accepted methods. In compiling that list of names the department shall consult with the state Bureau for Public Health and local health departments. A surface owner and water purveyor has an independent right to sample and analyze any water supply at his or her own expense. The laboratory utilized by the operator shall be approved by the agency as being certified and capable of performing sample analyses in accordance with this section.

**Rebuttable Presumption for Contamination or Deprivation of a Fresh Water Source or Supply:**

W. Va. Code § 22-6A-18 requires that (b) unless rebutted by one of the defenses established in subsection (c) of this section, in any action for contamination or deprivation of a fresh water source or supply within one thousand five hundred feet of the center of the well pad for horizontal well, there is a rebuttable presumption that the drilling and the oil or gas well or either was the proximate cause of the contamination or deprivation of the fresh water source or supply. (c) In order to rebut the presumption of liability established in subsection (b) of this section, the operator must prove by a preponderance of the evidence one of the following defenses: (1) The pollution existed prior to the drilling or alteration activity as determined by a predrilling or prealteration water well test. (2) The landowner or water purveyor refused to allow the operator access to the property to conduct a predrilling or prealteration water well test. (3) The water supply is not within one thousand five hundred feet of the well. (4) The pollution occurred more than six months after completion of drilling or alteration activities. (5) The pollution occurred as the result of some cause other than the drilling or alteration activity. (d) Any operator electing to preserve its defenses under subdivision (1), subsection (c) of this section shall retain the services of an independent certified laboratory to conduct the predrilling or prealteration water well test. A copy of the results of the test shall be submitted to the department and the surface owner or water purveyor in a manner prescribed by the secretary. (e) Any operator shall replace the water supply of an owner of interest in real property who obtains all or part of that owner's supply of water for domestic, agricultural, industrial or other legitimate use from an underground or surface source with a comparable water supply where the secretary determines that the water supply has been affected by contamination, diminution or interruption proximately caused by the oil or gas operation, unless waived in writing by that owner. (f) The secretary may order the operator conducting the oil or gas operation to: (1) Provide an emergency drinking water supply within twenty-four hours; (2) Provide temporary water supply within seventy-two hours; (3) Within thirty days begin activities to establish a permanent water supply or submit a proposal to the secretary outlining the measures and timetables to be used in establishing a permanent supply. The total time in providing a permanent water supply may not exceed two years. If the operator demonstrates that providing a permanent replacement water supply cannot be completed within two years, the secretary may extend the time frame on case-by-case basis; and (4) Pay all reasonable costs incurred by the real property owner in securing a water supply. (g) A person as described in subsection (b) of this section aggrieved under the provisions of subsections (b), (e) or (f) of this section may seek relief in court... (i) Notwithstanding the denial of the operator of responsibility for the damage to the real property owner's water supply or the status of any appeal on determination of liability for the damage to the real property owner's water supply, the operator may not discontinue providing the required water service until authorized to do so by the secretary or a court of competent jurisdiction.

**Written Comment:**

Pursuant to West Virginia Code § 22-6A-11(a), all persons described in subsection (b), section ten of this article may file written comments with the secretary as to the location or construction of the applicant's proposed well work within thirty days after the application is filed with the secretary. All persons described in West Virginia Code § 22-6A-10(b) may file written comments as to the location or construction of the applicant's proposed well work to the Secretary at:

Chief, Office of Oil and Gas  
Department of Environmental Protection  
601 57<sup>th</sup> St. SE  
Charleston, WV 25304  
(304) 926-0450

Such persons may request, at the time of submitting written comments, notice of the permit decision and a list of persons qualified to test water. **NOTE: YOU ARE NOT REQUIRED TO FILE ANY COMMENT.**

RECEIVED  
Office of Oil and Gas  
MAR 09 2017  
WV Department of  
Environmental Protection  
05/12/2017

**Time Limits and Methods for Filing Comments.**

The law requires these materials to be served on or before the date the operator files its Application. You have **THIRTY (30) DAYS** after the filing date to file your comments. Comments must be filed in person or received in the mail by the Chief's office by the time stated above. You may call the Chief's office to be sure of the date. Check with your postmaster to ensure adequate delivery time or to arrange special expedited handling. If you have been contacted by the well operator and you have signed a "voluntary statement of no objection" to the planned work described in these materials, then the permit may be issued at any time.

Pursuant to West Virginia Code § 22-6A-11(c)(2), Any objections of the affected coal operators and coal seam owners and lessees shall be addressed through the processes and procedures that exist under sections fifteen, seventeen and forty, article six of this chapter, as applicable and as incorporated into this article by section five of this article. The written comments filed by the parties entitled to notice under subdivisions (1), (2), (4), (5) and (6), subsection (b), section ten of this article shall be considered by the secretary in the permit issuance process, but the parties are not entitled to participate in the processes and proceedings that exist under sections fifteen, seventeen or forty, article six of this chapter, as applicable and as incorporated into this article by section five of this article.

**Comment Requirements**

Your comments must be in writing and include your name, address and telephone number, the well operator's name and well number and the approximate location of the proposed well site including district and county from the application. You may add other documents, such as sketches, maps or photographs to support your comments.

Disclaimer: All comments received will be placed on our web site <http://www.dep.wv.gov/oil-and-gas/Horizontal-Permits/Pages/default.aspx> and the applicant will automatically be forwarded an email notice that such comments have been submitted. The applicant will be expected to provide a response to comments submitted by any surface owner, water purveyor or natural gas storage operator noticed within the application.

**Permit Denial or Condition**

The Chief has the power to deny or condition a well work permit. Pursuant to West Virginia Code § 22-6A-8(d), the permit may not be issued or be conditioned, including conditions with respect to the location of the well and access roads prior to issuance if the director determines that:

- (1) The proposed well work will constitute a hazard to the safety of persons;
- (2) The plan for soil erosion and sediment control is not adequate or effective;
- (3) Damage would occur to publicly owned lands or resources; or
- (4) The proposed well work fails to protect fresh water sources or supplies.

A permit may also be denied under West Virginia Code § 22-6A-7(k), the secretary shall deny the issuance of a permit if the secretary determines that the applicant has committed a substantial violation of a previously issued permit for a horizontal well, including the applicable erosion and sediment control plan associated with the previously issued permit, or a substantial violation of one or more of the rules promulgated under this article, and in each instance has failed to abate or seek review of the violation within the time prescribed by the secretary pursuant to the provisions of subdivisions (1) and (2), subsection (a), section five of this article and the rules promulgated hereunder, which time may not be unreasonable.

Pursuant to West Virginia Code § 22-6A-10(g), any person entitled to submit written comments to the secretary pursuant to subsection (a), section eleven of this article, shall also be entitled to receive from the secretary a copy of the permit as issued or a copy of the order modifying or denying the permit if the person requests receipt of them as a part of the written comments submitted concerning the permit application. Such persons may request, at the time of submitting written comments, notice of the permit decision and a list of persons qualified to test water.

RECEIVED  
Office of Oil and Gas

MAR 09 2017

WV Department of  
Environmental Protection

05/12/2017

WW-6A  
(8-13)

4706900224

API NO. 47-069 -  
OPERATOR WELL NO. Melvin Kahle OHI 6H  
Well Pad Name: Melvin Kahle OHI

**Notice is hereby given by:**

Well Operator: SWN Production Co., LLC  
Telephone: 832-796-1000  
Email: Dee\_Southall@swn.com



Address: P.O. Box 1300  
Jane Lew, WV 26378  
Facsimile:

**Oil and Gas Privacy Notice:**

The Office of Oil and Gas processes your personal information, such as name, address and telephone number, as part of our regulatory duties. Your personal information may be disclosed to other State agencies or third parties in the normal course of business or as needed to comply with statutory or regulatory requirements, including Freedom of Information Act requests. Our office will appropriately secure your personal information. If you have any questions about our use or your personal information, please contact DEP's Chief Privacy Officer at [depprivacyofficer@wv.gov](mailto:depprivacyofficer@wv.gov).

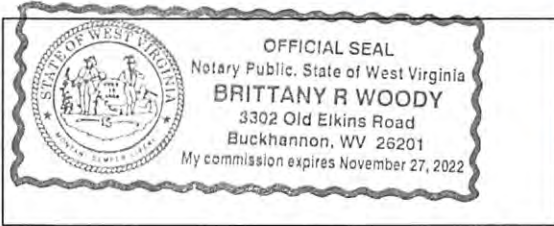

Subscribed and sworn before me this 23<sup>rd</sup> day of January 2017  
Brittany R Woody Notary Public  
My Commission Expires 11/27/22

RECEIVED  
Office of Oil and Gas  
MAR 09 2017  
WV Department of  
Environmental Protection 05/12/2017

Attachment #1

Water Purveyors within 1500' - Melvin Kahle OHI Pad

LANDOWNER  
Melvin Kahle Jr  
Connie Davis

SOURCE  
3 Springs  
Spring

WELL DEPTH

Address

28 Maple Avenue Wheeling, WV 26003  
278 McNash Road Triadelphia, WV 26059

RECEIVED  
Office of Oil and Gas  
MAR 09 2017  
WV Department of  
Environmental Protection

05/12/2017

STATE OF WEST VIRGINIA  
DEPARTMENT OF ENVIRONMENTAL PROTECTION, OFFICE OF OIL AND GAS  
NOTICE OF INTENT TO DRILL

Pursuant to W. Va. Code § 22-6A-16(b), the Notice of Intent to Drill is only required if the notice requirements of W. Va. Code § 22-6A-10(a) have NOT been met or if the Notice of Intent to Drill requirement has NOT been waived in writing by the surface owner.

**Notice Time Requirement:** Notice shall be provided at least TEN (10) days prior to filing a permit application.  
**Date of Notice:** 01/24/2017 **Date Permit Application Filed:** 3/7/17

**Delivery method pursuant to West Virginia Code § 22-6A-16(b)**

HAND DELIVERY  CERTIFIED MAIL RETURN RECEIPT REQUESTED

Pursuant to W. Va. Code § 22-6A-16(b), at least ten days prior to filing a permit application, an operator shall, by certified mail return receipt requested or hand delivery, give the surface owner notice of its intent to enter upon the surface owner's land for the purpose of drilling a horizontal well: *Provided*, That notice given pursuant to subsection (a), section ten of this article satisfies the requirements of this subsection as of the date the notice was provided to the surface owner: *Provided, however*, That the notice requirements of this subsection may be waived in writing by the surface owner. The notice, if required, shall include the name, address, telephone number, and if available, facsimile number and electronic mail address of the operator and the operator's authorized representative.

**Notice is hereby provided to the SURFACE OWNER(s):**

Name: Melvin W. & Carol M. Kahle / Name: \_\_\_\_\_  
Address: 28 Maple Ave. / Address: \_\_\_\_\_  
Wheeling, WV 26003 /

**Notice is hereby given:**

Pursuant to West Virginia Code § 22-6A-16(b), notice is hereby given that the undersigned well operator has an intent to enter upon the surface owner's land for the purpose of drilling a horizontal well on the tract of land as follows:

State: West Virginia UTM NAD 83 Easting: 531,962.45  
County: Ohio Northing: 4,435,782.73  
District: Triadelphia Public Road Access: Chapel Hill Road  
Quadrangle: Wheeling, WV Generally used farm name: Melvin Kahle  
Watershed: Upper Ohio South

**This Notice Shall Include:**

Pursuant to West Virginia Code § 22-6A-16(b), this notice shall include the name, address, telephone number, and if available, facsimile number and electronic mail address of the operator and the operator's authorized representative. Additional information related to horizontal drilling may be obtained from the Secretary, at the WV Department of Environmental Protection headquarters, located at 601 57<sup>th</sup> Street, SE, Charleston, WV 25304 (304-926-0450) or by visiting [www.dep.wv.gov/oil-and-gas/pages/default.aspx](http://www.dep.wv.gov/oil-and-gas/pages/default.aspx).

**Notice is hereby given by:**

Well Operator: SWN Production Company, LLC Authorized Representative: Michael Yates  
Address: PO Box 1300, 179 Innovation Drive Address: PO Box 1300, 179 Innovation Drive  
Jane Lew, WV 26378 Jane Lew, WV 26378  
Telephone: 304-517-6603 Telephone: 304-517-6603  
Email: Michael\_Yates@SWN.com Email: Michael\_Yates@SWN.com  
Facsimile: 304-471-2497 Facsimile: 304-471-2497

**Oil and Gas Privacy Notice:**

The Office of Oil and Gas processes your personal information, such as name, address and telephone number, as part of our regulatory duties. Your personal information may be disclosed to other State agencies or third parties in the normal course of business or as needed to comply with statutory or regulatory requirements, including Freedom of Information Act requests. Our office will appropriately secure your personal information. If you have any questions about our use or your personal information, please contact DEP's Chief Privacy Officer at [depprivacyofficer@wv.gov](mailto:depprivacyofficer@wv.gov).

Office of Oil and Gas  
MAR 09 2017  
WV Department of Environmental Protection  
05/12/2017

STATE OF WEST VIRGINIA  
DEPARTMENT OF ENVIRONMENTAL PROTECTION, OFFICE OF OIL AND GAS  
NOTICE OF PLANNED OPERATION

Notice Time Requirement: notice shall be provided no later than the filing date of permit application.  
Date of Notice: 01/24/2017 Date Permit Application Filed: 3/7/17

Delivery method pursuant to West Virginia Code § 22-6A-16(c)

- CERTIFIED MAIL RETURN RECEIPT REQUESTED
- HAND DELIVERY

Pursuant to W. Va. Code § 22-6A-16(c), no later than the date for filing the permit application, an operator shall, by certified mail return receipt requested or hand delivery, give the surface owner whose land will be used for the drilling of a horizontal well notice of the planned operation. The notice required by this subsection shall include: (1) A copy of this code section; (2) The information required to be provided by subsection (b), section ten of this article to a surface owner whose land will be used in conjunction with the drilling of a horizontal well; and (3) A proposed surface use and compensation agreement containing an offer of compensation for damages to the surface affected by oil and gas operations to the extent the damages are compensable under article six-b of this chapter. (d) The notices required by this section shall be given to the surface owner at the address listed in the records of the sheriff at the time of notice.

Notice is hereby provided to the SURFACE OWNER(s)  
(at the address listed in the records of the sheriff at the time of notice):

Name: Melvin W. & Carol M. Kahle / Name: \_\_\_\_\_  
Address: 28 Maple Ave. Address: \_\_\_\_\_  
Wheeling, WV 26003

Notice is hereby given:

Pursuant to West Virginia Code § 22-6A-16(c), notice is hereby given that the undersigned well operator has developed a planned operation on the surface owner's land for the purpose of drilling a horizontal well on the tract of land as follows:

State: West Virginia UTM NAD 83 Easting: 531,962.45  
County: Ohio Northing: 4,435,782.73  
District: Triadelphia Public Road Access: Chapel Hill Road  
Quadrangle: Wheeling, WV Generally used farm name: Melvin Kahle  
Watershed: Upper Ohio South

This Notice Shall Include:

Pursuant to West Virginia Code § 22-6A-16(c), this notice shall include: (1) A copy of this code section; (2) The information required to be provided by W. Va. Code § 22-6A-10(b) to a surface owner whose land will be used in conjunction with the drilling of a horizontal well; and (3) A proposed surface use and compensation agreement containing an offer of compensation for damages to the surface affected by oil and gas operations to the extent the damages are compensable under article six-b of this chapter. Additional information related to horizontal drilling may be obtained from the Secretary, at the WV Department of Environmental Protection headquarters, located at 601 57<sup>th</sup> Street, SE, Charleston, WV 25304 (304-926-0450) or by visiting [www.dep.wv.gov/oil-and-gas/pages/default.aspx](http://www.dep.wv.gov/oil-and-gas/pages/default.aspx).

Well Operator: SWN Production Company, LLC Address: PO Box 1300, 179 Innovation Drive  
Telephone: 304-517-6603 Jane Lew, WV 26378  
Email: Michael\_Yates@SWN.com Facsimile: 304-471-2497

Oil and Gas Privacy Notice:

The Office of Oil and Gas processes your personal information, such as name, address and telephone number, as part of our regulatory duties. Your personal information may be disclosed to other State agencies or third parties in the normal course of business or as needed to comply with statutory or regulatory requirements, including Freedom of Information Act requests. Our office will appropriately secure your personal information. If you have any questions about our use or your personal information, please contact DEP's Chief Privacy Officer at [depprivacyofficer@wv.gov](mailto:depprivacyofficer@wv.gov).

RECEIVED  
Office of Oil and Gas  
MAR 09 2017  
WV Department of Environmental Protection  
05/12/2017



## WEST VIRGINIA DEPARTMENT OF TRANSPORTATION

## Division of Highways

1900 Kanawha Boulevard East • Building Five • Room 110  
Charleston, West Virginia 25305-0430 • (304) 558-3505

Jim Justice  
Governor

Gregory L. Bailey, P. E.  
Acting Commissioner of Highways

January 25, 2017

James A. Martin, Chief  
Office of Oil and Gas  
Department of Environmental Protection  
601 57<sup>th</sup> Street, SE  
Charleston, WV 25304

Subject: DOH Permit for the Melvin Kahle Pad, Ohio County  
Melvin Kahle OHI 6H 47-069-00224

Dear Mr. Martin,

The West Virginia Division of Highways has transferred Permit #06-2011-0668 for the subject site to Southwestern Energy for access to the State Road for the well site located off of Ohio County Route 8 SLS.

The operator has signed an OIL AND GAS ROAD MAINTENANCE BONDING AGREEMENT and provided the required Bond. This operator is currently in compliance with the DOH OIL AND GAS POLICY dated January 3, 2012.

Very Truly Yours,

Gary K. Clayton, P.E.  
Regional Maintenance Engineer  
Central Office Oil & Gas Coordinator

Cc: Brittany Woody  
Southwestern Energy  
CH, OM, D-6  
File

RECEIVED  
Office of Oil and Gas  
MAR 09 2017  
WV Department of Environmental Protection 05/12/2017

Product Name	Product Use	Chemical Name	CAS Number
EC6734A (Champion Technologies)	Biocide	Hydrogen Peroxide	7722-84-1
		Acetic Acid	64-19-7
		Peroxyacetic Acid	79-21-0
GYPTRON T-390 (Champion Technologies)	Scale Inhibitor	Methanol	67-56-1
		Nonylphenol Ethoxylate	Proprietary
Bactron K-139 (Champion Technologies)	Biocide	Glutaraldehyde	111-30-8
		Quaternary Ammonium Compounds, Benzyl-C12-16-Alkyldimethyl, Chlorides	68424-85-1
		Ethanol	64-17-5
Bactron K-219 (Champion Technologies)	Biocide	Methanol	67-56-1
		Quaternary Ammonium Compounds, Benzyl-C12-16-Alkyldimethyl, Chlorides	68424-85-1
A264 (Schlumberger)	Corrosion Inhibitor	Methanol	67-56-1
		Aliphatic Acids	Proprietary
		Prop-2-yn-1-ol	107-19-7
		Aliphatic Alcohols, Ethoxylated #1	Proprietary
Myacide GA 25 (Schlumberger)	Biocide	Water	7732-18-5
		Glutaral	111-30-8
Scale Inhibitor B317 (Schlumberger)	Scale Inhibitor	Trisodium Ortho Phosphate	7601-54-9
		Ethane-1,2-diol	107-21-1
H215 (Schlumberger)	Hydrochloric Acid	Hydrochloric Acid	7647-01-0
J218 (Schlumberger)	Breaker	Diammonium Peroxidisulphate	7727-54-0
EB-Clean* J475 (Schlumberger)	Breaker	Diammonium Peroxidisulphate	7727-54-0
Water Gelling Agent J580 (Schlumberger)	Gel	Carbohydrate Polymer	Proprietary
Friction Reducer J609W (Schlumberger)	Friction Reducer	Ammonium Sulfate	7783-20-2
		Urea	57-13-6
Crosslinker J610 (Schlumberger)	Crosslinker	Potassium Hydroxide	1310-58-3
		Aliphatic Polyol	Proprietary
Iron Stabilizer L58 (Schlumberger)	Iron Stabilizer	Sodium Erythorbate	6381-77-7
40/70-Mesh Sand S012 (Schlumberger)	Sand	Crystalline Silica	14808-60-7
Sand S100 (Schlumberger)	Sand	Crystalline Silica	14808-60-7
EC6486A (Nalco Champion)	Scale Inhibitor	Amine Triphosphate	Proprietary
		Ethylene Glycol	107-21-1
SSA-2 (Halliburton)	Sand	Crystalline Silica	14808-60-7
FR-76 (Halliburton)	Friction Reducer	Inorganic salt	Proprietary
		Hydrotreated light petroleum distillate	Proprietary
LCA-1 (Halliburton)		Hydrotreated light petroleum distillate	Proprietary
SP BREAKER (Halliburton)	Breaker	Sodium Persulfate	7775-27-1



4706900224

Product Name	Product Use	Chemical Name	CAS Number
HAI-150E (Halliburton)	Corrosion Inhibitor	Methanol	NA
		Aliphatic Acids	
		Prop-2-yn-1-ol	
		Aliphatic Alcohols, Ethoxylated #1	
Diesel Fuel (Halliburton)		Diesel Fuel	68476-34-6
Hydrochloric Acid 10-30% (Halliburton)		Hydrochloric Acid	7647-01-0
WG-36 Gelling Agent (Halliburton)	Gel	Polysaccharide	9000-30-0
BC-140C (Halliburton)	Crosslinker		NA

RECEIVED  
Office of Oil and Gas  
MAR 09 2017  
WV Department of Environmental Protection 05/12/2017

# MELVIN KAHLE PAD "A" CONSTRUCTION AND RECLAMATION PLAN AS-BUILT TRIADELPHIA DISTRICT OHIO COUNTY, WV MARCH 2017



**WVDEP OOG  
ACCEPTED AS-BUILT**

*WJ* 5/3/2017

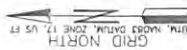

**LOD**  
TOTAL DISTURBED AREA: 8.14 ACRES  
ROAD DISTURBED AREA: 0.37 ACRES  
PAD DISTURBED AREA: 7.17 ACRES

**COORDINATES**

SITE ENTRANCE (NAD83)
LAT: 40.073418
LONG: 80.625320
CENTER OF PAD (NAD83)
LAT: 40.071866
LONG: 80.625227
GATHERING AREA (NAD83)
LAT: 40.073418
LONG: 80.625320
EXISTING WELL 3H (NAD83)
LAT: 40.071864
LONG: 80.625292
API: 069-00124
EXISTING WELL 8H (NAD83)
LAT: 40.071863
LONG: 80.625289
API: 069-00070

- SHEET INDEX**
- TS1: TITLE SHEET
  - EP2.1 EVACUATION ROUTE/PREVALING WIND
  - EP2.2 EVACUATION ROUTE/PREVALING WIND
  - AS3.1 ASBUILT OVERVIEW
  - AS3.2 ASBUILT
  - AS3.3 ASBUILT
  - ASR4.1 CONSTRUCTION AND RECLAMATION ACCESS ROAD PROFILE
  - MRD5.1 RECLAMATION PLAN OVERVIEW
  - MRD5.2 RECLAMATION PLAN
  - MRD5.3 RECLAMATION PLAN
  - MRD6.1 RECLAMATION DETAILS
  - MRD6.2 RECLAMATION DETAILS



NO	DATE	REVISION
#1	03-20-17	WDEP COMMENTS
#2	05-02-17	WDEP COMMENTS

PROJECT # 16-51  
DATE 2016-10-17  
DRAWN BY NKL  
CHECKED BY MCH



**ELK LAKE SERVICES, LLC**  
280 Indian Springs Road, Suite 123  
Indiana, PA 15701  
Phone (724) 463-7303

**SWN**  
Southwestern Energy  
P O Box 672625  
Houston, TX 77267

MELVIN KAHLE  
PAD "A"  
TRIADELPHIA DISTRICT  
OHIO COUNTY  
WEST VIRGINIA

TITLE SHEET  
SHEET NO. TSI

**COORDINATES:**

SITE ENTRANCE (NAD83)  
 LAT: 40.073418  
 LONG: 80.625320

CENTER OF PAD (NAD83)  
 LAT: 40.071685  
 LONG: 80.625227

GATHERING AREA (NAD83)  
 LAT: 40.073418  
 LONG: 80.625320

EXISTING WELL 3H (NAD83)  
 LAT: 40.071864  
 LONG: 80.625292

EXISTING WELL 8H (NAD83)  
 LAT: 40.071833  
 LONG: 80.625269

API: 069-00124

**NOTES:**

1. PROPERTY LINES PROVIDED BY GIS DATA.

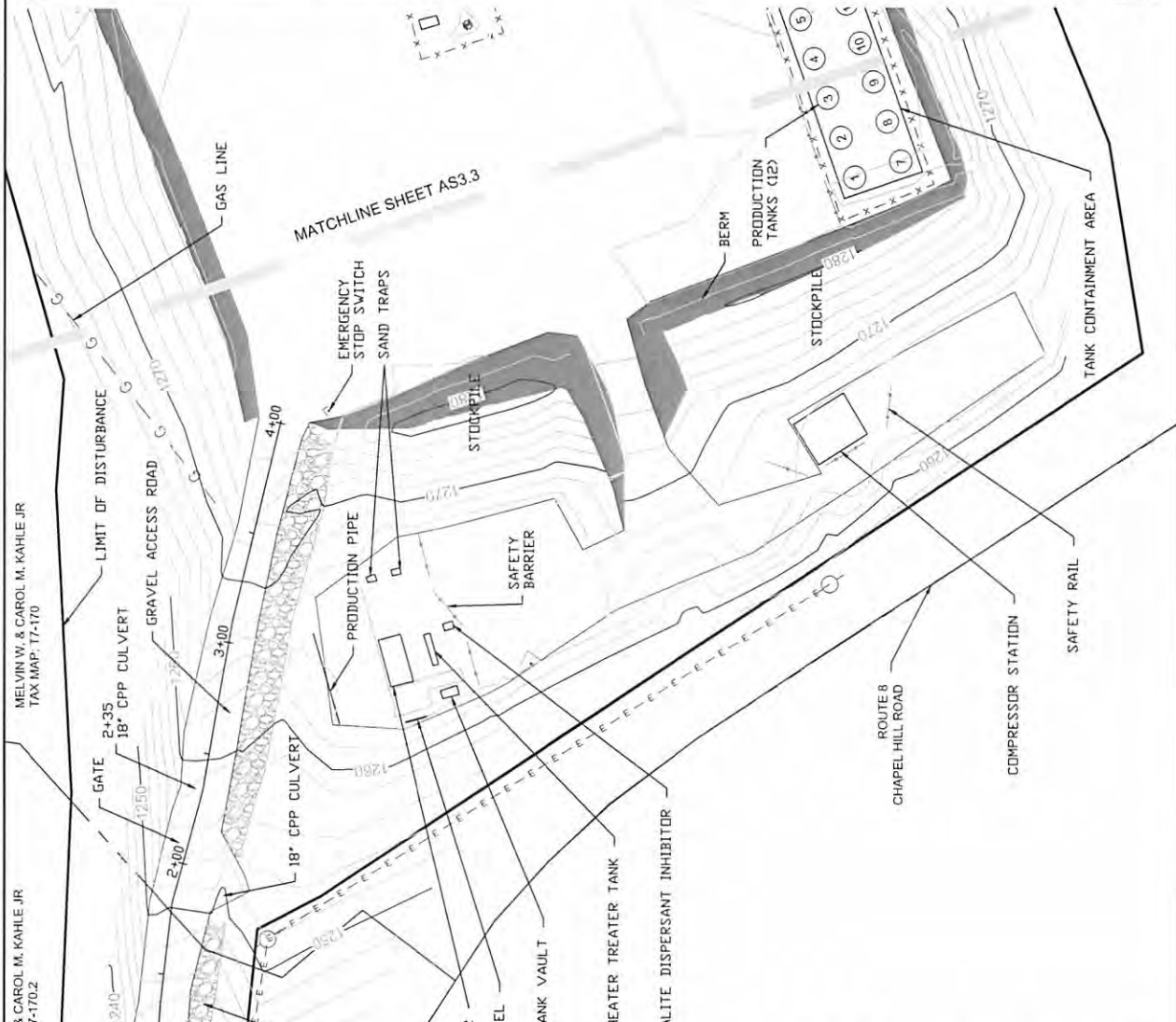

PRODUCTION TANKS	
TANK NO.	EASTING
#1	1,653,400.87
#2	1,653,409.95
#3	1,653,419.03
#4	1,653,428.11
#5	1,653,437.19
#6	1,653,446.39
#7	1,653,381.89
#8	1,653,390.97
#9	1,653,400.05
#10	1,653,409.13
#11	1,653,418.21
#12	1,653,427.88

NO	DATE	REVISION
#1	03-20-17	WDEP COMMENTS
#2	05-02-17	WDEP COMMENTS

PROJECT # 16-51  
 DATE: 2016-10-17  
 DRAWN BY: REL  
 CHECKED BY: MCH

**ELK LAKE SERVICES, LLC**  
 280 Indian Springs Road, Suite 123  
 Indiana, PA 15701  
 Phone: (724) 463-7303

**SWM**  
 Southwestern Energy Company  
 P.O. Box 672625  
 Houston, TX 77267

MELVIN KAHLE  
 PAD "A"  
 TRAILBLAZER DISTRICT  
 WEST VIRGINIA  
 AS-BUILT  
 ASS.3

**COORDINATES:**  
 SITE ENTRANCE (NAD83)  
 LAT: 40.073418  
 LONG: 80.625320  
 CENTER OF PAD (NAD83)  
 LAT: 40.071685  
 LONG: 80.625227  
 GATHERING AREA (NAD83)  
 LAT: 40.073418  
 LONG: 80.625320  
 EXISTING WELL 3H (NAD83)  
 LAT: 40.071684  
 LONG: 80.625292  
 API: 069-00124  
 EXISTING WELL 8H (NAD83)  
 LAT: 40.071683  
 LONG: 80.625269  
 API: 069-00070

**NOTES:**  
 1. PROPERTY LINES PROVIDED BY GIS DATA.

- LEGEND:**
- EDGE GRAVEL
  - PROPERTY LINE
  - STREAM
  - CONTOUR MINOR ASB
  - CONTOUR MAJOR ASB
  - RIP-RAP
  - LIMIT OF DISTURBANCE
  - CULVERT
  - FENCE
  - BERM

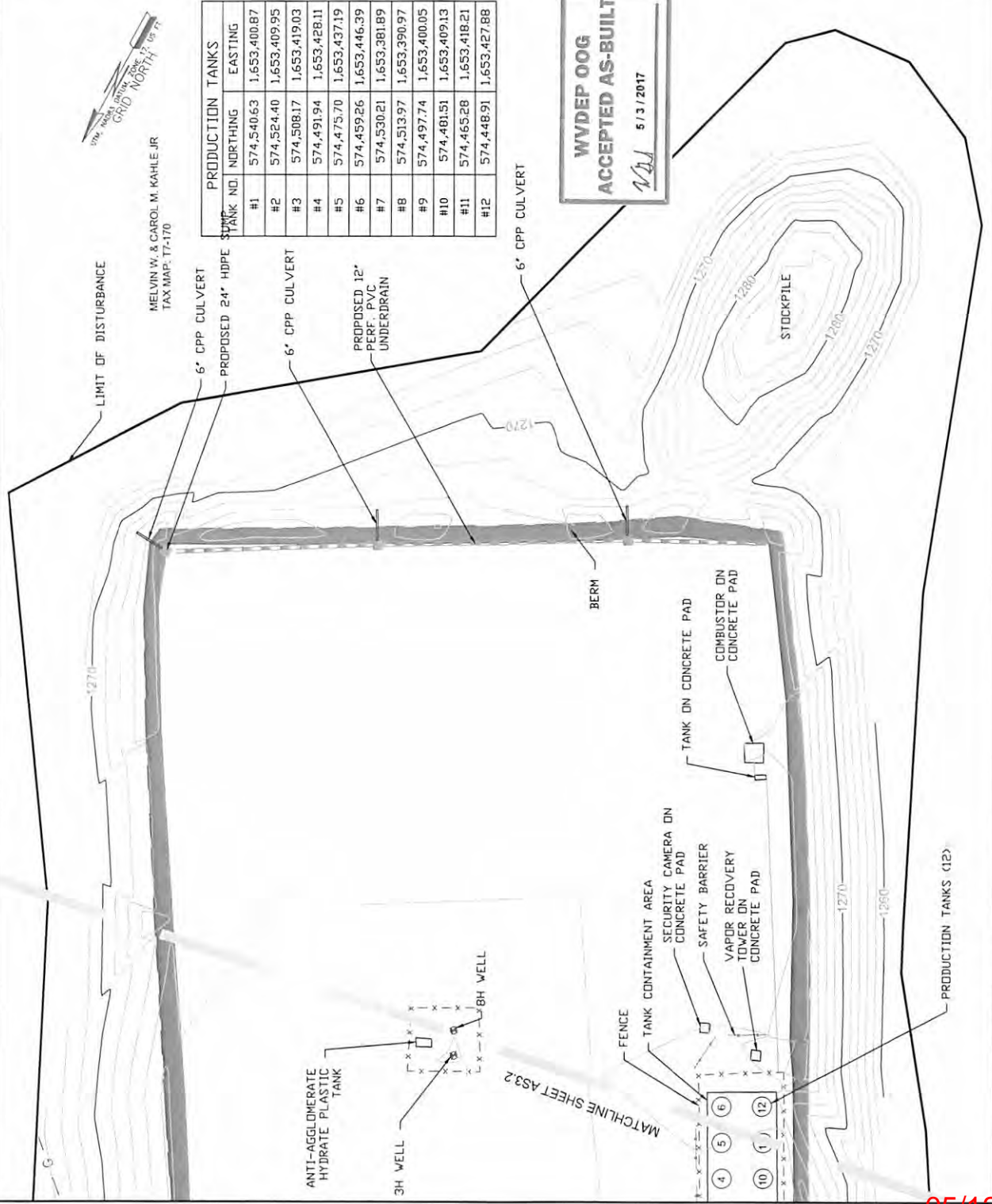

TANK NO.	NORTHING	EASTING
#1	574,540.63	1,653,400.87
#2	574,524.40	1,653,409.95
#3	574,508.17	1,653,419.03
#4	574,491.94	1,653,428.11
#5	574,475.70	1,653,437.19
#6	574,459.26	1,653,446.39
#7	574,530.21	1,653,381.89
#8	574,513.97	1,653,390.97
#9	574,497.74	1,653,400.05
#10	574,481.51	1,653,409.13
#11	574,465.28	1,653,418.21
#12	574,448.91	1,653,427.88

**WVDEP OOG**  
**ACCEPTED AS-BUILT**  
 5/3/2017

# MELVIN CONSTRUCTION

# TRIANGLE OHIO C

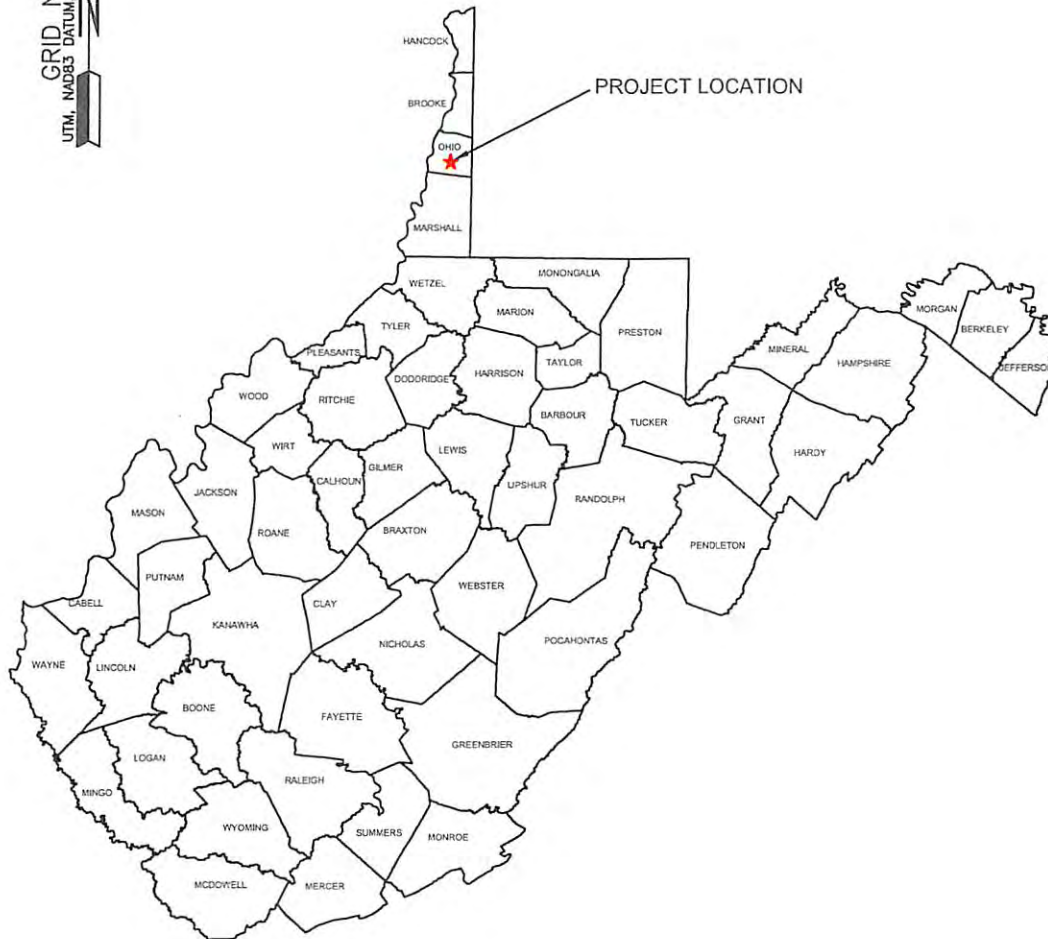
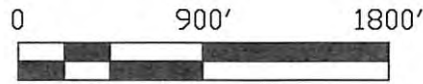

<u>LOD</u>
TOTAL DISTURBANCE
ROAD DISTURBANCE
PAD DISTURBANCE

<u>COORDINATES</u>
<u>SITE ENTRANCE</u>
LAT: 40.073418
LONG: 80.625320
<u>CENTER POINT</u>
LAT: 40.073418
LONG: 80.625320
<u>GATHERING AREA</u>
LAT: 40.073418
LONG: 80.625320
<u>EXISTING ROAD</u>
LAT: 40.073418
LONG: 80.625320

