

ELK LAKE SERVICES, LLC

280 Indian Springs Road,
Suite 123 Indiana, PA 15701
Phone: (724) 463-7303

Latitude: 40°05'00"

Latitude: 40°05'00" SURFACE HOLE 46'

BOTTOM HOLE 10700'

SURFACE HOLE LOCATION (SHL):
UTM (NAD83, ZONE 17, METERS):
NORTHING: 4,435,782.73
EASTING: 531,962.45

LANDING POINT (LPL):
UTM (NAD83, ZONE 17, METERS):
NORTHING: 4,435,551.57
EASTING: 531,801.24

BOTTOM HOLE LOCATION (BHL):
UTM (NAD83, ZONE 17, METERS):
NORTHING: 4,434,068.08
EASTING: 532,277.35

GRID NORTH
UTM, NAD83 DATUM, ZONE 17, US FT

TRACT	SURFACE OWNER / ROYALTY OWNER	TAX PARCEL	ACRES
1	MELVIN W. KAHLE AND CAROL M. KAHLE	6-T7-170	84.99
2	MARY ANGELA DICKEY	08-17-171	99.95
3	CONNIE DAVIS	8-17-172.16	10.036
4	ROBERT T. SELAK AND TAMMY L. SELAK	8-17-172.13	1.078
5	ROBERT T. SELAK AND TAMMY L. SELAK	8-17-172.18	0.126
6	BRIAN W. VOSSSEN AND TAMMIRA K. VOSSSEN	6-17-172.1	33.8
7	RANDALL E. BARTLETT	6-17-172.15	1
8	CLARK EDWARD MCKEE	6-17-174	61
9	LOUIS G. BRINKMEIER JR. AND JELINDA A. BRINKMEIER	6-T7-175	45.238
10	LINDA L. CLARK	7-TW3-1	10.4

TRACT	SURFACE OWNER	TAX PARCEL	ACRES
A	MELVIN W. & CAROL M. KAHLE JR.	6-T7-170.2	1.14
B	MELVIN W. KAHLE JR.	6-T2-36	28.47
C	FRANCIS A. & D.M. RIGGS	6-TBE-3	4.35
D	CHAS M. SLEDD COMPANY	7-TW7-1	2.96
E	CHAS M. SLEDD COMPANY	7-TW7-2	5.84
F	NAGLE FAMILY IRREVOCABLE TRUST	6-TW7-3	0.97
G	OHIO COUNTY PUBLIC SERV DIST	7-TW7-4.1	0.18
H	OHIO COUNTY PUBLIC SERV DIST	7-TW7-5	0.46
I	OHIO COUNTY PUBLIC SERV DIST	7-TW7-6	0.56
J	OHIO COUNTY PUBLIC SERV DIST	7-TW7-7	0.56
K	KEVIN S. & BRENDA A. KOSEM	7-TW7-8	1.19
L	EDWARD P. & JEAN C. LAUFFER (LE)	7-TW7-9	0.6
M	KEVIN S. & BRENDA A. KOSEM	7-TW7-10	0.61
N	KEVIN S. & BRENDA A. KOSEM	7-TW7-11	2.4
O	KEVIN S. & BRENDA A. KOSEM	7-TW7-12	0.98
P	EDWARD B. HARTLUB	7-TW8-2.1	0.54
Q	DAVID A. & KIMBERLY D. DOUGLASS	7-TW8-6	0.3
R	LARRY R. & REBECCA L. KALO	7-TW8-7	0.18
S	MATTHEW H. GOSSETT	7-TW8-14	0.21
T	MATTHEW H. & LEIGH ANN GOSSETT	7-TW8-14.3	0.19
U	MATTHEW H. GOSSETT	7-TW8-14.1	0.33
V	MICHELLE L. PARSONS	7-TW8-17	0.33
W	MICHELLE L. PARSONS	7-TW8-18-2	0.15
X	CLARENCE M. & BJ DENAUL	7-TW8-19	0.54
Y	CARPET UNLIMITED INC	7-TW8-2	0.67
Z	CARPET UNLIMITED INC	7-TW8-2.1	0.3
AA	CAROL L. McDONALD	7-TW8-21	0.27
BB	WILLIAM M. & S.R. ROSEMEIER	7-TW8-22	0.24
CC	ELMER & MARTHA ANDREWS	7-TW8-23	0.29
DD	JOHN WILLIAM NASH	7-TW8-24	0.97
EE	MIDTOWN MOBILE HOMES, INC	7-TW8-25	0.35
FF	WOODROW J. KNOLLINGER, JR.	7-TW8-26	0.23
GG	RAMOND FRANK HELBING, JR	7-TW8-27	0.09
HH	RAMOND FRANK HELBING, JR	7-TW8-28	0.09
II	R.S. HELBING	7-TW8-29	0.11
JJ	THOMAS J. HASSIF, JR.	7-TW8-30	0.16
KK	BOBBY D. PLANTS	7-TW8-30.1	0.25
LL	LINDA L. CLARK	7-TW4-50	0.47
MM	MIDTOWN MOBILE HOMES, INC	7-TW4-49	0.09
NN	WM G. & ALICE N. EICKLER	7-TW4-48	0.1
OO	DAWN M. MEANS	7-TW4-47	0.45
PP	LINDA L. CLARK	7-T7-187	0.13
QQ	ROBERT C. & S.G. TRENTON	7-T7-186	3.91
RR	WILLIAM J. BRINKMEIER	6-T7-175.2	1.9
SS	LOUIS BRINKMEIER, JR.	6-T7-175.1	10.44
TT	WILDA-LE BRINKMEIER	6-T7-165.1	3.02
UU	ABUNDANT LIFE BAPTIST CHURCH	6-T7-172.14	22.13
VV	RANDALL E. & D.M. BARTLETT	6-T7-172.4	7.25
WW	JERRY L. & CYNTHIA KOPIAR	6-T7-172.6	4.87
XX	DAVID A. DICKEY	6-T7-172.3	3.6
YY	WILLIAM R. & TERRY L. BENNETT	6-T7-172.11	2.87
ZZ	DAVID L. & MARY LOU FURBEE	6-T7-172.5	2.54
AB	THOMAS SCOTT TOMINACK	6-T7-172.7	4.18
AC	THOMAS S. & M.D. TOMINACK	6-T7-172.8	3.68
AD	MARK A. & ALAIRE S. KNOX	6-T7-172.10	3.82
AE	THOMAS & CATHY MILLER	6-T7-172.17	2.03
AF	JOSEPH T. SUBASIC	6-T7-161	0.4
AG	470 LAND CO. LLC	6-T7-158	30.04
AH	KAREN J. BUTLER	6-T7-160	2.94

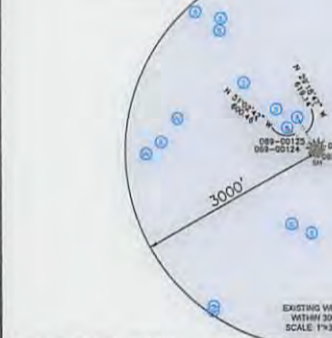
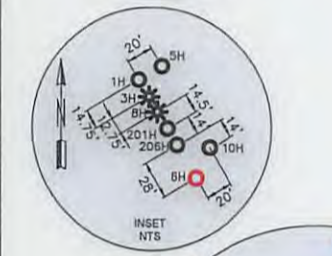
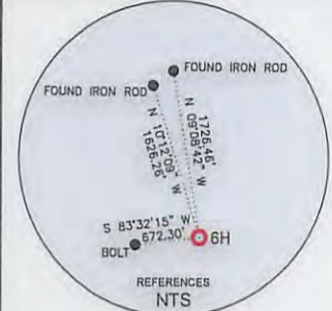

WELL RESTRICTIONS

1. NO OCCUPIED DWELLINGS > 2500 SQ FT. WITHIN 625 FEET OF CENTER OF PAD.
2. NO AGRICULTURE BUILDINGS > 2500 SQ FT. WITHIN 625 FEET OF CENTER OF PAD.
3. WATER WELLS OR DEVELOPED SPRINGS ARE WITHIN 531 FEET OF PROPOSED WELL.
4. PERENNIAL STREAMS, LAKES, PONDS, OR RESERVOIRS ARE WITHIN THE LIMITS OF DISTURBANCE.
5. NO NATURALLY PRODUCING TROUT STREAM WITHIN 300 FEET OF LIMITS OF DISTURBANCE.
6. NO GROUND INTAKE OR PUBLIC WATER SUPPLY WITHIN 1000 FEET OF WELL PAD, LIMITS OF DISTURBANCE, E & S CONTROLS OR PUBLIC WATER SUPPLY.

NOTES ON SURVEY

1. SURFACE AND ROYALTY OWNER INFORMATION AND THEIR BOUNDARIES SHOWN HEREON WERE PLOTTED FROM DEEDS AND/OR TAX PARCEL MAPS PROVIDED BY CLIENT AND/OR FIELD LOCATIONS.
2. THIS PLAT DOES NOT REPRESENT A BOUNDARY SURVEY OF THE PARCELS SHOWN HEREON.
3. ALL INSETS ARE GRID NORTH UNLESS OTHERWISE DEPICTED.

I, THE UNDERSIGNED, HEREBY CERTIFY THAT THIS PLAT IS CORRECT TO THE BEST OF MY KNOWLEDGE AND BELIEF AND SHOWS ALL THE INFORMATION REQUIRED BY LAW AND REGULATIONS ISSUED AND PRESCRIBED BY THE DEPARTMENT OF ENVIRONMENTAL PROTECTION.

P.S. 2164

[Signature]

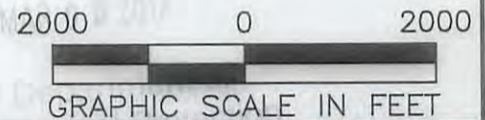
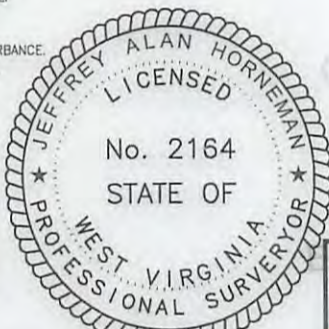

COMPANY: **SWN** Production Company, LLC **SWN** Production Company™

<p>(+) DENOTES LOCATION OF WELL ON UNITED STATES TOPOGRAPHIC MAPS</p> <p>WVDEP OFFICE OF OIL & GAS 601 57TH STREET CHARLESTON, WV 25034</p>	<p>MINIMUM DEGREE OF ACCURACY: 1/200</p> <p>PROVEN SURVEY SOURCE OF ELEVATION: GRADE GPS (NAVD 88, US FT)</p>	<p>COMPANY: MELVIN KAHLE OHI</p> <p>OPERATOR'S WELL #: 6H</p> <p>API WELL #: 47 69 00224</p> <p>STATE COUNTY PERMIT</p>
	<p>WELL TYPE: OIL <input type="checkbox"/> WASTE DISPOSAL <input type="checkbox"/> PRODUCTION <input checked="" type="checkbox"/> DEEP <input type="checkbox"/> GAS <input checked="" type="checkbox"/> LIQUID INJECTION <input type="checkbox"/> STORAGE <input type="checkbox"/> SHALLOW <input checked="" type="checkbox"/></p> <p>WATERSHED: UPPER OHIO SOUTH ELEVATION: 1276.3'</p> <p>DISTRICT: TRIADELPHIA COUNTY: OHIO COUNTY QUADRANGLE: WHEELING & VALLEY GROVE</p> <p>SURFACE OWNER: MELVIN W. KAHLE AND CAROL M. KAHLE ACREAGE: ±84.99</p> <p>OIL & GAS ROYALTY OWNER: MELVIN W. KAHLE AND CAROL M. KAHLE ACREAGE: ±84.99</p> <p>DRILL <input checked="" type="checkbox"/> DRILL DEEPER <input type="checkbox"/> REDRILL <input type="checkbox"/> FRACTURE OR STIMULATE <input checked="" type="checkbox"/> PLUG OFF OLD FORMATION <input type="checkbox"/> PERFORATE NEW FORMATION <input checked="" type="checkbox"/></p> <p>CONVERT <input type="checkbox"/> PLUG & ABANDON <input type="checkbox"/> CLEAN OUT & REPLUG <input type="checkbox"/> OTHER CHANGE <input type="checkbox"/> (SPECIFY)</p> <p>TARGET FORMATION: MARCELLUS ESTIMATED DEPTH: 6,348' TVD 11,857' TMD</p>	<p>05/12/2017</p>

WELL OPERATOR: SWN PRODUCTION COMPANY, LLC DESIGNATED AGENT: DEE SOUTHALL
ADDRESS: P.O. BOX 1300 ADDRESS: P.O. BOX 1300
CITY: JANE LEW STATE: WV ZIP CODE: 26378 CITY: JANE LEW STATE: WV ZIP CODE: 26378

<p>LEGEND:</p> <ul style="list-style-type: none"> ○ PROPOSED SURFACE HOLE / BOTTOM HOLE ⊙ EXISTING / PRODUCING WELLHEAD LPL* LANDING POINT LOCATION ⊙ EXISTING WATER WELL ⊙ EXISTING SPRING — SURVEYED BOUNDARY — DRILLING UNIT ==== LEASE BOUNDARY — PROPOSED PATH 	<p>REVISIONS:</p> <table border="1"> <tr> <td> </td> <td> </td> </tr> <tr> <td> </td> <td> </td> </tr> <tr> <td> </td> <td> </td> </tr> <tr> <td> </td> <td> </td> </tr> </table>									<p>DATE: 03-06-2017</p> <p>FILE NO: 16-51</p> <p>DRAWN BY: H. JOHN</p> <p>SCALE: 1" = 2000'</p> <p>DRAWING NO: 1</p> <p>WELL LOCATION PLAT: 1</p>

ELK LAKE SERVICES, LLC

280 Indian Springs Road,
Suite 123 Indiana, PA 15701
Phone: (724) 463-7303

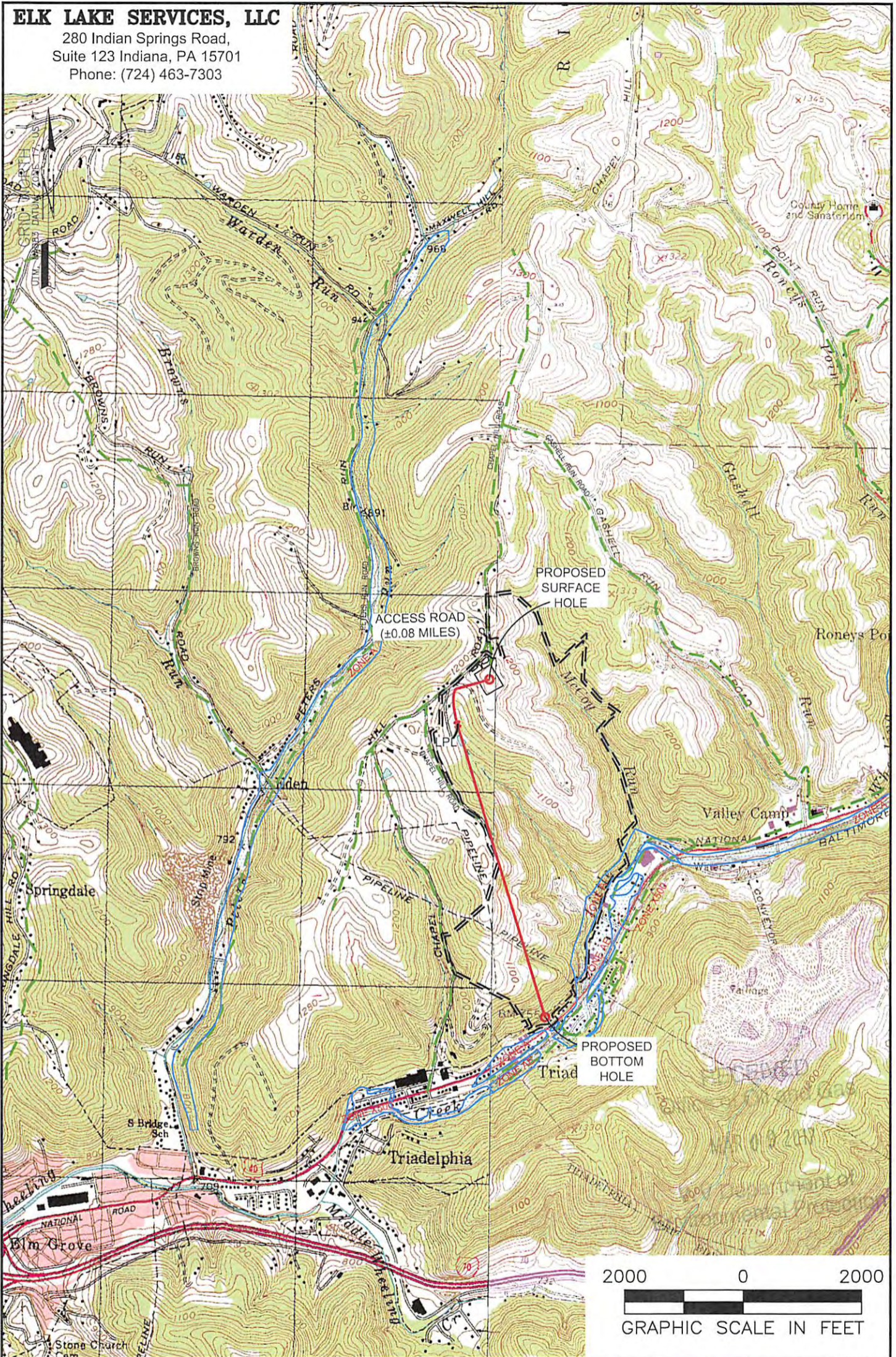

NOTES ON SURVEY

1. SURFACE AND ROYALTY OWNER INFORMATION AND THEIR BOUNDARIES SHOWN HEREON WERE PLOTTED FROM DEEDS AND/OR TAX PARCEL MAPS PROVIDED BY CLIENT AND/OR FIELD LOCATIONS.
2. THIS PLAT DOES NOT REPRESENT A BOUNDARY SURVEY OF THE PARCELS SHOWN HEREON.
3. ALL INSETS ARE GRID NORTH UNLESS OTHERWISE DEPICTED.

LEGEND:

- PROPOSED SURFACE HOLE / BOTTOM HOLE
- ☼ EXISTING / PRODUCING WELLHEAD
- LPL* LANDING POINT LOCATION
- FLOOD PLAIN
- ACCESS ROAD
- PUBLIC ROAD
- ACCESS ROAD TO PREV. SITE
- ==== LEASE BOUNDARY
- PROPOSED PATH

05/12/2017

WELL OPERATOR: SWN PRODUCTION COMPANY, LLC	WELL (FARM) NAME: MELVIN KAHLE OHI	WELL # 6H	SERIAL # XXXX
ADDRESS: P.O. BOX 1300 JANE LEW, WV 26378	COUNTY OHIO COUNTY - 69	DISTRICT: TRIADDELPHIA	
SURFACE OWNER: MELVIN W. KAHLE AND CAROL M. KAHLE	USGS 7 1/2 QUADRANGLE MAP NAME WHEELING, WV & VALLEY GROVE, WV		