

(2,000' SCALE) BOTTOM HOLE LATITUDE: 40°12'30" / 9716'

(2,000' SCALE) SURFACE HOLE LATITUDE: 40°10'00"

7340'



www.jhacompanies.com  
68011 Vineyard Road  
St. Clairsville, Ohio 43950  
740-695-6100



LINE	BEARING	DISTANCE
L1	N89°04'21"W	729.05'
L2	N72°32'37"W	766.65'

NOTES ON SURVEY

- COORDINATE SYSTEM IS UTM NAD 83 DATUM, ZONE 17, U.S. FOOT AND WELL COORDINATES ESTABLISHED USING SURVEY GRADE GPS.
- SURFACE AND ROYALTY OWNER INFORMATION AND THEIR BOUNDARIES SHOWN HEREON WERE PLOTTED FROM DEEDS AND/OR TAX PARCEL MAPS PROVIDED BY CLIENT AND/OR FIELD LOCATIONS.
- THIS PLAT DOES NOT REPRESENT A BOUNDARY SURVEY OF THE PARCELS SHOWN HEREON.
- NO DWELLINGS OR BUILDINGS WITHIN 625 FEET OF PROPOSED CENTER OF PAD
- NO PERENNIAL STREAMS, LAKES, PONDS, RESERVOIRS OR WETLANDS WITHIN 100 FEET OF THE LIMITS OF DISTURBANCE.
- NO NATURALLY PRODUCING TROUT STREAM WITHIN 300 FEET OF THE LIMITS OF DISTURBANCE.
- NO WATER WELLS OR DEVELOPED SPRINGS WITHIN 250 FEET OF PROPOSED WELL.
- NO DEEP WELLS WITHIN 3000'

06/07/2019

GRID NORTH  
UTM, NAD83 DATUM, ZONE 17, US

(2,000' SCALE) SURFACE HOLE LONGITUDE: -80°37'30"

9032'

(2,000' SCALE) BOTTOM HOLE LONGITUDE: -80°37'30"

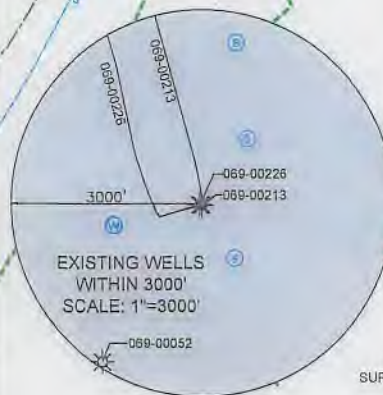

PROPOSED SURFACE HOLE

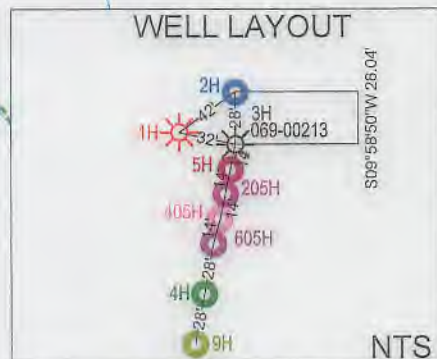

<b>SURFACE HOLE LOCATION (SHL):</b> UTM (NAD83, ZONE 17, METERS): NORTHING: 4445444.87 EASTING: 529682.80
<b>LANDING POINT LOCATION (LPL):</b> UTM (NAD83, ZONE 17, METERS): NORTHING: 4445643.82 EASTING: 529679.51
<b>BOTTOM HOLE LOCATION (BHL):</b> UTM (NAD83, ZONE 17, METERS): NORTHING: 4448181.19 EASTING: 528948.19

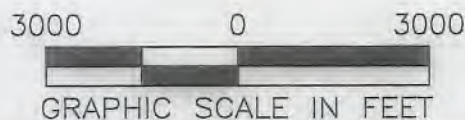
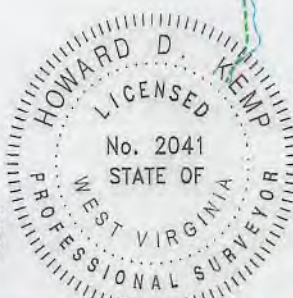

I, THE UNDERSIGNED, HEREBY CERTIFY THAT THIS PLAT IS CORRECT TO THE BEST OF MY KNOWLEDGE AND BELIEF AND SHOWS ALL THE INFORMATION REQUIRED BY LAW AND REGULATIONS ISSUED AND PRESCRIBED BY THE DEPARTMENT OF ENVIRONMENTAL PROTECTION.

P.S. 2041

COMPANY: **SWN** Production Company, LLC

	(+) DENOTES LOCATION OF WELL ON UNITED STATES TOPOGRAPHIC MAPS	MINIMUM DEGREE OF ACCURACY: 1/200	EDWARD DREMAK UP OHI
	WVDEP OFFICE OF OIL & GAS 601 57TH STREET CHARLESTON, WV 25034	PROVEN SOURCE OF ELEVATION: SURVEY GRADE GPS (NAVD 88, US FT)	OPERATOR'S WELL #: 2H
			API WELL #: 47 069 00300
			STATE COUNTY PERMIT

WELL TYPE: OIL <input type="checkbox"/> WASTE DISPOSAL <input type="checkbox"/> PRODUCTION <input checked="" type="checkbox"/> DEEP <input checked="" type="checkbox"/> GAS <input checked="" type="checkbox"/> LIQUID INJECTION <input type="checkbox"/> STORAGE <input type="checkbox"/> SHALLOW <input type="checkbox"/>	ELEVATION: 1,087.9'
WATERSHED: UPPER OHIO SOUTH	QUADRANGLE: TILTONSVILLE, OH
DISTRICT: RICHLAND COUNTY: OHIO	ACREAGE: ±34.19
SURFACE OWNER: ANDREW JOHN EVICK	ACREAGE: ±34.19
OIL & GAS ROYALTY OWNER: JOANNE V. DREMAK	
DRILL <input checked="" type="checkbox"/> DRILL DEEPER <input type="checkbox"/> REDRILL <input type="checkbox"/> FRACTURE OR STIMULATE <input checked="" type="checkbox"/> PLUG OFF OLD FORMATION <input type="checkbox"/> PERFORATE NEW FORMATION <input type="checkbox"/>	
CONVERT <input type="checkbox"/> PLUG & ABANDON <input type="checkbox"/> CLEAN OUT & REPLUG <input type="checkbox"/> OTHER CHANGE <input type="checkbox"/> (SPECIFY)	
TARGET FORMATION: POINT PLEASANT UNIT SIZE: 183.683 ACRES	ESTIMATED DEPTH: 10,414' TVD 19,458.4' TMD

WELL OPERATOR: SWN PRODUCTION COMPANY, LLC	DESIGNATED AGENT: BRITTANY WOODY
ADDRESS: P.O. BOX 1300	ADDRESS: P.O. BOX 1300
CITY: JANE LEW STATE: WV ZIP CODE: 26378	CITY: JANE LEW STATE: WV ZIP CODE: 26378

<b>LEGEND:</b>	<b>REVISIONS:</b>	<b>DATE:</b> 11-21-2018
PROPOSED SURFACE HOLE / BOTTOM HOLE	REVISED DDR 11-20-2018 PER DEP COMMENTS	
EXISTING / PRODUCING WELLHEAD		DRAWN BY: D. REED
LPL LANDING POINT LOCATION		SCALE: 1" = 3000'
EXISTING WATER WELL		DRAWING NO: 2018-284
EXISTING SPRING		WELL LOCATION PLAT



WELL BORE TABLE FOR SURFACE / ROYALTY OWNERS		
TRACT	SURFACE OWNER (S) / ROYALTY OWNER (R)	TAX PARCEL
1	ANDREW JOHN EVICK (S) / JOANNE V. DREMAK (R)	04-R5-54
TRACT	SURFACE OWNER	TAX PARCEL
2	ANDREW JOHN EVICK (S/R)	04-R5-49
3	BOARD OF COMMISSIONERS OHIO COUNTY (S) / CAROLE L. FREELAND, SHARI LYNN FREELAND & TERESA RENEE; DOROTHY HUMPHREY; ROBERT T. DAVIDSON; BETH L. CHRISTOPHER & JEFFREY CHRISTOPHER; AUDREY MAE PREDMORE; ANNA MAE MOORE & GERALD THOMAS MOORE; ARLENE F. BARRETT & JOSEPH CHARLES BARRETT; JOHN ARLEY FREELAND; BETTY JANE CLAYPOOLE, BY ANNA MOORE, HER ATTORNEY IN FACT; DALE E. WISARD & JANET WISARD; HAROLD E. WISARD & ELDINE WISARD; WILDA P. FREELAND, BY ERIC FREELAND, HER ATTORNEY IN FACT; ELEANOR FREELAND TESAREK & THOMAS TESAREK; ROBERT E. PETERS, SR.; ROBERT WISARD; JULIA A. FREELAND PRICE; LINDA FREELAND WHEELER & JAMES WHEELER, JR.; WILLIAM CHARLES FREELAND & LAURA ANNE FREELAND, JESSICA FREELAND; TRACY CASEY & DREW CASEY; JANICE L. STEINBRENNER; THOMAS A. WELDON; JAMES MILLER; JOHN PAUL FREELAND; JOSEPH ROBERT FREELAND & PATRICIA FREELAND; STEVEN S. WISARD & JULIE WISARD; ELIZABETH ELLEN FLUHARTY, BY DOUGLAS FLUHARTY, HER ATTORNEY IN FACT; CHERYL L. HUNTER; ELIZABETH ANN BECK & CHARLES ALLEN BECK; REBECCA BARLOW, A SINGLE WOMAN; THE BOARD OF OHIO COUNTY COMMISSIONERS; BENJAMIN C. BARLOW; MARIE B. RIDGEWAY LORENTZ, BY HER ATTORNEY IN FACT NANCY MARIE KEELY (DECEASED) (R)	04-R5-10
4	S.E.W. TRUST, C/O SHANE E. WOLOSCHAN (S)/ S.E.W. TRUST, SHANE E. WOLOSCHAN, TRUSTEE (R)	04-R5-9
5	RODNEY K. MCCONNELL & NEDRA C. MCCONNELL (S/R)	04-R2-20
6	HENRY W. ZEIDLER & JUDITH K. ZEIDLER (S)/ HENRY W. ZEIDLER, JUDITH K. ZEIDLER & MARGARET ZEIDLER BURGGRAF (R)	03-B46-0015.0000

06/07/2019

ADJOINING OWNERS TABLE		
TRACT	SURFACE OWNER	TAX PARCEL
A	ALLIANCE RESOURCE GP, LLC	04-R8-B
B	ALLIANCE RESOURCE GP, LLC	04-R5-52
C	ALLIANCE RESOURCE GP, LLC	04-R5-53
D	WINDSOR COAL COMPANY (C/O CNX LAND-PROPERTY TAX)	04-R5-50
E	JOHN W. METZ	04-R5-46
F	BURNT MILL ACRES, LLC (C/O MARK FOSTER)	04-R5-13
G	JULIE A. KOEHLER	04-R5-45.4
H	JULIE A. KOEHLER	04-R5-45.13
I	HELEN TAYLOR	04-R5-12
J	HELEN TAYLOR	04-R5-14
K	HUMPHREY D., JR. & T.M. FLICK	04-R5-15
L	DALE A. & JENNIFER VILLANI	04-R5-16
M	DALE A. & JENNIFER A. VILLANI	04-R5-17.1
N	ROBERT N. & C.L. CONNER	04-R5-17
O	PATRICIA ROUSH	04-R5-18
P	ERVAN D. & NANCY G. TRUBIANO	04-R5-19
Q	BRIAN W. & MELINDA K. SOWIZRAL	04-R5-20.1
R	DENNIS J. & SHEINA L. HOSKINS	04-R5-20.4
S	HAROLD & LINDA COAST	04-R5-2.9
T	ROBERT KUBOVICZ	04-R5-8
U	JOHN E. & E.R. HARWATT	04-R5-8.2
V	RODNEY K. MCCONNELL & NEDRA C. MCCONNELL	04-R2-9999.9999
W	RODNEY K. & NEDRA C. MCCONNELL	03-B46-0014.0000
X	RODNEY K. & N.C. MCCONNELL	04-R2-18.2
Y	SYLVIA A. HAWRANICK	04-R2-18.1
Z	HENRY W. ZEIDLER, JUDITH K. ZEIDLER & MARGARET L. BURGGRAF	03-B46-0013.0000
AA	KENNETH D. & BARBARA J. COVER	03-B46-0012.0000
AB	JOAN GARRETT	03-B46-0009.0000
AC	JOAN GARRETT	03-B46-0017.0000
AD	EVERT RUNYAN	03-B41-0018.0000
AE	BARRY L. & PATRICIA A. GREATHOUSE	03-B41-0032.0000
AF	BARRY L. & PATRICIA A. GREATHOUSE	03-B41-0083.0000
AG	BARRY L. & PATRICIA A. GREATHOUSE	03-B46-0019.0000
AH	STACY ANN GREATHOUSE & PATRICIA ANN GREATHOUSE (SURVIVOR)	03-B46-0041.0000
AI	BARRY L. & PATRICIA A. GREATHOUSE (SURVIVOR)	03-B41-0082.0000
AJ	DANNY GENE & VIRGINIA MARGARET BRITT (SURVIVOR)	03-B46-0027.0000
AK	TRACY GILBERT	03-B46-0022.0001
AL	BRUCE D. BONAR (½) & WILLIAM BONAR (½)	03-B46-0020.0000
AM	MARC SEAMON	04-R6-2
AN	OHIO COUNTY BOARD OF COMMISSIONERS	04-R5-55
AO	RICHARD L. & DEBORAH K. BLACK	04-R5-58.1
AP	RAY W. ARCHER	04-R5-58
AQ	WINDSOR COAL COMPANY	04-R8-8.1
AR	ALLIED WASTE, INC	04-R5-56
AS	EDWARD W. & JOANNE V. DREMAK	04-R5-54.1
AT	TUNNEL RIDGE, LLC	04-R8-8.1B
AU	SUSAN L. CAIN	04-R8-8.3
AV	HAMMOND PUBLIC SERVICE DISTRICT	03-B46-0016.0000

REVISIONS:  
REVISED DDR 11-20-2018 PER DEP COMMENTS

COMPANY:

**SWN**  
Production Company, LLC

**SWN** <sup>R-V+</sup>  
Production Company™

OPERATOR'S EDWARD DREMAK UP OHI

DATE: 11-21-2018

WELL #: 2H

DRAWN BY: D. REED

DISTRICT: RICHLAND

COUNTY: OHIO

STATE: WV

SCALE: N/A

DRAWING NO: 2018-284

WELL LOCATION PLAT

47-069-00300 H6A

PROPERTY NUMBER 2501169011  
PAD ID 3001165800