



SWN PRODUCTION COMPANY, LLC



Location: Ohio County, WV

Slot: 206H

Field: Ohio

Well: Dallas Hall OHI 206H

Facility: Dallas Hall OHI Pad

Wellbore: Dallas Hall OHI 206H AWB

Plot reference wellpath is Dallas Hall OHI 206H awp Proj: 17943'

Grid System: NAD83 / UTM Zone 17 North, US feet

True vertical depths are referenced to SDC 41 (KB)

* = Wellpath was transformed from a different geodetic datum

Reference wellpath measured depths are referenced to SDC 41 (KB)

North Reference: Grid north

SDC 41 (KB) to Mean Sea Level: 1300.7 feet

Scale: True distance

Mean Sea Level to Ground level (At Slot: 206H): -1274.7 feet

Coordinates are in feet referenced to Slot

Offset wellpath MDs are referenced to each path's default MD datum

Depths are in feet

Created by: tranlam on 2023-08-01; Database: WA_MPL_EASTERNUS_Defn

Location Information

Facility Name			Grid East (US ft)	Grid North (US ft)	Latitude	Longitude
Dallas Hall OHI Pad			1748601.815	14575539.433	40°08'0.1760"N	80°36'46.5880"W
Slot	Local N (ft)	Local E (ft)	Grid East (US ft)	Grid North (US ft)	Latitude	Longitude
206H	-17.47	-10.83	1748590.990	14575521.970	40°08'0.0038"N	80°36'46.7284"W
SDC 41 (KB) to Ground level (At Slot: 206H)					26ft	
Mean Sea Level to Ground level (At Slot: 206H)					-1274.7ft	
SDC 41 (KB) to Mean Sea Level					1300.7ft	

Bottom Hole Location

MD (ft)	Inc (°)	Az (°)	TVD (ft)	Local N (ft)	Local E (ft)	Grid East (US ft)	Grid North (US ft)	Latitude	Longitude
17943.00	88.550	144.460	6343.91	-10440.81	2867.67	1751457.55	14565085.22	40°06'16.7026"N	80°36'10.4067"W

API: 47069003530000
 BH JOB: 111896960
 DURATION: 07.23.2023 to 07.27.2023
 RIG: SDC 41

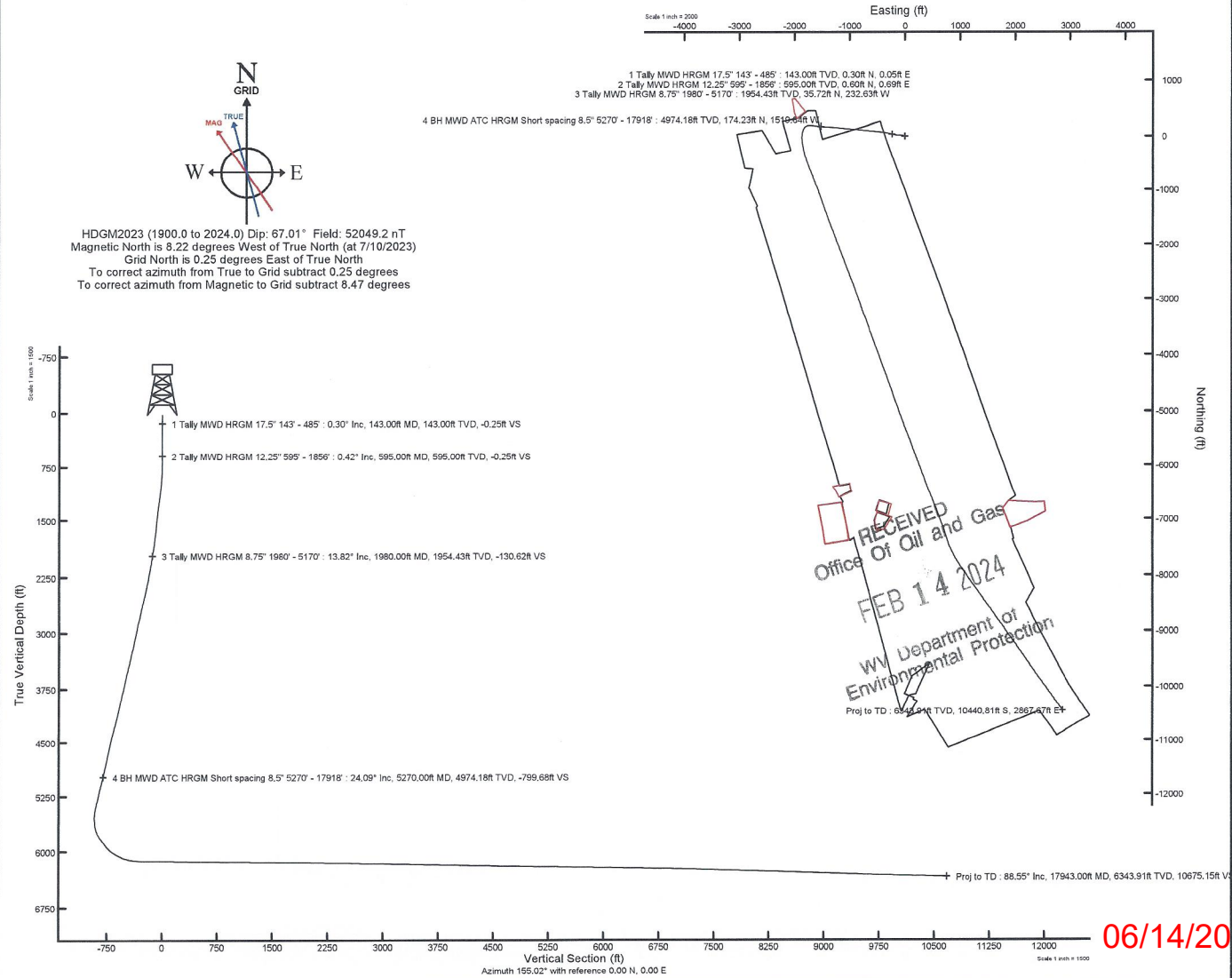

REFERENCE WELLPATH IDENTIFICATION

Operator	SWN PRODUCTION COMPANY, LLC	Well	Dallas Hall OHI 206H
Field	Ohio	API	47069003330000
Facility	Dallas Hall OHI Pad	Wellbore	Dallas Hall OHI 206H AWB
Slot	206H		

REPORT SETUP INFORMATION

Projection System	NAD83 / UTM Zone 17 North, US feet	Software System	WellArchitect® 6.0
North Reference	Grid	User	Tranlam
Scale	0.999613	Report Generated	8/1/2023 at 11:02:36 PM
Convergence at slot	0.25° East	Database	WA_MPL_EASTERNUS_Defn

WELLPATH LOCATION

	Local coordinates		Grid coordinates		Geographic coordinates	
	North[ft]	East[ft]	Easting[US ft]	Northing[US ft]	Latitude	Longitude
Slot Location	-17.47	-10.83	1748590.99	1457521.97	40°08'0.0038"N	80°36'46.7284"W
Facility Reference Pt			1748601.82	1457539.43	40°08'0.1760"N	80°36'46.5880"W
Field Reference Pt			0.00	0.00	0°00'0.0000"	85°29'19.4780"W

WELLPATH DATUM

Calculation method	Minimum curvature	SDC 41 (KB) to Facility Vertical Datum	1300.70ft
Horizontal Reference Pt	Slot	SDC 41 (KB) to Mean Sea Level	1300.70ft
Vertical Reference Pt	SDC 41 (KB)	SDC 41 (KB) to Ground Level at Slot (206H)	26.00ft
MD Reference Pt	SDC 41 (KB)	Section Origin	N 0.00, E 0.00 ft
Field Vertical Reference	Mean Sea Level	Section Azimuth	155.02°

REFERENCE WELLPATH IDENTIFICATION

Operator	SWN PRODUCTION COMPANY, LLC	Well	Dallas Hall OHI 206H
Field	Ohio	API	47069003530000
Facility	Dallas Hall OHI Pad	Wellbore	Dallas Hall OHI 206H AWB
Slot	206H		

WELLPATH DATA (198 stations) † = interpolated, ‡ = extrapolated station

MD [ft]	Inclination [°]	Azimuth [°]	TVD [ft]	Vert Sect [ft]	North [ft]	East [ft]	Grid East [US ft]	Grid North [US ft]	Latitude	Longitude	Closure Dist [ft]	Closure Dir [°]	DLS ["/100ft]	Comments
0.00†	0.000	9.310	0.00	0.00	0.00	0.00	1748590.99	14575521.97	40°08'0.0038"N	80°36'46.7284"W	0.00	0.000	0.00	
26.00	0.000	9.310	26.00	0.00	0.00	0.00	1748590.99	14575521.97	40°08'0.0038"N	80°36'46.7284"W	0.00	0.000	0.00	
143.00	0.300	9.310	143.00	-0.25	0.30	0.05	1748591.04	14575522.27	40°08'0.0068"N	80°36'46.7278"W	0.31	9.310	0.26	
236.00	0.200	340.680	236.00	-0.62	0.70	0.04	1748591.03	14575522.88	40°08'0.0107"N	80°36'46.7279"W	0.70	2.900	0.17	
327.00	0.120	50.190	327.00	-0.80	0.91	0.06	1748591.05	14575522.88	40°08'0.0128"N	80°36'46.7276"W	0.91	3.528	0.21	
417.00	0.150	16.580	417.00	-0.91	1.08	0.16	1748591.15	14575523.05	40°08'0.0145"N	80°36'46.7263"W	1.09	8.527	0.09	
485.00	0.230	134.490	485.00	-0.85	1.07	0.28	1748591.27	14575523.04	40°08'0.0144"N	80°36'46.7247"W	1.11	14.905	0.48	
595.00	0.420	142.200	595.00	-0.25	0.60	0.69	1748591.68	14575522.57	40°08'0.0097"N	80°36'46.7195"W	0.91	49.140	0.18	
688.00	0.830	277.580	687.99	-0.28	0.42	0.23	1748591.22	14575522.39	40°08'0.0079"N	80°36'46.7254"W	0.48	29.003	1.25	
779.00	2.630	284.220	778.95	-1.95	1.02	-2.45	1748588.54	14575522.99	40°08'0.0140"N	80°36'46.7599"W	2.65	292.541	1.99	
869.00	3.900	288.750	868.80	-5.37	2.51	-7.35	1748583.65	14575524.48	40°08'0.0289"N	80°36'46.8229"W	7.76	288.839	1.44	
960.00	6.120	288.860	959.45	-10.87	5.07	-14.87	1748576.13	14575527.04	40°08'0.0546"N	80°36'46.9196"W	15.71	288.828	2.44	
1051.00	8.470	284.970	1049.70	-18.54	8.37	-25.94	1748565.07	14575530.34	40°08'0.0877"N	80°36'47.0618"W	27.25	287.885	2.64	
1143.00	11.070	284.590	1140.36	-28.52	12.35	-41.03	1748549.98	14575534.31	40°08'0.1276"N	80°36'47.2560"W	42.85	286.745	2.83	
1234.00	13.130	280.550	1229.34	-40.09	16.44	-59.65	1748531.36	14575538.40	40°08'0.1688"N	80°36'47.4954"W	61.87	285.408	2.45	
1325.00	14.890	274.890	1317.63	-51.92	19.33	-81.46	1748509.56	14575541.29	40°08'0.1983"N	80°36'47.7761"W	83.72	283.348	2.45	
1417.00	15.060	268.490	1406.51	-62.57	20.02	-105.19	1748485.84	14575541.98	40°08'0.2062"N	80°36'48.0816"W	107.08	280.776	1.81	
1509.00	13.450	267.250	1495.68	-71.38	19.19	-127.83	1748463.21	14575541.16	40°08'0.1990"N	80°36'48.3730"W	129.26	278.539	1.78	
1599.00	12.880	271.280	1583.31	-79.78	18.91	-148.31	1748442.74	14575540.88	40°08'0.1971"N	80°36'48.6368"W	149.51	277.268	1.20	
1691.00	12.920	278.710	1673.00	-90.02	20.70	-168.73	1748422.33	14575542.66	40°08'0.2157"N	80°36'48.8996"W	169.99	276.995	1.80	
1781.00	12.660	284.420	1760.77	-101.86	24.68	-188.23	1748402.84	14575546.64	40°08'0.2558"N	80°36'49.1504"W	189.84	277.470	1.43	
1856.00	13.210	285.040	1833.86	-112.59	28.95	-204.46	1748386.61	14575550.91	40°08'0.2987"N	80°36'49.3592"W	206.50	278.059	0.76	
1980.00	13.820	282.060	1954.43	-130.62	35.72	-232.63	1748358.45	14575557.68	40°08'0.3668"N	80°36'49.7214"W	235.36	278.730	0.75	
2071.00	14.670	283.770	2042.63	-144.38	40.74	-254.45	1748336.64	14575562.69	40°08'0.4173"N	80°36'50.0021"W	257.69	279.096	1.04	
2162.00	15.780	284.690	2130.44	-159.49	46.62	-277.61	1748313.49	14575568.57	40°08'0.4764"N	80°36'50.2999"W	281.50	279.532	1.25	
2251.00	17.650	283.270	2215.67	-175.57	52.78	-302.45	1748288.65	14575574.73	40°08'0.5384"N	80°36'50.6194"W	307.02	279.899	2.15	
2342.00	18.820	279.800	2302.11	-192.49	58.45	-330.35	1748260.77	14575580.40	40°08'0.5956"N	80°36'50.9782"W	335.48	280.034	1.75	
2432.00	20.320	278.350	2386.90	-209.36	63.19	-360.11	1748231.02	14575585.13	40°08'0.6437"N	80°36'51.3612"W	365.62	279.952	1.75	
2523.00	22.450	279.050	2471.63	-227.76	68.22	-392.91	1748198.23	14575590.16	40°08'0.6948"N	80°36'51.7831"W	398.79	279.850	2.36	
2614.00	24.330	277.280	2555.15	-247.49	73.33	-428.67	1748162.49	14575595.27	40°08'0.7469"N	80°36'52.2432"W	434.89	279.707	2.21	

REFERENCE WELLPATH IDENTIFICATION

Operator	SWN PRODUCTION COMPANY, LLC	Well	Dallas Hall OHI 206H
Field	Ohio	API	47069003530000
Facility	Dallas Hall OHI Pad	Wellbore	Dallas Hall OHI 206H AWB
Slot	206H		

WELLPATH DATA (198 stations)

MD [ft]	Inclination [°]	Azimuth [°]	TVD [ft]	Vert Sect [ft]	North [ft]	East [ft]	Grid East [US ft]	Grid North [US ft]	Latitude	Longitude	Closure Dist [ft]	Closure Dir [°]	DLS [°/100ft]	Comments
2705.00	24.790	276.230	2637.92	-267.39	77.77	-466.23	1748124.94	14575599.71	40°08'0.7924"N	80°36'52.7265"W	472.67	279.470	0.70	
2797.00	24.980	274.400	2721.38	-286.91	81.36	-504.77	1748086.42	14575603.29	40°08'0.8295"N	80°36'53.2226"W	511.28	279.156	0.86	
2890.00	25.020	275.390	2805.67	-306.49	84.71	-543.93	1748047.27	14575606.65	40°08'0.8643"N	80°36'53.7265"W	550.49	278.852	0.45	
2981.00	23.940	276.620	2888.49	-325.89	88.65	-581.43	1748009.79	14575610.58	40°08'0.9048"N	80°36'54.2091"W	588.15	278.669	1.31	
3071.00	23.470	275.210	2970.89	-344.47	92.38	-617.42	1747938.81	14575614.31	40°08'0.9432"N	80°36'54.6722"W	624.29	278.510	0.82	
3161.00	22.770	274.110	3053.67	-361.96	95.25	-652.64	1747938.61	14575617.19	40°08'0.9731"N	80°36'55.1255"W	659.55	278.304	0.91	
3252.00	23.530	275.720	3137.34	-379.79	98.33	-688.28	1747902.98	14575620.26	40°08'1.0050"N	80°36'55.5842"W	696.26	278.130	1.09	
3345.00	24.630	276.870	3222.24	-399.49	102.50	-725.99	1747865.28	14575624.43	40°08'1.0478"N	80°36'56.0695"W	733.19	278.036	1.29	
3437.00	24.590	274.810	3305.89	-419.12	106.39	-764.10	1747827.19	14575628.32	40°08'1.0880"N	80°36'56.5599"W	771.47	277.927	0.93	
3528.00	24.350	276.260	3388.72	-438.26	110.03	-801.61	1747789.69	14575631.95	40°08'1.1255"N	80°36'57.0427"W	809.13	277.815	0.71	
3618.00	24.490	278.110	3470.67	-458.06	114.68	-838.52	1747752.79	14575636.61	40°08'1.1731"N	80°36'57.5177"W	846.33	277.788	0.86	
3710.00	24.630	277.510	3554.34	-478.77	119.88	-876.41	1747714.92	14575641.80	40°08'1.2260"N	80°36'58.0051"W	884.57	277.789	0.31	
3801.00	23.690	273.470	3637.38	-497.67	123.46	-913.46	1747677.89	14575645.38	40°08'1.2630"N	80°36'58.4820"W	921.76	277.697	2.09	
3894.00	23.370	275.330	3722.64	-515.88	126.31	-950.47	1747640.89	14575648.23	40°08'1.2927"N	80°36'58.9584"W	958.83	277.570	0.87	
3987.00	23.780	278.100	3807.88	-535.42	130.66	-987.40	1747603.97	14575652.58	40°08'1.3373"N	80°36'59.4336"W	996.01	277.538	1.27	
4078.00	23.140	275.120	3891.36	-554.40	134.84	-1023.38	1747568.01	14575656.76	40°08'1.3802"N	80°36'59.8965"W	1032.22	277.506	1.48	
4168.00	23.340	276.620	3974.06	-572.61	138.48	-1058.70	1747532.70	14575660.39	40°08'1.4176"N	80°37'0.3511"W	1067.72	277.452	0.69	
4258.00	23.480	275.340	4056.65	-591.01	142.20	-1094.26	1747497.15	14575664.12	40°08'1.4559"N	80°37'0.8087"W	1103.46	277.404	0.59	
4348.00	23.840	272.900	4139.09	-608.56	144.79	-1130.28	1747461.15	14575666.70	40°08'1.4830"N	80°37'1.2723"W	1139.52	277.300	1.16	
4440.00	26.350	277.280	4222.41	-628.16	148.32	-1169.11	1747422.33	14575670.23	40°08'1.5195"N	80°37'1.7720"W	1178.48	277.230	3.39	
4530.00	26.390	276.660	4303.04	-649.32	153.17	-1208.79	1747382.67	14575675.08	40°08'1.5692"N	80°37'2.2826"W	1218.46	277.222	0.31	
4622.00	25.880	274.360	4385.64	-669.88	157.07	-1249.12	1747342.36	14575678.98	40°08'1.6094"N	80°37'2.8016"W	1258.96	277.167	1.23	
4712.00	25.030	273.990	4466.90	-688.73	159.89	-1287.70	1747303.79	14575681.79	40°08'1.6389"N	80°37'3.2981"W	1297.59	277.078	0.96	
4806.00	24.820	273.320	4552.14	-707.71	162.41	-1327.24	1747264.27	14575684.32	40°08'1.6655"N	80°37'3.8071"W	1337.14	276.976	0.37	
4899.00	24.820	272.410	4636.55	-725.95	164.36	-1366.24	1747225.29	14575686.27	40°08'1.6865"N	80°37'4.3090"W	1376.09	276.860	0.41	
4989.00	24.670	272.390	4718.29	-743.28	165.94	-1403.87	1747187.66	14575688.85	40°08'1.7037"N	80°37'4.7935"W	1413.65	276.741	0.17	
5079.00	24.980	273.330	4799.97	-760.92	167.83	-1441.61	1747149.94	14575689.73	40°08'1.7239"N	80°37'5.2793"W	1451.35	276.640	0.56	
5170.00	23.890	274.590	4882.82	-779.13	170.42	-1479.16	1747112.40	14575692.32	40°08'1.7511"N	80°37'5.7626"W	1488.95	276.572	1.33	
5270.00	24.090	276.160	4974.18	-799.68	174.23	-1519.64	1747071.94	14575696.13	40°08'1.7905"N	80°37'6.2835"W	1529.59	276.541	0.67	
5362.00	24.650	276.440	5057.98	-819.39	178.40	-1557.37	1747034.22	14575700.30	40°08'1.8333"N	80°37'6.7691"W	1567.56	276.535	0.62	

Actual Wellpath Report

Dallas Hall OHI 206H awp Proj: 17943'

Page 4 of 9

REFERENCE WELLPATH IDENTIFICATION

Operator	SWN PRODUCTION COMPANY, LLC	Well	Dallas Hall OHI 206H
Field	Ohio	API	47069003530000
Facility	Dallas Hall OHI Pad	Wellbore	Dallas Hall OHI 206H AWB
Slot	206H		

WELLPATH DATA (198 stations)

MD [ft]	Inclination [°]	Azimuth [°]	TVD [ft]	Vert Sect [ft]	North [ft]	East [ft]	Grid East [US ft]	Grid North [US ft]	Latitude	Longitude	Closure Dist [ft]	Closure Dir [°]	DLS [°/100ft]	Comments
5452.00	23.220	276.390	5140.24	-838.41	182.48	-1593.65	1746997.95	14575704.38	40°08'1.8751"N	80°37'7.2360"W	1604.07	276.532	1.59	
5544.00	24.570	275.960	5224.35	-857.69	186.48	-1630.70	1746960.92	14575708.38	40°08'1.9163"N	80°37'7.7128"W	1641.33	276.524	1.48	
5635.00	24.460	276.130	5307.15	-877.15	190.46	-1668.25	1746923.39	14575712.35	40°08'1.9572"N	80°37'8.1960"W	1679.09	276.513	0.14	
5726.00	24.500	276.360	5389.97	-896.69	194.56	-1705.74	1746885.92	14575716.45	40°08'1.9993"N	80°37'8.6783"W	1716.80	276.507	0.11	
5817.00	24.960	263.590	5472.68	-912.63	194.51	-1743.60	1746848.07	14575716.40	40°08'1.9993"N	80°37'9.1658"W	1754.41	276.365	5.88	
5909.00	23.160	242.910	5556.84	-918.16	184.08	-1779.06	1746812.62	14575705.98	40°08'1.8988"N	80°37'9.6229"W	1788.56	275.907	9.32	
6000.00	25.270	227.000	5639.92	-911.49	162.66	-1809.23	1746782.46	14575684.57	40°08'1.6884"N	80°37'10.0126"W	1816.53	275.137	7.51	
6092.00	28.810	208.050	5722.00	-892.04	129.63	-1834.07	1746757.63	14575651.55	40°08'1.3631"N	80°37'10.3342"W	1838.65	274.043	10.08	
6183.00	33.840	196.890	5799.77	-859.93	85.97	-1851.77	1746739.94	14575607.91	40°08'0.9324"N	80°37'10.5645"W	1853.77	272.658	8.42	
6274.00	40.700	186.890	5872.22	-815.77	32.15	-1862.72	1746729.00	14575554.11	40°08'0.4010"N	80°37'10.7084"W	1862.99	270.989	10.04	
6366.00	47.080	179.810	5938.52	-759.63	-31.42	-1866.21	1746725.51	14575490.57	40°07'59.7730"N	80°37'10.7568"W	1866.47	269.036	8.74	
6457.00	55.010	174.020	5995.72	-693.99	-101.96	-1862.21	1746729.51	14575420.05	40°07'59.0757"N	80°37'10.7092"W	1864.99	266.866	10.01	
6549.00	62.360	169.850	6043.52	-618.84	-179.68	-1851.08	1746740.63	14575342.36	40°07'58.3072"N	80°37'10.5702"W	1859.78	264.456	8.88	
6640.00	70.560	167.810	6079.84	-537.89	-261.44	-1834.89	1746756.82	14575260.63	40°07'57.4985"N	80°37'10.3663"W	1853.42	261.891	9.24	
6732.00	78.320	164.230	6104.50	-450.96	-347.35	-1813.45	1746778.25	14575174.75	40°07'56.6487"N	80°37'10.0949"W	1846.41	259.157	9.23	
6823.00	85.560	163.170	6117.25	-361.95	-433.77	-1788.17	1746803.52	14575088.37	40°07'55.7936"N	80°37'9.7743"W	1840.03	256.365	8.04	
6915.00	88.890	159.190	6121.71	-270.62	-520.72	-1758.53	1746833.14	14575001.45	40°07'54.9331"N	80°37'9.3975"W	1834.01	253.505	5.64	
7006.00	89.320	158.940	6123.13	-179.86	-605.70	-1726.02	1746865.64	14574916.50	40°07'54.0920"N	80°37'8.9836"W	1829.21	250.663	0.55	
7098.00	89.480	158.890	6124.09	-88.08	-691.54	-1692.92	1746898.72	14574830.70	40°07'53.2423"N	80°37'8.5623"W	1828.72	247.781	0.18	
7189.00	89.850	159.750	6124.63	2.66	-776.67	-1660.79	1746930.85	14574745.60	40°07'52.3997"N	80°37'8.1532"W	1833.42	244.937	1.03	
7281.00	89.200	159.520	6125.39	94.36	-862.92	-1628.77	1746962.85	14574659.39	40°07'51.5460"N	80°37'7.7458"W	1843.24	242.086	0.75	
7372.00	89.380	160.030	6126.52	185.04	-948.30	-1597.32	1746994.29	14574574.04	40°07'50.7009"N	80°37'7.3456"W	1857.60	239.303	0.59	
7464.00	89.200	159.970	6127.66	276.69	-1034.75	-1565.85	1747025.75	14574487.63	40°07'49.8454"N	80°37'6.9453"W	1876.86	236.543	0.21	
7556.00	89.230	160.230	6128.92	368.32	-1121.24	-1534.54	1747057.05	14574401.16	40°07'48.9893"N	80°37'6.5470"W	1900.53	233.846	0.28	
7648.00	89.450	160.430	6129.98	459.92	-1207.87	-1503.58	1747088.00	14574314.57	40°07'48.1319"N	80°37'6.1531"W	1928.65	231.224	0.32	
7739.00	89.320	159.820	6130.95	550.55	-1293.44	-1472.64	1747118.92	14574229.03	40°07'47.2849"N	80°37'5.7596"W	1960.02	228.707	0.69	
7830.00	89.320	160.110	6132.03	641.20	-1378.93	-1441.47	1747150.08	14574143.58	40°07'46.4388"N	80°37'5.3630"W	1994.81	226.270	0.32	
7922.00	89.200	160.200	6133.22	732.83	-1465.46	-1410.24	1747181.30	14574057.08	40°07'45.5824"N	80°37'4.9657"W	2033.80	223.900	0.16	
8013.00	89.350	160.330	6134.37	823.44	-1551.11	-1379.51	1747212.01	14573971.47	40°07'44.7347"N	80°37'4.5749"W	2075.81	221.649	0.22	
8105.00	89.350	159.910	6135.42	915.07	-1637.62	-1348.23	1747243.29	14573884.99	40°07'43.8785"N	80°37'4.1770"W	2121.21	219.464	0.46	

Actual Wellpath Report

Dallas Hall OHI 206H awp Proj: 17943'

REFERENCE WELLPATH IDENTIFICATION

Operator	SWN PRODUCTION COMPANY, LLC	Well	Dallas Hall OHI 206H
Field	Ohio	API	47069003530000
Facility	Dallas Hall OHI Pad	Wellbore	Dallas Hall OHI 206H AWB
Slot	206H		

WELLPATH DATA (198 stations)

MD [ft]	Inclination [°]	Azimuth [°]	TVD [ft]	Vert Sect [ft]	North [ft]	East [ft]	Grid East [US ft]	Grid North [US ft]	Latitude	Longitude	Closure Dist [ft]	Closure Dir [°]	DLS [°/100ft]	Comments
8196.00	89.480	159.400	6136.35	1005.77	-1722.94	-1316.59	1747274.91	14573799.70	40°07'43.0340"N	80°37'3.7744"W	2168.39	217.385	0.58	
8288.00	89.200	159.560	6137.41	1097.48	-1809.09	-1284.35	1747307.14	14573713.58	40°07'42.1813"N	80°37'3.3640"W	2218.64	215.472	0.35	
8379.00	89.200	159.830	6138.68	1188.17	-1894.43	-1252.77	1747338.71	14573628.27	40°07'41.3366"N	80°37'2.9623"W	2271.19	213.476	0.30	
8471.00	89.720	160.180	6139.54	1279.82	-1980.88	-1221.31	1747370.15	14573541.86	40°07'40.4810"N	80°37'2.5621"W	2327.12	211.656	0.68	
8562.00	89.690	159.660	6140.01	1370.48	-2066.35	-1190.07	1747401.38	14573456.42	40°07'39.6351"N	80°37'2.1646"W	2384.55	209.939	0.57	
8654.00	89.850	159.940	6140.38	1462.16	-2152.69	-1158.30	1747433.14	14573370.12	40°07'38.7805"N	80°37'1.7605"W	2444.53	208.283	0.35	
8745.00	89.050	159.540	6141.25	1552.85	-2238.05	-1126.79	1747464.63	14573284.79	40°07'37.9356"N	80°37'1.3595"W	2505.70	206.724	0.98	
8837.00	89.780	159.410	6142.19	1644.57	-2324.21	-1094.54	1747496.88	14573198.66	40°07'37.0828"N	80°37'0.9491"W	2569.04	205.217	0.81	
8928.00	89.350	159.980	6142.88	1735.26	-2409.55	-1062.96	1747528.44	14573113.36	40°07'36.2381"N	80°37'0.5473"W	2633.60	203.804	0.78	
9020.00	89.480	159.870	6143.82	1826.92	-2495.96	-1031.38	1747560.01	14573026.98	40°07'35.3829"N	80°37'0.1456"W	2700.66	202.451	0.19	
9111.00	89.350	159.820	6144.75	1917.59	-2581.38	-1000.03	1747591.35	14572941.59	40°07'34.5374"N	80°36'59.7467"W	2768.32	201.176	0.15	
9203.00	88.980	159.470	6146.09	2009.28	-2667.63	-968.03	1747623.33	14572855.38	40°07'33.6838"N	80°36'59.3396"W	2837.84	199.945	0.55	
9294.00	89.350	159.660	6147.42	2099.98	-2752.89	-936.26	1747655.09	14572770.15	40°07'32.8399"N	80°36'58.9354"W	2907.75	198.783	0.46	
9386.00	89.260	159.770	6148.54	2191.67	-2839.18	-904.37	1747686.97	14572683.90	40°07'31.9858"N	80°36'58.5296"W	2979.73	197.668	0.15	
9477.00	89.140	159.720	6149.81	2282.35	-2924.54	-872.87	1747718.46	14572598.56	40°07'31.1409"N	80°36'58.1288"W	3052.02	196.618	0.14	
9569.00	89.230	159.910	6151.11	2374.02	-3010.88	-841.13	1747750.19	14572512.26	40°07'30.2863"N	80°36'57.7250"W	3126.17	195.608	0.23	
9660.00	89.200	159.640	6152.36	2464.70	-3096.26	-809.67	1747781.63	14572426.91	40°07'29.4412"N	80°36'57.3248"W	3200.38	194.655	0.30	
9752.00	89.020	159.900	6153.79	2556.37	-3182.58	-777.86	1747813.43	14572340.63	40°07'28.5869"N	80°36'56.9202"W	3276.26	193.735	0.34	
9843.00	88.890	159.990	6155.45	2647.02	-3268.05	-746.66	1747844.62	14572255.19	40°07'27.7410"N	80°36'56.5233"W	3352.26	192.870	0.17	
9935.00	89.140	159.760	6157.03	2738.68	-3354.42	-715.01	1747876.25	14572168.86	40°07'26.8861"N	80°36'56.1207"W	3429.77	192.033	0.37	
10027.00	89.020	159.610	6158.51	2830.36	-3440.68	-683.08	1747908.18	14572082.63	40°07'26.0323"N	80°36'55.7143"W	3507.83	191.229	0.21	
10118.00	89.260	159.560	6159.87	2921.06	-3525.96	-651.34	1747939.91	14571997.38	40°07'25.1882"N	80°36'55.3105"W	3585.61	190.466	0.27	
10210.00	89.170	159.650	6161.14	3012.76	-3612.18	-619.28	1747971.95	14571911.19	40°07'24.3348"N	80°36'54.9027"W	3664.88	189.728	0.14	
10301.00	88.250	159.920	6163.18	3103.42	-3697.55	-587.84	1748003.37	14571825.85	40°07'23.4898"N	80°36'54.5027"W	3743.99	189.033	1.05	
10393.00	88.830	159.670	6165.53	3195.07	-3783.86	-556.08	1748035.13	14571739.58	40°07'22.6355"N	80°36'54.0987"W	3824.51	188.360	0.69	
10485.00	88.740	159.950	6167.48	3286.73	-3870.19	-524.33	1748066.86	14571653.28	40°07'21.7811"N	80°36'53.6948"W	3905.55	187.715	0.32	
10576.00	89.350	159.630	6169.00	3377.40	-3955.58	-492.90	1748098.28	14571567.93	40°07'20.9359"N	80°36'53.2950"W	3986.17	187.103	0.76	
10668.00	89.200	159.670	6170.16	3469.09	-4041.83	-460.91	1748130.26	14571481.71	40°07'20.0822"N	80°36'52.8880"W	4068.02	186.506	0.17	
10759.00	88.950	159.650	6171.63	3559.78	-4127.14	-429.28	1748161.87	14571396.43	40°07'19.2378"N	80°36'52.4856"W	4149.41	185.938	0.28	
10851.00	88.830	159.470	6173.41	3651.48	-4213.33	-397.16	1748193.98	14571310.27	40°07'18.3847"N	80°36'52.0769"W	4232.01	185.385	0.24	

REFERENCE WELLPATH IDENTIFICATION

Operator	SWN PRODUCTION COMPANY, LLC	Well	Dallas Hall OHI 206H
Field	Ohio	API	47069003530000
Facility	Dallas Hall OHI Pad	Wellbore	Dallas Hall OHI 206H AWB
Slot	206H		

WELLPATH DATA (198 stations)

MD [ft]	Inclination [°]	Azimuth [°]	TVD [ft]	Vert Sect [ft]	North [ft]	East [ft]	Grid East [US ft]	Grid North [US ft]	Latitude	Longitude	Closure Dist [ft]	Closure Dir [°]	DLS ["/100ft]	Comments
10942.00	88.550	159.470	6175.49	3742.18	-4298.53	-365.26	1748225.88	14571225.11	40°07'17.5414"N	80°36'51.6710"W	4314.02	184.857	0.31	
11034.00	88.770	159.780	6177.64	3833.86	-4384.75	-333.23	1748257.89	14571138.92	40°07'16.6880"N	80°36'51.2636"W	4397.40	184.346	0.41	
11125.00	88.920	159.710	6179.48	3924.53	-4470.11	-301.74	1748289.37	14571053.60	40°07'15.8432"N	80°36'50.8629"W	4480.28	183.862	0.18	
11216.00	88.950	159.660	6181.17	4015.21	-4555.43	-270.15	1748320.95	14570968.31	40°07'14.9986"N	80°36'50.4611"W	4563.43	183.394	0.06	
11308.00	89.010	159.670	6182.81	4106.89	-4641.68	-238.18	1748352.90	14570882.09	40°07'14.1449"N	80°36'50.0544"W	4647.79	182.937	0.07	
11399.00	89.140	159.780	6184.28	4197.58	-4727.03	-206.65	1748384.42	14570796.77	40°07'13.3001"N	80°36'49.6534"W	4731.55	182.503	0.19	
11491.00	88.800	159.690	6185.93	4289.25	-4813.33	-174.79	1748416.27	14570710.52	40°07'12.4460"N	80°36'49.2481"W	4816.50	182.080	0.38	
11582.00	89.350	159.750	6187.40	4379.93	-4898.67	-143.26	1748447.79	14570625.20	40°07'11.6012"N	80°36'48.8469"W	4900.77	181.675	0.61	
11674.00	88.650	159.730	6189.00	4471.60	-4984.97	-111.40	1748479.63	14570538.94	40°07'10.7471"N	80°36'48.4417"W	4986.21	181.280	0.76	
11765.00	88.740	159.630	6191.08	4562.28	-5070.28	-79.81	1748511.21	14570453.66	40°07'9.9027"N	80°36'48.0398"W	5070.91	180.902	0.15	
11857.00	88.950	159.760	6192.93	4653.95	-5156.55	-47.89	1748543.12	14570367.43	40°07'9.0488"N	80°36'47.6338"W	5156.77	180.532	0.27	
11948.00	89.140	159.690	6194.45	4744.64	-5241.90	-16.36	1748574.63	14570282.11	40°07'8.2040"N	80°36'47.2327"W	5241.92	180.179	0.22	
12040.00	89.140	159.310	6195.83	4836.34	-5328.06	15.85	1748606.84	14570195.98	40°07'7.3512"N	80°36'46.8229"W	5328.08	179.830	0.41	
12131.00	89.290	159.880	6197.08	4927.05	-5413.34	47.58	1748638.55	14570110.73	40°07'6.5071"N	80°36'46.4193"W	5413.55	179.496	0.65	
12223.00	89.140	159.800	6198.34	5018.71	-5499.70	79.28	1748670.24	14570024.41	40°07'5.6523"N	80°36'46.0161"W	5500.27	179.174	0.18	
12315.00	88.920	159.480	6199.89	5110.40	-5585.94	111.29	1748702.23	14569938.20	40°07'4.7987"N	80°36'45.6090"W	5587.05	178.859	0.42	
12406.00	89.420	160.300	6201.21	5201.06	-5671.38	142.57	1748733.51	14569852.79	40°07'3.9530"N	80°36'45.2111"W	5673.17	178.560	1.06	
12498.00	89.170	159.770	6202.34	5292.70	-5757.84	173.98	1748764.90	14569766.36	40°07'3.0973"N	80°36'44.8116"W	5760.47	178.269	0.64	
12589.00	89.170	159.630	6203.66	5383.39	-5843.18	205.55	1748796.46	14569681.06	40°07'2.2526"N	80°36'44.4101"W	5846.80	177.985	0.15	
12681.00	89.080	159.520	6205.07	5475.09	-5929.39	237.65	1748828.55	14569594.89	40°07'1.3993"N	80°36'44.0017"W	5934.15	177.705	0.15	
12772.00	89.230	159.650	6206.41	5565.79	-6014.66	269.39	1748860.28	14569509.64	40°07'0.5552"N	80°36'43.5980"W	6020.69	177.435	0.22	
12864.00	89.110	159.670	6207.74	5657.48	-6100.92	301.37	1748892.24	14569423.42	40°06'59.7015"N	80°36'43.1913"W	6108.36	177.172	0.13	
12955.00	89.020	159.280	6209.23	5748.19	-6186.12	333.28	1748924.14	14569338.25	40°06'58.8581"N	80°36'42.7852"W	6195.10	176.916	0.46	
13046.00	88.860	159.450	6210.81	5838.90	-6271.35	365.14	1748955.99	14569253.06	40°06'58.0145"N	80°36'42.3800"W	6281.97	176.668	0.54	
13138.00	88.860	159.420	6212.55	5930.59	-6357.56	397.22	1748988.06	14569166.88	40°06'57.1612"N	80°36'41.9718"W	6369.95	176.425	0.38	
13229.00	88.950	159.540	6214.29	6021.30	-6442.77	429.12	1749019.94	14569081.71	40°06'56.3178"N	80°36'41.5661"W	6457.04	176.189	0.16	
13321.00	88.920	159.820	6216.00	6112.98	-6529.03	461.06	1749051.87	14568995.48	40°06'55.4640"N	80°36'41.1598"W	6545.29	175.961	0.31	
13412.00	89.020	159.370	6217.63	6203.67	-6614.30	492.78	1749083.58	14568910.24	40°06'54.6199"N	80°36'40.7563"W	6632.63	175.739	0.51	
13503.00	88.830	159.390	6219.34	6294.39	-6699.46	524.82	1749115.61	14568825.12	40°06'53.7771"N	80°36'40.3487"W	6719.98	175.521	0.21	
13595.00	89.110	159.650	6220.99	6386.09	-6785.63	557.01	1749147.78	14568738.98	40°06'52.9241"N	80°36'39.9393"W	6808.45	175.307	0.42	

REFERENCE WELLPATH IDENTIFICATION

Operator	SWN PRODUCTION COMPANY, LLC	Well	Dallas Hall OHI 206H
Field	Ohio	API	47069003530000
Facility	Dallas Hall OHI Pad	Wellbore	Dallas Hall OHI 206H AWB
Slot	206H		

WELLPATH DATA (198 stations)

MD [ft]	Inclination [°]	Azimuth [°]	TVD [ft]	Vert Sect [ft]	North [ft]	East [ft]	Grid East [US ft]	Grid North [US ft]	Latitude	Longitude	Closure Dist [ft]	Closure Dir [°]	DLS [°/100ft]	Comments
13686.00	88.830	159.600	6222.63	6476.79	-6870.92	588.68	1749179.45	14568653.72	40°06'52.0799"N	80°36'39.5364"W	6896.09	175.103	0.31	
13778.00	88.950	159.270	6224.41	6568.50	-6957.04	621.00	1749211.74	14568567.63	40°06'51.2274"N	80°36'39.1254"W	6984.70	174.899	0.38	
13869.00	88.920	159.510	6226.10	6659.22	-7042.20	653.02	1749243.76	14568482.50	40°06'50.3845"N	80°36'38.7180"W	7072.42	174.702	0.27	
13960.00	89.010	159.180	6227.75	6749.94	-7127.34	685.12	1749275.84	14568397.40	40°06'49.5418"N	80°36'38.3097"W	7160.19	174.509	0.38	
14052.00	88.950	159.430	6229.38	6841.67	-7213.39	717.62	1749308.33	14568311.38	40°06'48.6900"N	80°36'37.8961"W	7249.00	174.319	0.28	
14143.00	88.950	159.400	6231.05	6932.39	-7298.57	749.61	1749340.31	14568226.24	40°06'47.8469"N	80°36'37.4892"W	7336.96	174.136	0.03	
14235.00	89.020	159.580	6232.68	7024.09	-7384.72	781.84	1749372.53	14568140.12	40°06'46.9942"N	80°36'37.0792"W	7425.99	173.956	0.21	
14326.00	88.310	157.390	6234.80	7114.90	-7469.35	815.20	1749405.88	14568055.52	40°06'46.1564"N	80°36'36.6546"W	7513.71	173.771	2.53	
14418.00	88.490	153.910	6237.37	7206.84	-7553.12	853.12	1749443.77	14567971.78	40°06'45.3269"N	80°36'36.1714"W	7601.15	173.556	3.79	
14509.00	88.220	153.640	6239.98	7297.78	-7634.72	893.31	1749483.96	14567890.22	40°06'44.5188"N	80°36'35.6587"W	7686.80	173.326	0.42	
14600.00	88.370	150.610	6242.69	7388.61	-7715.12	935.84	1749526.46	14567809.85	40°06'43.7225"N	80°36'35.1159"W	7771.67	173.084	3.33	
14692.00	87.720	149.240	6245.83	7480.19	-7794.68	981.91	1749572.52	14567730.32	40°06'42.9342"N	80°36'34.5274"W	7856.29	172.820	1.65	
14784.00	88.890	144.940	6248.55	7571.25	-7871.86	1031.86	1749622.45	14567653.16	40°06'42.1693"N	80°36'33.8888"W	7939.21	172.532	4.84	
14875.00	88.060	144.890	6250.98	7660.81	-7946.30	1084.15	1749674.72	14567578.75	40°06'41.4315"N	80°36'33.2201"W	8019.92	172.231	0.91	
14967.00	87.600	144.110	6254.46	7751.19	-8021.15	1137.54	1749728.08	14567503.94	40°06'40.6895"N	80°36'32.5372"W	8101.41	171.928	0.98	
15058.00	87.880	144.120	6258.05	7840.48	-8094.82	1190.83	1749781.36	14567430.30	40°06'39.9592"N	80°36'31.8554"W	8181.94	171.631	0.31	
15150.00	88.400	144.270	6261.03	7930.80	-8169.39	1244.63	1749835.14	14567355.75	40°06'39.2199"N	80°36'31.1673"W	8263.66	171.337	0.59	
15241.00	88.030	144.000	6263.87	8020.12	-8243.10	1297.92	1749888.40	14567282.07	40°06'38.4892"N	80°36'30.4856"W	8344.66	171.052	0.50	
15333.00	88.890	145.410	6266.34	8110.59	-8318.16	1351.05	1749941.52	14567207.04	40°06'37.7451"N	80°36'29.8060"W	8427.17	170.774	1.79	
15424.00	88.580	145.580	6268.35	8200.32	-8393.13	1402.59	1749993.03	14567132.10	40°06'37.0020"N	80°36'29.1470"W	8509.52	170.513	0.39	
15516.00	88.120	144.650	6271.00	8290.91	-8468.57	1455.18	1750045.61	14567056.69	40°06'36.2543"N	80°36'28.4743"W	8592.68	170.250	1.13	
15607.00	88.280	144.210	6273.86	8380.31	-8542.56	1508.09	1750098.50	14566982.74	40°06'35.5209"N	80°36'27.7976"W	8674.65	169.988	0.51	
15699.00	88.280	144.710	6276.62	8470.71	-8617.38	1561.55	1750151.93	14566907.94	40°06'34.7791"N	80°36'27.1139"W	8757.72	169.729	0.54	
15790.00	88.340	144.640	6279.30	8560.19	-8691.59	1614.14	1750204.50	14566833.75	40°06'34.0434"N	80°36'26.4412"W	8840.21	169.479	0.10	
15882.00	88.280	144.530	6282.02	8650.63	-8766.54	1667.43	1750257.77	14566758.84	40°06'33.3005"N	80°36'25.7596"W	8923.71	169.231	0.14	
15973.00	88.030	144.040	6284.95	8739.99	-8840.39	1720.52	1750310.85	14566685.02	40°06'32.5684"N	80°36'25.0805"W	9006.25	168.987	0.60	
16065.00	88.280	144.340	6287.91	8830.31	-8914.96	1774.33	1750364.63	14566610.48	40°06'31.8292"N	80°36'24.3923"W	9089.81	168.744	0.42	
16157.00	88.150	144.300	6290.77	8920.67	-8989.65	1827.96	1750418.24	14566535.81	40°06'31.0887"N	80°36'23.7063"W	9173.62	168.506	0.15	
16248.00	88.280	144.410	6293.61	9010.05	-9063.56	1880.96	1750471.22	14566461.93	40°06'30.3559"N	80°36'23.0283"W	9256.69	168.276	0.19	
16340.00	87.970	144.330	6296.62	9100.42	-9138.30	1934.53	1750524.77	14566387.22	40°06'29.6150"N	80°36'22.3432"W	9340.82	168.047	0.35	

Actual Wellpath Report

Dallas Hall OHI 206H awp Proj: 17943'
Page 8 of 9

REFERENCE WELLPATH IDENTIFICATION

Operator	SWN PRODUCTION COMPANY, LLC	Well	Dallas Hall OHI 206H
Field	Ohio	API	47069003530000
Facility	Dallas Hall OHI Pad	Wellbore	Dallas Hall OHI 206H AWB
Slot	206H		

WELLPATH DATA (198 stations) † = interpolated, ‡ = extrapolated station

MD [ft]	Inclination [°]	Azimuth [°]	TVD [ft]	Vert Sect [ft]	North [ft]	East [ft]	Grid East [US ft]	Grid North [US ft]	Latitude	Longitude	Closure Dist [ft]	Closure Dir [°]	DLS [°/100ft]	Comments
16431.00	88.210	144.570	6299.65	9189.82	-9212.30	1987.41	1750577.63	14566313.25	40°06'28.8815"N	80°36'21.6669"W	9424.24	167.826	0.37	
16523.00	87.780	144.400	6302.87	9280.22	-9287.14	2040.82	1750631.02	14566238.44	40°06'28.1396"N	80°36'20.9838"W	9508.73	167.606	0.50	
16614.00	88.280	144.290	6306.00	9369.59	-9361.03	2093.83	1750584.01	14566164.57	40°06'27.4070"N	80°36'20.3057"W	9592.35	167.392	0.56	
16706.00	88.120	144.260	6308.89	9459.93	-9435.69	2147.53	1750737.68	14566089.95	40°06'26.6669"N	80°36'19.6190"W	9676.98	167.178	0.18	
16797.00	88.060	144.410	6311.92	9549.30	-9509.58	2200.55	1750790.69	14566016.09	40°06'25.9344"N	80°36'18.9408"W	9760.86	166.971	0.18	
16889.00	87.940	143.950	6315.13	9639.61	-9584.13	2254.36	1750844.48	14565941.56	40°06'25.1953"N	80°36'18.2525"W	9845.69	166.764	0.52	
16980.00	88.220	144.430	6318.18	9728.93	-9657.89	2307.58	1750897.67	14565867.84	40°06'24.4641"N	80°36'17.5719"W	9929.74	166.562	0.61	
17072.00	88.770	145.250	6320.60	9819.45	-9733.07	2360.54	1750950.61	14565792.68	40°06'23.7188"N	80°36'16.8946"W	10015.23	166.367	1.07	
17163.00	88.150	144.300	6323.04	9908.97	-9807.38	2413.00	1751003.06	14565718.40	40°06'22.9822"N	80°36'16.2236"W	10099.87	166.178	1.25	
17255.00	88.370	144.520	6325.84	9999.35	-9882.16	2466.52	1751056.55	14565643.65	40°06'22.2408"N	80°36'15.5392"W	10185.33	165.986	0.34	
17346.00	88.650	144.440	6328.20	10088.79	-9956.20	2519.37	1751109.38	14565569.64	40°06'21.5068"N	80°36'14.8632"W	10270.02	165.800	0.32	
17438.00	88.310	144.220	6330.64	10179.16	-10030.92	2573.00	1751162.99	14565494.95	40°06'20.7662"N	80°36'14.1774"W	10355.66	165.613	0.44	
17529.00	88.980	144.680	6333.33	10268.58	-10104.92	2625.89	1751215.86	14565420.97	40°06'20.0325"N	80°36'13.5010"W	10440.53	165.433	0.51	
17621.00	88.340	144.630	6335.50	10359.05	-10179.94	2679.09	1751269.04	14565345.98	40°06'19.2888"N	80°36'12.8206"W	10526.58	165.256	0.73	
17712.00	88.340	143.700	6337.63	10448.40	-10253.70	2732.35	1751322.28	14565272.26	40°06'18.5576"N	80°36'12.1394"W	10611.51	165.079	1.24	
17804.00	88.400	144.050	6340.25	10538.62	-10327.98	2786.57	1751376.48	14565198.01	40°06'17.8212"N	80°36'11.4459"W	10697.29	164.901	0.39	
17918.00	88.550	144.460	6343.28	10650.58	-10420.47	2853.14	1751443.02	14565105.55	40°06'16.9042"N	80°36'10.5945"W	10804.01	164.688	0.38	
17943.00†	88.550	144.460	6343.91	10675.15	-10440.81	2867.67	1751457.55	14565085.22	40°06'16.7026"N	80°36'10.4087"W	10827.46	164.642	0.00	

HOLE & CASING SECTIONS - Ref Wellbore: Dallas Hall OHI 206H AWB Ref Wellpath: Dallas Hall OHI 206H awp Proj: 17943'

String/Diameter	Start MD [ft]	End MD [ft]	Interval [ft]	Start TVD [ft]	End TVD [ft]	Start N/S [ft]	End N/S [ft]	Start E/W [ft]	End E/W [ft]	End E/W [ft]
13.375in Casing	26.00	540.00	514.00	26.00	540.00	0.00	0.87	0.00	0.00	0.46
9.625in Casing	26.00	1926.00	1900.00	26.00	1901.97	0.00	32.92	0.00	0.00	-220.17
5.5in Casing	26.00	17943.00	17917.00	26.00	6343.91	0.00	-10440.81	0.00	0.00	2867.67

REFERENCE WELLPATH IDENTIFICATION

Operator	SWN PRODUCTION COMPANY, LLC	Well	Dallas Hall OHI 206H
Field	Ohio	API	47069003530000
Facility	Dallas Hall OHI Pad	Wellbore	Dallas Hall OHI 206H AWB
Slot	206H		

TARGETS

Name	TVD [ft]	North [ft]	East [ft]	Grid East [US ft]	Grid North [US ft]	Latitude	Longitude	Shape
Dallas Hall OHI 206H WP1 rev 1	6118.00	-7659.05	898.31	1749488.95	14567865.90	40°06'44.2782"N	80°36'35.5957"W	point
Dallas Hall OHI 206H LP Rev 4	6119.00	-478.92	-1776.07	1746815.61	14575043.24	40°07'55.3470"N	80°37'9.6210"W	point
Dallas Hall OHI 206H BHL rev 2	6323.00	-10441.46	2865.98	1751455.86	14565084.57	40°06'16.6963"N	80°36'10.4304"W	point

WELLPATH COMPOSITION - Ref Wellbore: Dallas Hall OHI 206H AWB Ref Wellpath: Dallas Hall OHI 206H awp Proj: 17943'

Start MD [ft]	End MD [ft]	Positional Uncertainty Model	Log Name/Comment	Wellbore	Survey Date
26.00	485.00	OWSG MWD rev2 + HRGM	1 Tally MWD HRGM 17.5" 143' - 485'	Dallas Hall OHI 206H AWB	7/23/2023
485.00	1856.00	OWSG MWD rev2 + HRGM	2 Tally MWD HRGM 12.25" 595' - 1856'	Dallas Hall OHI 206H AWB	7/23/2023
1856.00	5170.00	OWSG MWD rev2 + HRGM	3 Tally MWD HRGM 8.75" 1980' - 5170'	Dallas Hall OHI 206H AWB	7/23/2023
5170.00	17943.00	BH AutoTrak Curve/Express (2019) (HRGM, Short spacing)	4 BH MWD ATC HRGM Short spacing 8.5" 5270' - 17918'	Dallas Hall OHI 206H AWB	7/23/2023

RECEIVED
 Office Of Oil and Gas
 FEB 14 2024
 WV Department of
 Environmental Protection