



1) Date: February 7, 19 83
 2) Operator's Well No. P--12
 3) API Well No. 47 073 1599
 State West Virginia County Jefferson Permit 1599

DRILLING CONTRACTOR:

STATE OF WEST VIRGINIA
DEPARTMENT OF MINES, OIL AND GAS DIVISION

OIL AND GAS WELL PERMIT APPLICATION

- 4) WELL TYPE: A Oil / Gas
 B (If "Gas", Production / Underground storage / Deep / Shallow)
- 5) LOCATION: Elevation: 1080' Watershed: Sharps Run
 District: Jefferson County: Pleasants Quadrangle: Schultz 7.5'
- 6) WELL OPERATOR PRENCO 11) DESIGNATED AGENT Denzil L. Prather
 Address P. O. Box 91 Address P. O. Box 91
Mineral Wells, WV 26150 Mineral Wells, WV 26150
- 7) OIL & GAS ROYALTY OWNER G.S.M. Powell Ers. 12) COAL OPERATOR None
 Address Belmont, WV Address _____
- 8) SURFACE OWNER Harry L. Sigler, Jr. 13) COAL OWNER(S) WITH DECLARATION ON RECORD:
 Address Rt. #3 Name _____
St. Marys, WV 26170 Address _____
- 9) FIELD SALE (IF MADE) TO: 14) COAL LESSEE WITH DECLARATION ON RECORD:
 Address _____ Name _____
 Address _____
- 10) OIL & GAS INSPECTOR TO BE NOTIFIED
 Name Robert A. Lowther Address _____
General Delivery
Middlebourne, WV 26149 PF: 758-4764
- 15) PROPOSED WORK: Drill / Drill deeper _____ / Redrill _____ / Fracture or stimulate _____
 Plug off old formation _____ / Perforate new formation _____
 Other physical change in well (specify) _____
- 16) GEOLOGICAL TARGET FORMATION, Devonian Shale
- 17) Estimated depth of completed well, 5000 feet
- 18) Approximate water strata depths: Fresh, n/a feet; salt, n/a feet.
- 19) Approximate coal seam depths: None Is coal being mined in the area? Yes _____ / No

RECEIVED

FEB 8 - 1983

OIL AND GAS DIVISION
WV DEPARTMENT OF MINES

20) CASING AND TUBING PROGRAM

CASING OR TUBING TYPE	SPECIFICATIONS					FOOTAGE INTERVALS		CEMENT FILL-UP OR SACKS (Cubic feet)	PACKERS
	Size	Grade	Weight per ft.	New	Used	For drilling	Left in well		
Conductor									
Fresh water	8 5/8			X			400'	To surface	Kinds
Coal				X			1200'	To surface	Sizes
Intermediate	6 5/8			X			4000'	280 sks.	Depths set
Production	4 1/2			X					Perforations:
Tubing									Top Bottom
Liners									

- 21) EXTRACTION RIGHTS
 Check and provide one of the following:
 Included is the lease or leases or other continuing contract or contracts by which I hold the right to extract oil or gas.
 The requirement of Code 22-4-1-(c) (1) through (4). (See reverse side for specifics.)
- 22) ROYALTY PROVISIONS
 Is the right to extract, produce or market the oil or gas based upon a lease or other continuing contract or contracts providing for flat well royalty or any similar provision for compensation to the owner of the oil or gas in place which is not inherently related to the volume of oil or gas so extracted, produced or marketed? Yes No
- If the answer above is No, nothing additional is needed. If the answer is Yes, you may use Affidavit Form IV-60.
- 23) Required Copies (See reverse side.)
- 24) Copies of this Permit Application and the enclosed plat and reclamation plan have been mailed by registered mail or delivered by hand to the above named coal operator, coal owner(s), and coal lessee on or before the day of the mailing or delivery of this Permit Application to the Department of Mines at Charleston, West Virginia.
- Notary: Elizabeth J. Snyder Signed: Denzil L. Prather
 My Commission Expires June 12, 1990 Its: Designated Agent

OFFICE USE ONLY
DRILLING PERMIT

Permit number 47-073-1599 Date February 9 1983

This permit covering the well operator and well location shown below is evidence of permission granted to drill in accordance with the pertinent legal requirements subject to the conditions contained herein and on the reverse hereof. Notification must be given to the District Oil and Gas Inspector. (Refer to No. 10) Prior to the construction of roads, locations and pits for any permitted work. In addition, the well operator or his contractor shall notify the proper district oil and gas inspector 24 hours before actual permitted work has commenced.)

Permit expires October 9, 1983 unless drilling is commenced prior to that date and prosecuted with due diligence.

Bond: Blanket Agent: rk my Plat: PL Casing: PL Fee: 243

[Signature]
Administrator, Office of Oil and Gas

NOTE: Keep one copy of this permit posted at the drilling location.

Line Item Explanation

- 1) Date of Application
- 2) Your well name and number
- 3) To be filled out by office of oil & gas
- 4A) "Oil" means natural crude oil or petroleum and other hydrocarbons, regardless of gravity, which are produced at the well in liquid form by ordinary production methods and which are not the result of condensation of gas after it leaves underground reservoirs: "Gas" means all natural gas and all other fluid hydrocarbons not defined as oil.
- 4B) "Shallow well" means any well drilled and completed in a formation above the top of the uppermost member of the "Onondaga Group" or a depth less than six thousand feet, whichever is shallower.
"Deep well" means any well drilled and completed in a formation at or below the top of the uppermost member of the "Onondaga Group" or at a depth less than six thousand feet, whatever is shallower.
- 5) Where well is located
- 6) Before a permit can be issued in a corporation, company partnership, or fictitious name, the name must be registered with the Secretary of State Office
- 7) Use separate sheet if necessary
- 8) Present surface owner at time application is filed.
- 9) Optional
- 11) See Reg. 7.01 relating to code §22-4-1k
- 12) "Coal Operator" means any persons, firm, partnership, partnership association or corporation that proposes to or does operate a coal mine. See Note 24
- 13 & 14) As per §22-4-20; See Note 24
- 15) Work that will be attempted—A separate Form IV-2 shall not be required for fracturing or stimulating a well where fracturing or stimulating is to be part of the work for which a permit is sought and is noted as such on the Form IV-2 filed in connection therewith.
- 16) Anticipated formation for which well will be completed
- 17) Self explanatory
- 18) Depth to deepest freshwater, and shallowest salt water, taken from nearby wells corrected for differences in elevation
- 19) All coal seam depths
- 20) Proposed casing program and cementing refer to Code 22-4-5, 22-4-6, 22-4-7, 22-4-8, 22-4-8a Reg 9.01, 15.01, 15.02, 15.03, 15.04, 25.01, 25.02, 25.03, 25.04
- 21) Code 22-4-11(c) - In lieu of filing the lease or leases or other continuing contract or contracts, the applicant for a permit described herein may file the following:
 - (1) A brief description of the tract of land including the district and county wherein the tract is located;
 - (2) The identification of all parties to all leases or other continuing contractual agreements by which the right to extract, produce or market the oil or gas is claimed;
 - (3) The book and page number wherein each such lease or contract by which the right to extract, produce or market the oil or gas is recorded;
 - (4) A brief description of the royalty provisions of each such lease or contract.
- 22) Code 22-4-11(d) and 22-4-11(e).
- 23) Regulation 7.02 of the Department of Mines provides that the original and four copies of Form IV-2 must be filed with the Department, accompanied by (i) a plat in the form prescribed by Regulation 11, (ii) a bond in one of the forms prescribed by Regulation 12, or in lieu thereof the other security allowed by Code §22-4-2, (iii) Form IV-9, "Reclamation Plan", applicable to the reclamation required by Code §22-4-12b and Regulation 23, (iv) unless previously paid on the same well, the fee required by Code §22-4-12a, and (v) if applicable, the consent required by Code §22-4-8a from the owner of any water well or dwelling within 200 feet of the proposed well.
- 24) **The above named coal operator, coal owner(s), and coal lessee are hereby notified that any objection they wish to make or are required to make by Code §22-4-3 must be filed with the Department of Mines within fifteen (15) days after the receipt of this Application by the Department.**

The following waiver must be completed by the coal operator and by any coal owner or coal lessee who has recorded a declaration under Code 22-4-20, if the permit is to be issued within fifteen (15) days of receipt thereof.

WAIVER

The undersigned coal operator _____ / owner _____ / lessee _____ / of the coal under this well location has examined this proposed well location. If a mine map exists which covers the area of the well location, the well location has been added to the mine map. The undersigned has no objection to the work proposed to be done at this location, provided, the well operator has complied with all applicable requirements of the West Virginia Code and the governing regulations.

Date: _____, 19____

By _____

Its _____

PRENCO

STATE ROUTE 14 - P.O. BOX 91
MINERAL WELLS, WEST VIRGINIA 26150

PHONE
304-489-2221

PHONE
304-489-2222

November 18, 1982

Royalty owners: G. S. M. Powell Hrs. - P-10

1/8th Royalty

Marguerite Powell	Belmont, WV	6/18
Robert Streitenberger	Rt. 2 - Box 248X Williston, FL	6/18
Mary Lou Hague	1011 51st St. Vienna, WV	1/18
Daisy Deem	408-B 58th St. Vienna, WV	1/18
James E. Deem	614 39th St. Vienna, WV	1/18
B. C. Deem, Jr.	2801 Morningside Ave. Parkersburg, WV	1/18
Margaret R. Rolfer	12302 Gamma St. Garden Grove, CA	1/18
Anna C. Farnsworth	3102 25th Street Parkersburg, WV	1/18

PRENCO

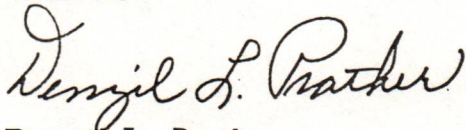

Denzil L. Prather
Designated Agent

RECEIVED

FEB 8 - 1983

OIL AND GAS DIVISION
WV DEPARTMENT OF MINES

CONFIDENTIAL INFORMATION - NOT TO BE PUBLISHED.



1126

IV-9
(Rev 8-81)

DATE Jan. 25, 1983

WELL NO. P-12

State of West Virginia
Department of Mines
Oil and Gas Division

API NO. 47 - 073 - 1599

CONSTRUCTION AND RECLAMATION PLAN

COMPANY NAME PRENCO

DESIGNATED AGENT Denzil L. Prather

Address Box 91, Mineralwells WV

Address Same

Telephone 489-2221/2222

Telephone

LANDOWNER Harry L. Sigler, Jr.

SOIL CONS. DISTRICT Upper Ohio

Revegetation to be carried out by Darrell Null

(Agent)

This plan has been reviewed by Upper Ohio SCD. All corrections and additions become a part of this plan:

2/3/83
(Date)

Kenneth R. Mason
(SCD Agent)

ACCESS ROAD

LOCATION

Structure Drainage ditches (A)

Structure Diversion Ditch (1)

Spacing

Material Earth

Page Ref. Manual 2-12

Page Ref. Manual 2-12

Structure Rip-rap (B)

Structure Rip-rap (2)

Spacing Logs

Material Logs

Page Ref. Manual N/A

Page Ref. Manual N/A

Structure Culvert (C)

Structure (3)

Spacing 24" diameter

Material

Page Ref. Manual 2-7

Page Ref. Manual

All structures should be inspected regularly and repaired if necessary. All commercial timber is to be cut and stacked and all brush and small timber to be cut and removed from the site before dirt work begins.

REVEGETATION

Treatment Area I

Treatment Area II

Lime _____ Tons/acre
or correct to pH 6.5

Lime _____ Tons/acre
or correct to pH 6.5

Fertilizer 500 lbs/acre
(10-20-20 or equivalent)

Fertilizer 500 lbs/acre
(10-20-20 or equivalent)

Mulch Hay 1.5 Tons/acre

Mulch Hay 1.5 Tons/acre

Seed* Ky. 31 Fescue 30 lbs/acre

Seed* Ky. 31 Fescue 30 lbs/acre

Perennial Ryegrass 30 lbs/acre

Perennial Ryegrass 30 lbs/acre

Alsike Clover 10 lbs/acre

Alsike Clover 10 lbs/acre

*Inoculate all legumes such as vetch, trefoil and clovers with the proper bacterium. Inoculate with 3X recommended amount.

PLAN PREPARED BY David W. Batten

ADDRESS PO Box 91

Mineralwells, WV 26150

PHONE NO.

489-2221-2222

NOTES: Please request landowners' cooperation to protect new seedling for one growing season. Attach separate sheets as necessary for comments.

IV-9 REVERSE
(REV 8-81)

ATTACH OR PHOTOCOPY SECTION OF
INVOLVED TOPOGRAPHIC MAP.
QUADRANGLE Schultz 7 $\frac{1}{2}$ '

LEGEND

Well Site 

Access Road 



10-5-15

to
st

PRENCO

STATE ROUTE 14 - P.O. BOX 91
MINERAL WELLS, WEST VIRGINIA 26150

PHONE
304-489-2221

PHONE
304-489-2222

February 7, 1983

Jefferson District
Pleasants Co., W. Va.
G. S. M. Powell Heirs
92.50 acres
Recorded Feb. 7, 1968
Lease Book 121, page 403
1/8th Royalty to be paid

AFFIDAVIT

I, Denzil L. Prather (the above designated owner or operator, or authorized representative thereof) hereby verifies that the owner or owners of the mineral estate upon which this proposed well is to be located will receive minimum one-eighth (1/8) royalty payments for any gas or oil extracted therefrom. Copies of the Permit Application and the enclosed plat and reclamation plan have been mailed by registered mail or delivered by hand to the above-named coal operator, co-owner(s), and coal lessee on or before the day of the mailing or delivery of this Permit Application to the Department of Mines at Charleston, West Virginia.

Signed: Denzil L. Prather
~~Owner, Operator, or~~ Authorized Representative)

Notary : Elizabeth F. Snyder (Signed)

My commission expires June 12, 1990

RECEIVED

FEB 8 - 1983

OIL AND GAS DIVISION
WV DEPARTMENT OF MINES

HALLIBURTON SERVICES JOB SUMMARY

FORM 2025

HALLIBURTON
DIVISION
LOCATION

RENO, OHIO

BILLED ON
TICKET NO. 509650

WELL DATA
 FIELD SCHULTZ SEC. 5-TH TWP. 012 RNG. JEFFERSON COUNTY PLEASANTS STATE W. Va.
 FORMATION NAME SAND TYPE SAND
 FORMATION THICKNESS _____ FROM _____ TO _____
 INITIAL PROD: OIL _____ BPD. WATER _____ BPD. GAS _____ MCFD _____
 PRESENT PROD: OIL _____ BPD. WATER _____ BPD. GAS _____ MCFD _____
 COMPLETION DATE _____ MUD TYPE _____ MUD WT. _____
 PACKER TYPE _____ SET AT _____
 BOTTOM HOLE TEMP. _____ PRESSURE _____
 MISC. DATA _____ TOTAL DEPTH 2809

NEW USED	WEIGHT	SIZE	FROM	TO	MAXIMUM PSI ALLOWABLE
	<u>10.50</u>	<u>4 1/2</u>	<u>62</u>	<u>2792</u>	<u>1500</u>
CASING					
LINER					
TUBING					
OPEN HOLE					SHOTS/FT.
PERFORATIONS					
PERFORATIONS					
PERFORATIONS					

TOOLS AND ACCESSORIES

TYPE AND SIZE	QTY.	MAKE
FLOAT COLLAR		
FLOAT SHOE <u>4 1/2</u>	<u>1 EA.</u>	<u>HOWCO</u>
GUIDE SHOE		
CENTRALIZERS <u>4 1/2</u>	<u>3 EA.</u>	<u>"</u>
BOTTOM PLUG		
TOP PLUG <u>4 1/2</u> <u>NO Baffle</u>	<u>1 EA.</u>	<u>"</u>
HEAD <u>4 1/2</u> <u>PK. 3 MANIFOLD</u>	<u>1 EA.</u>	<u>"</u>
PACKER		
OTHER		

JOB DATA

CALLED OUT	ON LOCATION	JOB STARTED	JOB COMPLETED
DATE <u>5-7-93</u> TIME <u>11:00</u>	DATE <u>5-7-93</u> TIME <u>14:00</u>	DATE <u>5-7-93</u> TIME <u>15:05</u>	DATE <u>5-7-93</u> TIME <u>16:05</u>

PERSONNEL AND SERVICE UNITS

NAME	UNIT NO. & TYPE	LOCATION
<u>M. GEMMEY</u>	<u>31277</u> <u>OPER</u>	<u>RENO</u>
<u>C. BABB</u>	<u>357N</u> <u>HT-150</u>	<u>"</u>
<u>H. GALMAN</u>	<u>50K3</u> <u>Bulk TRK.</u>	<u>"</u>

MATERIALS

TREAT. FLUID _____ DENSITY _____ LB/GAL. API _____
 DISPL. FLUID _____ DENSITY _____ LB/GAL. API _____
 PROP. TYPE _____ SIZE _____ LB. _____
 ACID TYPE _____ GAL. _____ % _____
 SURFACTANT TYPE _____ GAL. _____ IN _____
 NE AGENT TYPE _____ GAL. _____ IN _____
 FLUID LOSS ADD. TYPE _____ GAL.-LB. _____ IN _____
 GELLING AGENT TYPE _____ GAL.-LB. _____ IN _____
 FRIC. RED. AGENT TYPE _____ GAL.-LB. _____ IN _____
 BREAKER TYPE _____ GAL.-LB. _____ IN _____
 BLOCKING AGENT TYPE _____ GAL.-LB. _____
 PERFFAC BALLS TYPE _____ QTY. _____
 OTHER 5 SKB HOWCO GEL

DEPARTMENT CEMENT
 DESCRIPTION OF JOB CEMENT 4 1/2 IN. MIXING
 JOB DONE THRU: TUBING CASING ANNULUS TBG./ANN.
 CUSTOMER REPRESENTATIVE X Michael J. ...
 HALLIBURTON OPERATOR Michael J. ... COPIES REQUESTED _____

CEMENT DATA

STAGE	NUMBER OF SACKS	TYPE	API CLASS	BRAND	BULK SACKED	ADDITIVES	YIELD CU.FT./SK.	MIXED LBS./GAL.
<u>1</u>	<u>255</u>	<u>50002</u>	<u>A</u>	<u>HOWCO</u>	<u>B</u>	<u>10% SALT; 12.5% SK GILSONITE</u>	<u>1.54</u>	<u>13.47</u>

PRESSURES IN PSI

SUMMARY

VOLUMES

CIRCULATING 200 DISPLACEMENT 500 PRESLUSH: BBL-GAL. 25 TYPE GEL
 BREAKDOWN _____ MAXIMUM _____ LOAD & SHDN: BBL-GAL. 200 PAD: BBL-GAL. _____
 AVERAGE _____ FRACTURE GRADIENT _____ TREATMENT: BBL-GAL. _____ DISPL: BBL-GAL. 44.39
 SHUT-IN: INSTANT _____ 5-MIN. _____ 15-MIN. _____ CEMENT SLURRY: BBL-GAL. 69.94
 HYDRAULIC HORSEPOWER _____ TOTAL VOLUME: BBL-GAL. _____
 ORDERED _____ AVAILABLE _____ USED _____ REMARKS WELL CIRCULATED
 AVERAGE RATES IN BPM _____
 TREATING _____ DISPL. _____ OVERALL _____
 CEMENT LEFT IN PIPE _____
 FEET _____ REASON _____

CUSTOMER



IV-35
(Rev 8-81)

Date May 7, 1984
Operator's
Well No. P-12
Farm G S M Powell Heirs
API No. 47 - 073 - 1599

State of West Virginia
Department of Mines
Oil and Gas Division

WELL OPERATOR'S REPORT
OF
DRILLING, FRACTURING AND/OR STIMULATING, OR PHYSICAL CHANGE

RECEIVED
MAY 9 - 1984

WELL TYPE: Oil ___ / Gas XX / Liquid Injection ___ / Waste Disposal ___ /
(If "Gas," Production XX / Underground Storage ___ / Deep ___ / **DEPT. OF MINES**)

LOCATION: Elevation: 1080' Watershed Sharps Run
District: Jefferson County Pleasants Quadrangle Schultz 7 1/2'

COMPANY PRENCO
ADDRESS Box 91, Mineralwells WV
DESIGNATED AGENT Denzil L. Prather
ADDRESS Same
SURFACE OWNER Harry L. Sigler, Jr.
ADDRESS Schultz, WV
MINERAL RIGHTS OWNER G S M Powell Heirs
ADDRESS Belmont, WV
OIL AND GAS INSPECTOR FOR THIS WORK
R. Lowther ADDRESS Middlebourne, WV
PERMIT ISSUED Feb. 9, 1983
DRILLING COMMENCED Feb. 23, 1983
DRILLING COMPLETED Apr. 2, 1983
IF APPLICABLE: PLUGGING OF DRY HOLE ON
CONTINUOUS PROGRESSION FROM DRILLING OR
REWORKING. VERBAL PERMISSION OBTAINED
ON

Casing & Tubing	Used in Drilling	Left in Well	Cement fill up Cu. ft.
Size 20-16 Cond.			
9 5/8"	480'	pulled	none
8 5/8"	1187'	1187'	218 ft ³
7"			
5 1/2"			
4 1/2"		2792'	392 ft ³
3"			
2"			
Liners used			

GEOLOGICAL TARGET FORMATION Devonian shale Depth 5000 feet
Depth of completed well 2787 feet Rotary ___ / Cable Tools XX
Water strata depth: Fresh 100 feet; Salt ___ feet
Coal seam depths: None Is coal being mined in the area? No

OPEN FLOW DATA

Producing formation Fifth Sand Pay zone depth 2700 feet
Gas: Initial open flow ___ Mcf/d Oil: Initial open flow ___ Bbl/d
Final open flow 10 Mcf/d Final open flow ___ Bbl/d
Time of open flow between initial and final tests ___ hours
Static rock pressure 20 psig (surface measurement) after 24 hours shut in
(If applicable due to multiple completion--)
Second producing formation ___ Pay zone depth ___ feet
Gas: Initial open flow ___ Mcf/d Oil: Initial open flow ___ Bbl/d
Final open flow ___ Mcf/d Oil: Final open flow ___ Bbl/d
Time of open flow between initial and final tests ___ hours
Static rock pressure ___ psig (surface measurement) after ___ hours shut in

(Continue on reverse side)

PUEAS. 1599

DETAILS OF PERFORATED INTERVALS, FRACTURING OR STIMULATING, PHYSICAL CHANGE, ETC.

5/21/83: perforated 2656-2752 with 95 holes; fractured with 300 gal 15%
HCl and 540 MSCF N₂.

WELL LOG

FORMATION	COLOR	HARD OR SOFT	TOP FEET	BOTTOM FEET	REMARKS
					Including indication of all fresh and salt water, coal, oil and gas
red and gray shales, sand			0	1034	
sand			1034	1058	
gray shale			1058	1070	
sand			1070	1082	
gray shale			1082	1128	
sand			1128	1213	
gray shale			1213	1244	
sand			1244	1260	
gray shale			1260	1265	
black shale			1265	1274	
gray shale			1274	1330	
sand			1330	1358	
black shale			1358	1375	
sand			1375	1390	
dk gray shale			1390	1398	
sand			1398	1420	
gray shale			1420	1465	
sand			1465	1485	
dk gray shale			1485	1560	
sand			1560	1603	gas @ 1568
gray shale			1603	1618	
sand			1618	1710	oil @ 1690
limestone (Greenbrier)			1710	1760	
sand			1760	1828	
gray shale, sandy			1828	1862	
sand			1862	1877	gas @ 1862
gray shale			1877	1882	
sand (Squaw)			1882	1898	
shaly siltstone			1898	2268	
silty shale			2268	2278	Berea @ 2278
shaly siltstone, fine-coarse			2278	2804	TD

(Attach separate sheets as necessary)

PRENCO

Well Operator

By: David W. Batten

Geologist

Date: May 7, 1984

Note: Regulation 2.02(i) provides as follows:
"The term 'log' or 'well log' shall mean a systematic detailed geological record of all formations, including coal, encountered in the drilling of a well."

STATE OF WEST VIRGINIA
DEPARTMENT OF MINES
OIL AND GAS WELLS DIVISION

RECEIVED

MAR 17 1983

OIL AND GAS DIVISION
WV DEPARTMENT OF MINES

INSPECTOR'S WELL REPORT

Permit No. 073-1599

Oil or Gas Well _____
(KIND)

Company <u>prenc</u>	CASING AND TUBING	USED IN DRILLING	LEFT IN WELL	PACKERS
Address <u>mineral wells unit</u>	Size			
Farm <u>Harvey L. Sigler Jr</u>	16			Kind of Packer _____
Well No. <u>P-12</u>	13			
District <u>Jefferson</u> County <u>pleasant</u>	10			Size of _____
Drilling commenced <u>2-24-83</u>	8 1/2	1200	1200	
Drilling completed _____ Total depth _____	6 3/4			Depth set _____
Date shot _____ Depth of shot _____	5 3/16			
Initial open flow _____ /10ths Water in _____ Inch	3			Perf. top _____
Open flow after tubing _____ /10ths Merc. in _____ Inch	2			Perf. bottom _____
Volume _____ Cu. Ft.	Liners Used			Perf. top _____
Rock pressure _____ lbs. _____ hrs.				Perf. bottom _____
Oil _____ bbls., 1st 24 hrs.	CASING CEMENTED <u>8 5/8</u> SIZE <u>1200</u> No. FT. <u>3-13-83</u> Date			
Fresh water _____ feet _____ feet	NAME OF SERVICE COMPANY <u>Halliburton</u>			
Salt water _____ feet _____ feet	COAL WAS ENCOUNTERED AT _____ FEET _____ INCHES			
	_____ FEET _____ INCHES _____ FEET _____ INCHES			
	_____ FEET _____ INCHES _____ FEET _____ INCHES			

Drillers' Names _____

Harry L. Sigler Jr Contractor

Remarks: _____

3-14-83

DATE

R.A. Lowther

DISTRICT WELL INSPECTOR

STATE OF WEST VIRGINIA
DEPARTMENT OF MINES
OIL AND GAS WELLS DIVISION

INSPECTOR'S WELL REPORT

Permit No. 073-1599

Oil or Gas Well _____
(KIND)

Company preuco
 Address mineral wells w. Va
 Farm H. L. Sigler jr
 Well No. 2-12
 District Jefferson County pleasant
 Drilling commenced _____
 Drilling completed 3-31-83 Total depth 1860
 Date shot _____ Depth of shot _____
 Initial open flow _____ /10ths Water in _____ Inch
 Open flow after tubing _____ /10ths Merc. in _____ Inch
 Volume 200,000 Cu. Ft.
 Rock pressure _____ lbs. _____ hrs.
 Oil _____ bbls., 1st 24 hrs.
 Fresh water _____ feet _____ feet
 Salt water _____ feet _____ feet

CASING AND TUBING	USED IN DRILLING	LEFT IN WELL	PACKERS
Size			
16			Kind of Packer _____
13			
10			Size of _____
8 1/4			
6 5/8			Depth set _____
5 3/16			
3			Perf. top _____
2			Perf. bottom _____
Liners Used			Perf. top _____
			Perf. bottom _____

CASING CEMENTED _____ SIZE _____ No. FT. _____ Date _____
 NAME OF SERVICE COMPANY _____
 COAL WAS ENCOUNTERED AT _____ FEET _____ INCHES
 _____ FEET _____ INCHES FEET _____ INCHES
 _____ FEET _____ INCHES FEET _____ INCHES

Drillers' Names _____

Remarks: _____

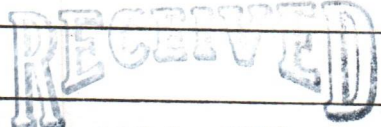

APR 7 - 1983

OIL & GAS DIVISION
DEPT. OF MINES

4-4-83
DATE

R. A. Lowther
DISTRICT WELL INSPECTOR



State of West Virginia
Department of Mines
Oil and Gas Division
Charleston 25305

FINAL INSPECTION REPORT
INSPECTORS COMPLIANCE REPORT

COMPANY preuco

PERMIT NO 47-073-1599

FARM & WELL NO Highler P-12

DIST. & COUNTY Jefferson pleasants

RULE	DESCRIPTION	IN COMPLIANCE	
		YES	NO
23.06	Notification Prior to Starting Work		
25.04	Prepared before Drilling to Prevent Waste		
25.03	High-Pressure Drilling		
16.01	Required Permits at Wellsite		
15.03	Adequate Fresh Water Casing		
15.02	Adequate Coal Casing		
15.01	Adequate Production Casing		
15.04	Adequate Cement Strenght		
15.05	Cement Type		
23.02	Maintained Access Roads		
25.01	Necessary Equipment to Prevent Waste		
23.04	Reclaimed Drilling Pits		
23.05	No Surface or Underground Pollution		
23.07	Requirements for Production & Gathering Pipelines		
16.01	Well Records on Site		
16.02	Well Records Filed		
7.05	Identification Markings		

I HAVE INSPECTED THE ABOVE CAPTIONED WELL AND RECOMMEND THAT IT BE RELEASED:

SIGNED R. A. Lawther

DATE Jan 24, 1986

Your well record was received and reclamation requirements approved. In accordance with Chapter 22, Article 4, Section 2, the above well will remain under bond coverage for the life of the well.

Administrator-Oil & Gas Division

DATE



RECEIVED
JUN 1 - 1984

OIL & GAS DIVISION
DEPT. OF MINES

State of West Virginia
Department of Mines
Oil and Gas Division
Charleston 25305
FINAL INSPECTION REPORT
INSPECTORS COMPLIANCE REPORT
May 16, 1984

COMPANY PRENCO
Box 91
Mineralwells, West Virginia 26150

PERMIT NO 073-1599
FARM & WELL NO GSM Powell, P-12
DIST. & COUNTY Jefferson/Pleasants

RULE	DESCRIPTION	IN COMPLIANCE	
		YES	NO
23.06	Notification Prior to Starting Work	<input checked="" type="checkbox"/>	<input type="checkbox"/>
25.04	Prepared before Drilling to Prevent Waste	<input checked="" type="checkbox"/>	<input type="checkbox"/>
25.03	High-Pressure Drilling	<input checked="" type="checkbox"/>	<input type="checkbox"/>
16.01	Required Permits at Wellsite	<input checked="" type="checkbox"/>	<input type="checkbox"/>
15.03	Adequate Fresh Water Casing	<input checked="" type="checkbox"/>	<input type="checkbox"/>
15.02	Adequate Coal Casing	<input type="checkbox"/>	<input type="checkbox"/>
15.01	Adequate Production Casing	<input checked="" type="checkbox"/>	<input type="checkbox"/>
15.04	Adequate Cement Strength	<input checked="" type="checkbox"/>	<input type="checkbox"/>
15.05	Cement Type	<input checked="" type="checkbox"/>	<input type="checkbox"/>
23.02	Maintained Access Roads	<input checked="" type="checkbox"/>	<input type="checkbox"/>
25.01	Necessary Equipment to Prevent Waste	<input checked="" type="checkbox"/>	<input type="checkbox"/>
23.04	Reclaimed Drilling Pits	<input checked="" type="checkbox"/>	<input type="checkbox"/>
23.05	No Surface or Underground Pollution	<input checked="" type="checkbox"/>	<input type="checkbox"/>
23.07	Requirements for Production & Gathering Pipelines	<input checked="" type="checkbox"/>	<input type="checkbox"/>
16.01	Well Records on Site	<input checked="" type="checkbox"/>	<input type="checkbox"/>
16.02	Well Records Filed	<input checked="" type="checkbox"/>	<input type="checkbox"/>
7.05	Identification Markings	<input checked="" type="checkbox"/>	<input type="checkbox"/>

I HAVE INSPECTED THE ABOVE CAPTIONED WELL AND RECOMMEND THAT IT BE RELEASED:

SIGNED R. A. Lowther

DATE May 30, 1984

Your well record was received and reclamation requirements approved. In accordance with Chapter 22, Article 4, Section 2, the above well will remain under bond coverage for the life of the well.

T. H. ...
Administrator-Oil & Gas Division

June 6, 1984

DATE

NORTH

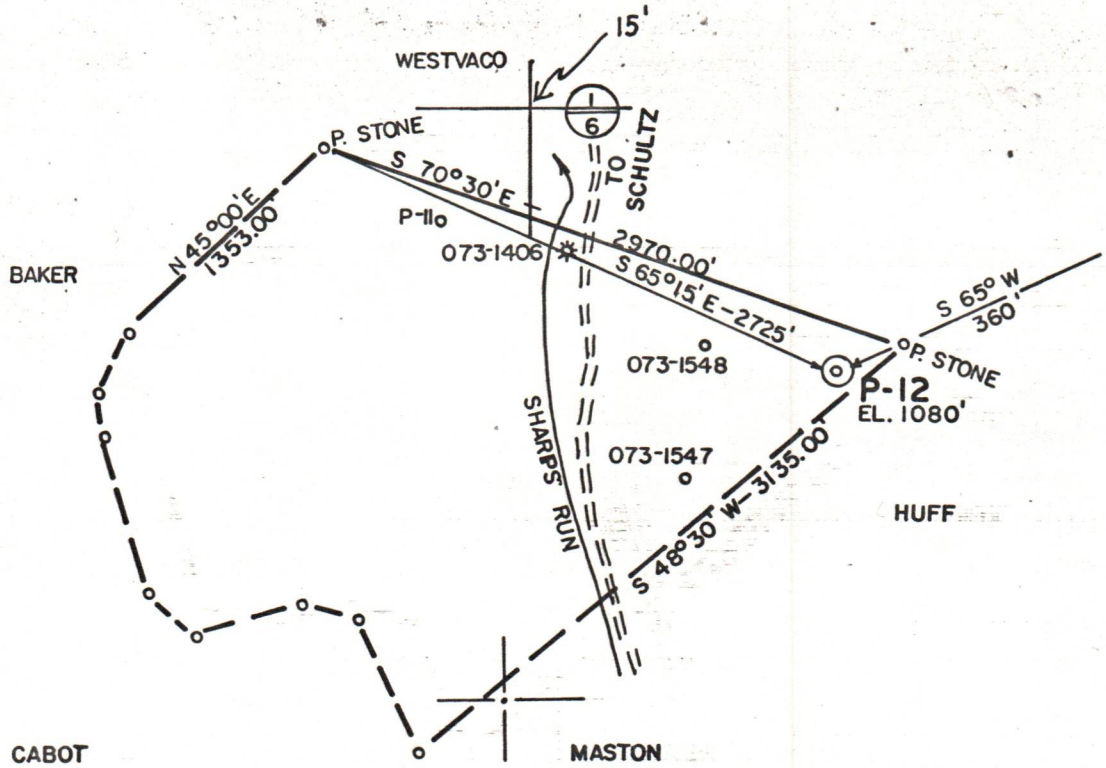

FILE NO. 83-55
 DRAWING NO. _____
 SCALE 1" = 1000'
 MINIMUM DEGREE OF ACCURACY 1' / 200'
 PROVEN SOURCE OF ELEVATION WELL 1406 (770')

I THE UNDERSIGNED, HEREBY CERTIFY THAT THIS PLAT IS CORRECT TO THE BEST OF MY KNOWLEDGE AND BELIEF AND SHOWS ALL THE INFORMATION REQUIRED BY LAW AND THE REGULATIONS ISSUED AND PRESCRIBED BY THE DEPARTMENT OF MINES.
 (SIGNED) *Chester B. Waterman*
 R.P.E. 3788 L.L.S. _____

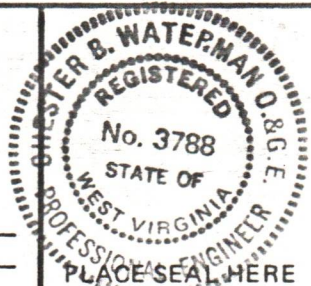

STATE OF WEST VIRGINIA
 DEPARTMENT OF MINES
 OIL AND GAS DIVISION



DATE 2/3, 19 83
 OPERATOR'S WELL NO. P-12
 API WELL NO. 47-073-1599
 STATE COUNTY PERMIT

(+) DENOTES LOCATION OF WELL ON UNITED STATES TOPOGRAPHIC MAPS
 WELL TYPE: OIL ___ GAS X LIQUID INJECTION ___ WASTE DISPOSAL ___
 (IF "GAS,") PRODUCTION X STORAGE ___ DEEP ___ SHALLOW ___
 LOCATION: ELEVATION 1080 WATER SHED SHARPS RUN
 DISTRICT JEFFERSON COUNTY PLEASANTS
 QUADRANGLE SCHULTZ 7.5'
 SURFACE OWNER HARRY L. SIGLER, JR. ACREAGE 145
 OIL & GAS ROYALTY OWNER G. S. M. POWELL HEIRS LEASE ACREAGE 145
 LEASE NO. _____
 PROPOSED WORK: DRILL X CONVERT ___ DRILL DEEPER ___ REDRILL ___ FRACTURE OR STIMULATE ___ PLUG OFF OLD FORMATION ___ PERFORATE NEW FORMATION ___ OTHER PHYSICAL CHANGE IN WELL (SPECIFY) _____
 PLUG AND ABANDON ___ CLEAN OUT AND REPLUG ___
 TARGET FORMATION DEVONIAN SHALE ESTIMATED DEPTH 5000'
 WELL OPERATOR PRENCO DESIGNATED AGENT DENZIL PRATHER
 ADDRESS P.O. BOX 91 ADDRESS SAME
MINERAL WELLS, WV 26150

Pleas-1599

(WILLOW ISLAND)





1126

IV-9
(Rev 8-81)

DATE Jan. 25, 1983

WELL NO. P-12

State of West Virginia

API NO. 47 - 073 - 1599

Department of Mines
Oil and Gas Division

CONSTRUCTION AND RECLAMATION PLAN

COMPANY NAME PRENCO
Address Box 91, Mineralwells WV
Telephone 489-2221/2222
LANDOWNER Harry L. Sigler, Jr.
Revegetation to be carried out by Darrell Null

DESIGNATED AGENT Denzil L. Prather
Address Same
Telephone _____
SOIL CONS. DISTRICT Upper Ohio
(Agent)

This plan has been reviewed by Upper Ohio SCD. All corrections and additions become a part of this plan:

2/3/83
(Date)

Renneth R. Mason
(SCD Agent)

ACCESS ROAD

LOCATION

Structure Drainage ditches (A)

Structure Diversion Ditch (1)

Spacing _____

Material Earth

Page Ref. Manual 2-12

Page Ref. Manual 2-12

RECEIVED

Structure Rip-rap (B)

Structure Rip-rap (2)

Spacing Logs

Material Logs

Page Ref. Manual N/A

Page Ref. Manual N/A

OIL AND GAS DIVISION
WV DEPARTMENT OF MINES

Structure Culvert (C)

Structure _____ (3)

Spacing 24" diameter

Material _____

Page Ref. Manual 2-7

Page Ref. Manual _____

All structures should be inspected regularly and repaired if necessary. All commercial timber is to be cut and stacked and all brush and small timber to be cut and removed from the site before dirt work begins.

REVEGETATION

Treatment Area I

Treatment Area II

Lime _____ Tons/acre
or correct to pH 6.5

Lime _____ Tons/acre
or correct to pH 6.5

Fertilizer 500 lbs/acre
(10-20-20 or equivalent)

Fertilizer 500 lbs/acre
(10-20-20 or equivalent)

Mulch Hay 1.5 Tons/acre

Mulch Hay 1.5 Tons/acre

Seed* Ky. 31 Fescue 30 lbs/acre

Seed* Ky. 31 Fescue 30 lbs/acre

Perennial Ryegrass 30 lbs/acre

Perennial Ryegrass 30 lbs/acre

Alsike Clover 10 lbs/acre

Alsike Clover 10 lbs/acre

*Inoculate all legumes such as vetch, trefoil and clovers with the proper bacterium. Inoculate with 3X recommended amount.

PLAN PREPARED BY David W. Batten

ADDRESS PO Box 91

Mineralwells, WV 26150

PHONE NO. 489-2221-2222

NOTES: Please request landowners' cooperation to protect new seedling for one growing season. Attach separate sheets as necessary for comments.

