

10060'

LATITUDE 39°25'

D.W. MOORE
10.33 AC.

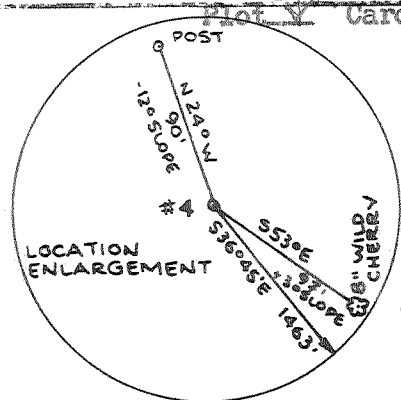

G.W. RIGGS
16.88 AC.

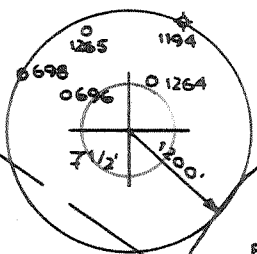

0.985
1.92 W

0.985
4.15 W

AUSTIN L. BAILEY

AUSTIN
L. BAILEY
73.5 AC. LEASE

ALONZO
BAILEY
49.29 AC.

M. BAILEY
0.27 AC.

24" HEDGE APPLE

FENCE POST

COUNTY ROUTE 26

FENCE POST

FILE NO. _____
 DRAWING NO. _____
 SCALE **1" = 500'**
 MINIMUM DEGREE OF ACCURACY **1:200**
 PROVEN SOURCE OF ELEVATION **ROAD INT. ELEV. 994'**

I THE UNDERSIGNED, HEREBY CERTIFY THAT THIS PLAT IS CORRECT TO THE BEST OF MY KNOWLEDGE AND BELIEF AND SHOWS ALL THE INFORMATION REQUIRED BY LAW AND THE REGULATIONS ISSUED AND PRESCRIBED BY THE DEPARTMENT OF MINES.
 (SIGNED) William B. Blalock
 R.P.E. _____ L.L.S. **551**

PLACE SEAL HERE



STATE OF WEST VIRGINIA
 DEPARTMENT OF MINES
 OIL AND GAS DIVISION

DATE **31 MAY**, 19 **84**
 OPERATOR'S WELL NO. **44**
 API WELL NO. _____
47 - 073 - 1849
 STATE COUNTY PERMIT

WELL TYPE: OIL GAS LIQUID INJECTION _____ WASTE DISPOSAL _____
 (IF "GAS") PRODUCTION STORAGE _____ DEEP _____ SHALLOW
 LOCATION ELEVATION **652'** WATER SHED **MIDDLE ISLAND CREEK**
 DISTRICT **UNION** 5 569 COUNTY **PLEASANTS**
 QUADRANGLE **RAVEN ROCK 7 1/2' QUAD.** ST. MARYS 116 05

SURFACE OWNER **AUSTIN L. BAILEY** ACREAGE **73.5**
 OIL & GAS ROYALTY OWNER **AUSTIN L. BAILEY** LEASE ACREAGE **73.5**
 LEASE NO. _____

PROPOSED WORK: DRILL CONVERT _____ DRILL DEEPER _____ REDRILL _____ FRACTURE OR STIMULATE PLUG OFF OLD FORMATION _____ PERFORATE NEW FORMATION _____ OTHER PHYSICAL CHANGE IN WELL (SPECIFY) _____

PLUG AND ABANDON _____ CLEAN OUT AND REPLUG _____
 TARGET FORMATION **SQUAW** 501 ESTIMATED DEPTH **2000'**
 WELL OPERATOR **L. I. B. OIL COMPANY** DESIGNATED AGENT **BERNARD TICE**
 ADDRESS **P.O. Box C** ADDRESS **P.O. Box C**
ST. MARYS, W.VA. 26170 **ST. MARYS, W.VA. 26170**

RECEIVED

JUL 30 1984



(3227)

IV-35 (Rev 8-81)

OIL & GAS DIVISION DEPT. OF MINES State of West Virginia

Department of Mines Oil and Gas Division

Date July 26 1984 Operator's Well No. A. Bailey #4 Farm Leonard Bailey API No. 47-073-1849

RECEIVED NOV 2 - 1984

WELL OPERATOR'S REPORT OF

DRILLING, FRACTURING AND/OR STIMULATING, OR PHYSICAL CHANGE

DEPT. OF MINES

WELL TYPE: Oil XX / Gas XX / Liquid Injection / Waste Disposal / (If "Gas," Production XX / Underground Storage / Deep / Shallow /)

LOCATION: Elevation: 652' Watershed Middle Island Creek District: Union County Pleasants Quadrangle Raven Rock

COMPANY L & B Oil Company, Inc. ADDRESS 210 Second St., St. Marys, WV DESIGNATED AGENT Bernard Tice ADDRESS 210 Second St., St. Marys, WV SURFACE OWNER Leonard Bailey ADDRESS Rt. 2, St. Marys, WV 26170 MINERAL RIGHTS OWNER Leonard & Anne Bailey & Alonzo Bailey ADDRESS Rt. 2, St. Marys, WV 26170 OIL AND GAS INSPECTOR FOR THIS WORK Robert Lowther ADDRESS Middlebourne, WV PERMIT ISSUED 6-11-84 DRILLING COMMENCED 6-13-84 DRILLING COMPLETED 6-15-84

Table with 4 columns: Casing & Tubing, Used in Drilling, Left in Well, Cement fill up Cu. ft. Rows include sizes 20-16 Cond., 13-10", 9 5/8, 8 5/8 (257' drilling, 257' left, to surface), 7, 5 1/2, 4 1/2 (1630' drilling, 1630' left, 1000' fill up), 3, 2, and Liners used.

IF APPLICABLE: PLUGGING OF DRY HOLE ON CONTINUOUS PROGRESSION FROM DRILLING OR REWORKING. VERBAL PERMISSION OBTAINED ON

GEOLOGICAL TARGET FORMATION Injun Depth 1600 feet Depth of completed well 1640 feet Rotary XX / Cable Tools Water strata depth: Fresh 28 feet; Salt N/A feet Coal seam depths: N/A Is coal being mined in the area? No

OPEN FLOW DATA Producing formation Injun Pay zone depth 511-1556 feet Gas: Initial open flow 80 Mcf/d Oil: Initial open flow 6 Bbl/d Final open flow 80 Mcf/d Oil: Final open flow 6 Bbl/d Time of open flow between initial and final tests 48 hours Static rock pressure 600 psig (surface measurement) after 24 hours shut in (If applicable due to multiple completion--)

(Continue on reverse side)

NOV 26 1984

DETAILS OF PERFORATED INTERVALS, FRACTURING OR STIMULATING, PHYSICAL CHANGE, ETC.

18 perfs from 1551' to 1556'

frac with 570 bbls. of H2O 15,000 lbs. of 20/40 sand

WELL LOG

FORMATION	COLOR	HARD OR SOFT	TOP FEET	BOTTOM FEET	REMARKS
					Including indication of all fres and salt water, coal, oil and ga
Shale			0	60	fresh water 28'
Gray Shale			60	170	
Red Shale			170	265	
Sand Stone			265	310	
Gray Shale			310	460	
Red Shale			460	510	
Sand & Shale			510	605	
Red Shale			605	716	
Cow Run			716	746	
First Salt Sand			926	965	
Second Salt Sand			1030	1058	
Third Salt Sand			1166	1184	
Maxon			1290	1337	
<u>Injun</u>			1384	1562	
Shale			1562	<u>1650</u> T.D.	

(Attach separate sheets as necessary)

L & B Oil Company, Inc.

Well Operator

By: Bernard Tice President

Date: July 26, 1984

Note: Regulation 2.02(i) provides as follows:
"The term 'log' or 'well log' shall mean a systematic detailed geological record of all formations, including sand, encountered in the drilling of a well."

RECEIVED

JUN 11 1984



1) Date: June 4, 19 84
 2) Operator's Well No. A. Bailey #4
 3) API Well No. 47 - 073 - 1849
 State County Permit

STATE OF WEST VIRGINIA
DEPARTMENT OF MINES, OIL AND GAS DIVISION

APPLICATION FOR A WELL WORK PERMIT

OIL & GAS DIVISION

- 4) WELL TYPE: Oil Gas XX /
 B (If "Gas", Production XX / Underground storage / Deep / Shallow XXX /)
 5) LOCATION: Elevation: 652' Watershed: Middle Island Creek (OMI:2)
 District: Union County: Pleasants Quadrangle: Raven Rock
 6) WELL OPERATOR L & B Oil Company, Inc. 7) DESIGNATED AGENT Bernard Tice
 Address 210 Second Street Address 210 Second Street
St. Marys, WV 26170 St. Marys, WV 26170
 8) OIL & GAS INSPECTOR TO BE NOTIFIED 9) DRILLING CONTRACTOR:
 Name Bob Lowther Name Unknown
 Address 3rd Street Address
Middlebourne, WV 26149
 10) PROPOSED WELL WORK: Drill XX / Drill deeper / Redrill / Stimulate XX /
 Plug off old formation / Perforate new formation /
 Other physical change in well (specify)
 11) GEOLOGICAL TARGET FORMATION, Squaw
 12) Estimated depth of completed well, 2000 feet
 13) Approximate strata depths: Fresh, 50 feet; salt, N/A feet.
 14) Approximate coal seam depths: N/A Is coal being mined in the area? Yes / No NO /

15) CASING AND TUBING PROGRAM

CASING OR TUBING TYPE	SPECIFICATIONS					FOOTAGE INTERVALS		CEMENT FILL-UP OR SACKS (Cubic feet)	PACKERS
	Size	Grade	Weight per ft.	New	Used	For drilling	Left in well		
Conductor									Kinds
Fresh water									
Coal									Sizes
Intermediate	8 5/8		20#	X		250'	250'	to surface	<u>NEAT</u>
Production	4 1/2		10.5#	X		2000'	2000'	1000' Fill up	UD Depths set
Tubing									
Liners									Perforations:
									Top Bottom

OFFICE USE ONLY
DRILLING PERMIT

Permit number 47-073-1849 Date June 11, 19 84

This permit covering the well operator and well location shown below is evidence of permission granted to drill in accordance with the pertinent legal requirements subject to the conditions contained herein and on the reverse hereof. Notification must be given to the District Oil and Gas Inspector, (Refer to No. 8) Prior to the construction of roads, locations and pits for any permitted work. In addition, the well operator or his contractor shall notify the proper district oil and gas inspector 24 hours before actual permitted work has commenced.)

The permitted work is as described in the Notice and Application, plat, and reclamation plan, subject to any modifications and conditions specified on the reverse hereof.

Permit expires June 11, 1986 unless well work is commenced prior to that date and prosecuted with due diligence.

Bond: <u>Blanket</u>	Agent: <u>MU</u>	Plat: <u>MU</u>	Casing: <u>MU</u>	Fee: <u>006 907</u>
----------------------	------------------	-----------------	-------------------	---------------------

Margaret J. Hassel
Administrator, Office of Oil and Gas

NOTE: Keep one copy of this permit posted at the drilling location.