

# BERTHA FRESHWATER LEASE

## 47-073-02621

## WELL NO. 470730000J

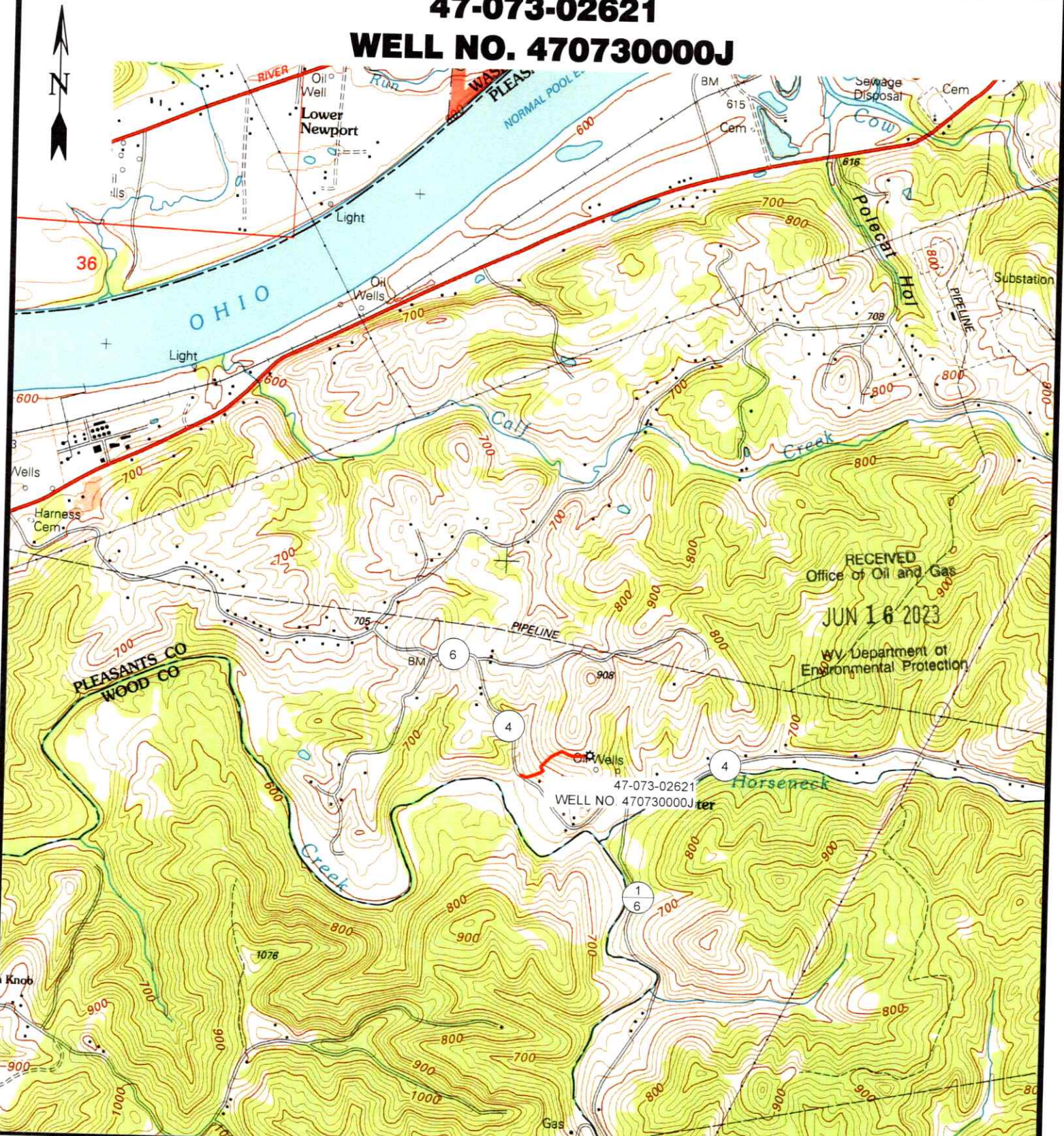

12 Vanhorn Drive | P.O. Box 150 | Glenville, WV 26351 | 304.462.5634  
 1412 Kanawha Boulevard, East | Charleston, WV 25301 | 304.346.3952  
 254 East Beckley Bypass | Beckley, WV 25801 | 304.255.5296

sllwv.com

WILLOW ISLAND 7.5 ±

**SCALE: 1"=2000'**

0' 2000' 4000'



DRAWN BY GF	FILE NO. 9378	DATE 4-10-23	CADD FILE: 9378-SURV-TOP0-ROO- GF-230410.DWG
----------------	------------------	-----------------	--

06/30/2023



**BERTHA FRESHWATER  
35 ACRE LEASE  
WELL NO. 470730000J  
47-073-02621**

NAD'83 GEO. LAT-(N) 39.325404 LONG-(W) 81.328208  
NAD'83 UTM (M)(ZONE 17) N. 4,352,939 E. 471,711

**WELL NO. 407300000J  
47-073-02621**

P/O 2-7-48  
GENE M. & SANDRA  
L. COKELEY,  
TRUSTEES  
183.00 AC.

REBAR IN  
CONCRETE

2-7-62  
GENE M. AND  
SANDRA L.  
COKELEY TRUSTEE  
7 AC.

2-7-48  
GENE M. & SANDRA  
L. COKELEY,  
TRUSTEES  
183.00 AC.

2-7-55  
TIMOTHY G.  
BRAMMER, SR.  
43.12 AC.

**WELL NO. 470730000J  
47-073-02621**

2-7-67  
GENE M. &  
SANDRA L.  
COKELEY  
11 AC.

2-8-27  
GENE M. & SANDRA  
L. COKELEY  
109.5 AC.

2-7-66  
CYNTHIA  
MARIE HICKS  
26.7 AC.

P/O 2-7-55  
TIMOTHY G.  
BRAMMER, SR.  
43.12 AC.

2-7-72  
GENE M. &  
SANDRA L.  
COKELEY  
9.36 AC.



12 Vanhorn Drive | P.O. Box 150 | Glenville, WV 26351 | 304.462.5634  
1412 Kanawha Boulevard, East | Charleston, WV 25301 | 304.346.3952  
254 East Beckley Bypass | Beckley, WV 25801 | 304.255.5296  
slswv.com

RECEIVED  
Office of Oil and Gas  
JUN 16 2023  
HORSENECK RUN  
WV Department of  
Environmental Protection

**LEGEND**

- LEASE LINE
  - SURFACE LINE
  - TIE LINE
  - CREEK
  - ROAD
  - COUNTY ROUTE
  - PROPOSED WELL
  - EXISTING WELL
  - PERMITTED WELL
- DISTRICT-TAXMAP-PARCEL 00-00-00

**NOTES ON SURVEY**

1. WELL SPOT CIRCLE & TOPO MARK SCALE IS 1"=2000'.

I THE UNDERSIGNED, HEREBY CERTIFY THAT THIS PLAT IS CORRECT TO THE BEST OF MY KNOWLEDGE AND BELIEF AND SHOWS ALL THE INFORMATION REQUIRED BY LAW AND THE REGULATIONS ISSUED AND PRESCRIBED BY THE DIVISION OF ENVIRONMENTAL PROTECTION.

P.S.  
677

*Gregory A. Smith*

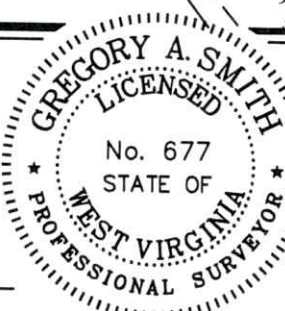

(+) DENOTES LOCATION OF WELL ON UNITED STATES TOPOGRAPHIC MAPS.

DATE APRIL 10, 2023

REVISED \_\_\_\_\_, 20\_\_\_\_

OPERATORS WELL NO. 470730000J

API WELL NO. 47 - 073 - 02621-P  
STATE COUNTY PERMIT

MINIMUM DEGREE OF ACCURACY 1/200

FILE NO. 9378-SURV-4708502621-MT-R00-230417.dwg

HORIZONTAL & VERTICAL CONTROL DETERMINED BY DGPS (SUBMETER MAPPING GRADE TIE TO CORS NETWORK) SCALE 1" = 500'

STATE OF WEST VIRGINIA  
DIVISION OF ENVIRONMENTAL PROTECTION  
OFFICE OF OIL AND GAS



WELL TYPE: OIL  GAS  LIQUID INJECTION \_\_\_\_\_ WASTE DISPOSAL \_\_\_\_\_ IF "GAS" PRODUCTION \_\_\_\_\_ STORAGE \_\_\_\_\_ DEEP \_\_\_\_\_ SHALLOW

LOCATION: ELEVATION 770' WATERSHED HORSENECK RUN OF BULL CREEK

DISTRICT GRANT COUNTY PLEASANTS QUADRANGLE WILLOW ISLAND 7.5'

SURFACE OWNER TIMOTHY G. BRAMMER SR. ACREAGE 43.118±

ROYALTY OWNER TIMOTHY G. BRAMMER SR. ACREAGE 43.06

PROPOSED WORK: LEASE NO. \_\_\_\_\_

DRILL \_\_\_\_\_ CONVERT \_\_\_\_\_ DRILL DEEPER \_\_\_\_\_ REDRILL \_\_\_\_\_ FRACTURE OR STIMULATE \_\_\_\_\_ PLUG OFF OLD FORMATION \_\_\_\_\_ PERFORATE NEW FORMATION \_\_\_\_\_ PLUG AND ABANDON  CLEAN OUT AND REPLUG \_\_\_\_\_ OTHER \_\_\_\_\_

PHYSICAL CHANGE IN WELL (SPECIFY) \_\_\_\_\_ TARGET FORMATION UNKNOWN

ESTIMATED DEPTH UNKNOWN

WELL OPERATOR UNKNOWN WVDEP PAID PLUGGING CONTRACT DESIGNATED AGENT JASON HARMON, WVDEP

ADDRESS 601 57TH STREET ADDRESS 601 57TH STREET

CHARLESTON, WV 25304 (WVDEP) CHARLESTON, WV 25304

COUNTY NAME PERMIT