

J.R. Locka

# 8	2.27	S	# 7	1.92	S
	0.66	W		0.63	W
# 9	2.27	S	# 2	1.83	S
	0.58	W		0.42	W
# 5	1.84	S	# 3	1.79	S
	0.55	W		0.46	W
# 6	1.91	S	# 4	1.78	S
	0.57	W		0.53	W
			# 1	1.82	S
				0.36	W

- New Location
- Drill Deeper
- Abandonment

Company Pierson Smith & Co.

Address R.F.D. near Walker WVA.

Farm T.E. Fleming

Tract \_\_\_\_\_ Acres 87.6 Lease No. \_\_\_\_\_

Well (Farm) No. 1 to 9 Serial No. \_\_\_\_\_

Elevation (Spirit Level) 885 895 910 942 925 1000 960 725

Quadrangle St Marys 9  
785

County Pleasants District Lafayette

Engineer J.E. Anderson

Engineer's Registration No. Wood Co. Surveyor

File No. \_\_\_\_\_ Drawing No. \_\_\_\_\_

Date 1-6-1942 Scale 1 in = 20 P

STATE OF WEST VIRGINIA 189-A-#6  
 DEPARTMENT OF MINES 190-A-#7  
 OIL AND GAS DIVISION 200-A-#2  
 CHARLESTON 201-A-#3  
 202-A-#4  
 203-A-#1

WELL LOCATION MAP  
 FILE NO. PLEAS-182-A-#8  
PLEAS-183-A-#9  
PLEAS-188-A-#5

+ Denotes location of well on United States Topographic Maps, scale 1 to 62,500, latitude and longitude lines being represented by border lines as shown.

- Denotes one inch spaces on border line of original tracing.

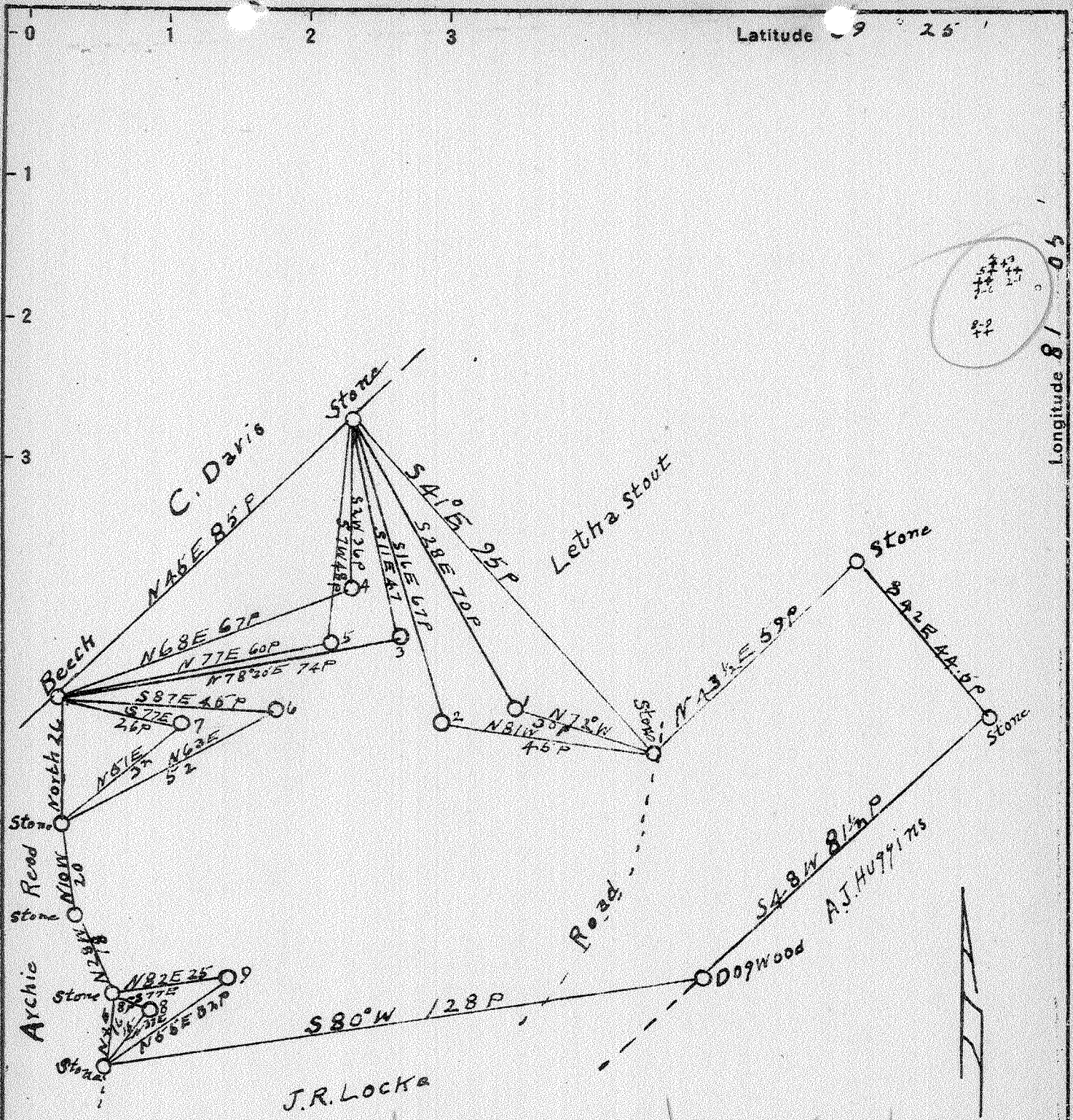

#1	0.35 W 1.83 Q	#4	0.5 W 1.8 Q	#7	0.64 W 1.93 Q
#2	0.42 W 1.83 Q	#5	0.53 W 1.86 Q	#8	0.65 W 2.31 Q
#3	0.44 W 1.86 Q	#6	0.57 W 1.92 Q	#9	0.59 W 2.3 Q

New Location   
 Drill Deeper   
 Abandonment

Company Piersol Smith & Coos  
 Address RFD, non Walker WVA.  
 Farm T.E. Fleming  
 Tract \_\_\_\_\_ Acres 87.6 Lease No. \_\_\_\_\_  
 Well (Farm) No. 1 to 9 Serial No. \_\_\_\_\_  
 Elevation (Spirit Level) 885 895 910 942 925 1000 950 725  
 Quadrangle St Marys  
 County Pleasants District Lafayette  
 Engineer J.E. Anderson  
 Engineer's Registration No. Wood Co. Surveyor  
 File No. \_\_\_\_\_ Drawing No. \_\_\_\_\_  
 Date 1-6-1942 Scale 1 in = 20 P

STATE OF WEST VIRGINIA  
 DEPARTMENT OF MINES  
 OIL AND GAS DIVISION  
 CHARLESTON

**WELL LOCATION MAP**

FILE NO. PLEAS-182-A-#8  
PLEAS-183-A-#9  
PLEAS-188-A-#5

+ Denotes location of well on United States Topographic Maps, scale 1 to 62,500, latitude and longitude lines being represented by border lines as shown.

- Denotes one inch spaces on border line of original tracing.

189A

Lafayette District, Pleasants County, W. Va.  
 By Piersol, Smith & Coss, R. D. No. 2, Walker, W. Va.  
 Abandoned under permit Pleas-.....-A?  
 On 57.5 acres, on Shamce Run.  
 Elevation, 1000' l.  
 Surface owned by T. E. Fleming, St. Marys, W. Va., R. D. No. 3E,  
 and minerals by Julia E. Rice, Adm., Sistersville, W. Va.  
 Drilling commenced about 1901.  
 8" casing, 250'; 6 $\frac{1}{2}$ " 940'; all left in.  
 Abandonment reported to Dept. of Mines Feb. 21, 1942.  
 Record to RGT from Mrs. Griffith May 22, 1942. Old file No. 96.

	Top.	Bottom.
Clay and red rock	0 -	800
Cave	800 -	950
Slate--shale	950 -	1000
Sand	1000 -	1015
Total depth		1015

STATE OF WEST VIRGINIA  
DEPARTMENT OF MINES  
OIL AND GAS DIVISION

(L100)

96

See Plot 200  
PLEAS-189-A

WELL RECORD

Permit No. ....

Oil or Gas Well.....  
(KIND)

Company Piersol, Smith & Coss  
 Address R. D. #2, Walker, W. VA.  
 Farm T. E. Fleming Acres 87.5  
 Location (waters) Shawnee Run  
 Well No. 6 Elev. 1000'  
 District Lafayette County Pleasants  
 The surface of tract is owned in fee by T. E. Fleming  
 Address StMarys, R.D. 38  
 Mineral rights are owned by Andy Rice Hrs.  
Julia B. Rice Adon Address Sistersville  
 Drilling commenced about 1901  
 Drilling completed.....  
 Date shot..... Depth of shot.....  
 Open Flow /10ths Water in..... Inch  
 /10ths Merc. in..... Inch  
 Volume..... Cu. Ft.  
 Rock Pressure..... lbs..... hrs.  
 Oil..... bbls., 1st 24 hrs.  
 Fresh water..... feet..... feet  
 Salt water..... feet..... feet

Casing and Tubing	Used in Drilling	Left in Well	Packers
Size			
16.....			Kind of Packer.....
13.....			
10.....			Size of.....
8 1/4.....	250	250	
6 1/4.....	940	940	Depth set.....
5 3/16.....			
3.....			Perf. top.....
2.....			Perf. bottom.....
Liners Used.....			Perf. top.....
			Perf. bottom.....

CASING CEMENTED..... SIZE..... No. Ft..... Date.....  
 COAL WAS ENCOUNTERED AT..... FEET..... INCHES  
 FEET..... INCHES..... FEET..... INCHES  
 FEET..... INCHES..... FEET..... INCHES

Formation	Color	Hard or Soft	Top	Bottom	Oil, Gas or Water	Depth Found	Remarks
Clay &	Red Rock		0000	800'			
Cave			800	950			
Slate-	shale		950	1000			
Sand			1000	1015	Bottom of hole		



Formation	Color	Hard or Soft	Top	Bottom	Oil, Gas or Water	Depth Found	Remarks
			1000	1018	Bottom of hole		
			890	1000			
			800	890			
			0000	800			



Form No. \_\_\_\_\_ Date 2 21, 1942  
 APPROVED Piersol Smith & Co., Owner  
 By E. R. Piersol (Title)  
 U.S. GEOLOGICAL SURVEY DEPARTMENT OF THE INTERIOR  
 BUREAU OF MINERAL INVESTIGATION  
 WASHINGTON, D. C.