

Latitude 39° 25'

3.61 mi. S  
1.33 mi. W

Longitude 81° 15'

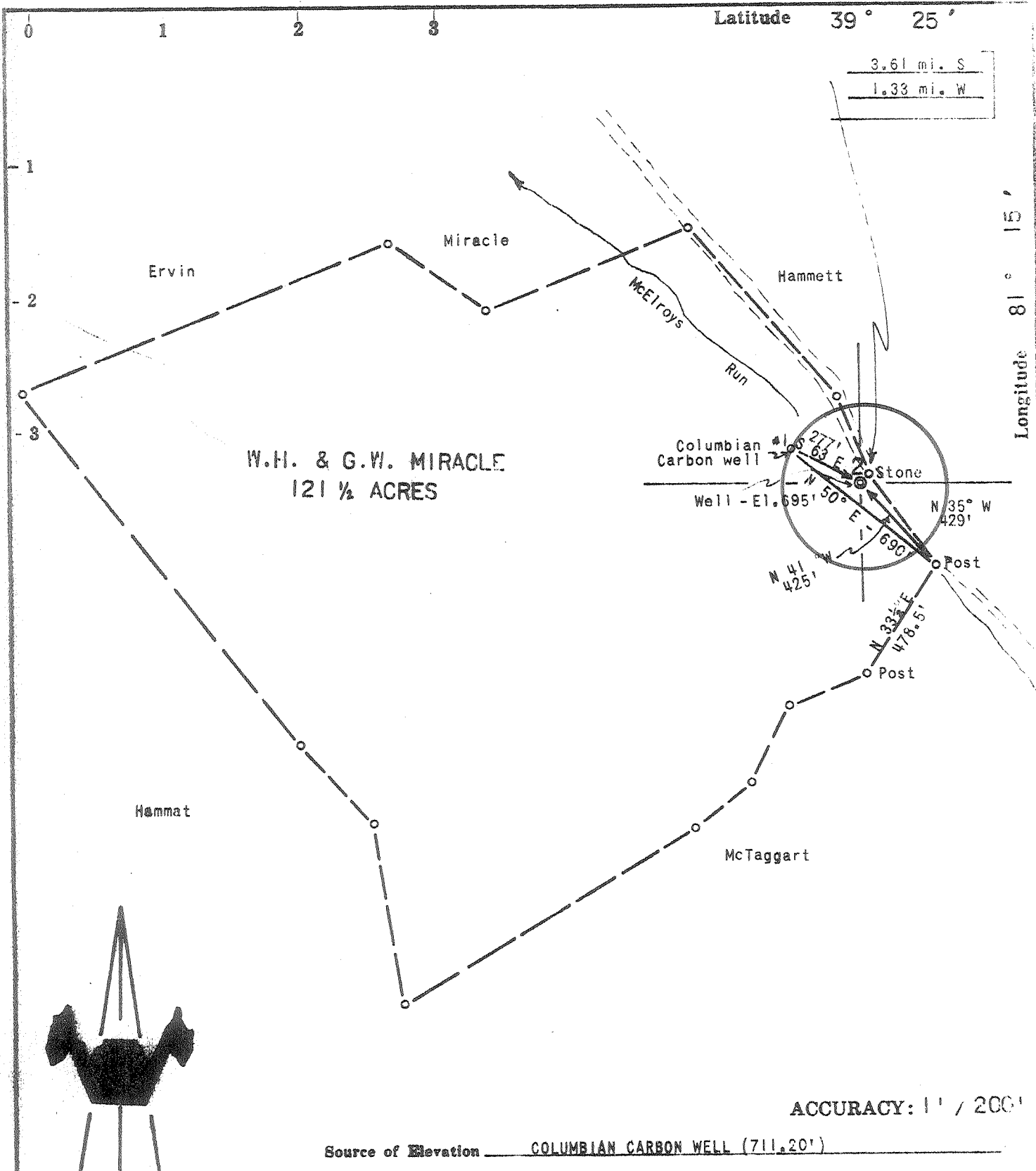

ACCURACY: 1" / 200'

Source of Elevation COLUMBIAN CARBON WELL (711.20')

- New Location
- Drill Deeper
- Abandonment
- Fracture
- Redrill

7-10-73

I, the undersigned, hereby certify that this map is correct to the best of my knowledge and belief and shows all the information required by paragraph 6 of the rules and regulations of the oil and gas section of the mining laws of West Virginia.

*Chet Waterman*

FOR: W. VA. DEPARTMENT OF MINES  
 Company OIL & GAS DIVISION  
 Address 1204 KANAWHA BOULEVARD, EAST  
 CHARLESTON, WEST VIRGINIA 25301  
 Farm W.H. & G.W. MIRACLE  
 Tract \_\_\_\_\_ Acres 121 1/2 Lease No. \_\_\_\_\_  
 Well (Farm) No. 2 Serial No. \_\_\_\_\_  
 Elevation (Spirit Level) 695'  
 Quadrangle MARIETTA EC  
 County PLEASANTS District GRANT  
 Engineer CHET WATERMAN  
 Engineer's Registration No. 3788  
 File No. 73003-183 Drawing No. \_\_\_\_\_  
 Date 5/9/73 Scale 1" = 500'

Pursley's Pulling  
& Well Service  
Box 51  
Leary, W. Va.

STATE OF WEST VIRGINIA  
DEPARTMENT OF MINES  
OIL AND GAS DIVISION  
CHARLESTON

WELL LOCATION MAP  
FILE NO. Pleas-1095 (A)

+ Denotes location of well on United States Topographic Maps, scale 1 to 62,500, latitude and longitude lines being represented by border lines as shown.

— Denotes one inch spaces on border line of original tracing.

47-073

STATE OF WEST VIRGINIA  
DEPARTMENT OF MINES  
OIL AND GAS WELLS DIVISION

**AFFIDAVIT OF PLUGGING AND FILLING WELL**

AFFIDAVIT SHOULD BE MADE IN TRIPLICATE. ONE COPY MAILED TO THE DEPARTMENT, ONE COPY TO BE RETAINED BY THE WELL OPERATOR AND THE THIRD COPY (AND EXTRA COPIES IF REQUIRED) SHOULD BE MAILED TO EACH COAL OPERATOR AT THEIR RESPECTIVE ADDRESSES.

None	A.A. Pursley dba: Pursley's Pulling & Well Service
COAL OPERATOR OR OWNER	NAME OF WELL OPERATOR
ADDRESS	Box 51, Leroy, West Virginia 25252
COAL OPERATOR OR OWNER	COMPLETE ADDRESS
ADDRESS	August 28 19 73
LEASE OR PROPERTY OWNER	WELL AND LOCATION
ADDRESS	Grant District
	Pleasants County
	Well No. Two
	W.H. & G.W. Miracle Farm

STATE INSPECTOR SUPERVISING PLUGGING: Paul Garrett, 321 Beech St. Clarksburg, W.V. 26301

**AFFIDAVIT**

STATE OF WEST VIRGINIA, }  
County of Jackson } ss:

Eugene Pursley and A.A. Pursley  
being first duly sworn according to law depose and say that they are experienced in the work of plugging and filling oil and gas wells and were employed by Pursleys Pulling & Well Service, well operator, and participated in the work of plugging and filling the above well, that said work was commenced on the 7 day of August, 19 73, and that the well was plugged and filled in the following manner:

SAND OR ZONE RECORD FORMATION	FILLING MATERIAL	PLUGS USED SIZE & KIND	CASING	
			CSG PULLED	CSG LEFT IN
	Cement & 6% Bentonite Gel			
	Cement 075'-575'	6 1/2"	152'	
	Gel 575-150'	8 5/8"	149'	
	Cement 150' to surface	10"	20'	
COAL SEAMS				
(NAME)			DESCRIPTION OF MONUMENT	
(NAME)			Erected Marker as prescribed by	
(NAME)			Oil & Gas Division	
(NAME)				

and that the work of plugging and filling said well was completed on the 20th day of August, 19 73

And further deponents saith not.

Sworn to and subscribed before me this 28 day of August, 19 73.

My commission expires:  
March 22 1980

Eugene Pursley  
A.A. Pursley  
Paul Pursley  
Notary Public.

Permit No. Pleas-1095 A.C. NO.