

REFERENCE POINTS

6° SASSAFRAS  
 100.6' @ N85E Δ Pct  
 S1.0  
 SAPP UNIT No 5

4,550'  
 LATITUDE 39° 27' 30"

*Janice*  
 10/7/96

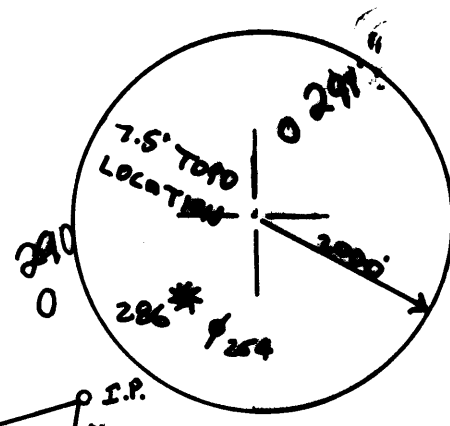

Sapp etals  
 34.24 Ac.

Sapp etals.  
 70.45 Ac.

G Sapp etals  
 61.62 Ac.

SAPP UNIT #5

GEORGE BUCKLEW  
 Fullmer Lease  
 121.5 Ac.

NORTH

LONGITUDE 79° 05' 00"

(+) DENOTES LOCATION OF WELL ON UNITED STATES TOPOGRAPHIC MAPS

FILE NO. 96005  
 DRAWING NO. 96005  
 SCALE 1" = 600'  
 MINIMUM DEGREE OF ACCURACY 1:200  
 PROVEN SOURCE OF ELEVATION Existing Well #206 Southwest of Lees Ferry

I THE UNDERSIGNED, HEREBY CERTIFY THAT THIS PLAT IS CORRECT TO THE BEST OF MY KNOWLEDGE AND BELIEF AND SHOWS ALL THE INFORMATION REQUIRED BY LAW AND THE REGULATIONS ISSUED AND PRESCRIBED BY THE DEPARTMENT OF ENERGY.  
 (SIGNED) *Mark C. Shambelin*  
 R.P.E. \_\_\_\_\_ L.L.S. 827

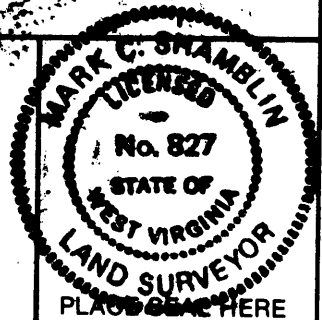

STATE OF WEST VIRGINIA  
 DEPARTMENT OF ENERGY  
 OIL AND GAS DIVISION



DATE Sept 26, 191996  
 OPERATOR'S WELL NO. SAPP UNIT #5  
 API WELL NO. 47 077 00307

WELL TYPE: OIL \_\_\_ GAS X LIQUID INJECTION \_\_\_ WASTE DISPOSAL \_\_\_  
 (IF "GAS,") PRODUCTION \_\_\_ STORAGE \_\_\_ DEEP \_\_\_ SHALLOW X

LOCATION: ELEVATION 1797 WATER SHED Tree Fork Creek  
 DISTRICT Lyons COUNTY Preston

QUADRANGLE New BURG (7.5')  
 SURFACE OWNER Gladys Sapp etals ACREAGE 61.62  
 OIL & GAS ROYALTY OWNER Gladys Sapp etals LEASE ACREAGE 280  
 LEASE NO. \_\_\_\_\_

PROPOSED WORK: DRILL X CONVERT \_\_\_ DRILL DEEPER \_\_\_ REDRILL \_\_\_ FRACTURE OR STIMULATE X PLUG OFF OLD FORMATION \_\_\_ PERFORATE NEW FORMATION \_\_\_ OTHER PHYSICAL CHANGE IN WELL (SPECIFY) 6-6 373

PLUG AND ABANDON \_\_\_ CLEAN OUT AND REPLUG \_\_\_  
 TARGET FORMATION FOURTH SAND ESTIMATED DEPTH 2600'  
 WELL OPERATOR LORAY OPERATING Co. DESIGNATED AGENT OLIN SHOKEY  
 ADDRESS State Rt 85 YATESBORO, PA ADDRESS Rt 1 Box 139B RAVENSWOOD, WV 26164

FORM WW-6  
 HALLS INC. 068065

COUNTY NAME  
 PERMIT

WR-35

RECEIVED  
WV Division of  
Environmental Protection

Date 04/02/97  
API # 47-077-00307

APR 07 1997  
Permitting  
Office of Oil & Gas

State of West Virginia  
Division of Environmental Protection  
Section of Oil and Gas

Well Operator's Report of Well Work

Farm Name: Sapp Unit Operator Well No.: 5  
 Location: Elevation: 1797 Quadrangle: Newburg  
 District: Lyons County: Preston  
 Latitude: 4550 Feet South of Deg: 39 Min: 27 Sec: 30  
 Longitude: 3500 Feet West of Deg: 79 Min: 50 Sec: 00

Company: Lomak Operating Company  
 P O Box 235  
 Yatesboro, PA 16263

Agent: Olin Shockey

Inspector: Phillip Tracy  
 Permit Issued: 10/07/96  
 Well Work Commenced: 12/7/96  
 Well Work Completed: 12/13/96  
 Verbal Plugging  
 Permission granted on:  
 Rotary  Cable  Rig  
 Total Depth (feet) 2456  
 Fresh water depths (ft)  
 Salt water depths (ft)  
 Is coal being mined in area (Y/N)?  
 Coal Depths (ft):

Casing & Tubing	Grade & Weight	Used in Drilling	Left in Well	Cement Fill Up Cu. Ft.
7"	H-40 17#		1224.35	175 sacks
4-1/2"	J-55 10.5 & 11.6#		2394.8	170 sacks
1-1/2"	CW-42 2.75#		2310	

OPEN FLOW DATA

Producing formation Fourth Sand Pay zone depth (ft) \_\_\_\_\_  
 Gas: Initial open flow \_\_\_\_\_ Mcf/day Oil: Initial open flow \_\_\_\_\_ Bbl/day  
 Final open flow 75 Mcf/day Oil: Final open flow \_\_\_\_\_ Bbl/day  
 Time of open flow between initial and final tests \_\_\_\_\_ Hours  
 Static Rock Pressure 600 psig (surface pressure) after 72 Hours

Second producing formation \_\_\_\_\_ Pay zone depth (ft) \_\_\_\_\_  
 Gas: Initial open flow \_\_\_\_\_ Mcf/day Oil: Initial open flow \_\_\_\_\_ Bbl/day  
 Final open flow \_\_\_\_\_ Mcf/day Oil: Final open flow \_\_\_\_\_ Bbl/day  
 Time of open flow between initial and final tests \_\_\_\_\_ Hours  
 Static Rock Pressure \_\_\_\_\_ psig (surface pressure) after \_\_\_\_\_ Hours

NOTE: ON BACK OF THIS FORM PUT THE FOLLOWING: 1). DETAILS OF PERFORATED INTERVALS, FRACTURING OR STIMULATING, PHYSICAL CHANGE, ETC. 2). THE WELL LOG WHICH IS A SYSTEMATIC DETAILED GEOLOGICAL RECORD OF ALL FORMATIONS, INCLUDING COAL ENCOUNTERED BY THE WELLBORE.

Stephen P. Rupert  
FOR: LOMAK OPERATING COMPANY

By:   
Date: April 3, 1997

APR 3 1997

**Sapp Unit #5**

Perforated Fourth SS with 20 shots from 2,288' to 2,300'. Broke down formation at 2,218 psi  
Treated with 328 barrels of fluid and 36,910 lbs. of 20/40 sand.

	Top	Bottom
Sand and Shale	0	1,250
Big Lime	1,250	1,434
Shale	1,434	1,520
Upper Weir	1,520	1,575
Shale	1,575	1,588
Lower Weir	1,588	1,621
Shale	1,621	1,734
Berea	1,734	1,763
Shale	1,763	1,780
Middle Gantz	1,780	1,810
Shale, Sand	1,810	2,280
Upper Fourth	2,280	2,314
Shale	2,314	T.D.

STATE OF WEST VIRGINIA  
DIVISION OF ENVIRONMENTAL PROTECTION, OFFICE OF OIL AND GAS  
WELL WORK PERMIT APPLICATION

22680

Well Operator: <sup>5694</sup> Lomak Operating Company 302 75 (3) 507

Operator's Well Number: SAPP UNIT #5 3) Elevation: 1797

Well type: (a) Oil\_\_\_/ or Gas<sup>X</sup>/ *Issued 10/07/96*  
*Expires 10/07/98*  
(b) If Gas: Production\_\_\_/ Underground Storage\_\_\_/  
Deep\_\_\_/ Shallow<sup>X</sup>/

5) Proposed Target Formation(s): Fourth Sand

6) Proposed Total Depth: 2600 feet

7) Approximate fresh water strata depths: N/A

8) Approximate salt water depths: None

9) Approximate coal seam depths: 407-410, 607-610, 797-800

10) Does land contain coal seams tributary to active mine? Yes\_\_\_/ No<sup>X</sup>/

11) Proposed Well Work: Drill & Stimulate New Well.

12)

RECEIVED  
WV Division of  
Environmental Protection  
OCT 04 1996

Permitting  
Office of Oil & Gas

CASING AND TUBING PROGRAM

TYPE	SPECIFICATIONS		FOOTAGE INTERVALS		CEMENT	
	Size	Grade	Weight per ft.	For drilling		Left in well
Conductor						
Fresh Water <sup>ps</sup>	7"				1,227' <sup>US</sup>	38 csr 18-11.3 38 csr 18-11.2 .2
Coal						
Intermediate						
Production	4-1/2"				2,407'	38 csr 18-11.1
Tubing						
Liners						

PACKERS : Kind None  
Sizes \_\_\_\_\_  
Depths set \_\_\_\_\_

For Office of Oil and Gas Use Only

100/2  
Fee(s) paid:  Well Work Permit  Reclamation Fund  WPCP  
 Plat  WW-9  WW-2B  Bond Blanket Agent  
(Type)

OCT 04 1996

Permitting  
Office of Oil & Gas

- 1) Date: \_\_\_\_\_
- 2) Operator's well number  
Sapp Unit #5 \_\_\_\_\_
- 3) API Well No: 47 - 077 - 0307  
State County Permit

STATE OF WEST VIRGINIA - BUREAU OF ENVIRONMENT  
DIVISION OF ENVIRONMENTAL PROTECTION  
OFFICE OF OIL AND GAS

NOTICE AND APPLICATION FOR A WELL WORK PERMIT

- 4) Surface Owner(s) to be served:
  - (a) Name Gladys L Sapp  
Address Route 1, Box 67  
Independence, WV 26374
  - (b) Name \_\_\_\_\_  
Address \_\_\_\_\_
  - (c) Name \_\_\_\_\_  
Address \_\_\_\_\_
- 5) (a) Coal Operator:
  - Name \_\_\_\_\_  
Address \_\_\_\_\_
  - (b) Coal Owner(s) with Declaration  
Name \_\_\_\_\_  
Address \_\_\_\_\_
  - (c) Coal Lessee with Declaration  
Name \_\_\_\_\_  
Address \_\_\_\_\_
- 6) Inspector Phillip Tracy  
Address Route 2, Box 37-A  
Montrose, WV 26283  
Telephone (304)- 636-8798

TO THE PERSON(S) NAMED ABOVE TAKE NOTICE THAT:

\_\_\_\_\_ Included is the lease or leases or other continuing contract or contracts by which I hold the right to extract oil and gas OR

X Included is the information required by Chapter 22, Article 6, Section 8(d) of the Code of West Virginia (see page 2)

I certify that as required under Chapter 22 of the West Virginia Code I have served copies of this notice and application, a location plat, and accompanying documents pages 1 through \_\_\_\_\_ on the above named parties, by:

- X Personal Service (Affidavit attached)
- \_\_\_\_\_ Certified Mail (Postmarked postal receipt attached)
- \_\_\_\_\_ Publication (Notice of Publication attached)

I have read and understand Chapter 22-6 and 38 CSR 11-18, and I agree to the terms and conditions of any permit issued under this application.

I certify under penalty of law that I have personally examined and am familiar with the information submitted on this application form and all attachments, and that based on my inquiry of those individuals immediately responsible for obtaining the information, I believe that the information is true, accurate, and complete.

I am aware that there are significant penalties for submitting false information, including the possibility of fine and imprisonment.

Well Operator Lomak Operating Company  
 By: [Signature]  
 Its: Attorney in Fact  
 Address P O Box 235  
Yatesboro, PA 16263  
 Telephone 412-783-7144

Subscribed and sworn before me this 30<sup>th</sup> day of October, 19 96

My commission expires \_\_\_\_\_  
[Signature] Notary Public

