

New Location
 Drill Deeper
 Abandonment
 issued 6-4-70

Company CABOT CORP.
Goodfrey L. Cabot Inc.
 Address Box 1473 Charleston W. Va.
 Farm Raymond City Coal & Transp. Corp.
 Tract _____ Acres 230 Lease No. 3-1063
 Well (Farm) No. 4 Serial No. 1450
 Elevation (Spirit Level) 955.3
 Quadrangle St. Albans NE
 County Putnam District Pocatalico
 Engineer H. J. Simmons Jr
 Engineer's Registration No. 1632
 File No. _____ Drawing No. _____
 Date 12-8-55 Scale 1" = 1320'

STATE OF WEST VIRGINIA
 DEPARTMENT OF MINES
 OIL AND GAS DIVISION
 CHARLESTON

WELL LOCATION MAP
 FILE NO. Put-591-P

+ Denotes location of well on United States Topographic Maps, scale 1 to 62,500, latitude and longitude lines being represented by border lines as shown.
 - Denotes one inch spaces on border line of original tracing.

6-6-70 Deep Well

P

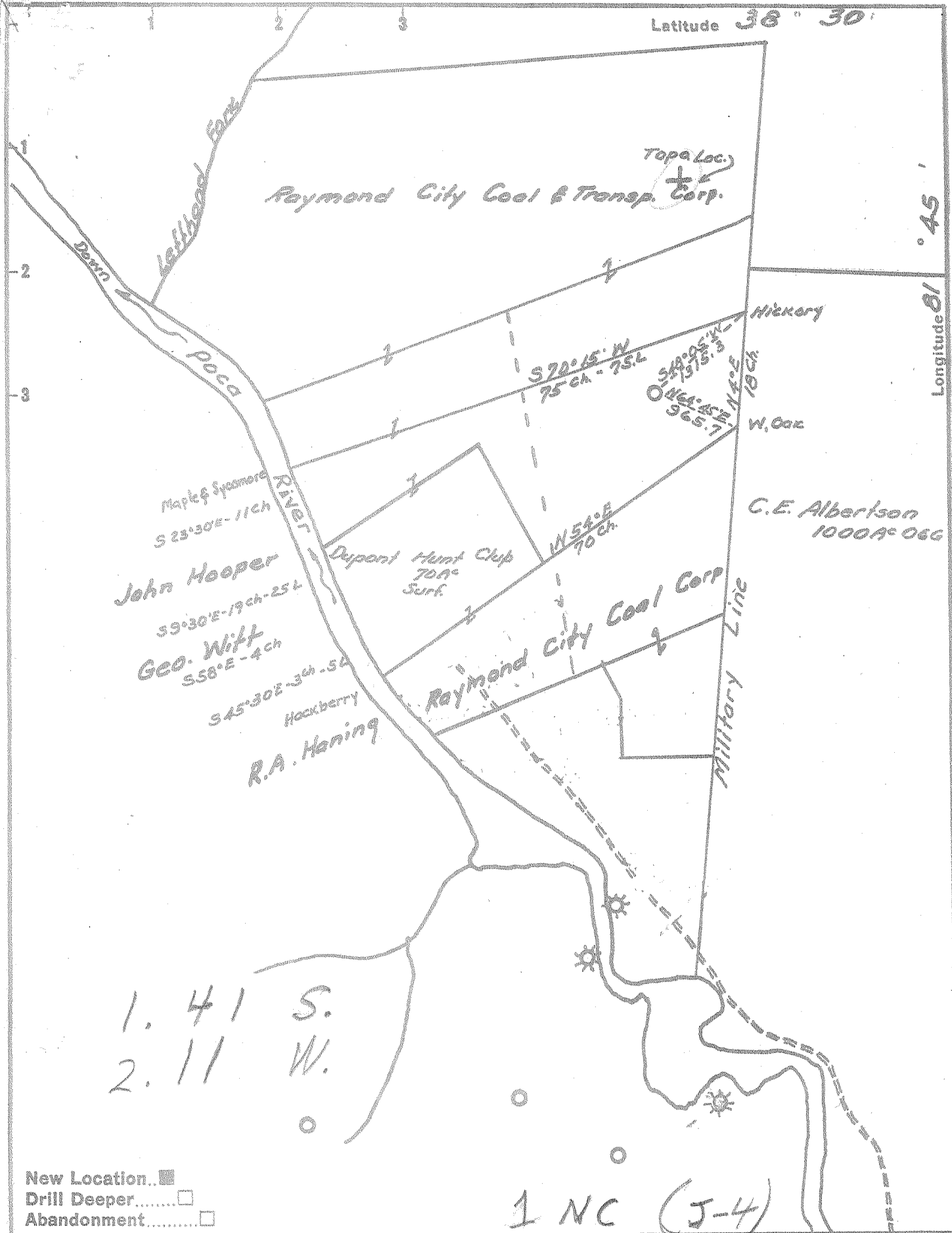

New Location...
 Drill Deeper.....
 Abandonment.....

1. 41 S.
 2. 11 W.

1 NC (J-4)

Company Godfrey L. Cabot Inc.
 Address Box 1473 Charleston W. Va.
 Farm Raymond City Coal & Transp. Corp.
 Tract _____ Acres 230 Lease No. 3-1063
 Well (Farm) No. 4 Serial No. 1450
 Elevation (Spirit Level) 955.3
 Quadrangle St. Albans - NE
 County Putnam District Pocatalico
 Engineer H. J. Simmons Jr
 Engineer's Registration No. 1652
 File No. _____ Drawing No. _____
 Date 12-8-55 Scale 1" = 1320'

STATE OF WEST VIRGINIA
 DEPARTMENT OF MINES
 OIL AND GAS DIVISION
 CHARLESTON

WELL LOCATION MAP
 FILE NO. Put-591

+ Denotes location of well on United States Topographic Maps, scale 1 to 62,500, latitude and longitude lines being represented by border lines as shown.
 - Denotes one inch spaces on border line of original tracing.

Deep Well



STATE OF WEST VIRGINIA
DEPARTMENT OF MINES
OIL AND GAS DIVISION 2

Quadrangle St. Albans

WELL RECORD

Permit No. PUT-591

Oil or Gas Well GAS
(KIND)

Company Godfrey L. Cabot, Inc.
Address Charleston, W. Va.
Farm Raymond City Coal & Trans. Acres 230
Location (waters) _____
Well No. 4 Elev. 955
District Pocatalico County Putnam
The surface of tract is owned in fee by _____
Address _____
Mineral rights are owned by Raymond City Coal & Trans. Co.
Address Cedar Grove, W. Va.
Drilling commenced April 27, 1956
Drilling completed July 27, 1956
Date Shot _____ From _____ To _____
With _____
Open Flow _____ /10ths Water in _____ Inch
_____ /10ths Merc. in _____ Inch
Volume 455 M (Big Lime & Orisk.) when turned on. Ft.
Rock Pressure in line. Not taken. hrs.
Oil _____ bbls., 1st 24 hrs.
Fresh water 217 feet 997, 1525 feet
Salt water _____ feet _____ feet

Casing and Tubing	Used in Drilling	Left in Well	Packers
Size			
16			Kind of Packer _____
13			
10			Size of _____
8 1/4			
8 3/16			Depth set _____
8			Perf. top _____
2			Perf. bottom _____
Liners Used			Perf. top _____
			Perf. bottom _____

CASING CEMENTED _____ SIZE _____ No. Ft. _____ Date _____
COAL WAS ENCOUNTERED AT 242 FEET 72 INCHES
_____ FEET _____ INCHES FEET _____ INCHES
_____ FEET _____ INCHES FEET _____ INCHES

Formation	Color	Hard or Soft	Top	Bottom	Oil, Gas or Water	Depth Found	Remarks
Red Rock			0	70			
Slate			70	109			
Red Rock			109	119			
Slate & Shell			119	242			Lost water @ 217.
Coal			242	248			
Red Rock			248	253	Water		Could not bail down.
Slate & Shell			253	319			
Red Rock			319	378			
Lime	Red		378	620			
Lime	Grey		620	645			
Red Rock			645	679			
Sand			679	740			
Red Rock			740	765			
Slate & Shell			765	780			
Sand			780	790			
Slate & Shells			790	920			
Sand			920	1030	Water	997	1/4 blr. /hr.
Slate & Shell			1030	1365			
Sand			1365	1405			
Lime			1405	1460			
Sand			1460	1510			
Salt Sand			1510	1755	Water	1525	Hole full.
Lime			1755	1788			
Sand			1788	1805			
Shale			1805	1820			
Lime			1820	1845			
Shale			1845	1855			
BIG LIME			1855	2043			
INJUN			2043	2095			
Lime			2095	2145			
Slate & Shell			2145	2475			
Brown Shale			2475	2500			
BEREA			2500	2515			
Slate & Shell			2515	3455	Gas	3370-80	smell.
Brown Shale			3455	3542			
Slate & Shell			3542	3719	Gas	3645-3645	smell.



Formation	Color	Hard or Soft	Top 2	Bottom	Oil, Gas or Water	Depth Found	Remarks
Brown Shale Slate & Shell			3719 3772	3772 3935	Gas	3726-3757;	332 Mcf.
Brown Shale Slate & Shell			3935 4210	4210 4565			
Brown Shale Slate & Shell			4565 4583	4583 4623			
Brown Shale CORNIFEROUS ORISKANY			4623 4860 4950	4860 4950	Gas	4956-58;	484 Mcf, decreased to 180 Mcf.
Total Depth				4962			
					NOTE:	Pin off stem at 4962, also skirt and slips from slip socket. All of above tools left in hole. Top of tools were shot with 2 qts. of glycerine in attempt to free tools; not successful. Top of tools at 4933'.	
					4860 955 ----- 3905		
					455 180 ----- 275		

Date....., 19.....

APPROVED....., Owner

By..... (Title)