

Latitude $30^{\circ} 40'$
 Accuracy 1 in 200
 Elevation Run From U.S.G.S. BM⁴H-113 Elev. 950.00

"I, the undersigned, hereby certify that this map is correct to the best of my knowledge and belief and shows all the information required by paragraph 6 of the rules and regulations of the oil and gas section of the mining laws of West Virginia."

Ray Boston

+ topo. loc.

Longitude $81^{\circ} 45'$

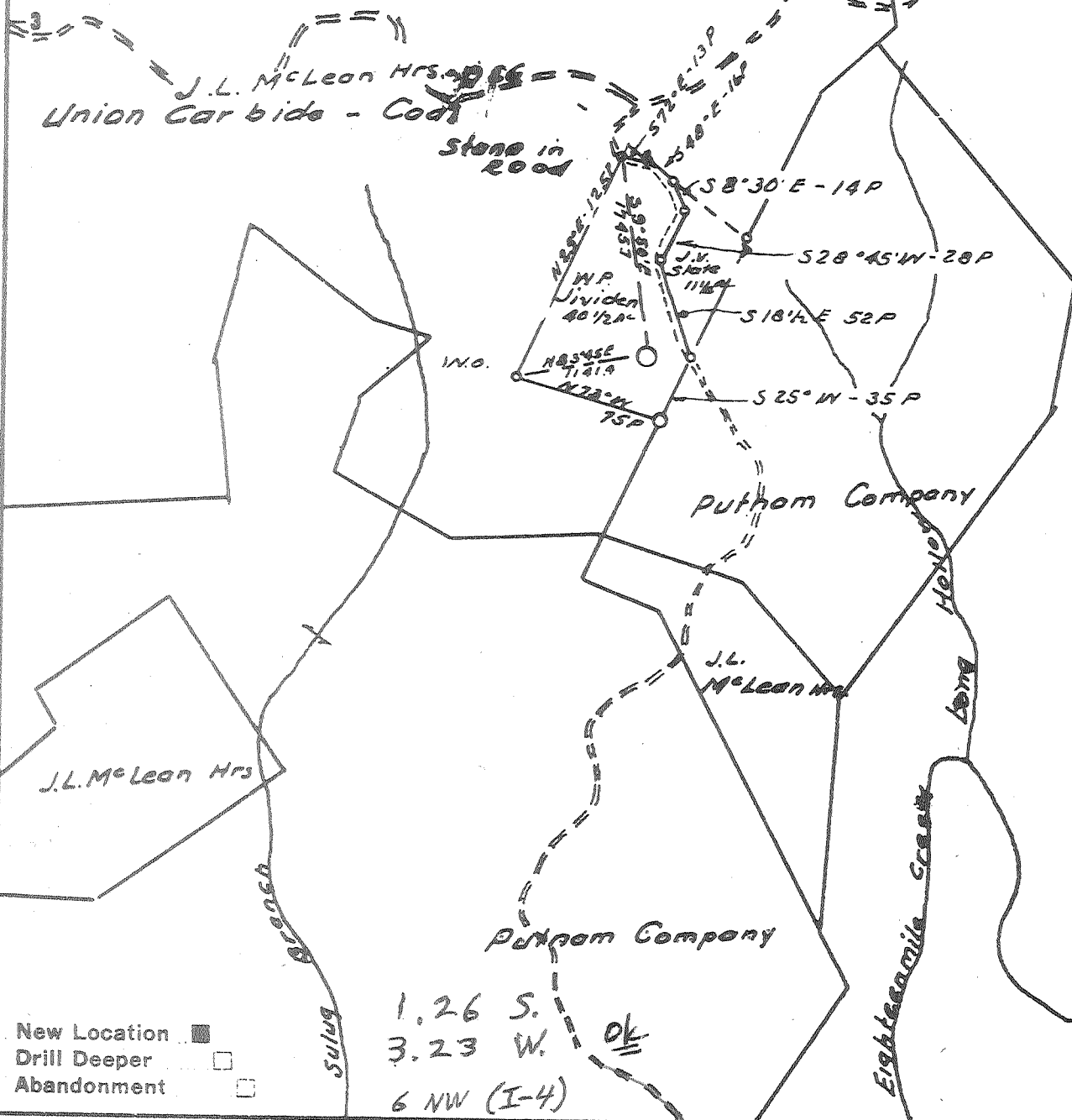

Company CABOT CORPORATION
 Address Box 1473 Charleston Wya.
 Farm W.P. Jividen et al Unit # WY 95
 Tract _____ Acres 260 Unit No. WY 95
 Well (Farm) No. 1 Serial No. 1543
 Elevation (Spirit Level) 970.48
 Quadrangle Winfield - EC
 County Putnam District Union
 Engineer Ray Boston
 Engineer's Registration No. 3204
 File No. _____ Drawing No. _____
 Date 7-12-63 Scale 1" = 1320'

STATE OF WEST VIRGINIA
 DEPARTMENT OF MINES
 OIL AND GAS DIVISION
 CHARLESTON

WELL LOCATION MAP
 FILE NO. PUT-687

+ Denotes location of well on United States Topographic Maps, scale 1 to 62,500, latitude and longitude lines being represented by border lines as shown.
 - Denotes one inch spaces on border line of original tracing.

1-0 (10) Deep Well



STATE OF WEST VIRGINIA
DEPARTMENT OF MINES
OIL AND GAS DIVISION *et*

Quadrangle Winfield

WELL RECORD

Permit No. PUT 697

Oil or Gas Well Dry Hole
(KIND)

Company Cabot Corporation
Address Box 1473, Charleston, W. Va.
Farm W. P. Jividen Acres 260
Location (waters) Eighteenmile Creek
Well No. 1, Serial 1543 Elev. 970
District Union County Putnam
The surface of tract is owned in fee by W. P. Jividen
Address Liberty, W. Va.
Mineral rights are owned by W. P. Jividen
Address Liberty, W. Va.
Drilling commenced July 31, 1963
Drilling completed August 14, 1963
Date Shot _____ From _____ To _____
With Not treated
Open Flow /10ths Water in _____ Inch
/10ths Merc. in _____ Inch
Volume DRY HOLE Cu. Ft.
Rock Pressure _____ lbs. _____ hrs.
Oil _____ bbls., 1st 24 hrs.
WELL ACIDIZED _____
WELL FRACTURED Not treated

Casing and Tubing	Used in Drilling	Left in Well	Packers
Size			
16			Kind of Packer
13	185	185	
10			Size of
8 1/4	2285		
6 3/4			Depth set
5 3/16			
3			Perf. top
2			Perf. bottom
Liners Used			Perf. top
			Perf. bottom

CASING CEMENTED 13" SIZE No. Ft. 100 bags Date _____

COAL WAS ENCOUNTERED AT None FEET _____ INCHES
_____ FEET _____ INCHES FEET _____ INCHES
_____ FEET _____ INCHES FEET _____ INCHES

RESULT AFTER TREATMENT

ROCK PRESSURE AFTER TREATMENT

Fresh Water _____ Feet Salt Water 1180, 1485 Feet

Formation	Color	Hard or Soft	Top	Bottom	Oil, Gas or Water	Depth	Remarks	
Red Rock			0	30			Drilled w/air from surface to approximately 1490'.	
Slate & Shell			30	118				
Red Rock			118	130				
Slate & Shell			130	146				
Red Rock			146	160				
Slate & Shell			160	225		Drilled w/mud to 2285'.		
Red Rock			225	240				
Shale			240	264				
Red Rock			264	282				
Shale			282	347				
Slate & Shell			347	381			Drilled w/air from 2285 to total depth	
Red Rock			381	404				
Slate & Shell			404	518				
Red Rock			518	535				
Slate & Shell			535	570				
Red Rock			570	615				
Slate & Shell			615	790				
Sand			790	835				
Siltstone & Red Rock			835	930				
Sand			930	996				
Slate & Shell			996	1175				
Sand			1175	1295	Water	1180	Salt water,	
Slate & Shell			1295	1427				
Sand			1427	1490	Water	1485		
Slate & Shell			1490	1792				
Sand			1792	1990				
BIG LINE			1990	2195				
Siltstone & Shale			2195					
DOWN			2225					
Slate & Shell			2260					

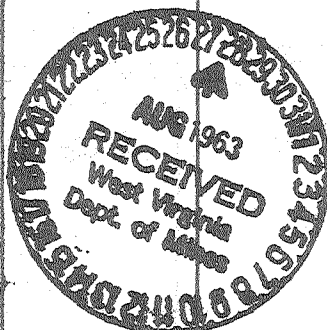

Deep Well

Formation	Color	Hard or Soft	Top	Bottom	Oil, Gas or Water	Depth Found	Remarks
SHALE			3885	4955	Gas		38 Ref
CONIFEROUS			4995	5020			
ORISKANY SAND			5020	5030			
Lime break			5030	5040			
ORISKANY			5040	5068			
Lime, dolomitic			5068	5740	Gas	56662	Show of sulphur gas
Sand (Williamson)			5740	5770			
Lime			5770	5968			
TOTAL DEPTH				5968			
				5450	4955	5020	5068
					970		
					<u>3985</u>	4050	4096
							5740
							970
							4970
					5740		
					970		
					<u>4770</u>		
						Log Well	5756-76
						Lock pt.	5844-70 (5970)

Date August 26, 1963, 19

APPROVED CABOT CORPORATION

Owner

By

Manager

(Title)

Godfrey L. Cabot Division