

New Location
 Drill Deeper
 Abandonment

Minimum Error of Closure 1 IN 200
 Source of Elevation PUT-483

"I, the undersigned, hereby certify that this map is correct to the best of my knowledge and belief and shows all the information required by paragraph 6 of the rules and regulations of the oil and gas section of the mining laws of West Virginia."

Company TEARVEE OIL & GAS, INC
 Address CHARLESTON, W.V.
 Farm ROBERT SAYRE
 Tract _____ Acres 107 Lease No. _____
 Well (Farm) No. C-22-1 Serial No. _____
 Elevation (Spirit Level) 584.5
 Quadrangle WINFIELD (15 MIN) SC
 County FUTNAM District UNION
 Engineer _____
 Engineer's Registration No. JOHN GALPIN 875
 File No. _____ Drawing No. _____
 Date DEC 1 1976 Scale 1 IN = 1000 FT

STATE OF WEST VIRGINIA
 DEPARTMENT OF MINES
 OIL AND GAS DIVISION
 CHARLESTON

WELL LOCATION MAP
FILE NO. PUT-838

+ Denotes location of well on United States Topographic Maps, scale 1 to 62,500 latitude and longitude lines being represented by border lines as shown.
 - Denotes one inch spaces on border line of original tracing.

47-079

1/14/77

Latitude 38° 35'

Longitude 81° 50'

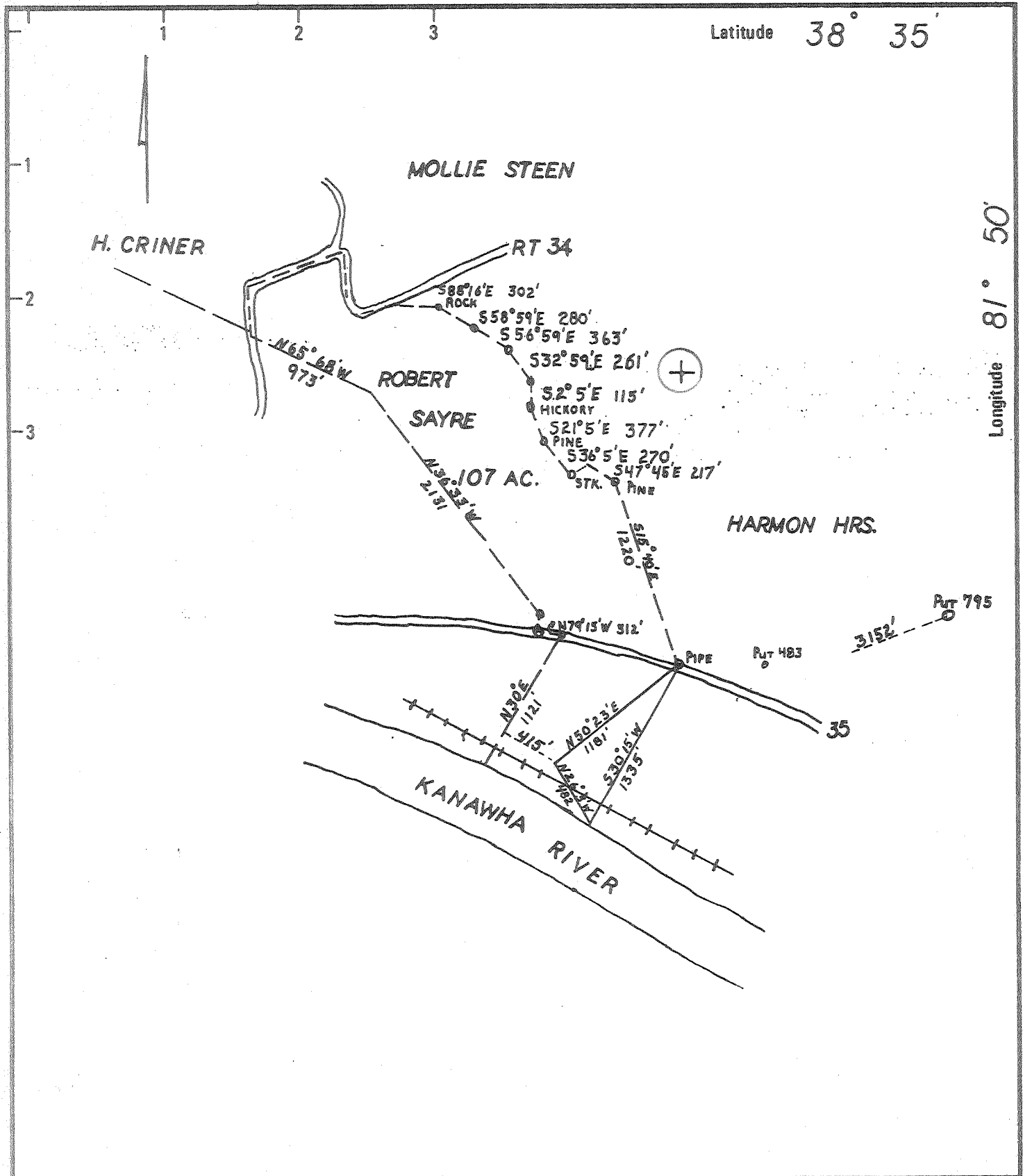

New Location
 Drill Deeper
 Abandonment

Minimum Error of Closure 1 IN 200
 Source of Elevation PUT-483
 "I, the undersigned, hereby certify that this map is correct to the best of my knowledge and belief and shows all the information required by paragraph 6 of the rules and regulations of the oil and gas section of the mining laws of West Virginia."

Company TEARVEE OIL & GAS, INC.
 Address CHARLESTON, W.V.
 Farm ROBERT SAYRE
 Tract _____ Acres 107 Lease No. _____
 Well (Farm) No. C-20-1 Serial No. _____
 Elevation (Spirit Level) 584.5
 Quadrangle WINFIELD (15 MIN) SC
 County PUTNAM District UNION
 Engineer _____
 Engineer's Registration No. 875
 File No. _____ Drawing No. _____
 Date JAN 13, 1977 Scale 1 IN = 1000 FT

STATE OF WEST VIRGINIA
 DEPARTMENT OF MINES
 OIL AND GAS DIVISION
 CHARLESTON

WELL LOCATION MAP
 FILE NO. PUT-838-DD?

+ Denotes location of well on United States Topographic Maps, scale 1 to 62,500 latitude and longitude lines being represented by border lines as shown.
 - Denotes one inch spaces on border line of original tracing.

47-079 FEB 1 1977

IV-35
(Rev 8-81)

RECEIVED
JUL 10 1985

OIL & GAS DIVISION
DEPT. OF MINES

RECEIVED
JUL 31 1985
DIVISION OF OIL & GAS
DEPARTMENT OF ENERGY
Operator's

State of West Virginia

Department of Mines
Oil and Gas Division

Well No. C-20
Farm Robert Sayre
API No. 47 - 079 - 838DR

WELL OPERATOR'S REPORT
OF
DRILLING, FRACTURING AND/OR STIMULATING, OR PHYSICAL CHANGE

they received permit to drill
deeper than indicated on original
permit, but there's
only 1 episode of
drilling, I think.

WELL TYPE: Oil ___ / Gas X / Liquid Injection ___ / Waste Disposal ___ /
(If "Gas," Production X / Underground Storage ___ / Deep X / Shallow ___ /)

LOCATION: Elevation: 584.5 Watershed Kanawha River
District: Union County Putnam Quadrangle Winfield

COMPANY Teavee Oil & Gas, Inc.
ADDRESS 1901 Kanawha Valley Bldg. Charleston, WV
DESIGNATED AGENT D. K. Bowers
ADDRESS same as above
SURFACE OWNER Robert Sayre
ADDRESS Red House, WV
MINERAL RIGHTS OWNER Robert Sayre
ADDRESS Red House, WV
OIL AND GAS INSPECTOR FOR THIS WORK
C. Hively ADDRESS Elkview, WV
PERMIT ISSUED 1/14/77 ✓
DRILLING COMMENCED 2/06/77
DRILLING COMPLETED 2/14/77 ✓
IF APPLICABLE: PLUGGING OF DRY HOLE ON
CONTINUOUS PROGRESSION FROM DRILLING OR
REWORKING. VERBAL PERMISSION OBTAINED
ON _____

Casing & Tubing	Used in Drilling	Left in Well	Cement fill up Cu. ft.
Size 20-16 Cond.			
13 -10 ³ / ₄	128	128	80
9 5/8			
8 5/8			
7	2271		Pulled
5 1/2			
4 1/2			
3 1/2	4538	4538	130
2			
Liners used			

GEOLOGICAL TARGET FORMATION Oriskany Sand Depth 4463 feet
Depth of completed well 4538 feet Rotary XX / Cable Tools _____
Water strata depth: Fresh 40 feet; Salt 1050 feet
Coal seam depths: N/A Is coal being mined in the area? NO

OPEN FLOW DATA
Producing formation Oriskany Sand Pay zone depth 4466 feet
Gas: Initial open flow SHOW Mcf/d Oil: Initial open flow N/A Bbl/d
Final open flow SHOW *** Mcf/d Final open flow N/A Bbl/d
Time of open flow between initial and final tests ---- hours
Static rock pressure 600 psig (surface measurement) after 24 hours shut in
(If applicable due to multiple completion--)
Second producing formation N/A Pay zone depth _____ feet
Gas: Initial open flow _____ Mcf/d Oil: Initial open flow _____ Bbl/d
Final open flow _____ Mcf/d Oil: Final open flow _____ Bbl/d
Time of open flow between initial and final tests _____ hours
Static rock pressure _____ psig (surface measurement) after _____ hours shut in

*** Non producing

(Continue on reverse side)
AUG 12 1985

DETAILS OF PERFORATED INTERVALS, FRACTURING OR STIMULATING, PHYSICAL CHANGE, ETC.

Perforated Intervals; 4454-4458 8 shots and 4466-4474 16 shots.

Treated with 1000 gallons HCl 15%, 10,000 lbs. of 80/100 sand and 15,000 lbs. of 20/40 sand., 105 MSCF N₂ and 715 bbls. H₂O.

WELL LOG

FORMATION	COLOR	HARD OR SOFT	TOP FEET	BOTTOM FEET	REMARKS
					Including indication of all fresh and salt water, coal, oil and gas
Surface			0.0	80	Fresh water
Shale			80	100	
Sand			100	120	
Shale & Red rock			120	600	
Shale & Sand			600	800	
Sand & Slate			800	952	
Slate & Shells			952	1169	Salt water
Salt Sand			1169	1291	
Slate & Shells			1291	1538	
Little Lime			1538	1550	
Lime Shells			1550	1556	
Big Lime			1556	1649	
Slate & Shells			1649	1697	
BIG INJUN			1697	1766	
Shale			1766	2131	
COFFEE SHALE			2131	2155	
BEREA			2155	2181	
Shale			2181	3106	
*BROWN SHALE			3106	3782	
*White Slate			3782	4138	
*MARCELLUS SHALE			4138	4361	
*CORNIFEROUS LIME			4361	4463	
*ORISKANY SAND			4463	4474	GAS
Lime			4474	4475	TD

* INDICATE ELECTRIC LOG TOPS

(Attach separate sheets as necessary)

TEAVERE OIL & GAS, INC.

Well Operator

By: D. K. Bowers Agent

Date: 7/1/85

Note: Regulation 2.02(i) provides as follows:
"The term 'log' or 'well log' shall mean a systematic detailed geological record of all formations, including coal, encountered in the drilling of a well."



STATE OF WEST VIRGINIA
DEPARTMENT OF MINES

Oil and Gas Division

OIL AND GAS WELL PERMIT APPLICATION

RECEIVED
JAN 14 1977
DEPT. OF MINES

TO THE DEPARTMENT OF MINES,
Charleston, W. Va.

DATE January 13, 1977

Surface Owner Robert E. Sayre
Address Red House, W. Va.
Mineral Owner Robert E. Sayre
Address Same
Coal Owner Robert E. Sayre
Address Same
Coal Operator None
Address _____

Company Seaves Oil and Gas, Inc.
Address Charleston, W. Va.
Farm Robert E. Sayre Acres 107
Location (waters) Kanawha River
Well No. C-20-1 Elevation 384.5
District Union County Futuan
Quadrangle Winfield (15 Min)

THIS PERMIT MUST BE POSTED AT THE WELL SITE

All provisions being in accordance with Chapter 27 of the W. Va. Code, the location is hereby approved for deepening. This permit shall expire if operations have not commenced by 5-14-77

[Signature]
Deputy Director - Oil & Gas Division

INSPECTOR TO BE NOTIFIED Martin Nichols
PH: 548-6993 ADDRESS Clendenin W. Va.

GENTLEMEN:

The undersigned well operator is entitled to drill upon the above named farm or tract of land for oil and gas, having fee title thereto, (or as the case may be) under grant or lease dated Oct. 1 1976 by Robert E. Sayre made to Seaves Oil and Gas and recorded on the 4th day of Oct. 1976, in Futuan County, Book 59 Page 101

XX NEW WELL XX DRILL DEEPER XX REDRILL XX FRACTURE OR STIMULATE
OIL AND GAS WELL ORIGINALLY DRILLED BEFORE JUNE 5, 1969.

The enclosed plat was prepared by a registered engineer or licensed land surveyor and all coal owners and/or operators have been notified as of the above date.

The above named coal owners and/or operator are hereby notified that any objection they wish to make, or are required to make by Section 3 of the Code, must be received by, or filed with the Department of Mines within ten (10) days. *

Copies of this notice and the enclosed plat were mailed by registered mail, or delivered to the above named coal operators or coal owners at their above shown respective address _____ day _____ before, or on the same day with the mailing or delivery of this copy to the Department of Mines at Charleston, West Virginia.

PLEASE SUBMIT COPIES OF ALL
GEOPHYSICAL LOGS DIRECTLY TO:

West Virginia Geological and Economic Survey
P. O. Box 879
Morgantown, W. Va. 26505

Address
of
Well Operator

Very truly yours, William W. Schaf
(Sign Name) Seaves Oil and Gas, Inc.
Well Operator
1901 Kanawha Valley Bldg
Street
Charleston
City or Town
West Virginia
State

I have read & understand the reclamation requirements as set forth in Chapter 22, Article 4, Section 12-b and will carry out the specific requirements.

*SECTION 3 If no objections are filed or found by the Department of mines, within said period of ten days from the receipt of notice and plat by the department of mines, to said proposed location, the department shall forthwith issue to the well operator a permit reciting the filing of such plat, that no objections have been made by the coal operators or found thereto by the department and that the same is approved and the well operator authorized to proceed.

BLANKET BOND

Perit-838-00 PERMIT NUMBER
47-079

THIS IS AN ESTIMATE ONLY
ACTUAL INFORMATION WILL BE SUBMITTED ON OG-10 UPON COMPLETION

PROPOSED WORK ORDER TO _____ DRILL II DEEPEN _____ FRACTURE-STIMULATE
 DRILLING CONTRACTOR: (If Known) RESPONSIBLE AGENT:
 NAME Ray Resources Corporation NAME V. C. Smith
 ADDRESS 630 Commerce Square, Shao. ADDRESS Winfield
 TELEPHONE 344-8993 TELEPHONE 755-5202
 ESTIMATED DEPTH OF COMPLETED WELL: II ROTARY _____ CABLE TOOLS _____
 PROPOSED GEOLOGICAL FORMATION: Crickany
 TYPE OF WELL: OIL _____ GAS II COMB. _____ STORAGE _____ DISPOSAL _____
 RECYCLING _____ WATER FLOOD _____ OTHER _____

TENTATIVE CASING PROGRAM:

CASING AND TUBING SIZE	USED FOR DRILLING	LEFT IN WELL	CEMENT FILL UP OR SACKS - CUBIC FT.
20 - 16			
13 - 10	150'	150'	10 Sacks
9 - 5/8			
8 - 5/8			
7	2240'	2240'	100 Sacks
5 1/2			
4 1/2			
3	4500'	4500'	Perf. Top 30 Sacks
2			Perf. Bottom
Liners			Perf. Top
			Perf. Bottom

APPROXIMATE FRESH WATER DEPTHS 30 FEET SALT WATER _____ FEET
 APPROXIMATE COAL DEPTHS Not Known
 IS COAL BEING MINED IN THE AREA? No BY WHOM? _____

TO DRILL:

SUBMIT FIVE (5) COPIES OF OG - 1, \$100.00 PERMIT FEE, PERFORMANCE BOND AND PERMANENT COPY OF PLAT.

TO DRILL DEEPER OR REDRILL:

SUBMIT FIVE (5) COPIES OF OG - 1, SHOWING ORIGINAL PERMIT NUMBER AND PERFORMANCE BOND. ON WELLS DRILLED PRIOR TO 1929, A PERMANENT COPY OF THE PLAT AND THE ORIGINAL WELL RECORD MUST ALSO BE SUBMITTED.

TO FRACTURE - STIMULATE:

OIL AND/OR GAS WELL ORIGINALLY DRILLED BEFORE JUNE 5, 1929, FIVE (5) COPIES OG - 1, PERFORMANCE BOND, PERMANENT PLAT AND ORIGINAL WELL RECORD.

OIL AND/OR GAS WELL ORIGINALLY DRILLED ON AND/OR AFTER JUNE 5, 1929, FIVE COPIES OG - 1, SHOWING ORIGINAL PERMIT NUMBER, AND PERFORMANCE BOND.

Required forms must be filed within ninety (90) days of completion for bond release. Inspector to be notified twenty-four (24) hours in advance.

The following waiver must be completed by the coal operator if the permit is to be issued within ten days of receipt thereof.

WAIVER: I the undersigned, Agent for _____ Coal Company, Owner or Operator of the coal under this lease have examined and place on our mine maps this proposed well location.

We the _____ Coal Company have no objections to said well being drilled at this location, providing operator has complied with all rules and regulations in Articles 4, 5, and 7, Chapter 22 of the West Virginia Code.

 For Coal Company

 Official Title



STATE OF WEST VIRGINIA
DEPARTMENT OF MINES

Oil and Gas Division

OIL AND GAS WELL PERMIT APPLICATION

RECEIVED

DEC 27 1976

OIL & GAS DIVISION
DEPT. OF MINES

TO THE DEPARTMENT OF MINES,
Charleston, W. Va.

DATE December 1, 1976

Surface Owner Robert E. Sayre
Address Red House, W. Va.
Mineral Owner Same
Address _____
Coal Owner Same
Address _____
Coal Operator None
Address _____

Company TEAVERE OIL & GAS, INC..
Address 1901 Kanawha Valley Bldg.
Farm Robert E. Sayre Acres 107
Location (waters) Kanawha River
Well No. C-20-1 Elevation 584.5
District Union County Putnam
Quadrangle Winfield (15 Min.)

THIS PERMIT MUST BE POSTED AT THE WELL SITE

All provisions being in accordance with Chapter 27 of the W. Va. Code, the location is hereby approved for drilling. This permit shall expire if operations ~~have not commenced~~ by 4-28-77.

Robert E. Sayre

Deputy Director - Oil & Gas Division

INSPECTOR TO BE NOTIFIED Martin Nichols

GENTLEMEN:

PH: 548-6993 ADDRESS Clendenin, W. Va.

The undersigned well operator is entitled to drill upon the above named farm or tract of land for oil and gas, having fee title thereto, (or as the case may be) under grant or lease dated October 1 76 by Robert E. Sayre made to TEAVERE OIL & GAS, INC. and recorded on the October day of 4 76, in Putnam County, Book 59 Page 101

NEW WELL DRILL DEEPER REDRILL FRACTURE OR STIMULATE
OIL AND GAS WELL ORIGINALLY DRILLED BEFORE JUNE 5, 1969.

The enclosed plat was prepared by a registered engineer or licensed land surveyor and all coal owners and/or operators have been notified as of the above date.

The above named coal owners and/or operator are hereby notified that any objection they wish to make, or are required to make by Section 3 of the Code, must be received by, or filed with the Department of Mines within ten (10) days. *

Copies of this notice and the enclosed plat were mailed by registered mail, or delivered to the above named coal operators or coal owners at their above shown respective address _____ day _____ before, or on the same day with the mailing or delivery of this copy to the Department of Mines at Charleston, West Virginia.

PLEASE SUBMIT COPIES OF ALL
GEOPHYSICAL LOGS DIRECTLY TO:

West Virginia Geological and Economic Survey
P. O. Box 879
Morgantown, W. Va. 26505

Address
of
Well Operator

Very truly yours, *William W. Bluff*
(Sign Name) TEAVERE OIL & GAS, INC.

Well Operator
1901 Kanawha Valley Bldg.
Street
Charleston
City or Town
West Virginia
State

I have read and understand the reclamation requirements as set forth in Chapter 22, Article 4, Section 12-b and will carry out the specified requirements.

Signed by: *William W. Bluff*

*SECTION 3 If no objections are filed or found by the Department of mines, within said period of ten days from the receipt of notice and plat by the department of mines, to said proposed location, the department shall forthwith issue to the well operator a permit reciting the filing of such plat, that no objections have been made by the coal operators or found thereto by the department and that the same is approved and the well operator authorized to proceed.

PUT-838 PERMIT NUMBER

47-079

BLANKET BOND

THIS IS AN ESTIMATE ONLY
ACTUAL INFORMATION WILL BE SUBMITTED ON OG-10 UPON COMPLETION

PROPOSED WORK ORDER TO X DRILL _____ DEEPEN _____ FRACTURE-STIMULATE _____
 DRILLING CONTRACTOR: (If Known) RESPONSIBLE AGENT:
 NAME Not known NAME V. C. Smith
 ADDRESS _____ ADDRESS Winfield
 TELEPHONE _____ TELEPHONE 755-5202
 ESTIMATED DEPTH OF COMPLETED WELL: 4120 ROTARY X CABLE TOOLS _____
 PROPOSED GEOLOGICAL FORMATION: Brown Shale
 TYPE OF WELL: OIL _____ GAS X COMB. _____ STORAGE _____ DISPOSAL _____
 RECYCLING _____ WATER FLOOD _____ OTHER _____

TENTATIVE CASING PROGRAM:

CASING AND TUBING SIZE	USED FOR DRILLING	LEFT IN WELL	CEMENT FILL UP OR SACKS - CUBIC FT.
20 - 16			
13 - 10	150'	150'	To Surface
9 - 5/8			
8 - 5/8			
7 7"	1850	1850	Bottom Hole Packer
5 1/2			
4 1/2			
3 2"		4100	Perf. Top
2			Perf. Bottom
Liners			Perf. Top
			Perf. Bottom

APPROXIMATE FRESH WATER DEPTHS 80' FEET _____ SALT WATER _____ FEET _____
 APPROXIMATE COAL DEPTHS Not known
 IS COAL BEING MINED IN THE AREA? No BY WHOM? _____

TO DRILL:

SUBMIT FIVE (5) COPIES OF OG - 1, \$100.00 PERMIT FEE, PERFORMANCE BOND AND PERMANENT COPY OF PLAT.

TO DRILL DEEPER OR REDRILL:

SUBMIT FIVE (5) COPIES OF OG - 1, SHOWING ORIGINAL PERMIT NUMBER AND PERFORMANCE BOND, ON WELLS DRILLED PRIOR TO 1929, A PERMANENT COPY OF THE PLAT AND THE ORIGINAL WELL RECORD MUST ALSO BE SUBMITTED.

TO FRACTURE - STIMULATE:

OIL AND/OR GAS WELL ORIGINALLY DRILLED BEFORE JUNE 5, 1929, FIVE (5) COPIES OG - 1, PERFORMANCE BOND, PERMANENT PLAT AND ORIGINAL WELL RECORD.

OIL AND/OR GAS WELL ORIGINALLY DRILLED ON AND/OR AFTER JUNE 5, 1929, FIVE COPIES OG - 1, SHOWING ORIGINAL PERMIT NUMBER, AND PERFORMANCE BOND.

Required forms must be filed within ninety (90) days of completion for bond release. Inspector to be notified twenty-four (24) hours in advance.

The following waiver must be completed by the coal operator if the permit is to be issued within ten days of receipt thereof.

WAIVER: I the undersigned, Agent for _____ Coal Company, Owner or Operator of the coal under this lease have examined and place on our mine maps this proposed well location.

We the _____ Coal Company have no objections to said well being drilled at this location, providing operator has complied with all rules and regulations in Articles 4, 5, and 7, Chapter 22 of the West Virginia Code.

For Coal Company

Official Title