

NOTES: Location Determined By Differential GPS

(+) DENOTES LOCATION OF WELL ON UNITED STATES TOPOGRAPHIC MAPS (1/2")

FILE NO. _____
 DRAWING NO. 7460
 SCALE 1" = 2000'
 MINIMUM DEGREE OF ACCURACY 1/200
 PROVEN SOURCE OF ELEVATION EXISTING WELL PAD

I THE UNDERSIGNED, HEREBY CERTIFY THAT THIS PLAT IS CORRECT TO THE BEST OF MY KNOWLEDGE AND BELIEF AND SHOWS ALL THE INFORMATION REQUIRED BY LAW AND THE REGULATIONS ISSUED AND PRESCRIBED BY THE DEPARTMENT OF ENERGY.
 (SIGNED) Harry H. Smith, Jr.
 R.P.E. _____ L.L.S. 429

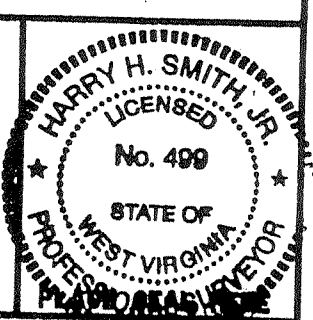

WEST VIRGINIA
 DIVISION OF ENVIRONMENTAL PROTECTION
 OFFICE OF OIL AND GAS
 1000 McJUNKIN ROAD
 CHARLOTTE, WEST VIRGINIA 25143-2506



DATE SEPTEMBER 18, 1999
 OPERATOR'S WELL NO. 7460
 API WELL NO. _____

WELL TYPE: GAS LIQUID INJECTION _____ WASTE DISPOSAL _____
 OF "GAS," PRODUCTION _____ STORAGE DEEP _____ SHALLOW _____
 LOCATION: ELEVATION 3547.7' WATER SHED East Fork Of Gladly Fork
 DISTRICT Dry Fork COUNTY Randolph
 QUADRANGLE Snake Of Candy COORDINATES LAT: 38°43'52" LONG: 79°44'04"
 SURFACE OWNER United States Department Of Interior ACREAGE 2326
 & GAS ROYALTY OWNER USA LEASE ACREAGE 18212.33
 LEASE OWNER USA LEASE NO. 30700
 PROPOSED WORK: DRILL _____ CONVERT _____ DRILL DEEPER _____ REDRILL _____ FRACTURE OR
 STIMULATE _____ PLUG OFF OLD FORMATION _____ PERFORATE NEW
 FORMATION _____ OTHER PHYSICAL CHANGE IN WELL (SPECIFY) Storage Recondition
 PLUG AND ABANDON _____ CLEAN OUT AND REPLUG _____
 TARGET FORMATION _____ ESTIMATED DEPTH _____
 FULL OPERATOR COLUMBIA GAS TRANSMISSION CORP DESIGNATED AGENT Richard L. Cely
 ADDRESS PO Box 1273, Charleston, WV ADDRESS P O Box 1273, Charleston, WV
25325-1273 25325-1273

MAY 24 1999

DEEP WELL

RANDOLPH COUNTY NAME PERMIT 1217

Latitude 38° 45'

Longitude 79° 40'

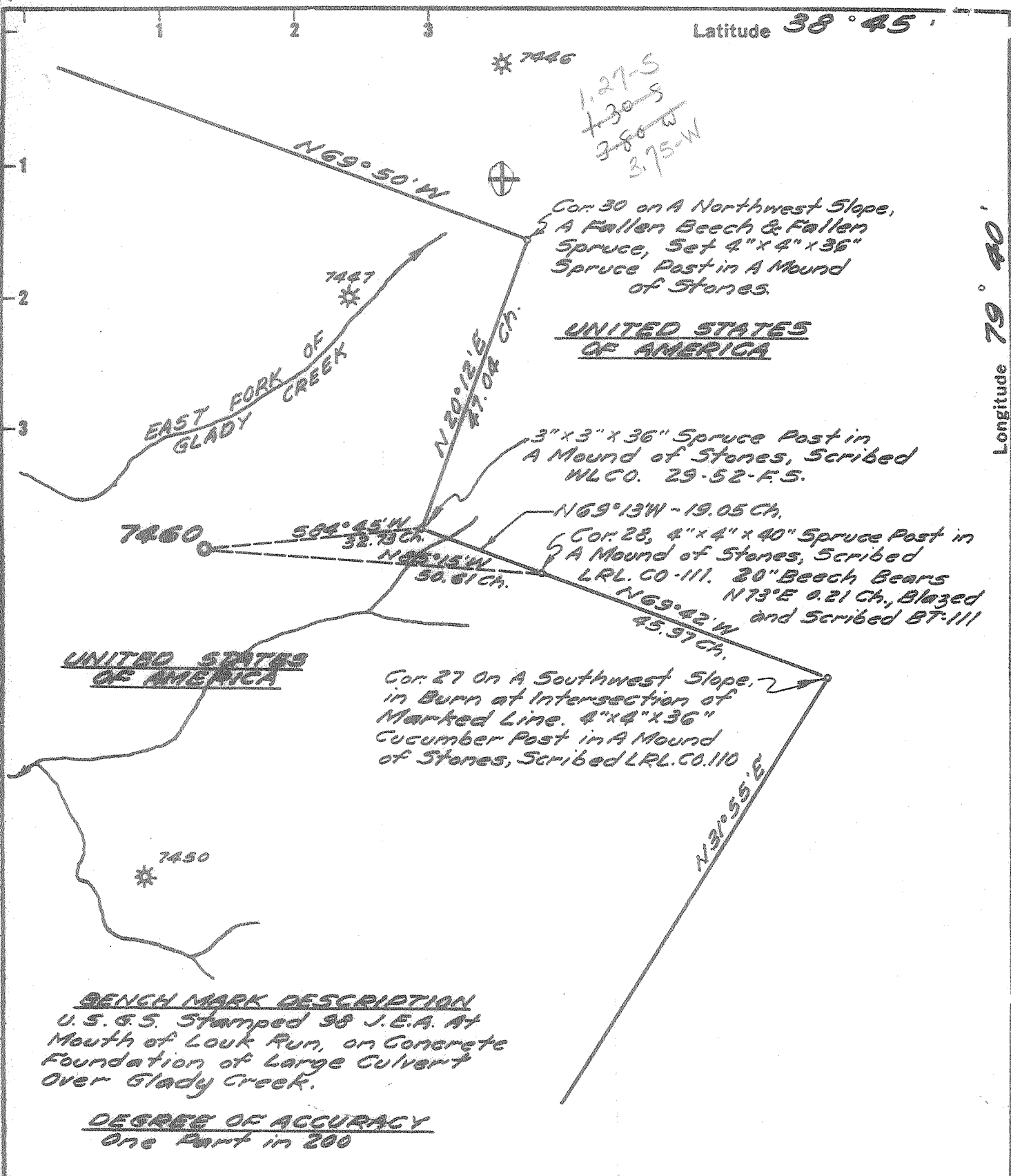

BENCH MARK DESCRIPTION
 U.S.G.S. Stamped 98 J.E.A. At Mouth of Louk Run, on Concrete Foundation of Large Culvert over Gladly Creek.

DEGREE OF ACCURACY
 One Part in 200

- Fracture Before 6/5/27
- New Location
- Drill Deeper
- Redrill
- Abandonment

I, the undersigned, hereby certify that this map is correct to the best of my knowledge and belief and shows all the information required by Paragraph 5 of the Rules and Regulations of the Oil and Gas Section of the Mining Laws of West Virginia.

The accuracy of this survey is within the limits and as prescribed in paragraph 5 by the Oil and Gas Division of the Department of Mines Regulations.

PROVEN ELEVATION 2923.00'

Company ATLANTIC SEABOARD CORP
 Address CHARLESTON, W.VA.
 Farm UNITED STATES OF AMERICA
 Tract 52 Acres 1822 BLM-A-022923 Lease No. 45-200
 Well (Farm) No. _____ Serial No. 7460
 Elevation (Spirit Level) 3547.74
 Quadrangle SPRUCE KNOB-NW
 County RANDOLPH District DRY FORK
 Engineer O.L. Jinks
 Engineer's Registration No. 2712
 File No. 164-85 Drawing No. _____
 Date APRIL 16, '66 Scale 1" = 1320'

STATE OF WEST VIRGINIA
 DEPARTMENT OF MINES
 OIL AND GAS DIVISION
 CHARLESTON

WELL LOCATION MAP
 FILE NO. RAN-121

+ Denotes location of well on United States Topographic Maps, scale 1 to 62,500 latitude and longitude lines being represented by border lines as shown.

- Denotes one inch spaces on border line of original tracing.

9-0 261

DEEP WELL { DRISKANY STORAGE
 T.D. = Helderberg



STATE OF WEST VIRGINIA
DEPARTMENT OF MINES
OIL AND GAS DIVISION

Rotary
Spudder
Cable Tools
Storage

WELL RECORD

Oil or Gas Well Gas Storage
(KIND)

Quadrangle Spruce Knob
Permit No. RAN-121

Company Atlantic Seaboard Corporation
Address P.O. Box 1273 Charleston, W. Va. 25325
Farm U.S.A. Tr. 52 Acres 48,212.33
Location (waters) East Fork of Gladly Creek
Well No. X-77-7460 Elev. 3547.74'
District Dry Fork County Randolph
The surface of tract is owned in fee by _____
Address _____

Casing and Tubing	Used in Drilling	Left in Well	Packers
Size			Kind of Packer
16			
13 3/8		35' Cemented	
10			Size of
9-5/8		1246' Cemented	
7"		5756' Cemented	Depth set
5 3/16			
4 1/2			
3			Perf. top
2 3/8		5937'	Perf. bottom
Liners Used			Perf. top
			Perf. bottom

Mineral rights are owned by U. S. Geological Survey
Gen. Services Bldg. Address Washington, D. C.
Drilling commenced 6-11-66
Drilling completed 6-26-66
Date Shot _____ From _____ To _____
With _____
Open Flow _____ /10ths Water in _____ Inch
_____ /10ths Merc. in _____ Inch
Volume 3,890,000 - Oriskany Cu. Ft.
Rock Pressure 1510 lbs. _____ hrs.
Oil _____ bbls., 1st 24 hrs.

Attach copy of cementing record.
CASING CEMENTED _____ SIZE _____ No. Ft. _____ Date _____
Amount of cement used (bags) _____
Name of Service Co. _____
COAL WAS ENCOUNTERED AT _____ FEET _____ INCHES
_____ FEET _____ INCHES
_____ FEET _____ INCHES

WELL ACIDIZED (DETAILS) _____
WELL FRACTURED (DETAILS) _____

RESULT AFTER TREATMENT (Initial open Flow or bbls.) _____
ROCK PRESSURE AFTER TREATMENT _____ HOURS _____
Fresh Water 279 Feet 930 Salt Water _____ Feet _____
Producing Sand _____ Depth _____

Formation	Color	Hard or Soft	Top	Bottom	Oil, Gas or Water	Depth	Remarks
Surface			0	35	Water at 279'		
Sand			35	365			
Sand & Shale			365	780	Water at 930'		
Shale			780	1092			
Sand & Shale			1092	1254	Show gas 5756'		
Sand			1254	1348			
Sand & Shale			1348	1618	All gas test 18/10 W 2" 179 M when drilling completed.		
Sand			1618	1896			
Sand & Shale			1896	3070			
Shale			3070	5217			
Tully Lime			5217	5233	Test before acidized 18/10 W 2" 179 M		
Marcellus Shale			5233	5523	Acidized 7-1-66 with 12,000 gallons 28% Hcl acid, overflushed with 4,000 gallons water		
Onondaga Lime			5523	5595	Test after acidized 2" spring gauge thru 4" 3,890 M		
Chert - HRV			5595	5711			
Shale - NEGRO MORE			5711	5748			
Oriskany Sand			5748	5940			
Helderberg			5940				
Total Depth			5945'				

485

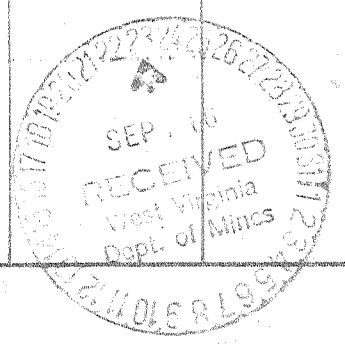

RECEIVED
Office of Oil & Gas
Permitting
NOV 17 1999
WV Division of
Environmental Protection

18-May-99
API # 47- 083-00121-T

State of West Virginia
Division of Environmental Protection
Section of Oil and Gas

Reviewed [Signature]

Well Operator's Report of Well Work

Farm name: US FOREST SERVICE Operator Well No.: GLADY #7460

LOCATION: Elevation: 3,547.00 Quadrangle: SINKS OF GANDY
District: DRY FORK County: RANDOLPH
Latitude: 6925 Feet South of 39 Deg. 45 Min. 0 Sec.
Longitude: 7425 Feet West of 79 Deg. 42 Min. 30 Sec.

Company: COLUMBIA GAS TRANSMISSION
P.O. BOX 1273
CHARLESTON, WV 25325-1273
Agent: RICHARD L. COTY
Inspector: PHILLIP TRACY
Permit Issued: 05/21/99
Well work Commenced: 06-21-99
Well work Completed: 07-30-99
Verbal Plugging
Permission granted on: _____
Rotary Cable Rig
Total Depth (feet) 5,945'KB (cleaned out to 5,929'GL)
Fresh water depths (ft) See Original Records
Salt water depths (ft) See Previous
Is coal being mined in area (Y/N) ? N
Coal Depths (ft) : See Previous

Casing & Up Tubing Size	Used in Drilling	Left in Well	Cement Fill Cu. Ft.
CLEANED OUT WELL STIMULATION; SEE BACK FOR DETAILS			

OPEN FLOW DATA
Producing formation Oriskany Pay zone depth (ft) 5748' - 5940'
Gas : Initial open flow _____ MCF/d Oil : Initial open flow _____ Bbl/d
Final open flow _____ MCF/d Final open flow _____ Bbl/d
Time of open flow between initial and final tests _____ Hours
Static rock Pressure _____ psig (surface pressure) after _____ Hours
Second producing formation _____ Pay zone depth (ft) _____
Gas : Initial open flow _____ MCF/d Oil : Initial open flow _____ Bbl/d
Final open flow _____ MCF/d Final open flow _____ Bbl/d
Time of open flow between initial and final tests _____ Hours
Static rock Pressure _____ psig (surface pressure) after _____ Hours

NOTE: ON BACK OF THIS FORM PUT THE FOLLOWING: 1). DETAILS OF PERFORATED INTERVALS, FRACTURING OR STIMULATING, PHYSICAL CHANGE, ETC. 2). THE WELL LOG WHICH IS A SYSTEMATIC DETAILED GEOLOGICAL RECORD OF ALL FORMATIONS, INCLUDING COAL ENCOUNTERED BY THE WELLBORE.

For : COLUMBIA GAS TRANSMISSION CORP.

By : W.H. Frazer
Date : 11/16/99

RAN DIA-1-T

NOV 23 1999

WR-35

18-May-99

API # 47- 083-00121-T

State of West Virginia
Division of Environmental Protection
Section of Oil and Gas

Well Operator's Report of Well Work

STIMULATION

- (07/30/99) Acidized by Halliburton Energy Services
- Pre-flush 3,990 gals 15% Halliburton 75 Quality FE Foamed Acid
- Displaced with 9,366 gals 65 Quality Foamed water.
- Treated w/ 9,996 gals 20% FE 65 Quality Foamed Acid
- Followed w/ 9,996 gals 15% FE 65 Quality Foamed Acid
- Flushed w/ 12,852 gals 65 Quality Foam & 630 gals water.
- Additives: 21 gals; 36 gals HC2; 7 gals SCA-130; 5 gals FE-5A; 30 gals BA-2; 7 gals PEN 88M.
- Total acid 4,662 gals 28% FE Acid.
- Total nitrogen 687,000 scf.
- The waste fluids were hauled to LAD in Wheeling, WV for disposal.