

[08-78]

OIL AND GAS WELL PERMIT APPLICATION

Operator's Well No. No. 1 Gillooly  
API Well No. FEB 17 1981 83 -0429  
State County Permit

WELL TYPE: Oil  / Gas

(If "Gas", Production  / Underground storage  / Deep  / Shallow

LOCATION: Elevation: 2160 2160 Watershed: Short Run of Middle Fork River

District: Roaring Creek County: Randolph Quadrangle: Ellamore

WELL OPERATOR Braxton Oil and Gas Corp.

Address 2821 N.W. 50th Street  
Okla. City, Okla. 73112

DESIGNATED AGENT W.M. Woodroe

Address P.O. Box 951  
Charleston, W. VA. 25323

OIL & GAS ROYALTY OWNER Patrick G. Gillooly

Address 116 South Washington St.  
Berkeley Springs, W. VA. 25411

Acreage 66.66

SURFACE OWNER L.L. Moss

Address Rt. 2, Buckhannon  
West Virginia

Acreage 66.66

FIELD SALE (IF MADE) TO:

Name X X

Address \_\_\_\_\_

COAL OPERATOR None

Address \_\_\_\_\_

COAL OWNER(S) WITH DECLARATION ON RECORD:

Name Patrick G. Gillooly

Address 116 South Washington St.

Berkely Springs, W. Va. 25411

Name \_\_\_\_\_

Address \_\_\_\_\_

COAL LESSEE WITH DECLARATION ON RECORD:

Name None

Address \_\_\_\_\_

OIL & GAS INSPECTOR TO BE NOTIFIED

Name Bob Stewart

Address Jane Lew

West Virginia

The undersigned well operator is entitled to operate for oil or gas purposes at the above location under a deed  / lease  / other contract  / dated February 6, 1981, to the undersigned well operator from Mike Ross

Assignment of lease

[If said deed, lease, or other contract has been recorded:]

Recorded on not recorded, 19\_\_\_\_, in the office of the Clerk of the County Commission of \_\_\_\_\_ County, West Virginia, in \_\_\_\_\_ Book \_\_\_\_\_ at page \_\_\_\_\_. A permit is requested as follows:

PROPOSED WORK: Drill  / Drill deeper  / Redrill  / Fracture or stimulate  / Plug off old formation  / Perforate new formation  / Other physical change in well (specify) \_\_\_\_\_

--planned as shown on the work order on the reverse side hereof.

The above named coal operator, coal owner(s), and coal lessee are hereby notified that any objection they wish to make or are required to make by Code § 22-4-3 must be filed with the Department of Mines within fifteen (15) days after the receipt of this Application by the Department.

Copies of this Permit Application and the enclosed plat and reclamation plan have been mailed by registered mail or delivered by hand to the above named coal operator, coal owner(s), and coal lessee on or before the day of the mailing or delivery of this Permit Application to the Department of Mines at Charleston, West Virginia.

Braxton Oil and Gas Corp.  
Donald S. Garvin  
Well Operator

03/15/2024

PLEASE SUBMIT COPIES OF ALL GEOPHYSICAL LOGS DIRECTLY TO:

WEST VIRGINIA OIL AND GAS CONSERVATION COMMISSION  
1615 WASHINGTON STREET EAST  
CHARLESTON, WV 25311

TELEPHONE: (204) 248-2000

BOND DRILL

By Donald S. Garvin

Its President



PROPOSED WORK ORDER

THIS IS AN ESTIMATE ONLY:  
ACTUAL INFORMATION MUST BE SUBMITTED ON FORM IV-35 UPON COMPLETION

DILLING CONTRACTOR (IF KNOWN) Unknown  
Address \_\_\_\_\_

GEOLOGICAL TARGET FORMATION, Elk Sand

Estimated depth of completed well, 5000 feet Rotary X / Cable tools \_\_\_\_\_ /  
Approximate water strata depths: Fresh, 75 feet; salt, ? feet.  
Approximate coal seam depths: 400' **Is coal being mined in the area?** Yes X / No \_\_\_\_\_

Casing and Tubing Program

Casing or Tubing Type	Specifications					Footage Intervals		Cement Fill-up or Sacks (Cubic feet)	Packers
	Size	Grade	Weight per ft	New	Used	For drilling	Left in well		
Conductor									Kinds
Fresh water									
Normal	8 5/8	RS	20#	X		0-750	750'	200 sx	Sizes
Intermediate									
Production	4 1/2	CW	10 1/2	X				165 sx	Depths set
Casing									
Packers									Perforations:
									Top Bottom

NOTE: Regulation 7.02 of the Department of Mines provides that the original and four copies of Form IV-2 must be filed with the Department, accompanied by (i) a plat in the form prescribed by Regulation 11, (ii) a bond in one of the forms prescribed by Regulation 12, or in lieu thereof the other security allowed by Code § 22-4-2, (iii) Form IV-9, "Reclamation Plan", applicable to the reclamation required by Code § 22-4-12b and Regulation 23, (iv) unless previously paid on the same well, the fee required by Code § 22-4-12a, and (v) if applicable, the consent required by Code § 22-4-8a from the owner of any water well or dwelling within 200 feet of the proposed well.

**THIS PERMIT MUST BE POSTED AT THE WELL SITE** A separate Form IV-2 shall not be required for fracturing or stimulating a well if fracturing or stimulating is to be part of the work for which a permit is sought and is noted as such on the Form IV-2 filed in connection therewith.

All provisions being in accordance with Chapter 22, of the W. Va. Code, the location is hereby approved for drilling. This permit shall expire if operations have not commenced by 10-25-81.

*John B. Bennett*  
Deputy Director - Oil & Gas Division







The following waiver must be completed by the coal operator and by any coal owner or coal lessee who has recorded a declaration under Code § 22-4-20, if the permit is to be issued within fifteen (15) days of receipt thereof:





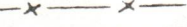

W A I V E R

The undersigned coal operator \_\_\_\_\_ / owner \_\_\_\_\_ / lessee \_\_\_\_\_ of the coal under this well location has examined this proposed well location. If a mine map exists which covers the area of the well location, the well location has been added to the mine map. The undersigned has no objection to the work proposed to be done at this location, provided, the well operator has complied with all applicable requirements of the West Virginia Code and the governing regulations.

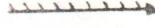
Date: \_\_\_\_\_, 19\_\_\_\_ By \_\_\_\_\_  
Its \_\_\_\_\_ 03/15/2024

Well Site Plan

Legend: Property Boundary   
 Road   
 Existing Fence   
 Planned Fence   
 Stream   
 Open Ditch 

Diversion   
 Spring   
 Wet Spot   
 Building   
 Drain Pipe   
 Waterway 

Sketch to include well location, existing access road, roads to be constructed, wellsite, drilling pits and necessary structures numbered or lettered to correspond with first part of this plan. Include all natural drainage.

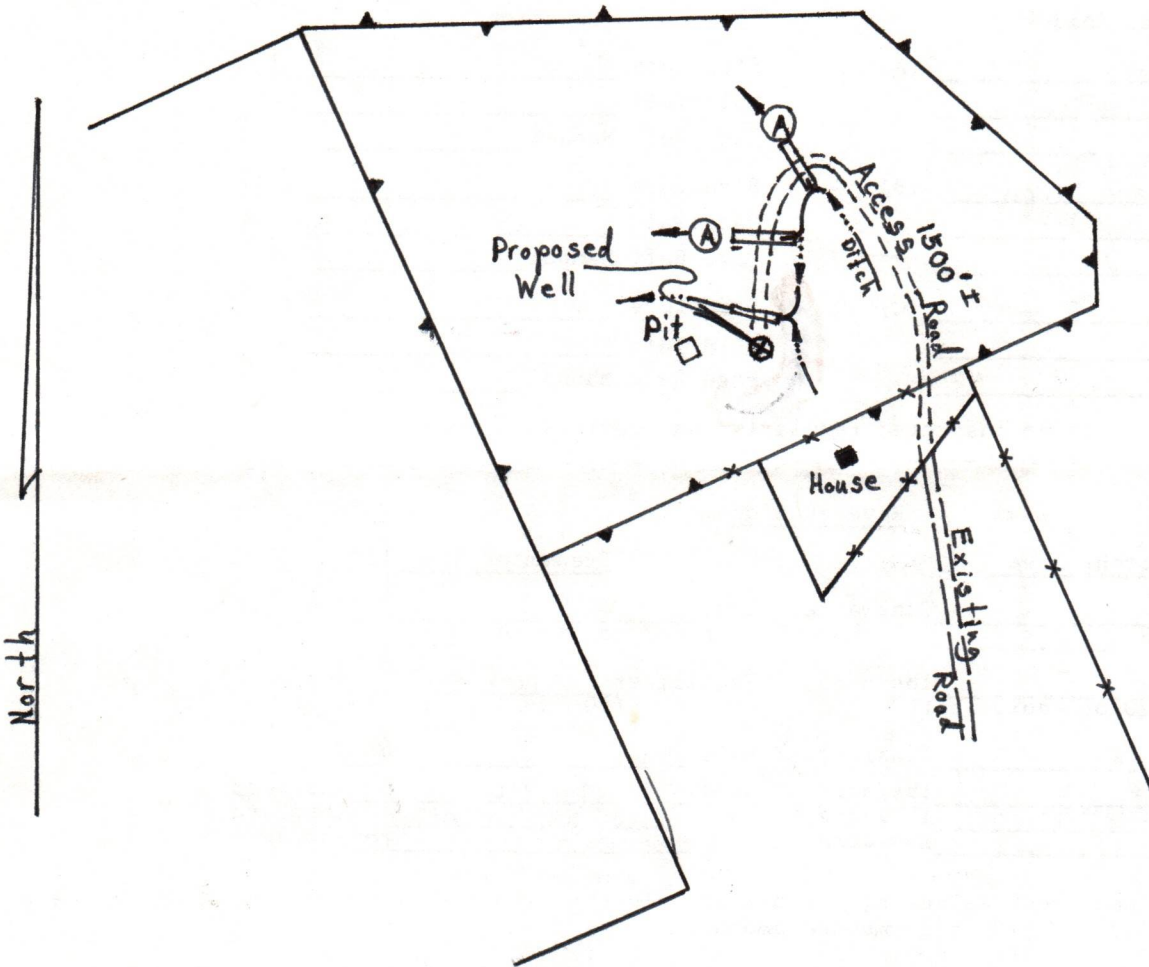

Comments: \_\_\_\_\_

- 1) Disturbed area to be kept to a minimum. \_\_\_\_\_
- 2) Cut slopes to be 2:1 \_\_\_\_\_
- 3) New culverts to be at natural drain areas or at 300' max. \_\_\_\_\_  
 Ditches to be cut on uphill side of road where necessary. \_\_\_\_\_
- 4) Timber to be cut, stacked and burned. \_\_\_\_\_

03/15/2024

Signature: \_\_\_\_\_ Agent \_\_\_\_\_ Address \_\_\_\_\_ Phone Number \_\_\_\_\_

Request landowners cooperation to protect new seeding for one growing season.



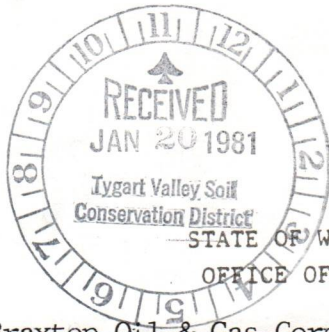

Date Jan. 16, 19 81  
 Well No. No. 1 Gillboly  
 API No. 47 - Randolph  
 State West Virginia County Perritt

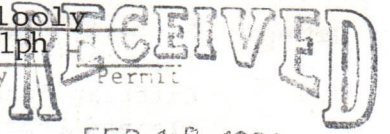

083-0429

FEB 17 1981

Company Name Braxton Oil & Gas Corp. Designated Agent R. Woodroe OIL & GAS DIVISION  
 Address 2821 N.W. 50th Street Address Charleston, W. VA. DEPT. OF MINES  
 Telephone Oklahoma City, Oklahoma Telephone \_\_\_\_\_  
 Landowner L.L. Moss Soil Cons. District Tygart's Valley SCD

Revegetation to be carried out by Braxton Oil & Gas Corp. (Agent)

This plan has been reviewed by Tygart Valley SCD All corrections and additions become a part of this plan. 1-21-81 Juanita Helrich  
 (Date) (SCD Agent)

Access Road	Location
Structure <u>Culverts</u> (A)	Structure <u>None</u> (1)
Spacing <u>300' Spacing</u>	Material _____
Page Ref. Manual <u>I- 8</u>	Page Ref. Manual _____
Structure <u>Drainage Ditch</u> (B)	Structure _____ (2)
Spacing _____	Material _____
Page Ref. Manual <u>I- 11</u>	Page Ref. Manual _____
Structure _____ (C)	Structure _____ (3)
Spacing _____	Material _____
Page Ref. Manual _____	Page Ref. Manual _____

All structures should be inspected regularly and repaired if necessary.

Revegetation

Treatment Area I	Treatment Area II
Lime <u>Estimated 3</u> Tons/acre or correct to pH <u>6.5</u>	Lime <u>3</u> Tons/Acre or correct to pH <u>6.5</u>
Fertilizer <u>600</u> lbs/acre (10-20-20 or equivalent)	Fertilizer <u>600</u> lbs/acre (10-20-20 or equivalent)
Mulch <u>Hay-</u> <u>2</u> Tons/Acre	Mulch <u>Hay</u> <u>2</u> Tons/Acre
Seed* <u>Kentucky 31-</u> <u>40</u> lbs/acre	Seed* <u>Kentucky 312</u> <u>40</u> lbs/acre
<u>Birdsfoot Trefoil-</u> <u>10</u> lbs/acre	<u>Birdsfoot Trefoil</u> <u>10</u> lbs/acre
<u>Ryegrass</u> <u>- 10</u> lbs/acre	<u>Ryegrass</u> <u>10</u> lbs/acre

\*Inoculate all legumes such as vetch, trefoil and clovers with the proper bacterium. Inoculate with 3X recommended amount.

Attach or photocopy section of involved Topographic map. Quadrangle Ellamore, W.Va. 7.5'

Legend: Well Site  
 Access Road

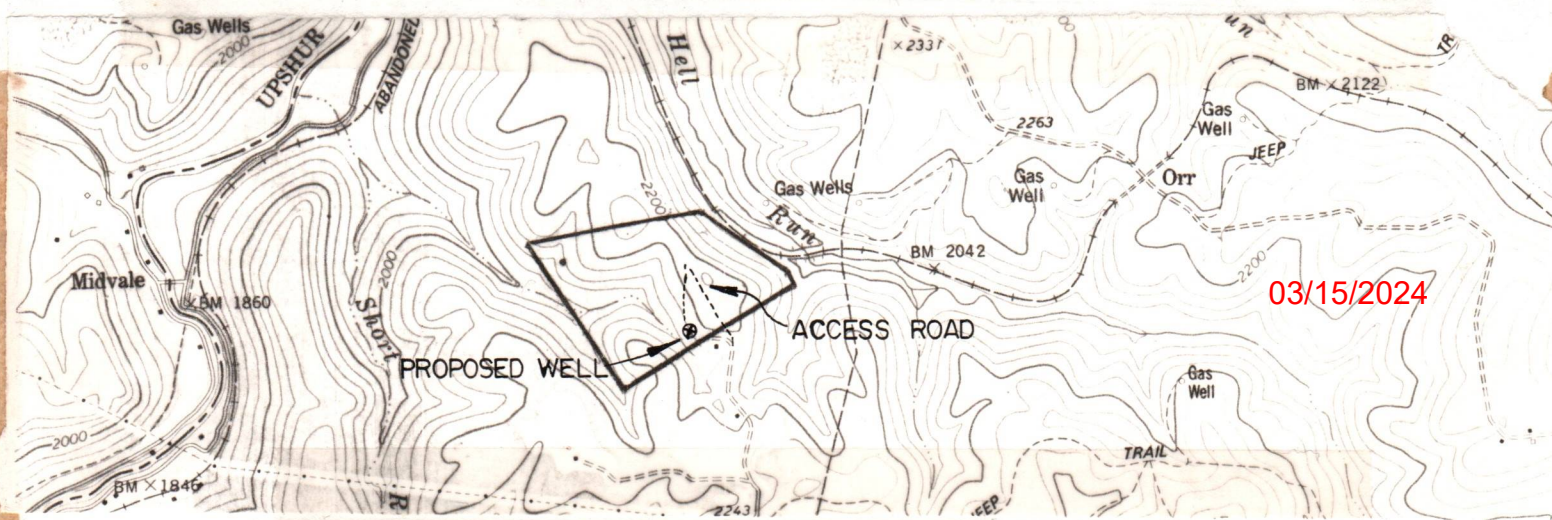



Formation	Color	Hard or Soft	Top Feet	Bottom Feet	Oil, Gas or Water	* Remarks
03/15/2024						

Date September 9, 19 81

APPROVED Braxton Oil & Gas Corp. Owner

By Donald S. Lawin  
(Title)





STATE OF WEST VIRGINIA  
DEPARTMENT OF MINES

Oil and Gas Division  
WELL RECORD

RECEIVED

SEP 17 1981

OIL AND GAS DIVISION  
WV DEPARTMENT OF MINES

Rotary  Oil   
Cable  Gas   
Recycling  Comb.   
Water Flood  Storage   
Disposal  (Kind)

Quadrangle Ellamore  
Permit No. 47-083-0429

Company <u>Braxton Oil &amp; Gas Corp.</u>	Casing and Tubing	Used in Drilling	Left in Well	Cement fill up Cu. ft. (Sks.)
Address <u>11032 Quail Ck. Rd., Okla. City, OK</u>				
Farm <u>Patrick Gillooly</u> Acres <u>67</u>	Size			
Location (waters) <u>Short Run</u>	20-16			
Well No. <u>one (1)</u> Elev. <u>2160'</u>	Cond.			
District <u>Roaring Creek County Randolph</u>	13-10" 11 3/4"	20'	20'	
The surface of tract is owned in fee by <u>L.L. Moss</u>	9 5/8			
Address <u>Rt. 2, Buckhannon, WV 26201</u>	8 5/8	835'	835'	240 sks.
Mineral rights are owned by <u>Patrick Gillooly</u>	7			
Address _____	5 1/2			
Drilling Commenced <u>7-30-81</u>	4 1/2	5107'	5107'	800 sks.
Drilling Completed <u>8-6-81</u>	3			
Initial open flow <u>100,000</u> cu. ft. <u>0</u> bbls.	2 1" siphon		3500'	
Final production <u>900,000</u> cu. ft. per day <u>0</u> bbls.	Liners Used			
Well open <u>3</u> hrs. before test <u>680#</u> RP.				

Well treatment details: Attach copy of cementing record.  
8/18/81-1st stage-500 gal. acid, 485 bbls. water, 9,000 # 80/100 sand, 42,000 # 20/40 sand.  
8/18/81-2nd stage-500 gal. acid, 463 bbls. water, 9,000 # 80/100 sand, 42,000 # 20/40 sand.  
8/18/81-3rd stage-500 gal. acid, 384 bbls. water, 9,000 # 80/100 sand, 30,000 # 20/40 sand.  
 Coal was encountered at 161-164, 350-353 Feet \_\_\_\_\_ Inches  
 Fresh water 63' Feet \_\_\_\_\_ Salt Water none Feet \_\_\_\_\_  
 Producing Sand Elk, 2nd Alexander, Benson, Elizabeth Depth 4850-4870, 4470-4480, 3640-3660, Bayard, 5th Sand 2120-2130, 2065-2080, 1880-1920

Formation	Color	Hard or Soft	Top Feet	Bottom Feet	Oil, Gas or Water	* Remarks
Sand			0	156		
Shale			156	161		
Coal			161	164		
Shale			164	300		
Sand			300	350		
Coal			350	353		
Sandy Shale			353	1038		
Big Lime			1038	1175		
Big Injun			1175	1290		
Sandy Shale			1290	1700		
4th Sand			1700	1765		
Sandy Shale			1765	1880		
5th Sand			1880	1920	Show Gas	
Sandy Shale			1920	2065		
Bayard Sand			2065	2080	Show Gas	
Sandy Shale			2080	2120		
Elizabeth Sand			2120	2130	Show Gas	
Sandy Shale			2130	3640		
Benson Sand			3640	3660	Show Gas	
Sandy Shale			3660	4470		03/15/2024
2nd Alexander			4470	4480	Show Gas	
Sandy Shale			4480	4850		
Elk Sand			4850	4870	Show Gas	
Sandy Shale			4870	5200	TD	

(over)

\* Indicates Electric Log tops in the remarks section.



STATE OF WEST VIRGINIA  
DEPARTMENT OF MINES  
OIL AND GAS WELLS DIVISION

RECEIVED

JUL 30 1981

INSPECTOR'S WELL REPORT

OIL & GAS DIVISION  
DEPT. OF MINES

Permit No. 083-0429

Oil or Gas Well OAS  
(KIND)

Company <u>BRAXTON Oil &amp; Gas</u>	CASING AND TUBING	USED IN DRILLING	Left in Well	PACKERS
Address <u>Buckhannon</u>	Size			
Farm <u>PATRICK Gillooly</u>	16			Kind of Packer
Well No. <u>#1</u>	13			
District <u>ROARING Creek</u> County <u>RANDOLPH</u>	10			Size of
Drilling commenced <u>7-28-81</u>	8 1/4			
Drilling completed _____ Total depth _____	6 3/8			Depth set
Date shot _____ Depth of shot _____	5 3/16			
Initial open flow _____ /10ths Water in _____ Inch	3			Perf. top
Open flow after tubing _____ /10ths Merc. in _____ Inch	2			Perf. bottom
Volume _____ Cu. Ft.	Liners Used			Perf. top
Rock pressure _____ lbs. _____ hrs.				Perf. bottom
Oil _____ bbls., 1st 24 hrs.	CASING CEMENTED _____ SIZE _____ No. FT. _____ Date _____			
Fresh water _____ feet _____ feet	NAME OF SERVICE COMPANY _____			
Salt water _____ feet _____ feet	COAL WAS ENCOUNTERED AT _____ FEET _____ INCHES			
	_____ FEET _____ INCHES _____ FEET _____ INCHES			
	_____ FEET _____ INCHES _____ FEET _____ INCHES			

Drillers' Names APPALACHIAN RIG 5

Remarks:

Move Rig SPUD

7-28-81  
DATE

Robert Steward 5/1  
03/15/2024  
DISTRICT WELL INSPECTOR







STATE OF WEST VIRGINIA  
DEPARTMENT OF MINES  
OIL AND GAS WELLS DIVISION

RECEIVED

MAY 21 1982

OIL AND GAS DIVISION  
WV DEPARTMENT OF MINES

INSPECTOR'S WELL REPORT

Permit No. 083-0429

Oil or Gas Well GAS  
(KIND)

Company BRAXTON oil & GAS

Address BUCKHANNON

Farm P Gillooly

Well No. #1

District ROARING CREEK County RANDOLPH

Drilling commenced 7-28-81

Drilling completed \_\_\_\_\_ Total depth \_\_\_\_\_

Date shot \_\_\_\_\_ Depth of shot \_\_\_\_\_

Initial open flow \_\_\_\_\_ /10ths Water in \_\_\_\_\_ Inch

Open flow after tubing \_\_\_\_\_ /10ths Merc. in \_\_\_\_\_ Inch

Volume \_\_\_\_\_ Cu. Ft.

Back pressure \_\_\_\_\_ lbs. \_\_\_\_\_ hrs.

\_\_\_\_\_ bbls., 1st 24 hrs.

Fresh water \_\_\_\_\_ feet \_\_\_\_\_ feet

Salt water \_\_\_\_\_ feet \_\_\_\_\_ feet

CASING AND TUBING	USED IN DRILLING	LEFT IN WELL	PACKERS
Size			
16			Kind of Packer _____
13			
10			Size of _____
8 1/4			
6 5/8			Depth set _____
5 3/16			
3			Perf. top _____
2			Perf. bottom _____
Liners Used			Perf. top _____
			Perf. bottom _____

CASING CEMENTED \_\_\_\_\_ SIZE \_\_\_\_\_ No. FT. \_\_\_\_\_ Dat \_\_\_\_\_

NAME OF SERVICE COMPANY \_\_\_\_\_

COAL WAS ENCOUNTERED AT \_\_\_\_\_ FEET \_\_\_\_\_ INCHES

\_\_\_\_\_ FEET \_\_\_\_\_ INCHES \_\_\_\_\_ FEET \_\_\_\_\_ INCHES

\_\_\_\_\_ FEET \_\_\_\_\_ INCHES \_\_\_\_\_ FEET \_\_\_\_\_ INCHES

Drillers' Names \_\_\_\_\_

Remarks:

O.K. TO Release

5-19-82

Robert Stewart

03/15/2024

571









State of West Virginia

Department of Mines  
Oil and Gas Division

Charleston 25305

WALTER N. MILLER  
DIRECTOR

THEODORE M. STREIT  
ADMINISTRATOR

July 13, 1982

Braxton Oil & Gas Corporation  
Quail Creek North Office Bldg., Suite 165  
11032 Quail Creek Road  
Oklahoma City, Oklahoma 73120

Dear Sir:

The required records and reports have been received in this office and the District Inspectors have submitted Final Inspections for the following wells listed below:

<u>PERMIT NO.</u>	<u>FARM AND WELL NUMBER</u>	<u>DISTRICT</u>
083-0393-REN.	L. L. Moss, #3	Roaring Creek
083-0429	Patrick G. Gillooly, #1	Roaring Creek
083-0430	Patrick G. Gillooly, #2	Roaring Creek
083-0477	Nada Davis, #2 Preisse	Roaring Creek
083-0497	Westvaco, #1 Tenney	Roaring Creek
083-0498	Westvaco, #2 Tenney	Roaring Creek
083-0478	Meadow Lark Farms, #1 Preisse	Roaring Creek

In accordance with Chapter 22, Article 4, Section 2, the bond coverage for above captioned wells will stay in force for life of well. Reclamation requirements have been approved.

Very truly yours,

Theodore M. Streit

TMS:rl

03/15/2024



RECEIVED

SEP 24 1981

1.0 API well number: (If not available, leave blank. 14 digits.)	47-083-0429			
2.0 Type of determination being sought: (Use the codes found on the front of this form.)	103 Section of NGPA		OIL & GAS DIVISION DEPT OF MIN Category Code	
3.0 Depth of the deepest completion location: (Only needed if sections 103 or 107 in 2.0 above.)	5200 feet			
4.0 Name, address and code number of applicant: (35 letters per line maximum. If code number not available, leave blank.)	Braxton Oil and Gas Corp. Name 11032 Quail Creek Rd., Suite 165 Street Oklahoma City, Okla. City State		2170 Seller Code 73120 Zip Code	
5.0 Location of this well: [Complete (a) or (b).] (a) For onshore wells (35 letters maximum for field name.)	Ellamore Field Name Randolph County		West Virginia State	
(b) For OCS wells:	Area Name _____ Block Number _____ Date of Lease: _____ Mo. Day Yr. OCS Lease Number _____			
(c) Name and identification number of this well: (35 letters and digits maximum.)	No. 1 Gillooly			
(d) If code 4 or 5 in 2.0 above, name of the reservoir: (35 letters maximum.)	_____			
6.0 (a) Name and code number of the purchaser: (35 letters and digits maximum. If code number not available, leave blank.)	Columbia Gas Company Name		004030 Buyer Code	
(b) Date of the contract:	Pending _____ Mo. Day Yr.			
(c) Estimated annual production:	40 MMcf.			
	(a) Base Price (\$/MMBTU)	(b) Tax	(c) All Other Prices [Indicate (+) or (-).]	(d) Total of (a), (b) and (c)
7.0 Contract price: (As of filing date. Complete to 3 decimal places.)	-0-	No Contract	-0-	-0-
8.0 Maximum lawful rate: (As of filing date. Complete to 3 decimal places.)	2.501	Variable	.010	2.511
9.0 Person responsible for this application:	Donald S. Garvin President Name Title <i>Donald S. Garvin</i> Signature September 17, 1981 (405) 755-2823 Date Application is Completed Phone Number			
Agency Use Only	Date Received by Juris. Agency SEP 24 1981 Date Received by FERC			



JAN 11 1982

PARTICIPANTS:

DATE:

BUYER-SELLER CODE

OPERATOR:

Braxton Oil + Gas Corp

002170

LEASING PURCHASER:

Columbia Gas Transmission

004030

OTHER:

W. Va. Department of Mines, Oil & Gas Division  
 WELL DETERMINATION FILE NUMBER  
91-09-24-103-083 = 0429  
 Use Above File Number on all Communications  
 Relating to Determination of this Well

CHK 1500'

Checked. 3/60

Qualifies J E Huzzey

CHECK EACH ITEM AS COMPLETE OR NOTE WHAT IS MISSING

ITEM NO.

- 1. FERC -121  Items not completed - Line No. 7.0 all 8.0 b
- 2. IV-1 Agent  WM Woodroe
- 3. IV-2 Well Permit
- 4. IV-6 Well Plat
- 5. IV-35 Well Record  Drilling  Deepening
- 6. IV-36 Gas-Oil Test: Gas Only  Was Oil Produced?  Ratio
- 7. IV-39 Annual Production \_\_\_\_\_ years
- 8. IV-40 90 day Production \_\_\_\_\_ Days off line: \_\_\_\_\_
- 9. IV-48 Application for certification. Complete?
- 10-17. IV Form 51 - 52 - 53 - 54 - 55 - 56 - 57 - 58 Complete?  Affidavit Signed
- 18-28. Other: Survey \_\_\_\_\_ Logs \_\_\_\_\_ Geological Charts \_\_\_\_\_  
 Structure Map \_\_\_\_\_ 1: 4000 Map \_\_\_\_\_ Well Tabulations \_\_\_\_\_  
 Gas Analyses \_\_\_\_\_
- (5) Date commenced: 7-30-81 Date completed 8-6-81 Deepened
- (5) Production Depth: 4850 - 4870
- (5) Production Formation: EIK
- (5) Final Open Flow: 900 mcf
- (5) After Frac. R. P. 680 # 3 hrs
- (6) Other Gas Test:
- (7) Avg. Daily Gas from Annual Production:
- (8) Avg. Daily Gas from 90-day ending w/1-120 days
- (8) Line Pressure:  PSIG from Daily Report
- (5) Oil Production:  From Completion Report
- 10-17. Does lease inventory indicate enhanced recovery being done \_\_\_\_\_
- 10-17. Is affidavit signed?  Notarized?
- Does official well record with the Department confirm the submitted information? 03/15/2024
- Additional information \_\_\_\_\_ Does computer program confirm? \_\_\_\_\_
- Was Determination Objected to \_\_\_\_\_ By Whom? \_\_\_\_\_

HHH



Date September 17, 1981

STATE OF WEST VIRGINIA  
DEPARTMENT OF MINES, OIL AND GAS DIVISION

Operator's Well No. No. 1 Gillooly  
API Well No. 47 - 083 - 0429  
State County Permit

WELL CLASSIFICATION FORM  
NEW ONSHORE PRODUCTION WELL  
NGPA Section 103

DESIGNATED AGENT John O. Kizer  
ADDRESS 1200 Charleston National Plaza  
Charleston, West Virginia 25301

WELL OPERATOR Braxton Oil and Gas Corp.

LOCATION: Elevation 2160'  
Watershed Short Run  
Roaring  
Dist. Creek County Randolph Quad Ellamore

ADDRESS 11032 Quail Creek Rd.

Okla. City, Okla. 73120

GAS PURCHASER Columbia Gas Co.

ADDRESS P.O. Box 1273

Charleston, W. Va. 25323

Gas Purchase Contract No. pending  
Meter Chart Code unknown  
Date of Contract pending

Date surface drilling was begun: July 29, 1981

Indicate the bottom hole pressure of the well and explain how this was calculated:

$$BHP = P_1 + P_2 (eGL / 53.34 T_1)$$

$$P = 680$$
$$L = 3377$$
$$T = 120$$
$$G = .66$$
$$BHP = 730 \text{ PSI}$$

AFFIDAVIT

I, Donald S. Garvin, having been first sworn according to law state that surface drilling of the well for which this determination is sought was begun on or after February 19, 1977; the well satisfies applicable state or federal well spacing requirements and the well is not within a proration unit, in existence at the time surface drilling began, which was applicable to the reservoir from which gas is or will be produced and which applied to any other well producing gas in commercial quantities or on which surface drilling began on or after February 19, 1977, and which was capable of producing gas in commercial quantities. I state, further, that I have concluded, to the best of my information, knowledge and belief, that the well for which this determination is sought is a new onshore production well and that I am not aware of any information not described in the application which is inconsistent with this conclusion.

Donald S. Garvin  
Donald S. Garvin

OKLAHOMA  
STATE OF ~~WEST VIRGINIA~~  
COUNTY OF Oklahoma, TO WIT:

I, Lianna DeBee, a Notary Public in and for the state and county aforesaid, do certify that Donald S. Garvin, whose name is signed to the writing above, bearing date the 17 day of Sept., 1981, has acknowledged the same before me, in my county aforesaid. Given under my hand and official seal this 17th day of Sept., 1981. My term of office expires on the 2nd day of October, 1981.

[NOTARIAL SEAL]

Lianna DeBee  
Notary Public