



1) Date: June 25, 19 84
 2) Operator's Well No. A-1586 (McMullan)
 3) API Well No. 47 - 083 - 0927
 State County Permit

STATE OF WEST VIRGINIA
 DEPARTMENT OF MINES, OIL AND GAS DIVISION
 APPLICATION FOR A WELL WORK PERMIT

- 4) WELL TYPE: A Oil / Gas /
 B (If "Gas", Production / Underground storage / Deep / Shallow /)
- 5) LOCATION: Elevation: 2956' Watershed: Long Run MTM 13
 District: Middle Fork S County: Randolph Quadrangle: Cassity 7.5' 282
- 6) WELL OPERATOR Alamco 925
 Address P. O. Box 1740
Clarksburg, WV 26301
- 7) DESIGNATED AGENT D. L. Wheeler
 Address P. O. Box 1740
Clarksburg, WV 26301
- 8) OIL & GAS INSPECTOR TO BE NOTIFIED
 Name Philip Tracy
 Address Forest Festival Terrace, Apt. 24
Elkins, WV 26241
- 9) DRILLING CONTRACTOR:
 Name Development Drilling
 Address P. O. Box 1740
Clarksburg, WV 26301
- 10) PROPOSED WELL WORK: Drill / Drill deeper / Redrill / Stimulate
 Plug off old formation / Perforate new formation /
 Other physical change in well (specify) _____
- 11) GEOLOGICAL TARGET FORMATION, 5th Sand
- 12) Estimated depth of completed well, 3,000 feet
- 13) Approximate trata depths: Fresh, _____ feet; salt, _____ feet.
- 14) Approximate coal seam depths: _____ Is coal being mined in the area? Yes No

RECEIVED
 JUN 28 1984

15) CASING AND TUBING PROGRAM

| CASING OR TUBING TYPE | SPECIFICATIONS | | | | | FOOTAGE INTERVALS | | CEMENT FILLUP OR SACKS (Cubic feet) | PACKERS |
|-----------------------|----------------|-------|----------------|-----|------|-------------------|--------------|-------------------------------------|-----------------------------|
| | Size | Grade | Weight per ft. | New | Used | For drilling | Left in well | | |
| Conductor | 16" | | | | X | 20' | 20' | Cement to Surface | |
| Fresh water | | | | | | | | | |
| Coal | 8-5/8" | | 20# | X | | 700' | 700' | Cement to Surface | by rule 15.05 |
| Intermediate | | | J.55 | | | | | | |
| Production | 4-1/2" | | 10.50# | X | | 3000' | 3000' | Req. by Rule 15.01 | Depths |
| Tubing | | | | | | | | | |
| Liners | | | | | | | | | Perforations: Top Bottom |

OFFICE USE ONLY
 DRILLING PERMIT

Permit number 47-083-0927 Date July 16, 19 84

This permit covering the well operator and well location shown below is evidence of permission granted to drill in accordance with the pertinent legal requirements subject to the conditions contained herein and on the reverse hereof. **Notification must be given to the District Oil and Gas Inspector, (Refer to No. 8) Prior to the construction of roads, locations and pits for any permitted work.** In addition, the well operator or his contractor shall notify the proper district oil and gas inspector 24 hours before actual permitted work has commenced.)

The permitted work is as described in the Notice and Application, plat, and reclamation plan, subject to any modifications and conditions specified on the reverse hereof.
 Permit expires July 16, 1986 unless well work is commenced prior to that date and prosecuted with due diligence.

| | | | | |
|-------------------------|---------------------|--------------------|---------------------|-------------------|
| Bond: BLANKET | Agent: <u>LS</u> | Plat: <u>MM</u> | Casing <u>MM</u> | Fee <u>451</u> |
|-------------------------|---------------------|--------------------|---------------------|-------------------|

[Signature]
 Administrator, Office of Oil and Gas

NOTE: Keep one copy of this permit posted at the drilling location.



OFFICE USE ONLY

PERMIT MODIFICATIONS AND CONDITIONS (IF ANY) TO THE PROPOSED WELL WORK

1) DATE: June 25, 1984
2) OPERATOR: MTTM 13
3) WELL NO.: 088
4) DISTRICT: Mobile
5) COUNTY: Kanawha
6) WELL OPERATOR ADDRESS: E. O. Box 1740, Charleston, WV 25301
7) DESIGNATED AGENT: D. J. Minter
8) DRILLING CONTRACTOR: [Name redacted]
9) PROPOSED WELL WORK: [Details redacted]
10) GEOLOGICAL TARGET FORMATION: [Details redacted]
11) ESTIMATED DEPTH OF COMPLETED WELL: 3,000 feet
12) APPROXIMATE COIL SEAM DEPTH: [Details redacted]

RECEIVED
JUN 26 1984

| Casing or Tubing Type | Grade | Weight per ft. | New | Used | FOOTAGE IN FEET | |
|-----------------------|--------|----------------|-----|------|-----------------|--------------|
| | | | | | For drilling | Left in well |
| Production | 4-1/2" | 9.35 | X | | 3000' | 3000' |
| Intermediate | 3-1/2" | 20.8 | X | | 700' | 700' |
| Flow water | 10" | | | | 20' | 20' |
| Conductor | 10" | | | | 20' | 20' |

OFFICE USE ONLY

This part of Form IV-2(b) is to record the dates of certain occurrences and any follow-up inspections.

| | Date | Date(s) |
|------------------------------------|---------------|---------|
| Application received | | |
| Well work started | | |
| Completion of the drilling process | July 16, 1984 | |
| Well Record received | | |
| Reclamation completed | | |

OTHER INSPECTIONS

Reason: _____

Reason: _____

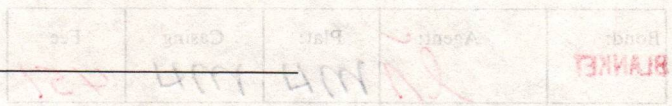

12/01/2023

IV-9
(Rev 8-81)

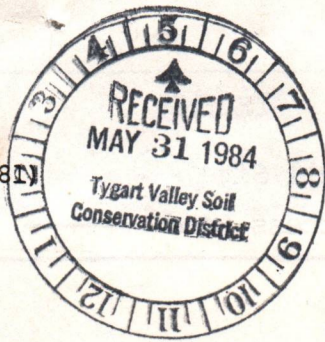

DATE May 30, 1984
WELL NO. A-1586
API NO. 47-083-0927

State of West Virginia
Department of Mines
Oil and Gas Division

CONSTRUCTION AND RECLAMATION PLAN

COMPANY NAME ALAMCO
Address P. O. DRAWER 1740
Clarksburg, WV 26301
Telephone 623-6671

DESIGNATED AGENT Daniel L. Wheeler
Address P. O. Drawer 1740
Clarksburg, WV 26301
Telephone 304 623-6671

LANDOWNER WESTVACO

SOIL CONS. DISTRICT TYGART VALLEY

Revegetation to be carried out by ALAMCO (Agent)

This plan has been reviewed by Tygart Valley SCD. All corrections
and additions become a part of this plan: 6-2-84 (Date)

Junior Helms
(SCD Agent)

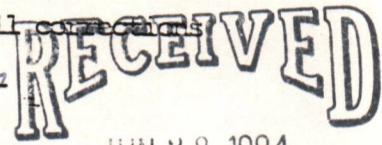

JUN 28 1984

NOTE: LOCATION TO BE
BUILT IN CENTER OF
EXISTING WELL ROAD

ACCESS ROAD

| Structure | (A) | Structure | LOCATION | OIL & GAS DIVISION |
|-----------------------------|-----|---|--------------|--------------------|
| Structure <u>SEE "NOTE"</u> | (A) | Structure <u>DRAINAGE Ditch</u> | <u>Ditch</u> | DEPT. OF MINES (1) |
| Spacing _____ | | Material <u>Earthen</u> | | |
| Page Ref. Manual _____ | | Page Ref. Manual <u>2:12</u> | | |
| Structure _____ | (B) | Structure <u>CULVERTS</u> | | (2) |
| Spacing _____ | | Material <u>16" I.O. (WHERE NEEDED)</u> | | |
| Page Ref. Manual _____ | | Page Ref. Manual <u>2:7</u> | | |
| Structure _____ | (C) | Structure <u>RIPRAP</u> | | (3) |
| Spacing _____ | | Material <u>ROCK</u> | | |
| Page Ref. Manual _____ | | Page Ref. Manual <u>N/A</u> | | |

All structures should be inspected regularly and repaired if necessary. All commercial timber is to be cut and stacked and all brush and small timber to be cut and removed from the site before dirt work begins.

REVEGETATION

Treatment Area I

Lime 3 Tons/acre
or correct to pH 6.5

Fertilizer 600 lbs/acre
(10-20-20 or equivalent)

Mulch STRAW 2 Tons/acre

Seed* KENTUCKY 31 40 lbs/acre
DOMESTIC RYEGRASS 10 lbs/acre
BIRDFOOT TREFOIL 10 lbs/acre

Treatment Area II

Lime 3 Tons/acre
or correct to pH 6.5

Fertilizer 600 lbs/acre
(10-20-20 or equivalent)

Mulch STRAW 2 Tons/acre

Seed* KENTUCKY 31 40 lbs/acre
DOMESTIC RYEGRASS 10 lbs/acre
BIRDFOOT TREFOIL 10 lbs/acre

*Inoculate all legumes such as vetch, trefoil and clovers with the proper bacterium. Inoculate with 3X recommended amount.

NOTES: Please request landowner's cooperation to protect new seedling for one growing season. Attach separate sheets as necessary for comments.

PLAN PREPARED BY Daniel L. Wheeler 12/01/2023
ADDRESS P. O. Drawer 1740
200 West Main Street
Clarksburg, West Virginia 26301
PHONE NO. 304 623-6671

ATTACH OR PHOTOCOPY SECTION OF INVOLVED TOPOGRAPHIC MAP. QUADRANGLE CASSITY 7.5'





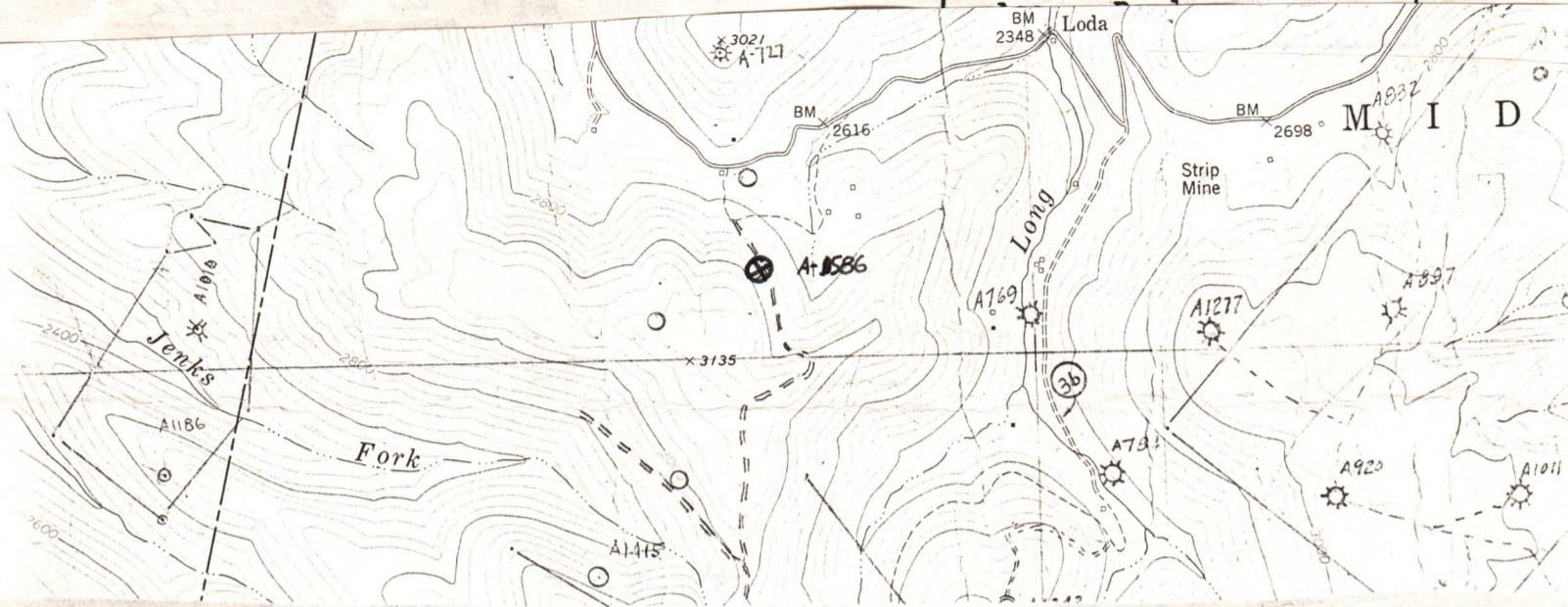

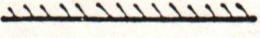
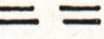

LEGEND

Well Site 

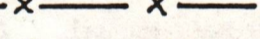

Sketch to include well location, existing access road, roads to be constructed, well site, drilling pits and necessary structures numbered or lettered to correspond with the first part of this plan. Include all natural drainage.

LEGEND

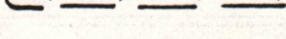
| | |
|---|--|
| Property boundary  | Diversion  |
| Road  | Spring  |
| Existing fence  | Wet spot  |
| Planned fence  | Building  |
| Stream  | Drain pipe  |
| Open ditch  | Waterway  |

COMMENTS:

Slope of Access road  -- Cuts to be on a 2:1 slope or less. Access road subject to change by company of landowner. All ditches and culverts will be maintained after construction is completed. If revision is made, revised plan will be submitted.

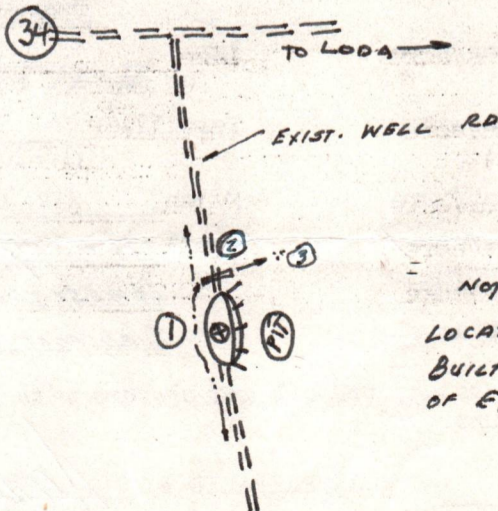
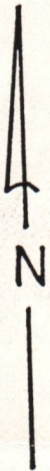

NOTE:
LOCATION TO BE BUILT IN CENTER OF EXIST. WELL ROAD.

12/01/2023

NOTE: Top Soil to be piled and used in reclamation

1) Date: June 25, 1984
2) Operator's Well No. A-1586 (McMullan)
3) API Well No. 47 - 083-0927

STATE OF WEST VIRGINIA
DEPARTMENT OF MINES, OFFICE OF OIL & GAS
NOTICE OF APPLICATION FOR A WELL WORK PERMIT

State County Permit
International Coal Co.
Greenbrier Valley Bldg.
119 Washington St. E.
Lewisburg, WV 24901

4) SURFACE OWNER(S) OF RECORD TO BE SERVED

- (i) Name Westvaco Corp.
Address 203 Randolph Ave.
Elkins, WV 26241
- (ii) Name _____
Address _____
- (iii) Name _____
Address _____

5(i) COAL OPERATOR Amax Coal Co.

Address 105 Meridan St.
Indianapolis, IN 46225

5(ii) COAL OWNER(S) WITH DECLARATION ON RECORD:

Name Harry McMullan III
Address P. O. Box 8
Washington, NC 27889

Name _____
Address _____

5(iii) COAL LESSEE WITH DECLARATION ON RECORD:

Name Amax Coal Co.
Address 105 S. Meridan St.
Indianapolis, IN 46225

TO THE PERSON(S) NAMED ABOVE: You should have received this Form and the following documents: International Coal Co. Greenbrier Valley Bldg. 119 Washington St. E. Lewisburg, WV 24901

- (1) The Application for a Well Work Permit on Form IV-2(B) (or Form IV-4 if the well is to be plugged, which sets out the parties involved in the drilling or other work, and describes the well and its location and, if applicable, the proposed casing and cementing program;
- (2) The plat (surveyor's map) showing the well location on Form IV-6; and
- (3) The Construction and Reclamation Plan on Form IV-9 (unless the well work is only to plug a well), which sets out the plan for erosion and sediment control and for reclamation for the site and access road.

THE REASON YOU RECEIVED THESE DOCUMENTS IS THAT YOU HAVE RIGHTS REGARDING THE APPLICATION WHICH ARE SUMMARIZED IN THE "INSTRUCTIONS" ON THE REVERSE SIDE OF THE COPY OF THE APPLICATION (FORM IV-2(B) OR FORM 4, DESIGNATED FOR YOU. HOWEVER, YOU ARE NOT REQUIRED TO TAKE ANY ACTION AT ALL.

Take notice that under Chapter 22 of the West Virginia Code, the undersigned well operator proposes to file or has filed this Notice and Application and accompanying documents for a Well Work Permit with the Administrator of the Office of Oil and Gas, West Virginia Department of Mines, with respect to a well at the location described on attached Application and depicted on attached Form IV-6. Copies of this Notice, the Application, the plat, and the Construction and Reclamation Plan have been mailed by registered or certified mail or delivered by hand to the person(s) named above (or by publication in certain circumstances) on or before the day of mailing or delivery to the Administrator.

6) EXTRACTION RIGHTS

Check and provide one of the following:

- Included is the lease or leases or other continuing contract or contracts by which I hold the right to extract oil or gas.
- The requirement of Code 22-4-1-(c) (1) through (4). (See reverse side for specifics.)

7) ROYALTY PROVISIONS

Is the right to extract, produce or market the oil or gas based upon a lease or leases or other contract or contracts providing for flat well royalty or any similar provision for compensation to the owner of the oil or gas in place which is not inherently related to the volume of oil or gas so extracted, produced or marketed? ~~XXX~~ No

If the answer above is No, nothing additional is needed. If the answer is Yes, you may use Affidavit Form IV-60.

See the reverse side for line item instructions, and for instructions concerning the required copies of the Notice and Application, plat, and Construction and Reclamation Plan.

The truth of the information on the Notice and Application is verified and sworn to and the Notice is signed on behalf of the Well Operator in my County and State by

Daniel L. Wheeler

this 25 day of June, 19 84.

My commission expires 3/16, 19 94.

Sheila D Parks

Notary Public, Harrison County,
State of West Virginia

WELL OPERATOR ALAMCO, INC.

By Daniel L. Wheeler
Its Vice President

Address P. O. Drawer 1740

Clarksburg, WV 26301

Telephone 304-623-6671

12/01/2023

I N S T R U C T I O N S T O A P P L I C A N T

CONCERNING THE LINE ITEMS:

- 1) Date of Notice.
- 2) Your well name and number.
- 3) To be filled out by the Office of Oil & Gas.
- 4) & 5) Use separate sheet if necessary.
- 4) Surface owner(s) of record to be served with Notice and Application. However, see also Code § 22-4-1b(b) if "more than three tenants in common or other co-owners of interest described in subsection (a) of this section hold interests in such lands".
- 5(i) "Coal Operator" means any person, firm, partnership, partnership association or corporation that proposes to or does operate a coal mine.
- 5(ii, iii) See Code § 22-4-20.
- 6) See Code § 22-4-11(c). However, in lieu of filing the lease(s) or other continuing contract(s), the Applicant may fill out the information in the space provided below.
- 7) See Code § § 22-4-11(d, e).

CONCERNING THE REQUIRED COPIES FOR FILING AND SERVICE:

Filing. Code § 22-4-1k and Regulation 7.02 provide that the original and required copies of the Notice and Application must be filed with the Administrator, accompanied by (i) a plat in the form prescribed by Regulation 11, (ii) a bond in one of the forms prescribed by Regulation 12, or in lieu thereof the other security allowed by Code § 22-4-1k(d) and the reclamation required by Code § 22-4-12b and Regulation 23, (iv) unless previously paid on the same well, the fees required by Code § 22-4-1a(c) and 22-3-12a, and (v) if applicable, the consent required by Code § 22-4-8a from the owner of any water well on dwelling within 200 feet of the proposed well.

Service. In addition, service must be made on the surface owner(s) and the person(s) with an interest in the coal. See Code § § 22-4-1m, 22-4-2, 22-4-2a, and 22-4-2b.

INFORMATION SUPPLIED UNDER CODE § 22-4-11(d)
IN LIEU OF FILING LEASE(S) AND OTHER CONTINUING CONTRACT(S)

Under the oath required to make the verification on the obverse side of this Notice, I depose and say that I am the person who signed the Notice for the Applicant, and that--

- (1) the tract of land is the same tract described in the Application to which this Notice applies, partly or wholly depicted in the accompanying plat, and described in the Construction and Reclamation Plan;
- (2) the parties and recordation data (if recorded) for lease(s) or other continuing contract(s) by which the Applicant claims the right to extract, produce or market the oil or gas are as follows:

| <u>Grantor, lessor, etc.</u> | <u>Grantee, lessee, etc.</u> | <u>Royalty</u> | <u>Book</u> | <u>Page</u> |
|---|------------------------------|----------------|-------------|-------------|
| Harry McMullan, Jr., et al | Columbia Gas Transmission | 1/8 | 275 | 185 |
| Columbia Gas assigned to Allegheny Land And Mineral Co. (ALAMCO) | | | 7 | 14 |

P 528 441 789

RECEIPT FOR CERTIFIED MAIL

NO INSURANCE COVERAGE PROVIDED
NOT FOR INTERNATIONAL MAIL

(See Reverse) A-1586 SDP

★ U.S.G.P.O. 1983-403-517

| | | |
|---|--|--|
| Sent to | Dave Darco | |
| Street and No. | Amaco Coal Co. 105 S. Meridan Street | |
| P.O., State and ZIP Code | Indianapolis, Indiana 4622 | |
| A-1586 | | |
| Postage | \$ | |
| Certified Fee | | |
| Special Delivery Fee | | |
| Restricted Delivery Fee | | |
| Return Receipt Showing to whom and Date Delivered | ALAMCO, INC. 200 W. Main Street P. O. Box 1740 Clarksburg, WV 26302 | |
| Return receipt showing to whom, Date, and Address of Delivery | | |
| TOTAL Postage and Fees | \$ | |
| Postmark or Date | 28 1984 | |

PS Form 3800, Feb. 1982

RECEIVED
JUN 28 1984

OIL & GAS DIVISION
DEPT. OF MINES

P 528 441 787

RECEIPT FOR CERTIFIED MAIL

NO INSURANCE COVERAGE PROVIDED
NOT FOR INTERNATIONAL MAIL

(See Reverse) A-1586 SDP

★ U.S.G.P.O. 1983-403-517

| | | |
|---|--|--|
| Sent to | Harry McMullan, III | |
| Street and No. | P. O. Box 8 | |
| P.O., State and ZIP Code | Washington, NC 27889 | |
| A-1586 | | |
| Postage | \$ | |
| Certified Fee | | |
| Special Delivery Fee | | |
| Restricted Delivery Fee | | |
| Return Receipt Showing to whom and Date Delivered | ALAMCO, INC. 200 W. Main Street P. O. Box 1740 Clarksburg, WV 26302 | |
| Return receipt showing to whom, Date, and Address of Delivery | | |
| TOTAL Postage and Fees | \$ | |
| Postmark or Date | | |

PS Form 3800, Feb. 1982

P 528 441 788

RECEIPT FOR CERTIFIED MAIL

NO INSURANCE COVERAGE PROVIDED
NOT FOR INTERNATIONAL MAIL

(See Reverse) A-1586 SDP

★ U.S.G.P.O. 1983-403-517

| | | |
|---|--|--|
| Sent to | International Coal Co. | |
| Street and No. | 119 Washington Street East | |
| P.O., State and ZIP Code | Lewisburg, WV 24901 | |
| A-1586 | | |
| Postage | \$ | |
| Certified Fee | | |
| Special Delivery Fee | | |
| Restricted Delivery Fee | | |
| Return Receipt Showing to whom and Date Delivered | ALAMCO, INC. 200 W. Main Street P. O. Box 1740 Clarksburg, WV 26302 | |
| Return receipt showing to whom, Date, and Address of Delivery | | |
| TOTAL Postage and Fees | \$ | |
| Postmark or Date | 28 1984 | |

PS Form 3800, Feb. 1982

P 528 441 790

RECEIPT FOR CERTIFIED MAIL

NO INSURANCE COVERAGE PROVIDED
NOT FOR INTERNATIONAL MAIL

(See Reverse) A-1586 SDP

★ U.S.G.P.O. 1983-403-517

| | | |
|---|--|--|
| Sent to | Harry McMullan, III | |
| Street and No. | P. O. Box 8 | |
| P.O., State and ZIP Code | Washington, NC 27889 | |
| A-1586 | | |
| Postage | \$ | |
| Certified Fee | | |
| Special Delivery Fee | | |
| Restricted Delivery Fee | | |
| Return Receipt Showing to whom and Date Delivered | ALAMCO, INC. 200 W. Main Street P. O. Box 1740 Clarksburg, WV 26302 | |
| Return receipt showing to whom, Date, and Address of Delivery | | |
| TOTAL Postage and Fees | \$ | |
| Postmark or Date | 12/01/2023 | |

PS Form 3800, Feb. 1982



Date September 10, 1984

Operator's
Well No. A-1586
Farm McMullan
API No. 47 - 083 - 0927

RECEIVED

SEP 12 1984

STATE OF WEST VIRGINIA
DEPARTMENT OF MINES

OIL & GAS DIVISION
DEPT. OF MINES

OIL and GAS DIVISION

WELL OPERATOR'S REPORT
OF

DRILLING, FRACTURING AND/OR STIMULATING, OR PHYSICAL CHANGE

WELL TYPE: OIL / GAS X / LIQUID INJECTION / WASTE DISPOSAL /
(If "Gas", Production / Underground Storage / Deep / Shallow /)

LOCATION: Elevation: 2956' Watershed Long Run
District: Middle Fork County: Randolph Quadrangle: Cassity 7.5'

COMPANY ALAMCO, INC

200 West Main Street

ADDRESS Clarksburg, West Virginia 26301

DESIGNATED AGENT ALAMCO, INC

200 West Main Street

ADDRESS Clarksburg, West Virginia 26301

SURFACE OWNER Westvaco

ADDRESS 203 Randolph, Elkins, WV 26241

MINERAL RIGHTS OWNER Harry McMullan III

ADDRESS P.O. Box 8, Washington, NC 27889

OIL AND GAS INSPECTOR FOR THIS WORK Philip

Forest Festival Terrace

Tracy ADDRESS Apt. #24, Elkins, WV 26241

PERMIT ISSUED July 16, 1984

DRILLING COMMENCED August 8, 1984

DRILLING COMPLETED August 13, 1984

IF APPLICABLE: PLUGGING OF DRY HOLE ON
CONTINUOUS PROGRESSION FROM DRILLING OR
REWORKING. VERBAL PERMISSION OBTAINED
ON _____

| Casing & Tubing Size Cond. | Used in Drilling | Left in Well | Cement fill up Cu. Ft. |
|----------------------------|------------------|--------------|------------------------|
| 20-16 | | | |
| 11-3/4" | 35' | Pulled | |
| 9 5/8" | | | |
| 8 5/8" | 859' | 859' | to surface |
| 7" | | | |
| 5 1/2" | | | |
| 4 1/2" | 2350' | 2350' | w/265 sks 1100' |
| 3 | | | |
| 2 | | | |
| Liners used | | | |

GEOLOGICAL TARGET FORMATION 5th Sand DEPTH 3000 FEET

Depth of completed well 2951 feet Rotary x / Cable Tools _____

Water Strata depth: Fresh 140 feet Salt _____ feet

Coal seam depth: 168-171, 303-307, 520-525, 705-709 Is coal being mined in this area? No

OPEN FLOW DATA

Producing formation 5th, 4-A, 4th, Gordon Pay zone depth See Back feet

Gas: Initial open flow 39 Mcf/d Oil: Initial open flow _____ Bbl/d

Final open flow 440 Mcf/d Final open flow _____ Bbl/d

Time of open flow between initial and final tests 2 hours

Static rock pressure 350 psig (surface measurement after 84 hours shut-in

(If applicable due to multiple completion--)

Second producing formation _____ Pay zone depth 12/01/2023 feet

Gas: Initial open flow _____ Mcf/d Oil: Initial open flow _____ Bbl/d

Final open flow _____ Mcf/d Final open flow _____ Bbl/d

Time of open flow between initial and final tests _____ hours

Static rock pressure _____ psig (surface measurement) after _____ hours shut-in

(continue on reverse side)

KMN
C 261

DETAILS OF PERFORATED INTERVALS, FRACTURING OR STIMULATING, PHYSICAL CHANGE ETC.

Well was fractured August 21, 1984
 Perforations: 1878 - 1892
 1930 - 1934 Gordon & 4th Sand
 2086 - 2094 4th A Sand
 2130 - 2134
 2176 - 2182 4th A & 5th Sand

WELL LOG

| FORMATION COLOR HARD OR SOFT | TOP FEET | BOTTOM FEET | REMARKS Including indication of all fresh and salt water, coal, oil and gas |
|------------------------------|----------|-------------|--|
| Sand & Shale | 0 | 168 | Damp @ 140' |
| Coal | 168 | 171 | Gas check @ 1192' No show |
| Sand & Shale | 171 | 303 | Gas check @ 1977' No show |
| Coal | 303 | 307 | Gas check @ 2009' No show |
| Sand & Shale | 307 | 520 | Gas check @ 2324' 33 MCF/D |
| Coal | 520 | 525 | Gas check @ 2699' 37 MCF/D |
| Sand & Shale | 525 | 705 | Gas check @ 2951' 39 MCF/D |
| Coal | 705 | 709 | |
| Sand & Shale | 709 | 842 | |
| Red Rock | 842 | 872 | |
| Sand & Shale | 872 | 882 | <u>GAMMA RAY LOG TOPS</u> |
| Shale & Red Rock | 882 | 1065 | Gordon Stray 1748' |
| Sand & Shale | 1065 | 1224 | Gordon 1876' |
| Little Lime | 1224 | 1250 | 4th Sand 1918' |
| Sand & Shale | 1250 | 1278 | 4th A Sand 2070' |
| Big Lime | 1278 | 1425 | 5th Sand 2146' |
| Sand & Shale | 1425 | 1462 | |
| Big Injun | 1462 | 1560 | |
| Sand & Shale | 1560 | 2951 T.D. | |

(Attach separate sheets as necessary)

ALAMCO, INC.

Well Operator

By: Hayne Gonnewille / dpp

Date: September 10, 1984

12/01/2023

Note: Regulation 2.02 (i) provides as follows
 "The term 'log' or 'well log' shall mean a systematic detailed geological record of all formations, including coal, encountered in the drilling of a well."

STATE OF WEST VIRGINIA
DEPARTMENT OF MINES
OIL AND GAS WELLS DIVISION

RECEIVED
AUG 21 1984

INSPECTOR'S WELL REPORT

OIL & GAS DIVISION
DEPT. OF MINES
Oil or Gas Well _____
(KIND)

Permit No. 83-927

Company Alanco
 Address _____
 Farm Harry McMiller
 Well No. A-1584
 District Middle Fork County Randolph
 Drilling commenced _____
 Drilling completed _____ Total depth 2950
 Date shot _____ Depth of shot _____
 Initial open flow _____ /10ths Water in _____ Inch
 Open flow after tubing _____ /10ths Merc. in _____ Inch
 Volume _____ Cu. Ft.
 Rock pressure _____ lbs. _____ hrs.
 Oil _____ bbls., 1st 24 hrs.
 Fresh water _____ feet _____ feet
 Salt water _____ feet _____ feet

| CASING AND TUBING | USED IN DRILLING | LEFT IN WELL | PACKERS |
|-------------------|------------------|--------------|----------------------|
| Size | | | |
| 16 | | | Kind of Packer _____ |
| 13 | | | |
| 10 | | | Size of _____ |
| 8 1/4 | | | |
| 6 3/8 | | | Depth set _____ |
| 5 3/16 | | | |
| <u>4 1/2</u> | <u>2450</u> | <u>2450</u> | Perf. top _____ |
| 2 | | | Perf. bottom _____ |
| Liners Used | | | Perf. top _____ |
| | | | Perf. bottom _____ |

CASING CEMENTED _____ SIZE _____ No. FT. _____ Date _____
 NAME OF SERVICE COMPANY _____
 COAL WAS ENCOUNTERED AT _____ FEET _____ INCHES
 _____ FEET _____ INCHES _____ FEET _____ INCHES
 _____ FEET _____ INCHES _____ FEET _____ INCHES

Drillers' Names _____
 Remarks: _____

8-15-84
DATE

Philip Long 12/01/2023
DISTRICT WELL INSPECTOR



RECEIVED

NOV 26 1984

OIL & GAS DIVISION
DEPT. OF MINES

State of West Virginia
Department of Mines
Oil and Gas Division
Charleston 25305

FINAL INSPECTION REPORT
INSPECTORS COMPLIANCE REPORT
October 17, 1984

COMPANY Alamco, Inc.

PERMIT NO 083-0927

P. O. Drawer 1740

FARM & WELL NO Westvaco, A-1586

Clarksburg, West Virginia 26301

DIST. & COUNTY Middle Fork/Randolph

| RULE | DESCRIPTION | IN COMPLIANCE | |
|-------|---|---------------|----|
| | | YES | NO |
| 23.06 | Notification Prior to Starting Work | | |
| 25.04 | Prepared before Drilling to Prevent Waste | | |
| 25.03 | High-Pressure Drilling | | |
| 16.01 | Required Permits at Wellsite | | |
| 15.03 | Adequate Fresh Water Casing | | |
| 15.02 | Adequate Coal Casing | | |
| 15.01 | Adequate Production Casing | | |
| 15.04 | Adequate Cement Strenght | | |
| 15.05 | Cement Type | | |
| 23.02 | Maintained Access Roads | | |
| 25.01 | Necessary Equipment to Prevent Waste | | |
| 23.04 | Reclaimed Drilling Pits | | |
| 23.05 | No Surface or Underground Pollution | | |
| 23.07 | Requirements for Production & Gathering Pipelines | | |
| 16.01 | Well Records on Site | | |
| 16.02 | Well Records Filed | | |
| 7.05 | Identification Markings | | |

I HAVE INSPECTED THE ABOVE CAPTIONED WELL AND RECOMMEND THAT IT BE RELEASED:

SIGNED Phillip Tracy

DATE 11-30-84

Your well record was received and reclamation requirements approved. In accordance with Chapter 22, Article 4, Section 2, the above well will remain under bond coverage for the life of the well.

T. H. ...

Administrator-Oil & Gas Division

January 11, 1985

DATE

MN 7/13/84

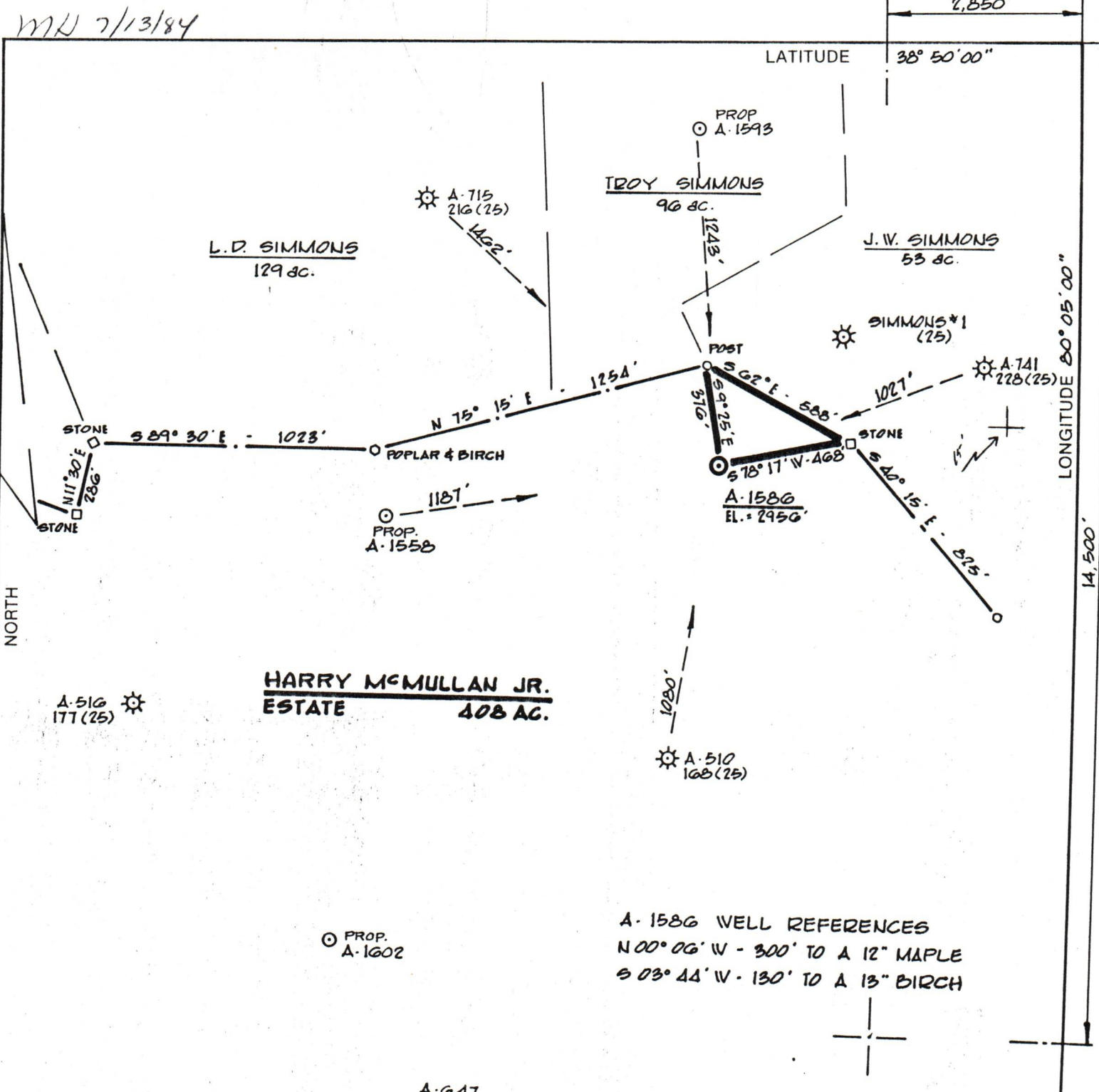

A-1586 WELL REFERENCES
 N 00° 06' W - 300' TO A 12" MAPLE
 S 03° 44' W - 130' TO A 13" BIRCH

PROP. A-1602

A-647 186 (25)

(+) DENOTES LOCATION OF WELL ON UNITED STATES TOPOGRAPHIC MAPS

FILE NO. SH/SP
 DRAWING NO. _____
 SCALE 1" = 500'
 MINIMUM DEGREE OF ACCURACY 1:200
 PROVEN SOURCE OF ELEVATION ALAMCO A-510
API = 168 EL = 3050'

I THE UNDERSIGNED, HEREBY CERTIFY THAT THIS PLAT IS CORRECT TO THE BEST OF MY KNOWLEDGE AND BELIEF AND SHOWS ALL THE INFORMATION REQUIRED BY LAW AND THE REGULATIONS ISSUED AND PRESCRIBED BY THE DEPARTMENT OF MINES.
 (SIGNED) Cecil R. Main
 R.P.E. _____ L.L.S. 711

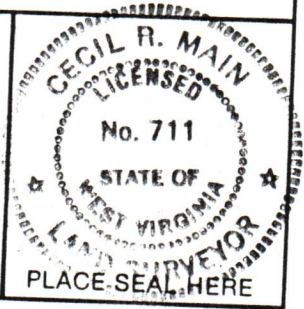

STATE OF WEST VIRGINIA
 DEPARTMENT OF MINES
 OIL AND GAS DIVISION



DATE 6-1, 1984
 OPERATOR'S WELL NO. A-1586
 API WELL NO. _____

WELL TYPE: OIL ___ GAS X LIQUID INJECTION ___ WASTE DISPOSAL ___
 (IF "GAS,") PRODUCTION X STORAGE ___ DEEP ___ SHALLOW X
 LOCATION: ELEVATION 2956' WATERSHED LONG RUN
 DISTRICT MIDDLE FORK COUNTY RANDOLPH
 QUADRANGLE CASSITY 7.5'

SURFACE OWNER WESTVACO
 OIL & GAS ROYALTY OWNER HARRY McMULLAN, JR. ESTATE ACREAGE 408
 LEASE NO. 2123 LEASE ACREAGE 408

PROPOSED WORK: DRILL X CONVERT ___ DRILL DEEPER ___ REDRILL ___ FRACTURE OR STIMULATE ___ PLUG OFF OLD FORMATION ___ PERFORATE NEW FORMATION X OTHER PHYSICAL CHANGE IN WELL (SPECIFY) _____

PLUG AND ABANDON ___ CLEAN OUT AND REPLUG ___
 TARGET FORMATION 5th SAND ESTIMATED DEPTH 3,000'
 WELL OPERATOR ALAMCO DESIGNATED AGENT DANIEL L. WHEELER
 ADDRESS P.O. BOX 1740, CLARKSBURG, W.V. 26302-1740 ADDRESS P.O. BOX 1740, CLARKSBURG, W.V. 26302-1740

083 RANDOLPH COUNTY NAME 0927 PERMIT

12/01/2023