

PROPOSED WORK ORDER

THIS IS AN ESTIMATE ONLY:
ACTUAL INFORMATION MUST BE SUBMITTED ON FORM IV-35 UPON COMPLETION

DRILLING CONTRACTOR (IF KNOWN) UNKNOWN
Address _____

GEOLOGICAL TARGET FORMATION, ELK

Estimated depth of completed well, 5500 feet Rotary x / Cable tools _____ /

Approximate water strata depths: Fresh, 150 feet; salt, 0 feet.

Approximate coal seam depths: 0 Is coal being mined in the area? Yes _____ / No x /

CASING AND TUBING PROGRAM

CASING OR TUBING TYPE	SPECIFICATIONS			New	Used	FOOTAGE INTERVALS		CEMENT FILL-UP OR SACKS (Cubic feet)	PACKERS
	Size	Grade	Weight per ft			For drilling	Left in well		
Conductor	11-3/4	cw	45#	x		45'	45'	40 sx	Kinds
Fresh Water	8-5/8	erw	23#	x		1200'	1200'	350 sx	Baker
Coal									Sizes
Intermediate									
Production	4-1/2	erw	10.5#	x		0	5500'	700 sx	Depths set 4000'
Tubing	2-3/8	cw	4.7#	x		0	4000'	0	
Liners									Perforations: est. depth Top 3200' Bottom 5300'

NOTE: Regulation 7.02 of the Department of Mines provides that the original and four copies of Form IV-2 must be filed with the Department, accompanied by (i) a plat in the form prescribed by Regulation 11, (ii) a bond in one of the forms prescribed by Regulation 12, or in lieu thereof the other security allowed by Code § 22-4-2, (iii) Form IV-9, "Reclamation Plan", applicable to the reclamation required by Code § 22-4-12b and Regulation 23, (iv) unless previously paid on the same well, the fee required by Code § 22-4-12a, and (v) if applicable, the consent required by Code § 22-4-8a from the owner of any water well or dwelling within 200 feet of the proposed well.

A separate Form IV-2 shall not be required for fracturing or stimulating a well where fracturing or stimulating is to be part of the work for which a permit is sought and is noted as such on the Form IV-2 filed in connection therewith.

THIS PERMIT MUST BE POSTED AT THE WELL SITE
ALL PROVISIONS BEING IN ACCORDANCE WITH: CHAPTER 22,
ARTICLE 4 OF THE W. VA. CODE, THE LOCATION IS HEREBY
APPROVED FOR drilling **. THIS PERMIT SHALL EXPIRE**
IF OPERATIONS HAVE NOT COMMENCED BY 1-5-83
BY [Signature]

The following waiver must be completed by the coal operator and by any coal owner or coal lessee who has recorded a declaration under Code 22-4-20, if the permit is to be issued within fifteen (15) days of receipt thereof.

WAIVER

The undersigned coal operator _____ / owner _____ / lessee _____ / of the coal under this well location has examined this proposed well location. If a mine map exists which covers the area of the well location, the well location has been added to the mine map. The undersigned has no objection to the work proposed to be done at this location, provided, the well operator has complied with all applicable requirements of the West Virginia Code and the governing regulations.

Date: _____, 19 _____

By _____
Its _____

04/19/2024



DATE APRIL 16 1982

WELL NO. 2 - BYRD

State of West Virginia

API NO. 47 - 085 - 5591

Department of Mines
Oil and Gas Division

CONSTRUCTION AND RECLAMATION PLAN

COMPANY NAME RIMROCK PRODUCTION CORP.

DESIGNATED AGENT ROBERT L. MURDOCK

Address 4424A EMERSON AVE. PARKERSBURG W.V.

Address 4424A EMERSON AVE. PARKERSBURG W.V.

Telephone 304-485-6040

Telephone 304-485-6040

LANDOWNER FRED A & LEONARD BYRD

SOIL CONS. DISTRICT LITTLE KANAWHA

Revegetation to be carried out by RIMROCK PRODUCTION CORP. (Agent)

This plan has been reviewed by Little Kanawha SCD. All corrections and additions become a part of this plan:

4-30-82

(Date)

Jarrett Newton
(SCD Agent)

ACCESS ROAD

LOCATION

Structure DITCH RELIEF CROSS DRAIN (A)

Structure SEE COMMENTS ON BACK (1)

Spacing

Material

Page Ref. Manual I: 4

Page Ref. Manual

Structure DIVERSION DITCH (B)

Structure (2)

Spacing

Material

Page Ref. Manual I: 9

Page Ref. Manual

Structure SEDIMENT BARRIER (C)

Structure (3)

Spacing BRUSH OR STONE

Material

Page Ref. Manual I: 15

Page Ref. Manual

All structures should be inspected regularly and repaired if necessary. All commercial timber is to be cut and stacked and all brush and small timber to be cut and removed from the site before dirt work begins.

REVEGETATION

Treatment Area I & II

Treatment Area III

Lime _____ Tons/acre
or correct to pH 6.5

Lime _____ Tons/acre
or correct to pH _____

Fertilizer 600 lbs/acre
(10-20-20 or equivalent)

Fertilizer _____ lbs/acre
(10-20-20 or equivalent)

Mulch HAY 2 Tons/acre

Mulch _____ Tons/acre

Seed* CROWN VETCH 10 35 lbs/acre

Seed* _____ lbs/acre

KY-31 40 10 lbs/acre

_____ lbs/acre

_____ lbs/acre

_____ lbs/acre

*Inoculate all legumes such as vetch, trefoil and clovers with the proper bacterium. Inoculate with 3X recommended amount.

04/19/2024

PLAN PREPARED BY SMITH LAND SURVEYING

ADDRESS 111 SOUTH STREET

GLENVILLE W.V. 26031

PHONE NO. 304-462-5634

NOTES: Please request landowners' cooperation to protect new seedling for one growing season. Attach separate sheets as necessary for comments.

ATTACH OR PHOTOCOPY SECTION OF INVOLVED TOPOGRAPHIC MAP. QUADRANGLE BURNTHOUSE 7.5'

LEGEND

Well Site ⊕

Access Road ———

WELL SITE PLAN

Sketch to include well location, existing access road, roads to be constructed, wellsite, drilling pits and necessary structures numbered or lettered to correspond with the first part of this plan. Include all natural drainage.

LEGEND

Property boundary		Diversion	
Road		Spring	
Existing fence		Wet spot	
Planned fence		Building	
Stream		Drain pipe	
Open ditch		Waterway	

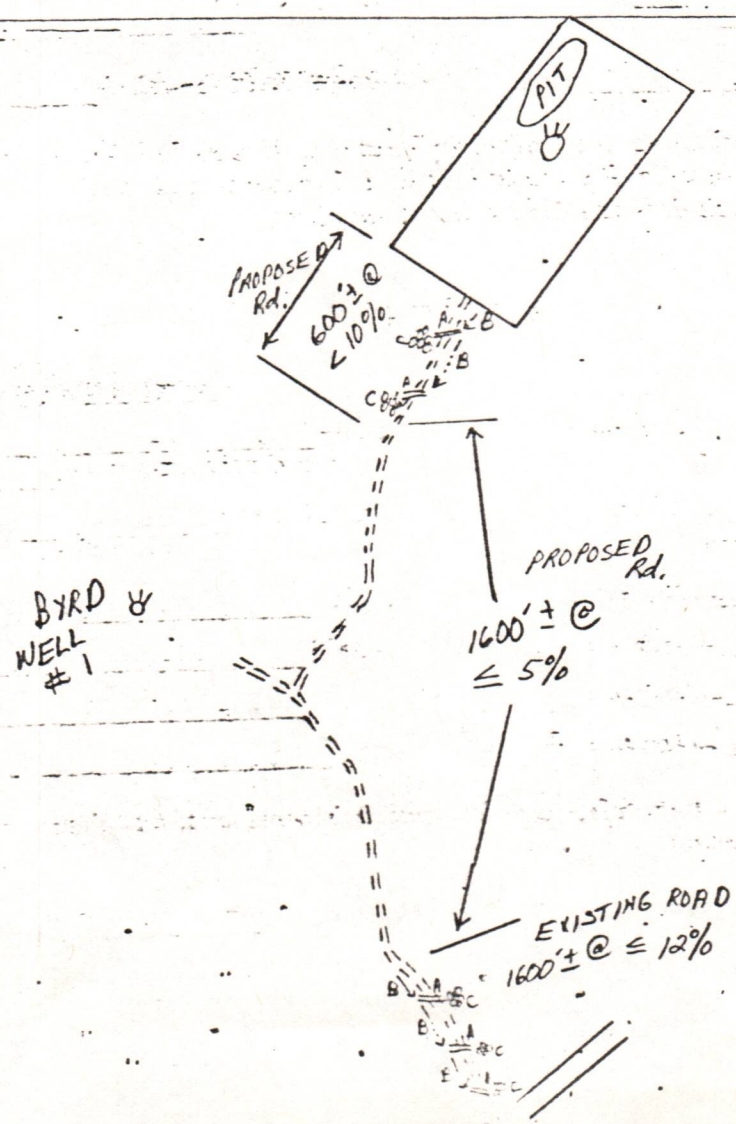

1. LOCATION TO BE MADE ON FLAT ON TOP OF RIDGE.
2. BRUSH & TIMBER TO BE CUT & STACKED.
3. EXISTING ACCESS ROAD TO BE MAINTAINED.

04/19/2024

UNITED STATES
DEPARTMENT OF THE INTERIOR
GEOLOGICAL SURVEY

PROPOSED
Well #2
of Pd

*Cracked
on
original*





State of West Virginia
Department of Mines
Oil and Gas Division
Charleston 25305

WALTER N. MILLER
DIRECTOR

THEODORE M. STREIT
ADMINISTRATOR

August 5, 1983

Samuel Hersman
P.O. Box 66
Smithville, W.Va. 26178

Dear Mr. Hersman:

I am enclosing (2) Plats & Reclamation Plans for the Byrd #1 & Byrd #2 for Rimrock Production Corporation in Ritchie County.

We got a well record that matches Well # 2 - RIT-5591 in accordance with elevation...

The only exception it stated Well # 1 and someone in the office Posted it as RIT-5590 instead of RIT-5591...

Can you go back to these locations and send me a Final Inspection on the well that was actually drilled according to rec. plans and plats that I have enclosed???

The lady from Rimrock called and said the contractor had gotten the wrong permits mixed up at the actual well sites, she tried to explain that RIT-5591 was actually drilled and she would send in a letter stating that RIT-5590 was not drilled.

Just send me in a FINAL INSPECTION for the right well..... and a Final on Cancellation for the other one.

I hate to get in messes like this and I'm sure you feel the same way.

Thank you,

Charlotte Milam

04/19/2024

DETAILS OF PERFORATED INTERVALS, FRACTURING OR STIMULATING, PHYSICAL CHANGE, ETC.

Stage 1 - 4720-5180 - 41 holes

Stage 2 - 3705-4475 - 45 holes

Stage 3 - 2510-3575 - 49 holes

WELL LOG

FORMATION	COLOR	HARD OR SOFT	TOP FEET	BOTTOM FEET	REMARKS Including indication of all fresh and salt water, coal, oil and gas
Sand & Shale			Surface	1500	
Sand, Shale & Lime			1500	1970	
Big Injun Sand			1970	2050	
Shale			2050	2170	
Silt & Shale			2170	2312	
Wier Sand			2312	2378	
Coffee Shale			2380	2416	
Berea Sand			2416	2428	
Silts & Sand			2428	2684	
Gordon Sand			2684	2734	
Shale & Silt			2734	2798	
Fifth Sand			2798	2896	
Devonian Shale			2896	4944	
Alexander			4944	4982	
Shale & Silt			4982	5429	

(Attach separate sheets as necessary)

RIMROCK PRODUCTION CORPORATION

Well Operator

By: Alison Crane

Alison Crane 04/19/2024

Date: May 20, 1982

Note: Regulation 2.02(i) provides as follows:
"The term 'log' or 'well log' shall mean a systematic detailed geological record of all formations, including coal, encountered in the drilling of a well."



IV-35
(Rev 8-81)

Date May 20, 1982
Operator's
Well No. BYRD #2
Farm BYRD
API No. 47 - 085 5591

State of West Virginia
Department of Mines
Oil and Gas Division

WELL OPERATOR'S REPORT (CORRECTED WELL NUMBER & PERMIT)
OF
DRILLING, FRACTURING AND/OR STIMULATING, OR PHYSICAL CHANGE

WELL TYPE: Oil X / Gas X / Liquid Injection / Waste Disposal /
(If "Gas," Production / Underground Storage / Deep / Shallow /)

LOCATION: Elevation: 1116.42' Watershed South Fork of the Hughes River
District: Union County Ritchie Quadrangle Burnthouse 7.5

COMPANY RIMROCK PRODUCTION CORPORATION
ADDRESS 4424 "B" Emerson Ave., Parkersburg, WVA
DESIGNATED AGENT Robert L. Murdock
ADDRESS 4424 "B" Emerson Ave., Parkersburg, WVA
SURFACE OWNER Freda & Leonard Byrd
ADDRESS Harrisville, WVA
MINERAL RIGHTS OWNER Freda & Leonard Byrd
ADDRESS Harrisville, WVA
OIL AND GAS INSPECTOR FOR THIS WORK Deo
Mace ADDRESS Rt. 1, Box 5, Sandridge,
WVA
PERMIT ISSUED
DRILLING COMMENCED May 9, 1982
DRILLING COMPLETED May 14, 1982
IF APPLICABLE: PLUGGING OF DRY HOLE ON
CONTINUOUS PROGRESSION FROM DRILLING OR
REWORKING. VERBAL PERMISSION OBTAINED
ON

Casing & Tubing	Used in Drilling	Left in Well	Cement fill up Cu. ft.
Size 20-16 Cond.			
13-10"	50	0	
9 5/8			
8 5/8	1173	1173	to Surface
7			
5 1/2			
4 1/2	5430	5430	750 sks.
3			
2			
Liners used			

GEOLOGICAL TARGET FORMATION Devonian Shale Depth 2430-5429 feet
Depth of completed well 5429 feet Rotary X / Cable Tools
Water strata depth: Fresh 300 feet; Salt feet
Coal seam depths: 0 Is coal being mined in the area? No

OPEN FLOW DATA

Producing formation Devonian Shale Pay zone depth 2510-5180 feet
Gas: Initial open flow 0 Mcf/d Oil: Initial open flow 0 Bbl/d
Final open flow 220 Mcf/d Final open flow 20 Bbl/d
Time of open flow between initial and final tests hours
Static rock pressure psig (surface measurement) after hours shut in
(If applicable due to multiple completion--)
Second producing formation Pay zone depth feet
Gas: Initial open flow Mcf/d Oil: Initial open flow Bbl/d
Final open flow Mcf/d Oil: Final open flow Bbl/d
Time of open flow between initial and final tests hours
Static rock pressure psig (surface measurement) after hours shut in

(Continue on reverse side)

Rt. 5591

STATE OF WEST VIRGINIA
DEPARTMENT OF MINES
OIL AND GAS WELLS DIVISION

RECEIVED

MAY 18 1982

OIL AND GAS DIVISION
WV DEPARTMENT OF MINES

INSPECTOR'S WELL REPORT

Permit No. 85-359

Oil or Gas Well _____
(KIND)

Company <u>Jim Cook</u>	CASING AND TUBING	USED IN DRILLING	LEFT IN WELL	PACKERS
Address _____	Size			
Farm <u>Buel</u>	16			Kind of Packer _____
Well No. <u>2</u>	13			Size of _____
District <u>Union</u> County <u>Put</u>	10			
Drilling commenced _____	8 1/4			Depth set _____
Drilling completed _____ Total depth _____	6 3/8			
Date shot _____ Depth of shot _____	5 3/16			Perf. top _____
Initial open flow _____ /10ths Water in _____ Inch	3			Perf. bottom _____
Open flow after tubing _____ /10ths Merc. in _____ Inch	2			Perf. top _____
Volume _____ Cu. Ft.	Liners Used			Perf. bottom _____
Rock pressure _____ lbs. _____ hrs.				
OIL _____ bbls., 1st 24 hrs.	CASING CEMENTED <u>8 5/8</u> SIZE <u>1173</u> No. FT. _____ Date <u>5-10-82</u>			
Fresh water _____ feet _____ feet	NAME OF SERVICE COMPANY <u>Halibenton</u>			
Salt water _____ feet _____ feet	COAL WAS ENCOUNTERED AT _____ FEET _____ INCHES			
	_____ FEET _____ INCHES _____ FEET _____ INCHES			
	_____ FEET _____ INCHES _____ FEET _____ INCHES			

Drillers' Names _____

Remarks: CHM #1

5-10-82
DATE

W. J. Mace 04/19/2024
DISTRICT WELL INSPECTOR

STATE OF WEST VIRGINIA
 DEPARTMENT OF MINES
 OIL AND GAS DIVISION
FINAL INSPECTION REQUEST
INSPECTOR'S COMPLIANCE REPORT

RECEIVED
 JAN 19 1984
 OIL & GAS DIVISION
 DEPT. OF MINES

Permit No. 47-085-5591 County Ritchie
 Company Pinnacle Production Corp. Farm Byrd
 Inspector Samuel N. Hersman Well No. Byrd # 2
 Date 1-17-84

RULE	DESCRIPTION	IN COMPLIANCE	
		Yes	No
23.06	Notification Prior to starting Work	_____	_____
25.04	Prepared before Drilling to prevent waste	_____	_____
25.03	High-Pressure Drilling	_____	_____
16.01	Required Permits at wellsite	_____	_____
15.03	Adequate Fresh Water Casing	_____	_____
15.02	Adequate Coal Casing	_____	_____
15.01	Adequate Production Casing	_____	_____
15.04	Adequate Cement Strength	_____	_____
23.02	Maintained Access Roads	✓	_____
25.01	Necessary Equipment to prevent Waste	_____	_____
23.03	Reclaimed Drilling Site	✓	_____
23.04	Reclaimed Drilling Pits	✓	_____
23.05	No surface or underground Pollution	_____	_____
7.03	Identification Markings	✓	_____

COMMENTS: OK to Release

I have inspected the above well and (HAVE/HAVE NOT) found it to be in compliance with all of the rules and regulations of the Office of Oil and Gas Department of Mines of the State of West Virginia.

SIGNED: Samuel N. Hersman
 DATE: 1-17-84

04/19/2024



State of West Virginia
Department of Mines
Oil and Gas Division
Charleston 25305

WALTER N. MILLER
DIRECTOR

THEODORE M. STREIT
ADMINISTRATOR

January 25, 1984

Rimrock Production Corp.
4424 B. Emerson Avenue
Parkersburg, W. Va. 26104

In Re: PERMIT NO: 47-085-5591
FARM: Freda E. & Leonard Byrd
WELL NO: 2
DISTRICT: Union
COUNTY Ritchie

Gentlemen:

The FINAL INSPECTION REPORT for the above described well has been received in this office. Only the column check below applies:

The well designated by the above permit number has been released under your Blanket Bond.

Please return the enclosed cancelled single bond which covered the well designated by the above permit number to the surety company who executed said bond in your behalf, in order that they may give you credit on their records.

Your well record was received and reclamation requirements approved. In accordance with Chapter 22, Article 4, Section 2, the above captioned well will remain under bond coverage for life of the well.

Very truly yours,

Theodore M. Streit, Administrator
Office of Oil & Gas-Dept. Mines

**U.S. DEPARTMENT OF ENERGY
Federal Energy Regulatory Commission
Washington, D.C. 20426**

**APPLICATION FOR DETERMINATION OF THE MAXIMUM LAWFUL
PRICE UNDER THE NATURAL GAS POLICY ACT (NGPA)
(Sections 102, 103, 107 and 108)**

PLEASE READ BEFORE COMPLETING THIS FORM:

General Instructions:

Complete this form if you are applying for price classification under sections 102, 103, 107 or 108 of the NGPA. A separate application is required for each well. If any reservoir qualifies for a category which differs from the category applicable to the producing well, separate applications must be made for the producing well and the reservoir. Complete each appropriate item on the reverse side of this page. The code numbers used in items 4.0 and 6.0 can be obtained from the Buyer/Seller Code Book. If there is more than one purchaser or contract, identify the additional information in the space below. Enter any additional remarks in the space below.

Submit the completed application to the appropriate Jurisdictional Agency as listed in title 18 of the CFR, part 270.103. If there are any questions, call (202) 275-4539.

Specific Instructions for Item 2.0, Type of Determination:

<u>Section of NGPA</u>	<u>Category Code</u>	<u>Description</u>
102	1	New OCS Lease
102	2	New onshore well (2.5 mile test)
102	3	New onshore well (1,000 feet deeper test)
102	4	New onshore reservoir
102	5	New reservoir on old OCS Lease
403	-	New onshore production well
107	-	High cost natural gas
108	-	Stripper well

Other Purchasers/Contracts:

<u>Contract Date (Mo. Day Yr.)</u>	<u>Purchaser</u>	<u>Buyer Code</u>
	Columbia Gas Transmission Corporation	004030

Remarks:

58871 WUL

PARTICIPANTS:

DATE: DEC. 3 1982

BUYER-SELLER CODE

WELL OPERATOR: Rimrock Production Corp.

FIRST PURCHASER: Columbia Gas Trans. Corp.

OTHER: _____

004020

W. Va. Department of Mines, Oil & Gas Division
 WELL DETERMINATION FILE NUMBER
9206 14-107-085-559
 Use Above File Number on all Communications
 Relating to Determination of this Well

QUALIFIED

CHECK EACH ITEM AS COMPLETE OR NOTE WHAT IS MISSING

ITEM NO.

- 1. FERC -121 1 Items not completed - Line No. All 7.0 + 8.0
- 2. IV-1 Agent Robert L. Murdock
- 3. IV-2 Well Permit _____
- 4. IV-6 Well Plat
- 5. IV-35 Well Record Drilling Deepening
- 6. IV-36 Gas-Oil Test: Gas Only Was Oil Produced? Ratio
- 7. IV-39 Annual Production _____ years
- 8. IV-40 90 day Production _____ Days off line: _____
- 9. IV-48 Application for certification. Complete?
- 10-17. IV Form 51 - 52 - 53 - 54 - (55) - 56 - 57 - 58 Complete? Affidavit Signed
- 18-28. Other: Survey _____ Logs _____ Geological Charts _____
 Structure Map _____ 1: 4000 Map _____ Well Tabulations _____
 Gas Analyses _____
- (5) Date commenced: 5-9-82 Date completed 5-14-82 Deepened
- (5) Production Depth: 2510-5180
- (5) Production Formation: Devonian Shale
- (5) Final Open Flow: 220 MCF
- (5) After Frac. R. P. NA
- (6) Other Gas Test: _____
- (7) Avg. Daily Gas from Annual Production: _____
- (8) Avg. Daily Gas from 90-day ending w/1-120 days _____
- (8) Line Pressure: _____ PSIG from Daily Report _____
- (5) Oil Production: _____ From Completion Report _____
- 10-17. Does lease inventory indicate enhanced recovery being done NO
- 10-17. Is affidavit signed? Notarized?
- Does official well record with the Department confirm the submitted information? yes
- Additional information _____ Does computer program confirm? _____
- As Determination Objected to _____ By Whom? _____

04/19/2024

STATE OF WEST VIRGINIA
DEPARTMENT OF MINES OIL AND GAS DIVISION

Date May 20, 1982

Operator's Well No. Byrd #

APR 1982 No. 085 5590 5591

085-5591

WELL CLASSIFICATION FORM
HIGH COST GAS WELL - DEVONIAN SHALE
NGPA Section 107

DESIGNATED AGENT Robert L. Murdock

ADDRESS 4424 "B" Emerson Avenue
Parkersburg, WVA 26104

WELL OPERATOR RIMROCK PRODUCTION CORPORATION LOCATION Elevation 1038'

ADDRESS 4424 B Emerson Avenue Watershed South Fork of the Hughes River
Parkersburg, WVA 26104 Dist. Union County Pleasants Burnthouse 7.5

GAS PURCHASER Columbia Gas Trans. Corp. Gas Purchase Contract No. _____

ADDRESS P.O. Box 1273 Meter Chart Code _____
Charleston, WVA 25325 Date of Contract _____

Date surface drilling began May 8, 1982

Indicate the bottom hole pressure of the well and explain how this was calculated.

AFFIDAVIT

I, Robert L. Murdock, having been first sworn according to law, state that, I have calculated the percentage of footage of the producing interval which is not Devonian shale as indicated by a Gamma Ray index of less than 0.7 if a Gamma Ray log described subparagraph (3)(i) or (3)(ii)(A) has been filed, or as indicated by the report described in subparagraph (3)(ii)(B); I have demonstrated that the percentage of potentially disqualifying non-shale footage is equal to or less than five (5) percent of the gross Devonian age interval; and I have no knowledge of any information not described in the application which is inconsistent with a conclusion that the well qualifies as a high cost natural gas well.

Robert L. Murdock

STATE OF WEST VIRGINIA.

COUNTY OF Wood TO WIT

I, Sherril S. Baker, a Notary Public in and for the state and county aforesaid, do certify that Robert L. Murdock whose name is signed to the writing above, bearing date the 20 day of May, 1982, has acknowledged the same before me, in my county aforesaid

Given under my hand and official seal this 20 day of May, 1982.

My term of office expires on the 9 day of Feb., 1982.

Sherril S. Baker
Notary Public

NOTARIAL SEAL;

04/19/2024