



Date: June 22, 19 82

Operator's Well No. Gardner #1

API Well No. 47 085 5720
State 085 County Permit

STATE OF WEST VIRGINIA
DEPARTMENT OF MINES, OIL AND GAS DIVISION
OIL AND GAS WELL PERMIT APPLICATION

WELL TYPE: Oil x / Gas x /
(If "Gas", Production x / Underground storage / Deep / Shallow /)

LOCATION: Elevation: 1110 Watershed: Comfort Run
District: Grant County: Ritchie Quadrangle: Ellenboro 7.5

WELL OPERATOR Pimrock Production Corp DESIGNATED AGENT Robert L. Murdock
Address 4424 B Emerson Avenue Address 4424 B Emerson Avenue
Parkersburg, W.Va. 26104 Parkersburg, W.Va. 26104

OIL & GAS ROYALTY OWNER Cecil C. Gardner COAL OPERATOR none
Address Rt. 1 Address
St. Mary's 26170

Acres 91.25 COAL OWNER(S) WITH DECLARATION ON RECORD:
Name none

SURFACE OWNER Cecil C. Gardner Name none
Address Rt. 1 Address
St. Mary's 26170

Acres 91.25 Name
FIELD SALE (IF MADE) TO: Address

Address unknown Address

OIL & GAS INSPECTOR TO BE NOTIFIED Name Deo Mace
Name Deo Mace Address

Address Rt. 1 Box 5 Address
Sandridge W.Va.

RECEIVED

JUN 22 1982

OIL AND GAS DIVISION
WV DEPARTMENT OF MINES

The undersigned well operator is entitled to operate for oil or gas purposes at the above location under a deed / lease
assignment other contract x / dated Aug. 41, 19 81, to the undersigned well operator from Carbonit
Exploration Corp
(If said deed, lease, or other contract has been recorded:)

Recorded on Sept. 24, 19 81, in the office of the Clerk of the County Commission of Ritchie County, West
Va., in Lease Book 138 at page 446. A permit is requested as follows:

PROPOSED WORK: Drill x / Drill deeper / Redrill / Fracture or stimulate /
Plug off old formation / Perforate new formation /
Other physical change in well (specify)

 —planned as shown on the work order on the reverse side hereof.

The above named coal operator, coal owner(s), and coal lessee are hereby notified that any objection they wish to make or are required to
make by Code §22-4-3 must be filed with the Department of Mines within fifteen (15) days after the receipt of this Application by the
Department.

Copies of this Permit Application and the enclosed plat and reclamation plan have been mailed by registered mail or delivered by hand to
the above named coal operator, coal owner(s), and coal lessee on or before the day of the mailing or delivery of this Permit Application to
the Department of Mines at Charleston, West Virginia.

PLEASE SUBMIT COPIES OF ALL
GEOPHYSICAL LOGS DIRECTLY
TO:
WEST VIRGINIA OIL AND GAS
CONSERVATION COMMIS-
SION
1615 WASHINGTON STREET EAST
CHARLESTON, WV 25311
TELEPHONE: (304) 348-3092

BLANKET BOND

Pimrock Production Corp
Well Operator
By
Its Agent

04/19/2024

PROPOSED WORK ORDER

THIS IS AN ESTIMATE ONLY:
ACTUAL INFORMATION MUST BE SUBMITTED ON FORM IV-35 UPON COMPLETION

DRILLING CONTRACTOR (IF KNOWN) unknown
Address _____

GEOLOGICAL TARGET FORMATION, gib

Estimated depth of completed well, 5500 feet Rotary X / Cable tools _____ /

Approximate water strata depths: Fresh, 150/310 feet; salt, 610 feet.

Approximate coal seam depths: none Is coal being mined in the area? Yes _____ / No X /

CASING AND TUBING PROGRAM

CASING OR TUBING TYPE	SPECIFICATIONS			New	Used	FOOTAGE INTERVALS		CEMENT FILL-UP OR SACKS (Cubic feet)	PACKERS
	Size	Grade	Weight per ft			For drilling	Left in well		
Conductor	11 3/4	crw	45 [#]	X		350'	350'	CTS	Kinds
Fresh Water	8 5/8	crw	23 [#]	X		1200	1200	350 SKS	Baker
Coal									Sizes
Intermediate									
Production	4 1/2	crw	10.5 [#]	X		0	5500	750 SKS.	Depths set 4000'
Tubing	2 3/8	crw	4.7 [#]	X		0	4000	0	
Liners									Perforations: est. DEPTH
									Top 3200 Bottom 5400

NOTE: Regulation 7.02 of the Department of Mines provides that the original and four copies of Form IV-2 must be filed with the Department, accompanied by (i) a plat in the form prescribed by Regulation 11, (ii) a bond in one of the forms prescribed by Regulation 12, or in lieu thereof the other security allowed by Code § 22-4-2, (iii) Form IV-9, "Reclamation Plan", applicable to the reclamation required by Code § 22-4-12b and Regulation 23, (iv) unless previously paid on the same well, the fee required by Code § 22-4-12a, and (v) if applicable, the consent required by Code § 22-4-8a from the owner of any water well or dwelling within 200 feet of the proposed well.

A separate Form IV-2 shall not be required for fracturing or stimulating a well where fracturing or stimulating is to be part of the work for which a permit is sought and is noted as such on the Form IV-2 filed in connection therewith.

THIS PERMIT MUST BE POSTED AT THE WELL SITE.
ALL PROVISIONS BEING IN ACCORDANCE WITH CHAPTER 22,
ARTICLE 4 OF THE W. VA. CODE, THE LOCATION IS HEREBY
APPROVED FOR drilling **. THIS PERMIT SHALL EXPIRE**
IF OPERATIONS HAVE NOT COMMENCED BY 3-1-83 **.**
BY [Signature]

The following waiver must be completed by the coal operator and by any coal owner or coal lessee who has recorded a declaration under Code 22-4-20, if the permit is to be issued within fifteen (15) days of receipt thereof.

WAIVER

04/19/2024

The undersigned coal operator _____ / owner _____ / lessee _____ / of the coal under this well location has examined this proposed well location. If a mine map exists which covers the area of the well location, the well location has been added to the mine map. The undersigned has no objection to the work proposed to be done at this location, provided, the well operator has complied with all applicable requirements of the West Virginia Code and the governing regulations.

Date: _____, 19 _____

By _____
Its _____

ATTACH OR PHOTOCOPY SECTION OF INVOLVED TOPOGRAPHIC MAP.
QUADRANGLE Ellenboro 7.5

LEGEND











Well Site 

Access Road 

WELL SITE PLAN

Sketch to include well location, existing access road, roads to be constructed, wellsite, drilling pits and necessary structures numbered or lettered to correspond with the first part of this plan. Include all natural drainage.

LEGEND

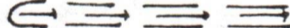
Property boundary 	Diversion 
Road 	Spring 
Existing fence 	Wet spot 
Planned fence 	Building 
Stream 	Drain pipe 
Open ditch 	Waterway 

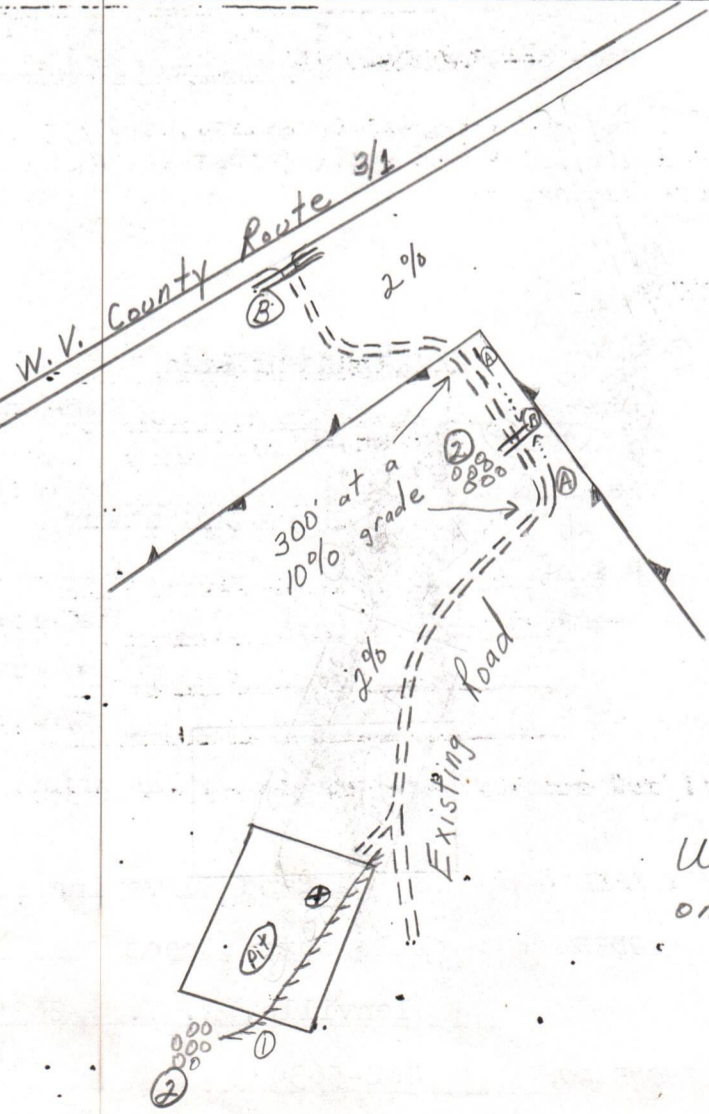

Note: 04/19/2024

Well location to be made on large flat on top of ridge



DATE June 9, 1982

WELL NO. 1

State of West Virginia

API NO. 47-085-5720

Department of Mines

Oil and Gas Division

CONSTRUCTION AND RECLAMATION PLAN

COMPANY NAME Rimrock Production Corp. DESIGNATED AGENT Robert L. Murdock
Address 4424B Emerson AVE., Parkersburg, WV Address 4424B Emerson Ave., Parkersburg
Telephone 428-1520 Telephone 428-1520 WV

LANDOWNER Cecil C. Gardner SOIL CONS. DISTRICT Little Kanawha
Revegetation to be carried out by Rimrock Production Corp. (Agent)

This plan has been reviewed by Little Kanawha SCD. All corrections and additions become a part of this plan: 6-14-82 (Date)
Jarrett Newton (SCD Agent)

ACCESS ROAD	LOCATION
Structure <u>Drainage Ditch</u> (A)	Structure <u>Diversion Ditch</u> (1)
Spacing _____	Material _____
Page Ref. Manual <u>2-12</u>	Page Ref. Manual <u>2-12</u>
Structure <u>Culvert</u>	Structure <u>Sediment Barrier</u> (2)
Spacing <u>Min. (1) 24" Pipe</u>	Material <u>Brush or stone</u>
Page Ref. Manual <u>2-7</u>	Page Ref. Manual <u>2-16</u>
Structure _____ (C)	Structure _____ (3)
Spacing _____	Material _____
Page Ref. Manual _____	Page Ref. Manual _____

RECEIVED

JUN 22 1982

OIL AND GAS DIVISION
WV DEPARTMENT OF MINES

All structures should be inspected regularly and repaired if necessary. All commercial timber is to be cut and stacked and all brush and small timber to be cut and removed from the site before dirt work begins.

REVEGETATION

Treatment Area I & II

Lime _____ Tons/acre
or correct to pH 6.5

Fertilizer 600 lbs/acre
(10-20-20 or equivalent)

Mulch Hay 2 Tons/acre

Seed* KY-31 Tall Fescue 45 lbs/acre
Crownvetch 10 lbs/acre
_____ lbs/acre

~~XXXXXXXXXXXXXXXXXXXX~~

Lime _____ Tons/acre
or correct to pH _____

Fertilizer _____ lbs/acre
(10-20-20 or equivalent)

Mulch _____ Tons/acre

Seed* _____ lbs/acre
_____ lbs/acre
_____ lbs/acre

*Inoculate all legumes such as vetch, trefoil and clovers with the proper bacterium. Inoculate with 3X recommended amount.

04/19/2024

PLAN PREPARED BY Smith Land Surveying

ADDRESS 111 South Street

Glenville, W. V. 26351

PHONE NO. 462-5634

NOTES: Please request landowners' cooperation to protect new seedling for one growing season. Attach separate sheets as necessary for comments.

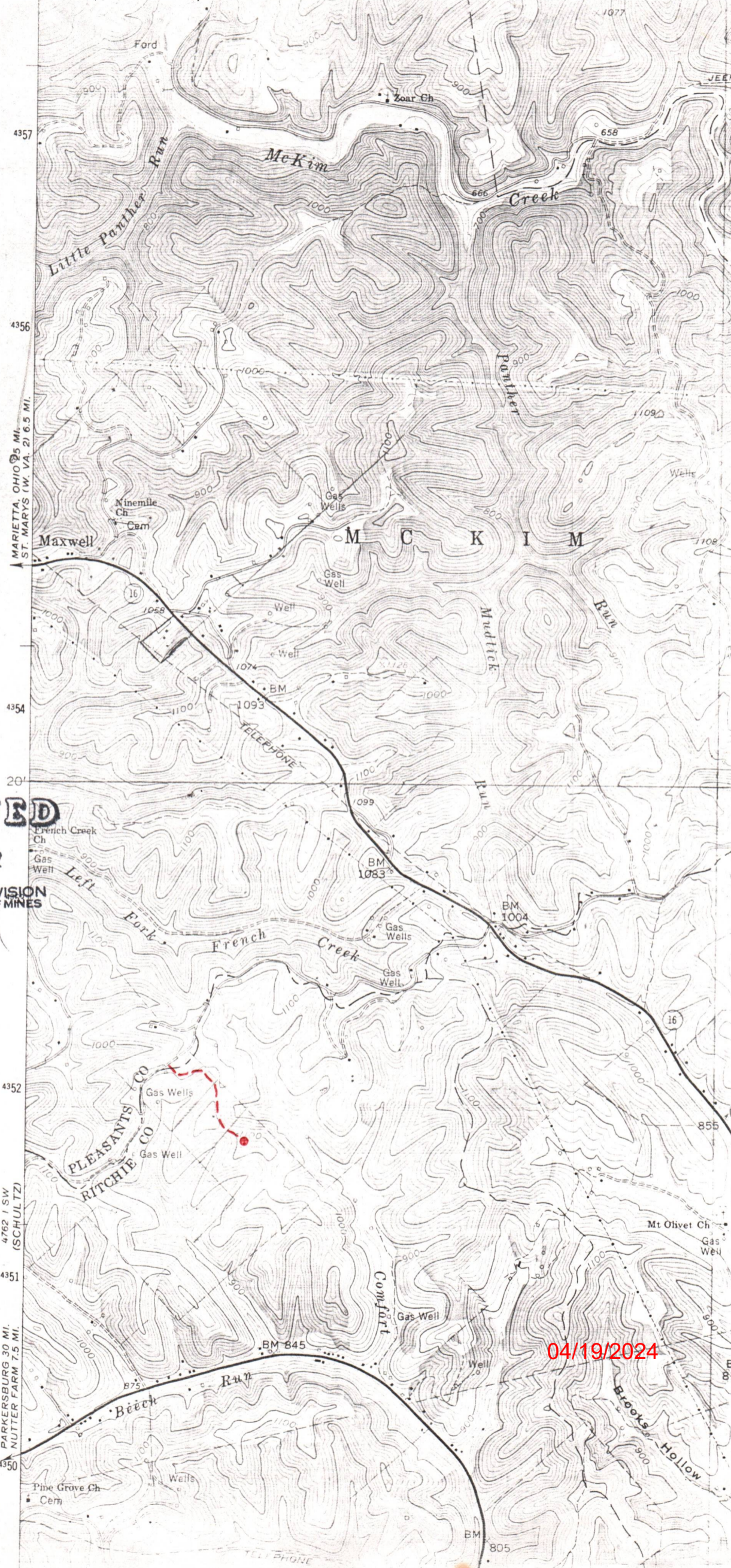

4357
4356
4354
20'
4352
4351
4350

MARIETTA, OHIO 25 MI.
ST. MARYS (W. VA. 2) 6.5 MI.

4762 1 SW
(SCHULTZ)

PARKERSBURG 30 MI.
NUTTER FARM 7.5 MI.

RECEIVED

JUN 22 1982

OIL AND GAS DIVISION
WV DEPARTMENT OF MINES

04/19/2024

RECEIVED

JUN 25 1982

OIL AND GAS DIVISION
U.S. DEPARTMENT OF THE INTERIOR

04/19/2024



RECEIVED

JUN 22 1982

OIL AND GAS DIVISION
WV DEPARTMENT OF MINES

State of West Virginia
Department of Mines
Oil and Gas Division
Charleston 25305

TO: ALL OPERATORS
FROM: Theodore M. Streit, Administrative Assistant
RE: New Permit Application Forms

DATE: June 10, 1982

On March 13, 1982, the legislature passed HB-154 which goes into effect June 11, 1982. This bill requires proof of one-eighth (1/8) royalty payment to the royalty owners before any well permit can be issued.

We are at the present time printing up new Permit Application Forms which should be available by next month. In the meantime you will be required to send in a notarized affidavit (sample copy below) with each permit application.

Gardner #1

AFFIDAVIT

I, Robert L. Murdock (the above designated owner or operator, or authorized representative thereof) hereby verifies that the owner or owners of the mineral estate upon which this proposed well is to be located will receive minimum one-eighth (1/8) royalty payments for any gas or oil extracted therefrom. Copies of the Permit Application and the enclosed plat and reclamation plan have been mailed by registered mail or delivered by hand to the above-named coal operator, co-owner(s), and coal lessee on or before the day of the mailing or delivery of this Permit Application to the Department of Mines at Charleston, West Virginia.

Signed: Robert L. Murdock
(Owner, Operator, or Authorized Representative)

Notary: Candace D. Wine (Signed)

My commission expires October 19, 1991

085-5720

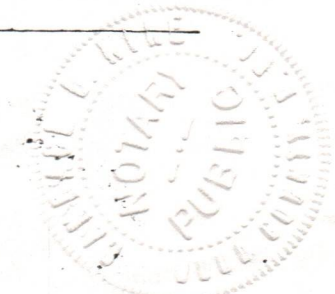

04/19/2024

RECEIVED

JUN 2 1985

OIL AND GAS DIVISION
WV DEPARTMENT OF MINES



04/19/2024

DETAILS OF PERFORATED INTERVALS, FRACTURING OR STIMULATING, PHYSICAL CHANGE, ETC.

Stage 1 - 4080 - 4850- 22 holes 850,000 scf N2 500 Gal. acid
 Stage 2 - 2630 - 4020 - 34 holes 1,190,000 scf N2 250 Gal. acid

WELL LOG

FORMATION	COLOR	HARD OR SOFT	TOP FEET	BOTTOM FEET	REMARKS
					Including indication of all fresh and salt water, coal, oil and gas
Soil			0	15	
Sandstone & Shale			15	50	
Sandstone & Shale			50	100	
Sandstone & Shale			100	200	
Sandstone & Shale			200	300	
Sandstone & Shale			300	400	
Siltstone			400	500	
Sandstone			500	600	
Sandstone & Siltstone			600	700	
Sandstone & Siltstone			700	800	
Sandstone & Siltstone			800	900	
Sandy Siltstone			900	1000	
Sandstone & Siltstone			1000	1100	
Sandstone & Shale			1100	1200	
Sandstone & Shale			1200	1300	
Sandstone & Shale			1300	1400	
Sandstone & Shale & Lime			1400	1500	
Sandstone & Shale			1500	1600	
Sandstone & Shale			1600	1700	
Sandstone & Shale			1700	1800	
Sandstone & Shale & Lime			1800	1900	
Sandstone & Shale			1900	1964	
Big Injun			1964	2093	
Shale			2093	2100	
Shale			2100	2200	
Shale & Siltstone			2200	2300	
Siltstone & Shale			2300	2400	
Shale			2400	2461	
Berea			2461	2467	
Sandy Siltstone & Shale			2467	2875	
Fifth Sand			2875	2883	
Shale			2883	3000	
Shale			3000	3500	
Shale & Siltstone			3500	4000	
Shale & Siltstone			4000	4500	
Shale			4500	4894	

(Attach separate sheets as necessary)

Rimrock Production Corporation

Well Operator

By: Karp E. Mc Kimmie - Agent 04/19/2024

Date: October 18, 1982

Note: Regulation 2.02(i) provides as follows:
 "The term 'log' or 'well log' shall mean a systematic detailed geological record of all formations, including coal, encountered in the drilling of a well."

RECEIVED



IV-35 (Rev 8-81) NOV 5 - 1982

OIL AND GAS DIVISION WV DEPARTMENT OF MINES

State of West Virginia Department of Mines Oil and Gas Division

Date October 18, 1982 Operator's Well No. #1 Farm Gardner API No. 47 - 085 - 5720

WELL OPERATOR'S REPORT OF DRILLING, FRACTURING AND/OR STIMULATING, OR PHYSICAL CHANGE

WELL TYPE: Oil x / Gas x / Liquid Injection / Waste Disposal / (If "Gas," Production x / Underground Storage / Deep / Shallow x /)

LOCATION: Elevation: 1110' Watershed Comfort Run District: Grant County Ritchie Quadrangle Ellenboro 7.5'

COMPANY Rimrock Production Corporation ADDRESS 4424 "B" Emerson Ave. Parkersburg, WV DESIGNATED AGENT Robert L. Murdock ADDRESS 4424 "B" Emerson, Parkersburg, WV 26101 SURFACE OWNER Cecil C. Gardner ADDRESS Rt. #1 St. Mary's, WV 26170 MINERAL RIGHTS OWNER Cecil C. Gardner ADDRESS Rt. #1 - St. Mary's, WV 26170 OIL AND GAS INSPECTOR FOR THIS WORK Sam Hersman ADDRESS Box 66, Smithville, WV PERMIT ISSUED DRILLING COMMENCED August 24, 1982 DRILLING COMPLETED August 28, 1982 IF APPLICABLE: PLUGGING OF DRY HOLE ON CONTINUOUS PROGRESSION FROM DRILLING OR REWORKING. VERBAL PERMISSION OBTAINED ON

Table with 4 columns: Casing & Tubing Size, Used in Drilling, Left in Well, Cement fill up Cu. ft. Rows include sizes 20-16, 13-10 3/4, 9 5/8, 8 5/8, 7, 5 1/2, 4 1/2, 3, 2, and Liners used.

GEOLOGICAL TARGET FORMATION Devonian Shale Depth feet Depth of completed well 4894 feet Rotary x / Cable Tools Water strata depth: Fresh 210 feet; Salt 460 feet Coal seam depths: Is coal being mined in the area? No

OPEN FLOW DATA Producing formation Devonian Shale Pay zone depth 2630-4850 feet Gas: Initial open flow 0 Mcf/d Oil: Initial open flow 0 Bbl/d Final open flow 126 Mcf/d Final open flow 0 Bbl/d Time of open flow between initial and final tests 24 hours Static rock pressure 500 psig (surface measurement) after 24 hours shut in (If applicable due to multiple completion--)

04/19/2024

(Continue on reverse side)

KIT - 5/1/80

STATE OF WEST VIRGINIA
DEPARTMENT OF MINES
OIL AND GAS WELLS DIVISION

RECEIVED

AUG 26 1982

OIL AND GAS DIVISION
WV DEPARTMENT OF MINES

INSPECTOR'S WELL REPORT

Permit No. 85-5720

Oil or Gas Well _____
(KIND)

Company Rimrock Prod. Corp.
 Address _____
 Farm Cecil C Gardner
 Well No. Gardner #1
 District Grant County Put
 Drilling commenced 8-23-82
 Drilling completed _____ Total depth _____
 Date shot _____ Depth of shot _____
 Initial open flow _____ /10ths Water in _____ Inch
 Open flow after tubing _____ /10ths Merc. in _____ Inch
 Volume _____ Cu. Ft.
 Rock pressure _____ lbs. _____ hrs.
 Oil _____ bbls., 1st 24 hrs.
 Fresh water _____ feet _____ feet
 Salt water _____ feet _____ feet

CASING AND TUBING	USED IN DRILLING	LEFT IN WELL	PACKERS
Size			
16			Kind of Packer _____
13			
10			Size of _____
8 1/4			
6 5/8			Depth set _____
5 3/16			
3			Perf. top _____
2			Perf. bottom _____
Liners Used			Perf. top _____
			Perf. bottom _____

CASING CEMENTED _____ SIZE _____ No. FT. _____ Date _____
 NAME OF SERVICE COMPANY _____
 COAL WAS ENCOUNTERED AT _____ FEET _____ INCHES
 _____ FEET _____ INCHES FEET _____ INCHES
 _____ FEET _____ INCHES FEET _____ INCHES

Drillers' Names Kennedy Drennon / Willard Speece / A.P. Collins
 Contractor F.W.A. Rig # 23 Tool Pusher
 Remarks: Horley Jors
Moved on location - Rig up - start Drilling

8-23-82
DATE

Samuel W. Huisman 04/19/2024
DISTRICT WELL INSPECTOR

STATE OF WEST VIRGINIA
DEPARTMENT OF MINES
OIL AND GAS WELLS DIVISION

INSPECTOR'S PLUGGING REPORT

Permit No. _____

Well No. _____

COMPANY _____ ADDRESS _____

FARM _____ DISTRICT _____ COUNTY _____

Filling Material Used _____

Liner		Location	Amount	Packer	Location		
PLUGS USED AND DEPTH PLACED			BRIDGES		CASING AND TUBING		
CEMENT-THICKNESS	WOOD-SIZE	LEAD	CONSTRUCTION-LOCATION		RECOVERED	SIZE	LOST

Drillers' Names _____

Remarks: _____

_____ I hereby certify I visited the above well on this date.
DATE

04/19/2024
DISTRICT WELL INSPECTOR

STATE OF WEST VIRGINIA
DEPARTMENT OF MINES
OIL AND GAS WELLS DIVISION

RECEIVED

AUG 2 - 1982

OIL AND GAS DIVISION
WV DEPARTMENT OF MINES

INSPECTOR'S WELL REPORT

Permit No. 85-5720

Oil or Gas Well _____
(KIND)

Company Rimrock Production Corp.
 Address _____
 Farm Cecil C. Gardner
 Well No. Gardner #1
 District Grant County Rit
 Drilling commenced 8-24-82
 Drilling completed _____ Total depth _____
 Date shot _____ Depth of shot _____
 Initial open flow _____ /10ths Water in _____ Inch
 Open flow after tubing _____ /10ths Merc. in _____ Inch
 Volume _____ Cu. Ft.
 Rock pressure _____ lbs. _____ hrs.
 Oil _____ bbls., 1st 24 hrs.
 Fresh water _____ feet _____ feet
 Salt water _____ feet _____ feet

CASING AND TUBING	USED IN DRILLING	LEFT IN WELL	PACKERS
Size			
16			Kind of Packer _____
13			
10			Size of _____
8 1/4			
6 3/8			Depth set _____
5 3/16			
3			Perf. top _____
2			Perf. bottom _____
Liners Used			Perf. top _____
			Perf. bottom _____

CASING CEMENTED _____ SIZE _____ No. FT. _____ Date _____
 NAME OF SERVICE COMPANY _____
 COAL WAS ENCOUNTERED AT _____ FEET _____ INCHES
 _____ FEET _____ INCHES FEET _____ INCHES
 _____ FEET _____ INCHES FEET _____ INCHES

Drillers' Names Kenney Drennen-Willard Speece - A.P. Collins
F.W.A. Rig # 23 Harley Jars
 Remarks: _____

Ran 1215 foot of 8 5/8 casing 300 sacks
Cemented by Nowaco
Plug down at 9:00 A.M.

8-25-82
DATE

Samuel M. Ferman 04/19/2024
DISTRICT WELL INSPECTOR

Form 26
2/16/82

STATE OF WEST VIRGINIA
DEPARTMENT OF MINES
OIL AND GAS WELLS DIVISION

INSPECTOR'S PLUGGING REPORT

Permit No. _____

Well No. _____

COMPANY _____ ADDRESS _____

FARM _____ DISTRICT _____ COUNTY _____

Filling Material Used _____

Liner	Location	Amount	Packer	Location		
PLUGS USED AND DEPTH PLACED			BRIDGES	CASING AND TUBING		
CEMENT-THICKNESS	WOOD-SIZE	LEAD	CONSTRUCTION-LOCATION	RECOVERED	SIZE	LOST

Drillers' Names _____

Remarks: _____

_____ DATE I hereby certify I visited the above well on this date.

04/19/2024
DISTRICT WELL INSPECTOR

STATE OF WEST VIRGINIA
DEPARTMENT OF MINES
OIL AND GAS WELLS DIVISION

APPROVED
MAY 3 1983

INSPECTOR'S WELL REPORT

OIL & GAS DIVISION
DEPT. OF MINES

Permit No. 85-5720

Oil or Gas Well _____
(KIND)

Company <u>Pinnacle Prod. Corp.</u>	CASING AND TUBING	USED IN DRILLING	LEFT IN WELL	PACKERS
Address _____	Size			
Farm <u>Gardner</u>	16			Kind of Packer _____
Well No. <u>1</u>	13			
District <u>Grant</u> County <u>Pitcher</u>	10			Size of _____
Drilling commenced _____	8 1/4			
Drilling completed _____ Total depth _____	6 5/8			Depth set _____
Date shot _____ Depth of shot _____	5 3/16			
Initial open flow _____ /10ths Water in _____ Inch	3			Perf. top _____
Open flow after tubing _____ /10ths Merc. in _____ Inch	2			Perf. bottom _____
Volume _____ Cu. Ft.	Liners Used _____			Perf. top _____
Rock pressure _____ lbs. _____ hrs.				Perf. bottom _____
Oil _____ bbls., 1st 24 hrs.	CASING CEMENTED _____ SIZE _____ No. FT. _____ Date _____			
Fresh water _____ feet _____ feet	NAME OF SERVICE COMPANY _____			
Salt water _____ feet _____ feet	COAL WAS ENCOUNTERED AT _____ FEET _____ INCHES			
	_____ FEET _____ INCHES _____ FEET _____ INCHES			
	_____ FEET _____ INCHES _____ FEET _____ INCHES			

Drillers' Names _____

Remarks: Final inspection OK to Release

4-29-83
DATE

Samuel W. K... 10/19/2024
DISTRICT WELL INSPECTOR

Form 26
2/16/82

STATE OF WEST VIRGINIA
DEPARTMENT OF MINES
OIL AND GAS WELLS DIVISION

INSPECTOR'S PLUGGING REPORT

Permit No. _____

Well No. _____

COMPANY _____ ADDRESS _____

FARM _____ DISTRICT _____ COUNTY _____

Filling Material Used _____

Liner Location Amount Packer Location

PLUGS USED AND DEPTH PLACED			BRIDGES	CASING AND TUBING		
CEMENT-THICKNESS	WOOD-SIZE	LEAD	CONSTRUCTION-LOCATION	RECOVERED	SIZE	LOST

Drillers' Names _____

Remarks: _____

_____ I hereby certify I visited the above well on this date.
DATE



State of West Virginia
Department of Mines
Oil and Gas Division
Charleston 25305

WALTER N. MILLER
DIRECTOR

THEODORE M. STREIT
ADMINISTRATOR

May 9, 1983

Rimrock Production Corporation
4424 Emerson Avenue
Parkersburg, W. Va. 26101

Gentlemen:

The required records and reports have been received in this office and the District Inspectors have submitted FINAL INSPECTIONS for the following wells listed below:

<u>PERMIT NUMBER</u>	<u>FARM AND WELL NUMBER</u>	<u>DISTRICT</u>
RIT-5455-FRAC.	E. C. Curry, #1	Union
RIT-5469	Olin D. Baker/Lettie M. Baker #1	Clay
RIT-5516-REFRAC.	Walter A. Crane Heirs, #1	Union
RIT-5590	Freda & Leonard Byrd, #1	Union
RIT-5611	Martin Corbin, et al, #1	Grant
RIT-5680	Walter A. Crane Heirs, "A" #1	Union
RIT-5685	Grace Cox, et al, #1	Union
RIT-5698	Carl Dotson, #1	Grant
RIT-5709	Merrill G. Hedrick, #1	Grant
RIT-5711	Merrill G. Hedrick, #2	Grant
RIT-5718	Elsie Cameron, Agent, #1	Union
RIT-5720	Cecil C. Gardner, #1	Grant
RIT-5752	Emmett Moyers, #1	Grant
RIT-5844	Arrahwanna Pifer, #1	Grant
RIT-5845	Floyd Pifer, et al, #1	Grant

In accordance with Chapter 22, Article 4, Section 2, the above captioned wells will remain under bond coverage for "life of wells." Reclamation requirements have been approved.....

Very truly yours,

Theodore M. Streit, Administrator
Office of Oil & Gas-Dept. Mines

TMS/

04/19/2024

map 6/24/82

8000

GARDNER LEASE WELL NO. 1

POST LATITUDE 39° 20' 00"

LONGITUDE 81° 05' 00"

NORTH

12" WHITE ASH
N 42° W
99'

S 42° W
165'

N 42° W
717.75'

N 45° 01' E
1210.82'

S 71° 06' W
839.46'

N 6° 04' E
587.38'

S 42° E
850'

S 42° W
1072.5'

20 ACRES ±

WELL NO. 1

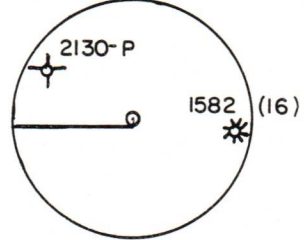

FILE NO. 6-67
 DRAWING NO. _____
 SCALE 1" = 200'
 MINIMUM DEGREE OF ACCURACY 1/200'
 PROVEN SOURCE OF ELEVATION B.M. AT ROAD
 ELEV. 845'

I THE UNDERSIGNED, HEREBY CERTIFY THAT THIS PLAT IS CORRECT TO THE BEST OF MY KNOWLEDGE AND BELIEF AND SHOWS ALL THE INFORMATION REQUIRED BY LAW AND THE REGULATIONS ISSUED AND PRESCRIBED BY THE DEPARTMENT OF MINES.
 (SIGNED) Gregory A. Smith
 R.P.E. _____ L.L.S. 677

PLACE SEAL HERE

(+) DENOTES LOCATION OF WELL ON UNITED STATES TOPOGRAPHIC MAPS
 FORM IV-6
 (8-78)



DATE JUNE 14, 1982
 OPERATOR'S WELL NO. 1
 API WELL NO. 47-085-5720
 STATE COUNTY PERMIT

STATE OF WEST VIRGINIA
 DEPARTMENT OF MINES
 OIL AND GAS DIVISION

WELL TYPE: OIL ___ GAS X LIQUID INJECTION ___ WASTE DISPOSAL ___
 (IF "GAS,") PRODUCTION ___ STORAGE X DEEP ___ SHALLOW X
 LOCATION: ELEVATION 1110' WATER SHED COMFORT RUN
 DISTRICT GRANT COUNTY RITCHIE
 QUADRANGLE ELLENBORO 7.5'
 SURFACE OWNER CECIL C. GARDNER ACREAGE 20
 OIL & GAS ROYALTY OWNER CECIL C. GARDNER LEASE ACREAGE 91.25
 LEASE NO. _____
 PROPOSED WORK: DRILL X CONVERT ___ DRILL DEEPER ___ REDRILL ___ FRACTURE OR STIMULATE ___ PLUG OFF OLD FORMATION ___ PERFORATE NEW FORMATION ___ OTHER PHYSICAL CHANGE IN WELL (SPECIFY) _____
 PLUG AND ABANDON ___ CLEAN OUT AND REPLUG ___
 TARGET FORMATION MARCELLUS ESTIMATED DEPTH 5325'
 WELL OPERATOR RIMROCK PROD. CO. DESIGNATED AGENT ROBERT MURDOCK
 ADDRESS 4424 - B EMERSON AVE. PARKERSBURG W.V. 26101 ADDRESS 4424 - B EMERSON AVE. PARKERSBURG W.V. 26101

04/19/2024