



STATE OF WEST VIRGINIA
DEPARTMENT OF MINES

RECEIVED

JUL 19 1982

OIL AND GAS DIVISION
WV DEPARTMENT OF MINES

Oil and Gas Division

OIL AND GAS WELL PERMIT APPLICATION

TO THE DEPARTMENT OF MINES,
Charleston, W. Va.

DATE July 16, 1982

Surface Owner Robert L. Drane
Address Auburn, West Va. 26325

Company Carnegie Natural Gas Company
Address 3904 Main St. Munhall, Pa. 15120

Mineral Owner Robert L. Drane
Address Auburn, W.Va. 26325

Farm R. L. Drane Acres 46.18

Location (waters) Brushy Fork

Coal Owner _____
Address _____

Well No. 1-1875 Elevation 815'

Coal Operator _____
Address _____

District Union County Ritchie

Quadrangle Burnt House

RECEIVED

JUL 22 1982
OIL AND GAS DIVISION
WV DEPARTMENT OF MINES

INSPECTOR

TO BE NOTIFIED Sam Hershman

ADDRESS _____

PHONE 477-3597

GENTLEMEN:

The undersigned well operator is entitled to drill upon the above named farm or tract of land for oil and gas, having fee title thereto, (or as the case may be) under grant or lease dated August 4, 1980 by Robert L. Drane made to Carnegie Natural Gas Company and recorded on the 16 day of July 1980, in Ritchie County, Book 132 Page 76

NEW WELL DRILL DEEPER REDRILL FRACTURE OR STIMULATE
OIL AND GAS WELL ORIGINALLY DRILLED BEFORE JUNE 5, 1969.

The enclosed plat was prepared by a registered engineer or licensed land surveyor and all coal owners and/or operators have been notified as of the above date.

The above named coal owners and/or operator are hereby notified that any objection they wish to make, or are required to make by Section 3 of the Code, must be received by, or filed with the Department of Mines within ten (10) days. *

Copies of this notice and the enclosed plat were mailed by registered mail, or delivered to the above named coal operators or coal owners at their above shown respective address _____ day _____ before, or on the same day with the mailing or delivery of this copy to the Department of Mines at Charleston, West Virginia.

PLEASE SUBMIT COPIES OF ALL
GEOPHYSICAL LOGS DIRECTLY TO:

WEST VIRGINIA GEOLOGICAL AND
ECONOMIC SURVEY
P. O. BOX 879
MORGANTOWN, WEST VIRGINIA 26505
AC-304 - 292-6331

Address
of
Well Operator

Very truly yours, Carnegie Natural Gas Company
(Sign Name) James C. Stephenson
Well Operator

3904 Main Street,
Street
Munhall, Pa. 15120
City or Town

State 04/12/2024

*SECTION 3 If no objections are filed or found by the Department of mines, within said period of ten days from the receipt of notice and plat by the department of mines, to said proposed location, the department shall forthwith issue to the well operator a permit reciting the filing of such plat, that no objections have been made by the coal operators or found thereto by the department and that the same is approved and the well operator authorized to proceed.

47-085-5777

PERMIT NUMBER

BLANKET BOND

THIS IS AN ESTIMATE ONLY
ACTUAL INFORMATION WILL BE SUBMITTED ON OG-10 UPON COMPLETION

PROPOSED WORK ORDER TO X DRILL _____ DEEPEN _____ FRACTURE-STIMULATE _____
 DRILLING CONTRACTOR: (If Known) _____ RESPONSIBLE AGENT: _____
 NAME S. W. Jack Drilling Company NAME J. C. Stephenson, Div. Supt.
 ADDRESS P.O. Box #48, Buckhannon, W.Va. 26201 ADDRESS Mannington, W.Va. 26582
 TELEPHONE 304-472-9403 TELEPHONE 304-986-2060
 ESTIMATED DEPTH OF COMPLETED WELL: 5050' ROTARY X CABLE TOOLS _____
 PROPOSED GEOLOGICAL FORMATION: Alexander
 TYPE OF WELL: OIL _____ GAS _____ COMB. _____ STORAGE _____ DISPOSAL _____
 RECYCLING _____ WATER FLOOD _____ OTHER _____

TENTATIVE CASING PROGRAM:

CASING AND TUBING SIZE	USED FOR DRILLING	LEFT IN WELL	CEMENT FILL UP OR SACKS - CUBIC FT.
20 - 16 11-3/4"	200'	200'	Cement to surface
13 - 10'			
9 - 5/8			
8 - 5/8	1750'	1750'	Cement to surface
7			
5 1/2			
4 1/2	5050'	5050'	2500' of fillup
3			Perf. Top
2			Perf. Bottom
Liners			Perf. Top
			Perf. Bottom

APPROXIMATE FRESH WATER DEPTHS 100' FEET _____ SALT WATER _____ FEET _____
 APPROXIMATE COAL DEPTHS _____
 IS COAL BEING MINED IN THE AREA? No BY WHOM? _____

TO DRILL:

SUBMIT FIVE (5) COPIES OF OG - 1, \$100.00 PERMIT FEE, PERFORMANCE BOND AND PERMANENT COPY OF PLAT.

TO DRILL DEEPER OR REDRILL:

SUBMIT FIVE (5) COPIES OF OG - 1, SHOWING ORIGINAL PERMIT NUMBER AND PERFORMANCE BOND. ON WELLS DRILLED PRIOR TO 1929, A PERMANENT COPY OF THE PLAT AND THE ORIGINAL WELL RECORD MUST ALSO BE SUBMITTED.

TO FRACTURE - STIMULATE:

OIL AND/OR GAS WELL ORIGINALLY DRILLED BEFORE JUNE 5, 1929, FIVE (5) COPIES OG - 1, PERFORMANCE BOND, PERMANENT PLAT AND ORIGINAL WELL RECORD.

OIL AND/OR GAS WELL ORIGINALLY DRILLED ON AND/OR AFTER JUNE 5, 1929, FIVE COPIES OG - 1, SHOWING ORIGINAL PERMIT NUMBER, AND PERFORMANCE BOND.

Required forms must be filed within ninety (90) days of completion for bond release. Inspector to be notified twenty-four (24) hours in advance.

The following waiver must be completed by the coal operator if the permit is to be issued within ten days of receipt thereof.

WAIVER: I the undersigned, Agent for _____ Coal Company, Owner or Operator of the coal under this lease have examined and place on our mine maps this proposed well location.

We the _____ Coal Company have no objections to said well being drilled at this location, providing operator has complied with all rules and regulations in Articles 4, 5, and 7, Chapter 22 of the West Virginia Code. 04/12/2024

THIS PERMIT MUST BE POSTED AT THE WELL SITE
ALL PROVISIONS BEING IN ACCORDANCE WITH CHAPTER 22,
ARTICLE 4 OF THE W. VA. CODE, THE LOCATION IS HEREBY
 APPROVED FOR drilling . THIS PERMIT SHALL EXPIRE
 IF OPERATIONS HAVE NOT COMMENCED BY 3-27-83
 BY [Signature]

 For Coal Company

 Official Title

MARKET BOND

ATTACH OR PHOTOCOPY SECTION OF INVOLVED TOPOGRAPHIC MAP. QUADRANGLE Burnt House

LEGEND

Well Site 



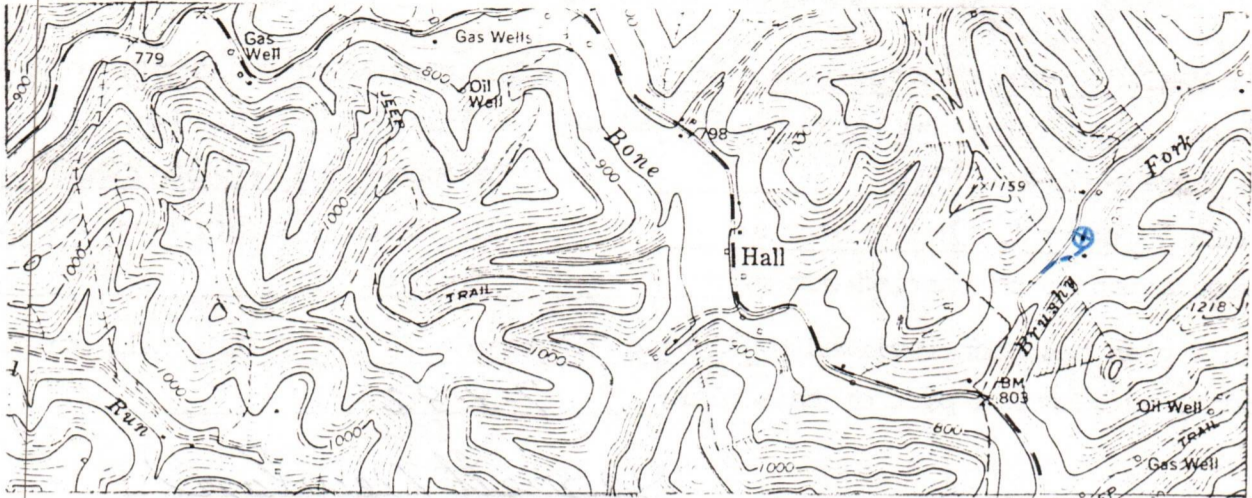





Access Road 

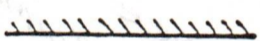

WELL SITE PLAN

Sketch to include well location, existing access road, roads to be constructed, wellsite, drilling pits and necessary structures numbered or lettered to correspond with the first part of this plan. Include all natural drainage.

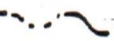
LEGEND

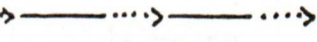
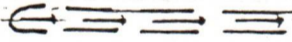
Property boundary 	Diversion 
Road 	Spring 
Existing fence 	Wet spot 
Planned fence 	Building 
Stream 	Drain pipe 
Open ditch 	Waterway 

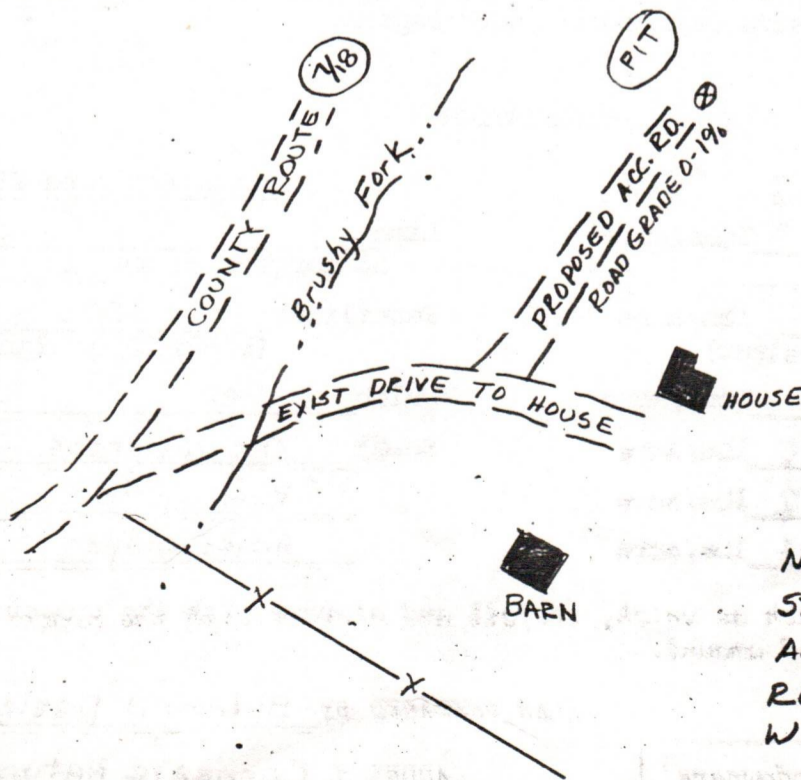

NOTE: WILL USE EXISTING STABILIZED STREAM CROSSING AND DRIVE WHERE PRACTICAL. REMAINDER OF ROADWAY WILL BE IN FLAT BOTTOM.

04/12/2024



DATE 6-14-82

WELL NO. 1-1875

API NO. 47-085-5777

IV-9
(Rev 8-81)

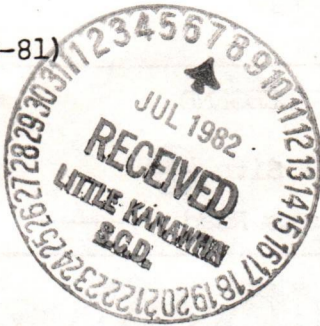

State of West Virginia

Department of Mines

Oil and Gas Division

CONSTRUCTION AND RECLAMATION PLAN

COMPANY NAME Carnegie Natural Gas Co.
Address 3904 Main St., Munhall, Pa. 15120
Telephone 412-462-7121

DESIGNATED AGENT J.C. Stephenson, Div. Supt.
Address P.O. Box 387, Mannington, W.V. 26582
Telephone 304-986-2060

LANDOWNER Robert L. Drane et al
Revegetation to be carried out by _____

SOIL CONS. DISTRICT Little Kanawha
Same (Agent)

This plan has been reviewed by Little Kanawha SCD. All corrections and additions become a part of this plan: 7-8-82

(Date)

Jarrett Newlon
(SCD Agent)

ACCESS ROAD

LOCATION

Structure None (A)

Structure None (1)

Spacing _____

Material _____

Page Ref. Manual _____

Page Ref. Manual _____

Structure see sketch (B)

Structure JUL 22 1982 (2)

Spacing and comment

Material _____

Page Ref. Manual _____

Page Ref. Manual _____

Structure _____ (C)

Structure _____ (3)

Spacing _____

Material _____

Page Ref. Manual _____

Page Ref. Manual _____

All structures should be inspected regularly and repaired if necessary. All commercial timber is to be cut and stacked and all brush and small timber to be cut and removed from the site before dirt work begins.

REVEGETATION

Treatment Area I

Treatment Area II

Lime _____ Tons/acre
or correct to pH 6.5

Lime _____ Tons/acre
or correct to pH 6.5

Fertilizer 1000 lbs/acre
(10-20-20 or equivalent)

Fertilizer 1000 lbs/acre
(10-20-20 or equivalent)

Mulch Hay 2 Tons/acre

Mulch Hay 2 Tons/acre

Seed* Orchardgrass 10 lbs/acre

Seed* Orchardgrass 10 lbs/acre

Red clover 12 lbs/acre

Red clover 12 lbs/acre

Alsike clover 4 lbs/acre

Alsike clover 4 lbs/acre

*Inoculate all legumes such as vetch, trefoil and clovers with the proper bacterium. Inoculate with 3X recommended amount.

04/12/2024

PLAN PREPARED BY Sidney J. Davis

ADDRESS Carnegie Natural Gas Co.
3904 Main Street
Munhall, PA 15120

PHONE NO. 412-462-7121

NOTES: Please request landowners' cooperation to protect new seedling for one growing season. Attach separate sheets as necessary for comments.

a-10

Ref- 5777

RECEIVED

JUL 19 1982

OIL AND GAS DIVISION
WV DEPARTMENT OF MINES

AFFIDAVIT

I, J. C. Stephenson (the above designated owner or operator, or authorized representative thereof) hereby verifies that the owner or owners of the mineral estate upon which this proposed well is to be located will receive minimum one-eighth (1/8) royalty payments for any gas or oil extracted therefrom. Copies of the Permit Application and the enclosed plat and reclamation plan have been mailed by registered mail or delivered by hand to the above-named coal operator, co-owner(s), and coal lessee on or before the day of the mailing or delivery of this Permit Application to the Department of Mines at Charleston, West Virginia.

Signed: James C. Stephenson
(Owner, Operator, or Authorized Representative)

Notary : S. Wayne Jones (Signed)

My commission expires MY COMMISSION EXPIRES OCTOBER 26, 1991

RECEIVED

JUL 22 1982

OIL AND GAS DIVISION
WV DEPARTMENT OF MINES



04/12/2024

RECEIVED

APR 12 1964

COMMUNICATIONS SECTION

RECEIVED

JUL 15 1964

COMMUNICATIONS SECTION

RECEIVED

JUL 15 1964

COMMUNICATIONS SECTION



RECEIVED

JUL 15 1964

COMMUNICATIONS SECTION

a-11

CARNEGIE NATURAL  COMPANY 3904 Main Street, Munhall, Pa. 15120
Phone 462-7121

July 23, 1982

Mike Lewis
State of West Virginia
Oil & Gas Division
1615 Washington Street East
Charleston, W.Va. 25311

Re: Lease #17749, Well #1875

Dear Sir:

As per your request to James C. Stephenson, our Division Superintendent, Mannington, West Virginia, we are enclosing a letter, dated May 25, 1982, executed by Robert L. Drane and Mary J. Drane, surface owners and part royalty owners, on the above lease, situate in Union District, Ritchie County, West Virginia, whereby they offer no objection to Carnegie's drilling within the reserve area of the house and water well.

This should suffice in completing the application for our Drilling Permit.

Very truly yours,

CARNEGIE NATURAL GAS COMPANY

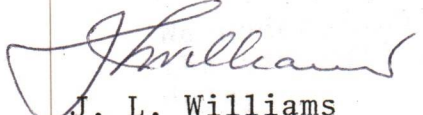

J. L. Williams
Land Agent

Rit-5777

JLW:jb
Encl.
cc: J. C. Stephenson

THE LOW COST FUEL 

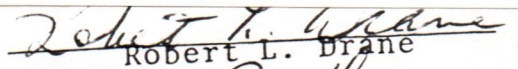
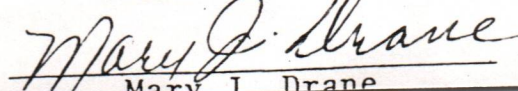
04/12/2024

Robert L. Drane

Mary J. Drane

11

04/12/2024

DETAILS OF PERFORATED INTERVALS, FRACTURING OR STIMULATING, PHYSICAL CHANGE, ETC.

Date	Perfs.	Sacks Sand	bbls. Foam	bbls. Acid
10-5-82	3024' - 3541'	400	103	12
10-5-82	1925' - 2324'	400	100	10
10-5-82	1736' - 1751'	160	47	9.5

WELL LOG

FORMATION	COLOR	HARD OR SOFT	TOP FEET	BOTTOM FEET	REMARKS Including indication of all fresh and salt water, coal, oil and gas
Clay	Brown		0	8	
Sand	Gray		8	32	
Shale	Gray		32	38	
Shale	Brown		38	42	
Red Rock	Red		42	73	
Sand	White		73	77	
R.R. & Shale	Red & Gray		77	100	
Sand	Gray		100	110	
Red Rock	Red		110	112	
Sandy Shale	Green		112	120	
R. R. & Shale	Red & Gray		120	127	
Sand	Gray		127	150	
Red Rock	Red		150	155	
Sand	Green		155	162	
Shale	Brown		162	230	
R. R. & Shale	Red & Gray		230	260	
Sand	Gray		260	380	
R. R. & Shale	Red & Gray		380	412	
Shale	Gray		412	426	
Red Rock	Red		426	442	
Sandy Shale	Gray		442	448	
Red Rock	Red		448	508	
Sand	White		508	562	
Shale	Gray		562	786	
Coal	Black		786	790	
Shale	Gray		790	1180	
Coal	Black		1180	1184	
Shale	Gray		1184	1300	
Sand	Gray		1300	1550	
Shale	Gray		1550	1610	
Lime	White & Gray		1610	1632	
Shale	Gray		1632	1645	
Lime	White		1645	1780	
Injun	White & Gray		1780	1960	
Shale	Gray		1960	2135	
Sand	Gray		2135	2324	
Shale	Gray		2324	2950	
Sand	Gray		2950	3160	
Shale	Gray		3160	3410	
Sand	Gray		3410	3530	
(Attach separate sheets as necessary)					
Shale	Gray		3530	3590	
Sand	Gray		3590	3840	
Shale	Gray		3840	5038	

CARNEGIE NATURAL GAS

Well Operator

T. D. 5038'

By: Roger G. [Signature] 04/12/2024
Date: FEB 21, 1983

Note: Regulation 2.02(i) provides as follows:
"The term 'log' or 'well log' shall mean a systematic detailed geological record of all formations, including ... encountered in the drilling of a well."



STATE

IV-35
(Rev 8-81)

RECEIVED

FEB 24 1983

OIL AND GAS DIVISION
WV DEPARTMENT OF MINES

State of West Virginia

Department of Mines
Oil and Gas Division

Date February 1, 1983
Operator's
Well No. 1-1875
Farm R. L. Drane
API No. 47-085-5777

WELL OPERATOR'S REPORT
OF

DRILLING, FRACTURING AND/OR STIMULATING, OR PHYSICAL CHANGE

WELL TYPE: Oil ___ / Gas x / Liquid Injection ___ / Waste Disposal ___ /
(If "Gas," Production x / Underground Storage ___ / Deep ___ / Shallow x /)

LOCATION: Elevation: 815' Watershed Brushy Fork
District: Union County Ritchie Quadrangle Burnt House

COMPANY Carnegie Natural Gas Company
ADDRESS 800 Regis Ave. Pittsburgh, Pa.
DESIGNATED AGENT J. C. Stephenson
ADDRESS Mannington, W.Va.
SURFACE OWNER Robert L. Drane
ADDRESS Auburn, W.Va.
MINERAL RIGHTS OWNER Robert L. Drane
ADDRESS Auburn, W.Va.
OIL AND GAS INSPECTOR FOR THIS WORK Sam Hershman ADDRESS Smithville, W.Va.
PERMIT ISSUED July 19, 1982
DRILLING COMMENCED August 23, 1982
DRILLING COMPLETED August 29, 1982
IF APPLICABLE: PLUGGING OF DRY HOLE ON CONTINUOUS PROGRESSION FROM DRILLING OR REWORKING. VERBAL PERMISSION OBTAINED ON _____

Casing & Tubing	Used in Drilling	Left in Well	Cement fill up ft.
Size 20-16 Cond.			
11-3/4 1800'	214	214	214
9 5/8			
8 5/8	1669	1669	1669'
7			
5 1/2			
4 1/2	3625	3625	2200'
3			
2			
Liners used			

GEOLOGICAL TARGET FORMATION Alexander Depth 5050 feet
Depth of completed well 3625 feet Rotary x / Cable Tools _____
Water strata depth: Fresh _____ feet; Salt _____ feet
Coal seam depths: 786-790 1180-1184 Is coal being mined in the area? No

OPEN FLOW DATA
Weir, Big Injun
Producing formation Warren, Speechley, Gordon, Pay zone depth 1736-3542 feet
Gas: Initial open flow 36 Mcf/d Oil: Initial open flow - Bbl/d
Final open flow 474 Mcf/d Final open flow - Bbl/d
Time of open flow between initial and final tests 72 hours
Static rock pressure 825 psig (surface measurement) after 72 hours shut in
(If applicable due to multiple completion--)
Second producing formation _____ Pay zone depth 04/12/2024 feet
Gas: Initial open flow _____ Mcf/d Oil: Initial open flow _____ Bbl/d
Final open flow _____ Mcf/d Oil: Final open flow _____ Bbl/d
Time of open flow between initial and final tests _____ hours
Static rock pressure _____ psig (surface measurement) after _____ hours shut in

(Continue on reverse side)

RIT-5777

STATE OF WEST VIRGINIA
DEPARTMENT OF MINES
OIL AND GAS WELLS DIVISION

RECEIVED

AUG 26 1982

OIL AND GAS DIVISION
WV DEPARTMENT OF MINES

INSPECTOR'S WELL REPORT

Permit No. 85-5777

Oil or Gas Well _____
(KIND)

Company Carnegie Met Gas Co.
 Address _____
 Farm R. S. Dron
 Well No. 1-1875
 District Union County Put
 Drilling commenced 8-23-82
 Drilling completed _____ Total depth _____
 Date shot _____ Depth of shot _____
 Initial open flow _____ /10ths Water in _____ Inch
 Open flow after tubing _____ /10ths Merc. in _____ Inch
 Volume _____ Cu. Ft.
 Rock pressure _____ lbs. _____ hrs.
 Oil _____ bbls., 1st 24 hrs.
 Fresh water _____ feet _____ feet
 Salt water _____ feet _____ feet

CASING AND TUBING	USED IN DRILLING	LEFT IN WELL	PACKERS
Size			
16			Kind of Packer _____
13			
10			Size of _____
8 1/4			
6 3/8			Depth set _____
5 3/16			
3			Perf. top _____
2			Perf. bottom _____
Liners Used			Perf. top _____
			Perf. bottom _____

CASING CEMENTED _____ SIZE _____ No. FT. _____ Date _____
 NAME OF SERVICE COMPANY _____
 COAL WAS ENCOUNTERED AT _____ FEET _____ INCHES
 _____ FEET _____ INCHES FEET _____ INCHES
 _____ FEET _____ INCHES FEET _____ INCHES

Drillers' Names Mike M Vickers / Ernie Coyer / Willard Westfall / Mike Ware
 Contractor S.W. Jack Rig #12 Hank Snow
 Remarks: _____

Move on location / Rig up / started Drilling

8-23-82
DATE

Samuel A. ...
DISTRICT WELL INSPECTOR

04/12/2024

Form 26
2/16/82

STATE OF WEST VIRGINIA
DEPARTMENT OF MINES
OIL AND GAS WELLS DIVISION

INSPECTOR'S PLUGGING REPORT

Permit No. _____

Well No. _____

COMPANY _____ ADDRESS _____

FARM _____ DISTRICT _____ COUNTY _____

Filling Material Used _____

Liner	Location		Amount	Packer	Location		
CEMENT-THICKNESS	PLUGS USED AND DEPTH PLACED		LEAD	CONSTRUCTION-LOCATION	CASING AND TUBING		
	WOOD-SIZE				RECOVERED	SIZE	LOST

Drillers' Names _____

Remarks: _____

DATE I hereby certify I visited the above well on this date.

04/12/2024
DISTRICT WELL INSPECTOR

STATE OF WEST VIRGINIA
DEPARTMENT OF MINES
OIL AND GAS WELLS DIVISION

RECEIVED

AUG 27 1982

OIL AND GAS DIVISION
WV DEPARTMENT OF MINES

INSPECTOR'S WELL REPORT

Permit No. 85-5777

Oil or Gas Well _____
(KIND)

Company Carnegie Nat Gas Co.
 Address _____
 Farm R. L. Drane
 Well No. 1-1875
 District Union County Rit
 Drilling commenced 8-23-82
 Drilling completed _____ Total depth _____
 Date shot _____ Depth of shot _____
 Initial open flow _____ /10ths Water in _____ Inch
 Open flow after tubing _____ /10ths Merc. in _____ Inch
 Volume _____ Cu. Ft.
 Rock pressure _____ lbs. _____ hrs.
 Oil _____ bbls., 1st 24 hrs.
 Fresh water 15' feet _____ feet
 Salt water _____ feet _____ feet

CASING AND TUBING	USED IN DRILLING	LEFT IN WELL	PACKERS
Size			
16			Kind of Packer _____
13			
10			Size of _____
8 1/4			
6 5/8			Depth set _____
5 3/16			
3			Perf. top _____
2			Perf. bottom _____
Liners Used			Perf. top _____
			Perf. bottom _____

CASING CEMENTED _____ SIZE _____ No. FT. _____ Date _____
 NAME OF SERVICE COMPANY _____
 COAL WAS ENCOUNTERED AT _____ FEET _____ INCHES
 _____ FEET _____ INCHES _____ FEET _____ INCHES
 _____ FEET _____ INCHES _____ FEET _____ INCHES

Drillers' Names Mike McKickers - Ernie Coyer - Willard Westfall - Mike Ware
 Contractor S. W. Jock Rig # 12 tool Pusher
Hank Snow

Remarks: Ran 214.65' of 11 3/4 casing
used 95 sacks cement - Halliburton C.T.S.

8-24-82
DATE

Samuel N. Heroman 04/12/2024
DISTRICT WELL INSPECTOR

STATE OF WEST VIRGINIA
DEPARTMENT OF MINES
OIL AND GAS WELLS DIVISION

RECEIVED

AUG 1 1982

OIL AND GAS DIVISION
WV DEPARTMENT OF MINES

INSPECTOR'S WELL REPORT

Permit No. 85-5777

Oil or Gas Well _____
(KIND)

Company Carnegie Nat. Gas Co

Address _____

Farm R. L. Drane

Well No. 1-1875

District Union County Pit

Drilling commenced 8-23-82

Drilling completed _____ Total depth _____

Date shot _____ Depth of shot _____

Initial open flow _____ /10ths Water in _____ Inch

Open flow after tubing _____ /10ths Merc. in _____ Inch

Volume _____ Cu. Ft.

Rock pressure _____ lbs. _____ hrs.

Oil _____ bbls., 1st 24 hrs.

Fresh water 15' feet _____ feet

Salt water _____ feet _____ feet

CASING AND TUBING	USED IN DRILLING	LEFT IN WELL	PACKERS
Size			
16			Kind of Packer _____
13			
10			Size of _____
8 1/4			
6 5/8			Depth set _____
5 3/16			
3			Perf. top _____
2			Perf. bottom _____
Liners Used			Perf. top _____
			Perf. bottom _____

CASING CEMENTED _____ SIZE _____ No. FT. _____ Date _____

NAME OF SERVICE COMPANY _____

COAL WAS ENCOUNTERED AT 786 to 790 FEET _____ INCHES

1180 to 1184 FEET _____ INCHES

_____ FEET _____ INCHES _____ FEET _____ INCHES

Drillers' Names _____

Remarks: on 8-25-82 Ran 1668.50 foot of 8 5/8 casing used 410 sacks cement - Halliburton
2032' deep at time of visit

8-26-82
DATE

Samuel N. Heiman 04/12/2024
DISTRICT WELL INSPECTOR

STATE OF WEST VIRGINIA
 DEPARTMENT OF MINES
 OIL AND GAS DIVISION
FINAL INSPECTION REQUEST
INSPECTOR'S COMPLIANCE REPORT

RECEIVED
 SEP 23 1983

OIL & GAS DIVISION
 DEPT. OF MINES

Permit No. 005-5777 County Ritchie
 Company CARNEGIE NAT. GAS Farm P. L. DRANE
 Inspector MIKE UNDERWOOD Well No. 1-1875
 Date 9-15-83

RULE	DESCRIPTION	IN COMPLIANCE	
		Yes	No
23.06	Notification Prior to starting Work	_____	_____
25.04	Prepared before Drilling to prevent waste	_____	_____
25.03	High-Pressure Drilling	_____	_____
16.01	Required Permits at wellsite	_____	_____
15.03	Adequate Fresh Water Casing	_____	_____
15.02	Adequate Coal Casing	_____	_____
15.01	Adequate Production Casing	_____	_____
15.04	Adequate Cement Strength	_____	_____
23.02	Maintained Access Roads	_____	_____
25.01	Necessary Equipment to prevent Waste	_____	_____
23.03	Reclaimed Drilling Site	<u>X</u>	_____
23.04	Reclaimed Drilling Pits	<u>X</u>	_____
23.05	No surface or underground Pollution	_____	_____
7.03	Identification Markings	<u>X</u>	_____

COMMENTS: _____

Release

I have inspected the above well and (HAVE/HAVE NOT) found it to be in compliance with all of the rules and regulations of the Office of Oil and Gas Department of Mines of the State of West Virginia.

SIGNED: Mike Underwood
 DATE: 9-15-83

04/12/2024



State of West Virginia
Department of Mines
Oil and Gas Division
Charleston 25305

WALTER N. MILLER
DIRECTOR

THEODORE M. STREIT
ADMINISTRATOR

October 7, 1983

Carnegie Natural Gas Company
800 Regis Avenue
Pittsburgh, Pa. 15236

Gentlemen:

The required records and reports have been received in this office and the District Inspectors have submitted FINAL INSPECTIONS for the following wells listed below:

<u>PERMIT NUMBER</u>	<u>FARM AND WELL NUMBER</u>	<u>DISTRICT</u>
RIT-4873	Mitilda Donaho, et al, #3-1838	Union
RIT-5172	Hiram Smith, #3-1846	Union
RIT-5674	J. B. Ballah, #2-1863	Union
RIT-5676	D. P. Mullenix, #2-1865	Union
RIT-5777	R. L. Drane, #1-1875	Union
WET-1235	John Mills, #3-1853	Green

In accordance with Chapter 22, Article 4, Section 2, the above captioned wells will remain under bond coverage for "life of wells." Reclamation requirements have been approved.....

Very truly yours,

Theodore M. Streit, Administrator
Office of Oil & Gas-Dept. Mines

TMS/

04/12/2024

A-12

701 14th Avenue
Munhall, Pa. 15120

May 25, 1982

Carnegie Natural Gas Company
3904 Main Street
Munhall, Pennsylvania 15120

Lease Number 17749

Dear Sirs:

You hold an oil and gas lease, made by Robert L. Drane and Mary J. Drane, his wife, dated July 16, 1980, covering forty-six (46) acres, more or less, in Union District, Ritchie County, West Virginia, of record in Lease Book 132, Page 76, which lease contains the following reservation:

"reserving, however, therefrom two hundred feet from dwelling houses and barns, now on the premises on which no well shall be drilled by either party except by mutual consent."

We understand that you have made a location for a well within the aforesaid reservation and desire to drill the same without delay.

This is to notify you that we have no objection to the drilling of said well as now located and that we hereby waive the said reservation insofar as the drilling of the well is concerned.

Very truly yours,

Robert L. Drane
Robert L. Drane

Mary J. Drane
Mary J. Drane

P.S.:

Also, you have our permission and consent to drill said well closer than 200' to our water well, now on property.

Robert L. Drane
Robert L. Drane

Mary J. Drane
Mary J. Drane

04/12/2024