



1) Date: October 28, 1982
 2) Operator's Well No. One - A
 3) API Well No. 47 085 6007
 State County Permit

DRILLING CONTRACTOR:
Over-John, Inc.
Parkersburg, WV 26101

STATE OF WEST VIRGINIA
 DEPARTMENT OF MINES, OIL AND GAS DIVISION
OIL AND GAS WELL PERMIT APPLICATION

- 4) WELL TYPE: A Oil / Gas
 B (If "Gas", Production / Underground storage _____ / Deep _____ / Shallow)
- 5) LOCATION: Elevation: 945 ft. Watershed: Devilhole Creek
 District: Grant County: Ritchie Quadrangle: Cairo 7.5'
- 6) WELL OPERATOR Over-John, Inc. 11) DESIGNATED AGENT Percy Johnson
 Address 6335 Emerson Ave. Address 6335 Emerson Ave.
Parkersburg, WV 26101 Parkersburg, WV 26101
- 7) OIL & GAS ROYALTY OWNER c/o R. L. Sweeney 12) COAL OPERATOR N/A
 Address 933 Buanly Road Address _____
Charlotte, NC 28210
- 8) SURFACE OWNER Westvaco Corp. 13) COAL OWNER(S) WITH DECLARATION ON RECORD:
 Address Rt. 95 & Rayon Dr. Name N/A
Parkersburg, WV 26101 Address _____
- 9) FIELD SALE (IF MADE) TO: Name N/A
 Address _____
- 10) OIL & GAS INSPECTOR TO BE NOTIFIED Name Samuel N. Hersman
 Address P. O. Box 66
Smithville, WV 26178
- 15) PROPOSED WORK: Drill / Drill deeper _____ / Redrill _____ / Fracture or stimulate _____
 Plug off old formation _____ / Perforate new formation _____
 Other physical change in well (specify) _____
- 16) GEOLOGICAL TARGET FORMATION, Ohio Shale
- 17) Estimated depth of completed well, 5200 feet
- 18) Approximate water strata depths: Fresh, 150 feet; salt, _____ feet.
- 19) Approximate coal seam depths: N/A Is coal being mined in the area? Yes _____ / No

20) CASING AND TUBING PROGRAM

CASING OR TUBING TYPE	Size	SPECIFICATIONS			FOOTAGE INTERVALS		CEMENT FILL-UP OR SACKS (Cubic feet)	PACKERS
		Grade	Weight per ft.	New	Used	For drilling		
Conductor	16"				X		40'	Kinds
Fresh water	11 3/4"		38 lb.	X			250'	To surface
Coal								Sizes
Intermediate	8 5/8"		23 lb.	X			1250'	To surface
Production	4 1/2"		10.5 lb	X			5200'	2500'
Tubing								Depths set
Liners								Perforations:
								Top Bottom

21) EXTRACTION RIGHTS

Check and provide one of the following:

- Included is the lease or leases or other continuing contract or contracts by which I hold the right to extract oil or gas.
 The requirement of Code 22-4-1-(c) (1) through (4). (See reverse side for specifics.)

22) ROYALTY PROVISIONS

Is the right to extract, produce or market the oil or gas based upon a lease or other continuing contract or contracts providing for flat well royalty or any similar provision for compensation to the owner of the oil or gas in place which is not inherently related to the volume of oil or gas so extracted, produced or marketed? Yes No

If the answer above is No, nothing additional is needed. If the answer is Yes, you may use Affidavit Form IV-60.

23) Required Copies (See reverse side.)

24) Copies of this Permit Application and the enclosed plat and reclamation plan have been mailed by registered mail or delivered by hand to the above named coal operator, coal owner(s), and coal lessee on or before the day of the mailing or delivery of this Permit Application to the Department of Mines at Charleston, West Virginia

Notary: Harold L. Darling
 My Commission Expires October 6, 1986

Signed: David Jenkins
 Its: Drilling Superintendent

OFFICE USE ONLY

Permit number 47-085-6007

DRILLING PERMIT

November 17, 1982

Date

04/05/2024

This permit covering the well operator and well location shown below is evidence of permission granted to drill in accordance with the pertinent legal requirements subject to the conditions contained herein and on the reverse hereof. Notification must be given to the District Oil and Gas Inspector. (Refer to No. 10) Prior to the construction of roads, locations and pits for any permitted work. In addition, the well operator or his contractor shall notify the proper district oil and gas inspector 24 hours before actual permitted work has commenced.)

Permit expires July 17, 1983

unless drilling is commenced prior to that date and prosecuted with due diligence.

Bond: <u>Blanket O.K.</u>	Agent: <u>M.A.M.A.</u>	Plat: <u>M.A.M.A.</u>	Casing: <u>M.A.M.A.</u>	Fee: <u>1347</u>
---------------------------	------------------------	-----------------------	-------------------------	------------------

[Signature]
 Administrator, Office of Oil and Gas

NOTE: Keep one copy of this permit posted at the drilling location.

Line Item Explanation

- 1) Date of Application
- 2) Your well name and number
- 3) To be filled out by office of oil & gas
- 4A) "Oil" means natural crude oil or petroleum and other hydrocarbons, regardless of gravity, which are produced at the well in liquid form by ordinary production methods and which are not the result of condensation of gas after it leaves underground reservoirs: "Gas" means all natural gas and all other fluid hydrocarbons not defined as oil.
- 4B) "Shallow well" means any well drilled and completed in a formation above the top of the uppermost member of the "Onondaga Group" or a depth less than six thousand feet, whichever is shallower.
"Deep well" means any well drilled and completed in a formation at or below the top of the uppermost member of the "Onondaga Group" or at a depth less than six thousand feet, whatever is shallower.
- 5) Where well is located
- 6) Before a permit can be issued in a corporation, company partnership, or fictitious name, the name must be registered with the Secretary of State Office
- 7) Use separate sheet if necessary
- 8) Present surface owner at time application is filed.
- 9) Optional
- 11) See Reg. 7.01 relating to code §22-4-1k
- 12) "Coal Operator" means any persons, firm, partnership, partnership association or corporation that proposes to or does operate a coal mine. See Note 24
- 13 & 14) As per §22-4-20; See Note 24
- 15) Work that will be attempted—A separate Form IV-2 shall not be required for fracturing or stimulating a well where fracturing or stimulating is to be part of the work for which a permit is sought and is noted as such on the Form IV-2 filed in connection therewith.
- 16) Anticipated formation for which well will be completed
- 17) Self explanatory
- 18) Depth to deepest freshwater, and shallowest salt water, taken from nearby wells corrected for differences in elevation
- 19) All coal seam depths
- 20) Proposed casing program and cementing refer to Code 22-4-5, 22-4-6, 22-4-7, 22-4-8, 22-4-8a Reg 9.01, 15.01, 15.02, 15.03, 15.04, 25.01, 25.02, 25.03, 25.04
- 21) Code 22-4-11(c) - In lieu of filing the lease or leases or other continuing contract or contracts, the applicant for a permit described herein may file the following:
 - (1) A brief description of the tract of land including the district and county wherein the tract is located;
 - (2) The identification of all parties to all leases or other continuing contractual agreements by which the right to extract, produce or market the oil or gas is claimed;
 - (3) The book and page number wherein each such lease or contract by which the right to extract, produce or market the oil or gas is recorded;
 - (4) A brief description of the royalty provisions of each such lease or contract.
- 22) Code 22-4-11(d) and 22-4-11(e).
- 23) Regulation 7.02 of the Department of Mines provides that the original and four copies of Form IV-2 must be filed with the Department, accompanied by (i) a plat in the form prescribed by Regulation 11, (ii) a bond in one of the forms prescribed by Regulation 12, or in lieu thereof the other security allowed by Code §22-4-2, (iii) Form IV-9, "Reclamation Plan", applicable to the reclamation required by Code §22-4-12b and Regulation 23, (iv) unless previously paid on the same well, the fee required by Code §22-4-12a, and (v) if applicable, the consent required by Code §22-4-8a from the owner of any water well or dwelling within 200 feet of the proposed well.
- 24) **The above named coal operator, coal owner(s), and coal lessee are hereby notified that any objection they wish to make or are required to make by Code §22-4-3 must be filed with the Department of Mines within fifteen (15) days after the receipt of this Application by the Department.**

The following waiver must be completed by the coal operator and by any coal owner or coal lessee who has recorded a declaration under Code 22-4-20, if the permit is to be issued within fifteen (15) days of receipt thereof.

WAIVER

The undersigned coal operator _____ / owner _____ / lessee _____ / of the coal under this well location has examined this proposed well location. If a mine map exists which covers the area of the well location, the well location has been added to the mine map. The undersigned has no objection to the work proposed to be done at this location, provided, the well operator has complied with all applicable requirements of the West Virginia Code and the governing regulations.

04/05/2021

Date: _____, 19____

By _____

Its _____

PHOTOCOPY SECTION OF
 TOPOGRAPHIC MAP.
 SCALE CAIRO 7.5'

LEGEND

Well Site 



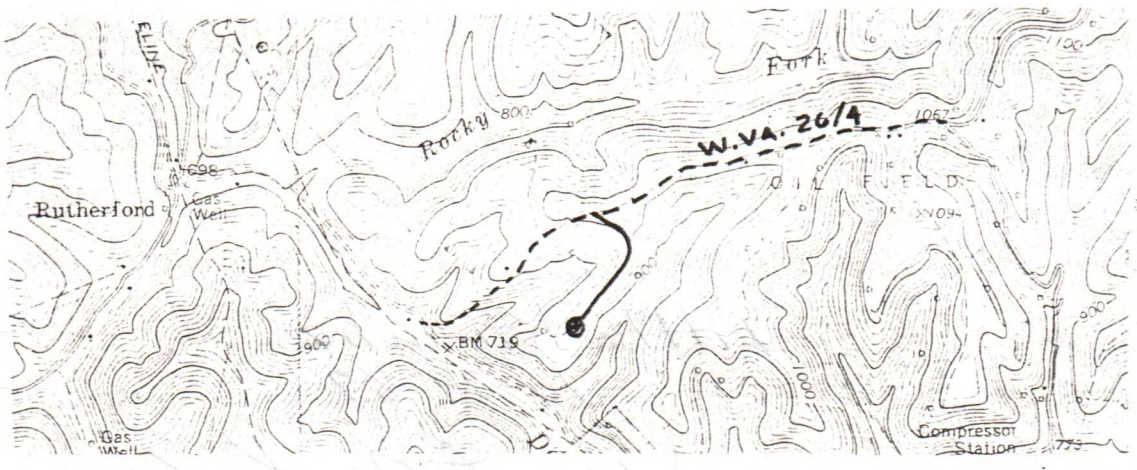





Access Road 

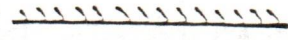

WELL SITE PLAN

Sketch to include well location, existing access road, roads to be constructed, wellsites, filling pits and necessary structures numbered or lettered to correspond with the first part of this plan. Include all natural drainage.

LEGEND

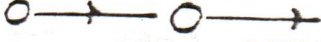
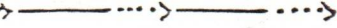
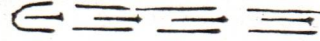
Property boundary 	Diversion 
Road 	Spring 
Existing fence 	Wet spot 
Planned fence 	Building 
Stream 	Drain pipe 
Open ditch 	Waterway 

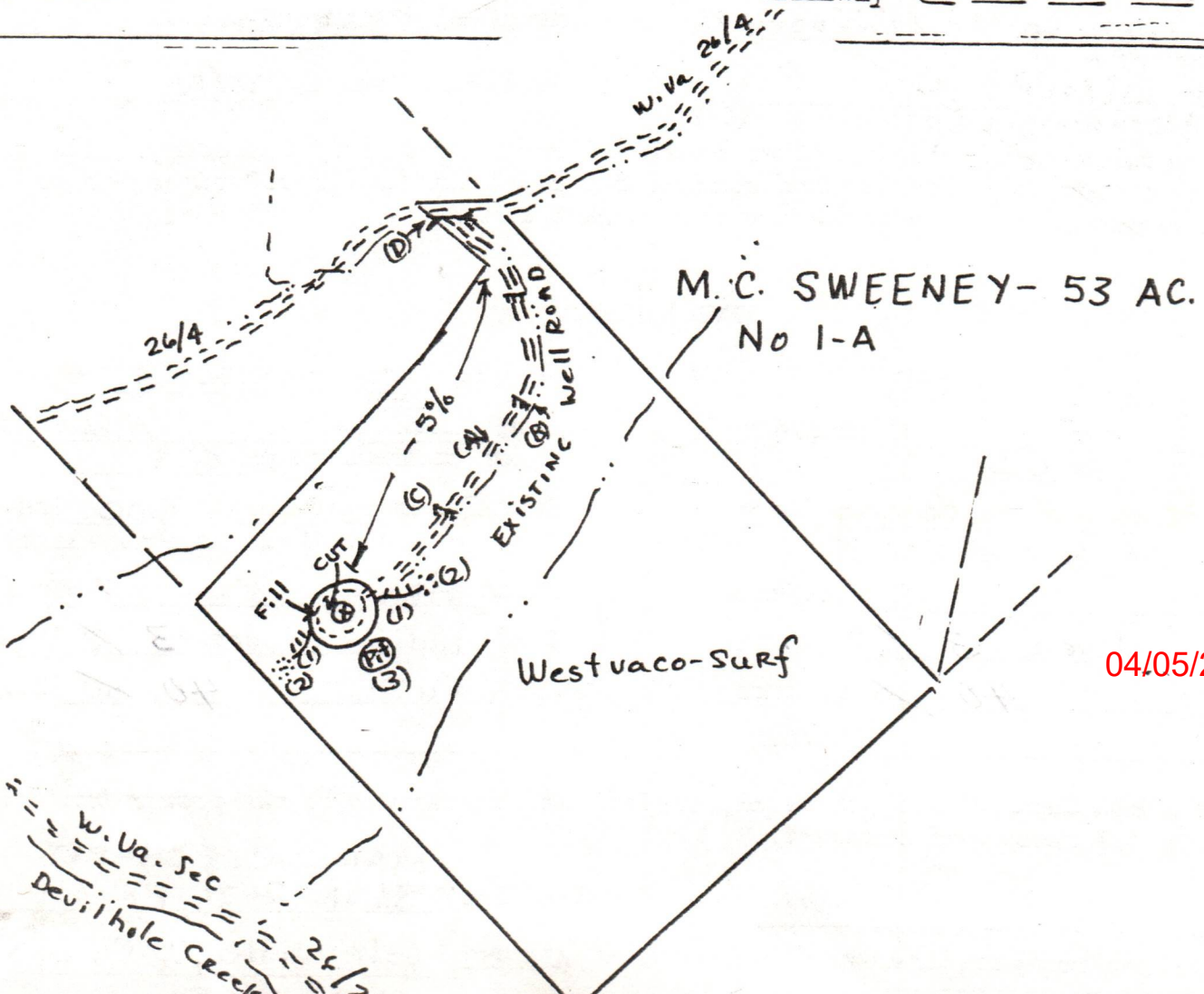

04/05/2024

State of West Virginia

Department of Mines
 Oil and Gas Division

CONSTRUCTION AND RECLAMATION PLAN

OWNER NAME OVER-JOHN, INC
 Address 6335 EMERSON AVE
PARKERSBURG, W.VA. 26101
 Telephone 422-6085

DESIGNATED AGENT MR. PERCY JOHNSON
 Address 6335 EMERSON AVE.
PARKERSBURG, W.Va 26101
 Telephone 422-6085

OWNER WESTVACO CORP.

SOIL CONS. DISTRICT Little Kanawha

Revegetation to be carried out by OVER-JOHN, INC / PERCY JOHNSON (Agent)

This plan has been reviewed by Little Kanawha SCD. All corrections and additions become a part of this plan: 10-29-82 (Date)

Janett Newton
 (SCD Agent)

ACCESS ROAD

LOCATION

Structure EARTHEN & STONE (A)
 Spacing _____
 Page Ref. Manual (2-14)

Structure Diversion Ditch (1)
 Material EARTHEN
 Page Ref. Manual (2-12)

Structure DRAINAGE DITCH (B)
 Spacing _____
 Page Ref. Manual (2-10)(b)

Structure Rock-rip-RAP (2)
 Material ROCK
 Page Ref. Manual (2-16)(c-4)

Structure CROSS DRAINS (C)
2% every 250'
 Spacing 15% every 60' & 20% every 45'
 Page Ref. Manual (2-1)(2-4)

Structure (Pit) (3)
 Material EARTHEN
 Page Ref. Manual N/A

1) 16" X 24' CMP CULVERT (D)
 All structures should be inspected regularly and repaired if necessary. All commercial timber is to be cut and stacked and all brush and small timber to be cut and removed from the site before dirt work begins.

REVEGETATION

Treatment Area I

Treatment Area II

Line 2 Tons/acre
 or correct to pH 6.5
 Fertilizer 600 lbs/acre
 (10-20-20 or equivalent)
 Mulch HAY 2 Tons/acre
 Seed* Ladino clover 3 1/2 lbs/acre
Ky 31 40 30 lbs/acre
 lbs/acre

Line 2 Tons/acre
 or correct to pH 6.5
 Fertilizer 600 lbs/acre
 (10-20-20 or equivalent)
 Mulch HAY 2 Tons/acre
 Seed* Ladino clover 3 1/2 lbs/acre
Ky 31 40 30 lbs/acre
 lbs/acre

04/05/2024

*Inoculate all legumes such as vetch, trefoil and clovers with the proper bacterium. Inoculate with 5X recommended amount.

PLAN PREPARED BY MARK C. ECHARD
STAR Rt 71, Box 6

ADDRESS Glenville, W.Va. 26351
412-5565

NOTES: Please request landowners' cooperation to protect new



DATE: Nov. 10, 1982
OPERATOR'S
WELL NO.: Sweeney #1A
API NO: 47 - 085 -
State County Permi

State of West Virginia

OFFICE OF OIL AND GAS
DEPARTMENT OF MINES

A F F I D A V I T

State of West Virginia
County of Wood

I, Donald C. Arnott (the designated owner or operator, or authorized representative thereof), after being duly sworn, do depose and say that the undersigned is authorized by the owner of the working interest in the well permit application to which this affidavit is attached do state that (he, she, or it) shall tender to the owner of the oil and gas in place not less than one-eighth of the total amount paid to or received by or allowed to the owner of the working interest at the wellhead for the oil or gas so extracted, produced, or marketed before deducting the amount to be paid or set aside for the owner of the oil or gas in place, or all such oil or gas to be extracted, produced, or marketed from the well. West Virginia Code 22-4-11(e) (1982).

Signed: 

Taken, Subscribed, and sworn to before me this 10th day of Nov., 1982.

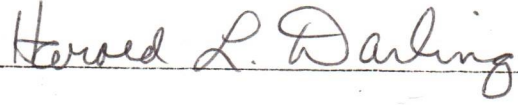
Notary: 

My Commission Expires: October 6, 1986

STATE OF WEST VIRGINIA
DEPARTMENT OF MINES
OIL AND GAS WELLS DIVISION

RECEIVED

DEC - 3 1982

OIL AND GAS DIVISION
WV DEPARTMENT OF MINES

INSPECTOR'S WELL REPORT

Permit No. 85-6007

Oil or Gas Well _____
(KIND)

Company Over John Inc.
 Address _____
 Farm Westvaco Corp.
 Well No. one A
 District Grant County Ritchie
 Drilling commenced 11-28-82
 Drilling completed _____ Total depth _____
 Date shot _____ Depth of shot _____
 Initial open flow _____ /10ths Water in _____ Inch
 Open flow after tubing _____ /10ths Merc. in _____ Inch
 Volume _____ Cu. Ft.
 Rock pressure _____ lbs. _____ hrs.
 Oil _____ bbls., 1st 24 hrs.
 Fresh water none - Dusted feet _____ feet
 Salt water _____ feet _____ feet

CASING AND TUBING	USED IN DRILLING	LEFT IN WELL	PACKERS
Size			
16			Kind of Packer _____
13			
10			Size of _____
8 1/4			
6 5/8			Depth set _____
5 3/16			
3			Perf. top _____
2			Perf. bottom _____
Liners Used			Perf. top _____
			Perf. bottom _____

CASING CEMENTED _____ SIZE _____ No. FT. _____ Date _____
 NAME OF SERVICE COMPANY _____
 COAL WAS ENCOUNTERED AT _____ FEET _____ INCHES
 _____ FEET _____ INCHES FEET _____ INCHES
 _____ FEET _____ INCHES FEET _____ INCHES

Drillers' Names Paul Minor - Rep. Green - T. Collins

Over John Inc Rig 22 Tool Pusher Chalmer Kohen
 Remarks: on 11-29-82 Ran 1219 foot of 8 5/8" casing
Halliburton ran 180 sacks Light Class A
and 100 sacks Common Class A = total 280 sacks
Plug down at 5:30 AM = Halliburton states good circulation
and good cement returns - Pit. O.K.
Picked up gas + oil in engine sand at 1800' foot Depth

11-30-82
DATE

Samuel N. [Signature]
DISTRICT WELL INSPECTOR

04/05/2024

STATE OF WEST VIRGINIA
 DEPARTMENT OF MINES
 OIL AND GAS DIVISION
FINAL INSPECTION REQUEST
INSPECTOR'S COMPLIANCE REPORT

Permit No. 085-6007

County Ritchie

Company Over-John, Inc.

District Grant

Inspector SAMUEL N. HERSMAN

Farm R. L. Sweeney

Date November 23, 1983

Well No. I-A Issued 11-17-82

RULE	DESCRIPTION	IN COMPLIANCE	
		Yes	No
23.06	Notification prior to starting work	_____	_____
25.04	Prepared before drilling to prevent waste	_____	_____
25.03	High-pressure drilling	_____	_____
16.01	Required permits at wellsite	_____	_____
15.03	Adequate fresh water casing	_____	_____
15.02	Adequate coal casing	_____	_____
15.01	Adequate production casing	_____	_____
15.04	Adequate cement strength	_____	_____
23.02	Maintained access roads	_____	_____
25.01	Necessary equipment to prevent waste	_____	_____
23.03	Reclaimed drilling site	_____	_____
23.04	Reclaimed drilling pits	_____	_____
23.05	No surface or underground pollution	_____	_____
7.05	Identification markings	_____	_____

COMMENTS: _____

I have inspected the above well and have found it to be in compliance with the rules and regulations of the Office of Oil and Gas Department of Mines of the State of West Virginia, and the well can be released from the permitted work.

* SIGNED: Samuel N. Hersman

DATE: 2-8-84 04/05/2024



State of West Virginia
Department of Mines
Oil and Gas Division
Charleston 25305

WALTER N. MILLER
DIRECTOR

THEODORE M. STREIT
ADMINISTRATOR

February 14, 1984

Over-John, Inc.
6335 Emerson Avenue
Parkersburg, W. Va. 26101

In Re: PERMIT NO: 47-085-6007
FARM: R. L. Sweeney
WELL NO: Sweeney 1-A
DISTRICT: Grant
COUNTY Ritchie

Gentlemen:

The FINAL INSPECTION REPORT for the above described well has been received in this office. Only the column check below applies:

_____ The well designated by the above permit number has been released under your Blanket Bond.

_____ Please return the enclosed cancelled single bond which covered the well designated by the above permit number to the surety company who executed said bond in your behalf, in order that they may give you credit on their records.

XXXXXX Your well record was received and reclamation requirements approved. In accordance with Chapter 22, Article 4, Section 2, the above captioned well will remain under bond coverage for life of the well.

Very truly yours,

Theodore M. Streit, Administrator
Office of Oil & Gas-Dept. Mines

TMS/r1

04/05/2024