



1) Date: December 28, 1982  
2) Operator's Well No. Lowther #2  
3) API Well No. 47 085 6136  
State County Permit

DRILLING CONTRACTOR:

Over-John, Inc.  
Parkersburg, WV 26101

STATE OF WEST VIRGINIA  
DEPARTMENT OF MINES, OIL AND GAS DIVISION

OIL AND GAS WELL PERMIT APPLICATION

- 4) WELL TYPE: A Oil X / Gas X / B (If "Gas", Production X / Underground storage / Deep / Shallow)
5) LOCATION: Elevation: 1203 feet / Watershed: Goose Creek / District: Grant / County: Ritchie / Quadrangle: Schultz 7.5'
6) WELL OPERATOR Over-John, Inc. / Address 6335 Emerson Ave. / Parkersburg, WV 26101
7) OIL & GAS ROYALTY OWNER A. B. Lowther Heirs / Address % Robert A. Lowther / Middlebourne, WV 26149 / Acreage 82.5
8) SURFACE OWNER Harry Jones / Address Rt. 1 / Cairo, WV / Acreage 80.4
9) FIELD SALE (IF MADE) TO:
10) OIL & GAS INSPECTOR TO BE NOTIFIED Name Samuel N. Hersman / Address P. O. Box 66 / Smithville, WV 26178
11) DESIGNATED AGENT Percy Johnson / Address 6335 Emerson Ave. / Parkersburg, WV 26101
12) COAL OPERATOR N/A
13) COAL OWNER(S) WITH DECLARATION ON RECORD: N/A
14) COAL LESSEE WITH DECLARATION ON RECORD: N/A
15) PROPOSED WORK: Drill X / Drill deeper / Redrill / Fracture or stimulate X / Plug off old formation / Perforate new formation / Other physical change in well (specify)
16) GEOLOGICAL TARGET FORMATION, Marcellus
17) Estimated depth of completed well, 5500 feet
18) Approximate water strata depths: Fresh, 150 feet; salt, feet.
19) Approximate coal seam depths: N/A Is coal being mined in the area? Yes / No X

20) CASING AND TUBING PROGRAM

Table with columns: CASING OR TUBING TYPE, SPECIFICATIONS (Size, Grade, Weight per ft., New, Used), FOOTAGE INTERVALS (For drilling, Left in well), CEMENT FILL-UP OR SACKS (Cubic feet), PACKERS (Kinds, Sizes, Depths set, Perforations: Top, Bottom)

21) EXTRACTION RIGHTS

- Check and provide one of the following:
[X] Included is the lease or leases or other continuing contract or contracts by which I hold the right to extract oil or gas.
[ ] The requirement of Code 22-4-1-(c) (1) through (4). (See reverse side for specifics.)

22) ROYALTY PROVISIONS

Is the right to extract, produce or market the oil or gas based upon a lease or other continuing contract or contracts providing for flat well royalty or any similar provision for compensation to the owner of the oil or gas in place which is not inherently related to the volume of oil or gas so extracted, produced or marketed? Yes [ ] No [X]

If the answer above is No, nothing additional is needed. If the answer is Yes, you may use Affidavit Form IV-60.

23) Required Copies (See reverse side.)

24) Copies of this Permit Application and the enclosed plat and reclamation plan have been mailed by registered mail or delivered by hand to the above named coal operator, coal owner(s), and coal lessee on or before the day of the mailing or delivery of this Permit Application to the Department of Mines at Charleston, West Virginia.

Notary: Harold L. Darling / My Commission Expires October 6, 1986

Signed: [Signature] / Its: Drilling Supt.

OFFICE USE ONLY

Permit number 47-085-6136 / DRILLING PERMIT / December 30, 1982 / Date 03/29/2024

This permit covering the well operator and well location shown below is evidence of permission granted to drill in accordance with the pertinent legal requirements subject to the conditions contained herein and on the reverse hereof. Notification must be given to the District Oil and Gas Inspector. (Refer to No. 10) Prior to the construction of roads, locations and pits for any permitted work. In addition, the well operator or his contractor shall notify the proper district oil and gas inspector 24 hours before actual permitted work has commenced.)

Permit expires August 30, 1983

unless drilling is commenced prior to that date and prosecuted with due diligence.

Table with columns: Bond, Agent, Plat, Casing, Fee

[Signature] / Administrator, Office of Oil and Gas

Line Item Explanation

- 1) Date of Application
- 2) Your well name and number
- 3) To be filled out by office of oil & gas
- 4A) "Oil" means natural crude oil or petroleum and other hydrocarbons, regardless of gravity, which are produced at the well in liquid form by ordinary production methods and which are not the result of condensation of gas after it leaves underground reservoirs: "Gas" means all natural gas and all other fluid hydrocarbons not defined as oil.
- 4B) "Shallow well" means any well drilled and completed in a formation above the top of the uppermost member of the "Onondaga Group" or a depth less than six thousand feet, whichever is shallower.  
"Deep well" means any well drilled and completed in a formation at or below the top of the uppermost member of the "Onondaga Group" or at a depth less than six thousand feet, whatever is shallower.
- 5) Where well is located
- 6) Before a permit can be issued in a corporation, company partnership, or fictitious name, the name must be registered with the Secretary of State Office
- 7) Use separate sheet if necessary
- 8) Present surface owner at time application is filed.
- 9) Optional
- 11) See Reg. 7.01 relating to code §22-4-1k
- 12) "Coal Operator" means any persons, firm, partnership, partnership association or corporation that proposes to or does operate a coal mine. See Note 24
- 13 & 14) As per §22-4-20; See Note 24
- 15) Work that will be attempted—A separate Form IV-2 shall not be required for fracturing or stimulating a well where fracturing or stimulating is to be part of the work for which a permit is sought and is noted as such on the Form IV-2 filed in connection therewith.
- 16) Anticipated formation for which well will be completed
- 17) Self explanatory
- 18) Depth to deepest freshwater, and shallowest salt water, taken from nearby wells corrected for differences in elevation
- 19) All coal seam depths
- 20) Proposed casing program and cementing refer to Code 22-4-5, 22-4-6, 22-4-7, 22-4-8, 22-4-8a Reg 9.01, 15.01, 15.02, 15.03, 15.04, 25.01, 25.02, 25.03, 25.04
- 21) Code 22-4-11(c) - In lieu of filing the lease or leases or other continuing contract or contracts, the applicant for a permit described herein may file the following:
  - (1) A brief description of the tract of land including the district and county wherein the tract is located;
  - (2) The identification of all parties to all leases or other continuing contractual agreements by which the right to extract, produce or market the oil or gas is claimed;
  - (3) The book and page number wherein each such lease or contract by which the right to extract, produce or market the oil or gas is recorded;
  - (4) A brief description of the royalty provisions of each such lease or contract.
- 22) Code 22-4-11(d) and 22-4-11(e).
- 23) Regulation 7.02 of the Department of Mines provides that the original and four copies of Form IV-2 must be filed with the Department, accompanied by (i) a plat in the form prescribed by Regulation 11, (ii) a bond in one of the forms prescribed by Regulation 12, or in lieu thereof the other security allowed by Code §22-4-2, (iii) Form IV-9, "Reclamation Plan", applicable to the reclamation required by Code §22-4-12b and Regulation 23, (iv) unless previously paid on the same well, the fee required by Code §22-4-12a, and (v) if applicable, the consent required by Code §22-4-8a from the owner of any water well or dwelling within 200 feet of the proposed well.
- 24) **The above named coal operator, coal owner(s), and coal lessee are hereby notified that any objection they wish to make or are required to make by Code §22-4-3 must be filed with the Department of Mines within fifteen (15) days after the receipt of this Application by the Department.**

.....

The following waiver must be completed by the coal operator and by any coal owner or coal lessee who has recorded a declaration under Code 22-4-20, if the permit is to be issued within fifteen (15) days of receipt thereof.

**WAIVER**

The undersigned coal operator \_\_\_\_\_/ owner \_\_\_\_\_/ lessee \_\_\_\_\_/ of the coal under this well location has examined this proposed well location. If a mine map exists which covers the area of the well location, the well location has been added to the mine map. The undersigned has no objection to the work proposed to be done at this location, provided, the well operator has complied with all applicable requirements of the West Virginia Code and the governing regulations.

03/29/2024

Date: \_\_\_\_\_, 19\_\_\_\_\_

By \_\_\_\_\_

Its \_\_\_\_\_

Mr. Bus White  
December 13, 1982  
Page 4

---

(d) A. B. Lowther and Grace E. Lowther to J. M. Satterfield and O. S. Satterfield, dated February 18, 1933, recorded in Lease Book No. 66, at page 451, for a period of ten years and as long thereafter as oil or gas is produced, covering 1/2 acre tract. This lease is, according to Robert A. Lowther, still in effect and valid.

(e) A. B. Lowther and Grace E. Lowther to J. B. Mercer and B. A. C. Mercer, dated February 26, 1947, recorded in Lease Book No. 77, at page 73, for one year and as long thereafter as land is operated in search for or production of oil or gas or delay rental is paid, covering 65-1/2 acres.

(f) A. Bernard Lowther and Grace E. Lowther, his wife, to Robert J. Sipoha, November 18, 1958, recorded in Lease Book No. 88, at page 473, for ten years and as long thereafter as oil or gas is produced, covering 65-1/2 acres.

(5) Assignment dated January 27, 1982, by Canyon Oil Corporation to Bison, Inc., of an undivided 100% interest in all proceeds from the sale of oil, gas and/or other hydrocarbon substances which may be produced, saved and sold from the Robert Lowther Well No. 1, located on the subject lease, recorded in Lease Book No. 141, at page 163.

Very truly yours,

  
George W. Hill, Jr.

GWHJr:t

03/29/2024

STATE OF WEST VIRGINIA  
DEPARTMENT OF MINES  
OIL AND GAS WELLS DIVISION

RECEIVED

JAN 7 - 1983

OIL AND GAS DIVISION  
WV DEPARTMENT OF MINES

INSPECTOR'S WELL REPORT

Permit No. 85-6136

Oil or Gas Well \_\_\_\_\_  
(KIND)

|                                                         |                                                           |                  |              |                      |
|---------------------------------------------------------|-----------------------------------------------------------|------------------|--------------|----------------------|
| Company <u>Over John Inc.</u>                           | CASING AND TUBING                                         | USED IN DRILLING | LEFT IN WELL | PACKERS              |
| Address _____                                           | Size                                                      |                  |              |                      |
| Farm <u>Harry Jones</u>                                 | 16                                                        |                  |              | Kind of Packer _____ |
| Well No. <u>Lowther # 2</u>                             | 13                                                        |                  |              |                      |
| District <u>Grant</u> County <u>Ritchie</u>             | 10                                                        |                  |              | Size of _____        |
| Drilling commenced <u>12-31-82</u>                      | 8 1/4                                                     |                  |              |                      |
| Drilling completed _____ Total depth _____              | 6 3/8                                                     |                  |              | Depth set _____      |
| Date shot _____ Depth of shot _____                     | 5 3/16                                                    |                  |              |                      |
| Initial open flow _____ /10ths Water in _____ Inch      | 3                                                         |                  |              | Perf. top _____      |
| Open flow after tubing _____ /10ths Merc. in _____ Inch | 2                                                         |                  |              | Perf. bottom _____   |
| Volume _____ Cu. Ft.                                    | Liners Used                                               |                  |              | Perf. top _____      |
| Rock pressure _____ lbs. _____ hrs.                     |                                                           |                  |              | Perf. bottom _____   |
| Oil _____ bbls., 1st 24 hrs.                            | CASING CEMENTED _____ SIZE _____ No. FT. _____ Date _____ |                  |              |                      |
| Fresh water _____ feet _____ feet                       | NAME OF SERVICE COMPANY _____                             |                  |              |                      |
| Salt water _____ feet _____ feet                        | COAL WAS ENCOUNTERED AT _____ FEET _____ INCHES           |                  |              |                      |
|                                                         | _____ FEET _____ INCHES _____ FEET _____ INCHES           |                  |              |                      |
|                                                         | _____ FEET _____ INCHES _____ FEET _____ INCHES           |                  |              |                      |

Drillers' Names Terry Collins Rep Green Paul Minor

Over John Rig # 22 tool Pusher Chalmer Cohen

Remarks: Ran 1321 foot of 8 5/8 casing  
Newsco ran 210 sacks of 50-50 Pas mix  
and 100 sacks common - total of 310 sacks

1-3-83  
DATE

Samuel N. Hersman  
DISTRICT WELL INSPECTOR

03/29/2024



STATE OF WEST VIRGINIA  
 DEPARTMENT OF MINES  
 OIL AND GAS DIVISION  
FINAL INSPECTION REQUEST  
INSPECTOR'S COMPLIANCE REPORT

**RECEIVED**

NOV 1 - 1983

OIL & GAS DIVISION  
 DEPT. OF MINES

Permit No. 005-6136  
 Company OVER JOHN INC.  
 Inspector MIKE U.  
 Date 10-26-83

County Ritchie  
 Farm \_\_\_\_\_  
 Well No. Lowther 2<sup>#</sup>

| RULE  | DESCRIPTION                               | IN COMPLIANCE |       |
|-------|-------------------------------------------|---------------|-------|
|       |                                           | Yes           | No    |
| 23.06 | Notification Prior to starting Work       | _____         | _____ |
| 25.04 | Prepared before Drilling to prevent waste | _____         | _____ |
| 25.03 | High-Pressure Drilling                    | _____         | _____ |
| 16.01 | Required Permits at wellsite              | _____         | _____ |
| 15.03 | Adequate Fresh Water Casing               | _____         | _____ |
| 15.02 | Adequate Coal Casing                      | _____         | _____ |
| 15.01 | Adequate Production Casing                | _____         | _____ |
| 15.04 | Adequate Cement Strength                  | _____         | _____ |
| 23.02 | Maintained Access Roads                   | _____         | _____ |
| 25.01 | Necessary Equipment to prevent Waste      | _____         | _____ |
| 23.03 | Reclaimed Drilling Site                   | <u>X</u>      | _____ |
| 23.04 | Reclaimed Drilling Pits                   | <u>X</u>      | _____ |
| 23.05 | No surface or underground Pollution       | _____         | _____ |
| 7.03  | Identification Markings                   | <u>X</u>      | _____ |

COMMENTS: O.K. to Release

Request well rec...

I have inspected the above well and (HAVE/HAVE NOT) found it to be in compliance with all of the rules and regulations of the Office of Oil and Gas Department of Mines of the State of West Virginia.

SIGNED: Mike Underwood  
 DATE: 10-26-83

03/29/2024

DETAILS OF PERFORATED INTERVALS, FRACTURING OR STIMULATING, PHYSICAL CHANGE, ETC.

First Stage  
4830 - 4524 - 26 perforations

Second Stage  
4274 - 3995 - 24 perforations

Third Stage  
3947 - 3730 - 26 perforations

Fourth Stage  
3488 - 3303 - 25 perforations

Nitrogen Frac with 2.6 million cubic feet of nitrogen.

WELL LOG

| FORMATION                    | COLOR | HARD OR SOFT | TOP FEET | BOTTOM FEET | REMARKS<br>Including indication of all fresh and salt water, coal, oil and gas |
|------------------------------|-------|--------------|----------|-------------|--------------------------------------------------------------------------------|
| unconsolidated gravel & clay |       |              | 0        | 60          |                                                                                |
| Sandstone                    |       |              | 60       | 85          | fresh water                                                                    |
| Shale                        |       |              | 85       | 210         |                                                                                |
| Pittsburg Coal               |       |              | 210      | 212         |                                                                                |
| Sand & Shale                 |       |              | 212      | 906         |                                                                                |
| Murphey Sand                 |       |              | 906      | 982         | Salt Water                                                                     |
| Dunkard Sand                 |       |              | 1418     | 1451        |                                                                                |
| Shale                        |       |              | 1451     | 1565        |                                                                                |
| Horseneck Sand               |       |              | 1565     | 1604        |                                                                                |
| First & Second Salt Sand     |       |              | 1644     | 1744        | Salt Water                                                                     |
| Third Salt Sand              |       |              | 1824     | 1858        | Salt Water                                                                     |
| Shale                        |       |              | 1858     | 1954        |                                                                                |
| Maxton Sand                  |       |              | 1954     | 1984        | Salt Water                                                                     |
| Greenbrier Limestone         |       |              | 2023     | 2042        |                                                                                |
| Big Injun                    |       |              | 2082     | 2181        | Oil & Gas                                                                      |
| Shale                        |       |              | 2190     | 2554        |                                                                                |
| Berea                        |       |              | 2554     | 2575        |                                                                                |
| Shale                        |       |              | 2575     | 2665        |                                                                                |
| Fifty Foot                   |       |              | 2665     | 2696        |                                                                                |
| Shale                        |       |              | 2696     | 2942        |                                                                                |
| Gordon                       |       |              | 2942     | 2978        |                                                                                |
| Shale                        |       |              | 2978     | 3760        |                                                                                |
| Tiona                        |       |              | 3760     | 3792        |                                                                                |
| Shale                        |       |              | 3792     | 4099        |                                                                                |
| Sheffield                    |       |              | 4099     | 4138        |                                                                                |
| Shale                        |       |              | 4138     | 4200        |                                                                                |
| Bradford                     |       |              | 4200     | 4226        |                                                                                |
| Shale                        |       |              | 4226     | 4853        |                                                                                |

(Attach separate sheets as necessary) /

Deep Rock Oil & Gas Company 03/29/2024  
 Well Operator  
 By: Bus White Bus White  
 Date: March 16, 1983 Owner

Note: Regulation 2.02(i) provides as follows:  
 "The term 'log' or 'well log' shall mean a systematic detailed geological record of all formations including..."



IV-35  
(Rev 8-81)

State of West Virginia  
Department of Mines  
Oil and Gas Division

Date March 16, 1983  
Operator's Well No. 2 - Lowther  
Farm Lowther  
API No. 47 - 085 - 6136

WELL OPERATOR'S REPORT  
OF  
DRILLING, FRACTURING AND/OR STIMULATING, OR PHYSICAL CHANGE

WELL TYPE: Oil x / Gas x / Liquid Injection     / Waste Disposal     /  
(If "Gas," Production     / Underground Storage     / Deep     / Shallow     /)

LOCATION: Elevation: 1203 Watershed Goose Creek  
District: Grant County Ritchie Quadrangle Schultz 7.5

COMPANY Deep Rock Oil & Gas Co.  
ADDRESS 4532 E. Kathbun Road, Birch Run,  
DESIGNATED AGENT Percy Johnson<sup>MI</sup>  
ADDRESS 6335 Emerson Ave., Parkersburg,  
SURFACE OWNER Harry Jones WV 26101  
ADDRESS Rt. 1 - Cairo, WV  
MINERAL RIGHTS OWNER Robert Lowther & Heirs  
ADDRESS Middlebourne, WV 26149  
OIL AND GAS INSPECTOR FOR THIS WORK Samuel  
Hersman ADDRESS Smithville, WV 26178  
PERMIT ISSUED December 28, 1982  
DRILLING COMMENCED December 28, 1982  
DRILLING COMPLETED January 7, 1983  
IF APPLICABLE: PLUGGING OF DRY HOLE ON  
CONTINUOUS PROGRESSION FROM DRILLING OR  
REWORKING. VERBAL PERMISSION OBTAINED  
ON    

| Casing & Tubing  | Used in Drilling | Left in Well | Cement fill up Cu. ft. |
|------------------|------------------|--------------|------------------------|
| Size 20-16 Cond. |                  |              |                        |
| 13-10"           |                  |              |                        |
| 9 5/8            |                  |              |                        |
| 8 5/8            | 1321             | 1321         | 340 sxs.               |
| 7                |                  |              |                        |
| 5 1/2            |                  |              |                        |
| 4 1/2            | 4853             | 4853         | 542 sxs.               |
| 3                |                  |              |                        |
| 2                |                  |              |                        |
| Liners used      |                  |              |                        |

GEOLOGICAL TARGET FORMATION Devonian Shale Depth 4,900 feet  
Depth of completed well 4853 feet Rotary x / Cable Tools      
Water strata depth: Fresh 60-85 feet; Salt 906-82 feet 1644-1744, 1824-185  
1954-84  
Coal seam depths: 210 Is coal being mined in the area? no

OPEN FLOW DATA  
Producing formation Devonian Shale Pay zone depth 3303-4830 feet  
Gas: Initial open flow 500 Mcf/d Oil: Initial open flow 0 Bbl/d  
Final open flow 307 Mcf/d Final open flow 0 Bbl/d  
Time of open flow between initial and final tests 24 hours  
Static rock pressure 450 psig (surface measurement) after 24 hours shut in  
(If applicable due to multiple completion--)  
Second producing formation     Pay zone depth     feet  
Gas: Initial open flow     Mcf/d Oil: Initial open flow     Bbl/d  
Final open flow     Mcf/d Oil: Final open flow     Bbl/d  
Time of open flow between initial and final tests     hours  
Static rock pressure     psig (surface measurement) after     hours shut in

(Continue on reverse side)

Ritchie 6136

03/29/2024





State of West Virginia  
Department of Mines  
Oil and Gas Division  
Charleston 25305

WALTER N. MILLER  
DIRECTOR

THEODORE M. STREIT  
ADMINISTRATOR

January 4, 1984

Over-John, Inc.  
6335 Emerson Avenue  
Parkersburg, W. Va. 26101

In Re: PERMIT NO: 47-085-6136  
FARM: A. B. Lowther Heirs  
WELL NO: 2  
DISTRICT: Grant  
COUNTY Ritchie

Gentlemen:

The FINAL INSPECTION REPORT for the above described well has been received in this office. Only the column check below applies:

\_\_\_\_\_ The well designated by the above permit number has been released under your Blanket Bond.

\_\_\_\_\_ Please return the enclosed cancelled single bond which covered the well designated by the above permit number to the surety company who executed said bond in your behalf, in order that they may give you credit on their records.

XXXXXX Your well record was received and reclamation requirements approved. In accordance with Chapter 22, Article 4, Section 2, the above captioned well will remain under bond coverage for life of the well.

Very truly yours,

Theodore M. Streit, Administrator  
Office of Oil & Gas-Dept. Mines

TMS/rl

03/29/2024

RECEIVED

SEP 13 1983



IV-27  
11/23/81

OIL & GAS DIVISION  
DEPT. OF MINES STATE OF WEST VIRGINIA  
DEPARTMENT OF MINES

Date: 9-6-83  
Well No: LOWMYER 2#  
API NO: 47-085-6136  
State County Permit

### Oil and Gas Division NOTICE OF VIOLATION

WELL TYPE: Oil X / Gas X Liquid Injection      / Waste Disposal      /  
Of "Gas" - Production      / Storage      / Deep      / Shallow X /  
LOCATION: Elevation: 1203 Watershed: GOOSE CREEK  
District: GRANT County: RITCHIE Quadrangle: SCHULTZ 7:51  
WELL OPERATOR OVER-JOHN INC DESIGNATED AGENT PERCY JOHNSON  
Address 6335 EMERSON AVE. Address 6335-EMERSON AVE  
PARKER BURG W. VA 26101 PARKER BURG W. VA 26101

The above well is being posted this 4 day of Sept, 1983, for a violation of Code 22-4-12.13 and/or Regulation 23.03, set forth in detail as follows:  
(USE REVERSE SIDE OF THIS NOTICE IF NECESSARY)

*Reclamation incomplete*

A copy of this notice has been posted at the well site and sent by certified or registered mail to the indicated well operator or his designated agent.  
You are hereby granted until SEPT 13, 1983, to abate this violation.  
Failure to abate the violation may result in action by the Department under Code 22-4-17 or Code 22-4-18.

Mike Underwood  
Oil and Gas Inspector

Address P.O. 2 Box 135  
SALEM W. VA 26426

Telephone: 782-1022 03/29/2024

RECEIVED

SEP 23 1983

IV-27  
1123X81



DEPT. OF MINES  
OIL & GAS DIVISION  
STATE OF WEST VIRGINIA

### Oil and Gas Division NOTICE OF VIOLATION

Date: 9-14-83  
Well No: Kenneth 2  
API No: 17-055-0130  
State County Permit

WELL TYPE: Oil  Gas  Liquid Injection  Waste Disposal   
Of "Gas" - Production  Storage  Deep  Shallow

LOCATION: Elevation: 1525 Watershed: Green Creek  
District: Grant County: Pitkin Quadrangle: Section 12

WELL OPERATOR: Over-Tech Inc DESIGNATED AGENT: Henry Johnson  
Address: 635 Emerson Ave Address: 635 Emerson Ave

635 Emerson Ave 635 Emerson Ave

The above well is being posted this 14 day of Sept, 1983, for a violation of Code 22-4-17 and/or Regulation 22.13, set forth in detail as follows:  
(USE REVERSE SIDE OF THIS NOTICE IF NECESSARY)

*Production irregular*

A copy of this notice has been posted at the well site and sent by certified or registered mail to the indicated well operator or his designated agent.  
You are hereby granted until Sept 13, 1983, to abate this violation.  
Failure to abate the violation may result in action by the Department under

Code 22-4-17 or Code 22-4-18.

[Signature]  
Oil and Gas Inspector

Address: P.O. Box 135  
Salmon, W. Va. 26049

Telephone: 782-1043

03/29/2024



DATE: December 29, , 1982  
OPERATOR'S  
WELL NO.: Lowther #2

API NO: 47 - 085 -  
State County Permi

State of West Virginia

OFFICE OF OIL AND GAS  
DEPARTMENT OF MINES

A F F I D A V I T

State of West Virginia

County of Wood

I, Donald C. Arnott (the designated owner or operator, or authorized representative thereof), after being duly sworn, do depose and say that the undersigned is authorized by the owner of the working interest in the well permit application to which this affidavit is attached do state that (he, she, or it) shall tender to the owner of the oil and gas in place not less than one-eighth of the total amount paid to or received by or allowed to the owner of the working interest at the wellhead for the oil or gas so extracted, produced, or marketed before deducting the amount to be paid or set aside for the owner of the oil or gas in place, or all such oil or gas to be extracted, produced, or marketed from the well. West Virginia Code 22-4-11(e) (1982).

Signed: 

Taken, Subscribed, and sworn to before me this 29 day of Dec., 1982.

Notary: Harold L. Darling

My Commission Expires: October 6, 1986

RECEIVED  
DEC 30 1982  
OIL & GAS DIVISION  
DEPT. OF MINES

Mr. Bus White  
December 13, 1982  
Page 3

---

vested in Canyon Oil Corporation, subject only to the following liens, objections and defects, assuming the indices in said Clerk's Office are accurate and complete and subject to an accurate survey or inspection of the premises:

(1) The Estate of A. B. Lowther, who died testate on or about April 2, 1980, owning the minerals and leasing rights in the subject property and by his will leaving all interests to his wife, Grace E. Lowther, has not been appraised, released from inheritance taxes or settled in Ritchie County.

(2) Real estate taxes for the year 1982 are paid.

(3) Real estate taxes for the year 1982 are assessed on the Land Book for Grant District as follows:

Lowther, Robert, 64-1/2 Acres Minerals Goose Creek  
Lowther, Robert, 1/2 Acre Minerals Goose Creek  
Lowther, Robert, 18 Acres Minerals Goose Creek

(4) Oil and gas leases as follows:

(a) R. M. Lowther and wife to F. R. Parshall, dated July 21, 1903, recorded in Lease Book No. 19, at page 126, for the term of three years, and as much longer as the premises are operated for oil or gas or as rent for failure to commence operation is paid, covering 64-1/2 acres.

(b) R. M. Lowther and wife to Freehold Oil & Gas Co., dated December 6, 1912, recorded in Lease Book No. 37, at page 296, for so long as \$15.00 per year rental is paid, covering 1/2 acre tract.

(c) R. M. Lowther and wife to David French, dated September 18, 1919, recorded in Lease Book No. 44, at page 233, for the term of three years, or for as much longer as delay rental is paid, covering 18 acre tract.

03/29/2024

M.S. 12/30/82

← 5,100' →

LATITUDE 39° 20'

LONGITUDE 81° 07' 30"

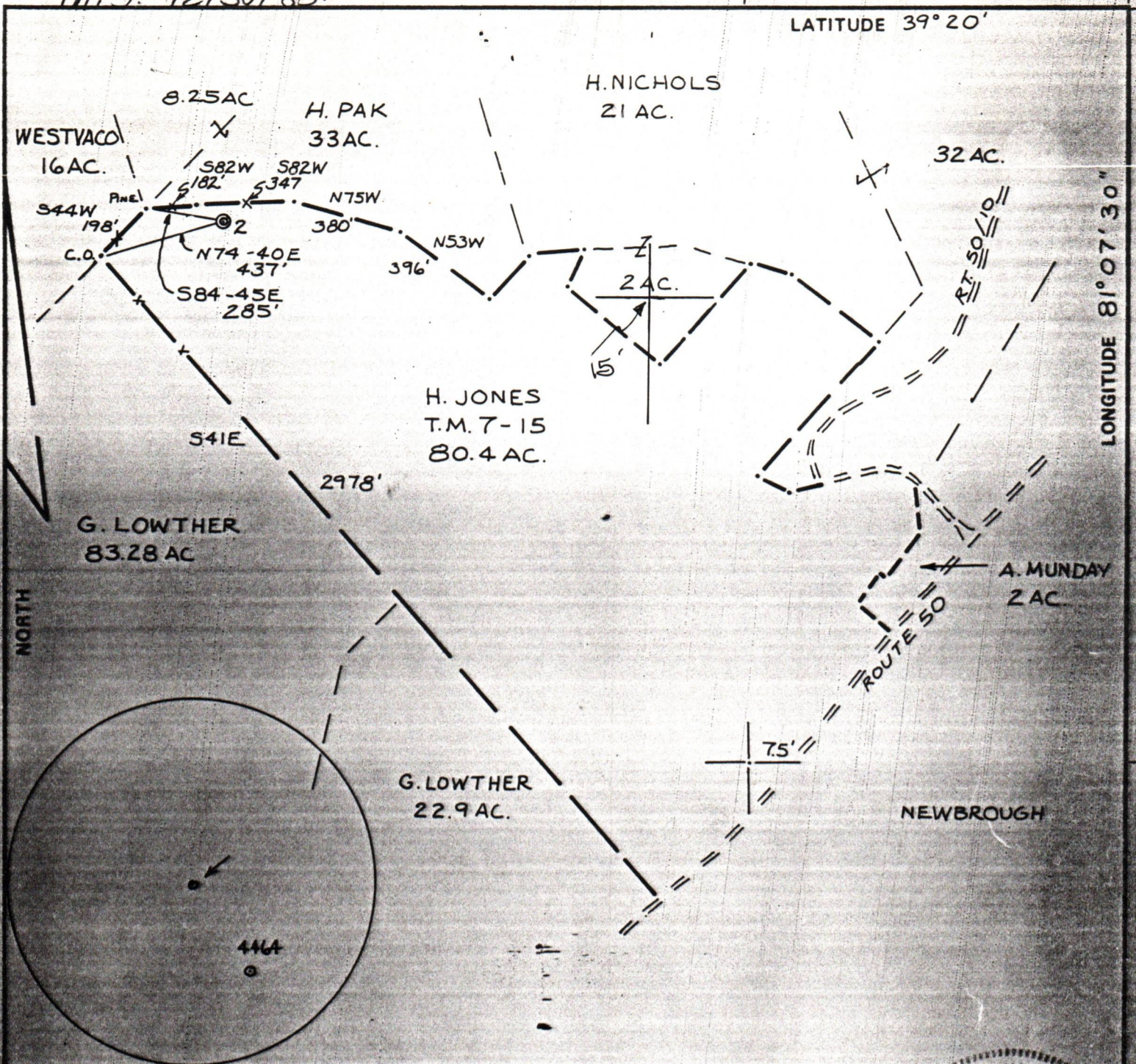

FILE NO. 81-50  
 DRAWING NO. 2  
 SCALE 1"=500  
 MINIMUM DEGREE OF ACCURACY 1/200  
 PROVEN SOURCE OF ELEVATION RD. INTER. 1079'

I THE UNDERSIGNED, HEREBY CERTIFY THAT THIS PLAT IS CORRECT TO THE BEST OF MY KNOWLEDGE AND BELIEF AND SHOWS ALL THE INFORMATION REQUIRED BY LAW AND THE REGULATIONS ISSUED AND PRESCRIBED BY THE DEPARTMENT OF MINES.  
 (SIGNED) Neal Hughes  
 R.P.E. \_\_\_\_\_ L.L.S. 632

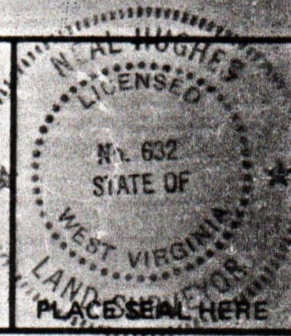

(+) DENOTES LOCATION OF WELL ON UNITED STATES TOPOGRAPHIC MAPS  
 FORM IV-6 (8-78)



DATE DEC. 15, 19 82  
 OPERATOR'S WELL NO. LOWTHER 2  
 API WELL NO. 47-085-6136  
 STATE COUNTY PERMIT

STATE OF WEST VIRGINIA  
 DEPARTMENT OF MINES  
 OIL AND GAS DIVISION

WELL TYPE: OIL  GAS  LIQUID INJECTION \_\_\_\_\_ WASTE DISPOSAL \_\_\_\_\_  
 (IF "GAS,") PRODUCTION  STORAGE \_\_\_\_\_ DEEP \_\_\_\_\_ SHALLOW \_\_\_\_\_  
 LOCATION: ELEVATION 1203' WATER SHED GOOSE CREEK  
 DISTRICT GRANT COUNTY RITCHIE  
 QUADRANGLE SCHULTZ 7.5'  
 SURFACE OWNER HARRY JONES ACREAGE 80.4  
 OIL & GAS ROYALTY OWNER A. B. LOWTHER HEIRS LEASE ACREAGE 82.5 03/29/2024  
 LEASE NO. \_\_\_\_\_  
 PROPOSED WORK: DRILL  CONVERT \_\_\_\_\_ DRILL DEEPER \_\_\_\_\_ REDRILL \_\_\_\_\_ FRACTURE OR STIMULATE  PLUG OFF OLD FORMATION \_\_\_\_\_ PERFORATE NEW FORMATION \_\_\_\_\_ OTHER PHYSICAL CHANGE IN WELL (SPECIFY) \_\_\_\_\_  
 PLUG AND ABANDON \_\_\_\_\_ CLEAN OUT AND REPLUG \_\_\_\_\_  
 TARGET FORMATION MARCELLUS ESTIMATED DEPTH 5500'  
 WELL OPERATOR OVERJOHN, INC. DESIGNATED AGENT PERCY JOHNSON  
 ADDRESS 6335 EMERSON AVENUE ADDRESS EMERSON AVE.  
PARKERSBURG, WV 26101 PARKERSBURG, W. VA. 26101

KT-6136