



1) Date: April 5, 19 83  
 2) Operator's Giebell B-90-1  
 Well No.  
 3) API Well No. 47 085 6381  
 State County Permit

DRILLING CONTRACTOR:  
 Gene Stalnaker, Inc.  
 P.O. Box 178  
 Glenville, WV 26351

STATE OF WEST VIRGINIA  
 DEPARTMENT OF MINES, OIL AND GAS DIVISION

OIL AND GAS WELL PERMIT APPLICATION

- 4) WELL TYPE: A Oil / Gas  /  
 B (If "Gas", Production / Underground storage / Deep / Shallow  /)
- 5) LOCATION: Elevation: 1108 Watershed: Horner Run  
 District: Clay County: Ritchie Quadrangle: Pennsboro 7.5
- 6) WELL OPERATOR Gene Stalnaker, Inc. 11) DESIGNATED AGENT Gene Stalnaker  
 Address P.O. Box 178 Address P.O. Box 178  
 Glenville, WV 26351 Glenville, WV 26351
- 7) OIL & GAS ROYALTY OWNER C.E. & Mary Giebell 12) COAL OPERATOR n/a  
 Address Pennsboro, WV Address n/a  
 Acreage 202.04
- 8) SURFACE OWNER C.E. & Mary Giebell 13) COAL OWNER(S) WITH DECLARATION ON RECORD:  
 Address Pennsboro, WV Name n/a  
 Acreage 20 of 202.04 Address  
 Name
- 9) FIELD SALE (IF MADE) TO: Address  
 Address
- 10) OIL & GAS INSPECTOR TO BE NOTIFIED  
 Name Samuel Hersman Address  
 Address Box 66 Smithville, WV  
 477-3597
- 14) COAL LESSEE WITH DECLARATION ON RECORD:  
 Name n/a  
 Address
- 15) PROPOSED WORK: Drill  / Drill deeper / Redrill / Fracture or stimulate  
 Plug off old formation / Perforate new formation  
 Other physical change in well (specify)
- 16) GEOLOGICAL TARGET FORMATION, Devonian Shale
- 17) Estimated depth of completed well, 5300 feet
- 18) Approximate water strata depths: Fresh, 140 feet; salt, feet.
- 19) Approximate coal seam depths: n/a Is coal being mined in the area? Yes / No

20) CASING AND TUBING PROGRAM

CASING OR TUBING TYPE	SPECIFICATIONS					FOOTAGE INTERVALS		CEMENT FILL-UP OR SACKS (Cubic feet)	PACKERS
	Size	Grade	Weight per ft.	New	Used	For drilling	Left in well		
Conductor	11 3/4			x		40'			Kinds
Fresh water									Sizes
Coal									
Intermediate	8 5/8	CW	20lb.	x		1200'	1200'	To Surface	NEAT
Production	4 1/2	ERW	10.50	x			5300'	2000' Fill	Depths set
Tubing								Up	
Liners									Perforations: Top Bottom

RECEIVED

APR 7 - 1983

21) EXTRACTION RIGHTS

Check and provide one of the following:

- Included is the lease or leases or other continuing contract or contracts by which I hold the right to extract oil or gas.  
 The requirement of Code 22-4-1-(c) (1) through (4). (See reverse side for specifics.)

OIL AND GAS DIVISION  
 WV DEPARTMENT OF MINES

22) ROYALTY PROVISIONS

Is the right to extract, produce or market the oil or gas based upon a lease or other continuing contract or contracts providing for flat well royalty or any similar provision for compensation to the owner of the oil or gas in place which is not inherently related to the volume of oil or gas so extracted, produced or marketed? Yes  No

If the answer above is No, nothing additional is needed. If the answer is Yes, you may use Affidavit Form IV-60.

23) Required Copies (See reverse side.)

24) Copies of this Permit Application and the enclosed plat and reclamation plan have been mailed by registered mail or delivered by hand to the above named coal operator, coal owner(s), and coal lessee on or before the day of the mailing or delivery of this Permit Application to the Department of Mines at Charleston, West Virginia.

Notary: Stewart B. Duffield  
 My Commission Expires August 6, 1992

Signed: Gene Stalnaker  
 Its: President

OFFICE USE ONLY

DRILLING PERMIT

Permit number 47-085-6381

Date April 13 1983  
 08/18/2023

This permit covering the well operator and well location shown below is evidence of permission granted to drill in accordance with the pertinent legal requirements subject to the conditions contained herein and on the reverse hereof. Notification must be given to the District Oil and Gas Inspector. (Refer to No. 10) Prior to the construction of roads, locations and pits for any permitted work. In addition, the well operator or his contractor shall notify the proper district oil and gas inspector 24 hours before actual permitted work has commenced.)

Permit expires December 13, 1983

unless drilling is commenced prior to that date and prosecuted with due diligence.

Bond: BB	Agent: 77	Plat: [Signature]	Casing: [Signature]	Fee: 13304
----------	-----------	-------------------	---------------------	------------

Administrator, Office of Oil and Gas

Line Item Explanation

FORM IV-2  
(Over)  
(8-8)

- 1) Date of Application
- 2) Your well name and number
- 3) To be filled out by office of oil & gas
- 4A) "Oil" means natural crude oil or petroleum and other hydrocarbons, regardless of gravity, which are produced at the well in liquid form by ordinary production methods and which are not the result of condensation of gas after it leaves underground reservoirs: "Gas" means all natural gas and all other fluid hydrocarbons not defined as oil.
- 4B) "Shallow well" means any well drilled and completed in a formation above the top of the uppermost member of the "Onondaga Group" or a depth less than six thousand feet, whichever is shallower.  
"Deep well" means any well drilled and completed in a formation at or below the top of the uppermost member of the "Onondaga Group" or at a depth less than six thousand feet, whatever is shallower.
- 5) Where well is located
- 6) Before a permit can be issued in a corporation, company partnership, or fictitious name, the name must be registered with the Secretary of State Office
- 7) Use separate sheet if necessary
- 8) Present surface owner at time application is filed.
- 9) Optional
- 11) See Reg. 7.01 relating to code §22-4-1k
- 12) "Coal Operator" means any persons, firm, partnership, partnership association or corporation that proposes to or does operate a coal mine. See Note 24
- 13 & 14) As per §22-4-20; See Note 24
- 15) Work that will be attempted—A separate Form IV-2 shall not be required for fracturing or stimulating a well where fracturing or stimulating is to be part of the work for which a permit is sought and is noted as such on the Form IV-2 filed in connection therewith.
- 16) Anticipated formation for which well will be completed
- 17) Self explanatory
- 18) Depth to deepest freshwater, and shallowest salt water, taken from nearby wells corrected for differences in elevation
- 19) All coal seam depths
- 20) Proposed casing program and cementing refer to Code 22-4-5, 22-4-6, 22-4-7, 22-4-8, 22-4-8a Reg 9.01, 15.01, 15.02, 15.03, 15.04, 25.01, 25.02, 25.03, 25.04
- 21) Code 22-4-11(c) - In lieu of filing the lease or leases or other continuing contract or contracts, the applicant for a permit described herein may file the following:
  - (1) A brief description of the tract of land including the district and county wherein the tract is located;
  - (2) The identification of all parties to all leases or other continuing contractual agreements by which the right to extract, produce or market the oil or gas is claimed;
  - (3) The book and page number wherein each such lease or contract by which the right to extract, produce or market the oil or gas is recorded;
  - (4) A brief description of the royalty provisions of each such lease or contract.
- 22) Code 22-4-11(d) and 22-4-11(e).
- 23) Regulation 7.02 of the Department of Mines provides that the original and four copies of Form IV-2 must be filed with the Department, accompanied by (i) a plat in the form prescribed by Regulation 11, (ii) a bond in one of the forms prescribed by Regulation 12, or in lieu thereof the other security allowed by Code §22-4-2, (iii) Form IV-9, "Reclamation Plan", applicable to the reclamation required by Code §22-4-12b and Regulation 23, (iv) unless previously paid on the same well, the fee required by Code §22-4-12a, and (v) if applicable, the consent required by Code §22-4-8a from the owner of any water well or dwelling within 200 feet of the proposed well.
- 24) **The above named coal operator, coal owner(s), and coal lessee are hereby notified that any objection they wish to make or are required to make by Code §22-4-3 must be filed with the Department of Mines within fifteen (15) days after the receipt of this Application by the Department.**

The following waiver must be completed by the coal operator and by any coal owner or coal lessee who has recorded a declaration under Code 22-4-20, if the permit is to be issued within fifteen (15) days of receipt thereof.

WAIVER

The undersigned coal operator \_\_\_\_\_ / owner \_\_\_\_\_ / lessee \_\_\_\_\_ of the coal under this well location has examined this proposed well location. If a mine map exists which covers the area of the well location, the well location has been added to the mine map. The undersigned has no objection to the work proposed to be done at this location, provided, the well operator has complied with all applicable requirements of the West Virginia Code and the governing regulations.

08/18/2023

Date: \_\_\_\_\_, 19 \_\_\_\_\_

By \_\_\_\_\_  
Its \_\_\_\_\_

NOTE: Keep one copy of this permit posted at the drilling location.

ATTACH OR PHOTOCOPY SECTION OF INVOLVED TOPOGRAPHIC MAP. QUADRANGLE Pennsboro 7.5'

LEGEND

Well Site ⊕

Access Road ———

WELL SITE PLAN

Sketch to include well location, existing access road, roads to be constructed, wellsite, drilling pits and necessary structures numbered or lettered to correspond with the first part of this plan. Include all natural drainage.

LEGEND

Property boundary	——— ——— ——— ——— ———	Diversion	~~~~~
Road	== == == == ==	Spring	○ →
Existing fence	— x — x —	Wet spot	⊕
Planned fence	— / — / —	Building	▣
Stream	~~~~~	Drain pipe	○ — ○ — ○ —
Open ditch	→ → → → →	Waterway	⇄ ⇄ ⇄ ⇄

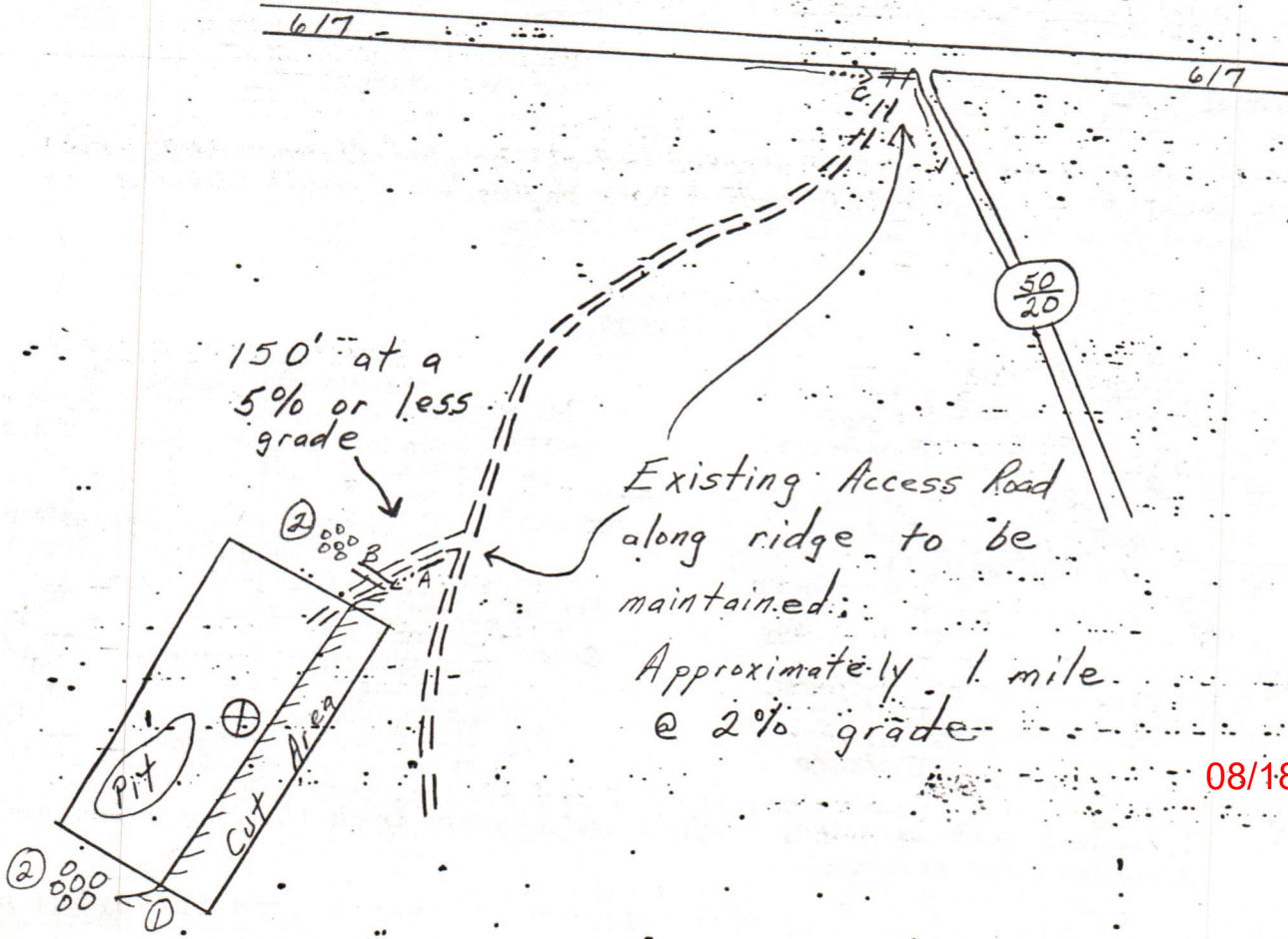

08/18/2023

State of West Virginia

Department of Mines  
Oil and Gas Division

CONSTRUCTION AND RECLAMATION PLAN

COMPANY NAME Gene Stalnaker, Inc.

DESIGNATED AGENT Gene Stalnaker

Address P.O. Box 178, Glenville, W. V. 26351

Address P.O. Box 178, Glenville, W. V.

Telephone 462-5701

Telephone 462-5701

LANDOWNER C.E. & Mary Giebell

SOIL CONS. DISTRICT Little Kanawha

Revegetation to be carried out by Gene Stalnaker, Inc.

(Agent)

This plan has been reviewed by Little Kanawha SCD. All corrections and additions become a part of this plan:

3-12-83  
(Date)

Garrett Newton  
(SCD Agent)

ACCESS ROAD

Structure Drainage Ditch

Spacing N/A

Page Ref. Manual 2-12

Structure Cross Drain

Spacing 50'

Page Ref. Manual 2-1

Structure Road Culvert

Spacing 1 (one) 12" Pipe

Page Ref. Manual 2-1

LOCATION

(A) Structure Diversion Ditch (1)

Material Earthen

Page Ref. Manual 2-12

(B) Structure Sediment Barrier (2)

Material Stone or logs

Page Ref. Manual 2-16

(C) Structure (3)

Material

Page Ref. Manual

All structures should be inspected regularly and repaired if necessary. All commercial timber is to be cut and stacked and all brush and small timber to be cut and removed from the site before dirt work begins.

REVEGETATION

Treatment Area I & II

Lime \_\_\_\_\_ Tons/acre  
or correct to pH 6.5

Fertilizer 600 lbs/acre  
(10-20-20 or equivalent)

Mulch Hay 2 Tons/acre

Seed\* KY-31 35 lbs/acre

Ladino Clover 5 lbs/acre

lbs/acre

Lime \_\_\_\_\_ Tons/acre  
or correct to pH \_\_\_\_\_

Fertilizer \_\_\_\_\_ lbs/acre  
(10-20-20 or equivalent)

Mulch \_\_\_\_\_ Tons/acre

Seed\* \_\_\_\_\_ lbs/acre

lbs/acre

lbs/acre

08/18/2023

\*Inoculate all legumes such as vetch, trefoil and clovers with the proper bacterium. Inoculate with 3X recommended amount.

PLAN PREPARED BY Smith Land Surveying Co.

ADDRESS 111 South Street

Glenville, WV 26351

PHONE NO. 304-462-5634

NOTES: Please request landowners' cooperation to protect new seedling for one growing season. Attach separate sheets as necessary for comments.

085-6381

PARKERSBURG 39 MI.  
ELLENBORO 3.5 MI.

4762 I SE  
(ELLENBORO)

17'30"

4349

4350

4351



THIS AGREEMENT, Made and entered into the 2nd day of March, 1983

by and between C.E. Giebell (widower)

Charles E. Giebell and Merlene Jane Giebell

part of the first part, hereinafter called the Lessor, and Gene Stalnaker party of the second part, hereinafter called the Lessee.

Witnesseth, That the Lessor in consideration of One Dollar in hand paid by the Lessee, receipt of which is hereby acknowledged, and of the covenants and agreements hereinafter contained, hereby grants and warrants generally the title to all the oil and gas in and under, and grants, demises and leases with covenants of quiet possession, and of sole right to convey, all that certain tract of land hereinafter described, for the sole and only purpose of operating for and producing oil and gas, together with the rights of way and servitudes for pipe lines, structures, plants, drips, tanks, stations, telephone, telegraph and electric power lines, houses for gates, meters and regulators, and all other rights and privileges necessary, incident to and convenient for the economic operation, including the drilling of wells, of this land for oil and gas, with the right to use free oil, gas and water for such purposes and with the right of removing either during or after the term hereof all and any property and improvements placed or erected on the premises by Lessee; also with the right of operating as one entire tract, or subdividing the premises situate in Clay District, Ritchie County, and State of West Virginia, on the waters of Horners Run bounded and described as follows:

On the North by lands of C.E. Giebell and Edgar Davis
On the East by lands of Joy Lou Noland and Ed
On the South by lands of Clarence Wade (See Exhibit A)
On the West by lands of Anne Delorse Scull
Containing (Seven tracts) 201 acres, more or less, reserving, however feet from the building now on the premises, on

RECEIVED

APR 7 - 1983

OIL AND GAS DIVISION WV DEPARTMENT OF MINES

6 months

To have and to hold unto and for the use of the Lessee for the term of 6 months from this date, and as long thereafter as the said land is operated by the Lessee in the search for or production of oil or gas, with the extension of term by payment of rentals as hereinafter set forth.

IN CONSIDERATION OF THE PREMISES the said Lessee covenants and agrees: 1st—To deliver to the credit of the Lessor, Their heirs or assigns, free of cost, in the pipe line to which said Lessee may connect its wells, a royalty of the equal one-eighth (1/8) part of all oil produced and saved from the leased premises; 2nd—To pay the equal one-eighth (1/8) of all money received from sale of gas from each and every gas well drilled on said premises, the product from which is marketed and used off the premises, said payment to be made within sixty days after commencing to market the gas therefrom as aforesaid and to be paid each three months thereafter while the gas from said well or wells is so marketed and used.

Said Lessee shall not be required in any event to increase the rate of said gas well payments or said royalty of oil or the delay rental payments hereinafter provided by reason of any royalty or interest in said oil or gas that may have been heretofore sold, reserved or conveyed by said Lessor or predecessors in title or otherwise; and if the Lessor does not have title to all the oil and gas in the leased premises, there shall be refunded such part of all delay rental and gas well payments made by the Lessee under this lease, as shall be proportionate to the outstanding title, and payments thereafter to be made for such purposes shall be reduced in the same proportion.

The leased premises may be fully and freely used by the Lessor for farming purposes, excepting such parts as are used by Lessee in operating hereunder.

08/18/2023

The said Lessee covenants and agrees to pay a rental at the rate of \$1,000.00 per month

( \$ ) ~~to be paid quarterly in advance~~ beginning ~~in~~ April 15, 1983 ~~months from~~ ~~this date~~ until a well is completed, or this lease surrendered; any rental paid for time beyond the date of completion of a gas well shall be credited upon the first royalty due upon the same.

All payments hereunder may be direct to the Lessor, or deposited to \_\_\_\_\_ credit or the credit of \_\_\_\_\_ respective heirs or assigns in \_\_\_\_\_ at \_\_\_\_\_ Post Office, \_\_\_\_\_ County, State of West Virginia, or in any of said methods to \_\_\_\_\_, who is hereby appointed agent to receive and receipt for the same.

Lessor may lay a line to any well producing gas only on said land or to second party's pipe line leading from said well to market, to take gas produced from said well for Their own use for heat and light in ~~the~~ dwelling house on said land at Lessor's own risk, subject to the use, operation, pumping and right of abandonment of the well and pipe line by the Lessee; ~~the first two hundred thousand~~ ~~feet of gas to be taken in each year shall be taken by the Lessor at the current published local rates of the Lessee~~ ~~and measurement (and regulation) shall be by meter and regulators set at the tap on the well or line.~~ This privilege is upon condition that the Lessor shall use said gas with economy, in safe and proper pipes and appliances, and shall subscribe to and be bound by reasonable rules and regulations of the Lessee published at such time relating to such use of gas. Also agreed are the following terms.

Lessor shall have unlimited free gas for three homes on or off of lease, as soon as wells are drilled in. All gas and oil pipelines shall be buried by Lessee;

This lease is not to be assigned or subleased without written consent of lessor;

All roads and well locations to be reclaimed and maintain in passable and suitable condition; If any well is abandon the lessor shall have the right to buy that well at salvage

value; All roads and well locations to be made by mutual agreement;

Lessor reserves a 1/64th O.R.R. in each and every well drilled on this lease.

It is further agreed that the Lessee shall have the right at any time to surrender this lease, or from time to time any part or parts of the leased land upon the payment of One (\$1.00) Dollar and all amounts due hereunder as to the land so surrendered, and thereafter the Lessee shall be released and discharged from all payments, obligations, covenants and conditions herein contained as to the land so surrendered, and this lease shall thereupon become null and void as to land in respect to which a surrender is made. If at the end of 6 months wells are not completed and in production lessee agrees to pay \$1,000.00 amonth till such time wells are in production.

The Lessor agrees that the recordation of deed of surrender in the proper County, and deposit in the post office of a check payable as above provided for said last mentioned sum and all amounts then due hereunder, shall be and be accepted as full and legal surrender of Lessee's rights under this lease.

Reserve the right not to have water taken out of 2 of our (Lessor) ponds.

All terms, conditions, limitations and covenants between the parties hereto shall extend to their respective heirs, successors, personal representatives and assigns.

IN WITNESS WHEREOF the parties to this agreement have hereunto set their hands and seals the day and year first above written.

Witness:  
Prepared by *[Signature]*

*C.E. Gibel* (Seal)

*Merlene Gibel* (Seal)

*[Signature]* (Seal)

\_\_\_\_\_ (Seal)

\_\_\_\_\_ (Seal)

\_\_\_\_\_ (Seal)

Signed: \_\_\_\_\_

Exhibit A

Fee	70 acres 22 poles	Tax Map 19 parcel 38
Fee	25 acres	Tax Map 19 parcel 27
Fee	16 acres 12 poles	Tax Map 19 parcel 27.1
Fee	59 acres 93 poles	Tax Map 19 parcel 28
5/6 OGM	14 acres 42 poles	Tax Map 19 parcel 38.3
5/6 OGM	14 acres 15 poles	Tax Map 19 parcel 38.2
5/6 OGM	2½ acres	Tax Map 19 parcel 38.1

STATE OF WEST VIRGINIA

COUNTY OF Ritchie

TO-WIT: I, Cynthia L. Brake, a Notary Public in and for said County and State, do certify that C.F. Giebell, & C.F. Giebell Jr. and Merlene Giebell his wife, whose name Merlene signed to the writing above, bearing date the 2 day of March 1983, has ack this day acknowledged the same before me in my said County.

Given under my hand this 4 day of March, 1983.

My Commission expires Jan. 21, 1990 Cynthia L. Brake, Notary Public

STATE OF WEST VIRGINIA

COUNTY OF

TO-WIT: I, \_\_\_\_\_, a Notary Public in and for said County and State, do certify that \_\_\_\_\_ and \_\_\_\_\_ his wife, whose name \_\_\_\_\_ signed to the writing above, bearing date the \_\_\_\_\_ day of \_\_\_\_\_ 19\_\_\_\_, has \_\_\_\_\_ this day acknowledged the same before me in my said County.

Given under my hand this \_\_\_\_\_ day of \_\_\_\_\_, 19\_\_\_\_\_.

My Commission expires \_\_\_\_\_, Notary Public

STATE OF WEST VIRGINIA

COUNTY OF

TO-WIT: I, \_\_\_\_\_, a Notary Public in and for said County and State, do certify that \_\_\_\_\_ and \_\_\_\_\_ his wife, whose name \_\_\_\_\_ signed to the writing above, bearing date the \_\_\_\_\_ day of \_\_\_\_\_ 19\_\_\_\_, has \_\_\_\_\_ this day acknowledged the same before me in my said County.

Given under my hand this \_\_\_\_\_ day of \_\_\_\_\_, 19\_\_\_\_\_.

My Commission expires \_\_\_\_\_, Notary Public



RECEIVED

08/18/2023

B2

DETAILS OF PERFORATED INTERVALS, FRACTURING OR STIMULATING, PHYSICAL CHANGE, ETC.

Stage 1	20 Holes	4666-4948	696,000 Nitrogen	500 Gal. 15% HCL
Stage 2	34 Holes	4061-4634	784,000 Nitrogen	500 Gal. 15% HCL
Stage 3	16 Holes	3685-4025	724,000 Nitrogen	500 Gal. 15% HCL
Stage 4	13 Holes	3516-3668	689,000 Nitrogen	500 Gal. 15% HCL

WELL LOG

FORMATION	COLOR	HARD OR SOFT	TOP FEET	BOTTOM FEET	REMARKS
					Including indication of all fresh and salt water, coal, oil and gas
KB-GL			0	10	
Clay Rock, Sand, Red Rock, Shale			10	1956	
Maxon			1956	2050	
Big Lime			2050	2092	
Injun			2092	2151	
Squaw			2151	2169	
D. Siltstone			2169	2440	
Weir			2440	2474	
Berea			2474	2485	
Shale			2485	2568	
Thirty Foot			2568	2660	
Gordon			2660	2728	
Siltstone			2728	2950	
Fifth Sand			2950	2969	
Shale-Siltstone			2969	3518	
Warren			3518	3597	
Siltstone			3597	3880	
Speechley			3880	3950	
Siltstone			3950	4612	
First Riley			4612	4637	
Siltstone			4637	4830	
Second Riley			4830	4852	
Siltstone			4852	4952	
Benson			4952	4963	
Siltstone			4963	5109	

(Attach separate sheets as necessary)

Gene Stalnaker, Inc.  
Well Operator

By: *Gene Stalnaker*

President

Date: August 29, 1983

08/18/2023

Note: Regulation 2.02(i) provides as follows:  
"The term 'log' or 'well log' shall mean a systematic detailed geological record of all formations, including coal, encountered in the drilling of a well."



B<sup>m</sup>

STATE OF WEST VIRGINIA  
DEPARTMENT OF MINES  
OIL AND GAS WELLS DIVISION

RECEIVED

AUG - 8 1983

INSPECTOR'S WELL REPORT

OIL & GAS DIVISION  
DEPT. OF MINES  
Oil or Gas Well \_\_\_\_\_  
(KIND)

Permit No. 85-6381

Company Gene Stalnaker

Address \_\_\_\_\_

Farm C.F + Mary Diebell

Well No. Diebell B-90-1

District Clay County Pitchco

Drilling commenced 8-1-83

Drilling completed \_\_\_\_\_ Total depth \_\_\_\_\_

Date shot \_\_\_\_\_ Depth of shot \_\_\_\_\_

Initial open flow \_\_\_\_\_ /10ths Water in \_\_\_\_\_ Inch

Open flow after tubing \_\_\_\_\_ /10ths Merc. in \_\_\_\_\_ Inch

Volume \_\_\_\_\_ Cu. Ft.

Rock pressure \_\_\_\_\_ lbs. \_\_\_\_\_ hrs.

Oil \_\_\_\_\_ bbls., 1st 24 hrs.

Fresh water \_\_\_\_\_ feet \_\_\_\_\_ feet

Salt water \_\_\_\_\_ feet \_\_\_\_\_ feet

CASING AND TUBING	USED IN DRILLING	LEFT IN WELL	PACKERS
Size			
16			Kind of Packer _____
13			
10			Size of _____
8 1/4			
6 5/8			Depth set _____
5 3/16			
3			Perf. top _____
2			Perf. bottom _____
Liners Used			Perf. top _____
			Perf. bottom _____

CASING CEMENTED \_\_\_\_\_ SIZE \_\_\_\_\_ No. FT. \_\_\_\_\_ Date \_\_\_\_\_

NAME OF SERVICE COMPANY \_\_\_\_\_

COAL WAS ENCOUNTERED AT \_\_\_\_\_ FEET \_\_\_\_\_ INCHES

\_\_\_\_\_ FEET \_\_\_\_\_ INCHES FEET \_\_\_\_\_ INCHES

\_\_\_\_\_ FEET \_\_\_\_\_ INCHES FEET \_\_\_\_\_ INCHES

Drillers' Names \_\_\_\_\_

Remarks: Ran 1268' foot of 8 5/8" casing Dowell ran 315 sacks cement. good circulation of cement

8-2-83  
DATE

Samuel N. Hersman  
DISTRICT WELL INSPECTOR

08/18/2023

8-10-83  
DATE

Samuel N. Hersman  
DISTRICT WELL INSPECTOR



B5

STATE OF WEST VIRGINIA  
DEPARTMENT OF MINES  
OIL AND GAS DIVISION

FINAL INSPECTION REQUEST

INSPECTOR'S COMPLIANCE REPORT

RECEIVED  
OCT 13 1983

OIL & GAS DIVISION  
DEPT. OF MINES

Permit No. 087-6381  
Company Gene Stalnaker, Inc.  
Inspector SAMUEL N. HERSMAN  
Date September 2, 1983

County Ritchie/Clay  
Farm C. E. & Mary Giebell  
Well No. B-90-1

RULE	DESCRIPTION	IN COMPLIANCE	
		Yes	No
23.06	Notification Prior to starting Work	___	___
25.04	Prepared before Drilling to prevent waste	___	___
25.03	High-Pressure Drilling	___	___
16.01	Required Permits at wellsite	___	___
15.03	Adequate Fresh Water Casing	___	___
15.02	Adequate Coal Casing	___	___
15.01	Adequate Production Casing	___	___
15.04	Adequate Cement Strength	___	___
23.02	Maintained Access Roads	___	___
25.01	Necessary Equipment to prevent Waste	___	___
23.03	Reclaimed Drilling Site	___	✓
23.04	Reclaimed Drilling Pits	___	___
23.05	No surface or underground Pollution	___	___
7.03	Identification Markings	___	___

COMMENTS: Location needs mulch, seed, lime  
can not release at this time  
Dozer on location completing dirt work

I have inspected the above well and (HAVE/HAVE NOT) found it to be in compliance with all of the rules and regulations of the Office of Oil and Gas Department of Mines of the State of West Virginia.

SIGNED: Samuel N. Hersman 08/18/2023  
DATE: 10-11-83

STATE OF WEST VIRGINIA  
 DEPARTMENT OF MINES  
 OIL AND GAS DIVISION  
FINAL INSPECTION REQUEST  
INSPECTOR'S COMPLIANCE REPORT

**RECEIVED**  
 JUL 29 1985

DIVISION OF OIL & GAS  
 DEPARTMENT OF ENERGY

Permit No. 087-6381 County Ritchie/Clay  
 Company Gene Stalnaker, Inc. Farm C. E. & Mary Giebell  
 Inspector SAMUEL N. HERSMAN Well No. B-90-1  
 Date September 2, 1983

RULE	DESCRIPTION	IN COMPLIANCE	
		Yes	No
23.06	Notification Prior to starting Work	<input checked="" type="checkbox"/>	<input type="checkbox"/>
25.04	Prepared before Drilling to prevent waste	<input type="checkbox"/>	<input type="checkbox"/>
25.03	High-Pressure Drilling	<input checked="" type="checkbox"/>	<input type="checkbox"/>
16.01	Required Permits at wellsite	<input checked="" type="checkbox"/>	<input type="checkbox"/>
15.03	Adequate Fresh Water Casing	<input checked="" type="checkbox"/>	<input type="checkbox"/>
15.02	Adequate Coal Casing	<input checked="" type="checkbox"/>	<input type="checkbox"/>
15.01	Adequate Production Casing	<input type="checkbox"/>	<input type="checkbox"/>
15.04	Adequate Cement Strength	<input type="checkbox"/>	<input type="checkbox"/>
23.02	Maintained Access Roads	<input checked="" type="checkbox"/>	<input type="checkbox"/>
25.01	Necessary Equipment to prevent Waste	<input type="checkbox"/>	<input type="checkbox"/>
23.03	Reclaimed Drilling Site	<input checked="" type="checkbox"/>	<input type="checkbox"/>
23.04	Reclaimed Drilling Pits	<input checked="" type="checkbox"/>	<input type="checkbox"/>
23.05	No surface or underground Pollution	<input type="checkbox"/>	<input type="checkbox"/>
7.03	Identification Markings	<input checked="" type="checkbox"/>	<input type="checkbox"/>

COMMENTS: \_\_\_\_\_  
 \_\_\_\_\_  
 \_\_\_\_\_  
 \_\_\_\_\_  
 \_\_\_\_\_

I have inspected the above well and (HAVE/HAVE NOT) found it to be in compliance with all of the rules and regulations of the Office of Oil and Gas Department of Mines of the State of West Virginia.

DATE - 7-25-85

SIGNED: Samuel N. Hersman

08/18/2023



STATE OF WEST VIRGINIA  
 DEPARTMENT OF ENERGY  
 DIVISION OF OIL AND GAS  
 1615 Washington Street, East  
 Charleston, West Virginia 25311  
 Telephone: 348-3500

August 12, 1985

ARCH A. MOORE, JR.  
 Governor

Gene Stalnaker, Inc.  
 P. O. Box 178  
 Glenville, West Virginia 26951

In Re: Permit No: 47-087-6381  
 Farm: C. E. & Mary Giebell  
 Well No: B-90-1  
 District: Clay  
 County: Ritchie  
 Issued: 4-13-83

Gentlemen:

The FINAL INSPECTION REPORT for the above captioned well has been received in this office. Only the column checked below applies:

The well designated by the above captioned permit number has been released ~~XXXXX~~ under your Blanket Bond.

Please return the enclosed cancelled single bond which covered the well designated by the above permit number to the surety company who executed said bond in your behalf, in order that they may give you credit on their records.

Your well record was received and reclamation requirements approved. In accordance with Chapter 22B, Article 1, Section 26, the above captioned well will remain under bond coverage for life of the well.

PERMIT CANCELLED - NEVER DRILLED

Very truly yours,

Theodore M. Streit

TMS/ nw

08/18/2023



c1

**APPLICATION FOR DETERMINATION OF THE MAXIMUM LAWFUL  
PRICE UNDER THE NATURAL GAS POLICY ACT (NGPA)**

1.0 API well number: (If not assigned, leave blank. 14 digits.)	47 - 085 - 6381															
2.0 Type of determination being sought: (Use the codes found on the front of this form.)	103 Section of NGPA      Category Code															
3.0 Depth of the deepest completion location: (Only needed if sections 103 or 107 in 2.0 above.)	4948 feet															
4.0 Name, address and code number of applicant: (35 letters per line maximum. If code number not available, leave blank.)	<p style="text-align: right;">OIL &amp; GAS DIVISION <del>DEPT. OF MINES</del> Seller Code</p> <p>Gene Stalnaker, Inc. Name P.O. Box 178 Street Glenville, WV 26351 City      State      Zip Code</p>															
5.0 Location of this well: [Complete (a) or (b).] (a) For onshore wells (35 letters maximum for field name.) (b) For OCS wells:	<p>N/A</p> <p>Field Name Ritchie      WV County      State</p> <p>Area Name      Block Number</p> <p style="text-align: center;">Date of Lease:           Mo.   Day   Yr.      OCS Lease Number</p>															
(c) Name and identification number of this well: (35 letters and digits maximum.)	Giebell B-90-1															
(d) If code 4 or 5 in 2.0 above, name of the reservoir: (35 letters maximum.)	_____															
6.0 (a) Name and code number of the purchaser: (35 letters and digits maximum. If code number not available, leave blank.) (b) Date of the contract:	<p>Pennsboro Glass Factory Name      Buyer Code</p> <p style="text-align: center;">          Mo.   Day   Yr.</p>															
(c) Estimated total annual production from the well:	12 Million Cubic Feet															
	<table border="1" style="width: 100%; border-collapse: collapse;"> <thead> <tr> <th style="width: 30%;"></th> <th style="width: 15%;">(a) Base Price</th> <th style="width: 15%;">(b) Tax</th> <th style="width: 15%;">(c) All Other Prices [Indicate (+) or (-).]</th> <th style="width: 25%;">(d) Total of (a), (b) and (c)</th> </tr> </thead> <tbody> <tr> <td>7.0 Contract price: (As of filing date. Complete to 3 decimal places.)</td> <td style="text-align: center;">S/MMBTU      _____</td> <td style="text-align: center;">_____</td> <td style="text-align: center;">_____</td> <td style="text-align: center;">_____</td> </tr> <tr> <td>8.0 Maximum lawful rate: (As of filing date. Complete to 3 decimal places.)</td> <td style="text-align: center;">S/MMBTU      _____</td> <td style="text-align: center;">_____</td> <td style="text-align: center;">_____</td> <td style="text-align: center;">_____</td> </tr> </tbody> </table>		(a) Base Price	(b) Tax	(c) All Other Prices [Indicate (+) or (-).]	(d) Total of (a), (b) and (c)	7.0 Contract price: (As of filing date. Complete to 3 decimal places.)	S/MMBTU      _____	_____	_____	_____	8.0 Maximum lawful rate: (As of filing date. Complete to 3 decimal places.)	S/MMBTU      _____	_____	_____	_____
	(a) Base Price	(b) Tax	(c) All Other Prices [Indicate (+) or (-).]	(d) Total of (a), (b) and (c)												
7.0 Contract price: (As of filing date. Complete to 3 decimal places.)	S/MMBTU      _____	_____	_____	_____												
8.0 Maximum lawful rate: (As of filing date. Complete to 3 decimal places.)	S/MMBTU      _____	_____	_____	_____												
9.0 Person responsible for this application:	<p>Gene Stalnaker      President Name      Title</p> <p><i>Gene Stalnaker</i> Signature      (304) 462-5701 Date Application is Completed      Phone Number</p>															

FERC-121 (8-82)

08/18/2023

PARTICIPANTS:

DATE: FEB 10 1984

BUYER-SELLER CODE

WELL OPERATOR: Gene Stalaker, Inc.

FIRST PURCHASER: Pennsboro Glass Factory

OTHER: \_\_\_\_\_

W. Va. Department of Mines, Oil & Gas Division  
 WELL DETERMINATION FILE NUMBER  
83 1117 - 103-095 - 6381  
 Use Above File Number on all Communications  
 Relating to Determination of this Well

*1500' Radius  
 Qualifies  
 [Signature]*

**APPROVED**

MAR 22 1984

CHECK EACH ITEM AS COMPLETE OR NOTE WHAT IS MISSING

ITEM NO.

- 1. FERC -121  Items not completed - Line No. \_\_\_\_\_
- 2. IV-1 Agent Gene Stalaker
- 3. IV-2 Well Permit
- 4. IV-6 Well Plat
- 5. IV-35 Well Record  Drilling  Deepening
- 6. IV-36 Gas-Oil Test: Gas Only  Was Oil Produced?  Ratio
- 7. IV-39 Annual Production \_\_\_\_\_ years
- 8. IV-40 90 day Production \_\_\_\_\_ Days off line: \_\_\_\_\_
- 9. IV-48 Application for certification. Complete?
- 10-17. IV Form 51 - 52 - 53 - (54) - 55 - 56 - 57 - 58 Complete?  Affidavit Signed
- 18-28. Other: Survey \_\_\_\_\_ Logs \_\_\_\_\_ Geological Charts \_\_\_\_\_  
 Structure Map \_\_\_\_\_ 1: 4000 Map \_\_\_\_\_ Well Tabulations \_\_\_\_\_  
 Gas Analyses \_\_\_\_\_
- (5) Date commenced: 8-1-83 Date completed 8-5-83 Deepened
- (5) Production Depth: 3516 - 4948
- (5) Production Formation: Devonian Shale
- (5) Final Open Flow: 685 MMCF
- (5) After Frac. R. P. 1330# 24hrs.
- (6) Other Gas Test: \_\_\_\_\_
- (7) Avg. Daily Gas from Annual Production: \_\_\_\_\_
- (8) Avg. Daily Gas from 90-day ending w/1-120 days \_\_\_\_\_
- (8) Line Pressure: \_\_\_\_\_ PSIG from Daily Report \_\_\_\_\_
- (5) Oil Production: \_\_\_\_\_ From Completion Report \_\_\_\_\_
- 10-17. Does lease inventory indicate enhanced recovery being done NO
- 10-17. Is affidavit signed?  Notarized?
- Does official well record with the Department confirm the submitted information? yes
- Additional information \_\_\_\_\_ Does computer program confirm? \_\_\_\_\_
- Was Determination Objected to \_\_\_\_\_ By Whom? \_\_\_\_\_

08/18/2023

STATE OF WEST VIRGINIA  
DEPARTMENT OF MINES, OIL AND GAS DIVISION

Date 11/15 1983

Operator's Well No. Giebell B-90-1

API Well No. 47 - 085 - 6381  
State County Permit

WELL CLASSIFICATION FORM  
NEW ONSHORE PRODUCTION WELL  
MGA Section 103

DESIGNATED AGENT Gene Stalnaker  
ADDRESS P.O. Box 178  
Glenville, WV 26351

WELL OPERATOR Gene Stalnaker, Inc.  
ADDRESS P.O. Box 178  
Glenville, WV 26351

LOCATION: Elevation 1108  
Watershed Horner Run  
Dist. Clay County Ritchie Quad. Pennsboro 7.5

GAS PURCHASER Pennsboro Glass Factory  
ADDRESS Pennsboro, WV

Gas Purchase Contract No. \_\_\_\_\_  
Meter Chart Code \_\_\_\_\_  
Date of Contract \_\_\_\_\_

\* \* \* \* \*

Date surface drilling was begun: 8/02/83

Indicate the bottom hole pressure of the well and explain how this was calculated:

Pf = 1330 e (.00003378 x .70 x 4232 x .78)

Pf = 1330 e (.0780)

Pf = 1330 (1.081)

EXPLANATION ATTACHED

Pf = 1438 #

AFFIDAVIT

I, Gene Stalnaker, having been first sworn according to law state that surface drilling of the well for which this determination is sought was begun on or after February 19, 1977; the well satisfies applicable state or federal well spacing requirements and the well is not within a proration unit, in existence at the time surface drilling began, which was applicable to the reservoir from which gas is or will be produced and which applied to any other well producing gas in commercial quantities or on which surface drilling began on or after February 19, 1977, and which was capable of producing gas in commercial quantities. I state, further, that I have concluded, to the best of my information, knowledge and belief, that the well for which this determination is sought is a new onshore production well and that I am not aware of any information not described in the application which is inconsistent with this conclusion.

Gene Stalnaker

STATE OF WEST VIRGINIA,

COUNTY OF Gilmer, TO WIT:

I, STEVEN B. DUFFIELD a Notary Public in and for the state and county aforesaid,

do certify that GENE STALNAKER whose name is signed to the writing above, bearing date

the 15th day of November, 1983, has acknowledged the same before me, in my county aforesaid.

Given under my hand and official seal this 15th day of November, 1983

My term of office expires on the 6th day of August, 1992.

[NOTARIAL SEAL]

Steven B. Duffield  
Notary Public

08/18/2023

STATE OF WEST VIRGINIA  
DEPARTMENT OF MINES, OIL AND GAS DIVISION

Date 11/15 1983  
Operator's Well No. Giebell B-90-1  
API Well No. 47 - 085 - 6381  
State            County            Permit             
Previous File No.            (If Applicable)

STATE APPLICATION FOR WELL CLASSIFICATION

WELL OPERATOR Gene Stalnaker, Inc.  
ADDRESS P.O. Box 178  
Glenville, WV 26351

DESIGNATED AGENT Gene Stalnaker  
ADDRESS P.O. Box 178  
Glenville, WV 26351

Gas Purchase Contract No.            and Date             
(Month, day and year)

Meter Chart Code           

Name of First Purchaser Pennsboro Glass Factory  
Pennsboro, WV  
(Street or P. O. Box)  
(City)            (State)            (Zip Code)           

FERC Seller Code            FERC Buyer Code           

TYPE OF DETERMINATION BEING SOUGHT:

- (1) Initial determination (See FERC Form 121.) 103 Section of NGPA            Category Code
- (2) Determination that increased production is the result of enhanced recovery technology.
- (3) Determination of a seasonally affected well.

Gene Stalnaker President  
Name (Print)            Title             
Gene Stalnaker  
Signature             
P.O. Box 178  
Street or P. O. Box             
Glenville, WV 26351  
City            State            (Zip Code)             
(304) 462-5701  
Area Code            Phone Number             
Code           

(Certificate of Proof of Service to Purchaser)

(All of the above to be completed by the Operator/Applicant)

(To be completed by Jurisdictional Agency. Executed copy to be returned to Operator/Applicant and purchaser, if known).

The Department of Mines has received a request  for certification of the above described well as meeting the requirements of Section            under the Natural Gas Policy Act of 1978 (NGPA);  or for determination that increased production is the result of enhanced recovery technology under Section 108 of (NGPA);  or for determination of a seasonally affected well under Section 108 of (NGPA).

All interested parties are hereby notified that on the            day of           , 1983, at the office of the Oil and Gas Division in Charleston, West Virginia, or as soon thereafter as it may be heard, there will be a public hearing, if requested, or if objection is filed.

This Application is assigned File No.           

Initial review of information submitted indicates the well  is,  is not entitled to certification as claimed under the Natural Gas Policy Act (NGPA). A review of this evidence and any additional evidence will be made at the time appointed for a public hearing or as soon thereafter as the matter may be heard.

Unless objections are timely filed or a request for a hearing is made within fifteen (15) days, a hearing will not be held except on ex parte motion of the department and the matter will go to determination.

WEST VIRGINIA DEPARTMENT OF MINES

NOV 17 1983

By            08/18/2023  
Title           

Received by             
Jurisdictional Agency

# CALCULATION OF BOTTOM HOLE PRESSURE

$$P_f = P_w e^{(XGLS)}$$

Where:

$P_f$  = shut-in formation pressure (psia)

$P_w$  = pressure at the wellhead (psia)

$e$  = napierian logarithm base (2.71828)

$G$  = specific gravity of gas .70

$L$  = length of casing to mid-point of the perforations (feet)

$S$  = supercompressibility of gas at the mean temperature and pressure  
(average of wellhead and bottom hole temperature and pressure) .78

$X = \frac{1}{53.34 T}$  where  $T$  = average wellhead and bottom hole temperature ( $^{\circ}R$ ) 95 +  $^{\circ}R$

