



1) Date: June 1, 19 83  
 2) Operator's Well No. E-951  
 3) API Well No. 47 085 6628  
 State 47 County 085 Permit 6628

DRILLING CONTRACTOR:

STATE OF WEST VIRGINIA  
DEPARTMENT OF MINES, OIL AND GAS DIVISION

OIL AND GAS WELL PERMIT APPLICATION

- 4) WELL TYPE: A Oil  / Gas   
 B (If "Gas", Production  / Underground storage  / Deep  / Shallow )
- 5) LOCATION: Elevation: 1030' Watershed: North Fork of Hughes River  
 District: Grant County: Ritchie Quadrangle: Harrisville
- 6) WELL OPERATOR Ensource Inc. 11) DESIGNATED AGENT Mike Nugen  
 Address P. O. Drawer 1738 Address P. O. Drawer 1738  
Clarksburg, WV 26301 Clarksburg, WV 26301
- 7) OIL & GAS ROYALTY OWNER Mildred Stanley Heirs 12) COAL OPERATOR Not Operated  
 Address RFD 1 Address \_\_\_\_\_  
Harrisville, WV 26362
- 8) SURFACE OWNER Same as above 13) COAL OWNER(S) WITH DECLARATION ON RECORD:  
 Name Mildred Stanley Heirs Address Same as above  
 Address \_\_\_\_\_  
 Acreage \_\_\_\_\_ Name \_\_\_\_\_  
 Address \_\_\_\_\_
- 9) FIELD SALE (IF MADE) TO: Consolidated Gas  
 Address 445 West Main St.  
Clarksburg, WV 26301
- 10) OIL & GAS INSPECTOR TO BE NOTIFIED  
 Name Deo Mace Address \_\_\_\_\_  
Route 1 - Box 65  
Sandridge, WV 25274
- 15) PROPOSED WORK: Drill  / Drill deeper \_\_\_\_\_ / Redrill \_\_\_\_\_ / Fracture or stimulate \_\_\_\_\_  
 Plug off old formation \_\_\_\_\_ / Perforate new formation \_\_\_\_\_  
 Other physical change in well (specify) \_\_\_\_\_
- 16) GEOLOGICAL TARGET FORMATION, Devonian Shale
- 17) Estimated depth of completed well, 5000 feet
- 18) Approximate water strata depths: Fresh, 50 feet; salt, 1030 feet.
- 19) Approximate coal seam depths: N/A Is coal being mined in the area? Yes \_\_\_\_\_ No

RECEIVED  
JUN - 8 1983  
OIL & GAS DIVISION  
DEPT. OF MINES

20) CASING AND TUBING PROGRAM

| CASING OR TUBING TYPE | SPECIFICATIONS |       |                |     |      | FOOTAGE INTERVALS |              | CEMENT FILL-UP OR SACKS (Cubic feet) | PACKERS                                                 |
|-----------------------|----------------|-------|----------------|-----|------|-------------------|--------------|--------------------------------------|---------------------------------------------------------|
|                       | Size           | Grade | Weight per ft. | New | Used | For drilling      | Left in well |                                      |                                                         |
| Conductor             | 11 3/4         | H40   | 42#            | X   |      | 60                | 60           | 30 sks                               | Kinds                                                   |
| Fresh water           |                |       |                |     |      |                   |              |                                      |                                                         |
| Coal                  |                |       |                |     |      |                   |              |                                      |                                                         |
| Intermediate          | 8 5/8          | H40   | 28#            | X   |      | 1300              | 1300         | 195 sks                              | Sizes                                                   |
| Production            | 4 1/2          | J55   | 10.5#          | X   |      | 5000              | 5000         | 450 sks                              | by Rule 15-05<br>Depths set 012 23 004<br>by Rule 15-01 |
| Tubing                |                |       |                |     |      |                   |              |                                      | Perforations:                                           |
| Liners                |                |       |                |     |      |                   |              |                                      | Top Bottom                                              |

- 21) EXTRACTION RIGHTS  
 Check and provide one of the following:  
 Included is the lease or leases or other continuing contract or contracts by which I hold the right to extract oil or gas.  
 The requirement of Code 22-4-1-(c) (1) through (4). (See reverse side for specifics.)
- 22) ROYALTY PROVISIONS  
 Is the right to extract, produce or market the oil or gas based upon a lease or other continuing contract or contracts providing for flat well royalty or any similar provision for compensation to the owner of the oil or gas in place which is not inherently related to the volume of oil or gas so extracted, produced or marketed? Yes  No

If the answer above is No, nothing additional is needed. If the answer is Yes, you may use Affidavit Form IV-60.

23) Required Copies (See reverse side.)

24) Copies of this Permit Application and the enclosed plat and reclamation plan have been mailed by registered mail or delivered by hand to the above named coal operator, coal owner(s), and coal lessee on or before the day of the mailing or delivery of this Permit Application to the Department of Mines at Charleston, West Virginia.

Notary: Wayne S. Carden  
 My Commission Expires March 23, 1993

Signed: Michael W. Nugen  
 Its: District Manager

OFFICE USE ONLY  
**DRILLING PERMIT**  
 Permit number 47-085-6628 Date July 25 1983  
04/26/2024

This permit covering the well operator and well location shown below is evidence of permission granted to drill in accordance with the pertinent legal requirements subject to the conditions contained herein and on the reverse hereof. **Notification must be given to the District Oil and Gas Inspector. (Refer to No. 10) Prior to the construction of roads, locations and pits for any permitted work.** In addition, the well operator or his contractor shall notify the proper district oil and gas inspector 24 hours before actual permitted work has commenced.)  
 Permit expires March 25, 1984

unless drilling is commenced prior to that date and prosecuted with due diligence.

|                |                  |                 |                   |                   |
|----------------|------------------|-----------------|-------------------|-------------------|
| Bond: <u>B</u> | Agent: <u>ls</u> | Plat: <u>EP</u> | Casing: <u>EP</u> | Fee: <u>77122</u> |
|----------------|------------------|-----------------|-------------------|-------------------|

Michael Lewis  
 Administrator, Office of Oil and Gas

NOTE: Keep one copy of this permit posted at the drilling location.

Line Item Explanation

- 1) Date of Application
- 2) Your well name and number
- 3) To be filled out by office of oil & gas
- 4A) "Oil" means natural crude oil or petroleum and other hydrocarbons, regardless of gravity, which are produced at the well in liquid form by ordinary production methods and which are not the result of condensation of gas after it leaves underground reservoirs: "Gas" means all natural gas and all other fluid hydrocarbons not defined as oil.
- 4B) "Shallow well" means any well drilled and completed in a formation above the top of the uppermost member of the "Onondaga Group" or a depth less than six thousand feet, whichever is shallower.  
"Deep well" means any well drilled and completed in a formation at or below the top of the uppermost member of the "Onondaga Group" or at a depth less than six thousand feet, whatever is shallower.
- 5) Where well is located
- 6) Before a permit can be issued in a corporation, company partnership, or fictitious name, the name must be registered with the Secretary of State Office
- 7) Use separate sheet if necessary
- 8) Present surface owner at time application is filed.
- 9) Optional
- 11) See Reg. 7.01 relating to code §22-4-1k
- 12) "Coal Operator" means any persons, firm, partnership, partnership association or corporation that proposes to or does operate a coal mine. See Note 24
- 13 & 14) As per §22-4-20; See Note 24
- 15) Work that will be attempted—A separate Form IV-2 shall not be required for fracturing or stimulating a well where fracturing or stimulating is to be part of the work for which a permit is sought and is noted as such on the Form IV-2 filed in connection therewith.
- 16) Anticipated formation for which well will be completed
- 17) Self explanatory
- 18) Depth to deepest freshwater, and shallowest salt water, taken from nearby wells corrected for differences in elevation
- 19) All coal seam depths
- 20) Proposed casing program and cementing refer to Code 22-4-5, 22-4-6, 22-4-7, 22-4-8, 22-4-8a Reg 9.01, 15.01, 15.02, 15.03, 15.04, 25.01, 25.02, 25.03, 25.04
- 21) Code 22-4-11(c) - In lieu of filing the lease or leases or other continuing contract or contracts, the applicant for a permit described herein may file the following:
  - (1) A brief description of the tract of land including the district and county wherein the tract is located;
  - (2) The identification of all parties to all leases or other continuing contractual agreements by which the right to extract, produce or market the oil or gas is claimed;
  - (3) The book and page number wherein each such lease or contract by which the right to extract, produce or market the oil or gas is recorded;
  - (4) A brief description of the royalty provisions of each such lease or contract.
- 22) Code 22-4-11(d) and 22-4-11(e).
- 23) Regulation 7.02 of the Department of Mines provides that the original and four copies of Form IV-2 must be filed with the Department, accompanied by (i) a plat in the form prescribed by Regulation 11, (ii) a bond in one of the forms prescribed by Regulation 12, or in lieu thereof the other security allowed by Code §22-4-2, (iii) Form IV-9, "Reclamation Plan", applicable to the reclamation required by Code §22-4-12b and Regulation 23, (iv) unless previously paid on the same well, the fee required by Code §22-4-12a, and (v) if applicable, the consent required by Code §22-4-8a from the owner of any water well or dwelling within 200 feet of the proposed well.
- 24) **The above named coal operator, coal owner(s), and coal lessee are hereby notified that any objection they wish to make or are required to make by Code §22-4-3 must be filed with the Department of Mines within fifteen (15) days after the receipt of this Application by the Department.**

The following waiver must be completed by the coal operator and by any coal owner or coal lessee who has recorded a declaration under Code 22-4-20, if the permit is to be issued within fifteen (15) days of receipt thereof.

WAIVER

The undersigned coal operator \_\_\_\_\_ / owner \_\_\_\_\_ / lessee \_\_\_\_\_ / of the coal under to be drilled on \_\_\_\_\_ 04/26/2024 has examined this proposed well location. If a mine map exists which covers the area of the well location, the well location has been added to the mine map. The undersigned has no objection to the work proposed to be done at this location, provided, the well operator has complied with all applicable requirements of the West Virginia Code and the governing regulations.

Date: \_\_\_\_\_, 19\_\_\_\_

By \_\_\_\_\_

Its \_\_\_\_\_



1) Date: June 1, 19 83  
 2) Operator's Well No. E-951 2  
 3) API Well No. 47 085 6628  
 State County Permit

DRILLING CONTRACTOR:

STATE OF WEST VIRGINIA  
DEPARTMENT OF MINES, OIL AND GAS DIVISION

OIL AND GAS WELL PERMIT APPLICATION

- 4) WELL TYPE: A Oil  Gas   
 B (If "Gas", Production  Underground storage  Deep  Shallow )
- 5) LOCATION: Elevation: 1030' Watershed: North Fork of Hughes River  
 District: Grant County: Ritchie Quadrangle: Harrisville
- 6) WELL OPERATOR Ensource Inc. 11) DESIGNATED AGENT Mike Nugen  
 Address P. O. Drawer 1738 Address P. O. Drawer 1738  
Clarksburg, WV 26301 Clarksburg, WV 26301
- 7) OIL & GAS ROYALTY OWNER Mildred Stanley Heirs Correction: Russell Richards 12) COAL OPERATOR Not Operated  
 Address RFD 1 Address \_\_\_\_\_  
Harrisville, WV 26362
- 8) SURFACE OWNER Same as above 13) COAL OWNER(S) WITH DECLARATION ON RECORD:  
 Name Mildred Stanley Heirs Russell Richards  
 Address Same as above
- 9) FIELD SALE (IF MADE) TO: Consolidated Gas  
 Address 445 West Main St.  
Clarksburg, WV 26301
- 10) OIL & GAS INSPECTOR TO BE NOTIFIED  
 Name Deo Mace  
 Address Route 1 - Box 65  
Sandridge, WV 25274
- 14) COAL LESSEE WITH DECLARATION ON RECORD:  
 Name Not - Leased  
 Address \_\_\_\_\_
- 15) PROPOSED WORK: Drill  / Drill deeper  / Redrill  / Fracture or stimulate  OIL & GAS DIVISION  
 Plug off old formation  / Perforate new formation  DEPT. OF MINES  
 Other physical change in well (specify) \_\_\_\_\_
- 16) GEOLOGICAL TARGET FORMATION, Devonian Shale
- 17) Estimated depth of completed well, 5000 feet
- 18) Approximate water strata depths: Fresh, 50 feet; salt, 1030 feet.
- 19) Approximate coal seam depths: N/A Is coal being mined in the area? Yes  / No

20) CASING AND TUBING PROGRAM

| CASING OR TUBING TYPE | SPECIFICATIONS |       |                |     |      | FOOTAGE INTERVALS |              | CEMENT FILL-UP OR SACKS (Cubic feet) | PACKERS       |
|-----------------------|----------------|-------|----------------|-----|------|-------------------|--------------|--------------------------------------|---------------|
|                       | Size           | Grade | Weight per ft. | New | Used | For drilling      | Left in well |                                      |               |
| Conductor             | 11 3/4         | H40   | 42#            | X   |      | 60                | 60           | 30 sks                               | Kinds         |
| Fresh water           |                |       |                |     |      |                   |              |                                      |               |
| Coal                  |                |       |                |     |      |                   |              |                                      | Sizes         |
| Intermediate          | 8 5/8          | H40   | 28#            | X   |      | 1300              | 1300         | 195 sks                              | Depths set    |
| Production            | 4 1/2          | J55   | 10.5#          | X   |      | 5000              | 5000         | 450 sks                              | Perforations: |
| Tubing                |                |       |                |     |      |                   |              |                                      | Top Bottom    |
| Liners                |                |       |                |     |      |                   |              |                                      |               |

- 21) EXTRACTION RIGHTS  
 Check and provide one of the following:  
 Included is the lease or leases or other continuing contract or contracts by which I hold the right to extract oil or gas.  
 The requirement of Code 22-4-1-(c) (1) through (4). (See reverse side for specifics.)
- 22) ROYALTY PROVISIONS  
 Is the right to extract, produce or market the oil or gas based upon a lease or other continuing contract or contracts providing for flat well royalty or any similar provision for compensation to the owner of the oil or gas in place which is not inherently related to the volume of oil or gas so extracted, produced or marketed? Yes  No   
 If the answer above is No, nothing additional is needed. If the answer is Yes, you may use Affidavit Form IV-60.
- 23) Required Copies (See reverse side.)
- 24) Copies of this Permit Application and the enclosed plat and reclamation plan have been mailed by registered mail or delivered by hand to the above named coal operator, coal owner(s), and coal lessee on or before the day of the mailing or delivery of this Permit Application to the Department of Mines at Charleston, West Virginia.
- Notary: Wayne S. Carden  
 My Commission Expires March 23, 1993
- Signed: Michael W. Nugen  
 Its: District Manager

OFFICE USE ONLY  
DRILLING PERMIT

04/26/2024

This permit covering the well operator and well location shown below is evidence of permission granted to drill in accordance with the pertinent legal requirements subject to the conditions contained herein and on the reverse hereof. Notification must be given to the District Oil and Gas Inspector. (Refer to No. 10) Prior to the construction of roads, locations and pits for any permitted work. In addition, the well operator or his contractor shall notify the proper district oil and gas inspector 24 hours before actual permitted work has commenced.)

Permit expires \_\_\_\_\_ unless drilling is commenced prior to that date and prosecuted with due diligence.

|       |        |       |        |     |
|-------|--------|-------|--------|-----|
| Bond: | Agent: | Plat: | Casing | Fee |
|-------|--------|-------|--------|-----|

Administrator, Office of Oil and Gas

NOTE: Keep one copy of this permit posted at the drilling location.



State of West Virginia  
Department of Mines  
Oil and Gas Division

DATE JUNE 2, 1983  
WELL NO. MILDRED STANLEY #  
API NO. 47 - 085 -

Correction  
Russell Richards  
E-951

CONSTRUCTION AND RECLAMATION PLAN

COMPANY NAME EN SOURCE INC. DESIGNATED AGENT MIKE NUGEN  
Address P.O. DRAWER 1738 Address P.O. DRAWER 1738  
Telephone 624-9653 CLARKSBURG, WV 26301 Telephone 624-9653 CLARKSBURG, WV  
LANDOWNER MILDRED STANLEY SOIL CONS. DISTRICT LITTLE KANAWHA  
Revegetation to be carried out by RECLAMATION CONTRACTOR (Agent Russell Richards)

This plan has been reviewed by Little Kanawha SCD. All corrections and additions become a part of this plan: 6-11-83 (Date)

Jarrett Newton  
(SCD Agent)

ACCESS ROAD

LOCATION

Structure CULVERTS (A)  
Spacing MIN. SIZE 12" I.D.  
Page Ref. Manual I-8  
Structure DRAINAGE DITCH (B)  
Spacing \_\_\_\_\_  
Page Ref. Manual I-11  
Structure DITCH RELIEF CROSS-DRAW (C)  
Spacing SEE SKETCH  
Page Ref. Manual I-5

Structure DIVERSION DITCHES (D)  
Material EARTHEN  
Page Ref. Manual I-11  
Structure \_\_\_\_\_  
Material \_\_\_\_\_  
Page Ref. Manual JUN 1983  
Structure OIL & GAS  
Material DEPT. OF MINE  
Page Ref. Manual \_\_\_\_\_

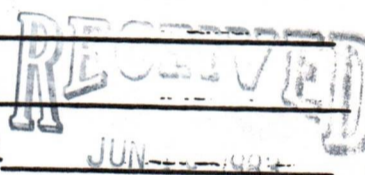

All structures should be inspected regularly and repaired if necessary. All commercial timber is to be cut and stacked and all brush and small timber to be cut and removed from the site before dirt work begins.

REVEGETATION

Treatment Area I & II

Treatment Area II

Lime 3 Tons/acre  
or correct to pH 6.5  
Fertilizer 500 lbs/acre  
(10-20-20 or equivalent)  
Mulch Hay or straw 2 Tons/acre  
Seed\* Ky 31 Fescue 30 lbs/acre  
Crown vetch 10 lbs/acre  
\_\_\_\_\_ lbs/acre

Lime \_\_\_\_\_ Tons/acre  
or correct to pH \_\_\_\_\_  
Fertilizer \_\_\_\_\_ lbs/acre  
(10-20-20 or equivalent)  
Mulch \_\_\_\_\_ Tons/acre  
Seed\* \_\_\_\_\_ lbs/acre  
\_\_\_\_\_ lbs/acre  
\_\_\_\_\_ lbs/acre

\*Inoculate all legumes such as vetch, trefoil and clovers with the proper bacterium. Inoculate with 3X recommended amount.

04/26/2024

PLAN PREPARED BY Mike Nugen PE & Burl G. Smith  
ADDRESS P.O. Drawer 1738  
Clarksburg WVa 26301  
PHONE NO. 304-624-9653

NOTES: Please request landowners' cooperation to protect new seedling for one growing season. Attach separate sheets as necessary for comments.

ATTACH OR PHOTOCOPIY SECTION OF  
INVOLVED TOPOGRAPHIC MAP.  
QUADRANGLE HARRISVILLE

**LEGEND**

Well Site 



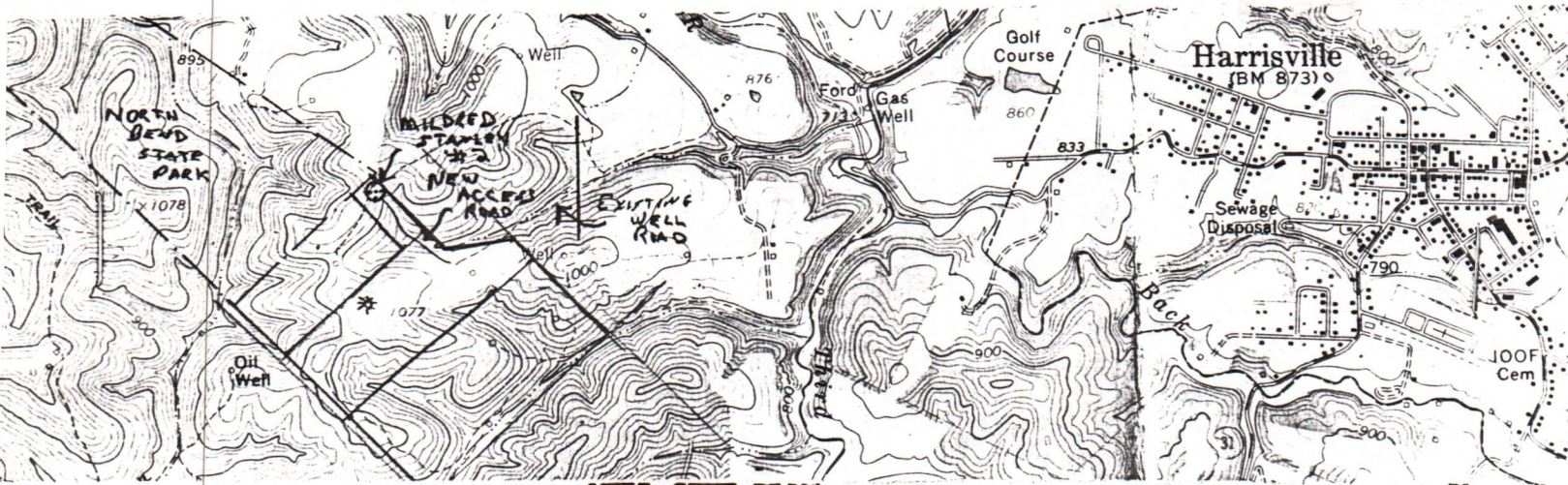









Access Road 



**WELL SITE PLAN**

Sketch to include well location, existing access road, roads to be constructed, well site, drilling pits and necessary structures numbered or lettered to correspond with the first part of this plan. Include all natural drainage.

**LEGEND**

|                                                                                                                                                                                                                                                                                                                                                                                                                                                                                                                                                                                                                                         |                                                                                                                                                                                                                                                                                                                                                                                                                                                                                                                                                                                                                                      |
|-----------------------------------------------------------------------------------------------------------------------------------------------------------------------------------------------------------------------------------------------------------------------------------------------------------------------------------------------------------------------------------------------------------------------------------------------------------------------------------------------------------------------------------------------------------------------------------------------------------------------------------------|--------------------------------------------------------------------------------------------------------------------------------------------------------------------------------------------------------------------------------------------------------------------------------------------------------------------------------------------------------------------------------------------------------------------------------------------------------------------------------------------------------------------------------------------------------------------------------------------------------------------------------------|
| <p>Property boundary </p> <p>Road </p> <p>Existing fence </p> <p>Planned fence </p> <p>Stream </p> <p>Open ditch </p> | <p>Diversion </p> <p>Spring </p> <p>Wet spot </p> <p>Building </p> <p>Drain pipe </p> <p>Waterway </p> |
|-----------------------------------------------------------------------------------------------------------------------------------------------------------------------------------------------------------------------------------------------------------------------------------------------------------------------------------------------------------------------------------------------------------------------------------------------------------------------------------------------------------------------------------------------------------------------------------------------------------------------------------------|--------------------------------------------------------------------------------------------------------------------------------------------------------------------------------------------------------------------------------------------------------------------------------------------------------------------------------------------------------------------------------------------------------------------------------------------------------------------------------------------------------------------------------------------------------------------------------------------------------------------------------------|

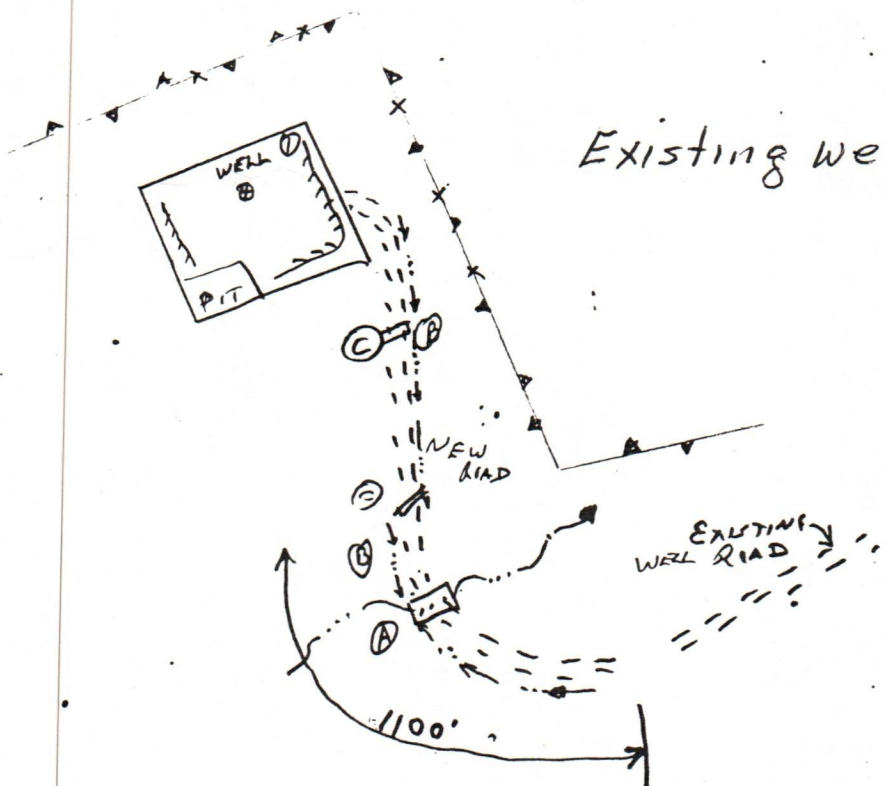

*Existing well road will be maintained*

04/26/2024

AGREEMENT, made and entered into the 25th day of January 19 78 by and between Russell E Richard and his wife Mary

1/2 Ogm

County of \_\_\_\_\_ and state of \_\_\_\_\_ part \_\_\_\_\_ of the first part.

hereinafter called Lessors, whether one or more, and Warren R Haight party of the second part, hereinafter called Lessee.

220 WITNESSETH, that the said Lessors for and in consideration of the sum of one Dollars to them in hand well and truly paid by said Lessee, the receipt of which is hereby acknowledged, and of the covenants and agreements hereinafter contained on the part of the said Lessee, to be paid, kept and performed, have granted, demised, leased and let and by these presents do grant, demise, lease and let with covenants of quiet possession, and that they have the sole right so to grant and demise, unto the said Lessee, its successors and assigns, for the purpose of mining and operating for oil and gas, and of building tanks, stations, power plants, water stations and structures thereon to take care of the said products, and of laying pipe lines on, over and across the leased premises and other lands of Lessors, for the purpose of conveying oil, gas, steam or water therein from and to wells and pipe lines on the premises and on adjoining and adjacent farms, and rights of way for road ways over this and other land of Lessors.

All that certain tract of land situate in Grant District Ritchie County and State of West Virginia on the waters of North Fork Hughes River

bounded as follows:

On the North by lands of A-Matheny & Bird Cokeley

On the East by lands of David McIntire

On the South by lands of George T Layfield

On the West by lands of E J Taylor

Containing Thirty Five (35) acres, more or less, being land purchased from \_\_\_\_\_ by deed dated \_\_\_\_\_ recorded Deed Book \_\_\_\_\_ page \_\_\_\_\_ reserving, however, therefrom all lands within two hundred feet of the resident buildings now on the premises on which no well shall be drilled by either party except by mutual consent. one (1) year

It is agreed that this lease shall remain in force for the term of 06 years from this date and as long thereafter as oil or gas, or either of them, is produced from the said lands by the said Lessee, its successors and assigns.

In Consideration of the Premises the said party of the second part, covenant and agrees: 1st—to deliver to the credit of the Lessors, their heirs or assigns, free of cost, in the pipe line to which Lessee may connect its wells, their equal share of 1/8th

and saved from the leased premises; and second, to pay the equal one-eighth (1/8) part of all oil produced their equal share of 1/8th

one-eighth (1/8) of the value at the well of the gas from each and every gas well drilled on said premises, the product from which is marketed and used off the premises, said gas to be measured at a meter set on the farm.

The Lessee shall not be required in any event to increase the rate of said gas well payments or said royalty of oil by reason of any royalty or interest in said oil or gas that may have been heretofore sold, reserved or conveyed by Lessors or their predecessor in title or otherwise. And any such outstanding royalty or interest shall first be deducted from the royalties and rentals above provided to be paid or delivered.

It is agreed by the parties hereto that the Lessee, its successors or assigns, shall have the right to use off the farm for such purposes as it may desire, "Casing Head Gas," (being gas produced from wells on the premises), but if said "casing head gas" or any part thereof should be manufactured into gasoline or other by-products by said company, said Lessors shall receive their equal share of 1/8 one-eighth of the net value at the factory of the gasoline and other by-products so manufactured.

Lessee may lay a line to any well producing gas only on said land or to second party's pipe line leading from said well to market, to take gas produced from said well for their own use for heat and light in one dwelling house on said land at Lessor's own risk, subject to the use, operation, pumping and right of abandonment of the well and pipe line by the Lessee; the first two hundred thousand cubic feet of gas so taken in each year shall be free, but all gas in excess of two hundred thousand cubic feet taken in each year shall be paid for by the Lessor at the current published local rates of the Lessee, and measurement and regulation shall be by meter and regulators set at the tap on the well or line. This privilege is upon condition that the Lessor shall use said gas with economy, in safe and proper pipes and appliances, and shall subscribe to and be bound by reasonable rules and regulations of the Lessee published at such time relating to such use of gas.

Lessee covenants and agrees to locate all wells so as to interfere as little as possible with the cultivated portion of the farm. And it is agreed that the leased premises may be fully and freely used by the Lessors for farming purposes, excepting such parts as are used by the Lessee in operating hereunder, and, further, that the said Lessee may drill or not drill on said land, as it may elect, and that the consideration and rentals paid and to be paid constitute adequate compensation for such privilege.

The said Lessee covenant and agrees to pay rental at the rate of one dollar per acre per year (\$-4.37 --) Dollars, quarterly in advance, beginning in date of final

acknowledgement hereon \_\_\_\_\_ months from this date, until, but not after, a well yielding royalty to the Lessors in drilled on the leased premises, and any rental paid for time beyond the date of completion of a gas well shall be credited upon the first royalty due upon the same and all rentals shall cease after the surrender of this lease as hereinafter provided for. All payments for delay, for gas produced and marketed, for gasoline and other by-products may be made direct to the lessors or be deposited to their credit, or to the credit of their heirs or assigns in the \_\_\_\_\_

Bank of \_\_\_\_\_ or by check mailed to Russell Richards at RFD 1 Harrisville 26362 P. O., \_\_\_\_\_ County State of West Virginia \_\_\_\_\_

; such payments may be also made in the same manner to \_\_\_\_\_ who is hereby appointed agent for the lessors to receive the same.

It is agreed that the Lessee is to have the privilege of using free, sufficient water and gas from the said premises to run all machinery necessary for drilling and operating thereon at any time to remove all machinery and fixtures placed on said premises; and further, upon the payment of one (\$1.00) Dollar at any time, by the party of the second part, or by its successors and assigns it or they shall have the right to surrender this lease for cancellation, after which all payments and liabilities thereafter to accrue under and by virtue of its terms shall cease and determine, and this lease becomes absolutely null and void.

Lessors agree that the recordation of a deed of surrender in the proper county, and the mailing in the postoffice of a check, payable as above provided, for said last mentioned sum and all amounts then due hereunder, shall be a full surrender and termination of this lease. All provisions of this lease shall be binding upon the heirs, executors, administrators, successors and assigns of the parties hereto. In Witness Whereof, the parties of this agreement have hereunto set their hands and seals the day and year first, above written.

Witness: \_\_\_\_\_ Russell E. Richard (Seal) Mary Richards (Seal) \_\_\_\_\_ (Seal) \_\_\_\_\_ (Seal) \_\_\_\_\_ (Seal) \_\_\_\_\_ (Seal)

04/26/2024

1/2 Ogm

County of \_\_\_\_\_ and state of \_\_\_\_\_ of \_\_\_\_\_ P. O. \_\_\_\_\_ part \_\_\_\_\_ of the first part.

hereinafter called Lessors, whether one or more, and Warren R Haught party of the second part, hereinafter called Lessee.

220 WITNESSETH, that the said Lessors for and in consideration of the sum of ONE Dollars to them in hand well and truly paid by said Lessee, the receipt of which is hereby acknowledged, and of the covenants and agreements hereinafter contained on the part of the said Lessee, to be paid, kept and performed, have granted, demised, leased and let and by these presents do grant, demise, lease and let with covenants of quiet possession, and that they have the sole right so to grant and demise, unto the said Lessee, its successors and assigns, for the purpose of mining and operating for oil and gas, and of building tanks, stations, power plants, water stations and structures thereon to take care of the said products, and of laying pipe lines on, over and across the leased premises and other lands of Lessors, for the purpose of conveying oil, gas, steam or water therein from and to wells and pipe lines on the premises and on adjoining and adjacent farms, and rights of way for road ways over this and other land of Lessors.

All that certain tract of land situate in Grant District Ritchie County and State of West Virginia on the waters of North Fork Hughes River

bounded as follows: On the North by lands of A Matheny & Bird Cokeley On the East by lands of David McIntire On the South by lands of George T Layfield On the West by lands of E J Taylor

Containing Thirty Five (35) acres, more or less, being land purchased from \_\_\_\_\_ by deed dated \_\_\_\_\_ recorded Deed Book \_\_\_\_\_ page \_\_\_\_\_ reserving, however, therefrom all lands within two hundred feet of the resident buildings now on the premises on which no well shall be drilled by either party except by mutual consent.

It is agreed that this lease shall remain in force for the term of one (1) years either of them, is produced from the said lands by the said Lessee, its successors and assigns.

In Consideration of the Premises the said party of the second part, covenants and agrees: 1st—to deliver to the credit of the Lessors, their heirs or assigns, free of cost, in the pipe line to which Lessee may connect its wells, their equal share of 1/8th the equal one-eighth (1/8) part of all oil produced and saved from the leased premises; and second, to pay their equal share of 1/8th

one-eighth (1/8) of the value at the well of the gas from each and every gas well drilled on said premises, the product from which is marketed and used off the premises, said gas to be measured at a meter set on the farm.

The Lessee shall not be required in any event to increase the rate of said gas well payments or said royalty of oil by reason of any royalty or interest in said oil or gas that may have been heretofore sold, reserved or conveyed by Lessors or their predecessor in title or otherwise. And any such outstanding royalty or interest shall first be deducted from the royalties and rentals above provided to be paid or delivered.

It is agreed by the parties hereto that the Lessee, its successors or assigns, shall have the right to use off the farm for such purposes as it may desire, "Casing Head Gas," (being gas produced from wells on the premises), but if said "casing head gas" or any part thereof should be manufactured into gasoline or other by-products by said company, said Lessors shall receive their equal share of 1/8th one-eighth of the net value at the factory of the gasoline and other by-products so manufactured.

Lessor may lay a line to any well producing gas only on said land or to second party's pipe line leading from said well to market, to take gas produced from said well for their own use for heat and light in one dwelling house on said land at Lessor's own risk, subject to the use, operation, pumping and right of abandonment of the well and pipe line by the Lessee; the first two hundred thousand cubic feet of gas so taken in each year shall be free, but all gas in excess of two hundred thousand cubic feet taken in each year shall be paid for by the Lessor at the current published local rates of the Lessee, and measurement and regulation shall be by meter and regulators set at the tap on the well or line. This privilege is upon condition that the Lessor shall use said gas with economy, in safe and proper pipes and appliances, and shall subscribe to and be bound by reasonable rules and regulations of the Lessee published at such time relating to such use of gas.

Lessee covenants and agrees to locate all wells so as to interfere as little as possible with the cultivated portion of the farm. And it is agreed that the leased premises may be fully and freely used by the Lessors for farming purposes, excepting such parts as are used by the Lessee in operating hereunder, and, further, that the said Lessee may drill or not drill on said land, as it may elect, and that the consideration and rentals paid and to be paid constitute adequate compensation for such privilege.

The said Lessee covenants and agrees to pay rental at the rate of Their proportional share of one dollar per acre per year (\$4.37) Dollars, quarterly in advance, beginning X date of final

acknowledgement hereon--- months from this date, until, but not after, a well yielding royalty to the Lessors in drilled on the leased premises, and any rental paid for time beyond the date of completion of a gas well shall be credited upon the first royalty due upon the same and all rentals shall cease after the surrender of this lease as hereinafter provided for. All payments for delay, for gas produced and marketed, for gasoline and other by-products may be made direct to the lessors or be deposited to their credit, or to the credit of their heirs or assigns in the \_\_\_\_\_

Bank of \_\_\_\_\_ or by check mailed to Mildred Stanley at RFD 1 Harrisville 26362 P. O., \_\_\_\_\_ County State of West Virginia; such payments may be also made in the same manner to \_\_\_\_\_ who is hereby appointed agent for the lessors to receive the same.

It is agreed that the Lessee is to have the privilege of using free, sufficient water and gas from the said premises to run all machinery necessary for drilling and operating thereon at any time to remove all machinery and fixtures placed on said premises; and further, upon the payment of one (\$1.00) Dollar at any time, by the party of the second part, or by its successors and assigns it or they shall have the right to surrender this lease for cancellation, after which all payments and liabilities thereafter to accrue under and by this lease shall cease and determine, and this lease becomes absolutely null and void.

Lessors agree that the recordation of a deed of surrender in the proper county, and the mailing in the postoffice of a check, payable as above provided, for said last mentioned sum and all amounts then due hereunder, shall be a full surrender and termination of this lease.

All provisions of this lease shall be binding upon the heirs, executors, administrators, successors and assigns of the parties hereto. In Witness Whereof, the parties of this agreement have hereunto set their hands and seals the day and year first, above written.

Witness: Mildred Stanley (Seal) Jettie Belle Stanley (Seal)

04/26/2024

ASSIGNMENT OF OIL AND GAS LEASE

WHEREAS, On the 25th day of January, 1978, certain oil and gas mining lease was entered into by and between Russell E. Richards and his wife Mary; Mildred Stanley & Jettie Belle Stanley, her daughter.

Lessor, and Warren R. Haught, covering the following described land in the County of Ritchie and State of West Virginia, to-wit: Two Leases bounded and described as follows:

- On the North by lands of: A. Matheny & Bird Cokeley
On the East by lands of: David McIntire
On the South by lands of: George T. Layfield
On the West by lands of: E. J. Taylor

RECEIVED JUN - 8 1983

OIL & GAS DIVISION DEPT. OF MINES

Said lease being recorded in the office of the County Clerk of said County, in Book 124, Page 522 of the Clerks Records of said County, and hereby referred to for all purposes.

NOW, THEREFORE, KNOW ALL MEN BY THESE PRESENTS: That the undersigned Warren R. Haught, for and in consideration of the sum of One Dollar, and other good and valuable considerations, cash in hand paid by HAUGHT, INC., the receipt of which is hereby acknowledged, do hereby grant, sell, transfer and assign unto the said HAUGHT, INC. the oil and mineral lease above mentioned, insofar as said lease covers:

and all personal property, machinery and equipment thereon, together with all leasehold and other rights, titles and interests in and to said land, created by virtue of the lease aforesaid.

TO HAVE AND TO HOLD unto the said HAUGHT, INC. its successors and assigns, forever, in accordance with the terms and provisions of said lease.

And for the same consideration the undersigned for Warren R. Haught and His heirs, successors and representatives do covenant with the said assignee, its successors and assigns, that said lease, hereby assigned, is now in full force and effect, with all rentals and royalties, payable under the same, duly paid; that the undersigned is the owner of said lease, rights thereunder and personal property thereon, with full right to convey the same, and that said lease, rights and property are now unencumbered; and to warrant and forever defend said lease, rights and property unto the said assignee, its successors and assigns, against all and every persons whomsoever lawfully claiming or to claim the same or any part thereof.

IN WITNESS WHEREOF, The undersigned owner and assignor has signed this instrument this 14th day of February, 1978

Warren R. Haught WRh

04/26/2024



No. \_\_\_\_\_

County \_\_\_\_\_

### Assignment of Oil and Gas Lease

From \_\_\_\_\_

To \_\_\_\_\_

Return to \_\_\_\_\_

Filed and admitted to record in the office  
of the Clerk of the County Commission of Ritchie  
County, W. Va. FEB 14 1978

at \_\_\_\_\_ 3:34 o'clock \_\_\_\_\_ P.M.

Recorded in \_\_\_\_\_

Book No. \_\_\_\_\_ Page \_\_\_\_\_

Notary Public \_\_\_\_\_

and in the capacity therein stated.  
Given under my hand and seal of office this \_\_\_\_\_ day of \_\_\_\_\_ 19\_\_\_\_

scribed to the foregoing instrument as \_\_\_\_\_ President of \_\_\_\_\_, for the purposes and consideration therein expressed a corporation, and acknowledged to me that he executed the same as the act and deed of said \_\_\_\_\_

Before me, the undersigned authority, on this day personally appeared \_\_\_\_\_, known to me to be the person whose name is sub-

COUNTY OF \_\_\_\_\_

STATE OF \_\_\_\_\_

Notary Public \_\_\_\_\_

Given under my hand and seal of office this \_\_\_\_\_ day of \_\_\_\_\_ 19\_\_\_\_

ally appeared \_\_\_\_\_ whose name \_\_\_\_\_ subscribed to the foregoing instrument, and acknowledged to me that \_\_\_\_\_ executed the same for the purposes and consideration therein expressed.

BEFORE ME, the undersigned authority in and for the State and County aforesaid, on this day person-

COUNTY OF \_\_\_\_\_

STATE OF \_\_\_\_\_

My comm. exp. Feb. 6, 1982

Notary Public Ritchie--W. Va. \_\_\_\_\_

Given under my hand and seal of office this 14th day of Feb. 19 78

ally appeared Warren R. Haught \_\_\_\_\_ the person whose name is subscribed to the foregoing instrument, and acknowledged to me that he executed the same for the purposes and consideration therein expressed.

BEFORE ME, the undersigned authority in and for the State and County aforesaid, on this day person-

COUNTY OF Ritchie

STATE OF West Virginia

04/26/2024

STATE OF WEST VIRGINIA  
DEPARTMENT OF MINES  
OIL AND GAS WELLS DIVISION

RECEIVED

JAN 12 1984

OIL & GAS DIVISION

INSPECTOR'S WELL REPORT DEPT. OF MINES

Permit No. 85-6628

Oil or Gas Well \_\_\_\_\_  
(KIND)

Company Ensource Inc.

Address \_\_\_\_\_

Farm Mildred Stanley

Well No. E-951

District Grant County Ritchie

Drilling commenced 1-5-83

Drilling completed \_\_\_\_\_ Total depth \_\_\_\_\_

Date shot \_\_\_\_\_ Depth of shot \_\_\_\_\_

Initial open flow \_\_\_\_\_ /10ths Water in \_\_\_\_\_ Inch

Open flow after tubing \_\_\_\_\_ /10ths Merc. in \_\_\_\_\_ Inch

Volume \_\_\_\_\_ Cu. Ft.

Rock pressure \_\_\_\_\_ lbs. \_\_\_\_\_ hrs.

Oil \_\_\_\_\_ bbls., 1st 24 hrs.

Fresh water None - Dusted hole. feet \_\_\_\_\_ feet

Salt water \_\_\_\_\_ feet \_\_\_\_\_ feet

| CASING AND TUBING | USED IN DRILLING | LEFT IN WELL | PACKERS              |
|-------------------|------------------|--------------|----------------------|
| Size              |                  |              |                      |
| 16                |                  |              | Kind of Packer _____ |
| 13                |                  |              |                      |
| 10                |                  |              | Size of _____        |
| 8 1/4             |                  |              |                      |
| 6 3/4             |                  |              | Depth set _____      |
| 5 3/16            |                  |              |                      |
| 3                 |                  |              | Perf. top _____      |
| 2                 |                  |              | Perf. bottom _____   |
| Liners Used       |                  |              | Perf. top _____      |
|                   |                  |              | Perf. bottom _____   |

CASING CEMENTED \_\_\_\_\_ SIZE \_\_\_\_\_ No. FT. \_\_\_\_\_ Date \_\_\_\_\_

NAME OF SERVICE COMPANY \_\_\_\_\_

COAL WAS ENCOUNTERED AT \_\_\_\_\_ FEET \_\_\_\_\_ INCHES

\_\_\_\_\_ FEET \_\_\_\_\_ INCHES \_\_\_\_\_ FEET \_\_\_\_\_ INCHES

\_\_\_\_\_ FEET \_\_\_\_\_ INCHES \_\_\_\_\_ FEET \_\_\_\_\_ INCHES

Drillers' Names Larry Hoover / Carl S. Johnston / William Deem / Richard Johnston

Remarks: Union Drilling Rig # 2 Total Packer Vernon Terry  
visit - 650 foot deep at time of visit - Perf OK

1-7-84  
DATE

Samuel M. Hermsmeider  
DISTRICT WELL INSPECTOR

04/26/2024

Form 26  
2/16/82

STATE OF WEST VIRGINIA  
DEPARTMENT OF MINES  
OIL AND GAS WELLS DIVISION

INSPECTOR'S PLUGGING REPORT

Permit No. \_\_\_\_\_

Well No. \_\_\_\_\_

COMPANY \_\_\_\_\_ ADDRESS \_\_\_\_\_

FARM \_\_\_\_\_ DISTRICT \_\_\_\_\_ COUNTY \_\_\_\_\_

Filling Material Used \_\_\_\_\_

| Liner                       |           |      | Location              | Amount | Packer            | Location |      |  |
|-----------------------------|-----------|------|-----------------------|--------|-------------------|----------|------|--|
| PLUGS USED AND DEPTH PLACED |           |      | BRIDGES               |        | CASING AND TUBING |          |      |  |
| CEMENT-THICKNESS            | WOOD-SIZE | LEAD | CONSTRUCTION-LOCATION |        | RECOVERED         | SIZE     | LOST |  |
|                             |           |      |                       |        |                   |          |      |  |
|                             |           |      |                       |        |                   |          |      |  |
|                             |           |      |                       |        |                   |          |      |  |
|                             |           |      |                       |        |                   |          |      |  |
|                             |           |      |                       |        |                   |          |      |  |
|                             |           |      |                       |        |                   |          |      |  |
|                             |           |      |                       |        |                   |          |      |  |
|                             |           |      |                       |        |                   |          |      |  |
|                             |           |      |                       |        |                   |          |      |  |
|                             |           |      |                       |        |                   |          |      |  |
|                             |           |      |                       |        |                   |          |      |  |

Drillers' Names \_\_\_\_\_

Remarks: \_\_\_\_\_

\_\_\_\_\_  
DATE I hereby certify I visited the above well on this date.

04/26/2024  
INSPECTOR

STATE OF WEST VIRGINIA  
DEPARTMENT OF MINES  
OIL AND GAS WELLS DIVISION

RECEIVED

JAN 13 1984

OIL & GAS DIVISION

DEPT. OF MINES

INSPECTOR'S WELL REPORT

Permit No. 85-6628

|                                                         |                                                           |                  |              |                      |
|---------------------------------------------------------|-----------------------------------------------------------|------------------|--------------|----------------------|
| Company <u>Ensorce Inc.</u>                             | CASING AND TUBING                                         | USED IN DRILLING | LEFT IN WELL | PACKERS              |
| Address _____                                           | Size                                                      |                  |              |                      |
| Farm <u>Mildred Stanley</u>                             | 16                                                        |                  |              | Kind of Packer _____ |
| Well No. <u>E-951</u>                                   | 13                                                        |                  |              |                      |
| District <u>Grant</u> County <u>Putnam</u>              | 10                                                        |                  |              | Size of _____        |
| Drilling commenced <u>1-5-84</u>                        | 8 3/4                                                     |                  |              |                      |
| Drilling completed _____ Total depth _____              | 6 3/4                                                     |                  |              | Depth set _____      |
| Date shot _____ Depth of shot _____                     | 5 3/16                                                    |                  |              |                      |
| Initial open flow _____ /10ths Water in _____ Inch      | 3                                                         |                  |              | Perf. top _____      |
| Open flow after tubing _____ /10ths Merc. in _____ Inch | 2                                                         |                  |              | Perf. bottom _____   |
| Volume _____ Cu. Ft.                                    | Liners Used _____                                         |                  |              | Perf. top _____      |
| Rock pressure _____ lbs. _____ hrs.                     |                                                           |                  |              | Perf. bottom _____   |
| Oil _____ bbls., 1st 24 hrs.                            | CASING CEMENTED _____ SIZE _____ No. FT. _____ Date _____ |                  |              |                      |
| Fresh water _____ feet _____ feet                       | NAME OF SERVICE COMPANY _____                             |                  |              |                      |
| Salt water _____ feet _____ feet                        | COAL WAS ENCOUNTERED AT _____ FEET _____ INCHES           |                  |              |                      |
|                                                         | _____ FEET _____ INCHES _____ FEET _____ INCHES           |                  |              |                      |
|                                                         | _____ FEET _____ INCHES _____ FEET _____ INCHES           |                  |              |                      |

Drillers' Names \_\_\_\_\_

Remarks: on 1-8-84 ran 1102 feet of 8 5/8" casing  
Halliburton ran 360 sacks cement - 26 joints total of casing

1980' gas show

1-9-84  
DATE

Samuel N. Hargman  
DISTRICT WELL INSPECTOR

04/26/2024

Form 26  
2/16/82

STATE OF WEST VIRGINIA  
DEPARTMENT OF MINES  
OIL AND GAS WELLS DIVISION

INSPECTOR'S PLUGGING REPORT

Permit No. \_\_\_\_\_

Well No. \_\_\_\_\_

COMPANY \_\_\_\_\_ ADDRESS \_\_\_\_\_

FARM \_\_\_\_\_ DISTRICT \_\_\_\_\_ COUNTY \_\_\_\_\_

Filling Material Used \_\_\_\_\_

| Liner                       |           |      | Location              | Amount | Packer | Location          |      |      |
|-----------------------------|-----------|------|-----------------------|--------|--------|-------------------|------|------|
| PLUGS USED AND DEPTH PLACED |           |      | BRIDGES               |        |        | CASING AND TUBING |      |      |
| CEMENT-THICKNESS            | WOOD-SIZE | LEAD | CONSTRUCTION-LOCATION |        |        | RECOVERED         | SIZE | LOST |
|                             |           |      |                       |        |        |                   |      |      |
|                             |           |      |                       |        |        |                   |      |      |
|                             |           |      |                       |        |        |                   |      |      |
|                             |           |      |                       |        |        |                   |      |      |
|                             |           |      |                       |        |        |                   |      |      |
|                             |           |      |                       |        |        |                   |      |      |
|                             |           |      |                       |        |        |                   |      |      |
|                             |           |      |                       |        |        |                   |      |      |
|                             |           |      |                       |        |        |                   |      |      |
|                             |           |      |                       |        |        |                   |      |      |
|                             |           |      |                       |        |        |                   |      |      |
|                             |           |      |                       |        |        |                   |      |      |
|                             |           |      |                       |        |        |                   |      |      |
|                             |           |      |                       |        |        |                   |      |      |
|                             |           |      |                       |        |        |                   |      |      |
|                             |           |      |                       |        |        |                   |      |      |
|                             |           |      |                       |        |        |                   |      |      |
|                             |           |      |                       |        |        |                   |      |      |
|                             |           |      |                       |        |        |                   |      |      |
|                             |           |      |                       |        |        |                   |      |      |

Drillers' Names \_\_\_\_\_

Remarks:

\_\_\_\_\_  
DATE I hereby certify I visited the above well on this date.

04/26/2024  
DISTRICT WELL INSPECTOR

STATE OF WEST VIRGINIA  
DEPARTMENT OF MINES  
OIL AND GAS WELLS DIVISION

RECEIVED  
JAN 18 1984

OIL & GAS DIVISION  
DEPT. OF MINES

INSPECTOR'S WELL REPORT

Permit No. 85-6628

Oil or Gas Well \_\_\_\_\_  
(KIND)

Company Ensource Inc.  
 Address \_\_\_\_\_  
 Farm Mildred Stanley  
 Well No. E-951  
 District Grant County Ritchie  
 Drilling commenced 1-5-84  
 Drilling completed 1-11-84 Total depth 5000  
 Date shot \_\_\_\_\_ Depth of shot \_\_\_\_\_  
 Initial open flow \_\_\_\_\_ /10ths Water in \_\_\_\_\_ Inch  
 Open flow after tubing \_\_\_\_\_ /10ths Merc. in \_\_\_\_\_ Inch  
 Volume \_\_\_\_\_ Cu. Ft.  
 Rock pressure \_\_\_\_\_ lbs. \_\_\_\_\_ hrs.  
 Oil \_\_\_\_\_ bbls., 1st 24 hrs.  
 Fresh water \_\_\_\_\_ feet \_\_\_\_\_ feet  
 Salt water \_\_\_\_\_ feet \_\_\_\_\_ feet

| CASING AND TUBING | USED IN DRILLING | LEFT IN WELL | PACKERS              |
|-------------------|------------------|--------------|----------------------|
| Size              |                  |              |                      |
| 16                |                  |              | Kind of Packer _____ |
| 13                |                  |              |                      |
| 10                |                  |              | Size of _____        |
| 8 1/4             |                  |              |                      |
| 6 3/4             |                  |              | Depth set _____      |
| 5 3/16            |                  |              |                      |
| 3                 |                  |              | Perf. top _____      |
| 2                 |                  |              | Perf. bottom _____   |
| Liners Used       |                  |              | Perf. top _____      |
|                   |                  |              | Perf. bottom _____   |

CASING CEMENTED \_\_\_\_\_ SIZE \_\_\_\_\_ No. FT. \_\_\_\_\_ Date \_\_\_\_\_  
 NAME OF SERVICE COMPANY \_\_\_\_\_  
 COAL WAS ENCOUNTERED AT \_\_\_\_\_ FEET \_\_\_\_\_ INCHES  
 \_\_\_\_\_ FEET \_\_\_\_\_ INCHES FEET \_\_\_\_\_ INCHES  
 \_\_\_\_\_ FEET \_\_\_\_\_ INCHES FEET \_\_\_\_\_ INCHES

Drillers' Names \_\_\_\_\_

Remarks: Ran 4910 foot of 4 1/2" casing 101 joints total of 4"  
Halliburton - cemented with 450 sacks cement  
Moving rig off location at time of visit

1-11-84  
DATE

Samuel M. Hoover  
DISTRICT WELL INSPECTOR

04/26/2024

Form 26  
2/16/82

STATE OF WEST VIRGINIA  
DEPARTMENT OF MINES  
OIL AND GAS WELLS DIVISION  
INSPECTOR'S PLUGGING REPORT

Permit No. \_\_\_\_\_ Well No. \_\_\_\_\_

COMPANY \_\_\_\_\_ ADDRESS \_\_\_\_\_

FARM \_\_\_\_\_ DISTRICT \_\_\_\_\_ COUNTY \_\_\_\_\_

Filling Material Used \_\_\_\_\_

| Liner                       | Location  |      | Amount                | Packer | Location          |      |      |
|-----------------------------|-----------|------|-----------------------|--------|-------------------|------|------|
| PLUGS USED AND DEPTH PLACED |           |      | BRIDGES               |        | CASING AND TUBING |      |      |
| CEMENT-THICKNESS            | WOOD-SIZE | LEAD | CONSTRUCTION-LOCATION |        | RECOVERED         | SIZE | LOST |
|                             |           |      |                       |        |                   |      |      |
|                             |           |      |                       |        |                   |      |      |
|                             |           |      |                       |        |                   |      |      |
|                             |           |      |                       |        |                   |      |      |
|                             |           |      |                       |        |                   |      |      |
|                             |           |      |                       |        |                   |      |      |
|                             |           |      |                       |        |                   |      |      |
|                             |           |      |                       |        |                   |      |      |
|                             |           |      |                       |        |                   |      |      |
|                             |           |      |                       |        |                   |      |      |
|                             |           |      |                       |        |                   |      |      |
|                             |           |      |                       |        |                   |      |      |
|                             |           |      |                       |        |                   |      |      |
|                             |           |      |                       |        |                   |      |      |
|                             |           |      |                       |        |                   |      |      |
|                             |           |      |                       |        |                   |      |      |
|                             |           |      |                       |        |                   |      |      |
|                             |           |      |                       |        |                   |      |      |
|                             |           |      |                       |        |                   |      |      |
|                             |           |      |                       |        |                   |      |      |

Drillers' Names \_\_\_\_\_

Remarks: \_\_\_\_\_

\_\_\_\_\_ I hereby certify I visited the above well on this date.  
DATE

\_\_\_\_\_ 04/26/2024  
DISTRICT WELL INSPECTOR



RECEIVED  
SEP 17 1984

OIL & GAS DIVISION  
**State of West Virginia DEPT. OF MINES**  
Department of Mines  
Oil and Gas Division  
Charleston 25305

FINAL INSPECTION REPORT  
INSPECTORS COMPLIANCE REPORT  
February 15, 1984

(7-83)

COMPANY Ensource, Inc.

PERMIT NO 085-6628

P. O. Drawer 1738

FARM & WELL NO Mildred Stanley #2, E-951

Clarksburg, West Virginia 26301

DIST. & COUNTY Grant/Ritchie

| RULE  | DESCRIPTION                                       | IN COMPLIANCE |    |
|-------|---------------------------------------------------|---------------|----|
|       |                                                   | YES           | NO |
| 23.06 | Notification Prior to Starting Work               |               |    |
| 25.04 | Prepared before Drilling to Prevent Waste         | ✓             |    |
| 25.03 | High-Pressure Drilling                            | ✓             |    |
| 16.01 | Required Permits at Wellsite                      | ✓             |    |
| 15.03 | Adequate Fresh Water Casing                       | ✓             |    |
| 15.02 | Adequate Coal Casing                              | ✓             |    |
| 15.01 | Adequate Production Casing                        | ✓             |    |
| 15.04 | Adequate Cement Strenght                          |               |    |
| 15.05 | Cement Type                                       |               |    |
| 23.02 | Maintained Access Roads                           | ✓             |    |
| 25.01 | Necessary Equipment to Prevent Waste              |               |    |
| 23.04 | Reclaimed Drilling Pits                           | ✓             |    |
| 23.05 | No Surface or Underground Pollution               | ✓             |    |
| 23.07 | Requirements for Production & Gathering Pipelines |               |    |
| 16.01 | Well Records on Site                              | ✓             |    |
| 16.02 | Well Records Filed                                | ✓             |    |
| 7.05  | Identification Markings                           | ✓             |    |

I HAVE INSPECTED THE ABOVE CAPTIONED WELL AND RECOMMEND THAT IT BE RELEASED:

SIGNED Samuel M. Kersman

DATE 9-10-84

Your well record was received and reclamation requirements approved. In accordance with Chapter 22, Article 4, Section 2, the above well will remain under bond coverage for the life of the well.

T. H. R. B.  
Administrator-Oil & Gas Division

October 25, 1984

DATE

TMS/chm

04/26/2024



**APPLICATION FOR DETERMINATION OF THE MAXIMUM LAWFUL  
PRICE UNDER THE NATURAL GAS POLICY ACT (NGPA)**

|                                                                                                                               |                                                   |                |                                      |                                            |                               |
|-------------------------------------------------------------------------------------------------------------------------------|---------------------------------------------------|----------------|--------------------------------------|--------------------------------------------|-------------------------------|
| 1.0 API well number:<br>(If not assigned, leave blank. 14 digits.)                                                            | 47 - 085 - 6628 -                                 |                |                                      |                                            |                               |
| 2.0 Type of determination being sought:<br>(Use the codes found on the front of this form.)                                   | 103<br>Section of NGPA                            | -              | Category Code                        |                                            |                               |
| 3.0 Depth of the deepest completion location:<br>(Only needed if sections 103 or 107 in 2.0 above.)                           | 5003 feet                                         |                |                                      |                                            |                               |
| 4.0 Name, address and code number of applicant:<br>(35 letters per line maximum. If code number not available, leave blank.)  | Ensource Inc.<br>Name                             |                | 04119<br>Seller Code                 |                                            |                               |
|                                                                                                                               | P. O. Drawer 1738<br>Street                       |                | OIL & GAS DIVISION<br>DEPT. OF MINES |                                            |                               |
|                                                                                                                               | Clarksburg<br>City                                | WV<br>State    | 26301<br>Zip Code                    |                                            |                               |
| 5.0 Location of this well: [Complete (a) or (b).]<br>(a) For onshore wells<br>(35 letters maximum for field name.)            | Field Name<br>Ritchie                             |                |                                      |                                            |                               |
|                                                                                                                               | WV<br>State                                       |                |                                      |                                            |                               |
| (b) For OCS wells:                                                                                                            | Area Name<br>N/A                                  |                |                                      |                                            |                               |
|                                                                                                                               | Block Number                                      |                |                                      |                                            |                               |
|                                                                                                                               | Date of Lease:<br>Mo. Day Yr.                     |                |                                      |                                            |                               |
|                                                                                                                               | OCS Lease Number                                  |                |                                      |                                            |                               |
| (c) Name and identification number of this well:<br>(35 letters and digits maximum.)                                          | Mildred Stanley #2                                |                |                                      |                                            |                               |
| (d) If code 4 or 5 in 2.0 above, name of the reservoir:<br>(35 letters maximum.)                                              | N/A                                               |                |                                      |                                            |                               |
| 6.0 (a) Name and code number of the purchaser:<br>(35 letters and digits maximum. If code number not available, leave blank.) | Consolidated Gas Transmission Corporation<br>Name |                |                                      | 004228<br>Buyer Code                       |                               |
| (b) Date of the contract:                                                                                                     | Mo. Day Yr.                                       |                |                                      |                                            |                               |
| (c) Estimated total annual production from the well:                                                                          | N/A Million Cubic Feet                            |                |                                      |                                            |                               |
| 7.0 Contract price:<br>(As of filing date. Complete to 3 decimal places.)                                                     | S/MMETU                                           | (a) Base Price | (b) Tax                              | (c) All Other Prices [Indicate (+) or (-)] | (d) Total of (a), (b) and (c) |
| 8.0 Maximum lawful rate:<br>(As of filing date. Complete to 3 decimal places.)                                                | S/M:MBTU                                          | 2.859          | 2.86                                 | ---                                        | 3.145                         |
| 9.C Person responsible for this application:                                                                                  | Michael W. Nugen<br>Name                          |                |                                      |                                            |                               |
| Agency Use Only                                                                                                               | District Manager<br>Title                         |                |                                      |                                            |                               |
| Date Received by FERC                                                                                                         | February 7, 1984<br>Date Application is Completed |                |                                      |                                            |                               |
| Date Received by FERC                                                                                                         | (304) 624-9653<br>Phone Number                    |                |                                      |                                            |                               |

RECEIVED

FEB 10 1984

FERC-121 (8-82)

04/26/2024

DATE: MAR 27 1984

BUYER-SELLER CODE

PARTICIPANTS:

WELL OPERATOR: Ensource Inc.

FIRST PURCHASER: Consolidated Gas Trans Corp

004228

OTHER: \_\_\_\_\_

W. Va. Department of Mines, Oil & Gas Division  
 WELL DETERMINATION FILE NUMBER  
8402 10 -103 -085 = 6628  
 Use Above File Number on all Communications  
 Relating to Determination of this Well

~~085 - 3826 -> TD = 2128'~~  
~~860 -> TD = 2090'~~

**APPROVED**

APR 27 1984

CHECK EACH ITEM AS COMPLETE OR NOTE WHAT IS MISSING

ITEM NO.

- 1. FERC -121 \_\_\_\_\_ Items not completed - Line No. \_\_\_\_\_
- 2. IV-1 Agent \_\_\_\_\_
- 3. IV-2 Well Permit \_\_\_\_\_
- 4. IV-6 Well Plat \_\_\_\_\_
- 5. IV-35 Well Record \_\_\_\_\_ Drilling \_\_\_\_\_ Deepening \_\_\_\_\_
- 6. IV-36 Gas-Oil Test: Gas Only \_\_\_\_\_ Was Oil Produced? \_\_\_\_\_ Ratio \_\_\_\_\_
- 7. IV-39 Annual Production \_\_\_\_\_ years
- 8. IV-40 90 day Production \_\_\_\_\_ Days off line \_\_\_\_\_
- 9. IV-48 Application for certification. Complete? \_\_\_\_\_
- 10-17. IV Form 51 - 52 - 53 - 54 - 55 - 56 - 57 - 58 Complete? \_\_\_\_\_ Affidavit Signed \_\_\_\_\_
- 18-28. Other: Survey \_\_\_\_\_ Logs \_\_\_\_\_ Geological Charts \_\_\_\_\_  
 Structure Map \_\_\_\_\_ 1: 4000 Map \_\_\_\_\_ Well Tabulations \_\_\_\_\_  
 Gas Analyses \_\_\_\_\_
- (5) Date commenced: \_\_\_\_\_ Date completed \_\_\_\_\_ Deepened \_\_\_\_\_
- (5) Production Depth: \_\_\_\_\_
- (5) Production Formation: \_\_\_\_\_
- (5) Final Open Flow: \_\_\_\_\_
- (5) After Frac. R. P. \_\_\_\_\_
- (6) Other Gas Test: \_\_\_\_\_
- (7) Avg. Daily Gas from Annual Production: \_\_\_\_\_
- (8) Avg. Daily Gas from 90-day ending w/1-120 days \_\_\_\_\_
- (8) Line Pressure: \_\_\_\_\_ PSIG from Daily \_\_\_\_\_
- (5) Oil Production: \_\_\_\_\_ From Completion Report \_\_\_\_\_
- 10-17. Does lease inventory indicate enhanced recovery being done \_\_\_\_\_
- 10-17. Is affidavit signed? \_\_\_\_\_ Notarized? \_\_\_\_\_
- Does official well record with the Department confirm the submitted information? \_\_\_\_\_
- Additional information \_\_\_\_\_ Does computer program confirm? \_\_\_\_\_
- Was Determination Objected to \_\_\_\_\_ By Whom? \_\_\_\_\_

04/26/2024

STATE APPLICATION FOR WELL CLASSIFICATION

WELL OPERATOR Ensource Inc.  
ADDRESS P. O. Drawer 1738  
Clarksburg, WV 26301

DESIGNATED AGENT Michael W. Nugen  
ADDRESS P. O. Drawer 1738  
Clarksburg, WV 26301

Gas Purchase Contract No. N/A and Date N/A  
(Month, day and year)

Meter Chart Code N/A

Name of First Purchaser Consolidated Gas Transmission Corporation  
445 W. Main Street  
(Street or P. O. Box)  
Clarksburg WV 26301  
(City) (State) (Zip Code)

FERC Seller Code 04119

FERC Buyer Code 004228

TYPE OF DETERMINATION BEING SOUGHT:

- (1) Initial determination (See FERC Form 121.) 103 Section of NGPA Category Code
- (2) Determination that increased production is the result of enhanced recovery technology.
- (3) Determination of a seasonally affected well.

Michael W. Nugen District Manager  
Name (Print) Title  
Michael W. Nugen  
Signature  
P. O. Drawer 1738  
Street or P. O. Box  
Clarksburg, WV 26301  
City State (Zip Code)  
(304) 624-9653  
Area Code Phone Number

(Certificate of Proof of Service to Purchaser)

I hereby certify that I have this day served the foregoing document together with the related attachments upon purchasers of natural gas from Ensource Inc.  
Dated at Clarksburg, West Virginia, this 7th day of February, 1984.

Michael W. Nugen  
Signature

(All of the above to be completed by the Operator/Applicant)

(To be completed by Jurisdictional Agency. Executed copy to be returned to Operator/Applicant and purchaser, if known).

The Department of Mines has received a request  for certification of the above described well as meeting the requirements of Section \_\_\_\_\_ under the Natural Gas Policy Act of 1978 (NGPA);  for determination that increased production is the result of enhanced recovery technology under Section 108 of (NGPA);  or for determination of a seasonally affected well under Section 108 of (NGPA).

All interested parties are hereby notified that on the \_\_\_\_\_ day of \_\_\_\_\_, 19\_\_\_\_, at the office of the Oil and Gas Division in Charleston, West Virginia, or as soon thereafter as it may be heard, there will be a public hearing, if requested, or if objection is filed.

This Application is assigned File No. \_\_\_\_\_

Initial review of information submitted indicates the well  is.  is not entitled to certification as claimed under the Natural Gas Policy Act (NGPA). A review of this evidence and any additional evidence will be made at the time appointed for a public hearing or as soon thereafter as the matter may be heard.

Unless objections are timely filed or a request for a hearing is made within fifteen (15) days, a hearing will not be held except on ex parte motion of the department and the matter will go to determination.

WEST VIRGINIA DEPARTMENT OF MINES

FEB 10 1984

[Signature]  
Director

Date received by  
Jurisdictional Agency

By \_\_\_\_\_  
Title \_\_\_\_\_

04/26/2024

STATE OF WEST VIRGINIA  
DEPARTMENT OF MINES, OIL AND GAS DIVISION

Date February 7, 1984

Operator's Well No. E-951  
Mildred Stanley #2

API Well No. 47 - 085 - 6628  
State County Permit

WELL CLASSIFICATION FORM  
NEW ONSHORE PRODUCTION WELL

NGPA Section 103

DESIGNATED AGENT Michael W. Nugen

ADDRESS P. O. Drawer 1738  
Clarksburg, WV 26301

WELL OPERATOR Ensource Inc.

LOCATION: Elevation 1030'

ADDRESS P. O. Drawer 1738  
Clarksburg, WV 26301

Watershed North Fork of Hughes River

GAS PURCHASER Consolidated Gas Trans.

Gas Purchase Contract No. N/A

ADDRESS 445 W. Main Street Corp.  
Clarksburg, WV 26301

Meter Chart Code N/A

Date of Contract N/A

\* \* \* \* \*

Date surface drilling was begun: 1/06/84

Indicate the bottom hole pressure of the well and explain how this was calculated:

$$BHP = P + P = (e^{GL/53.34T-1})$$

$$P = 800 + 14.73 = 814.73 \qquad BHP = 1426.35$$

$$G = .65$$

$$L = 2666$$

$$T = 580$$

AFFIDAVIT

I, Michael W. Nugen, having been first sworn according to law state that surface drilling of the well for which this determination is sought was begun on or after February 19, 1977; the well satisfies applicable state or federal well spacing requirements and the well is not within a proration unit, in existence at the time surface drilling began, which was applicable to the reservoir from which gas is or will be produced and which applied to any other well producing gas in commercial quantities or on which surface drilling began on or after February 19, 1977, and which was capable of producing gas in commercial quantities. I state, further, that I have concluded, to the best of my information, knowledge and belief, that the well for which this determination is sought is a new onshore production well and that I am not aware of any information not described in the application which is inconsistent with this conclusion.

*Michael W. Nugen*

STATE OF WEST VIRGINIA,  
COUNTY OF Harrison, TO WIT:

I, Hazel L. Carder, a Notary Public in and for the state and county aforesaid, do certify that Michael W. Nugen whose name is signed to the writing above, bearing date the 7th day of February, 1984, has acknowledged the same before me, in my county aforesaid.

Given under my hand and official seal this 7th day of February, 1984.

My term of office expires on the 23 day of March, 1993.

[NOTARIAL SEAL]

*Hazel L. Carder*  
Notary Public

04/26/2024

ASSIGNMENT AND POWER OF ATTORNEY

This Assignment and Power of Attorney from

OPPENHEIMER OIL & GAS CO, INC.,  
a Delaware Corporation

(herein called "Assignor") to Ensource Inc., a Delaware corporation having an office at 5575 DTC Parkway, Englewood, Colorado (herein called "Assignee");

WITNESSETH:

Assignor, for the sum of one dollar (\$1.00) and other valuable consideration, the receipt of which is hereby acknowledged, does by these presents GRANT, BARGAIN, SELL, EXCHANGE, CONVEY, ASSIGN, TRANSFER, SET OVER and DELIVER unto Assignee all of the following:

A. The interests in oil, gas, and other mineral leases, rights and properties and rights to production which are referred to or described in Exhibit A attached hereto and incorporated herein by reference (all of such being referred to as the "properties described" in the following subparagraphs B, C, D and E).

B. All right, title and interest of Assignor derived from all presently existing and valid oil, gas or mineral unitization, pooling, operating and communitization agreements, declarations and orders, and in and to the properties covered and the units created thereby (including all units formed under orders, regulations, rules or other official acts of any federal, state or other governmental agency having jurisdiction), which relate to any of the properties described.

C. All right, title and interest of Assignor in, to or under or by virtue of all presently existing and valid oil and gas sales, purchase, exchange and processing contracts, casinghead gas contracts, operating agreements, joint venture agreements, tax partnerships and other contracts, agreements and instruments (including without limitation, future interests, reversionary rights and deferred interests), which relate to any of the properties described, but only insofar as such contracts, agreements and instruments relate to the properties described.

D. All right, title and interest of Assignor in all personal property, improvements, lease and well equipment, easements, permits, licenses, servitudes and rights-of-way (including, but not by way of limitation, any wells, tanks, boilers, buildings, fixtures, machinery, injection facilities, saltwater disposal facilities, compression facilities and other equipment, gathering system, power lines, telephone and telegraph lines, roads and other appurtenances and easements) now being used in connection with the exploration, development, operation or maintenance of the properties described, or any unit or units in which part or parts of the properties described may be included, or being used in connection with the production, treating, storing, transportation or marketing of oil, gas and other minerals produced from or allocated to properties described or such unit or units.

E. Without limitation of the foregoing, all of Assignor's right, title, interest and estate of every nature and description in and to the properties described or described in any of the leases referred to or described in Exhibit A or included in any unit including any of Assignor's interest in any such lease or land described, even though Assignor's interests therein be incorrectly described in, or a description of such interests be omitted from Exhibit A.

This instrument was prepared by Charles F. Savage, an officer of the Assignee, at the Assignee's above address.

04/26/2024

The spouse of the Assignor, if a married person, joins herein for the purpose of conveying to the Assignee all of the interests, if any, of said spouse in the Property, and does hereby grant, transfer, convey and assign to the Assignee all of the right, title and interest, (including, without limitation, community property rights and rights of dower or curtesy) of said spouse in the Property.

Executed on the date set forth below in the acknowledgement, but effective as of 12:01 A.M. on the first day of July, 1981.

OPPENHEIMER OIL & GAS CO., INC.

*R. E. Kellerman*  
Signature(s) of Assignor(s)

Attest:

BY:

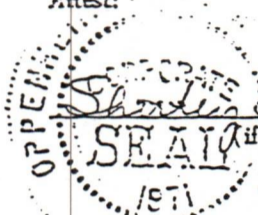

*Shirley Stovall*  
if corporate Assignor

PRESIDENT

*R. E. KELLERMAN*  
Full Name(s) of Assignor(s) (Please print)

*SHIRLEY STOVALL, SECRETARY*  
Name and Title of Attestant

Full Title of Person(s) Signing (if appropriate)

Signed and delivered  
in the presence of:

Signature of Spouse  
(Only if signed as an individual)

*Kay Gideon*  
Signature of Witness

Name of Spouse (Please print)

*Kay Gideon*  
Name (Please print)

*Delois Griffith*  
Signature of Witness

*Delois Griffith*  
Name (Please print)

This instrument was prepared by Charles F. Savage, an officer of the Assignee, at the Assignee's above address.

04/26/2024

ACKNOWLEDGMENT FOR CORPORATION

STATE OF .....

COUNTY OF .....

I, the undersigned authority in and for said County in said State, hereby certify that ..... whose name as ..... of ..... a corporation, is signed to the foregoing instrument and who is known to me, acknowledged before me on this day that, being informed of the contents of the instrument, he/she, as such officer and with full authority, executed the same voluntarily for and as the act of said corporation.

[Alabama]

Before me, the undersigned officer, on this day personally appeared ..... who acknowledged himself/herself to be the ..... of ..... a corporation, and that he/she, as such ..... being authorized so to do, executed the foregoing instrument for the purposes therein contained, by signing the name of the corporation by himself/herself as .....

[Arkansas, Pennsylvania, and South Dakota]

On this day, before me, the undersigned authority, appeared ..... to me personally known, who being by me duly sworn, did say that he/she is the ..... President of ..... a ..... corporation, and that said instrument was signed in behalf of said corporation by authority of its Board of Directors, and said ..... acknowledged said instrument to be the free act and deed of said corporation.

[Louisiana]

Personally appeared before me, the undersigned authority, on this day the within named ..... who acknowledged that he/she signed and delivered the foregoing instrument on the day and year therein mentioned.

[Mississippi]

On this day before me, the undersigned authority, personally appeared ..... known to me to be the ..... of the corporation that executed the within instrument and acknowledged to me that such corporation executed the same.

[Montana]

Before me, the undersigned authority, on this day personally appeared ..... known to me to be the person whose name is subscribed to the foregoing instrument and known to me to be the ..... President of ..... a corporation, and acknowledged to me that he/she executed said instrument for the purposes and consideration therein expressed, in the capacity therein stated, and as the act and deed of said corporation.

[Texas]

On this day personally appeared before me ..... who being by me duly sworn, did say that he/she is the ..... of ..... and that said instrument was signed in behalf of said corporation by authority of its bylaws/a resolution of its board of directors, and said ..... acknowledged to me that said corporation executed the same.

[Utah]

The foregoing instrument was acknowledged before me on this day by R. E. Kelleman, the OPPENHEIMER OIL & GAS CO., INC. President of ..... Delaware corporation, on behalf of the corporation.

[Colorado, Illinois, Kansas, Michigan, Nebraska, New Mexico, North Dakota, Ohio, Oklahoma, West Virginia, and Wyoming]

In witness whereof I hereunto set my hand and official seal this 23rd day of Nov., 1921



Notary Public in and for ..... County, .....  
Name: *Green Hunt*  
04/26/2024

RECEIVED

FEB 3 - 1984



IV-35 (Rev 8-81)

OIL & GAS DIVISION

DEPT. OF MINES

State of West Virginia

Department of Mines Oil and Gas Division

Date February 1, 1984

Operator's

Well No. E-951

Farm Mildred Stanley #2

API No. 47 - 085 - 6628

WELL OPERATOR'S REPORT OF

DRILLING, FRACTURING AND/OR STIMULATING, OR PHYSICAL CHANGE

WELL TYPE: Oil X / Gas X / Liquid Injection / Waste Disposal / (If "Gas," Production X / Underground Storage / Deep / Shallow /)

LOCATION: Elevation: 1030' Watershed North Fork of Hughes River District: Grant County Ritchie Quadrangle Harrisville

COMPANY Ensource Inc. ADDRESS P. O. Drawer 1738, Clarksburg, WV 26301 DESIGNATED AGENT Michael W. Nugen ADDRESS Same SURFACE OWNER Mildred Stanley Heirs ADDRESS RFD 1, Harrisville, WV 26362 MINERAL RIGHTS OWNER Same ADDRESS Same OIL AND GAS INSPECTOR FOR THIS WORK Deo Mace ADDRESS Route 1, Box 65 Sandridge, WV 25274 PERMIT ISSUED July 25, 1983 DRILLING COMMENCED 1/06/84 DRILLING COMPLETED 1/12/84 IF APPLICABLE: PLUGGING OF DRY HOLE ON CONTINUOUS PROGRESSION FROM DRILLING OR REWORKING. VERBAL PERMISSION OBTAINED ON

Table with 4 columns: Casing & Tubing, Used in Drilling, Left in Well, Cement fill up Cu. ft. Rows include sizes 20-16 Cond., 13-10", 9 5/8, 8 5/8, 7, 5 1/2, 4 1/2, 3, and 2 1/2.

GEOLOGICAL TARGET FORMATION Devonian Shale Depth 5000 feet Depth of completed well 5003 feet Rotary X / Cable Tools Water strata depth: Fresh 50 feet; Salt 1030 feet Coal seam depths: N/A Is coal being mined in the area? No

OPEN FLOW DATA

Producing formation Devonian Shale Pay zone depth 4834-2464 feet Gas: Initial open flow TSTM Mcf/d Oil: Initial open flow Bbl/d Final open flow 358 Mcf/d Oil: Final open flow 1 Bbl/d Time of open flow between initial and final tests 3 hours Static rock pressure 800 psig (surface measurement) after 24 hours shut in (If applicable due to multiple completion--)

04/26/2024

Second producing formation Pay zone depth feet Gas: Initial open flow Mcf/d Oil: Initial open flow Bbl/d Final open flow Mcf/d Oil: Final open flow Bbl/d Time of open flow between initial and final tests hours Static rock pressure psig (surface measurement) after hours shut in

(Continue on reverse side)

RIT 6628



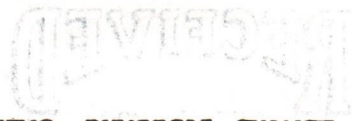

DETAILS OF PERFORATED INTERVALS, FRACTURING OR STIMULATING, PHYSICAL CHANGE, ETC.

Perforate 1st Stage 4834-4326 (19) holes, frac w/725 MSCF N<sub>2</sub>.  
 Perforate 2nd Stage 3741-3568 (20) holes, frac w/780 MSCF N<sub>2</sub>.  
 Perforate 3rd Stage 2868-2464 (20) holes, frac w/450 MSCF N<sub>2</sub>.

WELL LOG

| FORMATION              | COLOR | HARD OR SOFT | TOP FEET | BOTTOM FEET | REMARKS<br>Including indication of all fresh and salt water, coal, oil and gas |
|------------------------|-------|--------------|----------|-------------|--------------------------------------------------------------------------------|
| Soil                   |       |              | 0        | 5           |                                                                                |
| Sand                   |       |              | 5        | 88          |                                                                                |
| Sand, Shale & Red Rock |       |              | 88       | 309         |                                                                                |
| Coal                   |       |              | 309      | 319         |                                                                                |
| Sand & Shale           |       |              | 319      | 357         |                                                                                |
| Coal                   |       |              | 357      | 362         |                                                                                |
| Red Rock, Sand & Shale |       |              | 362      | 1152        |                                                                                |
| Sand                   |       |              | 1152     | 1906        |                                                                                |
| Sand & Shale           |       |              | 1906     | 3200        | Gas Ck. @ 1983'                                                                |
| Sand                   |       |              | 3200     | 3900        | Gas Ck. @ 2267'                                                                |
| Sand & Shale           |       |              | 3900     | 4703        | Gas Ck. @ 3332'                                                                |
| Benson                 |       |              | 4703     | 5003        | Gas Ck. @ 3863'                                                                |
|                        |       |              |          | 5003        | T.D.                                                                           |
| Geological Formations: |       |              |          |             |                                                                                |
| Big Lime               |       |              | 1600     | 1850        |                                                                                |
| Injun                  |       |              | 1850     | 2096        |                                                                                |
| Shale                  |       |              | 2100     | 2194        |                                                                                |
| Weir                   |       |              | 2194     | 2260        |                                                                                |
| Shale                  |       |              | 2260     | 2456        |                                                                                |
| Berea                  |       |              | 2456     | 2492        |                                                                                |
| Shale                  |       |              | 2492     | 2564        |                                                                                |
| Gordon                 |       |              | 2564     | 2692        |                                                                                |
| Silty Shale            |       |              | 2692     | 2858        |                                                                                |
| Fifth Sand             |       |              | 2858     | 2870        |                                                                                |
| Shale                  |       |              | 2870     | 3550        |                                                                                |
| Lower Speechly         |       |              | 3550     | 3610        |                                                                                |
| Shale                  |       |              | 3610     | 3676        |                                                                                |
| Balltown               |       |              | 3676     | 3756        |                                                                                |
| Shale                  |       |              | 3756     | 5000        |                                                                                |

(Attach separate sheets as necessary)

Ensource Inc.

Well Operator

By: Michael W. Auger

04/26/2024

Date: February 1, 1984

Note: Regulation 2.02(i) provides as follows:  
 "The term 'log' or 'well log' shall mean a systematic detailed geological record of all formations, including coal, encountered in the drilling of a well."

Ritchie County, W.V.

**ASSIGNMENT AND POWER OF ATTORNEY**

This Assignment and Power of Attorney from

WEST VIRGINIA DEVELOPMENT DRILLING PROGRAM NO. 2,  
a New York Limited Partnership,

(herein called "Assignor") to Ensource Inc., a Delaware corporation having an office at 5575 DTC Parkway, Englewood, Colorado (herein called "Assignee");

**WITNESSETH:**

Assignor, for the sum of one dollar (\$1.00) and other valuable consideration, the receipt of which is hereby acknowledged, does by these presents GRANT, BARGAIN, SELL, EXCHANGE, CONVEY, ASSIGN, TRANSFER, SET OVER and DELIVER unto Assignee all of the following:

A. The interests in oil, gas, and other mineral leases, rights and properties and rights to production which are referred to or described in Exhibit A attached hereto and incorporated herein by reference (all of such being referred to as the "properties described" in the following subparagraphs B, C, D and E).

B. All right, title and interest of Assignor derived from all presently existing and valid oil, gas or mineral unitization, pooling, operating and communitization agreements, declarations and orders, and in and to the properties covered and the units created thereby (including all units formed under orders, regulations, rules or other official acts of any federal, state or other governmental agency having jurisdiction), which relate to any of the properties described.

C. All right, title and interest of Assignor in, to or under or by virtue of all presently existing and valid oil and gas sales, purchase, exchange and processing contracts, casinghead gas contracts, operating agreements, joint venture agreements, tax partnerships and other contracts, agreements and instruments (including without limitation, future interests, reversionary rights and deferred interests), which relate to any of the properties described, but only insofar as such contracts, agreements and instruments relate to the properties described.

D. All right, title and interest of Assignor in all personal property, improvements, lease and well equipment, easements, permits, licenses, servitudes and rights-of-way (including, but not by way of limitation, any wells, tanks, boilers, buildings, fixtures, machinery, injection facilities, saltwater disposal facilities, compression facilities and other equipment, gathering system, power lines, telephone and telegraph lines, roads and other appurtenances and easements) now being used in connection with the exploration, development, operation or maintenance of the properties described, or any unit or units in which part or parts of the properties described may be included, or being used in connection with the production, treating, storing, transportation or marketing of oil, gas and other minerals produced from or allocated to properties described or such unit or units.

E. Without limitation of the foregoing, all of Assignor's right, title, interest and estate of every nature and description in and to the properties described or described in any of the leases referred to or described in Exhibit A or included in any unit including any of Assignor's interest in any such lease or land described, even though Assignor's interests therein be incorrectly described in, or a description of such interests be omitted from Exhibit A.

This instrument was prepared by Charles F. Savage, an officer of the Assignee, at the Assignee's above address.

04/26/2024  
RETURN TO  
COLE EXPLORATION  
11777 KATY FREEWAY  
SUITE 540. SOUTH BLDG.  
HOUSTON, TEXAS 77079

The spouse of the Assignor, if a married person, joins herein for the purpose of conveying to the Assignee all of the interests, if any, of said spouse in the Property, and does hereby grant, transfer, convey and assign to the Assignee all of the right, title and interest, (including, without limitation, community property rights and rights of dower or curtesy) of said spouse in the Property.

Executed on the date set forth below in the acknowledgement, but effective as of 12:01 A.M. on the first day of July, 1981.

WEST VIRGINIA DEVELOPMENT DRILLING PROGRAM NO. 2

Attest:

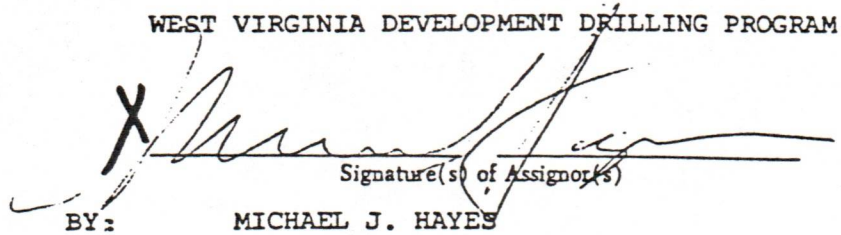
  
Signature(s) of Assignor(s)  
BY: MICHAEL J. HAYES

\_\_\_\_\_  
(if corporate Assignor)

\_\_\_\_\_  
Full Name(s) of Assignor(s) (Please print)

\_\_\_\_\_  
Name and Title of Attestant

GENERAL PARTNER  
\_\_\_\_\_  
Full Title of Person(s) Signing (if appropriate)

Signed and delivered  
in the presence of:

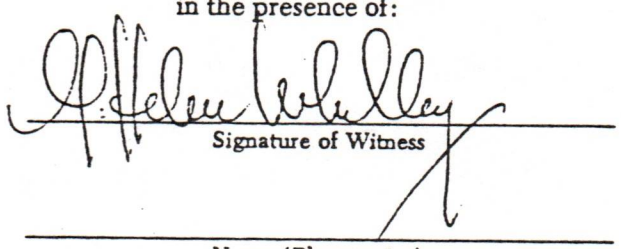
  
Signature of Witness

\_\_\_\_\_  
Signature of Spouse  
(Only if signed as an individual)

\_\_\_\_\_  
Name of Spouse (Please print)

\_\_\_\_\_  
Name (Please print)

\_\_\_\_\_  
Signature of Witness

\_\_\_\_\_  
Name (Please print)

This instrument was prepared by Charles F. Savage, an officer of the Assignee, at the Assignee's above address.

04/26/2024

ACKNOWLEDGMENT FOR PARTNERSHIP  
ACTING BY ONE OR MORE PARTNERS

STATE OF NY }  
COUNTY OF NY }

I, the undersigned authority in and for said County in said State, hereby certify that .....  
whose name as partner of ..... a partnership, is signed to the foregoing instrument and  
who is known to me, acknowledged before me on this day that, being informed of the contents of the instrument,  
he/she, in his/her capacity as such partner, executed the same voluntarily on the day the same bears date.

[Alabama]

On this day, before me, the undersigned officer, personally appeared ..... who acknowledged  
himself/herself to be one of the partners of ..... a partnership, and that he/she, as such  
partner, being authorized so to do, executed the foregoing instrument for the purposes therein contained, by signing  
the name of the partnership by himself/herself as a partner.

[Arkansas,  
Pennsylvania,  
and South  
Dakota]

On this day before me, the undersigned authority, personally appeared ..... to me  
known to be the person who executed the foregoing instrument in behalf of ..... a partner-  
ship, and acknowledged said instrument to be the free act and deed of said partnership.

[Louisiana]

Personally appeared before me, the undersigned authority, on this day the within named .....  
who acknowledged that he/she signed and delivered the foregoing instrument on the day and year therein  
mentioned.

[Mississippi]

On this day, before me, the undersigned authority, personally appeared ..... known to me  
to be the person whose name is subscribed to the within instrument as one of the partners of .....  
a partnership, and acknowledged to me that he/she subscribed the name of the partnership thereto by himself/  
herself as a partner.

[Montana]

Before me, the undersigned authority, on this day personally appeared ..... known  
to me to be the person whose name is subscribed to the foregoing instrument, and acknowledged that he/she  
executed the same for the purpose and consideration therein expressed and in the capacity therein stated.

[Texas]

On this day, personally appeared before me ..... who being by me duly sworn did say  
that he/she is a partner of ..... a partnership, and that said instrument was signed  
in behalf of said partnership by authority, and said ..... acknowledged to me that said partnership  
executed the same.

[Utah]

The foregoing instrument was acknowledged before me on this day by MICHAEL J. HAYES  
on behalf of WEST VIRGINIA DEVELOPMENT DRILLING PROGRAM NO. 2, a general partner  
....., a partnership.

[Colorado,  
Illinois,  
Kansas,  
Michigan,  
Nebraska,  
New Mexico,  
North  
Dakota, Ohio,  
Oklahoma,  
West  
Virginia, and  
Wyoming]

In witness whereof I hereunto set my hand and official seal this 7 day of April, 1982

My Commission Expires:

MARGARET C. SPRINGMANN  
Notary Public, State of New York  
No. 43-4697068  
Qualified in Richmond County  
Commission Expires March 30, 1983

Name: Margaret C. Springmann  
Notary Public in and for Richmond County, NY

04/26/2024



ASSIGNMENT AND POWER OF ATTORNEY

This Assignment and Power of Attorney from

ROBERT ALBRECHT

(herein called "Assignor") to Ensource Inc., a Delaware corporation having an office at 5575 DTC Parkway, Englewood, Colorado (herein called "Assignee");

WITNESSETH:

Assignor, for the sum of one dollar (\$1.00) and other valuable consideration, the receipt of which is hereby acknowledged, does by these presents GRANT, BARGAIN, SELL, EXCHANGE, CONVEY, ASSIGN, TRANSFER, SET OVER and DELIVER unto Assignee all of the following:

A. The interests in oil, gas, and other mineral leases, rights and properties and rights to production which are referred to or described in Exhibit A attached hereto and incorporated herein by reference (all of such being referred to as the "properties described" in the following subparagraphs B, C, D and E).

B. All right, title and interest of Assignor derived from all presently existing and valid oil, gas or mineral unitization, pooling, operating and communitization agreements, declarations and orders, and in and to the properties covered and the units created thereby (including all units formed under orders, regulations, rules or other official acts of any federal, state or other governmental agency having jurisdiction), which relate to any of the properties described.

C. All right, title and interest of Assignor in, to or under or by virtue of all presently existing and valid oil and gas sales, purchase, exchange and processing contracts, casinghead gas contracts, operating agreements, joint venture agreements, tax partnerships and other contracts, agreements and instruments (including without limitation, future interests, reversionary rights and deferred interests), which relate to any of the properties described, but only insofar as such contracts, agreements and instruments relate to the properties described.

D. All right, title and interest of Assignor in all personal property, improvements, lease and well equipment, easements, permits, licenses, servitudes and rights-of-way (including, but not by way of limitation, any wells, tanks, boilers, buildings, fixtures, machinery, injection facilities, saltwater disposal facilities, compression facilities and other equipment, gathering system, power lines, telephone and telegraph lines, roads and other appurtenances and easements) now being used in connection with the exploration, development, operation or maintenance of the properties described, or any unit or units in which part or parts of the properties described may be included, or being used in connection with the production, treating, storing, transportation or marketing of oil, gas and other minerals produced from or allocated to properties described or such unit or units.

E. Without limitation of the foregoing, all of Assignor's right, title, interest and estate of every nature and description in and to the properties described or described in any of the leases referred to or described in Exhibit A or included in any unit including any of Assignor's interest in any such lease or land described, even though Assignor's interests therein be incorrectly described in, or a description of such interests be omitted from Exhibit A.

This instrument was prepared by Charles F. Savage, an officer of the Assignee, at the Assignee's above address.

04/26/2024

RETURN TO  
COLE EXPLORATION  
11777 KATY FREEWAY  
SUITE 540. SOUTH BLDG  
HOUSTON, TEXAS 77079

ACKNOWLEDGMENT FOR SINGLE INDIVIDUAL

STATE OF UTAH }  
COUNTY OF Duchesne }

I, the undersigned authority, hereby certify that ... whose name is signed to the foregoing instrument, and who is known to me, acknowledged before me on this day that, being informed of the contents of the instrument, he/she executed the same voluntarily on the day the same bears date. [Alabama]

Before me, the undersigned officer, on this day personally appeared ..., known to me to be the person whose name is subscribed to the within instrument and acknowledged that he/she executed the same for the purposes therein contained. [Arkansas, Pennsylvania, and South Dakota]

On this day, before me, the undersigned authority, personally appeared ..., to me known to be the person who executed the foregoing instrument, and acknowledged that he/she executed the same as his/her free act and deed. [Louisiana]

Personally appeared before me, the undersigned authority, on this day the within named ... who acknowledged that he/she signed and delivered the foregoing instrument on the day and year therein mentioned. [Mississippi]

On this day, before me, the undersigned authority, personally appeared ..., known to me to be the person whose name is subscribed to the within instrument, and acknowledged to me that he/she executed the same. [Montana]

Before me, the undersigned authority, on this day personally appeared ..., known to me to be the person whose name is subscribed to the foregoing instrument, and acknowledged to me that he/she executed the same for the purpose and consideration therein expressed. [Texas]

On this day, personally appeared before me Robert A Albrecht, the signer of the above instrument, who duly acknowledged to me that he/she executed the same. [Utah]

The foregoing instrument was acknowledged before me on this day by Robert A Albrecht... [Colorado, Illinois, Kansas, Michigan, Nebraska, New Mexico, North Dakota, Ohio, Oklahoma, West Virginia, and Wyoming]

In witness whereof I hereunto set my hand and official seal this 13th day of Oct, 19 81

My Commission Expires:

9-18-85

Name: [Signature]  
Notary Public in and for Salt Lake County

04/26/2024

ACKNOWLEDGMENT FOR MARRIED COUPLES

STATE OF ..... }  
COUNTY OF ..... }

I, the undersigned authority, hereby certify that ..... and ..... whose names are signed to the foregoing instrument, and who are known to me, acknowledged before me on this day that, being informed of the contents of the instrument, they executed the same on the day same bears date. [Alabama]

Before me, the undersigned officer, on this day personally appeared ..... and ..... known to me to be the persons whose names are subscribed to the within instrument and acknowledged that they executed the same for the purposes therein contained. [Arkansas, Pennsylvania, and South Dakota]

On this day, before me, the undersigned authority, personally appeared ..... and ..... to me known to be the persons who executed the foregoing instrument, and acknowledged that they executed the same as their free act and deed. [Louisiana]

Personally appeared before me, the undersigned authority, on this day the within named ..... and ..... who acknowledged that they signed and delivered the foregoing instrument on the day and year therein mentioned. [Mississippi]

On this day, before me, the undersigned authority, personally appeared ..... and ..... known to me to be the persons whose names are subscribed to the within instrument, and acknowledged to me that they executed the same. [Montana]

Before me, the undersigned authority, on this day personally appeared ..... and ..... known to me to be the persons whose names are subscribed to the foregoing instrument, and acknowledged to me that they executed the same for the purpose and consideration therein expressed. [Texas]

On this day, personally appeared before me ..... and ..... the signers of the above instrument, who duly acknowledged to me that they executed the same. [Utah]

The foregoing instrument was acknowledged before me on this day by Robert Albrecht ..... and by ..... his wife. [Colorado, Illinois, Kansas, Michigan, Nebraska, New Mexico, North Dakota, Ohio, Oklahoma, West Virginia, and Wyoming]

In witness whereof I hereunto set my hand and official seal this ..... day of ..... , 19...

My Commission Expires: .....

Name: .....

Notary Public in and for ..... County, .....

04/26/2024

ASSIGNMENT AND POWER OF ATTORNEY

This Assignment and Power of Attorney from

GLENN L. HAUGHT & SONS,  
a West Virginia General Partnership

(herein called "Assignor") to Ensource Inc., a Delaware corporation having an office at 5575 DTC Parkway, Englewood, Colorado (herein called "Assignee");

WITNESSETH:

Assignor, for the sum of one dollar (\$1.00) and other valuable consideration, the receipt of which is hereby acknowledged, does by these presents GRANT, BARGAIN, SELL, EXCHANGE, CONVEY, ASSIGN, TRANSFER, SET OVER and DELIVER unto Assignee all of the following:

A. The interests in oil, gas, and other mineral leases, rights and properties and rights to production which are referred to or described in Exhibit A attached hereto and incorporated herein by reference (all of such being referred to as the "properties described" in the following subparagraphs B, C, D and E).

B. All right, title and interest of Assignor derived from all presently existing and valid oil, gas or mineral unitization, pooling, operating and communitization agreements, declarations and orders, and in and to the properties covered and the units created thereby (including all units formed under orders, regulations, rules or other official acts of any federal, state or other governmental agency having jurisdiction), which relate to any of the properties described.

C. All right, title and interest of Assignor in, to or under or by virtue of all presently existing and valid oil and gas sales, purchase, exchange and processing contracts, casinghead gas contracts, operating agreements, joint venture agreements, tax partnerships and other contracts, agreements and instruments (including without limitation, future interests, reversionary rights and deferred interests), which relate to any of the properties described, but only insofar as such contracts, agreements and instruments relate to the properties described.

D. All right, title and interest of Assignor in all personal property, improvements, lease and well equipment, easements, permits, licenses, servitudes and rights-of-way (including, but not by way of limitation, any wells, tanks, boilers, buildings, fixtures, machinery, injection facilities, saltwater disposal facilities, compression facilities and other equipment, gathering system, power lines, telephone and telegraph lines, roads and other appurtenances and easements) now being used in connection with the exploration, development, operation or maintenance of the properties described, or any unit or units in which part or parts of the properties described may be included, or being used in connection with the production, treating, storing, transportation or marketing of oil, gas and other minerals produced from or allocated to properties described or such unit or units.

E. Without limitation of the foregoing, all of Assignor's right, title, interest and estate of every nature and description in and to the properties described or described in any of the leases referred to or described in Exhibit A or included in any unit including any of Assignor's interest in any such lease or land described, even though Assignor's interests therein be incorrectly described in, or a description of such interests be omitted from Exhibit A.

This instrument was prepared by Charles F. Savage, an officer of the Assignee, at the Assignee's above address.

RETURN TO:  
COLE EXPLORATION 04/26/2024  
11777 KATY FREEWAY  
SUITE 540, SOUTH BLDG  
HOUSTON, TEXAS 77079



County of Ritchie (Continued)

850

An undivided 100.00% interest held of record by the Assignor in the following:

| <u>Title No.</u> | <u>Lessor</u>            | <u>Date</u> | <u>Book</u> | <u>Page</u> | <u>Description</u>          |
|------------------|--------------------------|-------------|-------------|-------------|-----------------------------|
|                  | Robert W. Cokeley, et ux | 9-17-74     | 118         | 53          |                             |
|                  | <u>Well or Unit</u>      |             |             |             |                             |
|                  | H-582                    |             |             |             |                             |
|                  |                          |             |             |             | <u>Working Interest</u>     |
|                  |                          |             |             |             | .0800000                    |
|                  |                          |             |             |             | <u>Net Revenue Interest</u> |
|                  |                          |             |             |             | .0678125                    |
|                  | Mildred Stanley, et vir  | 10-4-77     | 124         | 160         |                             |
|                  | <u>Well or Unit</u>      |             |             |             |                             |
|                  | H-583                    |             |             |             |                             |
|                  |                          |             |             |             | <u>Working Interest</u>     |
|                  |                          |             |             |             | .0800000                    |
|                  |                          |             |             |             | <u>Net Revenue Interest</u> |
|                  |                          |             |             |             | .0678125                    |

04/26/2024

Cole Exploration  
11777 Katy Fwy.  
S. Bldg. Suite 840  
Houston, Texas 77079

STATE OF WEST VIRGINIA,

(Form CC No. 1)

Ritchie County Commission Clerk's Office, ----- December 4th -----, 19 81 ----- at 11:05 o'clock A. M.

and Exhibit A attached  
The foregoing writing, with the certificate of acknowledgment/thereto, was this day admitted to record in said office.

Tester: ----- *Sandra B. May* -----, Clerk

Filed and admitted to record in the office  
of the Clerk of the County Commission of Ritchie  
County, W. Va. ----- DEC 4 1981 -----

19 ----- at ----- o'clock ----- A ----- M

Recorded in ----- lease -----

Book No. 139 ----- Page ----- 351 -----

Tester: *Sandra B. May* -----  
Clerk

04/26/2024

ASSIGNMENT AND POWER OF ATTORNEY

This Assignment and Power of Attorney from

A. C. MOORE

(herein called "Assignor") to Ensource Inc., a Delaware corporation having an office at 5575 DTC Parkway, Englewood, Colorado (herein called "Assignee");

WITNESSETH:

Assignor, for the sum of one dollar (\$1.00) and other valuable consideration, the receipt of which is hereby acknowledged, does by these presents GRANT, BARGAIN, SELL, EXCHANGE, CONVEY, ASSIGN, TRANSFER, SET OVER and DELIVER unto Assignee all of the following:

A. The interests in oil, gas, and other mineral leases, rights and properties and rights to production which are referred to or described in Exhibit A attached hereto and incorporated herein by reference (all of such being referred to as the "properties described" in the following subparagraphs B, C, D and E).

B. All right, title and interest of Assignor derived from all presently existing and valid oil, gas or mineral unitization, pooling, operating and communitization agreements, declarations and orders, and in and to the properties covered and the units created thereby (including all units formed under orders, regulations, rules or other official acts of any federal, state or other governmental agency having jurisdiction), which relate to any of the properties described.

C. All right, title and interest of Assignor in, to or under or by virtue of all presently existing and valid oil and gas sales, purchase, exchange and processing contracts, casinghead gas contracts, operating agreements, joint venture agreements, tax partnerships and other contracts, agreements and instruments (including without limitation, future interests, reversionary rights and deferred interests), which relate to any of the properties described, but only insofar as such contracts, agreements and instruments relate to the properties described.

D. All right, title and interest of Assignor in all personal property, improvements, lease and well equipment, easements, permits, licenses, servitudes and rights-of-way (including, but not by way of limitation, any wells, tanks, boilers, buildings, fixtures, machinery, injection facilities, saltwater disposal facilities, compression facilities and other equipment, gathering system, power lines, telephone and telegraph lines, roads and other appurtenances and easements) now being used in connection with the exploration, development, operation or maintenance of the properties described, or any unit or units in which part or parts of the properties described may be included, or being used in connection with the production, treating, storing, transportation or marketing of oil, gas and other minerals produced from or allocated to properties described or such unit or units.

E. Without limitation of the foregoing, all of Assignor's right, title, interest and estate of every nature and description in and to the properties described or described in any of the leases referred to or described in Exhibit A or included in any unit including any of Assignor's interest in any such lease or land described, even though Assignor's interests therein be incorrectly described in, or a description of such interests be omitted from Exhibit A.

This instrument was prepared by Charles F. Savage, an officer of the Assignee, at the Assignee's above address.

04/26/2024  
RETURN TO  
COLE EXPLORATION  
11777 KATY FREEWAY  
SUITE 540. SOUTH BLDG.  
HOUSTON, TEXAS 77079

ACKNOWLEDGMENT FOR SINGLE INDIVIDUAL

STATE OF New York }  
COUNTY OF New York }

I, the undersigned authority, hereby certify that ..... whose name is signed to the foregoing instrument, and who is known to me, acknowledged before me on this day that, being informed of the contents of the instrument, he/she executed the same voluntarily on the day the same bears date. [Alabama]

Before me, the undersigned officer, on this day personally appeared ....., known to me to be the person whose name is subscribed to the within instrument and acknowledged that he/she executed the same for the purposes therein contained. [Arkansas, Pennsylvania, and South Dakota]

On this day, before me, the undersigned authority, personally appeared ....., to me known to be the person who executed the foregoing instrument, and acknowledged that he/she executed the same as his/her free act and deed. [Louisiana]

Personally appeared before me, the undersigned authority, on this day the within named ..... who acknowledged that he/she signed and delivered the foregoing instrument on the day and year therein mentioned. [Mississippi]

On this day, before me, the undersigned authority, personally appeared ....., known to me to be the person whose name is subscribed to the within instrument, and acknowledged to me that he/she executed the same. [Montana]

Before me, the undersigned authority, on this day personally appeared ....., known to me to be the person whose name is subscribed to the foregoing instrument, and acknowledged to me that he/she executed the same for the purpose and consideration therein expressed. [Texas]

On this day, personally appeared before me ....., the signer of the above instrument, who duly acknowledged to me that he/she executed the same. [Utah]

The foregoing instrument was acknowledged before me on this day by A. C. Moore ..... [Colorado, Illinois, Kansas, Michigan, Nebraska, New Mexico, North Dakota, Ohio, Oklahoma, West Virginia, and Wyoming]

In witness whereof I hereunto set my hand and official seal this 29 day of October, 1981.

My Commission Expires:

BETSY SHACK  
Notary Public, State of New York  
No. 21-4544960  
Qualified in New York County  
Commission Expires March 30, 1983

Name: Betsy Shack  
Notary Public in and for New York County, N.Y.



ACKNOWLEDGMENT FOR MARRIED COUPLES

STATE OF ..... }  
COUNTY OF .....

I, the undersigned authority, hereby certify that ..... and ..... whose names are signed to the foregoing instrument, and who are known to me, acknowledged before me on this day that, being informed of the contents of the instrument, they executed the same on the day same bears date. [Alabama]

Before me, the undersigned officer, on this day personally appeared ..... and ..... known to me to be the persons whose names are subscribed to the within instrument and acknowledged that they executed the same for the purposes therein contained. [Arkansas, Pennsylvania, and South Dakota]

On this day, before me, the undersigned authority, personally appeared ..... and ..... to me known to be the persons who executed the foregoing instrument, and acknowledged that they executed the same as their free act and deed. [Louisiana]

Personally appeared before me, the undersigned authority, on this day the within named ..... and ..... who acknowledged that they signed and delivered the foregoing instrument on the day and year therein mentioned. [Mississippi]

On this day, before me, the undersigned authority, personally appeared ..... and ..... known to me to be the persons whose names are subscribed to the within instrument, and acknowledged to me that they executed the same. [Montana]

Before me, the undersigned authority, on this day personally appeared ..... and ..... known to me to be the persons whose names are subscribed to the foregoing instrument, and acknowledged to me that they executed the same for the purpose and consideration therein expressed. [Texas]

On this day, personally appeared before me ..... and ....., the signers of the above instrument, who duly acknowledged to me that they executed the same. [Utah]

The foregoing instrument was acknowledged before me on this day by .. A.. C.. Moore ....., and by ....., his wife. [Colorado, Illinois, Kansas, Michigan, Nebraska, New Mexico, North Dakota, Ohio, Oklahoma, West Virginia, and Wyoming]

In witness whereof I hereunto set my hand and official seal this .... day of ....., 19...

My Commission Expires: .....  
Name: .....  
Notary Public in and for ..... County, .....

04/26/2024

*Perth report  
of Marie Hurley*

ALBRECHT-MOORE and ASSOCIATES, INC.

SHAREHOLDERS RESOLUTION

Whereas, the board of directors have recommended that the corporation should be dissolved and have called a special meeting of the shareholders to consider the matter; and whereas, after the consideration of the statements of the officers of Albrecht-Moore and Associates, Inc. and the statements of the shareholders, it appears to be for the best interests of the shareholders of this corporation that its business should be terminated, the corporation dissolved, and its assets distributed according to law;

Now therefore, the holders of record of two-thirds of all outstanding shares of this corporation entitled to vote thereon concurring therein, it is

RESOLVED, that the shareholders of this corporation hereby and forthwith authorize such dissolution of the corporation, and that pursuant to article 10 of the Business corporation Law of the State of New York, the president and the secretary, or other proper officers, are hereby authorized to execute and file the proper certificate of dissolution with the Secretary of State, and that they and the other officers of this corporation are hereby authorized and directed to take the steps prescribed by law to complete the dissolution and to wind up the affairs of this corporation.

Dated: *6/26/81*

*Robert A. Albrecht* 9/3/81  
*Robert A. Albrecht*  
Robert A. Albrecht, Shareholder

*[Signature]*  
Alvin C. Moore, Jr. Shareholder



PROPERTY ADM. DEPT.

JUL 07 1982

|  |  |
|--|--|
|  |  |
|  |  |
|  |  |

04/26/2024

CERTIFICATE OF DISSOLUTION

OF

ALBRECHT-MOORE AND ASSOCIATES, INC.

UNDER SECTION 1003 OF THE BUSINESS CORPORATION LAW

The undersigned, ALVIN C. MOORE, JR., and ROBERT A. ALBRECHT, being, respectively, the president and secretary of Albrecht-Moore and Associates, Inc. do hereby certify and set forth:

1. The name of the corporation is Albrecht-Moore and Associates
2. The certificate of incorporation of Albrecht-Moore and Associates, Inc. was filed by the Department of State on the 19th day of September, 1975.
3. The name and address of each of the officers and directors are as follows:

|            |                                 |                                         |
|------------|---------------------------------|-----------------------------------------|
| OFFICERS:  | Alvin C. Moore, Jr., President, | 1725 York Avenue<br>New York, NY 10028  |
|            | Robert A. Albrecht, Secretary,  | 444 East 86th St.<br>New York, NY 10028 |
| DIRECTORS: | Alvin C. Moore, Jr.,            | 1725 York Avenue<br>New York, NY 10028  |
|            | Robert A. Albrecht,             | 444 East 86th St.<br>New York, NY 10028 |

04/26/2024

4. Albrecht-Moore and Associates, Inc. hereby elects to dissove.
5. The dissolution of Albrecht-Moore and Associates, Inc. was authorized at a meeting of the shareholders by the vote of the holders of two thirds of all outstanding shares entitled to votes thereon.

IN WITNESS WHEREOF, the undersigned have executed and signed this certificate this 26 day of June, 1981.

  
 \_\_\_\_\_  
 ALVIN C. MOORE, JR., President and shareholder

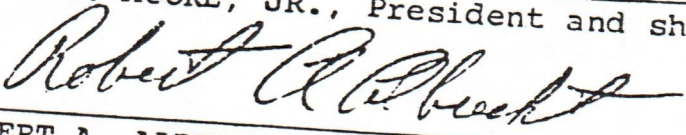
  
 \_\_\_\_\_  
 ROBERT A. ALBRECHT, Secretary and shareholder  
 9/7/81

State of New York, County of New York ss.:

Alvin C. Moore, Jr., being duly sworn deposes and says: deponent is President and shareholder of Albrecht-Moore and Associates, Inc.; deponent has read foregoing Certificate of Dissolution and knows the contents thereof; the same is true to deponent's own knowledge.

Sworn to before me  
 this 26<sup>th</sup> day of June, 1981

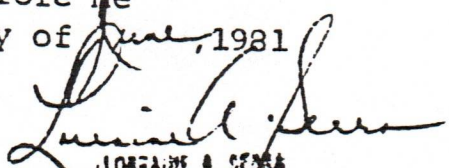
  
 LORRAINE A. SENEK  
 Notary Public, State of New York  
 No. 41-4731593  
 Qualification in Jackson County  
 Certificate Filed in New York County  
 Commission Expires March 30, 1983

  
 \_\_\_\_\_  
 ALVIN C. MOORE, JR.





LATITUDE  $39^{\circ} 15' 00''$   
 LONGITUDE  $81^{\circ} 05' 00''$   
 2100'  
 14,900'

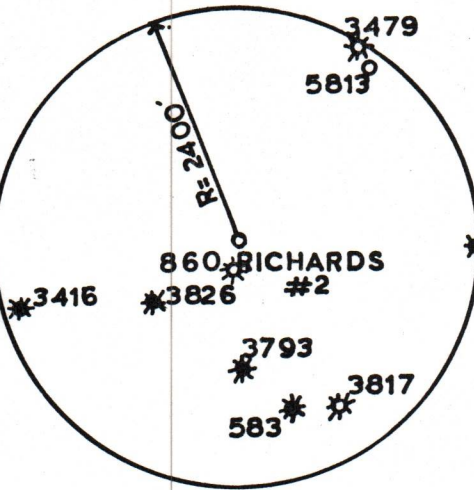
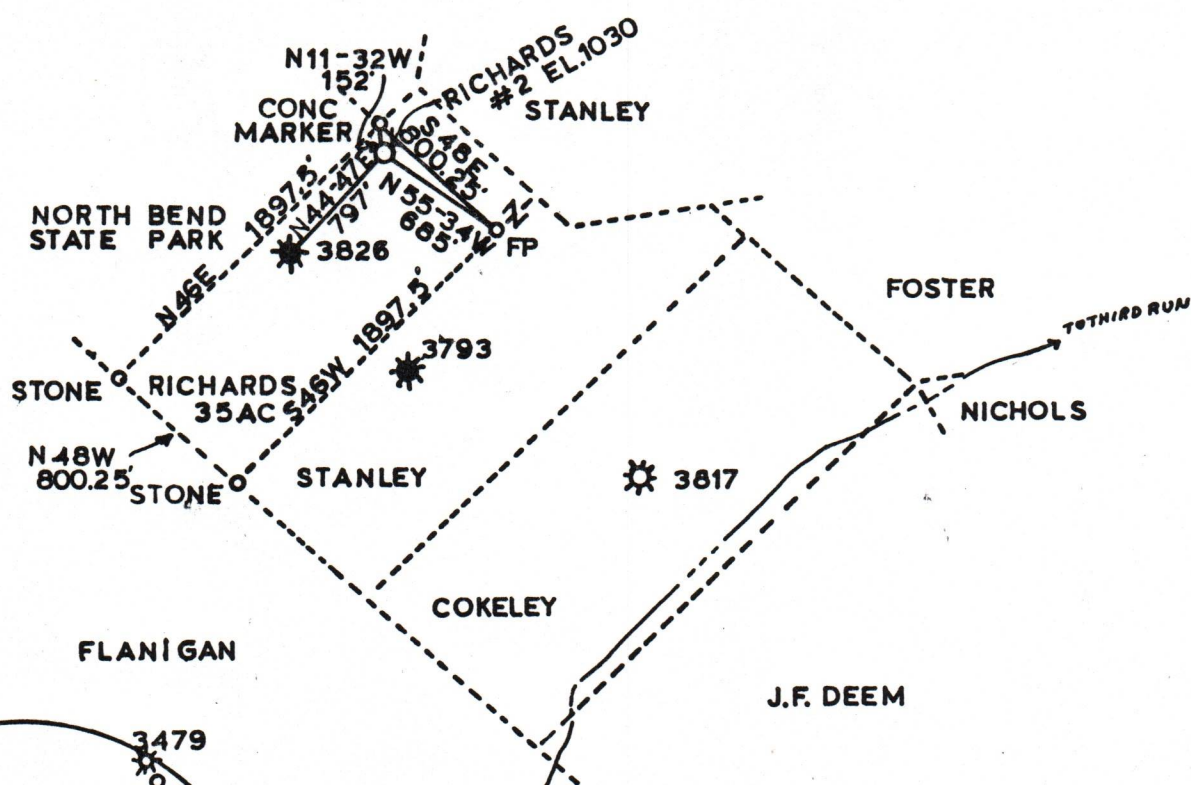

RICHARDS # 2  
7.5' QUAD LOCATION

FILE NO. \_\_\_\_\_  
 DRAWING NO. \_\_\_\_\_  
 SCALE  $1" = 1000'$   
 MINIMUM DEGREE OF ACCURACY  $1:200$   
 PROVEN SOURCE OF ELEVATION HIGH POINT  
EL 1077

I THE UNDERSIGNED, HEREBY CERTIFY THAT THIS PLAT IS CORRECT TO THE BEST OF MY KNOWLEDGE AND BELIEF AND SHOWS ALL THE INFORMATION REQUIRED BY LAW AND THE REGULATIONS ISSUED AND PRESCRIBED BY THE DEPARTMENT OF MINES.  
 (SIGNED) Burl J. Smith  
 R.P.E. 6988 L.L.S. \_\_\_\_\_

PLACE SEAL HERE

STATE OF WEST VIRGINIA  
 DEPARTMENT OF MINES  
 OIL AND GAS DIVISION



DATE JUNE 10, 19 83  
 OPERATOR'S WELL NO. RICHARDS #2  
 API WELL NO. \_\_\_\_\_

47 - 085 - 6628  
 STATE COUNTY PERMIT   
corrected Plat

(+) DENOTES LOCATION OF WELL ON UNITED STATES TOPOGRAPHIC MAPS  
 WELL TYPE: OIL  GAS  LIQUID INJECTION \_\_\_\_\_ WASTE DISPOSAL \_\_\_\_\_  
 (IF "GAS,") PRODUCTION \_\_\_\_\_ STORAGE \_\_\_\_\_ DEEP \_\_\_\_\_ SHALLOW   
 LOCATION: ELEVATION 1030 WATER SHED THIRD RUN  
 DISTRICT GRANT COUNTY RITCHIE  
 QUADRANGLE HARRISVILLE

SURFACE OWNER RUSSELLE E. RICHARDS ET UX ACREAGE 35 AC  
 OIL & GAS ROYALTY OWNER R.E. RICHARDSET UX & MV. STANLEY ET AL LEASE ACREAGE 35AC

PROPOSED WORK: DRILL  CONVERT \_\_\_\_\_ DRILL DEEPER \_\_\_\_\_ REDRILL \_\_\_\_\_ FRACTURE OR STIMULATE \_\_\_\_\_ PLUG OFF OLD FORMATION \_\_\_\_\_ PERFORATE NEW FORMATION \_\_\_\_\_ OTHER PHYSICAL CHANGE IN WELL (SPECIFY) \_\_\_\_\_

PLUG AND ABANDON \_\_\_\_\_ CLEAN OUT AND REPLUG \_\_\_\_\_  
 TARGET FORMATION DEVONIAN SHALE ESTIMATED DEPTH 5500'  
 WELL OPERATOR ENSOURCE INC. DESIGNATED AGENT MIKE NUGEN  
 ADDRESS P.O. DRAWER 1738 ADDRESS P.O. DRAWER 1738  
CLARKSBURG WV 26301 CLARKSBURG WV 26301

04/26/2024

R.T. 6628