

W. HARPER LEASE
98 ACERS ±
HARPER #2
A.P.I. #47-085-6764

NOTES ON SURVEY

1. TIES TO WELLS & CORNERS ARE BASED ON GRID NORTH FOR THE WV STATE PLANE COORDINATE SYSTEM NORTH ZONE NAD '27.
2. LEASE BOUNDARY SHOWN HEREON TAKEN FROM DEED BOOK 293 PAGE 195.
3. SURFACE OWNER AND ADJOINER INFORMATION TAKEN FROM THE ASSESSOR AND COUNTY CLERK RECORDS OF RITCHIE COUNTY IN MAY, 2011.
4. WELL LAT./LONG. (NAD'27) ESTABLISHED BY DGPS(SUBMETER MAPPING GRADE).

WELL NO. 2
A.P.I. # 47-085-6764
STATE PLANE COORDINATES
NORTH ZONE (NAD 27)
 N. 287,465
 E. 1,518,701
 LAT=(N) 39.276755
 LONG=(W) 81.200251
UTM (NAD 83)(METERS)
 N. 4,347,517
 E. 482,742



I THE UNDERSIGNED, HEREBY CERTIFY THAT THIS PLAT IS CORRECT TO THE BEST OF MY KNOWLEDGE AND BELIEF AND SHOWS ALL THE INFORMATION REQUIRED BY LAW AND THE REGULATIONS ISSUED AND PRESCRIBED BY THE DIVISION OF ENVIRONMENTAL PROTECTION.

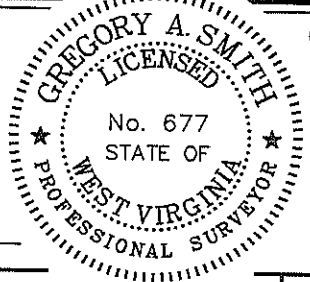

(+) DENOTES LOCATION OF WELL ON UNITED STATES TOPOGRAPHIC MAPS.
 DATE MAY 8, 20 12
 OPERATORS WELL NO. HARPER #2
 API WELL NO. 47 - 085 - 06764

P.S. 677

MINIMUM DEGREE OF ACCURACY 1 / 200 FILE NO. 7845P1 (407-51)
 PROVEN SOURCE OF ELEVATION DGPS (SUBMETER MAPPING GRADE) SCALE 1" = 500'

STATE OF WEST VIRGINIA
 DIVISION OF ENVIRONMENTAL PROTECTION
 OFFICE OF OIL AND GAS



WELL TYPE: OIL GAS LIQUID INJECTION WASTE DISPOSAL IF "GAS" PRODUCTION STORAGE DEEP SHALLOW

LOCATION: ELEVATION 1135' WATERSHED TRIBUTARY OF GOOSE CREEK
 DISTRICT GRANT COUNTY RITCHIE QUADRANGLE SCHULTZ 7.5'
 SURFACE OWNER ROBERT L. RUDOLPH II MD & NANNETTE RUDOLPH ACREAGE 102.335±
 ROYALTY OWNER C. KELLY ET AL ACREAGE 98±

PROPOSED WORK: LEASE NO. _____
 DRILL CONVERT DRILL DEEPER REDRILL FRACTURE OR STIMULATE PLUG OFF OLD FORMATION PERFORATE NEW FORMATION PLUG AND ABANDON CLEAN OUT AND REPLUG OTHER _____
 PHYSICAL CHANGE IN WELL (SPECIFY) _____ TARGET FORMATION SQUAW
 ESTIMATED DEPTH 2056'

WELL OPERATOR SCHULTZ RUN GAS COMPANY DESIGNATED AGENT PETE PAULEY
 ADDRESS 300 CAPITOL STREET, SUITE 1500 ADDRESS 300 CAPITOL STREET, SUITE 1500
CHARLESTON, WV 25301 CHARLESTON, WV 25301

LONGITUDE 81° 10' 00"

COUNTY NAME

PERMIT

W. HARPER LEASE HARPER #2 47-085-6764

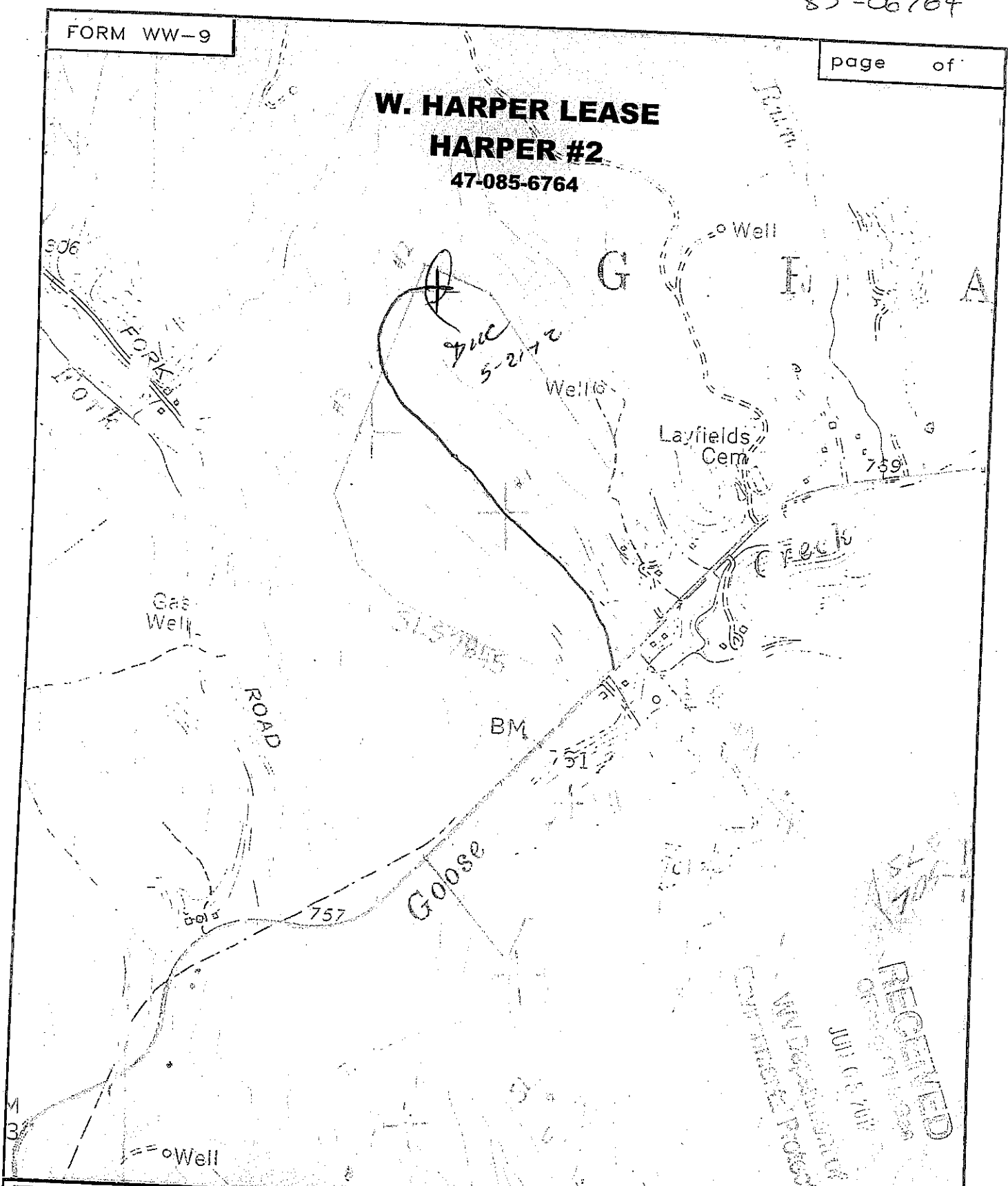

SLS
SMITH LAND SURVEYING
 P.O. BOX 150 GLENVILLE, WV. 26351

TOPO SECTION OF SCHULTZ 7.5'
 FILE NO. 7845 DATE 5/8/12 SCALE 1"=1000'