

WW-7
8-30-06



West Virginia Department of Environmental Protection
Office of Oil and Gas
WELL LOCATION FORM: GPS

API: 47-085-09172 WELL NO.: 3

FARM NAME: Mary Shanley

RESPONSIBLE PARTY NAME: Hall Drilling, LLC

COUNTY: Ritchie DISTRICT: Clay

QUADRANGLE: Ellenboro 7.5'

SURFACE OWNER: Tech Service Center

ROYALTY OWNER: Tech Service Center

UTM GPS NORTHING: 4,348,277 (941.4')

UTM GPS EASTING: 498,646 GPS ELEVATION: 287 m.

The Responsible Party named above has chosen to submit GPS coordinates in lieu of preparing a new well location plat for a plugging permit or assigned API number on the above well. The Office of Oil and Gas will not accept GPS coordinates that do not meet the following requirements:

1. Datum: NAD 1983, Zone: 17 North, Coordinate Units: meters, Altitude: height above mean sea level (MSL) – meters.
2. Accuracy to Datum – 3.05 meters
3. Data Collection Method:

Survey grade GPS : Post Processed Differential

Real-Time Differential

Mapping Grade GPS : Post Processed Differential

Real-Time Differential

4. Letter size copy of the topography map showing the well location.

I the undersigned, hereby certify this data is correct to the best of my knowledge and belief and shows all the information required by law and the regulations issued and prescribed by the Office of Oil and Gas.

MT Hall
Signature

Designated Agt.
Title

11-14-17
Date

RECEIVED
Office of Oil and Gas
NOV 15 2017
WV Department of
Environmental Protection

SUBJECT WELL
Mary Shanley No.3
47-085-09172

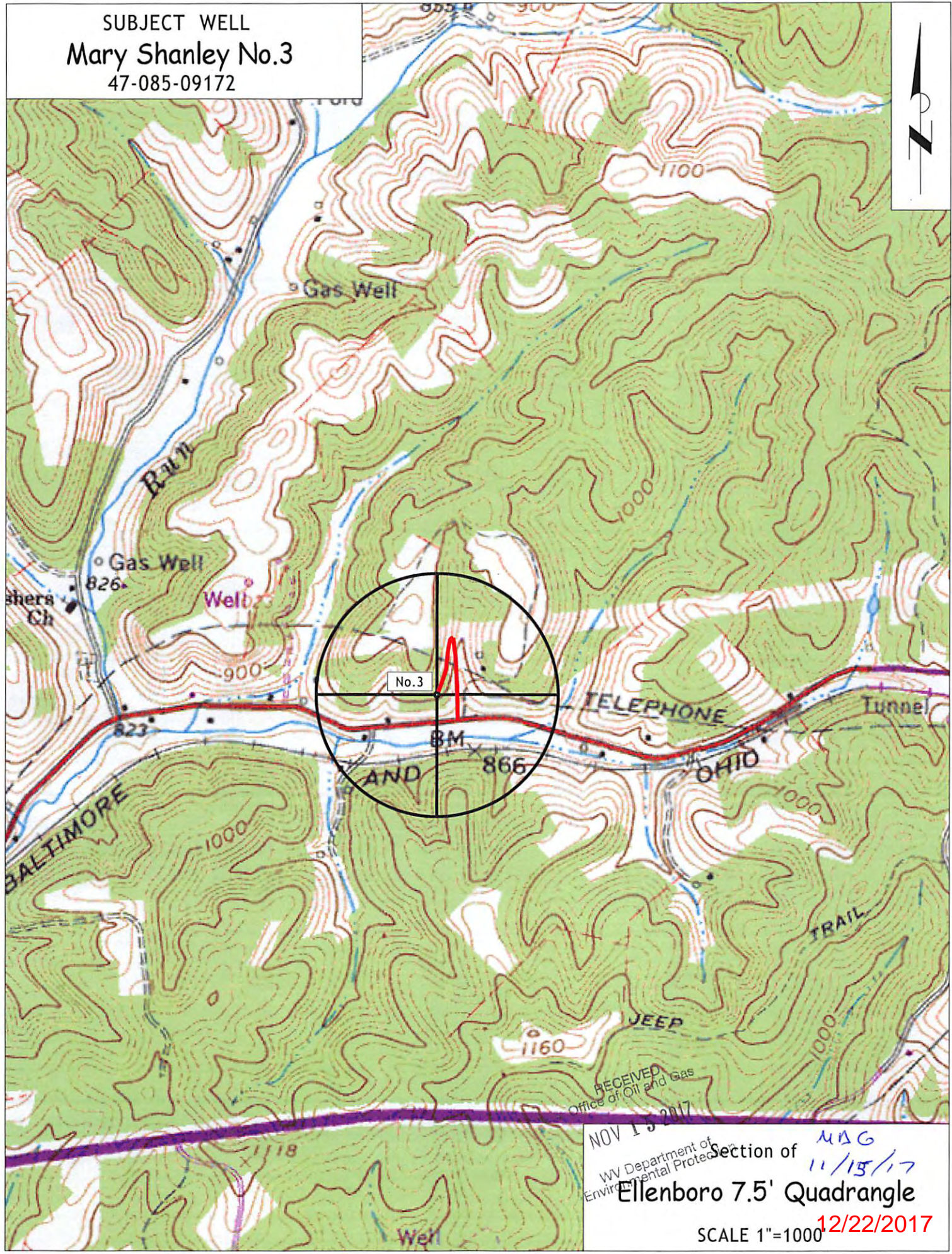

RECEIVED
Office of Oil and Gas

NOV 15 2017

Section of
WV Department of Environmental Protection
Ellenboro 7.5' Quadrangle

MAG
11/15/17

SCALE 1"=1000
12/22/2017