

I THE UNDERSIGNED, HEREBY CERTIFY THAT THIS PLAT IS CORRECT TO THE BEST OF MY KNOWLEDGE AND BELIEF AND SHOWS ALL THE INFORMATION REQUIRED BY LAW AND THE REGULATIONS ISSUED AND PRESCRIBED BY THE DIVISION OF ENVIRONMENTAL PROTECTION.

P.S. 677 *Gregory A. Smith*

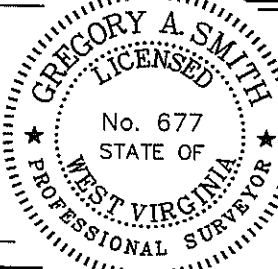

(+) DENOTES LOCATION OF WELL ON UNITED STATES TOPOGRAPHIC MAPS.  
 DATE MAY 10, 20 12  
 OPERATORS WELL NO. J. SMITH #6  
 API WELL NO. 47 - 085 - 09976

MINIMUM DEGREE OF ACCURACY 1/200 FILE NO. 6637P6 (407-53)  
 PROVEN SOURCE OF ELEVATION DGPS (SUBMETER MAPPING GRADE) SCALE 1" = 500'

STATE OF WEST VIRGINIA  
 DIVISION OF ENVIRONMENTAL PROTECTION  
 OFFICE OF OIL AND GAS

WELL TYPE: OIL  GAS  LIQUID INJECTION  WASTE DISPOSAL  IF "GAS" PRODUCTION  STORAGE  DEEP  SHALLOW

LOCATION: ELEVATION 838' WATERSHED GOOSE CREEK  
 DISTRICT GRANT COUNTY RITCHIE QUADRANGLE CAIRO 7.5'

SURFACE OWNER CHRISTINA O. SMITH (LIFE) ACREAGE 157.63±  
 ROYALTY OWNER NORMA SMITH ET AL ACREAGE 157±

PROPOSED WORK: LEASE NO. \_\_\_\_\_  
 DRILL  CONVERT  DRILL DEEPER  REDRILL  FRACTURE OR STIMULATE  PLUG OFF OLD FORMATION  PERFORATE NEW FORMATION  PLUG AND ABANDON  CLEAN OUT AND REPLUG  OTHER \_\_\_\_\_  
 PHYSICAL CHANGE IN WELL (SPECIFY) \_\_\_\_\_ TARGET FORMATION COW RUN  
 ESTIMATED DEPTH 1100'

WELL OPERATOR SCHULTZ RUN GAS COMPANY DESIGNATED AGENT PETE PAULEY  
 ADDRESS 300 CAPITOL STREET, SUITE 1500 ADDRESS 300 CAPITOL STREET, SUITE 1500  
CHARLESTON, WV 25301 CHARLESTON, WV 25301

# J.A. SMITH LEASE J. SMITH #6

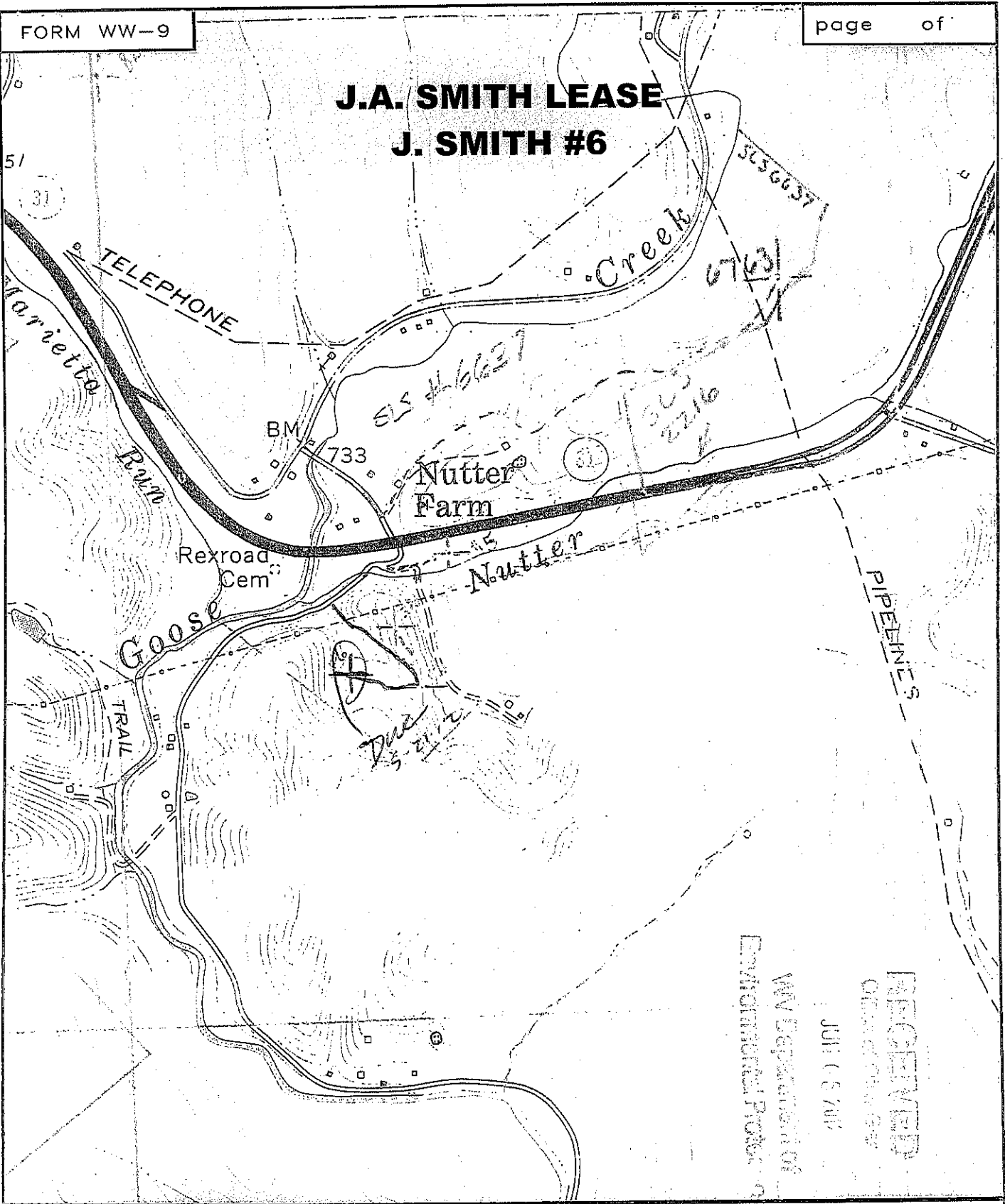

RECEIVED  
 CIVIL ENGINEERING  
 JUL 16 8 AM  
 WV Department of  
 Environmental Protection

**SLS**  
 SMITH LAND SURVEYING  
 P.O. BOX 150 GLENVILLE, WV. 26351

TOPO SECTION OF CAIRO 7.5'  
 FILE NO. 6637 DATE 5/10/12 SCALE 1"=1000'