

NOTES ON SURVEY

1. TIES TO WELLS, CORNERS AND REFERENCES ARE BASED ON GRID NORTH FOR THE WV STATE PLANE COORDINATE SYSTEM NORTH ZONE NAD '27.
2. WELL LAT./LONG. (NAD'27) ESTABLISHED BY DGPS(SURVEY GRADE TIE TO CORS NETWORK).
3. NO WATER WELLS WERE FOUND WITHIN 250 FEET OF PROPOSED GAS WELL. NO AGRICULTURAL BUILDINGS (GREATER THAN 2500 SQUARE FEET) OR DWELLINGS WERE FOUND WITHIN 625 FEET OF CENTER OF PROPOSED WELL PAD.

**EQT PRODUCTION COMPANY
TAYLOR LEASE
1,600 ACRES±
WELL NO. WV 515279**

(S.P.C. NORTH ZONE) (UTM(M) ZONE 17 NORTH)

NAD'27 S.P.C.(FT)	N. 280,830.2	E. 1,589,003.4
NAD'27 GEO.	LAT-(N) 39.261928	LONG-(W) 80.951567
NAD'83 UTM (M)	N. 4,345,853.8	E. 504,193.0
LANDING POINT		
NAD'27 S.P.C.(FT)	N. 280,507.8	E. 1,587,371.2
NAD'27 GEO.	LAT-(N) 39.260971	LONG-(W) 80.957313
NAD'83 UTM (M)	N. 4,345,747.2	E. 503,897.3
BOTTOM HOLE		
NAD'27 S.P.C.(FT)	N. 283,244.8	E. 1,586,094.9
NAD'27 GEO.	LAT-(N) 39.268428	LONG-(W) 80.961977
NAD'83 UTM (M)	N. 4,346,574.6	E. 503,294.6

A	DENNIS & KAREN BURCH	1.93 AC±	TM 30-5.9
B	MAYNARD F HARRIS ET AL	15.1 AC±	TM 30-5.2
C	ELDWYN J. MCKINNEY	0.97 AC±	TM 30-5.7
D	HARLAN H. WYERS ET AL	0.97 AC±	TM 30-5.8
E	JODY M. DEVERICKS ET AL	7 AC±	TM 30-5.10

REFERENCES

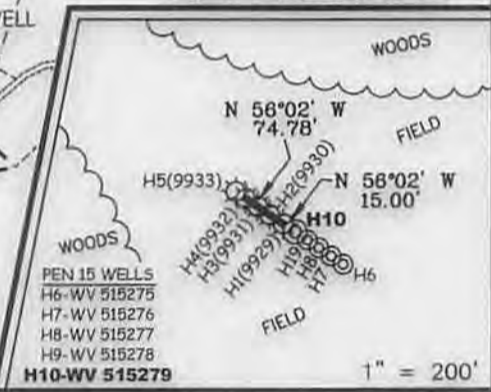

Professional Energy Consultants
A DIVISION OF SMITH LAND SURVEYING, INC.
SLS
SURVEYORS
ENGINEERS
ENVIRONMENTAL
PROJECT MGMT.
1264-422-5634
WWW.SLSURVEYS.COM



I THE UNDERSIGNED, HEREBY CERTIFY THAT THIS PLAT IS CORRECT TO THE BEST OF MY KNOWLEDGE AND BELIEF AND SHOWS ALL THE INFORMATION REQUIRED BY LAW AND THE REGULATIONS ISSUED AND PRESCRIBED BY THE DIVISION OF ENVIRONMENTAL PROTECTION.

P.S. 677
Gregory A. Smith

(*) DENOTES LOCATION OF WELL ON UNITED STATES TOPOGRAPHIC MAPS.
DATE JANUARY 10 20 14
REVISED _____ 20 _____
OPERATORS WELL NO. WV 515279
API WELL NO. 47 - 85 - 10097H6A
STATE COUNTY PERMIT

MINIMUM DEGREE OF ACCURACY 1/200 FILE NO. 7496P515279
PROVEN SOURCE OF ELEVATION DGPS (SUVERY GRADE TIE TO CORS NETWORK) SCALE 1" = 1000'

STATE OF WEST VIRGINIA
DIVISION OF ENVIRONMENTAL PROTECTION
OFFICE OF OIL AND GAS

WELL TYPE: OIL ___ GAS X LIQUID INJECTION ___ WASTE DISPOSAL ___ IF "GAS" PRODUCTION X STORAGE ___ DEEP ___ SHALLOW X

LOCATION:
ELEVATION 1,119' (PAD ELEVATION) WATERSHED LONG RUN OF NORTH FORK HUGHES RIVER
DISTRICT CLAY COUNTY RITCHIE QUADRANGLE PENNSBORO 7.5'

SURFACE OWNER DEWAYNE BRITTON ET UX ACREAGE 140.421
ROYALTY OWNER E. R. TAYLOR HEIRS ACREAGE 1,600±

PROPOSED WORK:
DRILL X CONVERT ___ DRILL DEEPER ___ REDRILL ___ FRACTURE OR STIMULATE X PLUG OFF OLD
FORMATION ___ PERFORATE NEW FORMATION ___ PLUG AND ABANDON ___ CLEAN OUT AND REPLUG ___ OTHER ___
PHYSICAL CHANGE IN WELL (SPECIFY) _____ TARGET FORMATION MARCELLUS
ESTIMATED DEPTH 6395 TWD

WELL OPERATOR EQT PRODUCTION COMPANY DESIGNATED AGENT REX C. RAY
ADDRESS 115 PROFESSIONAL PLACE P.O. BOX 280 BRIDGEPORT, WV 26330 ADDRESS 115 PROFESSIONAL PLACE BRIDGEPORT, WV 26330

05/23/2014

TAYLOR LEASE PEN 15
WV 515275, WV 515276, WV 515277
WV 515278 & WV 515279 WELL PAD

4708510097

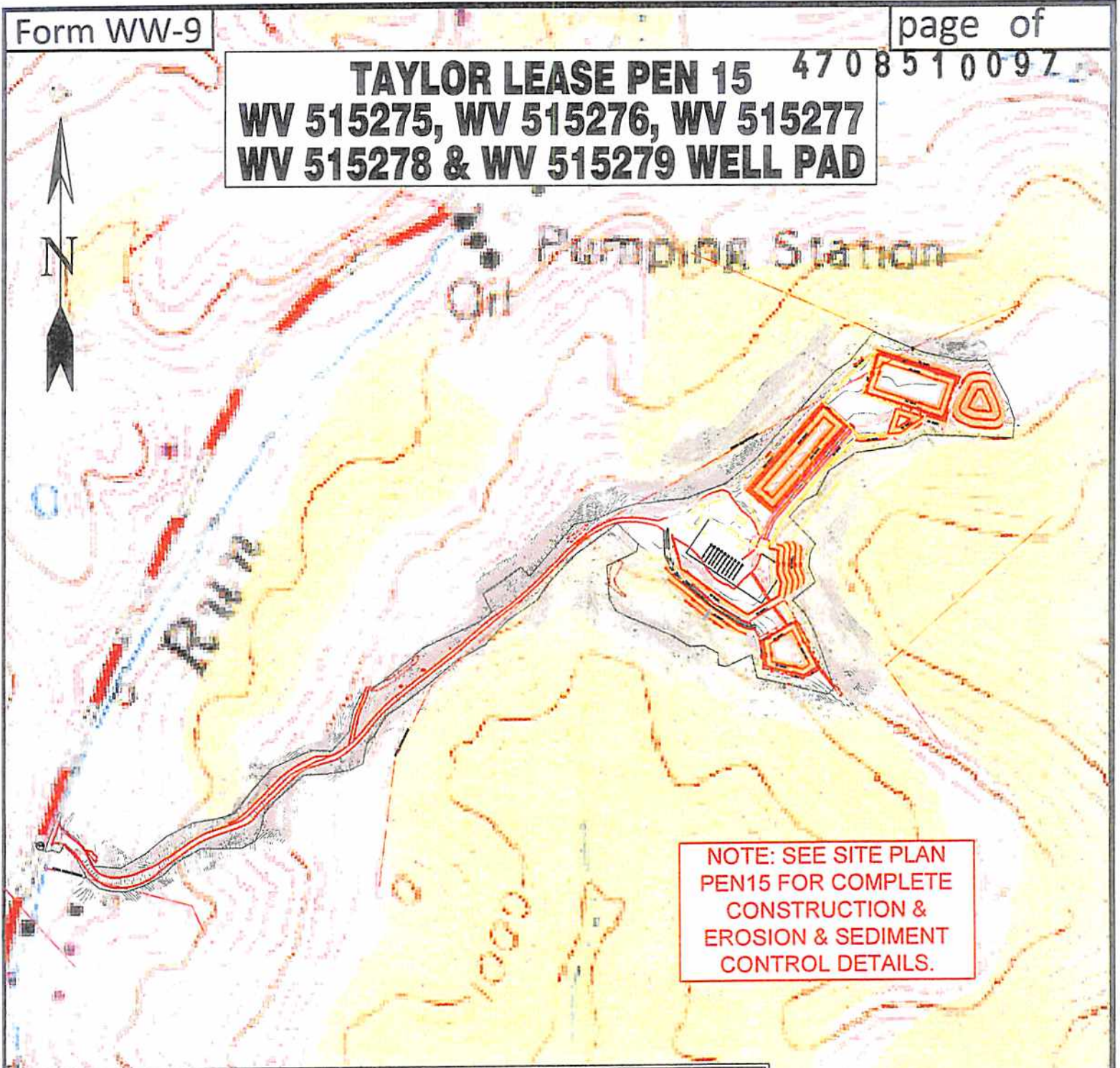

**NOTE: SEE SITE PLAN
PEN15 FOR COMPLETE
CONSTRUCTION &
EROSION & SEDIMENT
CONTROL DETAILS.**

Detail Sketch for Proposed PEN15 WV 515275,
WV 515276, WV 515277, WV 515278 & WV 515279

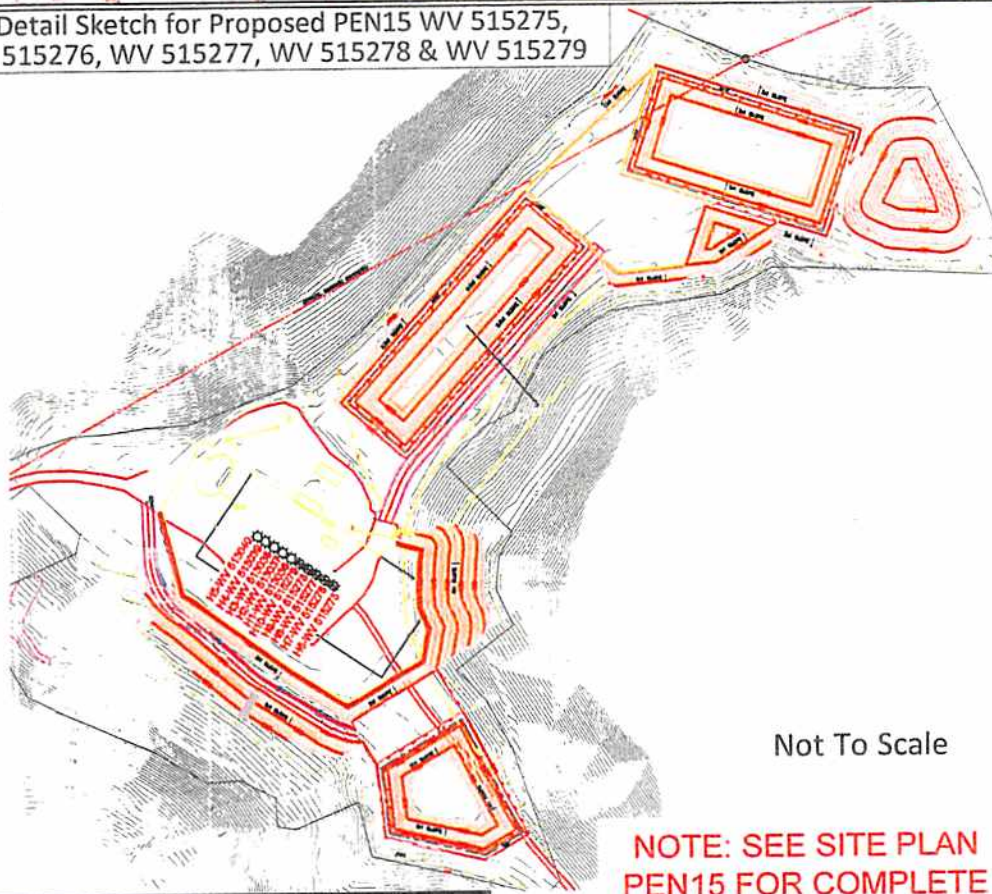

Not To Scale

**NOTE: SEE SITE PLAN
PEN15 FOR COMPLETE
CONSTRUCTION &
EROSION & SEDIMENT
CONTROL DETAILS.**

RECEIVED
Office of Oil and Gas
MAY 23 2014
SCALE: 1" = 500'
0' 500' 1000'

Professional Energy Consultants
DIVISION OF EARTH/LAND SURVEYING, INC.



**SURVEYORS
ENGINEERS
ENVIRONMENTAL
PROJECT MGMT.**

(304) 462-5634 WWW.SLSSURVEYS.COM

DRAWN BY K.D.W.	FILE NO. 7496	DATE 01-31-14	CADD FILE: 7496REC-PEN15.dwg
--------------------	------------------	------------------	---------------------------------

TOPO SECTION OF PENNSBORO 7.5'
USGS TOPO QUADRANGLE

05/23/2014