

A	JERRY MORTON ET AL	243.50 AC±	TM 31-05
B	JUDITH & JO ANN ROBINSON	106.265 AC±	TM 31-22
C	JANICE WILLIAMS	1.715 AC±	
D	JANICE WILLIAMS	111.876 AC±	
E	EQT PRODUCTION COMPANY	46.63 AC±	
F	WILLIAM & JANET BROADWATER	37.565 AC±	
G	WILLIAM & JANET BROADWATER	107 AC±	

**EQT PRODUCTION COMPANY
FLANAGAN LEASE**

**268 ACRES±
WELL NO. WV 514478**

(S.P.C. NORTH ZONE) (UTM(M) ZONE 17 NORTH)

NAD'27 S.P.C. (FT)	N. 279,160.90	E. 1,595,800.41
NAD'27 GEO.	LAT-(N) 39.257645	LONG-(W) 80.927472
NAD'83 UTM (M)	N. 4,345,379.86	E. 506,272.12

LANDING POINT

NAD'27 S.P.C. (FT)	N. 278,723.68	E. 1,594,908.79
NAD'27 GEO.	LAT-(N) 39.256406	LONG-(W) 80.930596
NAD'83 UTM (M)	N. 4,345,242.12	E. 506,002.71

BOTTOM HOLE

NAD'27 S.P.C. (FT)	N. 281,700.48	E. 1,593,941.56
NAD'27 GEO.	LAT-(N) 39.264535	LONG-(W) 80.934179
NAD'83 UTM (M)	N. 4,346,144.07	E. 505,892.91

LEGEND

LEASE LINE	---
SURFACE LINE	----
WELL LATERAL	-----
OFFSET LINE	-----
TIE LINE	-----
CREEK	~~~~~
ROAD	=====
RAIL ROAD	=====
COUNTY ROUTE	=====
STATE ROUTE	=====
PROPOSED WELL	⊙
EXISTING WELL	⊙
PERMITTED WELL	⊙
TAX MAP-PARCEL	TM 00-00

ROYALTY OWNERS

MARY LEE AZELVANDRE ET AL	500 AC±	LEASE NO. 114193
---------------------------	---------	------------------

NOTES ON SURVEY

- NO WATER WELLS WERE FOUND WITHIN 250' OF PROPOSED GAS WELL. NO AGRICULTURAL BUILDINGS ≥ 2500 SQ. FT. OR DWELLINGS WERE FOUND WITHIN 625' OF THE CENTER OF PROPOSED WELL PAD.

REFERENCES

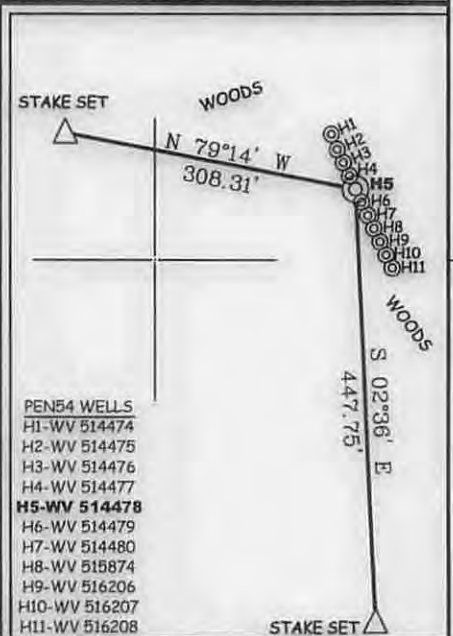

(+) DENOTES LOCATION OF WELL ON UNITED STATES TOPOGRAPHIC MAPS.

DATE JUNE 25 , 20 15

REVISED _____ , 20 _____

OPERATORS WELL NO. WV 514478

API WELL NO. 47 - 085 - 10228

STATE COUNTY PERMIT



I THE UNDERSIGNED, HEREBY CERTIFY THAT THIS PLAT IS CORRECT TO THE BEST OF MY KNOWLEDGE AND BELIEF AND SHOWS ALL THE INFORMATION REQUIRED BY LAW AND THE REGULATIONS ISSUED AND PRESCRIBED BY THE DIVISION OF ENVIRONMENTAL PROTECTION.

P.S. 677 *Gregory A. Smith*



MINIMUM DEGREE OF ACCURACY 1/200 FILE NO. 8083P514478

HORIZONTAL & VERTICAL CONTROL DETERMINED BY DGPS (SURVEY GRADE TIE TO CORS NETWORK) SCALE 1" = 2000'

STATE OF WEST VIRGINIA
DIVISION OF ENVIRONMENTAL PROTECTION
OFFICE OF OIL AND GAS

WELL TYPE:	OIL <input type="checkbox"/>	GAS <input checked="" type="checkbox"/>	LIQUID INJECTION <input type="checkbox"/>	WASTE DISPOSAL <input type="checkbox"/>	IF "GAS" PRODUCTION <input checked="" type="checkbox"/>	STORAGE <input type="checkbox"/>	DEEP <input type="checkbox"/>	SHALLOW <input checked="" type="checkbox"/>	
LOCATION:	GROUND PROPOSED								
ELEVATION:	<u>1,016'</u>	<u>1,016'</u>							
DISTRICT:	<u>CLAY</u>	COUNTY:	<u>RITCHIE</u>	QUADRANGLE:	<u>PENNSBORO 7.5'</u>				
SURFACE OWNER:	<u>JERRY MORTON ET AL</u>			ACREAGE:	<u>243.50±</u>				
ROYALTY OWNER:	<u>ELLEN S. FRANCAVIGLIA ET AL</u>			ACREAGE:	<u>268±</u>				
PROPOSED WORK:				LEASE NO.:	<u>105403</u>				
DRILL <input checked="" type="checkbox"/>	CONVERT <input type="checkbox"/>	DRILL DEEPER <input type="checkbox"/>	REDRILL <input type="checkbox"/>	FRACTURE OR STIMULATE <input checked="" type="checkbox"/>	PLUG OFF OLD FORMATION <input type="checkbox"/>	PERFORATE NEW FORMATION <input type="checkbox"/>	PLUG AND ABANDON <input type="checkbox"/>	CLEAN OUT AND REPLUG <input type="checkbox"/>	OTHER <input type="checkbox"/>
PHYSICAL CHANGE IN WELL (SPECIFY)				TARGET FORMATION:	<u>MARCELLUS</u>				
				ESTIMATED DEPTH:	<u>TVD 6,275'</u>				

WELL OPERATOR EQT PRODUCTION COMPANY DESIGNATED AGENT REX C. RAY

ADDRESS 115 PROFESSIONAL PLACE P.O. BOX 280 BRIDGEPORT, WV 26330 ADDRESS 115 PROFESSIONAL PLACE P.O. BOX 280 BRIDGEPORT, WV 26330

COUNTY NAME
PERMIT

08/21/2015

WATER SOURCE LOCATIONS FOR FLANAGAN LEASE PEN54 WELLS

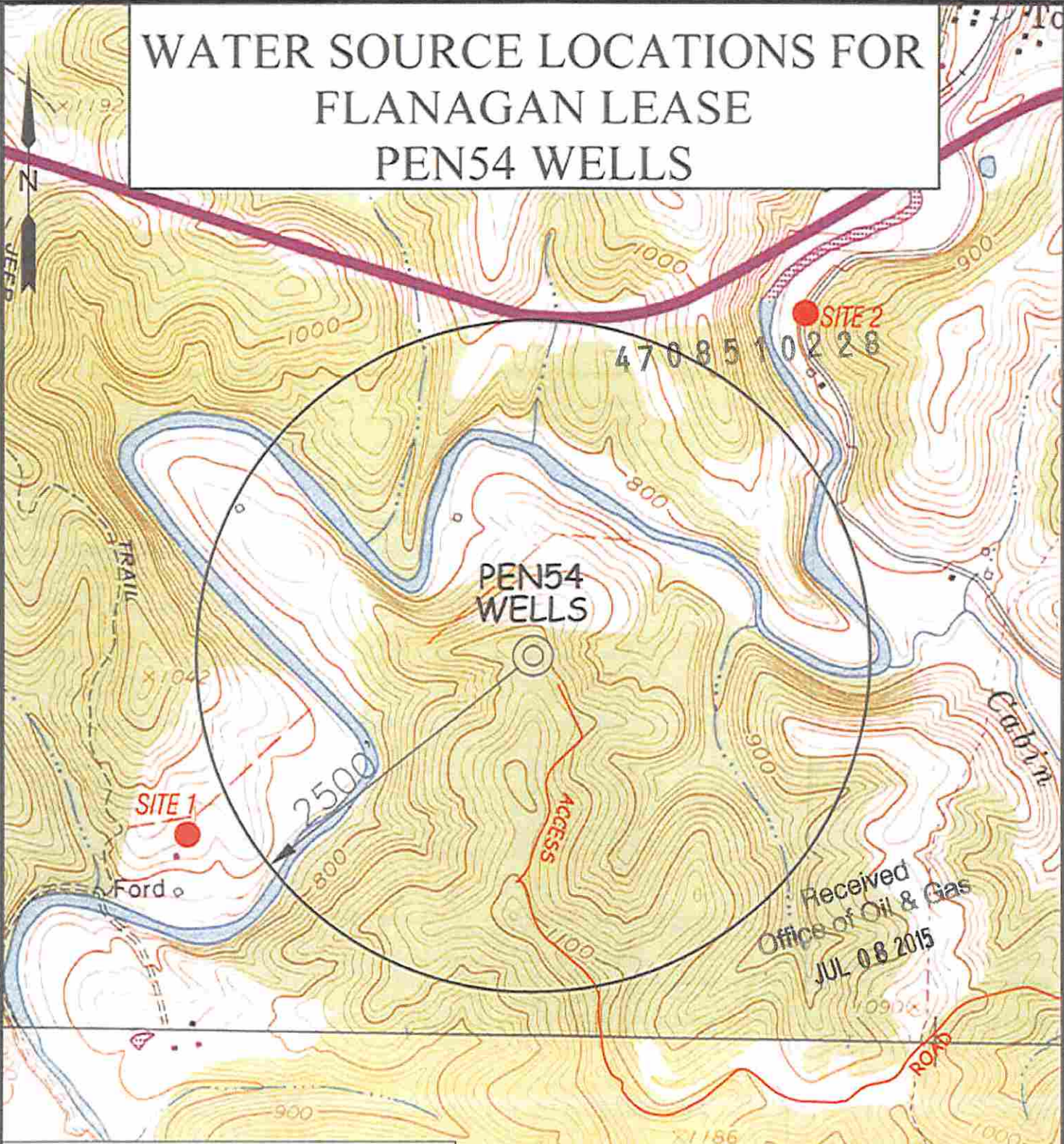

SCALE: 1-INCH=1000-FEET



LEGEND
● WATER WELL

Professional Energy Consultants
A DIVISION OF SATHURDAY SURVEYING, INC.

 SURVEYORS
 ENGINEERS
 ENVIRONMENTAL
 PROJECT MANAGERS

TOPO SECTION OF:
 PENNSBORO, WV 7.5' QUAD

DISTRICT	COUNTY	TAX MAP-PARCEL NO.
CLAY	RITCHIE	31-09

OPERATOR:
EQT PRODUCTION COMPANY
 115 PROFESSIONAL PLACE
 P.O. BOX 280
 BRIDGEPORT, WV 26308

08/21/2015

DRAWN BY K.D.W.	FILE NO. 8083	DATE 06/02/15	CADD FILE: 008265D054.dwg
--------------------	------------------	------------------	------------------------------