

EQT PRODUCTION COMPANY
WELL NO. 516212 - Ashley E. Ness, Jr. et al
PAGE 2 OF 2

LATITUDE 39°32'30" TH 5324'
LATITUDE 39°32'30" BH 2740'

LONGITUDE 80°55'00" BH 10,343'
LONGITUDE 80°55'00" TH 5441'

NOTES

1. THERE ARE NO WATER WELLS OR DEVELOPED SPRINGS WITHIN 250' OF THE PROPOSED WELL.
2. PERENNIAL STREAM, WETLAND, POND, RESERVOIR OR LAKE - THERE ARE WETLANDS LOCATED WITHIN 100 FEET OF THE PROPOSED PAD, LOD, OR E&S CONTROL. REFER TO WETLAND WAIVER REQUEST ASSOCIATED WITH THIS PERMIT APPLICATION FOR MORE DETAIL.
3. THERE ARE NO NATIVE TROUT STREAMS WITHIN 300' OF PROPOSED PAD, LOD, OR E&S CONTROL FEATURE.
4. PROPOSED PAD, LOD, OR E&S CONTROL FEATURE IS GREATER THAN 1000' FROM SURFACE OR GROUND-WATER INTAKE OF PUBLIC WATER SUPPLY.
5. CENTER OF PAD IS 625 FEET FROM OCCUPIED DWELLING STRUCTURE AND AGRICULTURAL BUILDINGS LARGER THAN 2500 SQUARE FEET.
6. IT IS NOT THE INTENTION OF THIS PLAT TO REPRESENT A COMPLETE BOUNDARY SURVEY OF THE PARCELS SHOWN HEREON. BOUNDARIES AS SHOWN TAKEN FROM RECORD DEED DESCRIPTIONS, TAX MAPS, AND SUPPLEMENTAL FIELD SURVEY.
7. OWNERSHIP DATA GATHERED FROM COUNTY PUBLIC TAX AND DEED RECORDS.
8. LATERAL GEOMETRY BASED ON WEST VIRGINIA SPC NORTH, NAD 27 DATUM

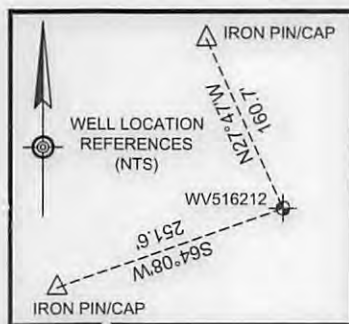

LEGEND

- OUTER LEASE BOUNDARY
- LEASE BOUNDARY
- SURFACE TRACT LINES
- WELL REFERENCE LINES
- ⊙ - COUNTY ROADS
- ⊙ - PUBLIC ROADS
- BLUE-LINE STREAMS
- ⊙ - PROPOSED WELL
- ⊙ - EXISTING WELL
- ▲ - LANDING POINT
- ⊗ - BOTTOM HOLE
- 1 - PROPERTY CROSSED BY BORE
- A - ADJOINER PROPERTY TAB

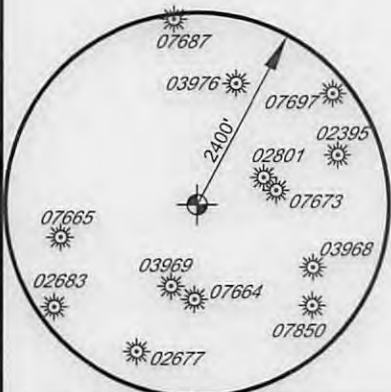
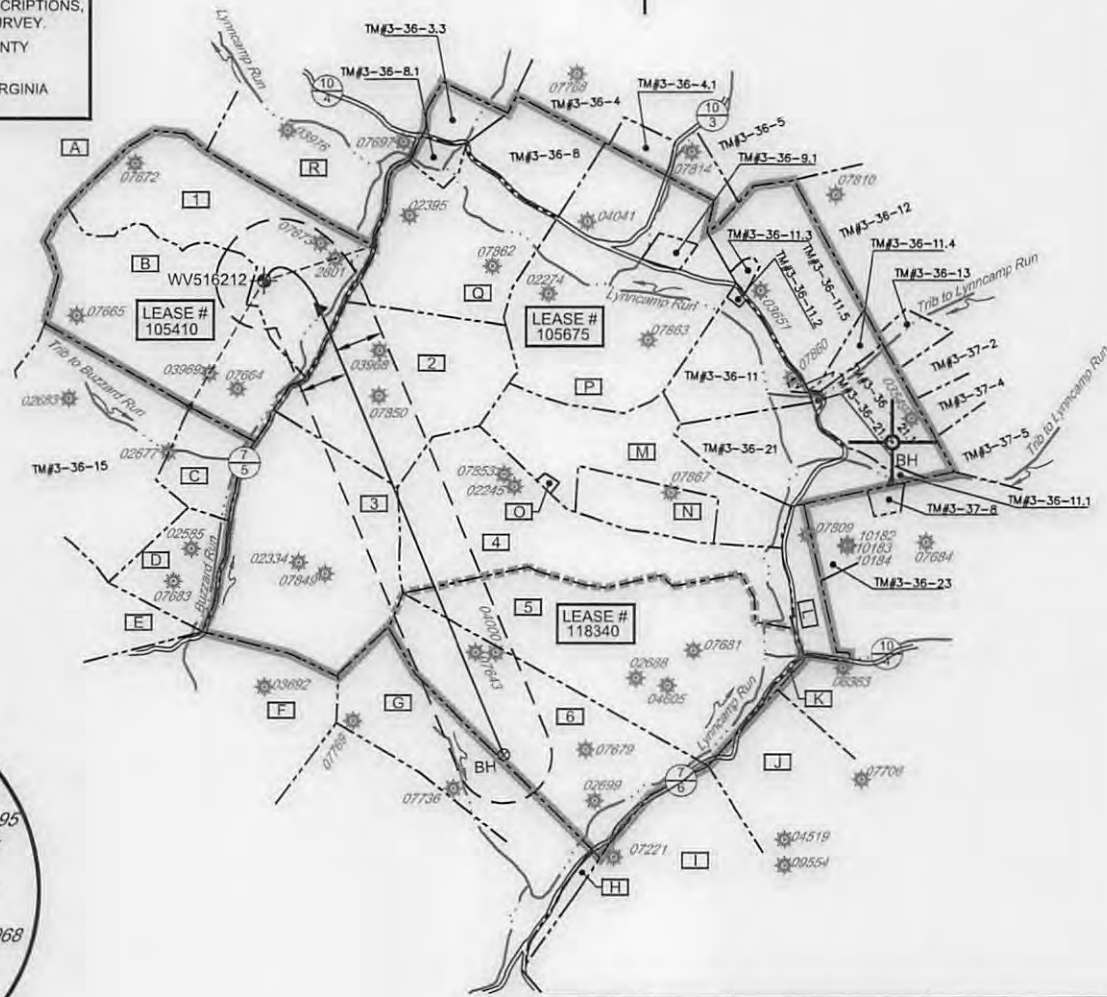

FILE NO. 7936-002
 DRAWN BY DMS
 SCALE 1 INCH = 2000 FEET
 MIN DEGREE OF ACCURACY 1 IN 2500
 PROVEN SOURCE OF ELEVATION SURVEY GRADE GPS

I, THE UNDERSIGNED, HEREBY CERTIFY THAT THIS PLAT IS CORRECT TO THE BEST OF MY KNOWLEDGE AND BELIEF AND SHOWS ALL THE INFORMATION REQUIRED BY LAW AND THE REGULATIONS ISSUED AND PRESCRIBED BY THE DIVISION OF ENVIRONMENTAL PROTECTION

David M. Shannon
 P.S. #2034



(+) DENOTES LOCATION OF WELL ON UNITED STATES TOPOGRAPHIC MAPS

WEST V. D.E.P.
 OFFICE OF OIL AND GAS
 601 57TH STREET
 CHARLESTON, WV 25304

DATE 1-5-2017
 OPERATORS WELL NO. WV516212
 API WELL NO. 47 085 10259 H6A
 STATE COUNTY PERMIT

WELL TYPE: OIL GAS LIQUID INJECTION WASTE DISPOSAL

IF "GAS", PRODUCTION STORAGE DEEP SHALLOW

LOCATION: WATERSHED BUZZARD RUN - NORTH FORK HUGHES RIVER ELEVATION (EXIST) 945.0 (PROP) 938.8

COUNTY/DISTRICT RITCHIE COUNTY - CLAY DISTRICT QUADRANGLE PULLMAN - SEC. 2

SURFACE OWNER CHRISTA J. SMITH ACREAGE 63.88 AC (DEED) 03/03/2017

OIL & GAS ROYALTY OWNER ASHLEY E. NESS JR., ET AL ACREAGE 150 AC LEASE# 105410

PROPOSED WORK: DRILL CONVERT DRILL DEEPER REDRILL FRACTURE OR STIMULATE

PLUG OFF OLD FORMATION PERFORATE NEW FORMATION PLUG & ABANDON

CLEAN OUT & REPLUG OTHER CHANGE (SPECIFY) _____

TARGET FORMATION: MARCELLUS ESTIMATED DEPTH 6183

WELL OPERATOR: EQT PRODUCTION COMPANY DESIGNATED AGENT REX C. RAY

ADDRESS 115 PROFESSIONAL PLACE, PO BOX 280 BRIDGEPORT, WV 26330 ADDRESS 115 PROFESSIONAL PLACE, PO BOX 280 BRIDGEPORT, WV 26330

EQT PRODUCTION COMPANY
WELL NO. 516212 - Ashley E. Ness, Jr. et al
PAGE 1 OF 2

UTM NAD83 ZONE 17N (METERS)	TOPHOLE	N-4342877.51	E-505580.39
	LANDING PT	N-4342790.76	E-505760.46
	BOT HOLE	N-4341384.68	E-506369.98
NAD27 SPC FEET NORTH ZONE	TOPHOLE	N-270987.23	E-1593393.36
	LANDING PT	N-270692.68	E-1593979.50
	BOT HOLE	N-266045.06	E-1595902.63
NAD27 GEO LAT(N) LONG(W)	TOPHOLE	N039.235101	W080.935510
	LANDING PT	N039.234318	W080.933425
	BOT HOLE	N039.221643	W080.926376

MINERAL OWNERS		AREA (Ac±)	LEASE #
Orma M. Johnson, et al		627	105675
Richard Barnard, et al		170	118340

PROPERTY TIES		
L1	S30°25'W	1523.8'
L2	N72°31'E	1201.0'

HORIZONTAL BORE GEOMETRY		
TH - LP	AZ 116.6807°	656.0'
LP - BH	AZ 157.5208°	5029.8'

TOTAL HORIZONTAL LENGTH - 5,892'



PROPERTIES CROSSED BY BORE					
TAB	OWNER	DISTRICT	TAX MAP #	PARCEL #	ACREAGE
1	CHRISTA J. SMITH	CLAY	3-36	P/O #7	69.88 Ac±
2	JOHN R. & ROSE MARIE SUDOL	CLAY	3-36	17	59.56 Ac±
3	FRANK J. OSTROWSKY	CLAY	3-36	18	89.25 Ac±
4	PEGGY WINCE	CLAY	3-36	19	69.5 Ac±
5	PEGGY WINCE	CLAY	3-36	33	95.788 Ac±
6	PEGGY WINCE	CLAY	3-36	32	72.63 Ac±

PROPERTIES ADJOINING THOSE CROSSED BY BORE (ABOVE)					
TAB	OWNER	DISTRICT	TAX MAP #	PARCEL #	ACREAGE
A	ELF, LLC	CLAY	3-36	6	184.724 Ac±
B	MICHAEL L. DAVIS	CLAY	3-36	P/O #7	79.21 Ac±
C	MICHAEL L. DAVIS	CLAY	3-36	16	18.18 Ac±
D	BRIAN M. & MICHAEL W. TAYLOR	CLAY	3-36	29.1	20.693 Ac±
E	BRIAN M. & MICHAEL W. TAYLOR	CLAY	3-36	29	65.407 Ac±
F	TERRY LEE RICHARDS	CLAY	3-36	30	121.5 Ac±
G	ROBERT F. & IRENE D. PUGH	CLAY	3-36	31	51.9 Ac±
H	ROBERT F. & IRENE D. PUGH	CLAY	3-40	10.1	2.89 Ac±
I	JUNE C. BERKLEY FAMILY TRUST	CLAY	3-40	25	81.37 Ac±
J	CLIFTON A. & SHIRLEY M. SAMPLES, ET AL	CLAY	3-36	37	32 Ac±
K	CHARLES E. COTTRILL, JR	CLAY	3-36	33.1	1.212 Ac±
L	CAROL MAY MCATEE	CLAY	3-36	34	11.69 Ac±
M	PEGGY L. VANMETER ET AL	CLAY	3-36	20	48.88 Ac±
N	EVERETT MCATEE	CLAY	3-36	20.1	16.53 Ac±
O	BERNARD & CAROL LEE MCATEE	CLAY	3-36	20.2	0.45 Ac±
P	PAUL W. HILVERS	CLAY	3-36	9	90.70 Ac±
Q	FAITH E. COTTRILL	CLAY	3-36	8.2	51.88 Ac±
R	FOUSS FARMS, LLC	CLAY	3-36	3.4	70.65 Ac±

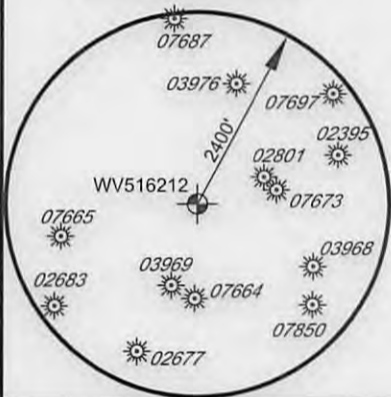

FILE NO. 7936-002
 DRAWN BY DMS
 SCALE 1 INCH = 2000 FEET
 MIN DEGREE OF ACCURACY 1 IN 2500
 PROVEN SOURCE OF ELEVATION SURVEY GRADE GPS

I, THE UNDERSIGNED, HEREBY CERTIFY THAT THIS PLAT IS CORRECT TO THE BEST OF MY KNOWLEDGE AND BELIEF AND SHOWS ALL THE INFORMATION REQUIRED BY LAW AND THE REGULATIONS ISSUED AND PRESCRIBED BY THE DIVISION OF ENVIRONMENTAL PROTECTION

David M. Shannon
 P.S. #2034

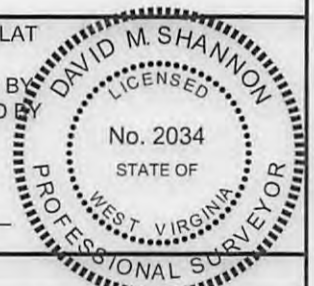

(+) DENOTES LOCATION OF WELL ON UNITED STATES TOPOGRAPHIC MAPS



W.V.D.E.P.
 OFFICE OF OIL AND GAS
 601 57TH STREET
 CHARLESTON, WV 25304

DATE 1-5-2017
 OPERATORS WELL NO. WV516212
 API WELL NO. 47 085 10259
 STATE COUNTY PERMIT

WELL TYPE: OIL GAS LIQUID INJECTION WASTE DISPOSAL
 IF "GAS", PRODUCTION STORAGE DEEP SHALLOW
 LOCATION: WATERSHED BUZZARD RUN - NORTH FORK HUGHES RIVER ELEVATION (EXIST) 945.0 (PROP) 938.8
 COUNTY/DISTRICT RITCHIE COUNTY - CLAY DISTRICT QUADRANGLE PULLMAN - SEC. 2
 SURFACE OWNER CHRISTA J. SMITH ACREAGE 69.88 AC (DEED) **03/03/2017**
 OIL & GAS ROYALTY OWNER ASHLEY E. NESS JR., ET AL ACREAGE 150 AC LEASE# 105410
 PROPOSED WORK: DRILL CONVERT DRILL DEEPER REDRILL FRACTURE OR STIMULATE
 PLUG OFF OLD FORMATION PERFORATE NEW FORMATION PLUG & ABANDON
 CLEAN OUT & REPLUG OTHER CHANGE (SPECIFY) _____
 TARGET FORMATION: MARCELLUS ESTIMATED DEPTH 6183
 WELL OPERATOR: EQT PRODUCTION COMPANY DESIGNATED AGENT REX C. RAY
 ADDRESS 115 PROFESSIONAL PLACE, PO BOX 280 ADDRESS 115 PROFESSIONAL PLACE, PO BOX 280
BRIDGEPORT, WV 26330 BRIDGEPORT, WV 26330

COUNTY NAME PERMIT