

LATITUDE 39°22'30" ← 2,053'

613' TO BOTTOM HOLE  
LATITUDE 39°22'30"

LONGITUDE 80°55'00" ← 1,247' LONGITUDE 80°55'00"

LONGITUDE 80°55'00" ← 1,076' TO BOTTOM HOLE

Antero Resources Corporation  
Well No. Cinqmars Unit 1H  
47-085-10341

NOTES:  
WELL 1H TOP HOLE INFORMATION:  
N: 320,637ft E: 1,597,462ft  
LAT: 39°22'17.68" LON: 80°55'26.14"  
BOTTOM HOLE INFORMATION:  
N: 311,785ft E: 1,598,762ft  
LAT: 39°20'50.41" LON: 80°55'07.80"  
WEST VIRGINIA COORDINATE SYSTEM OF 1927 NORTH ZONE.  
ZONE WAS DERIVED FROM MEASUREMENTS TAKEN WITH TRIMBLE GEOXT SUBMETER MAPPING GRADE GPS UNIT.  
PLAT ORIENTATION, CORNER, AND WELL REFERENCE TIE LINES ARE BASED ON GRID NORTH.

(NAD) 83 (UTM) ZONE 17 COORDS:  
WELL 1H TOP HOLE INFORMATION:  
N: 4,358,024m E: 506,567m  
BOTTOM HOLE INFORMATION:  
N: 4,355,334m E: 507,008m

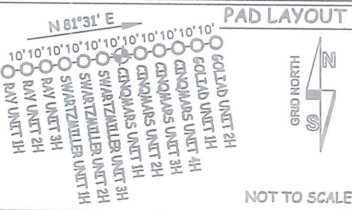

NOTE:  
4 WATER WELLS WERE LOCATED WITHIN 2000' OF CENTER OF PAD

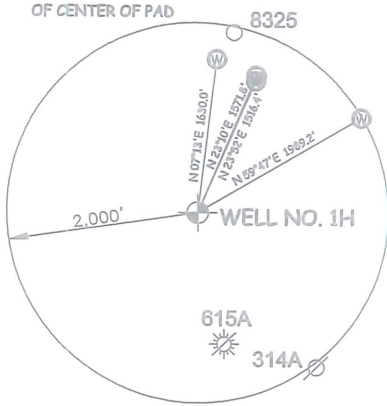

Table with 4 columns: TM-Par, Surface Owner, Book/Pg, Acreage. Lists various land parcels and owners.

Table with 2 columns: Royalty Owner, Name. Lists royalty owners for different sections of the well pad.

I THE UNDERSIGNED, HEREBY CERTIFY THAT THIS PLAT IS CORRECT TO THE BEST OF MY KNOWLEDGE AND BELIEF AND SHOWS ALL THE INFORMATION REQUIRED BY LAW AND THE RULES ISSUED AND PERSCRIBED BY THE DEPARTMENT OF ENVIRONMENTAL PROTECTION.



STATE OF WEST VIRGINIA, DIVISION OF ENVIRONMENTAL PROTECTION, OFFICE OF OIL AND GAS  
WILLOW LAND SURVEYING PLLC  
220 MASONIC AVE. PENNSBORO WEST VIRGINIA 26415

- 1. NO OCCUPIED DWELLINGS OR BUILDINGS TWO THOUSAND FIVE HUNDRED (2,500) SQUARE FEET OR LARGER USED TO HOUSE OR SHELTER DAIRY CATTLE OR POULTRY HUSBANDRY ARE LOCATED WITHIN SIX HUNDRED TWENTY-FIVE (625) FEET OF THE CENTER OF THE WELL PAD.
2. TOP HOLE DATA SHOWN HEREON WAS PROVIDED BY
3. AS DRILLED DATA WAS PROVIDED BY ANTERO RESOURCES CORPORATION.
4. WLS IS NOT CERTIFYING THE DATA AND INFORMATION PROVIDED LISTED IN NOTES 2 AND 3, ONLY THE RELATIONSHIP TO THE DATA AND INFORMATION PROVIDED TO THE LEASE BOUNDARIES.
5. WLS IS BY NO MEANS RESPONSIBLE FOR ANY ERRORS OR INACCURACIES WITH THE DATA AND INFORMATION THAT HAS BEEN PROVIDED.

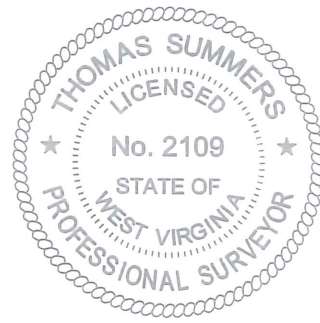

LEGEND section with symbols for Surface Owner Boundary Lines, Interior Surface Tracts, Proposed Well Path, and As Drilled Well Path. Includes signature of Thomas Summers and date 02/10/20.

WELL TYPE: OIL GAS X LIQUID INJECTION WASTE DISPOSAL 47 - 085 - 10341
(IF "GAS") PRODUCTION X STORAGE DEEP SHALLOW X STATE COUNTY PERMIT
LOCATION: ELEVATION 1,235' AS BUILT WATERSHED NORTH FORK HUGHES RIVER
QUADRANGLE PENNSBORO 7.5 DISTRICT CLAY COUNTY RITCHIE
SURFACE OWNER DAVID L. WEEKLEY REVOCABLE TRUST ACREAGE 203.38 ACRES +/-
OIL & GAS ROYALTY OWNER DAVID L. WEEKLEY REVOCABLE TRUST; NORMAN FLEMING ET UX; HAUGHT FAMILY TRUST; JOHN A. MILLIGAN ET AL; JOHN A. MILLIGAN ET AL; JOHN A. MILLIGAN ET AL; CHARLES ALLMAN; CHARLENE COTTRILL; EMERSON MCCULLOUGH ET AL; ROBERT MCCULLOUGH ET UX LEASE ACREAGE 229 AC±; 130 AC±; 323 AC±; 44.5 AC±; 25 AC±; 25 AC±; 60 AC±; 40 AC±; 154 AC±; 148 AC±
PROPOSED WORK: DRILL CONVERT DRILL DEEPER REDRILL FRACTURE OR STIMULATE
PLUG OFF OLD FORMATION PERFORATE NEW FORMATION OTHER PHYSICAL CHANGE IN WELL (SPECIFY) AS DRILLED PLUG & ABANDON CLEAN OUT & REPLUG
TARGET FORMATION MARCELLUS ESTIMATED DEPTH 6,599' TVD 15,816' MD
WELL OPERATOR ANTERO RESOURCES CORP. DESIGNATED AGENT DIANNA STAMPER - CT CORPORATION SYSTEM
ADDRESS 1615 WYNKOOP ST. ADDRESS 5400 D BIG TYLER ROAD
FORM WW-6 DENVER, CO 80202 CHARLESTON, WV 25313