

11/16/2018

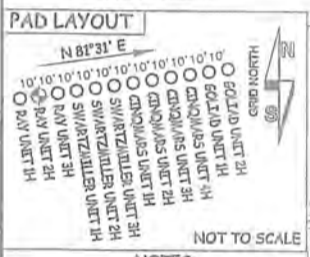

JOB # 17-043WA
 DRAWING # RAY2HR
 SCALE 1" = 2000'
 MINIMUM DEGREE OF ACCURACY SUBMETER
 PROVEN SOURCE OF ELEV. SUBMETER MAPPING GRADE GPS
 STATE OF WEST VIRGINIA DEPARTMENT OF ENERGY DIVISION OF OIL AND GAS

I THE UNDERSIGNED, HEREBY CERTIFY THAT THIS PLAT IS CORRECT TO THE BEST OF MY KNOWLEDGE AND BELIEF AND SHOWS ALL THE INFORMATION REQUIRED BY LAW AND THE RULES ISSUED AND PRESCRIBED BY THE DEPARTMENT OF ENVIRONMENTAL PROTECTION.



STATE OF WEST VIRGINIA, DIVISION OF ENVIRONMENTAL PROTECTION, OFFICE OF OIL AND GAS
 WILLOW LAND SURVEYING PLLC
 220 MASONIC AVE. PENNSBORO WEST VIRGINIA 26415

LEGEND
 - - - - - Surface Owner Boundary Lines +/-
 - - - - - Interior Surface Tracts +/-
 - - - - - Existing Fence
 - - - - - Found monument, as noted

DOUGLAS R. ROWE P.S. 2202
 DATE 07/30/18
 OPERATOR'S WELL# RAYUNIT#2H

WELL TYPE: OIL ___ GAS X LIQUID INJECTION ___ WASTE DISPOSAL ___
 (IF "GAS") PRODUCTION X STORAGE ___ DEEP ___ SHALLOW X
 LOCATION: ELEVATION 1,235' AS BUILT WATERSHED NORTH FORK HUGHES RIVER
 QUADRANGLE PENNSBORO 7.5' - TH MIDDLEBOURNE 7.5' - BH DISTRICT CLAY COUNTY RITCHIE
 SURFACE OWNER DAVID L. WEEKLEY REVOCABLE TRUST ACREAGE 203.38 ACRES +/-
 OIL & GAS ROYALTY OWNER DAVID L. WEEKLEY REVOCABLE TRUST; NORMAN FLEMING ET UX; LEASE ACREAGE 229 AC±; 126.5 AC±;
 BRIAN KEITH JONES; CLIFF WM. PERKINS ET UX; CLIFF WM. PERKINS ET UX; CLIFF WM. PERKINS ET UX; 31 AC±; 13 AC±; 13.5 AC±; 13 AC±;
 RAYMOND CECIL DARNELL; JOE-DOM INC.; RICHARD HALL BARNARD 81.5 AC±; 380 AC±; 148,252 AC±
 PROPOSED WORK: DRILL ___ CONVERT ___ DRILL DEEPER X REDRILL ___ FRACTURE OR STIMULATE X
 PLUG OFF OLD FORMATION ___ PERFORATE NEW FORMATION X OTHER PHYSICAL CHANGE IN WELL
 (SPECIFY) MOD-BHL PLUG & ABANDON ___ CLEAN OUT & REPLUG ___
 TARGET FORMATION MARCELLUS ESTIMATED DEPTH 7,000' TVD 16,400' MD
 WELL OPERATOR ANTERO RESOURCES CORP. DESIGNATED AGENT DIANNA STAMPER - CT CORPORATION SYSTEM
 ADDRESS 1615 WYNKOOP ST. ADDRESS 5400 D BIG TYLER ROAD
 DENVER, CO 80202 CHARLESTON, WV 25313

COUNTY NAME PERMIT