

10,065' TO TOP HOLE

LATITUDE 39°22'30"

7,190' LATITUDE 39°22'30"

LONGITUDE 80°52'30"

3,698'

LONGITUDE 80°52'30"

10,349' TO BOTTOM HOLE

Antero Resources Corporation Well No. Leeroy Unit 3H

NOTES:
WELL 3H TOP HOLE INFORMATION:
 N: 318,127ft E: 1,601,191ft
 LAT: 39°21'53.46" LON: 80°54'38.16"
BOTTOM HOLE INFORMATION:
 N: 311,431ft E: 1,603,964ft
 LAT: 39°20'47.72" LON: 80°54'01.53"
 WEST VIRGINIA COORDINATE SYSTEM OF 1927 NORTH ZONE. ZONE WAS DERIVED FROM MEASUREMENTS TAKEN WITH TRIMBLE GEOXT SUBMETER 3H TOP HOLE PLAT ORIENTATION, CORNER, AND WELL REFERENCE TIE LINES ARE BASED ON GRID NORTH.

(NAD) 83 (UTM) ZONE 17 COORDS:
WELL 3H TOP HOLE INFORMATION:
 N: 4,357,278m E: 507,716m
BOTTOM HOLE INFORMATION:
 N: 4,355,253m E: 508,594m

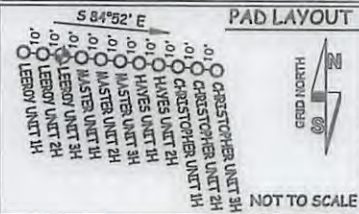

TM-Par	Surface Owner	Book/Pg	Acreage
04-09	Christin Haymond	346/484	111.48 AC
04-10	Perkins Oil & Gas Inc.	316/683	73.168 AC
04-10.2	Perkins Oil & Gas Inc.	316/760	19.772 AC
04-11.9	Thomas Smith	331/358	30.639 AC
04-13	Antero Resources Corp.	341/928	1.25 AC
04-13.1	Trustees Mountain Comm. Bldg.	124/569	1 AC
04-14	Jacob Cox	340/825	5.747 AC
04-15	Christopher Haymond	214/99	1.33 AC
04-27	Perkins Oil & Gas Inc.	308/653	29.589 AC
04-27.1	Perkins Oil & Gas Inc.	308/653	0.79 AC
04-29	Ralph Hayes	265/513	9.91 AC
04-32	Gary Bishop	339/45	4.7 AC
04-35	Gary Bishop	339/43	24.256 AC
04-35.1	Lewis Jones	309/603	23.424 AC
04-36	William Shriver	185/415	21.4 AC
04-47	Sheila Taylor	316/853	6.07 AC
04-47.1	William Shriver	185/415	8.5 AC
04-48	Susan Jones	287/276	42.05 AC
09-01	James Mahoney	277/668	147.83 AC
09-03	Matthew Washington	306/138	39.66 AC
09-04	Zacharia Kelley	312/915	33.50 AC
09-06	Richard Ridgway	312/65	18 AC
09-09	Jeanette Beem Et Al	221/577	51.41 AC
09-17	Rossiter Holmes	295/451	27.43 AC
09-19	Roger Scott	280/625	66 AC
09-20	Walter Smerycha	317/89	70.5 AC
09-21	Roy Robinson	175/817	36 AC

WV NORTH ZONE GRID NORTH

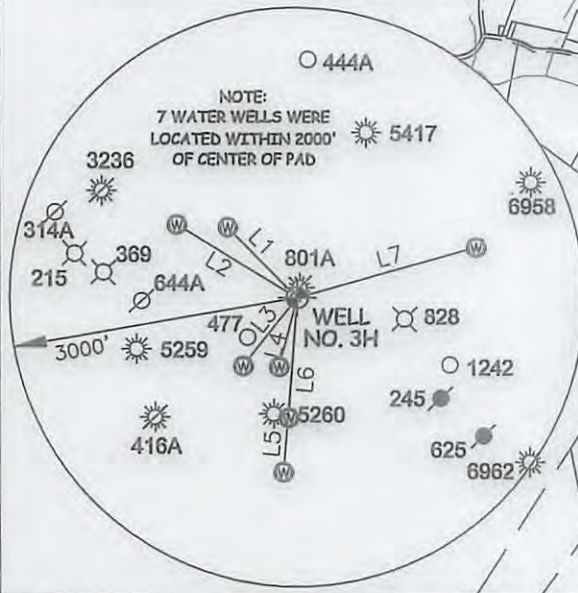

LINE	BEARING	DIST.
L1	N 44°29' W	1030.7'
L2	N 58°42' W	1467.2'
L3	S 38°14' W	908.2'
L4	S 14°39' W	747.3'
L5	S 04°35' W	1820.0'
L6	S 04°09' W	1253.8'
L7	N 74°14' E	1942.9'

Line	Royalty Owner
A	The Irene Nutter Haymond Trust
B	Gary R. Davis Et Ux
C	Candice Winzeler Nigolian
D	Perkins Oil & Gas
E	Charles Eugene Allman Et Ux
F	Norman Fleming
G	L. S. Taggart Et Al
H	Carl W. Ridgway Et Ux
I	Michael A. Toothman Et Ux
J	Charles Eugene Allman Et Ux
K	Gene P. Bond
L	Frederick Hardesty

(NAD) 27 (UTM) ZONE 17 COORDS:
WELL 3H TOP HOLE INFORMATION:
 N: 14,294,790ft E: 1,665,684ft
POINT OF ENTRY INFORMATION:
 N: 14,294,874ft E: 1,666,220ft
BOTTOM HOLE INFORMATION:
 N: 14,288,144ft E: 1,668,568ft

NOTE:
 NO OCCUPIED DWELLINGS OR BUILDINGS TWO THOUSAND FIVE HUNDRED (2,500) SQUARE FEET OR LARGER USED TO HOUSE OR SHELTER DAIRY CATTLE OR POULTRY HUSBANDRY ARE LOCATED WITHIN SIX HUNDRED TWENTY-FIVE (625) FEET OF THE CENTER OF THE WELL PAD.

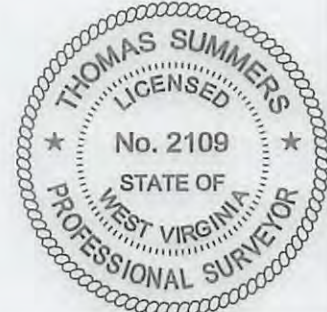

I THE UNDERSIGNED, HEREBY CERTIFY THAT THIS PLAT IS CORRECT TO THE BEST OF MY KNOWLEDGE AND BELIEF AND SHOWS ALL THE INFORMATION REQUIRED BY LAW AND THE RULES ISSUED AND PERSCRIBED BY THE DEPARTMENT OF ENVIRONMENTAL PROTECTION.



STATE OF WEST VIRGINIA, DIVISION OF ENVIRONMENTAL PROTECTION, OFFICE OF OIL AND GAS

WILLOW LAND SURVEYING PLLC
 220 MASONIC AVE. PENNSBORO WEST VIRGINIA 26415

JOB #	LEGEND	REFERENCES	STAKE/NAIL, SET
17-014WA	Surface Owner Boundary Lines +/- Interior Surface Tracts +/- Existing Fence Found monument, as noted		
DRAWING # LEEROY3H	<i>Thomas Summers</i>		
SCALE 1" = 2000'	THOMAS SUMMERS P.S. 2109		
MINIMUM DEGREE OF ACCURACY SUBMETER	DATE 04/13/18		
PROVEN SOURCE OF ELEV. SUBMETER MAPPING GRADE GPS	OPERATOR'S WELL# LEEROY UNIT #3H		
STATE OF WEST VIRGINIA DEPARTMENT OF ENERGY DIVISION OF OIL AND GAS			

WELL TYPE: OIL GAS LIQUID INJECTION WASTE DISPOSAL 47 - 085 - 10364
 (IF "GAS") PRODUCTION STORAGE DEEP SHALLOW STATE COUNTY PERMIT
 LOCATION: ELEVATION 974' - ORIGINAL 970' PROPOSED WATERSHED NORTH FORK HUGHES RIVER
 QUADRANGLE PENNSBORO 7.5' DISTRICT CLAY COUNTY RITCHIE
 SURFACE OWNER DANIEL M. HAYMOND IV, ET AL ACREAGE 111.48 ACRES +/- LEASE ACREAGE 375 AC±; 35.89 AC±;
 OIL & GAS ROYALTY OWNER THE IRENE NUTTER HAYMOND TRUST; CANDICE WINZELER NIGOLIAN; PERKINS OIL & GAS; NORMAN FLEMING; L. S. TAGGART ET AL; 44.0 AC±; 49.5 AC±; 151 AC±;
 CARL W. RIDGWAY ET UX; MICHAEL A. TOOTHMAN ET UX; GENE P. BOND 40 AC±; 34 AC±; 70.5 AC±;
 PROPOSED WORK: DRILL CONVERT DRILL DEEPER REDRILL FRACTURE OR STIMULATE
 (SPECIFY) PLUG OFF OLD FORMATION PERFORATE NEW FORMATION OTHER PHYSICAL CHANGE IN WELL
 TARGET FORMATION MARCELLUS ESTIMATED DEPTH 6,800' TVD 15,000' MD
 WELL OPERATOR ANTERO RESOURCES CORP. DESIGNATED AGENT DIANNA STAMPER - CT CORPORATION SYSTEM
 ADDRESS 1615 WYNKOOP ST. ADDRESS 5400 D BIG TYLER ROAD
 FORM WW-6 DENVER, CO 80202 CHARLESTON, WV 25313

06/29/2018

COUNTY NAME PERMIT

Antero Resources Corporation

Appalachian Basin

Leeroy Unit 3H

Ritchie County

Quadrangle: Middlebourne

Watershed: North Fork Hughes River

District: Clay

Date: 2-1-2017

